

Tech sheet

# CeramicSpeed Bottom Bracket

## Spacer overview for SRAM DUB

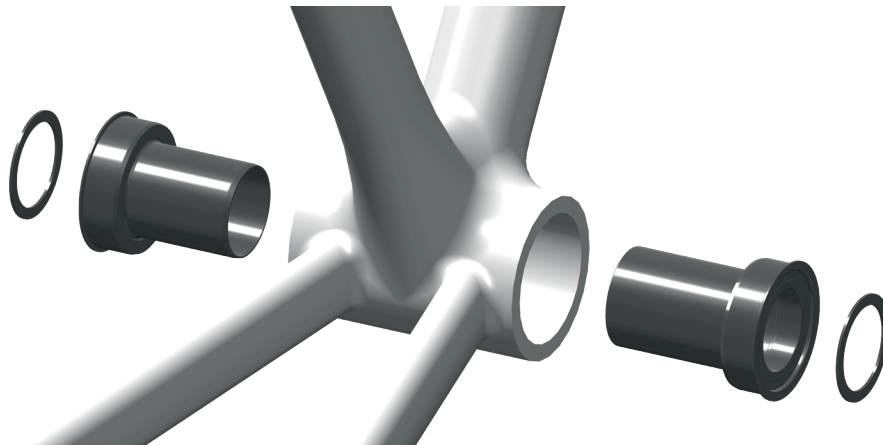

ROAD	Frame width	Non-drive side		Drive side	
		Standard	Wide	Standard	Wide
BB86	86,5	0	2 × 1 mm	3 mm	2 × 3 mm
BB30	68	0	3 mm	3 mm	2 × 1 + 3 mm
PF30	68	0	2 × 1 mm	3 mm	2 × 3 mm
PF30a	73	2 × 3 mm	NA	3 mm	NA
BBright	79	1 mm	3 mm	3 mm	2 × 3 mm
EVO386	86,5	2 × 1 mm	2 × 1 + 3 mm	2 × 3 mm	2 × 1 + 2 × 3 mm
BSA	68	1 mm	3 mm	3 mm	2 × 3 mm
ITA	70	1 mm	3 mm	3 mm	2 × 3 mm
T45 (Colnago)	82,5	3 mm	2 × 1 + 3 mm	2 × 1 + 3 mm	2 × 1 + 2 × 3 mm
T47	68	2 × 1 mm	2 × 1 + 3 mm	2 × 3 mm	2 × 1 + 2 × 3 mm
T47a	76,75	2 × 1 mm	2 × 1 + 3 mm	2 × 1 + 3 mm	2 × 1 + 2 × 3 mm
T47 (Trek)	85,5	3 mm	2 × 1 + 3 mm	2 × 3 mm	3 × 3 mm
T47	86,5	2 × 1 mm	2 × 1 + 3 mm	2 × 3 mm	2 × 1 + 2 × 3 mm

OFF-ROAD	Frame width	Non-drive side	Drive side
BB92	91,5	0	1 + 3 mm
BB30	73	0	1 + 3 mm
PF30	73	0	1 + 3 mm
PF30 (only for Cannondale AI)	83	0	1 + 3 mm
BSA	73	1 mm	1 + 3 mm