

---

# Mounting & Maintenance

OSPW X

For Shimano RX800/805



**CERAMICSPEED**

# Maintenance

No set of rules can be made for how often your Oversized Pulley Wheels are to be maintained. Maintenance frequency depends on the weather conditions that you are riding in.

A worn chain will increase the wear on the pulley wheels significantly, so make sure that you change your chain before it is completely worn out. Under normal conditions, we recommend that you service the Oversized Pulley Wheels when you have ridden under wet conditions, washed your bike or each time you lubricate the chain. For normal maintenance, add a drop of oil into the lubrication points (see the page 3) for optimal performance. Make sure to position the OSPW System horizontally to ensure that the oil reaches the Oversized Pulley Wheel bearings.

We recommend the use of CeramicSpeed Oil on the OSPW System. This can be purchased from the CeramicSpeed dealers worldwide or from our webshop. Watch our maintenance video on [ceramicspeed.com](http://ceramicspeed.com) in the Support section.

**When travelling**, your OSPW System will not fit in the bike travelling bag. We recommend that you dismount the whole rear derailleur and pack it aside.

## Extended Maintenance

Approximately once every half a year we recommend that you perform an extended maintenance. In this case, you should dismount the Oversized Pulley Wheels from the cage, remove the seals from both sides and clean all parts in a shaker with degreaser. After cleaning, dry the components off, put two drops of oil onto the CeramicSpeed Balls, place the seals back on and remount the Oversized Pulley Wheels. When dismounting the cage plates, you will need a 2.5 mm Allen Key for the pulley wheel bolts (see page 3) and a 2 mm Allen key for the tower bolts. To remount the screws, tighten the pulley wheel screws up to a max torque of 1 Nm and the tower bolts up to 0.3 Nm. For this, a torque tool is recommended. If you're riding in wet and muddy conditions, we recommend you to perform an extended maintenance more frequently and replace oil with All Round Grease for better protection.

# Mounting the CeramicSpeed Oversized Pulley Wheel X System for Shimano RX800/805

Pos.	Description
1	Pulley wheel bolts
2	Tower bolts
3	Back cage plate
4	Upper pulley
5	Lower pulley
6	Cage pivot
7	Front cage plate
8	Rotation stop screw
9	Pulley wheel lubrication points

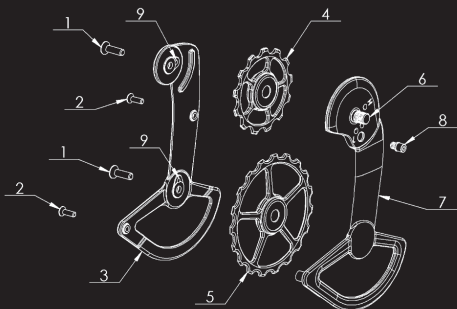

## Tools required

For the installation of your new CeramicSpeed Oversized Pulley Wheel X for Shimano RX800/805 you will need the following tools:

- A: 2mm Allen key
- B: 2,5mm Allen key
- C: 3mm Allen key
- D: 4mm Allen key
- E: Chain Tool
- F: Torque wrench
- G: Philips screwdriver

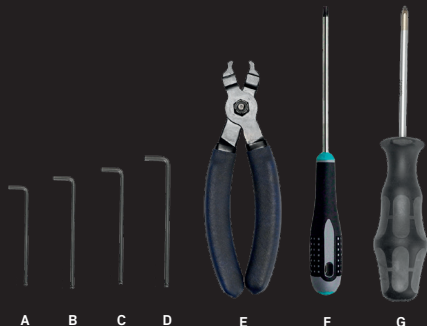

# Mounting Manual

To ensure the very best in riding performance it is vital that your new OSPW X System is mounted correctly. Follow these instructions to install your OSPW X System for Shimano RX800/805:

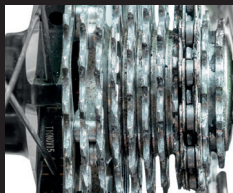

1. Begin with your bike mounted in a stand. Remove the chain and the rear wheel.

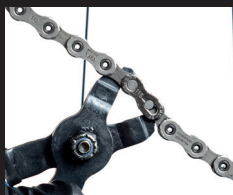

2. Remove your chain by using the proper chain tool. When completing the installation of the OSPW System you will need to start with a new, uncut chain.

Note: it is not recommended to add links to a previously ridden chain.

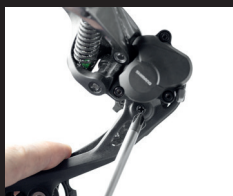

3. Next, shift the derailleur up, past the cable routing/motor point. Rotate the pulley cage (A) downward, locate and remove the Philips head pulley cage stop screw (B). Carefully allow the pulley cage spring to unwind, releasing the spring tension. Your derailleur cage will appear to be upside down.

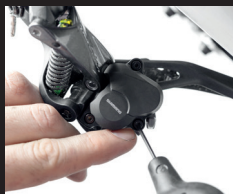

4. Remove the 3 screws on the clutch cover with a 2mm Allen Key. Please note the rubber gasket that sits between the clutch cover and derailleur body. Carefully set the cover, gasket and screws aside as they will be reinstalled.



5. Hold the pulley cage and loosen the main mounting screw inside the clutch with a 4mm Allen key to remove the stock cage. Take care that the clutch remains in the original position, flat against the derailleur body.

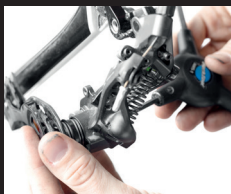

6. Once the cage is free, be careful not to drop the pulley spring and/or plastic spacer.



7. Remove the spring and plastic spacer from the Shimano cage and set it aside. The end of the spring is hooked to lock into the pulley cage, you may need to wiggle the spring to release the hook from the cage. Remove and keep the silver washer for use on the OSPW X system.



8. Unbox the OSPW X System and remove the original stop screw with a 2,5mm Allen key (to be reinstalled once the cage is mounted).



9. Install the flat silver washer from the stock cage onto the OSPW X body, over the threaded post.



10. Mount the factory spring and plastic spacer onto the face of the OSPW X System. Make sure that the plastic cover is placed exactly the same way on the OSPW X System as on the Shimano assembly. The flat face should sit against the OSPW X System.

Note the four spring tension settings on the OSPW cage: from H (high) to L (low). The L tension setting will reduce both chain tension and friction, but can result in slightly compromised shifting performance. The H tension setting provides the best in shifting performance, yet it will increase friction performance over lower tension settings.

For general mixed terrain (dirt/gravel) or Cyclo-Cross racing, select the spring tension hole just beside H (second highest tension) and insert the end of the spring until it's hooked. The plastic cover must be placed over the spring and aligned in the right position when mounting the OSPW cage to the derailleur body.

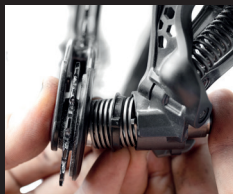

11. Pull the derailleur body back, and position the OSPW X cage facing forward. With the spring and plastic cover on the OSPW X, align the tension spring and plastic cover into the square shaped slot of the derailleur body and insert it until it sits flush. Pivot the system back and forth to ensure smooth movement and spring engagement. The clutch mechanism may be pushed out slightly during this.



12. Carefully align the female threads of the cage with the male thread in the derailleur body and slowly tighten to avoid cross threading the cage. Hold the OSPW cage still and tighten the original main mounting screw inside the clutch with a 4mm Allen key to 5.5 Nm. Take care that the clutch remains in the original position during the tightening.



13. Put on the clutch cover (be aware of the gasket) and mount the 3 screws on the clutch cover with a 2mm Allen Key to 0.8 Nm.



14. Rotate the cage counter-clockwise (up first and then backwards) to increase the spring tension. Once rotated far enough around, mount the CeramicSpeed stop screw with a 2,5mm Allen key. Tighten to 0.3 Nm.

Your new OSPW System is now mounted.

Shift down the derailleur to the bottom and install a new chain, followed by the rear wheel.

Confirm the upper & lower limits, and adjust the gears until it's aligned with the cassette sprockets.

## Chain length

If you are using a 44 tooth or larger chain ring you may not be able to overlap the ends of the chain for measurement. You do not need to add any links to a stock chain, a full length chain is sufficient for use.

Recommendation on upper pulley clearance on the largest cog (adjusting of B-limit) = 10-15mm depending on cassette size.



**STEP 1:** Place the chain on the smallest cog on the cassette. To find the correct chain length, pull the two chain ends together, just as you would when needing to cut a chain to length. The lower part of the cage should start to move downwards, away from the cassette, as referenced in the second image.





STEP 2: When tension is applied on the chain and the OSPW X System appears to be aligned as the diagram above, the chain needs to be cut (1 link shorter than step 1) and connected by the required amount of links in order to achieve sufficient tension in this gear combination (always the small cog on the cassette).

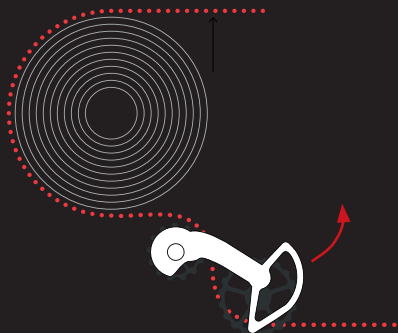

STEP 3: With the chain now cut to length it is important to test the clearance of the OSPW X System when the rear derailleur is set in the largest cog on the cassette. Just as the arrow indicates the cage should be able to rotate counter clockwise. It is important that there is some clearance between the upper pulley wheel of the OSPW X System and the largest cog on the cassette. If you find the clearance is not enough, adjust the B-tension accordingly.

# Up to 6 years warranty

Thankfully, we do not have to deal with warranty issues often. Nevertheless, we are happy to introduce you to our comprehensive warranty program.

## Standard products 4 years

Bottom Brackets  
Pulley Wheels  
Wheel Kits  
Headsets  
Oversized Pulley Wheel Systems  
Single Bearings

## Coated products 6 years

Bottom Brackets  
Pulley Wheels  
Wheel Kits  
Headsets  
Oversized Pulley Wheel Systems  
Single Bearings

We are committed to manufacturing and delivering the best ceramic bearing products in the industry. Should your CeramicSpeed product not live up to your expectations, and this is caused by defects in materials and/or workmanship, we encourage you to contact us.

Register your product within the first 30 days of purchase on [ceramicspeed.com/sport](https://ceramicspeed.com/sport) under the section Support. Should you thereafter, and within the warranty period need to file a claim, please return to the same section on our website and fill in your claim. We will always strive to revert to you concerning your claim within 24 hours.