

Straight Blade Devices

15A, 125V, 2 Pole, 3 Wire Grounding

Extra Heavy Duty Hospital Grade SNAPConnect® Receptacle

- Features
- Audible SNAP, indicates solid connection
  - Reduces installation time
  - Fully insulated design

Ordering Information

Description	Device Color	UPC Number	Catalog Number
Hospital grade, Style Line® decorator	Black	783585247991	SNAP2172BKA

Listings

UL Listed to UL498 File No. E2186  
CSA Certified  
Fed. Spec. W-C-596  
NEMA® WD-6 Compliant

Specifications

Face	Nylon
Base	PBT
Power Contacts	Brass
Ground Contacts	Brass
Mounting Strap	Galvanized steel
Automatic Self-grounding Staple	Stainless steel
Mounting Screws	Zinc plated steel

Performance

Electrical	
Current Interrupting	Receptacle certified for current interrupting at full rated current
Dielectric Voltage	Withstands 2,000V minimum
Mechanical	
Product Identification	Ratings are a permanent part of the device
Environmental	
Flammability	UL 94V-2
Operating Temperature	Maximum continuous 75°C; minimum -40°C (without impact)

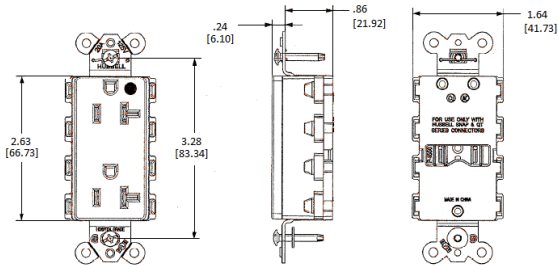

Complementary Products

Wallplate or Weatherproof Cover	StyleLine® Decorator Opening
---------------------------------	------------------------------

Online Resources

Customer Sales Drawings  
eCatalog  
Installation Instructions

