

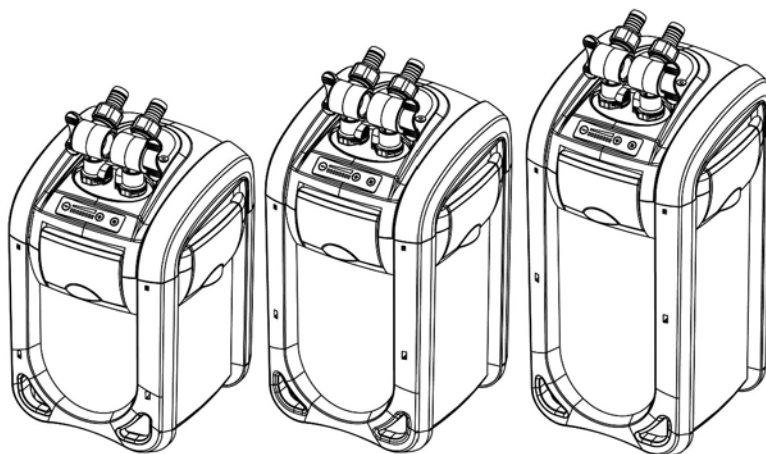

REACTION PRO



PRO-25 PRO-35 PRO-45

MANUAL

WWW.JBJLIGHTING.COM

REACTION- 4 STAGE

TABLE OF CONTENTS	
IMPORTANT SAFETY INTRUCTIONS	3—5
INTRODUCTION	
Parts View & Specifications	6
Unpacking	7
Unpacking	10
GETTING STARTED	
Removing Canister Lid	8
Attaching Canister Lid	9
Hose Connection to Valve	9
Connecting Valve to Canister Lid	10
Plumbing Assembly	10
Inlet / Outlet Pipe Placement	11
OPERATING	
Opening Valves & Powering Up	12
Auto Priming/Siphon	13
Adjusting Water Level	14
MAINTENANCE	15-16
CLEANING / REPLACING IMPELLOR	17
REPLACING UV BULB	18
WARRANTY	22-23

REACTION - 4 STAGE

Important Safety Instructions

WARNING

To guard against injury, basic safety precautions should be observed, including the following:

READ ALL SAFETY INSTRUCTIONS BEFORE USE.

DANGER

To avoid possible electric shock, special care should be taken since water is employed in the use of aquarium equipment. For each of the following situations, do not attempt to repair yourself: return the appliance to an authorized service facility for service or discard the appliance.

- A. If the appliance falls into water, DON'T reach for it! First unplug it and then retrieve it. If the electrical components of the appliance get wet, unplug the appliance immediately.
- B. Carefully examine the appliance after installation. It should not be plugged in if there is water on parts not intended to be wet.
- C. Do not operate any appliance if it has a damaged cord or plug, or if it is malfunctioning or if it is dropped or damaged in any manner.
- D. To avoid the possibility of the appliance plug or receptacle getting wet, position aquarium stand and tank to one side of a wall mounted receptacle to prevent water from dripping onto the receptacle or plug. A "drip loop", shown in the Figure at the right should be arranged by the user for each cord connecting an aquarium appliance to a receptacle. The "drip loop" is that part of the cord below the level of the receptacle or the connector if an extension cord is used, to prevent water travel along the cord and coming in contact with the receptacle. (Continued on pg 4)

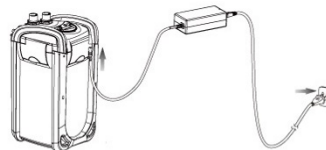

REACTION - 4 STAGE

Important Safety Instructions

D. (Continued from pg 3)

If the plug or the receptacle do get wet, DON'T unplug the cord. Disconnect the fuse to the circuit breaker that supplies power to the appliance. Then unplug and examine for the presence of water in the receptacle.

E. Close supervision is necessary when any appliance is used by or near children.

F. To avoid injury, do not contact moving parts or hot parts such as heaters, reflectors, lamp bulbs, and etc.

G. Always unplug an appliance from the outlet when not in use, before putting on or taking off parts, and before cleaning. Never yank the cord to pull plug from the outlet. Grasp the plug and pull to disconnect

H. Do not use an appliance for other than intended use. The use of attachments not recommended or sold by the appliance manufacturer may cause an unsafe condition.

I. Do not install or store the appliance where it will be exposed to the weather or to temperatures below freezing.

J. Make sure an appliance mounted on a tank is securely installed before operating it.

K. Read and observe all the important notices on the appliance.

L. This Appliance has a polarized plug (one blade is wider than the other). As a safety feature, this plug will fit in a polarized outlet only one way. If the plug does not fit fully in the outlet, reverse the plug. If it still does not fit, contact a qualified electrician. Never use with an extension cord unless plug can be fully inserted. Do not attempt to defeat this safety feature.

M. This appliance is intended **FOR HOUSEHOLD USE ONLY.**

Do not use or mount this appliance in such a way that the top vents are restricted or blocked. These vents are necessary to avoid over-heating and insure safe operating temperature.

REACTION - 4 STAGE

Important Safety Instructions

O. Make sure that all hose connections are firmly secured before turning on this filter. Never look directly at the UV lamp, which may cause discomfort to eyes and skin.

Always unplug canister filter before performing any maintenance.

CLEANING

It is important to keep this appliance clean. Always unplug the appliance before performing maintenance or cleaning of the exterior of this hood. Wipe exposed surfaces carefully with a damp terrycloth to remove any dust or mineral deposits which may collect over time. Make sure all surfaces are dry before re-plugging into an electrical outlet. To prevent scratching the appliance, use a damp terrycloth when cleaning.

SERVICING

In order to assure proper electrical connections and polarity, replacement parts and servicing should be performed only by a qualified electrician.

OPERATION

Please carefully read the entire "Owner's Manual" for proper operation procedures before proceeding with turning on this appliance and adding livestock such as fish, corals, and invertebrates.

SAVE THESE INSTRUCTIONS

REACTION PRO Introduction

PARTS EXPLODED VIEW & IDENTIFICATION

Reaction Pro Canister

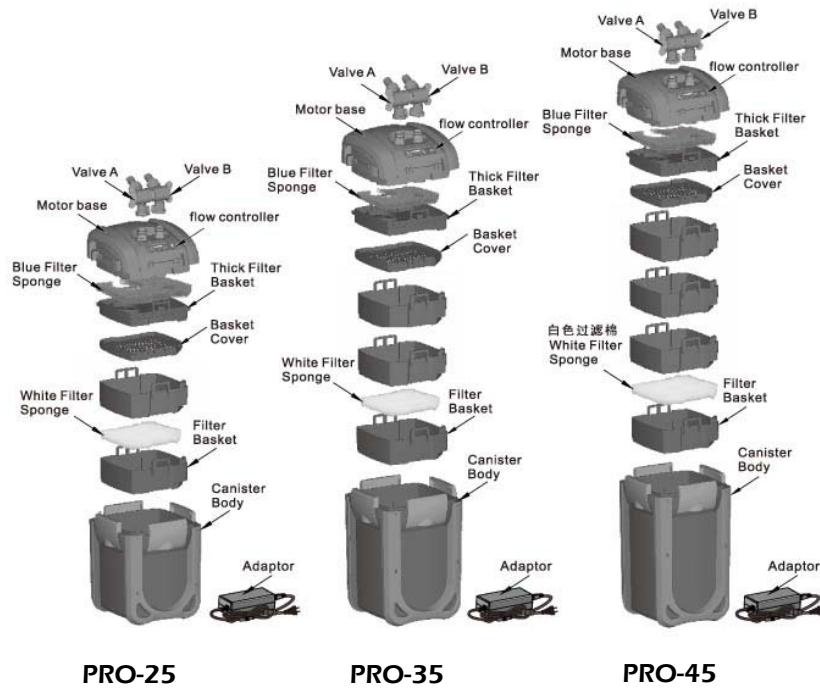

Specifications

MODEL	TANK SIZE	PUMP			DIMS <i>LxWxH</i>
		<i>Flow Rate</i>	<i>Power</i>	<i>UV</i>	
PRO-25	125	80-425	4-30W	4W	9.45"x9.45"x16.18"
PRO-35	145	80-425	4-30W	4W	9.45"x9.45"x18.31"
PRO-45	165	80-425	4-30W	4W	9.45"x9.45"x20.51"

REACTION PRO Introduction

What's Included in the Box

Carefully unpack your new REACTION PRO. Inspect all its components and confirm all parts are included before using.

Report any damages or missing components to:

Toll Free—877-374-9981

Email—warranty@jbjlighting.com

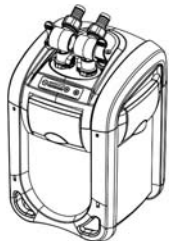

1—Reaction Pro Canister Filter



1—24V DC Plug

Plumbing Kit

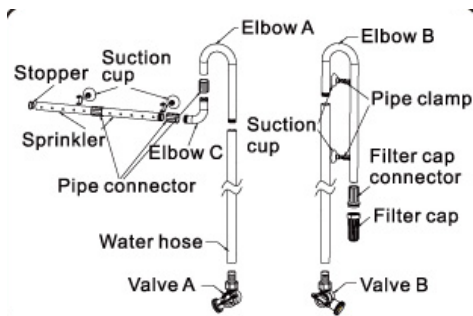

REACTION PRO

GETTING STARTED

• Removing Canister Lid



Pull locking clamp upwards and outwards



Pull out the top part of left & right locking clamps



Separate locking clamps from locking support on both sides



Lift filter lid and remove from canister

• Clean before use.

- It is recommended to clean canister filter before first time use.
- Use a wet cloth to wipe down the inside of the canister filter, trays, and lid.
- Remove filter media from plastic bags and place back in trays.
- It is recommended the bottom most filter to be White Filter Sponge and Top to be Blue Filter Sponge.
- The middle will be the BIO media

See fig below

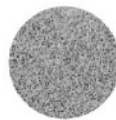

Blue filter sponge



Activated carbon



Quartz ball



Bio-ball



White filter sponge

- Filter Baskets must be placed back in the Canister with corner Water Entry positioned the same way on each tray.

Gap for the power cable



Water entry

Gap for the power cable

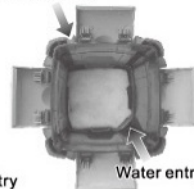

Water entry

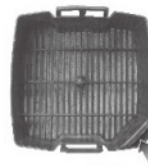

Water entry

REACTION PRO

GETTING STARTED

• Attaching Lid back onto Canister



Line up gaps for power cord



Fasten top edge of locking clamp to the locking support



Press the left & right locking clamps downward & inward



Press down the front and back locking clamps

• Hose connection to Valves

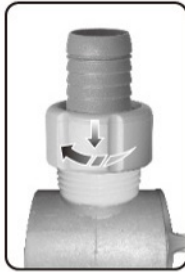

Twist Compression Nut Counter Clockwise to loosen

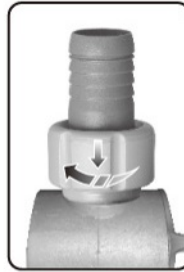

Insert hose to barbed fitting on valve

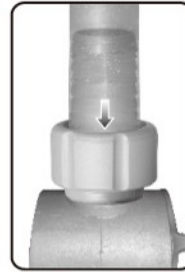

Tighten Compression Nut to secure hose.

REACTION PRO

GETTING STARTED

Connecting Valve to Canister Lid



Locate the inlet and outlet male connections on canister lid

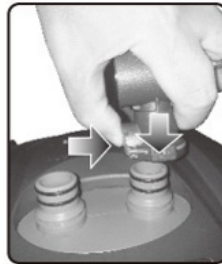

Insert valve onto canister lid by pressing the release on the valve



Push valve onto canister lid.

Plumbing assembly

Assembly Outlet and Inlet Pipe according the diagram below.

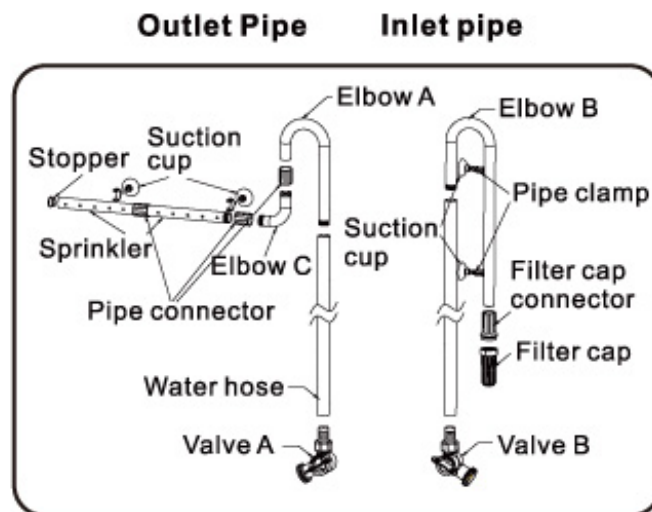

Spray Bar is optional to use on Outlet Pipe.

REACTION PRO

GETTING STARTED

Inlet / Outlet Placement

- Place inlet pipe in aquarium. Use suction cups to secure to aquarium wall.
- Place outlet pipe in aquarium. Use suction cups to secure to aquarium wall.

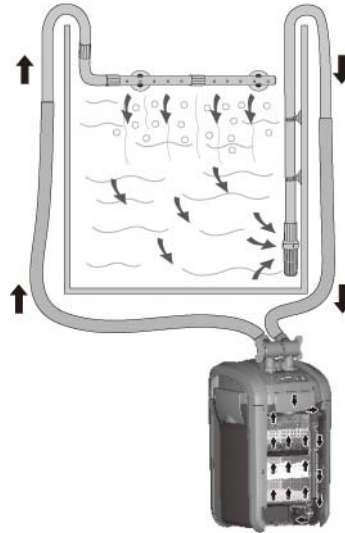

- Below are some suggestions for placement of the inlet and outlet pipes



REACTION PRO

OPERATION

Opening Valves

Once you have securely installed the inlet / outlet pipes you can open the valves as shown below.

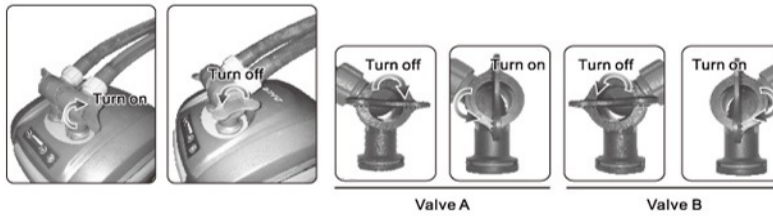

Power up

Confirm all plumbing connections are secure before powering up Reaction Pro Canister.

- Insert DC Adaptor plug into Canister Lid
- Plug DC plug into household approved surge protector

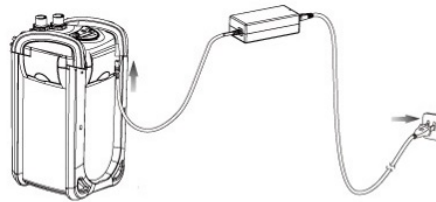

- The 4Watt UV will automatically turn on once Reaction Pro is powered up.
- The internal pump will automatically start running when powered up.

REACTION PRO

OPERATION

Auto Priming/Siphon

- Press "S" Button once to automatically siphon water through and push the air out of the canister. This will run for 12 seconds
- If the water is not pumped through you will need to repeat until water is pumped through.

NOTE: this function will be noisy for 12 seconds or until the water gets pumped through. Once water is pumped through and air pushed out the noise will subside.

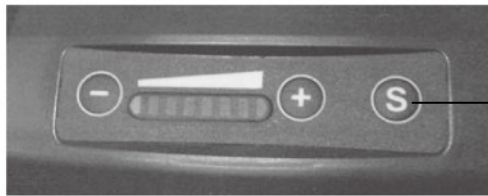

Auto Siphon

Once water is pumped through Reaction Pro—check for any leaks on any of the plumbing connections and Canister filter.

Variable Flow Control

The Reaction Pro has 9 flow rate settings 80gph to 425gph. Press the (-) or (+) buttons to the desired flow rate.

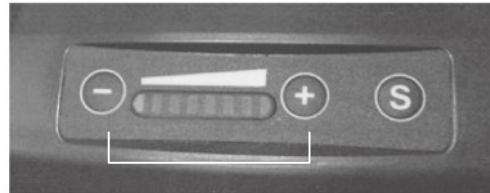

Variable
Flow Control

REACTION PRO

OPERATION

Adjusting Water Level

- Adjust the height or angle of the return hose back into your aquarium to your specific needs.
- If you have chosen to use the RETURN NOZZLE, you can turn the nozzle to face upwards for more surface tension or downwards for more movement at the bottom of the aquarium.
- If you have chosen to use the SPRAY BAR, adjust it so the small openings in the spray bar are angled at a 45 degrees angle so it breaks the surface of the water for more gas exchange.

REACTION PRO

MAINTENANCE

Water Changes

- Regular maintenance is the key to a successful thriving aquarium. Maintaining an aquarium can be very easy with a regular cleaning schedule.
- Water changes should be carried out on monthly to bi-monthly schedule depending on how much bio-load is kept.
- 25% water changes with gravel vacuuming is essential to keep dissolved organic carbons to a minimum.

Routine Maintenance

Periodic filter media replacement is crucial for the well being of your livestock. As most mechanical and chemical medias are exhausted, they slowly lose performance and no longer filter the water efficiently.

We recommend changing the media located inside the baskets on a monthly basis.

Maintenance Preparations

- Unplug the Filter Power Cord
- Close the **Inlet & Outlet Valves**.
- Press Release on Valves and lift up valves from Canister Filter
- Lift the Reaction Canister Filter from the main body and not the cover to a sink or drain to perform cleaning and maintenance husbandry.
- Unlock the **HANDLE CLAMPS** and remove cover carefully.
- Drain as much water out of the filter and remove baskets individually.

REACTION PRO

REPLACING THE FINE WHITE FILTER FLOSS

- A. White Filter Floss should be changed on a monthly basis to remove small trapped debris and free floating particulate matter.

REPLACING THE COARSE BLACK SPONGE

- A. Black Coarse Sponge should be changed on a monthly basis to remove medium to large trapped debris and free floating particulate matter.

REPLACING THE ACTIVATED CARBON BAG

- A. Activated Carbon adsorbs dissolved pollutants and removes the yellow discoloration of water and associated odors.
- B. Replace Activated Carbon Bag on a monthly basis.

CLEANING THE CERAMIC RINGS/QUARTZ BALLS

- A. The Ceramic Rings are the primary biological support for keeping toxic ammonia and nitrite at acceptable levels. Generally, the biological media should not be replaced unless detritus and waste is prohibiting the amount of exposed surface area available for the beneficial bacteria. Clean ceramic rings with the aquarium water and NEVER use tap water that can destroy the bacteria.
- B. Replace Ceramic Rings as needed or add extra for higher volume aquariums with large bio-loads.

REACTION PRO

CLEANING/REPLACING IMPELLER

- Remove Canister Lid from Canister
- From the underside—locate pump coupling.
- Turn coupling to loosen from Canister Lid
- Pull Coupling up
- Pull out Impellor and shaft

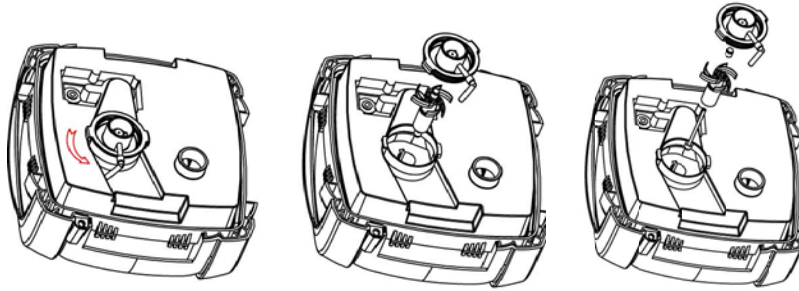

REACTION PRO

REPLACING UV-C LAMP

The UV-C lamp within the Reaction Pro Canister Filter requires replacement after 9-12 months use. Always disconnect the power supply and NEVER look directly at the lamp.

Tools Required: Phillips Screwdriver

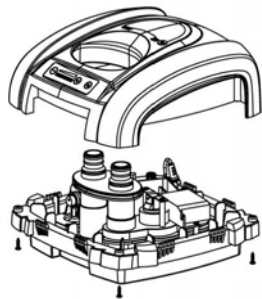

- Unscrew the (4) screws from the underside of the cover.

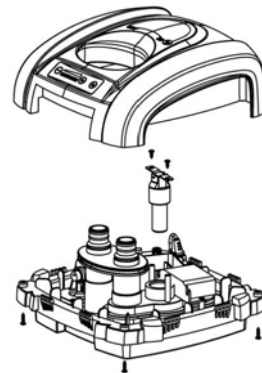

- Separate the top cover of Canister Lid from bottom housing
- Unscrew the (2) screws from UV socket from bottom housing

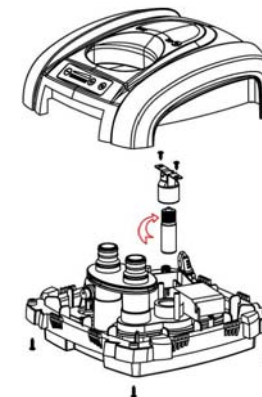

- Twist UV Bulb out of Socket and replace with UV-3W (3Watt UV Bulb)

REACTION PRO

NOTES

REACTION PRO

REACTION PRO

REACTION PRO

WARRANTY INFORMATION **1 Year Limited Warranty**

- This **REACTION PRO** is warranted to the original purchaser against defective material and workmanship for 1 Year from the date of original purchase. This warranty is valid only under the following conditions: additions, modifications, or changes made to the product by the purchaser and not by the manufacturer shall void this warranty. Damages brought on by abuse, misapplication, or mishandling also voids this warranty.

This warranty is limited to the repair or replacement of the product at the discretion of the manufacturer. This warranty does not cover personal injury, property loss, including livestock or damage (direct, incidental, or consequential) arising out of use of this product. This warranty gives you specific rights and you may also have other rights, which may vary from state to state.

This warranty card must be filled out completely and returned within (14) days from the date of purchase. Failure to do so will void this warranty. A proof of purchase from an authorized dealer must be provided when making a warranty claim.

Upon discovery of a defect, please call us to obtain an RMA #.

Tel: (310) 672-4099 / Tel: (310) 672-4021

All claims should be sent prepaid to the following address:

Transworld Aquatics Enterprises, Inc.

3730 Unit 3, West Century Blvd.

Inglewood, CA 90308

-

REACTION PRO

Please Fill Out Completely and Return within 14 days from date of purchase. *(Please Print)*

Customer Name: _____

Address: _____

City: _____

State: _____ Zip: _____

Phone#: _____

Email: _____

Yes I would like to receive emails on JBJ News—New Products, Sales, Rebates

No I do not want receive emails on JBJ News

Date of Purchase: _____

Model _____

Dealer Purchased From:

Please mail warranty registration and Proof of Purchase to:

**Transworld Aquatics Enterprises, Inc.
Attn: Warranty Dept.—REACTION PRO
3730 Unit 3, West Century Blvd.
Inglewood, CA 90308**

Tear Off



Fold Here

Stamp

Transworld Aquatic Enterprises, Inc

3730 W. Century Blvd #3
Inglewood, CA 90303
Phone: (877) 374-9981

JBJLIGHTING.COM