

ADDING A BATTERY TAB TO THE BATTERY FOR YOUR MICRO-PULSE M1

IMPORTANT: All new batteries for the model M1 need a tape tab (the battery is a DLI88 camcorder battery)

This allows the battery to be quickly and correctly inserted and removed from the M1.

This design saves a great deal of weight and size on the M1, keeping it slim and very compact.

When you get new batteries for your M1, please use the printed tab we provide and put it on as shown.

Make sure to stick the label with a loop remaining, sticking UP for the tab as shown.

Tab sticking up
on this side

When you insert and remove the battery, hold it by the tab.



Make sure the
Gold contacts
are on this side

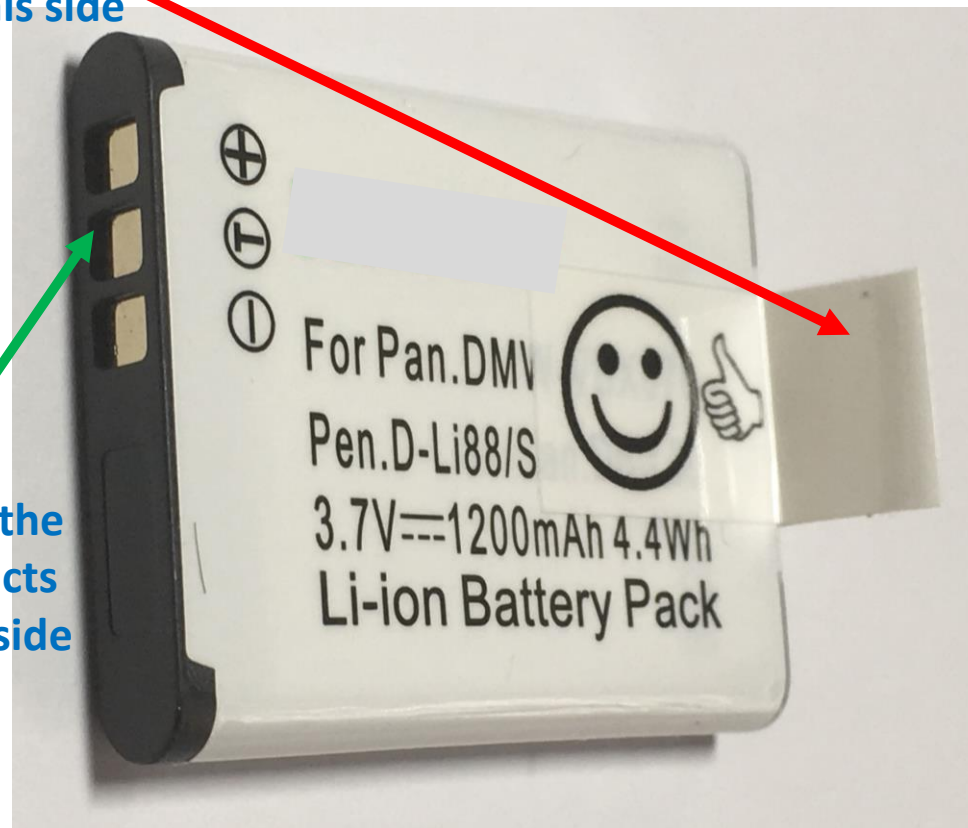

Apply tape to the battery to
make the loop as shown:



Side view of battery