

ROBUST-AIRE™

**NEW**

Large Systems with  
Aire-Guard Cabinet  
Technology (pg.3)

*(patent pending)*

**Kasco**®

MOVING WATER FORWARD, SINCE 1968

## ROBUST-AIRE™ DIFFUSED AERATION SYSTEMS

Restore your water body's natural ecosystem by adding beneficial water mixing and movement with Robust-Aire™. A shore-mounted compressor pushes air through self-weighted lines to a diffuser at the bottom of the pond, lake, or tank. This induces oxygen transfer and beneficial mixing to prevent weed overgrowth, algae, unpleasant odors, fish kills, and other issues.

[kascomarine.com](http://kascomarine.com)



The Longest Lasting,  
Most Efficient Diffuser

Contact us today to learn more | 715.262.4488 | [sales@kascomarine.com](mailto:sales@kascomarine.com)

# VITAL MIXING

## FOR YOUR WATER

- Includes 1-12 diffuser assemblies, compressor(s), and compressor mounting option (some models include tubing)
- No electricity required in water, making it safe for swimming
- Self-weighted diffuser will land right-side-up every time
- Lifetime warranty on diffuser and cabinet
- 15-year warranty on tubing, 3-year warranty on compressor

**11-44% More efficient than competition**

*(3rd-party tested)*

**34% Quieter than previous models**

**Most efficient at 8 ft. or deeper**

Water is entirely mixed for consistent temperature and stable environment



Dual loop diffuser provides high volumes of upward water movement

Diffuser membrane will not clog, reducing maintenance



The longest-lasting, most efficient diffuser on the market

Great for residential, commercial or industrial settings with power nearby or a long distance away.

Improves water clarity, decreases muck, expands fish habitat, and much more.

Pair with Pond Probiotics for maximum water quality improvement.

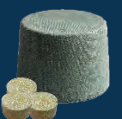

# NEW

## LARGE CABINET SYSTEMS WITH AIRE-GUARD CABINET TECHNOLOGY

Introducing Robust-Aire™ systems with patent-pending Aire-Guard Cabinet Technology. With innovative airflow in our largest-ever cabinets, these durable systems operate at lower internal temperatures, are easier to keep clean, and will withstand the toughest outdoor conditions.



### INSIDE AIRE-GUARD TECHNOLOGY

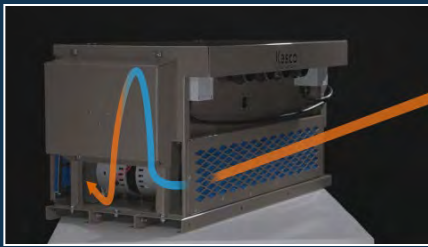

#### PURPOSEFUL AIRFLOW

Air is immediately filtered to remove dust and debris. Using high-powered fans, this clean air is then pulled through the compressor allowing it to stay cooler and operate efficiently.



#### SUPERIOR COOLING

The compressor on the left is using Aire-Guard Cabinet Technology and is almost 40° cooler than the compressor on the right.

#### Innovative airflow

Powerful fans blow clean air through compressors for superior cooling.

#### Largest-ever cabinets

Run 7 - 12 diffusers and 3 or 4 compressors from just 1 cabinet to tackle larger applications with less equipment.

#### Built to last

Increased filtration and cooling abilities allow systems to withstand wind, heat, rain, and dust.

#### Externally mounted gauges

Gauges, valves, and filter maintenance indicators are externally viewable for easy status checks.

#### External filtration

Large filters mounted on the outside of the cabinet ensure clean air and a clean cabinet interior.

#### No assembly required

Cabinets arrive fully assembled and ready for service.

Patent pending technology

New color blends with environment

Airflow safeguards compressor motor

*Compressor cabinet details on next page.*



## EASY COMPRESSOR MAINTENANCE

Large air filters allow for easier, less frequent cleaning. A visual maintenance indicator on the air filter turns red when cleaning is needed.



## EXPERT SIZING & LAYOUT ASSISTANCE

Contact our experts for a custom Robust-Aire™ layout at no charge. Using an aerial view of your pond or lake, our team will suggest the right system for your application.

# COMPRESSOR CABINET DETAILS

## NEW LARGE CABINET WITH AIRE-GUARD CABINET TECHNOLOGY

Kasco's largest cabinet option can accommodate 3 - 4 compressors and supplies air to 7 - 12 diffuser assemblies. Mount on shore, away from areas that may flood.

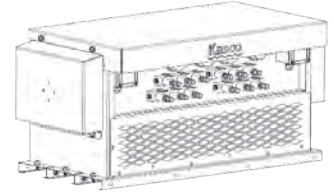

## BASE MOUNT CABINET

Accommodates up to 2 compressors and supplies air to 1 - 6 diffuser assemblies. Mount on shore, away from areas that may flood.

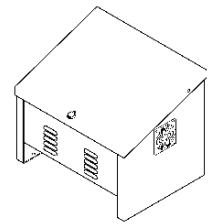

## POST MOUNT CABINET

Accommodates 1 compressor and supplies air to 1 - 3 diffuser assemblies. Attach cabinet to post or vertical wall with included hardware.

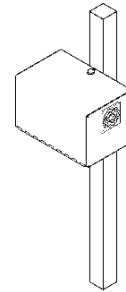

## NO-CABINET

Accommodates 1 compressor and supplies air to 1 - 3 diffuser assemblies. Mount in a clean, dry location with protection from outdoor conditions.

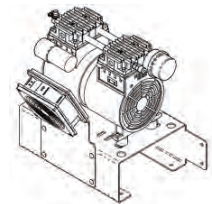

Contact Kasco today to determine the best Robust-Aire™ system for you.



MOVING WATER FORWARD, SINCE 1968

715-262-4488  
sales@kascomarine.com  
kascomarine.com