

Step 1. Fasten the bracket end to the wall using either screws suitable to the wall type (not provided), or command strips. Ensure the height of the arms does not coincide with the D-Pole joint height.

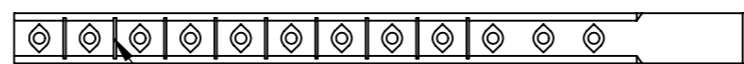

Step 2. Cut the arms to the length you prefer, using a toothed saw or knife. Cut along any of the notches.

Step 3. Fasten the arms to the wall mounted bracket using the screws provided. Don't overtighten to ensure the 3D printed plastic does not crack.

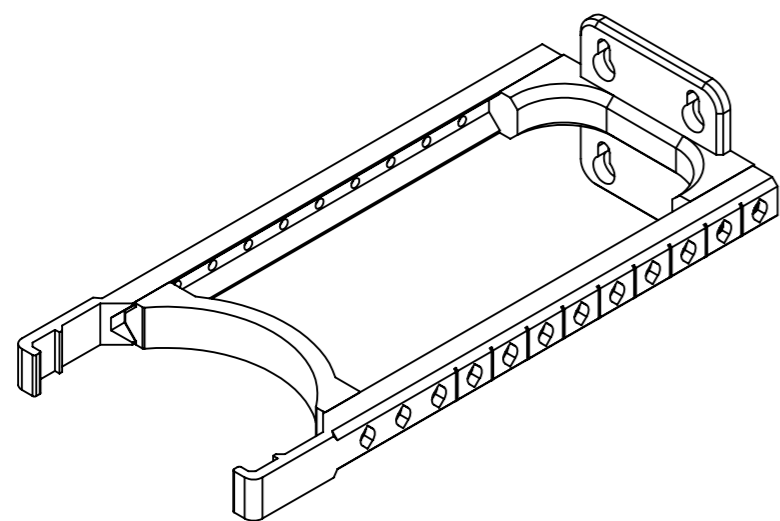
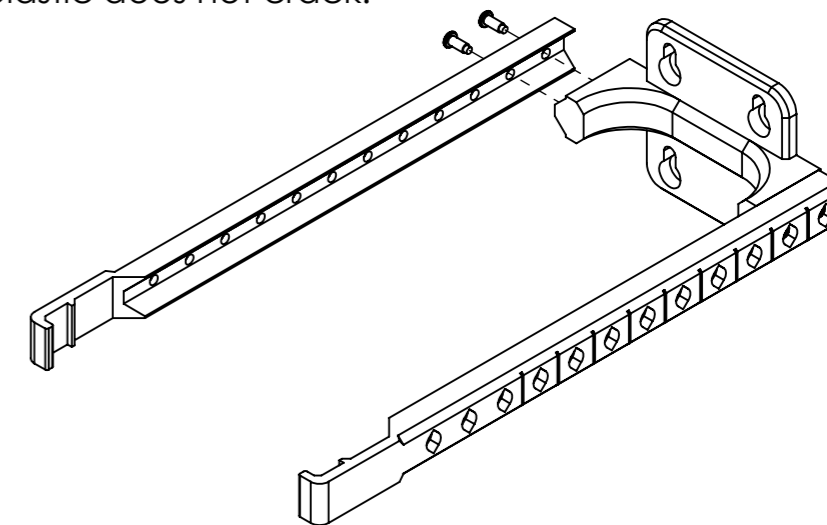

Step 4. Slide the back support between the arms, but don't fasten the screws just yet. If it is difficult to wedge between the arms, loosen the screws on one side of step 3.

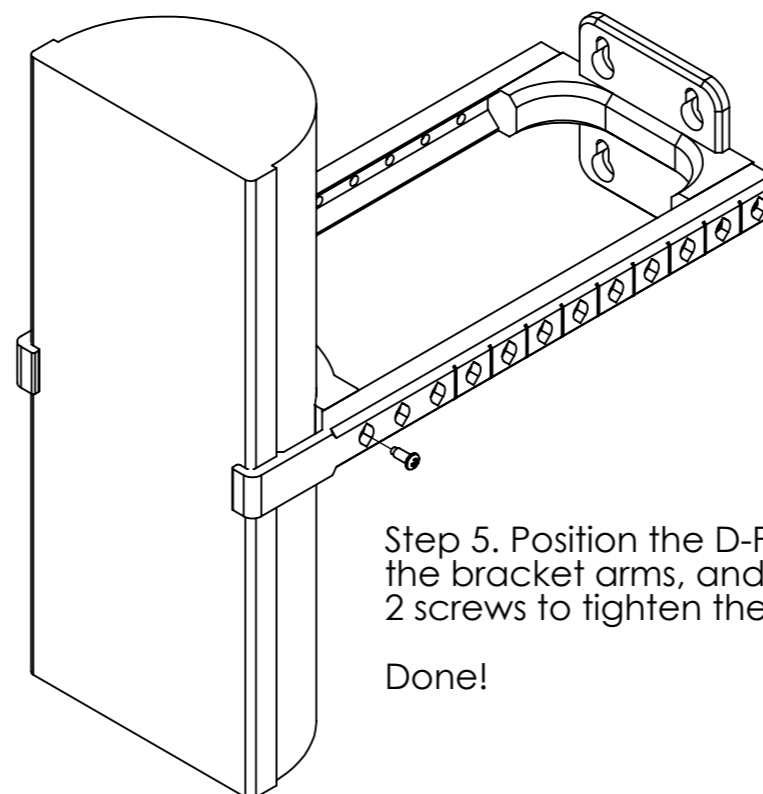

Step 5. Position the D-Pole between the bracket arms, and add the final 2 screws to tighten the back support.

Done!

Some notes:

- If using more than 1 bracket for a very tall moss pole, complete steps 1-4 for all the brackets before finishing step 5.
- Work with the potted D-Pole on hand to check heights and depths
- To remove the potted plant for watering and maintenance, just remove the screws from step 5 and the arms should bend enough to release the D-Pole.