

9PET201L-R HDP Angled Toolbox

Kit Contents

NOTE: CHECK KIT CONTENTS BEFORE COMMENCING FITMENT AND REPORT ANY DISCREPANCIES

Item	Description	Qty
1	HDP Toolbox (LH or RH)	1
2	Mount Rail	2
3	1/4 x 3/4 x 16G Washer	4
4	M6x16 8.8 Hex Bolt	4
5	M6x40 8.8 Hex Bolt	4
6	M6 Nyloc Nut	8

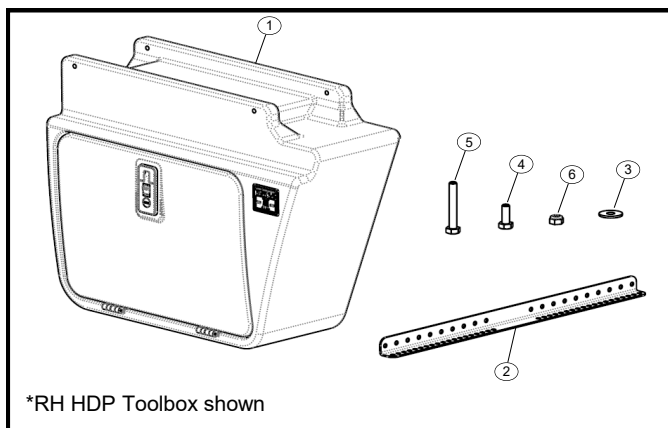

Tools Required

Fastener Torque Table

TOOLS REQUIRED	
10mm Socket	10mm Spanner
Tape Measure	Ratchet

Fastener size	Class	Torque
M6	8.8	9 Nm



MAXIMUM LOADING CAPACITY - 25Kg



Instructions will show images of the RH side installation using part 9PET201R. LH side installation using 9PET201L will be a mirror image.



Please read these instructions carefully before installation, paying special attention to all Notice, Caution & Warning notes. Failure to do so may result in damaged parts or injury to the installer or customer.



Fitting Time:

0 Hours : 15 Minutes

Section 1 - Installation**STEP 1a**

Note: Steps 1a & 1b are for installation to Alloy Tray Bodies. For Steel Tray Bodies, proceed to Step 2.

Locate the rear mudguard on the under side of the tray. Align Mount Rails to the underside of deck plank holes and rearward from the mudguard as shown in adjacent diagram.

Ensure flange of Mount Rail with the widely spaced holes are facing inward and bolt to deck planks, using M6x16 Bolt & M6 Nyloc Nuts as shown.

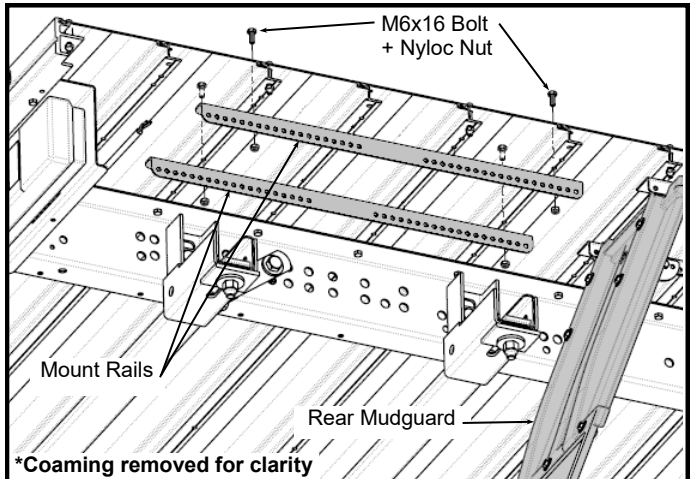
**STEP 1b**

Ensure flanges are facing inward towards main bearer and set at distance shown in adjacent diagram.

Proceed to Step 3.

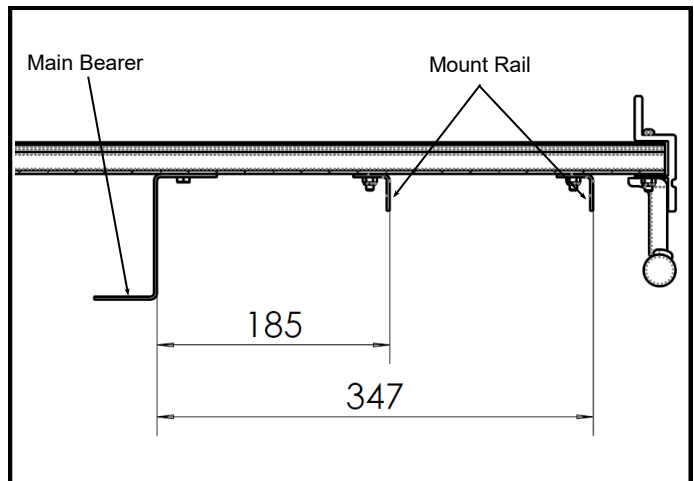
**STEP 2a**

Note: Steps 2a & 2b are for installation to Steel Tray Bodies only.

Locate the rear mudguard on the under side of the tray. Align Mount Rails to the underside cross bearer holes and rearward from the mudguard as shown in adjacent diagram.

Ensure flange of Mount Rail with the widely spaced holes are facing inward and bolted to the cross bearers, using M6x16 Bolt & M6 Nyloc Nuts as shown.

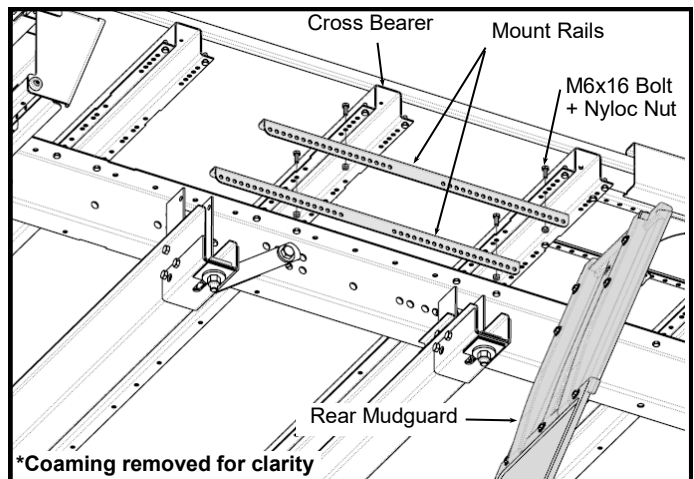

STEP 2b

Ensure flanges are facing inward towards main bearer and set at distance shown in adjacent diagram.

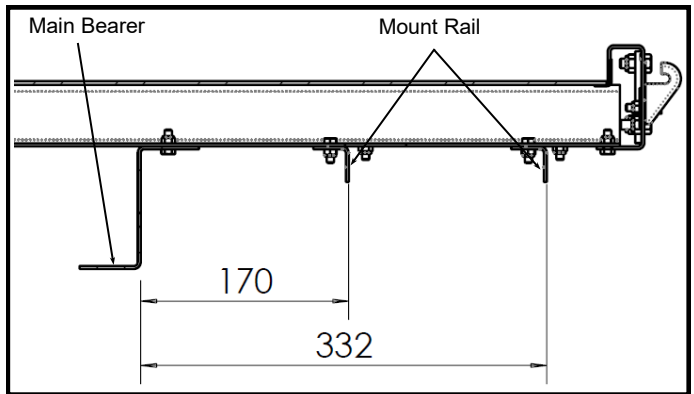

STEP 3

Assemble HDP Toolbox to Mount Rails as shown in adjacent diagram using M6x40 Bolts, Washer & M6 Nyloc Nut.

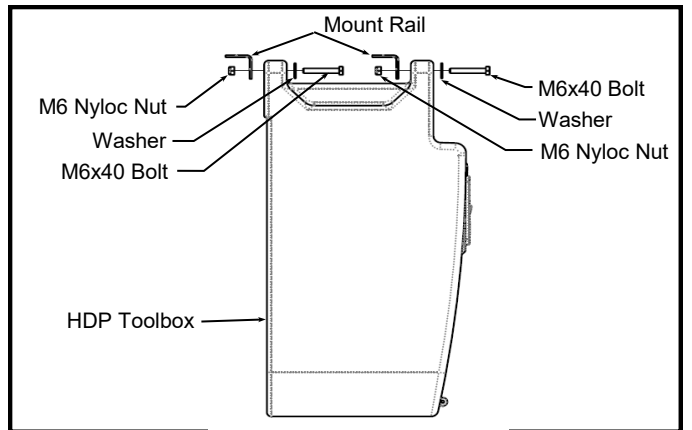

STEP 4

Ensure to keep a minimum gap of 10mm between HDP Toolbox and PP Mudguard.

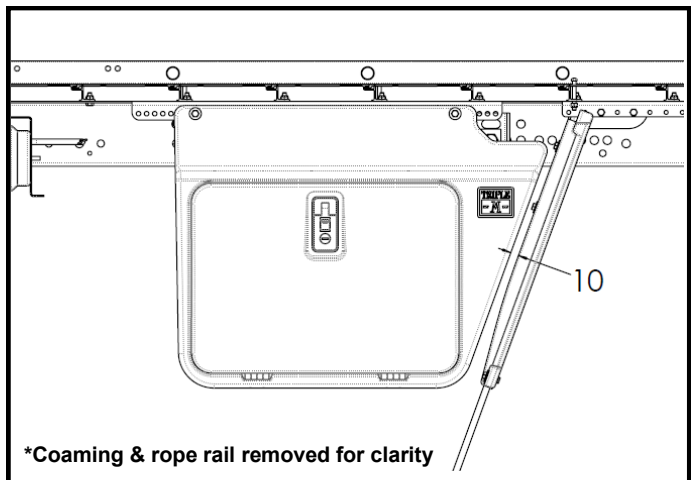

STEP 5

Complete the "toolbox key form" in adjacent diagram & remove and place into the vehicles user manual.

Close the toolbox door and place toolbox keys on the vehicle key-ring.

Toolbox Key Record

Key Number: _____

Fitment Date: _____

VIN: _____

