

保固登錄

親愛的顧客，感謝您的選購。請在拆封後先確認產品使用無故障與瑕疵，並掃 QR 碼或手動輸入網址 <https://supr.link/UegTI> 完成序號登錄，啟動原廠保固服務。



掃碼登錄序號

聯繫客服

如遭遇產品瑕疵或於使用期間發生異常，請加入官方 Line@ 聯繫客服人員，並提供細節照片與聲音檔案以利狀況排除。



LINE ID @tts8521n

連接與使用

也可至 <https://helptw.cloudvocal.com> 獲取相關使用說明

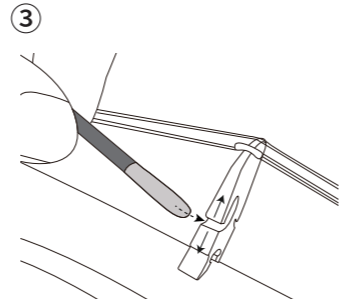
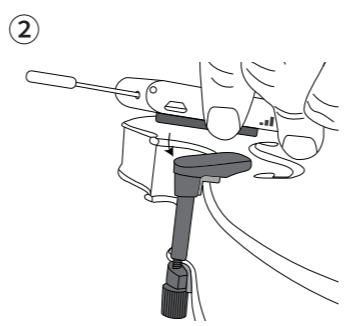
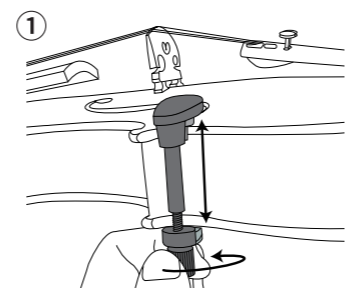
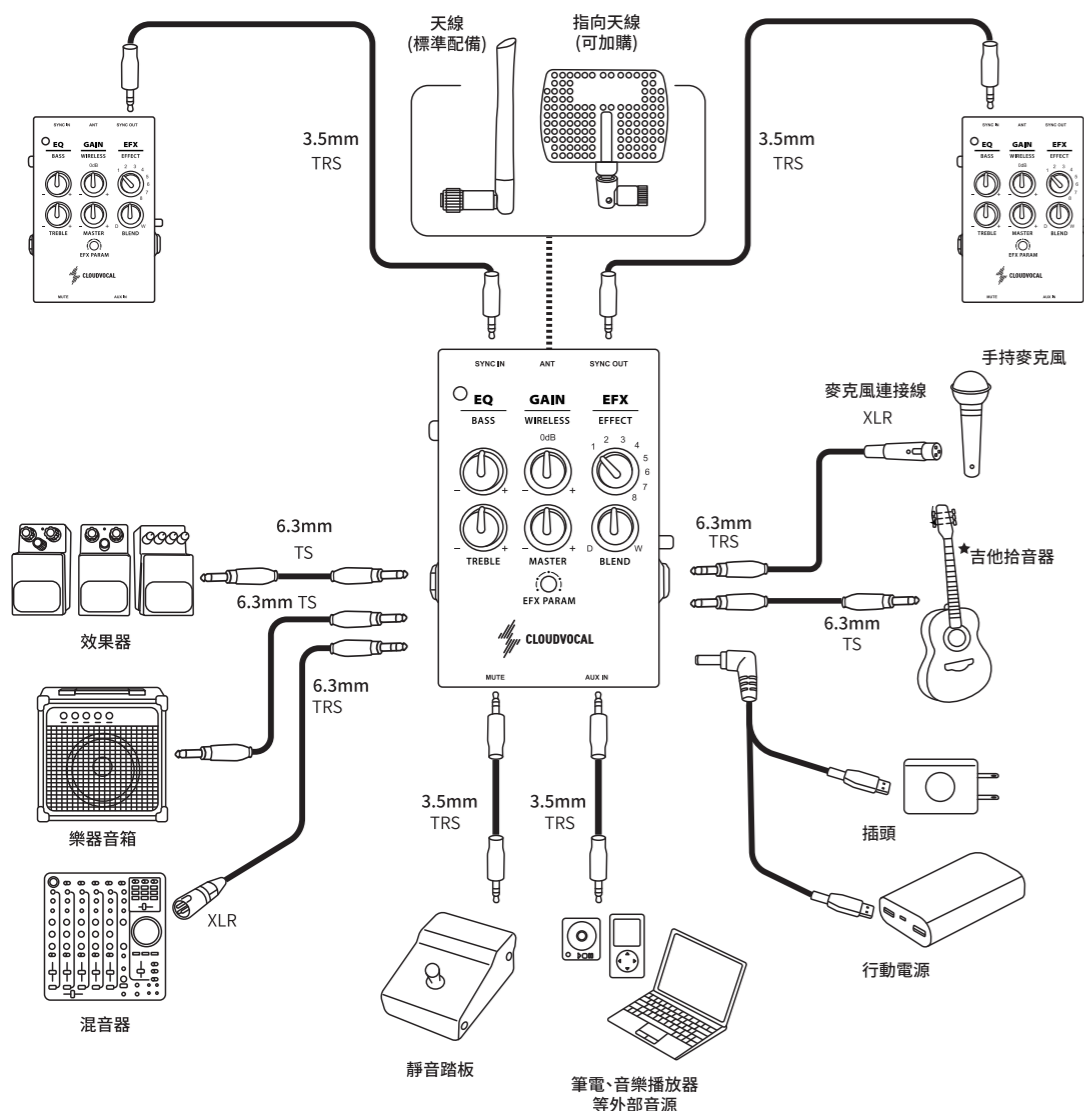

建議由專業人員進行琴橋空隙的擴張，以利加裝壓電拾音器

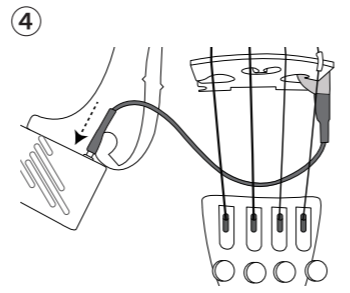

連接拾音器時：拾音器收音
拔除拾音器：麥克風收音

八段效果說明

1. 房間殘響 (Room reverb)

- 當 Effect 旋鈕為 1 時，會加入模擬房間般的聲音殘響。
- 可透過旋轉 EFX PARAM 調整殘響的持續時間與空間感。

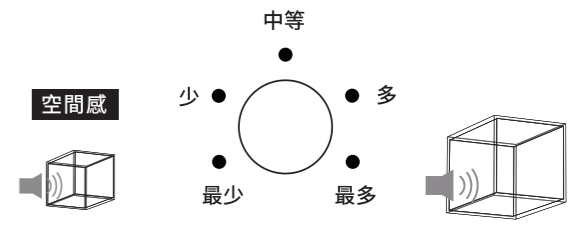

2. 大廳殘響 (Hall reverb)

- 當 Effect 旋鈕為 2 時，會加入模擬大廳堂般的聲音殘響。
- 可透過旋轉 EFX PARAM 調整殘響的持續時間與空間感。

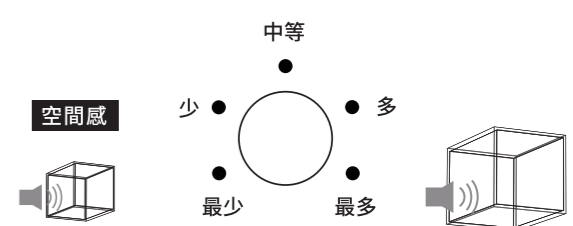

3. 場館殘響 (Arena reverb)

- 當 Effect 旋鈕為 3 時，會加入大型場館般的聲音殘響。
- 可透過旋轉 EFX PARAM 調整殘響的持續時間與空間感。

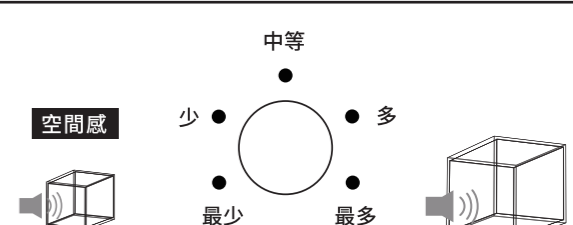

4. 延遲 (Delay)

- 當 Effect 旋鈕為 4 時，會讓聲音延遲一段時間後回放。
- 可透過旋轉 EFX PARAM 調整延遲的回放間隔。

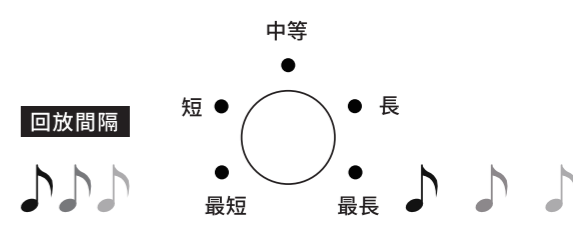

5. 延遲 + 殘響 (Delay + Reverb)

- 當 Effect 旋鈕為 5 時，會讓聲音延遲一段時間後回放並加入殘響。
- 可透過旋轉 EFX PARAM 調整延遲的回放間隔與殘響程度。

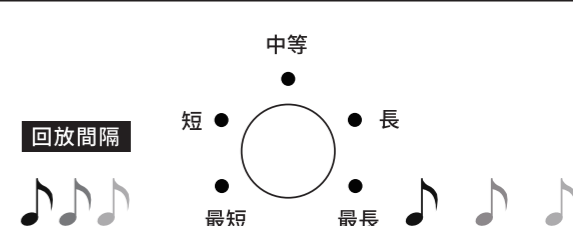

6. 特效延遲 (Modulated delay)

- 當 Effect 旋鈕為 6 時，會加入帶有特效的延遲音。
- 可透過旋轉 EFX PARAM 調整特效的濃淡程度。

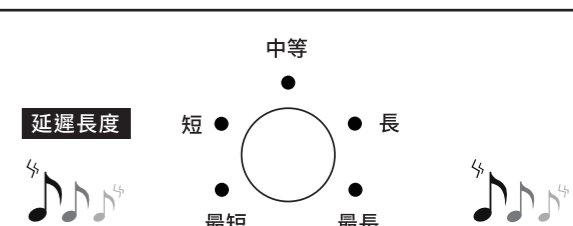

7. 星芒 (Shimmer)

- 當 Effect 旋鈕為 7 時，會讓聲音加入帶有八度和聲的殘響。
- 可透過旋轉 EFX PARAM 調整殘響程度。

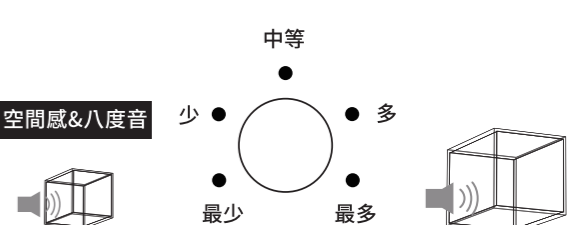

8. 低八度合音 (Low Octave)

- 當 Effect 旋鈕為 8 時，會加入比原本低八度的合音。
- 可透過旋轉 EFX PARAM 調整低八度音的空間感。

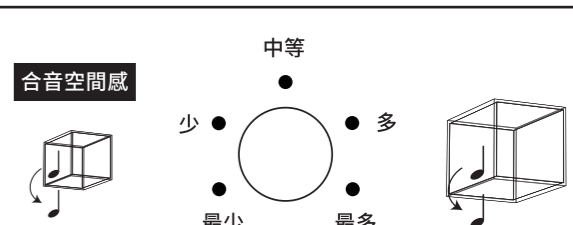

ISOLO VF-10 | Quick Start Guide

Warranty Registration

Thanks for your support. Once you make sure that your product is intact and is functioning normally, please scan the QR code or visit <https://supr.link/ICgE9> to register and activate warranty.

If you encounter any problem, please contact us via: service@cloudvocal.com. Make sure to include:

1. Order #
2. Product serial #
3. Detail of your problem in your email.



How to connect

For product support, visit gethelp.cloudvocal.com.

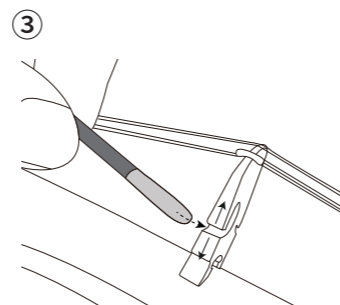
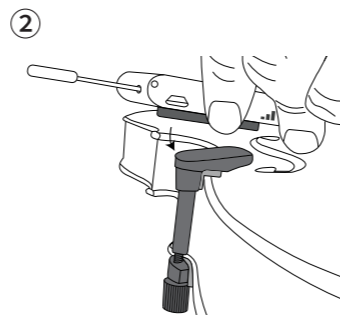
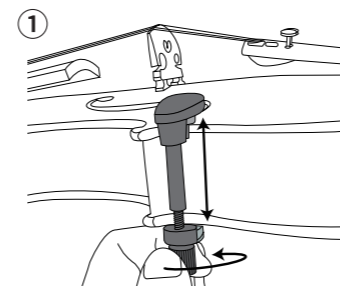
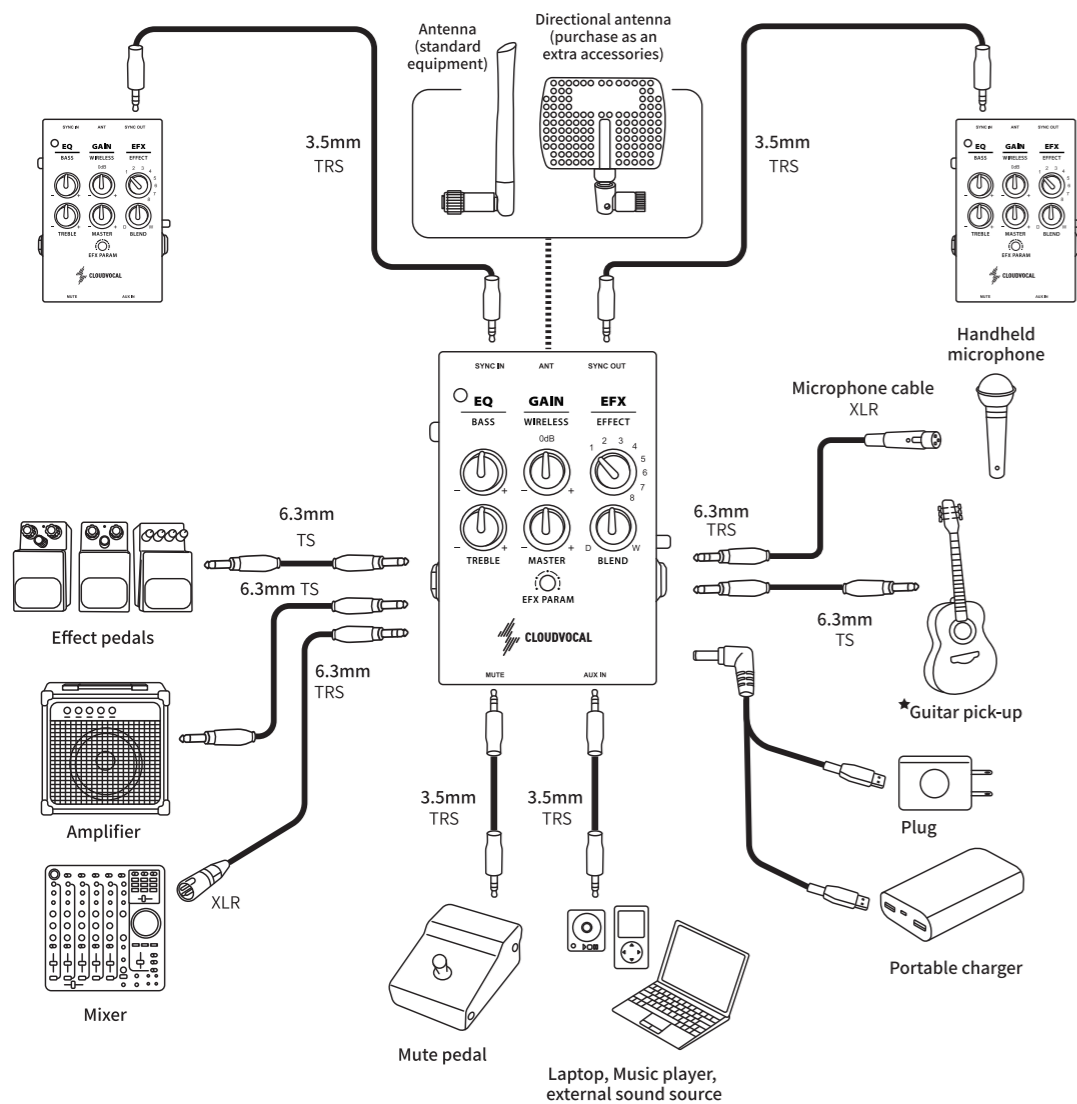

Professional tools or luthiers are required to expand the wing slot.

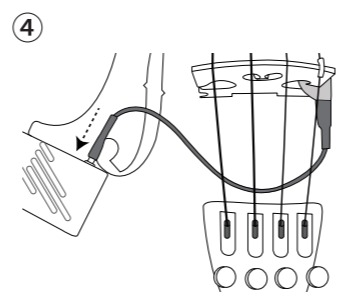

Insert cable : pickup mode
extract cable : mic mode

about the 8 effects

<p>1. Room reverb</p> <ul style="list-style-type: none"> • When effect knob is on 1, you can get a room like reverb. • EFX PARAM is for adjusting reverb decay in the space. 	
<p>2. Hall reverb</p> <ul style="list-style-type: none"> • When effect knob is on 2, you can get a hall like reverb. • EFX PARAM is for adjusting reverb decay. 	
<p>3. Arena reverb</p> <ul style="list-style-type: none"> • When effect knob is on 3, you can get an arena like reverb. • EFX PARAM is for adjusting reverb decay. 	
<p>4. Delay</p> <ul style="list-style-type: none"> • When effect knob is on 4, you will have your sound played back after sometime. • EFX PARAM is for adjusting delay repeat time. 	
<p>5. Delay & Reverb</p> <ul style="list-style-type: none"> • When effect knob is on 5, you can get both delay & reverb effects. • EFX PARAM is for adjusting delay time and reverb intensity. 	
<p>6. Modulated delay</p> <ul style="list-style-type: none"> • When effect knob is on 6, you can get a delay with modulation. • EFX PARAM is for adjusting the amount of modulation. 	
<p>7. Shimmer</p> <ul style="list-style-type: none"> • When effect knob is on 7, your note will be followed by a reverb and an octave higher in the background. • EFX PARAM is for adjusting shimmer level. 	
<p>8. Octave (Low)</p> <ul style="list-style-type: none"> • When effect knob is on 8, there will be a lower octave and reverb added to your sound. • EFX PARAM is for adjusting reverb level. 	