

WHERE INSPIRATION FLOWS



AXCES  
by VADO 

Export Guide 2023



○ Burj Khalifa, Dubai, UAE

# OUR CREDENTIALS SPEAK FOR THEMSELVES

**VADO** products are in some of the most prestigious hotel, commercial and residential developments across the world. This cityscape shows a small snapshot of a variety of prestigious projects we have been involved with.

The exceptional quality of our products, outstanding customer service and our agility to support large scale developments makes **VADO** a globally trusted brand.



The Shard, London, UK ○



○ Central Market, Abu Dhabi, UAE



Telford Homes, London, UK ○

| NEW

Ekko

Axces by VADO



AXCES  
by VADO

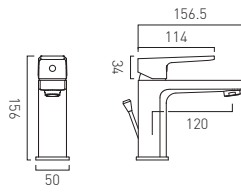

**AXCES**  
by VADO

mono basin mixer  
single lever, deck mounted  
with pop-up waste  
with Neoperl dual core aerator  
ceramic cartridge W-004-N35  
2 x 1/2" nut x 400mm flexipipe connections  
deck mount drill hole diameter 32mm  
minimum operating pressure 0.2 bar LP

chrome  
AX-EKO-100-CP



US hoses  
AX-EKO-100/US-CP

**E8** 4.5 l/m dual core flow  
regulator fitted as standard

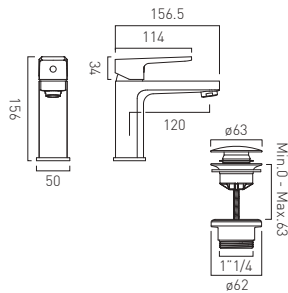

**AXCES**  
by VADO

mono basin mixer  
single lever, deck mounted, smooth bodied  
with push basin waste  
with Neoperl dual core aerator  
ceramic cartridge W-004-N35  
2 x 1/2" nut x 400mm flexipipe connections  
deck mount drill hole diameter 32mm  
minimum operating pressure 0.2 bar LP

chrome  
AX-EKO-100/CC-CP



**E8** 4.5 l/m dual core flow  
regulator fitted as standard

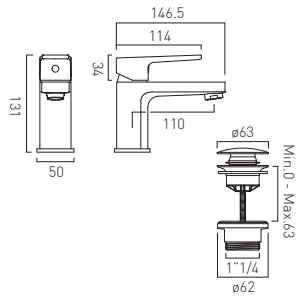

**AXCES**  
by VADO

mini mono basin mixer  
single lever, deck mounted, smooth bodied  
with push basin waste  
with Neoperl dual core aerator  
ceramic cartridge W-004-N35  
2 x 1/2" nut x 400mm flexipipe connections  
deck mount drill hole diameter 32mm  
minimum operating pressure 0.2 bar LP

chrome  
AX-EKO-100M/CC-CP



**E8** 4.5 l/m dual core flow  
regulator fitted as standard

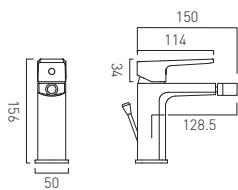

**AXCES**  
by VADO

mono bidet mixer  
single lever,  
deck mounted  
with pop-up waste  
with Neoperl water flow aerator  
ceramic cartridge W-004-N35  
2 x 1/2" nut x 400mm flexipipe connections  
deck mount drill hole diameter 32mm  
minimum operating pressure 1.0 bar MP

chrome  
AX-EKO-110-CP



US hoses  
AX-EKO-110/US-CP

**AXCES**  
by VADO

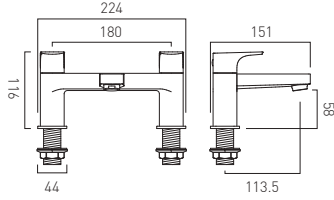

2 hole bath filler  
deck mounted  
with Neoperl water flow straightener  
cold ceramic cartridge H-302-RTC  
hot ceramic cartridge H-302-LTC  
2 x 3/4" male threaded connections  
deck mount drill hole diameter 28-30mm  
minimum operating pressure 0.2 bar LP

chrome  
AX-EKO-137-CP



**AXCES**  
by VADO

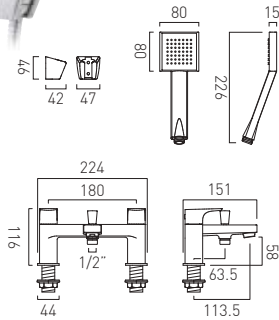

2 hole bath shower mixer  
deck mounted  
with Neoperl water flow straightener  
with Bokx single function shower kit  
cold ceramic cartridge H-302-RTC  
hot ceramic cartridge H-302-LTC  
2 x 3/4" male threaded connections  
deck mount drill hole diameter 28-30mm  
minimum operating pressure 1.0 bar MP

chrome  
AX-EKO-130+K-CP



**AXCES**  
by VADO

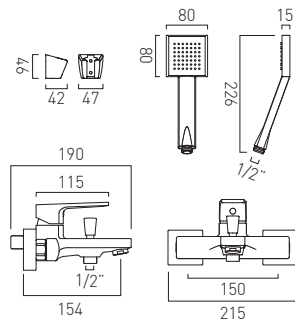

exposed bath shower mixer  
single lever, wall mounted  
with Neoperl water flow straightener  
with Bokx single function shower kit  
ceramic cartridge W-002-N35  
1/2" x 3/4" x 50mm eccentric threaded connections  
minimum operating pressure 1.0 bar MP

chrome  
AX-EKO-123+K-CP



PLEASE SEE PAGE 280 FOR  
**SHOWERING SOLUTIONS**

PLEASE SEE PAGE 296 FOR  
**COORDINATING ACCESSORIES**

| NEW



AXCES  
by VADO

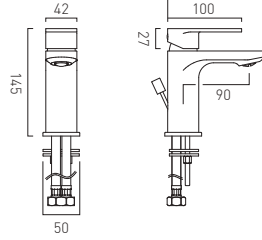

**AXCES**  
by VADO

mono basin mixer  
single lever, deck mounted  
with pop-up waste  
with Neoperl coin slot laminar flow aerator  
ceramic cartridge W-003-N35  
2 x 1/2" nut x 400mm flexipipe connections  
deck mount drill hole diameter 35mm  
minimum operating pressure 0.2 bar LP

chrome  
AX-MET-100-CP  
  
US hoses  
AX-MET-100/US-CP

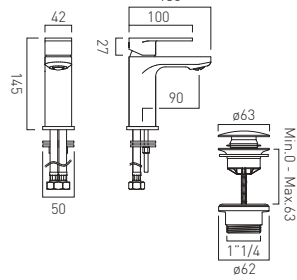

**AXCES**  
by VADO

mono basin mixer  
single lever, deck mounted  
smooth bodied  
with push basin waste  
with Neoperl coin slot laminar flow aerator  
ceramic cartridge W-003-N35  
2 x 1/2" nut x 400mm flexipipe connections  
deck mount drill hole diameter 35mm  
minimum operating pressure 0.2 bar LP

chrome  
AX-MET-100/CC-CP

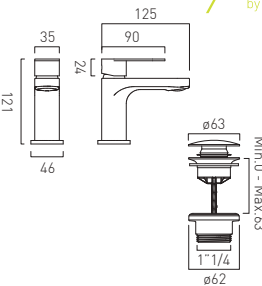

**AXCES**  
by VADO

mini mono basin mixer  
single lever, deck mounted, smooth bodied  
with push basin waste  
with Neoperl coin slot laminar flow aerator  
ceramic cartridge W-001-N25  
2 x 1/2" nut x 400mm flexipipe connections  
deck mount drill hole diameter 32mm  
minimum operating pressure 0.2 bar LP

chrome  
AX-MET-100M/CC-CP

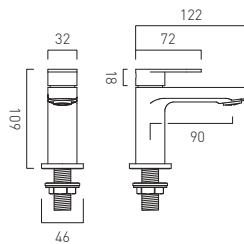

**AXCES**  
by VADO

basin pillar taps  
1/4 turn ceramic cartridges  
deck mounted  
with Neoperl coin slot laminar flow aerators  
cold ceramic cartridge H-201-RTC  
hot ceramic cartridge H-201-LTC  
deck mount drill hole diameter 22mm  
minimum operating pressure 0.2 bar LP

chrome  
AX-MET-106-CP

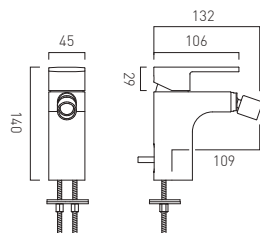

**AXCES**  
by VADO

mono bidet mixer  
single lever, deck mounted  
with pop-up waste  
with Neoperl dual core aerator  
ceramic cartridge W-002-N35  
2 x 1/2" nut x 400mm flexipipe connections  
deck mount drill hole diameter 35mm  
minimum operating pressure 0.2 bar LP

chrome  
AX-MET-110-CP  
  
US hoses  
AX-MET-110/US-CP

**EN 15186** 4.5 l/m dual core flow regulator fitted as standard



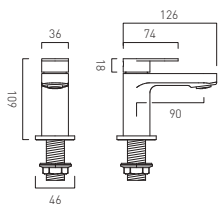

**AXCES**  
by VADO

bath pillar taps  
1/4 turn ceramic cartridges  
deck mounted  
with Neoperl coin slot laminar flow aerators  
cold ceramic cartridge CH-301-RTC  
hot ceramic cartridge CH-301-LTC  
deck mount drill hole diameter 28-30mm  
minimum operating pressure 0.2 bar LP

chrome  
AX-MET-136-CP

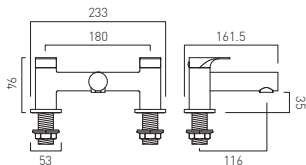

**AXCES**  
by VADO

2 hole bath filler  
deck mounted  
with Neoperl water flow straightener  
cold ceramic cartridge H-302-RTC  
hot ceramic cartridge H-302-LTC  
2 x 3/4" male threaded connections  
deck mount drill hole diameter 28-30mm  
minimum operating pressure 0.2 bar LP

chrome  
AX-MET-137-CP

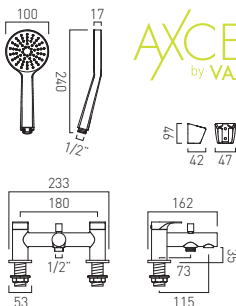

**AXCES**  
by VADO

2 hole bath shower mixer  
deck mounted  
with Neoperl water flow straightener  
with Sirkel single function shower kit  
cold ceramic cartridge H-302-RTC  
hot ceramic cartridge H-302-LTC  
2 x 3/4" male threaded connections  
deck mount drill hole diameter 28-30mm  
minimum operating pressure 0.2 bar LP

chrome  
AX-MET-130+K-CP

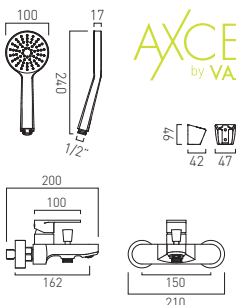

**AXCES**  
by VADO

exposed bath shower mixer  
single lever, wall mounted  
with Neoperl water flow straightener  
with Sirkel single function shower kit  
ceramic cartridge W-001-N35  
1/2" x 3/4" x 50mm eccentric threaded connections  
minimum operating pressure 1.0 bar MP

chrome  
AX-MET-123+K-CP

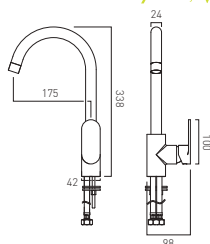

**AXCES**  
by VADO

Metiz  
mono kitchen mixer  
single lever  
deck mounted  
with swivel spout  
ceramic cartridge W-001-N35  
2 x 1/2" nut x 400mm flexipipe connections  
deck mount drill hole diameter 35mm  
minimum operating pressure 0.2 bar LP

chrome  
AX-MET-150-CP

US hoses  
AX-MET-150/US-CP

**eBb** FR-100/5-PLA



PLEASE SEE PAGE **280** FOR  
**SHOWERING SOLUTIONS**

PLEASE SEE PAGE **293** FOR  
**COORDINATING ACCESSORIES**



| NEW



AXCES  
by VADO



**AXCES**  
by VADO

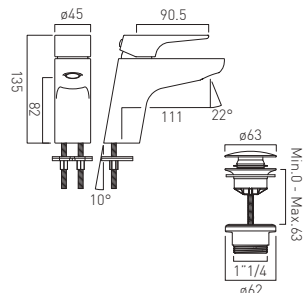

mono basin mixer  
single lever, deck mounted, smooth bodied  
with push basin waste  
with Neoperl easy clean directional aerator  
2 x 1/2" nut x 400mm flexipipe connections  
ceramic cartridge W-001-N35  
minimum operating pressure 0.2 bar LP

chrome  
AX-AWA-100/CC-CP



**AXCES**  
by VADO

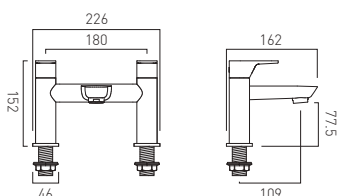

2 hole bath filler  
deck mounted  
with Neoperl water flow straightener  
cold ceramic cartridge ION-VALVE/CD/CL-3/4  
hot ceramic cartridge ION-VALVE/CD/HT-3/4  
2 x 3/4" male threaded connections  
deck mount drill hole diameter 28-30mm  
minimum operating pressure 0.2 bar LP

chrome  
AX-AWA-137-CP



**AXCES**  
by VADO

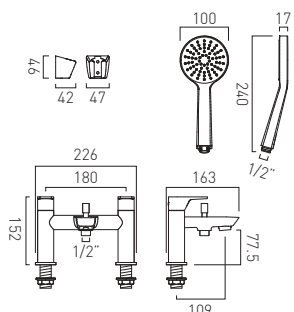

2 hole bath shower mixer  
deck mounted  
with Neoperl water flow straightener  
with Sirkel single function shower kit  
cold ceramic cartridge ION-VALVE/CD/CL-3/4  
hot ceramic cartridge ION-VALVE/CD/HT-3/4  
2 x 3/4" male threaded connections  
deck mount drill hole diameter 28-30mm  
minimum operating pressure 0.2 bar LP

chrome  
AX-AWA-130+K-CP



**AXCES**  
by VADO

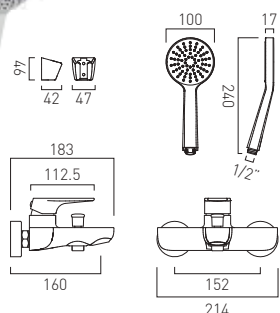

exposed bath shower mixer  
single lever, wall mounted  
with Neoperl water flow straightener  
with Sirkel single function shower kit  
ceramic cartridge W-001-N35  
1/2" x 3/4" x 50mm eccentric threaded connections  
minimum operating pressure 1.0 bar MP

chrome  
AX-AWA-123+K-CP



PLEASE SEE PAGE **280** FOR  
**SHOWERING SOLUTIONS**

PLEASE SEE PAGE **293** FOR  
**COORDINATING ACCESSORIES**

NEW

Vala

Axces by VADO



AXCES  
by VADO



**AXCES**  
by VADO

mono basin mixer  
single lever, deck mounted  
with pop-up waste  
with Neoperl dual core aerator  
ceramic cartridge W-003-N35  
2 x 1/2" nut x 400mm flexipipe connections  
deck mount drill hole diameter 35mm  
minimum operating pressure 0.2 bar LP

chrome  
AX-VAL-100-CP

US hoses  
AX-VAL-100/US-CP

**Eco** 4.5 l/m dual core flow  
regulator fitted as standard

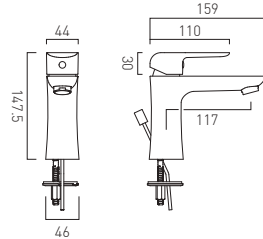

**AXCES**  
by VADO

mono basin mixer  
single lever, deck mounted, smooth bodied  
with push basin waste  
with Neoperl dual core aerator  
ceramic cartridge W-003-N35  
2 x 1/2" nut x 400mm flexipipe connections  
deck mount drill hole diameter 35mm  
minimum operating pressure 0.2 bar LP

chrome  
AX-VAL-100/CC-CP

**Eco** 4.5 l/m dual core flow  
regulator fitted as standard

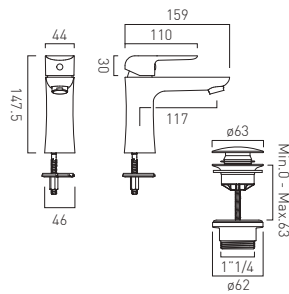

**AXCES**  
by VADO

mono bidet mixer  
single lever, deck mounted  
with pop-up waste  
with Neoperl dual core aerator  
ceramic cartridge W-003-N35  
2 x 1/2" nut x 400mm flexipipe connections  
deck mount drill hole diameter 35mm  
minimum operating pressure 0.2 bar LP

chrome  
AX-VAL-110-CP

**Eco** 4.5 l/m dual core flow  
regulator fitted as standard

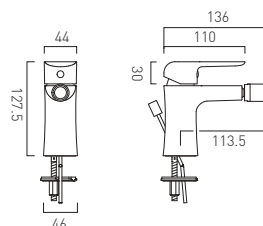



**AXCES**  
by VADO

2 hole bath filler  
deck mounted  
with Neoperl water flow straightener  
cold ceramic cartridge H-301-RTC  
hot ceramic cartridge H-301-LTC  
2 x 3/4" male threaded connections  
deck mount drill hole diameter 28-30mm  
minimum operating pressure 0.2 bar LP

chrome  
AX-VAL-137-CP

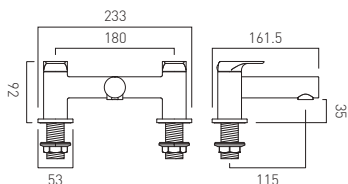

**AXCES**  
by VADO

2 hole bath shower mixer  
deck mounted  
with Neoperl water flow straightener  
with Sirkel single function shower kit  
cold ceramic cartridge H-301-RTC  
hot ceramic cartridge H-301-LTC  
2 x 3/4" male threaded connections  
deck mount drill hole diameter 28-30mm  
minimum operating pressure 0.2 bar LP

chrome  
AX-VAL-130+K-CP

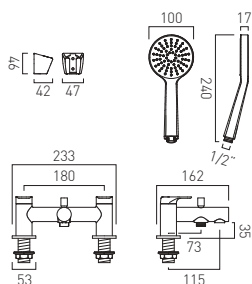

**AXCES**  
by VADO

exposed bath shower mixer  
single lever, wall mounted  
with Neoperl water flow straightener  
with Sirkel single function shower kit  
ceramic cartridge W-002-N35  
1/2" x 3/4" x 50mm eccentric threaded connections  
minimum operating pressure 1.0 bar MP

chrome  
AX-VAL-123+K-CP

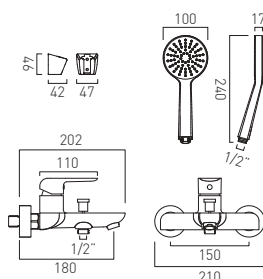

PLEASE SEE PAGE **280** FOR  
**SHOWERING SOLUTIONS**

PLEASE SEE PAGE **293** FOR  
**COORDINATING ACCESSORIES**

| NEW

Nuri

Axces by VADO



AXCES  
by VADO



**AXCES**  
by VADO

mono basin mixer  
single lever, deck mounted  
with pop-up waste  
with Neoperl water flow aerator  
ceramic cartridge W-001-N35  
2 x 1/2" nut x 400mm flexipipe connections  
deck mount drill hole diameter 35mm  
minimum operating pressure 1.0 bar MP

chrome  
AX-NUR-100-CP  
  
US hoses  
AX-NUR-100/US-CP

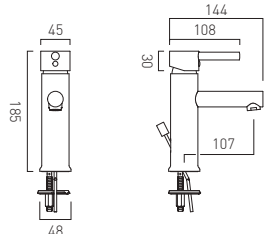

**AXCES**  
by VADO

mono basin mixer  
single lever, deck mounted, smooth bodied  
with push basin waste  
with Neoperl water flow aerator  
2 x 1/2" nut x 400mm flexipipe connections  
ceramic cartridge W-001-N35  
deck mount drill hole diameter 35mm  
minimum operating pressure 1.0 bar MP

chrome  
AX-NUR-100/CC-CP

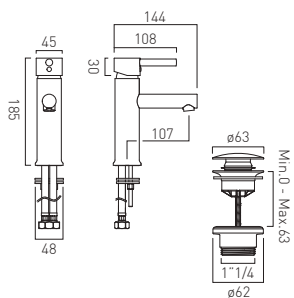

**AXCES**  
by VADO

mono bidet mixer  
single lever, deck mounted  
with pop-up waste  
with Neoperl water flow aerator  
ceramic cartridge W-001-N35  
2 x 1/2" nut x 400mm flexipipe connections  
deck mount drill hole diameter 35mm  
minimum operating pressure 1.0 bar MP

chrome  
AX-NUR-110-CP

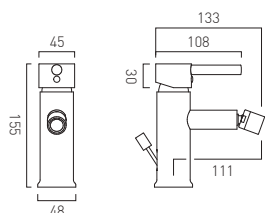

**AXCES**  
by VADO

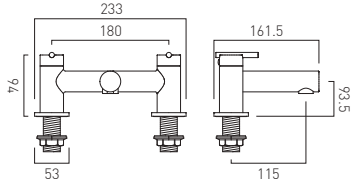

2 hole bath filler  
deck mounted  
with Neoperl water flow straightener  
cold ceramic cartridge CH-301-RTC  
hot ceramic cartridge CH-301-LTC  
2 x 3/4" male threaded connections  
deck mount drill hole diameter 28-30mm  
minimum operating pressure 0.2 bar LP

chrome  
AX-NUR-137-CP



**AXCES**  
by VADO

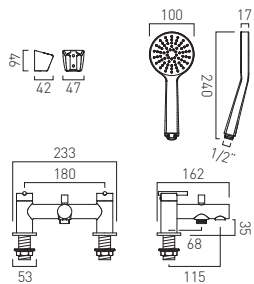

2 hole bath shower mixer  
deck mounted  
with Neoperl water flow straightener  
with Sirkel single function shower kit  
cold ceramic cartridge CH-301-RTC  
hot ceramic cartridge CH-301-LTC  
2 x 3/4" male threaded connections  
deck mount drill hole diameter 28-30mm  
minimum operating pressure 0.2 bar LP

chrome  
AX-NUR-130+K-CP



**AXCES**  
by VADO

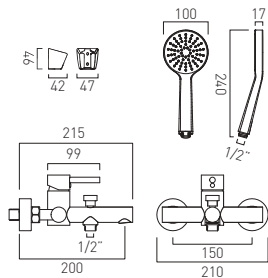

exposed bath shower mixer  
single lever, wall mounted  
with Neoperl water flow straightener  
with Sirkel single function shower kit  
ceramic cartridge W-001-N35  
1/2" x 3/4" x 50mm eccentric threaded connections  
minimum operating pressure 1.0 bar MP

chrome  
AX-NUR-123+K-CP



PLEASE SEE PAGE 280 FOR  
**SHOWERING SOLUTIONS**

PLEASE SEE PAGE 293 FOR  
**COORDINATING ACCESSORIES**



ROWE

ROWE

Acces by VADO



## Mono Basin Mixer + Pop-Up Waste



BRAND: Axces  
COLLECTION: Rowe  
SKU: AX-ROW-100-CP



**AXCES**  
by VADO

## Mono Basin Mixer + Push Basin Waste



BRAND: Axces  
COLLECTION: Rowe  
SKU: AX-ROW-100/CC-CP



**AXCES**  
by VADO

## Mini Mono Basin Mixer + Push Basin Waste



BRAND: Axces  
COLLECTION: Rowe  
SKU: AX-ROW-100M/CC-CP



**AXCES**  
by VADO

## Bath Filler



BRAND: Axces  
COLLECTION: Rowe  
SKU: AX-ROW-137-CP



**AXCES**  
by VADO

## Bath Shower Mixer + Shower Kit



BRAND: Axces  
 COLLECTION: Rowe  
 SKU: AX-ROW-130+K-CP



AXCES  
by VADO

## Bath Shower Mixer



BRAND: Axces  
 COLLECTION: Rowe  
 SKU: AX-ROW-123-CP



AXCES  
by VADO

## Bath Shower Mixer without Shower Kit



BRAND: Axces  
 COLLECTION: Rowe  
 SKU: AX-SIR-123T-CP



AXCES  
by VADO

## Bath Shower Mixer without Shower Kit



BRAND: Axces  
 COLLECTION: Rowe  
 SKU: AX-SIR-131T-CP



AXCES  
by VADO

## Thermostatic Bath Shower Mixer Column with Easy-Fit Bracket



BRAND: Axces  
COLLECTION: Rowe  
SKU: AX-SIR-123T-RRK/B-CP





AXCES  
by VADO

**AXCES**  
by VADO

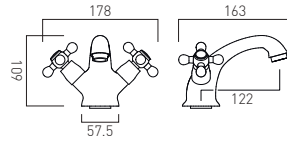

mono basin mixer  
deck mounted with pop-up waste  
with water flow straightener  
with Neoperl water flow aerator  
cold ceramic cartridge C-201-RTC  
hot ceramic cartridge C-201-LTC  
2 x 1/2" nut x 400mm flexipipe connections  
deck mount drill hole diameter 33mm  
minimum operating pressure 0.2 bar LP

chrome  
AX-VIC-100/CD-CP

ETB FR-100/5-PLA



**AXCES**  
by VADO

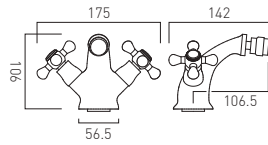

mono bidet mixer  
deck mounted with pop-up waste  
with water flow straightener  
with Neoperl water flow aerator  
cold ceramic cartridge C-201-RTC  
hot ceramic cartridge C-201-LTC  
2 x 1/2" nut x 400mm flexipipe connections  
deck mount drill hole diameter 33mm  
minimum operating pressure 0.2 bar LP

chrome  
AX-VIC-110/CD-CP

ETB FR-100/5-PLA



**AXCES**  
by VADO

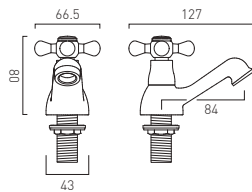

basin pillar taps  
deck mounted  
cold ceramic cartridge C-201-RTC  
hot ceramic cartridge C-201-LTC  
1/2" x 50mm threaded connections  
deck mount drill hole diameter 22mm  
minimum operating pressure 0.2 bar LP

chrome  
AX-VIC-106/CD-CP

ETB FR-106/4-PLA  
(2 are required)



**AXCES**  
by VADO

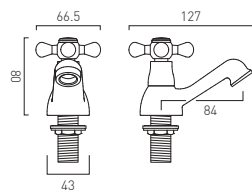

basin pillar cold only tap  
deck mounted  
cold ceramic cartridge C-201-RTC  
1/2" x 50mm threaded connections  
deck mount drill hole diameter 22mm  
minimum operating pressure 0.2 bar LP

chrome  
AX-VIC-106/CD/CL-CP

ETB FR-106/4-PLA



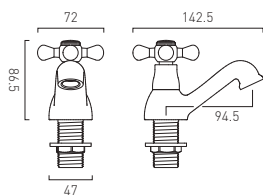

**AXCES**  
by VADO

bath pillar taps  
deck mounted  
cold ceramic cartridge C-201-RTC  
hot ceramic cartridge C-201-LTC  
3/4" x 50mm male threaded connections  
deck mount drill hole diameter 27mm  
minimum operating pressure 0.2 bar LP

chrome  
AX-VIC-136/CD-CP

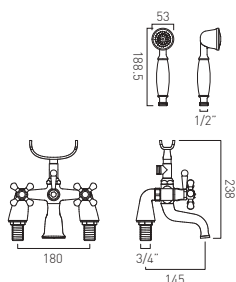

**AXCES**  
by VADO

2 hole bath shower mixer  
deck mounted  
with single function shower kit  
cold ceramic cartridge C-201-RTC  
hot ceramic cartridge C-201-LTC  
2 x 3/4" x 50mm male threaded connections on legs  
deck mount drill hole diameter 27mm  
minimum operating pressure 0.2 bar LP

chrome  
AX-VIC-131/S/CD-CP



**Eb** FR-SHOWER/9-C/P

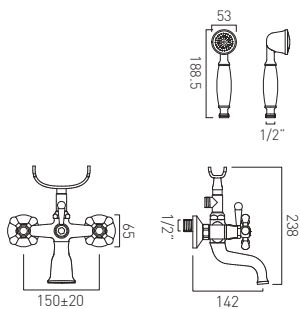

**AXCES**  
by VADO

exposed bath shower mixer  
wall mounted  
with single function shower kit  
cold ceramic cartridge C-201-RTC  
hot ceramic cartridge C-201-LTC  
1/2" x 3/4" x 40mm eccentric threaded connections  
minimum operating pressure 0.2 bar LP

chrome  
AX-VIC-120/CD-CP



**Eb** FR-SHOWER/9-C/P

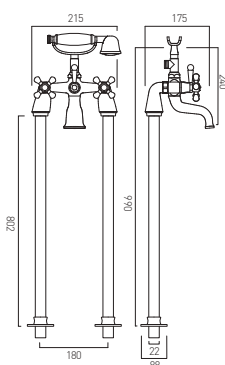

**AXCES**  
by VADO

bath shower mixer  
floor mounted  
with single function shower kit  
cold ceramic cartridge C-201-RTC  
hot ceramic cartridge C-201-LTC  
minimum operating pressure 0.2 bar LP

chrome  
AX-VIC-133/CD+K-CP



**Eb** FR-SHOWER/9-C/P

**AXCES**  
by VADO

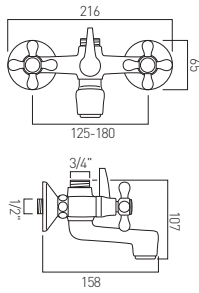

exposed bath shower mixer  
for use with AX-XAV-RIGID-CP (see page 284)  
wall mounted  
with water flow straightener  
cold ceramic cartridge C-201-RTC  
hot ceramic cartridge C-201-LTC  
1/2" x 3/4" x 40mm eccentric threaded connections  
3/4" threaded outlet for rigid riser  
minimum operating pressure 0.2 bar LP

chrome  
AX-VIC-121/CD-CP

**E8** FR-SHOWER/9-C/P



**AXCES**  
by VADO

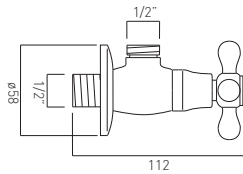

angle valve  
wall mounted  
hot and cold indices supplied  
ceramic cartridge C-201-RTC  
1/2" male inlet  
1/2" male outlet

chrome  
AX-VIC-160/CD-CP



**AXCES**  
by VADO

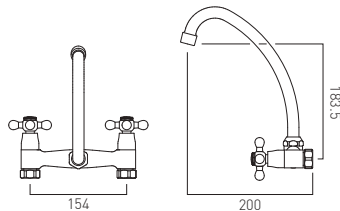

Victoriana  
2 hole kitchen mixer  
wall mounted  
with swivel spout  
cold ceramic cartridge C-201-RTC  
hot ceramic cartridge C-201-LTC  
1/2" x 3/4" x 48mm eccentrics  
minimum operating pressure 0.2 bar LP

chrome  
AX-VIC-154G/CD-CP



PLEASE SEE PAGE 299 FOR

**TOURNAMENT COORDINATING ACCESSORIES**



I NEW



AXCES  
by VADO

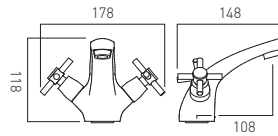

**AXCES**  
by VADO

mono basin mixer  
deck mounted  
with pop-up waste  
with water flow straightener  
with water flow aerator  
cold ceramic cartridge C-201-RTC  
hot ceramic cartridge C-201-LTC  
2 x 1/2" nut x 400mm flexipipe connections  
deck mount drill hole diameter 35mm  
minimum operating pressure 0.2 bar LP

chrome  
AX-VEC-100/CD-CP  
US hoses  
AX-VEC-100/CD/US-C/P

**Eto** FR-100/5-PLA

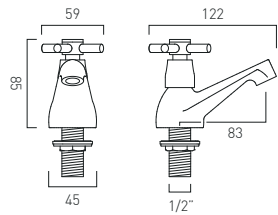

**AXCES**  
by VADO

basin pillar taps  
deck mounted  
with water flow straightener  
cold ceramic cartridge C-201-RTC  
hot ceramic cartridge C-201-LTC  
1/2" x 47mm threaded tail connections  
deck mount drill hole diameter 22mm  
minimum operating pressure 0.2 bar LP

chrome  
AX-VEC-106/CD-CP

**Eto** FR-106/4-PLA  
(2 are required)

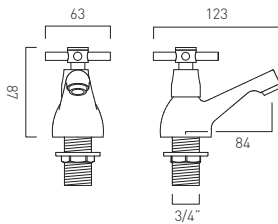

**AXCES**  
by VADO

bath pillar taps  
deck mounted  
with water flow straightener  
cold ceramic cartridge C-201-RTC  
hot ceramic cartridge C-201-LTC  
3/4" x 50mm male threaded connections  
deck mount drill hole diameter 27mm  
minimum operating pressure 0.2 bar LP

chrome  
AX-VEC-136/CD-CP

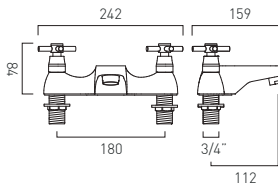
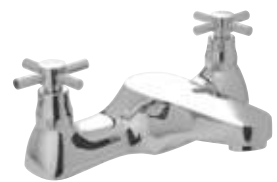

**AXCES**  
by VADO

2 hole bath filler  
deck mounted  
with Neoperl water flow straightener  
cold ceramic cartridge C-201-RTC  
hot ceramic cartridge C-201-LTC  
standard cartridge C-102-STD  
2 x 3/4" male threaded connections  
deck mount drill hole diameter 27mm  
minimum operating pressure 0.2 bar LP

chrome  
AX-VEC-137/CD-CP

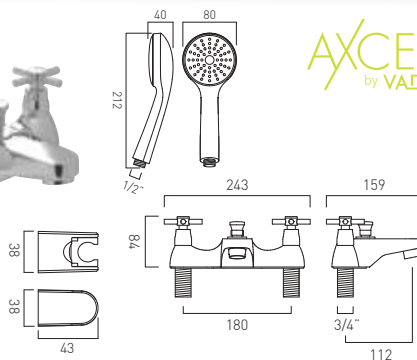

**AXCES**  
by VADO

2 hole bath shower mixer  
deck mounted  
with Neoperl water flow straightener  
with single function shower kit  
cold ceramic cartridge C-201-RTC  
hot ceramic cartridge C-201-LTC  
standard cartridge C-102-STD  
2 x 3/4" male threaded connections  
deck mount drill hole diameter 27mm  
minimum operating pressure 0.2 bar LP

chrome  
AX-VEC-130/CD+K-CP

**Eto** FR-SHOWER/9-C/P





AXCES  
by VADO

HANDLE  
OPTIONS



**CONTRACT**  
AST-1



**CROSS**  
AST-2



**LEVER**  
AST-3



mono basin mixer  
deck mounted  
with pop-up waste  
with water flow straightener  
with water flow aerator  
cold ceramic cartridge C-201-RTC  
hot ceramic cartridge C-201-LTC  
standard cartridge for AST-1 only C-102-STD  
2 x 1/2" nut x 400mm flexipipe connections  
deck mount drill hole diameter 35mm  
minimum operating pressure 0.2 bar LP

chrome  
ceramic cartridge  
AX-AST-100/CD-CP  
AX-AST-300-CP  
  
standard cartridge  
AX-AST-100-CP  
  
US hoses  
AX-AST-100/CD/US-C/P

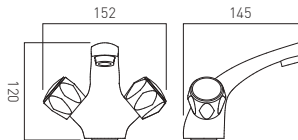

[FR-100/5-PLA](#)



basin pillar taps  
deck mounted  
with water flow straightener  
cold ceramic cartridge C-201-RTC  
hot ceramic cartridge C-201-LTC  
standard cartridge for AST-1 only C-102-STD  
1/2" x 50mm threaded tail connection  
deck mount drill hole diameter 22mm  
minimum operating pressure 0.2 bar LP

chrome  
ceramic cartridge  
AX-AST-106/CD-CP  
AX-AST-206/CD-CP  
AX-AST-306-CP

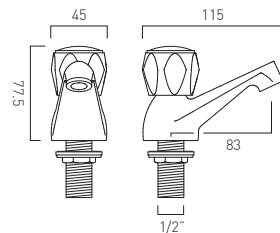

standard cartridge  
AX-AST-106-CP

[FR-106/4-PLA](#)  
(2 are required)



basin pillar cold only tap  
with cross handle  
deck mounted  
with water flow straightener  
cold ceramic cartridge C-201-RTC  
1/2" x 50mm threaded tail connection  
deck mount drill hole diameter 22mm  
minimum operating pressure 0.2 bar LP

chrome  
ceramic cartridge  
AX-AST-206/CL/CD-CP

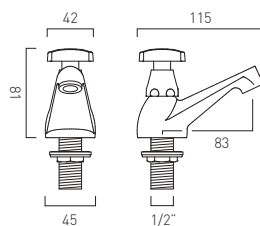

[FR-106/4-PLA](#)

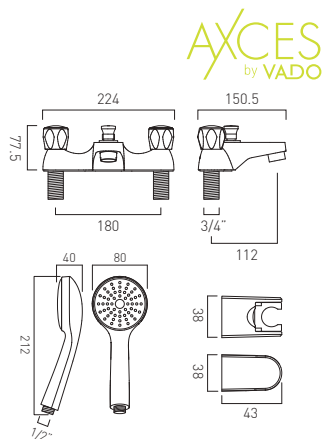

**AXCES**  
by VADO

2 hole bath shower mixer  
deck mounted  
with water flow straightener  
with single function shower kit  
cold ceramic cartridge C-201-RTC  
hot ceramic cartridge C-201-LTC  
standard cartridge for AST-1 only: C-102-STD  
2 x 3/4" male threaded connections  
deck mount drill hole diameter 27mm  
minimum operating pressure 0.2 bar LP

chrome  
ceramic cartridge  
AX-AST-130/CD+K-CP  
AX-AST-330+K-CP

standard cartridge  
AX-AST-130+K-CP

FR-SHOWER/9-C/P

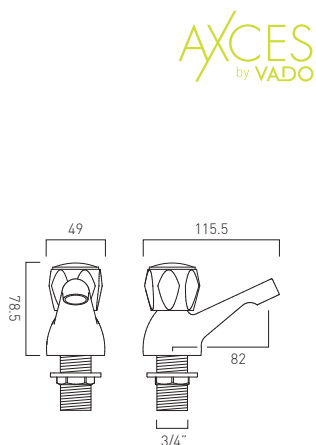

**AXCES**  
by VADO

bath pillar taps  
deck mounted  
with water flow straightener  
cold ceramic cartridge C-201-RTC  
hot ceramic cartridge C-201-LTC  
standard cartridge for AST-1 only: C-102-STD  
3/4" x 50mm male threaded connections  
deck mount drill hole diameter 27mm  
minimum operating pressure 0.2 bar LP

chrome  
ceramic cartridge  
AX-AST-136/CD-CP  
AX-AST-336-CP

standard cartridge  
AX-AST-136-CP

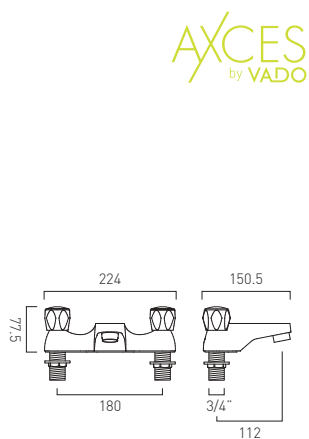

**AXCES**  
by VADO

2 hole bath filler  
deck mounted  
with water flow straightener  
cold ceramic cartridge C-201-RTC  
hot ceramic cartridge C-201-LTC  
standard cartridge for AST-1 only: C-102-STD  
2 x 3/4" male threaded connections  
deck mount drill hole diameter 27mm  
minimum operating pressure 0.2 bar LP

chrome  
ceramic cartridge  
AX-AST-137/CD-CP  
AX-AST-337-CP

standard cartridge  
AX-AST-137-CP

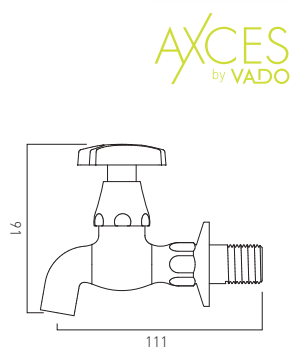

**AXCES**  
by VADO

bib tap 100mm  
wall mounted  
supplied with hot and cold indices  
ceramic cartridge AST-VALVE/CD/CL-1/2  
1/2" x 20mm threaded tail connections  
minimum operating pressure 0.2 bar LP

chrome  
ceramic cartridge  
AX-AST-262/CD/C-10-CP



**AXCES**  
by VADO

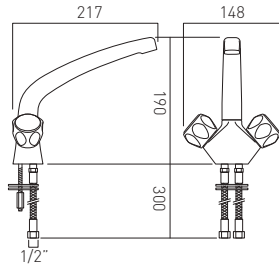

mono sink mixer  
deck mounted  
with swivel spout  
with water flow straightener  
cold ceramic cartridge C-201-RTC  
hot ceramic cartridge C-201-LTC  
standard cartridge for AST-1 only C-201-STD  
2 x 1/2" nut x 300mm flexipipe connections  
deck mount drill hole diameter 35mm  
minimum operating pressure 0.2 bar LP

chrome  
ceramic cartridge  
AX-AST-150/CD-CP  
AX-AST-350-CP

standard cartridge  
AX-AST-150-CP

**FR** FR-FLEXI/5-PLA  
(2 are required)



**AXCES**  
by VADO

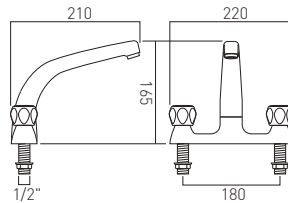

2 hole sink mixer  
deck mounted  
with swivel spout  
with water flow straightener  
cold ceramic cartridge C-201-RTC  
hot ceramic cartridge C-201-LTC  
standard cartridge for AST-1 only C-201-STD  
1/2" x 50mm threaded tail connections  
deck mount drill hole diameter 22mm  
minimum operating pressure 0.2 bar LP

chrome  
ceramic cartridge  
AX-AST-153/CD-CP  
AX-AST-353-CP

standard cartridge  
AX-AST-153-CP



**AXCES**  
by VADO

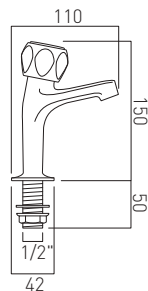

high neck sink pillar taps  
deck mounted  
with water flow straightener  
cold ceramic cartridge C-201-RTC  
hot ceramic cartridge C-201-LTC  
standard cartridge for AST-1 only C-102-STD  
1/2" x 50mm threaded connections  
deck mount drill hole diameter 22mm  
minimum operating pressure 0.2 bar LP

chrome  
ceramic cartridge  
AX-AST-156/CD-CP  
AX-AST-356-CP

standard cartridge  
AX-AST-156-CP

**FR** FR-106/4-PLA  
(2 are required)





AXCES  
by VADO



AXCES  
by VADO

mono basin mixer  
deck mounted  
thermostatic progressive cartridge PRO-001A-WAX  
deck mount drill hole diameter 31mm  
minimum operating pressure 0.2 bar LP

chrome  
PRO-100P-C/P

EBB FR-100/5-PLA

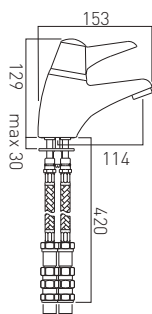

15mm compression  
or 1/2" male thread



AXCES  
by VADO

single non-concussive self-closing basin push tap  
deck mounted  
automatic shut off  
supplied with hot and cold indices  
with water flow aerator  
cartridge PRO-167/C+H/VALVE-C/P  
1/2" x 50mm threaded tail connections  
deck mount drill hole diameter 22mm  
minimum operating pressure 0.2 bar LP

chrome  
AX-PRO-167/C+H-CP

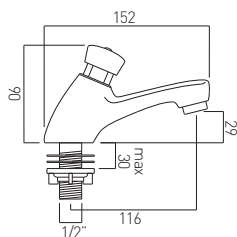

AXCES  
by VADO

medical mixer  
single long lever  
deck mounted  
smooth bodied  
ceramic cartridge CAR-K40B  
2 x 1/2" nut x 300mm flexipipe connections  
deck mount drill hole diameter 35mm  
minimum operating pressure 0.2 bar LP

chrome  
AX-PRO-300-CP

EBB FR-100/5-PLA

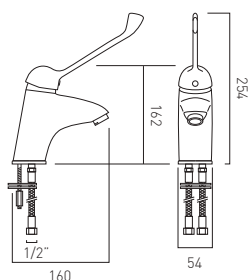





AXCES  
by VADO

AXCES  
by VADO

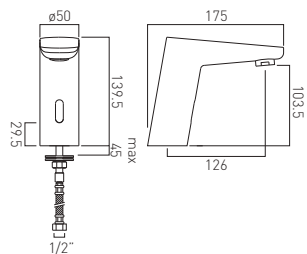

Ava  
infra-red mono basin tap  
deck mounted  
with rub clean aerator  
mains or battery operated  
takes standard AA batteries  
central processing unit: IR-100/CONTROL  
minimum operating pressure 1.0 bar MP

chrome  
AX-IR-100/AVA-CP

EBB FR-100/5-PLA

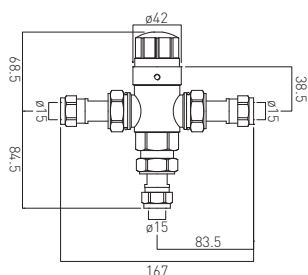

protherm in-line thermostatic valve  
supplied with 15mm compression fittings  
22mm compression fittings available separately  
thermostatic ceramic cartridge  
minimum operating pressure 0.2 bar LP

nickel / white  
PRO-5001-N/P

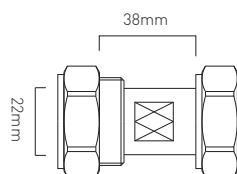

22mm compression fittings  
for use with protherm in-line thermostatic valve

chrome  
PRO-5001/C-22MM



| NEW



AXCES  
by VADO

Wastes & Fittings

Axces by VADO



**AXCES**  
by VADO

push basin waste  
easily converts into a slotted or unslotted waste  
clac-clac or free-flow

chrome  
AX-WG-393-CP

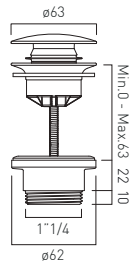

slotted captive basin waste  
flip top waste  
1.1/4" x 10mm threaded connections

chrome  
PEX-392-S-C/P

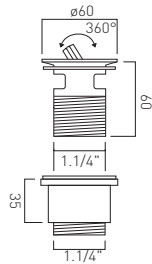

basin waste, metal plug and chain  
1.1/4" x 55mm threaded connections

chrome  
PEX-KITA-C/P

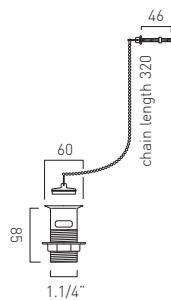

stowaway bath waste, metal plug and chain  
1.1/2" x 15mm threaded connections

chrome  
PEX-KITB-STOW-C/P

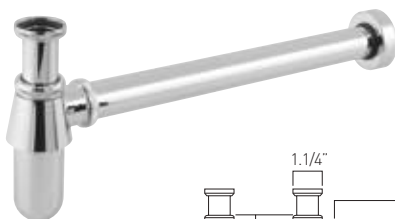
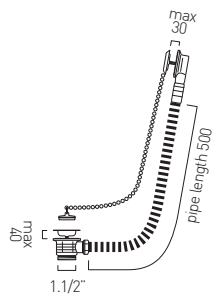

bottle trap  
35mm x 400mm pipe connections  
min-max vertical adjustment 50-140mm  
to outlet centre

chrome  
PEX-460/UK-1.1/4-C/P

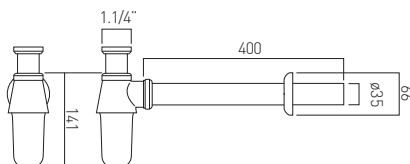

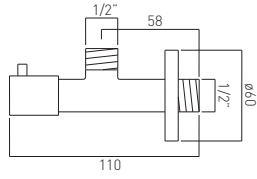

contemporary 1/4 turn angle valve  
wall mounted  
with integrated filter  
ceramic cartridge  
1/2" inlet  
1/2" outlet

chrome  
PEX-230-C/P

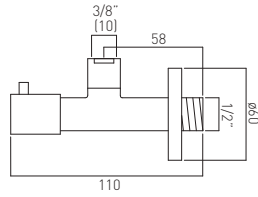

contemporary 1/4 turn angle valve  
wall mounted  
with integrated filter  
ceramic cartridge  
1/2" inlet  
10mm compression outlet  
or 3/8" threaded male outlet

chrome  
PEX-221-C/P



**AXCES**  
by VADO

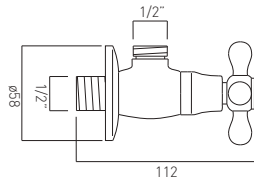

angle valve  
wall mounted  
hot and cold indices supplied  
ceramic cartridge C-201-RTC  
1/2" male inlet  
1/2" male outlet

chrome  
AX-VIC-160/CD-CP

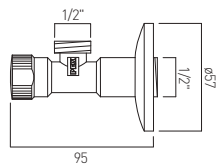

angle valve  
wall mounted  
1/2" male inlet  
1/2" male outlet

chrome  
PEX-225A-C/P

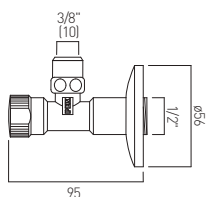

angle valve  
wall mounted  
1/2" inlet  
10mm compression outlet

chrome  
PEX-228A-C/P





**AXCES**  
by VADO

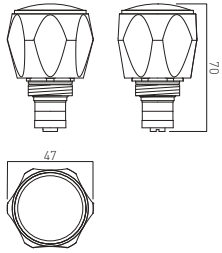

Astra  
pair of contract handles  
1/2" cartridge to suit contract taps  
supplied with hot and cold indices

chrome  
AX-AST-1/R-1/2



**AXCES**  
by VADO

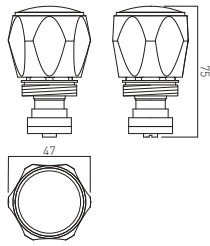

Astra  
pair of contract handles  
3/4" cartridge to suit contract taps  
supplied with hot and cold indices

chrome  
AX-AST-1/R-3/4

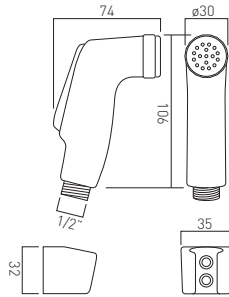

shattaf kit  
wall mounted  
chrome finish  
120cm hose  
minimum operating pressure 1.0 bar MP

chrome  
PEX-SHATTAF-C/P

FR-SHOWER/6-C/P

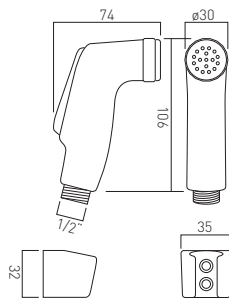

shattaf kit  
wall mounted  
black and chrome finish  
120cm hose  
minimum operating pressure 1.0 bar MP

chrome  
PEX-SHATTAF-B/C

FR-SHOWER/6-C/P

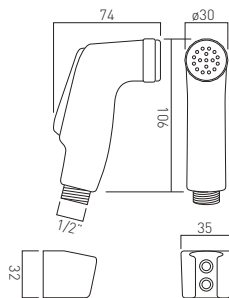

shattaf kit  
wall mounted  
white and chrome finish  
120cm hose  
minimum operating pressure 1.0 bar MP

chrome  
PEX-SHATTAF-W/C

FR-SHOWER/6-C/P



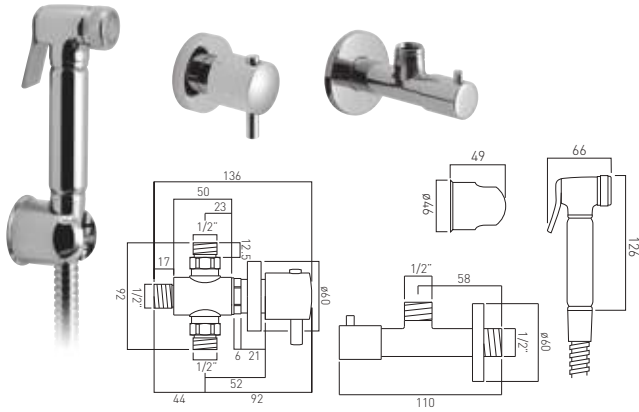

luxury shattaf kit  
with concealed thermostatic mixing valve  
and angle valve  
with 150cm hose and wall bracket  
wall mounted  
mixing valve thermostatic cartridge V-001D-PLA  
minimum operating pressure 1.0 bar MP

chrome  
XSH-SHATTAF/163-C/P

FR-SHOWER/6-C/P

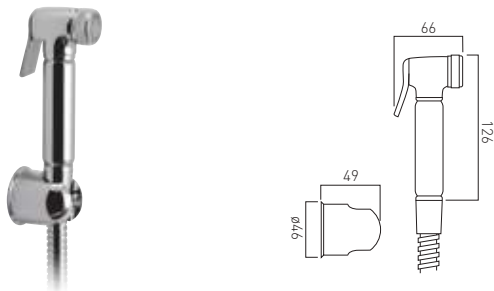

luxury brass shattaf handset  
100cm hose and wall bracket  
wall mounted  
minimum operating pressure 1.0 bar MP

chrome  
XSH-LUXSHATTAF100-CP

FR-SHOWER/6-C/P



**AXCES**  
by VADO

chrome plated stainless steel  
standard bore shower hose  
1/2" x 1/2" conical connection  
150cm

chrome  
AX-SH-015-150-DB-CP



**AXCES**  
by VADO

easy fit mounting brackets  
for use with AX-SIR-149T-RRK-CP  
and AX-SIR-149T-CP

chrome  
AX-SH-049EFB-RO-CP



**AXCES**  
by VADO

easy fit mounting brackets  
for use with AX-BOK-149T-RRK-CP  
and AX-BOK-149T-CP

chrome  
AX-SH-049EFB-SQ-CP



| NEW



Kitchen Mixers

Axces by VADO

AXCES  
by VADO





**AXCES**  
by VADO

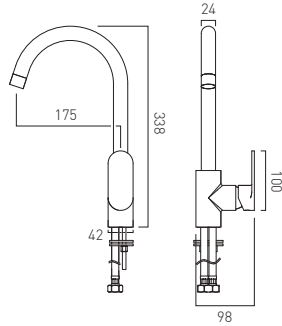

Metiz  
mono kitchen mixer  
single lever  
deck mounted  
with swivel spout  
ceramic cartridge W-001-N35  
2 x 1/2" nut x 400mm flexipipe connections  
deck mount drill hole diameter 35mm  
minimum operating pressure 0.2 bar LP

chrome  
AX-MET-150-CP  
  
US hoses  
AX-MET-150/US-CP  
  
**Eto** FR-100/5-PLA



**AXCES**  
by VADO

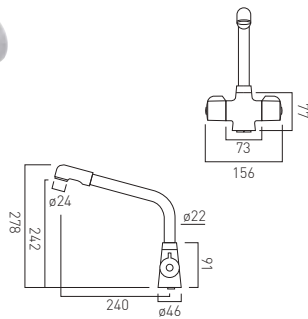

Base  
mono kitchen mixer  
deck mounted  
with swivel spout  
cold ceramic cartridge C-201-RTC  
hot ceramic cartridge C-201-LTC  
2 x 1/2" nut x 400mm flexipipe connections  
minimum operating pressure 0.2 bar LP

chrome  
AX-CUC-1050-CP  
  
**Eto** FR-100/5-PLA



**AXCES**  
by VADO

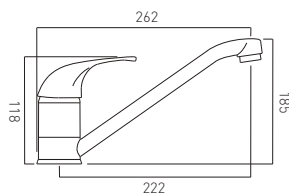

Matrix  
mono kitchen mixer  
single lever  
deck mounted  
with swivel spout  
with water flow aerator  
ceramic cartridge CAR-K40A/MAT  
2 x 1/2" nut x 400mm flexipipe connections  
deck mount drill hole diameter 34mm  
minimum operating pressure 0.2 bar LP

chrome  
AX-MAT-150-CP  
  
US hoses  
AX-MAT-150/US-C/P  
  
**Eto** FR-100/5-PLA



**AXCES**  
by VADO

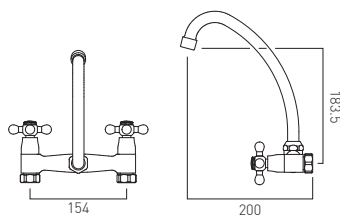

Victoriana  
2 hole kitchen mixer  
wall mounted  
with swivel spout  
cold ceramic cartridge C-201-RTC  
hot ceramic cartridge C-201-LTC  
1/2" x 3/4" x 48mm eccentrics  
minimum operating pressure 0.2 bar LP

chrome  
AX-VIC-154G/CD-CP



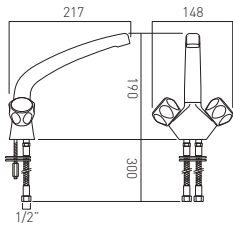

**AXCES**  
by VADO

**HANDLE  
OPTIONS**



**Contract**  
AST-1



**Lever**  
AST-3

Astra  
mono kitchen mixer  
deck mounted  
with swivel spout  
with water flow straightener  
cold ceramic cartridge C-201-RTC  
hot ceramic cartridge C-201-LTC  
standard cartridge for AST-1 only C-201-STD  
2 x 1/2" nut x 400mm flexipipe connections  
deck mount drill hole diameter 35mm  
minimum operating pressure 0.2 bar LP

chrome  
ceramic cartridge  
AX-AST-150/CD-CP  
AX-AST-350-CP

standard cartridge  
AX-AST-150-CP

**EBB** FR-FLEXI/5-PLA  
(2 are required)

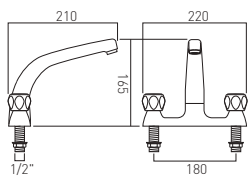

**AXCES**  
by VADO

**HANDLE  
OPTIONS**



**Contract**  
AST-1



**Lever**  
AST-3

Astra  
2 hole kitchen mixer  
deck mounted  
with swivel spout  
with water flow straightener  
cold ceramic cartridge C-201-RTC  
hot ceramic cartridge C-201-LTC  
standard cartridge for AST-1 only C-201-STD  
1/2" x 50mm threaded tail connections  
deck mount drill hole diameter 22mm  
minimum operating pressure 0.2 bar LP

chrome  
ceramic cartridge  
AX-AST-153/CD-CP  
AX-AST-353-CP

standard cartridge  
AX-AST-153-CP

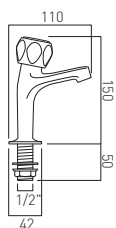

**AXCES**  
by VADO

**HANDLE  
OPTIONS**



**Contract**  
AST-1



**Lever**  
AST-3

Astra  
high neck kitchen pillar taps  
deck mounted  
with water flow straightener  
cold ceramic cartridge C-201-RTC  
hot ceramic cartridge C-201-LTC  
standard cartridge for AST-1 only C-102-STD  
1/2" x 50mm threaded connections  
deck mount drill hole diameter 22mm  
minimum operating pressure 0.2 bar LP

chrome  
ceramic cartridge  
AX-AST-156/CD-CP  
AX-AST-356-CP

standard cartridge  
AX-AST-156-CP

**EBB** FR-106/4-PLA  
(2 are required)



| NEW



Showering

Axces by VADO

AXCES  
by VADO



**AXCES**  
by VADO

Sirkel  
exposed round thermostatic 1/2" shower valve  
with single function slide rail shower kit  
1/2" x 3/4" x 50mm eccentrics  
easy fit mounting brackets  
thermostatic cartridge S-701-31S  
flow cartridge H-202-RTC  
minimum operating pressure 1.0 bar MP

kit comprises:

- AX-SIR-149T-CP**
- AX-SIR-SFSRK-DB-CP**
- AX-SH-049EFB-RO-CP**

chrome  
AX-SIR-SFSP-CP

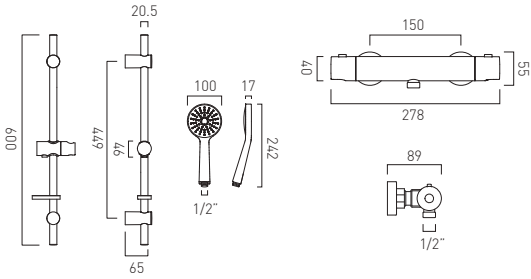

**AXCES**  
by VADO

Sirkel  
exposed round thermostatic 1/2" shower valve  
with 3 function slide rail shower kit  
1/2" x 3/4" x 50mm eccentrics  
easy fit mounting brackets  
thermostatic cartridge S-701-31S  
flow cartridge H-202-RTC  
minimum operating pressure 1.0 bar MP

kit comprises:

- AX-SIR-149T-CP**
- AX-SIR-MFSRK-DB-CP**
- AX-SH-049EFB-RO-CP**

chrome  
AX-SIR-MFSP-CP

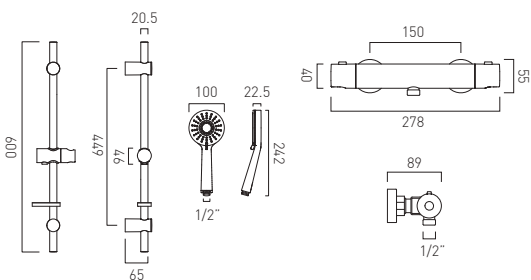

**AXCES**  
by VADO

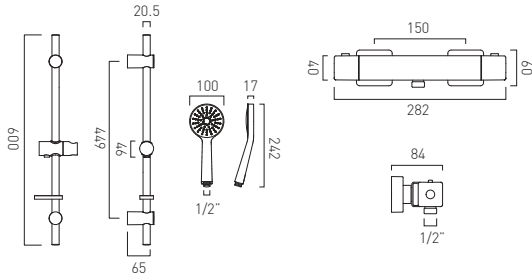

Bokx  
exposed square thermostatic 1/2" shower valve  
with Sirkel single function slide rail shower kit  
1/2" x 3/4" x 50mm eccentrics  
easy fit mounting brackets  
thermostatic cartridge S-701-31S  
flow cartridge H-202-RTC  
minimum operating pressure 1.0 bar MP

kit comprises:  
**AX-BOK-149T-CP**  
**AX-SIR-SFSRK-DB-CP**  
**AX-SH-049EFB-SQ-CP**

chrome  
AX-BOK-SFSP-CP



**AXCES**  
by VADO

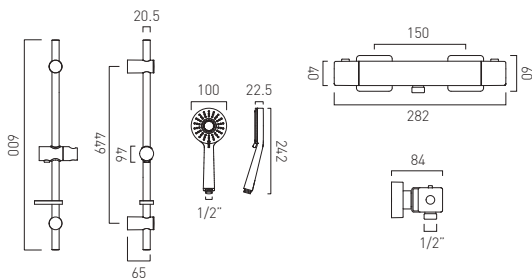

Bokx  
exposed square thermostatic 1/2" shower valve  
with Sirkel 3 function slide rail shower kit  
1/2" x 3/4" x 50mm eccentrics  
easy fit mounting brackets  
thermostatic cartridge S-701-31S  
flow cartridge H-202-RTC  
minimum operating pressure 1.0 bar MP

kit comprises:  
**AX-BOK-149T-CP**  
**AX-SIR-MFSRK-DB-CP**  
**AX-SH-049EFB-SQ-CP**

chrome  
AX-BOK-MFSP-CP



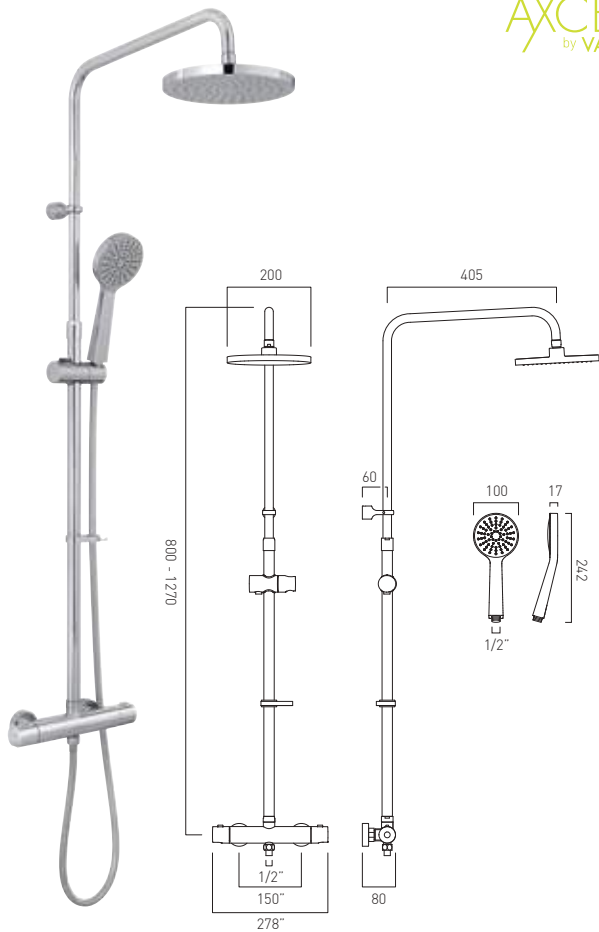

AXCES  
by VADO

Sirkel  
round thermostatic shower valve  
with integrated diverter  
rigid riser with single function shower head  
and handset  
200mm round shower head  
470mm height adjustment tolerance  
min 800mm - max 1270mm  
Adjustable for easy retro-fit

thermostatic cartridge S-701-31S  
diverter cartridge SG-801-25/2SX  
minimum operating pressure 1.0 bar MP

chrome  
AX-SIR-149T-RRK-CP

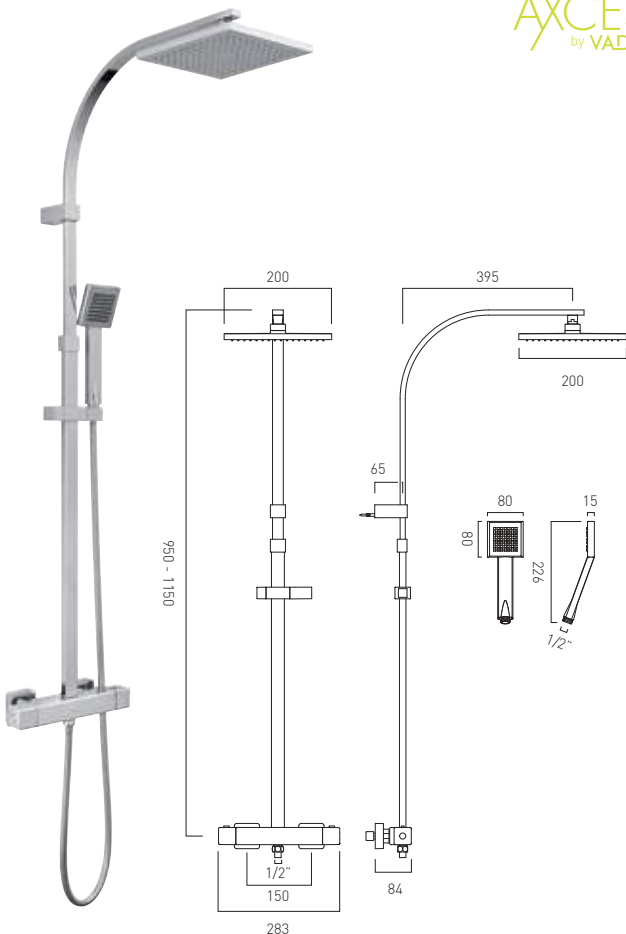

AXCES  
by VADO

Bokx  
square thermostatic shower valve  
with integrated diverter  
rigid riser with single function shower head  
and handset  
200mm square shower head  
200mm height adjustment tolerance  
min 950mm - max 1150mm  
Adjustable for easy retro-fit

thermostatic cartridge S-701-31S  
diverter cartridge SG-801-25/2SX  
minimum operating pressure 1.0 bar MP

chrome  
AX-BOK-149T-RRK-CP



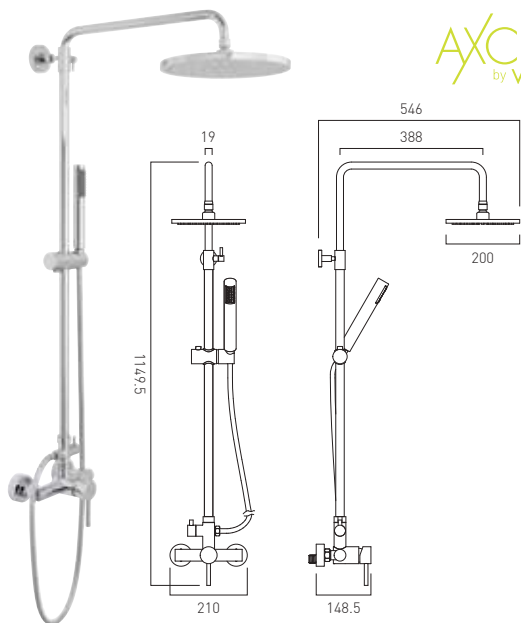

**AXCES**  
by VADO

Nuri  
single lever round exposed shower valve  
with integrated diverter  
rigid riser with single function shower  
head and handset  
254mm round shower head

ceramic cartridge C-003-N35  
minimum operating pressure 1.0 bar MP

chrome  
AX-NUR-149/RRK-CP



**AXCES**  
by VADO

rigid riser with 85mm (4") fixed shower head  
1/2" captive nut

for use with WAR-221/CD-C/P (see page 122)  
and AX-VIC-121/CD-CP (see page 258)  
minimum operating pressure 0.2 bar LP

chrome  
AX-XAV-RIGID-CP



**AXCES**  
by VADO

easy fit mounting brackets  
3/4" compression fit  
for use with AX-SIR-149T-RRK-CP  
and AX-SIR-149T-CP

chrome  
AX-SH-049EFB-RO-CP



**AXCES**  
by VADO

easy fit mounting brackets  
3/4" compression fit  
for use with AX-BOK-149T-RRK-CP  
and AX-BOK-149T-CP

chrome  
AX-SH-049EFB-SQ-CP



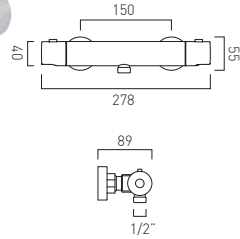

**AXCES**  
by VADO

Sirkel  
exposed round thermostatic 1/2" shower valve  
1/2" x 3/4" x 50mm eccentrics  
thermostatic cartridge S-701-31S  
flow cartridge H-202-RTC  
minimum operating pressure 1.0 bar MP

chrome  
AX-SIR-149T-CP

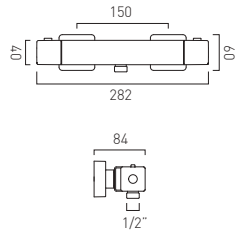

**AXCES**  
by VADO

Bokk  
exposed square thermostatic 1/2" shower valve  
1/2" x 3/4" x 50mm eccentrics  
thermostatic cartridge S-701-31S  
flow cartridge H-202-RTC  
minimum operating pressure 1.0 bar MP

chrome  
AX-BOK-149T-CP

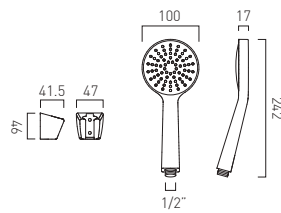

**AXCES**  
by VADO

Sirkel  
single function mini shower kit  
with 150cm hose and bracket  
minimum operating pressure 0.2 bar LP

chrome  
AX-SIR-SFMK-CP



EBB FR-SHOWER/9-C/P

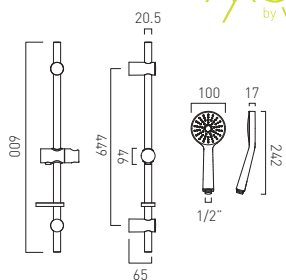

**AXCES**  
by VADO

Sirkel  
slide rail shower kit  
with single function handset  
600mm slide rail  
push button control slider  
hose AX-SH-015-150-DB-CP  
minimum operating pressure 0.2 bar LP

chrome  
AX-SIR-SFSRK-DB-CP



adjustable fixing  
for easy retro fit

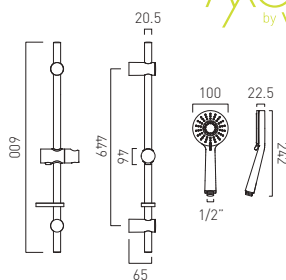

**AXCES**  
by VADO

Sirkel  
slide rail shower kit  
with 3 function handset  
600mm slide rail  
push button control slider  
hose AX-SH-015-150-DB-CP  
minimum operating pressure 1.0 bar MP

chrome  
AX-SIR-MFSRK-DB-CP



adjustable fixing  
for easy retro fit



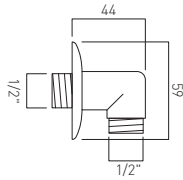

**AXCES**  
by VADO

wall outlet  
1/2" threaded inlet  
1/2" threaded outlet

chrome  
AX-WG-218-CP

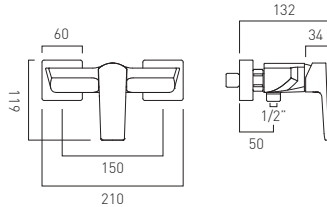

**AXCES**  
by VADO

Ekko  
exposed manual shower valve  
single lever  
wall mounted  
ceramic cartridge W-001-N35  
2 x 1/2" inlets  
1 x 1/2" shower outlet  
minimum operating pressure 1.0 bar MP

chrome  
AX-EKO-149-CP

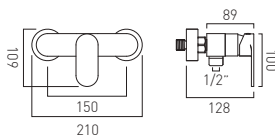

**AXCES**  
by VADO

Metiz  
exposed manual shower valve  
single lever  
wall mounted  
ceramic cartridge W-001-N35  
2 x 1/2" inlets  
1 x 1/2" shower outlet  
minimum operating pressure 1.0 bar MP

chrome  
AX-MET-149-CP



FR-SHOWER/9-C/P

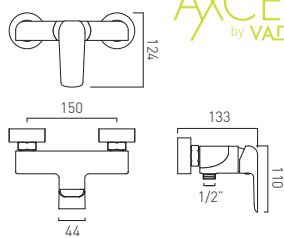

**AXCES**  
by VADO

Vala  
exposed manual shower valve  
single lever  
wall mounted  
ceramic cartridge W-002-N35  
2 x 1/2" inlets  
1 x 1/2" shower outlet  
minimum operating pressure 0.2 bar LP

chrome  
AX-VAL-149-CP



FR-SHOWER/9-C/P

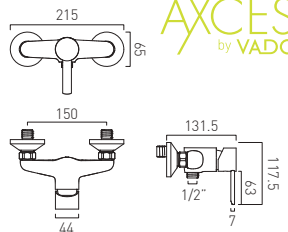

**AXCES**  
by VADO

Kore  
exposed manual shower valve  
single lever  
wall mounted  
ceramic cartridge W-002-N35  
2 x 1/2" inlets  
1 x 1/2" shower outlet  
minimum operating pressure 0.2 bar LP

chrome  
AX-KOR-149-CP



FR-SHOWER/9-C/P

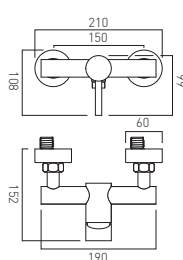

**AXCES**  
by VADO

Nuri  
exposed manual shower valve  
single lever  
wall mounted  
ceramic cartridge W-001-N35  
2 x 1/2" inlets  
1 x 1/2" shower outlet  
minimum operating pressure 1.0 bar MP

chrome  
AX-NUR-149-CP



FR-SHOWER/9-C/P



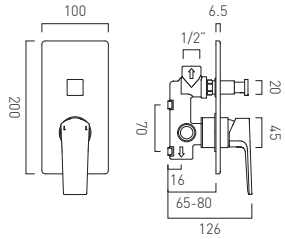

**AXCES**  
by VADO

Ekko  
concealed 2 outlet shower valve with diverter  
single lever  
wall mounted  
with rectangular backplate  
ceramic cartridge W-001-N35  
2 x 1/2" female inlets  
1 x 3/4" female outlet  
min-max wall mount 40-65mm  
minimum operating pressure 1.0 bar MP

chrome  
AX-EKO-147-CP

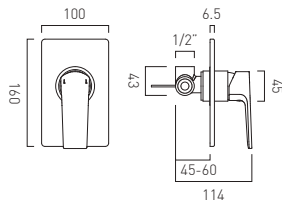

**AXCES**  
by VADO

Ekko  
concealed 1 outlet shower valve  
single lever  
wall mounted  
with rectangular backplate  
ceramic cartridge W-001-N35  
2 x 1/2" female inlets  
1 x 1/2" female outlet  
min-max wall mount 65-80mm  
minimum operating pressure 1.0 bar MP

chrome  
AX-EKO-145-CP

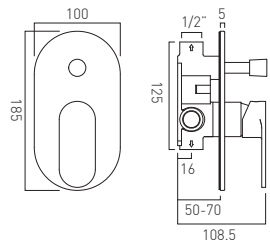

**AXCES**  
by VADO

Metiz  
concealed 2 outlet shower valve with diverter  
single lever  
wall mounted  
with oval backplate  
ceramic cartridge W-001-N35  
2 x 1/2" female inlets  
2 x 1/2" female outlets (one is blanked off)  
min-max wall mount 40-65mm  
minimum operating pressure  
0.2 bar LP (shower) 1.5 bar MP (bath)

chrome  
AX-MET-147A-CP

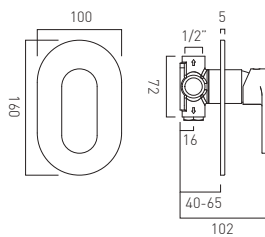

**AXCES**  
by VADO

Metiz  
concealed 1 outlet shower valve  
single lever  
wall mounted  
with oval backplate  
ceramic cartridge W-001-N35  
2 x 1/2" female inlets  
2 x 1/2" female outlets (one is blanked off)  
min-max wall mount 40-65mm  
minimum operating pressure  
0.2 bar LP (shower) 1.5 bar MP (bath)

chrome  
AX-MET-145A-CP

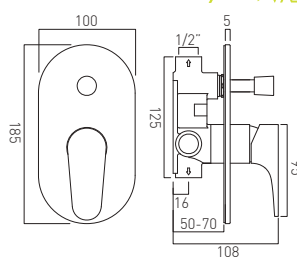

**AXCES**  
by VADO

Ava  
concealed 2 outlet shower valve with diverter  
single lever  
wall mounted  
with oval backplate  
ceramic cartridge W-001-N35  
2 x 1/2" female inlets  
2 x 1/2" female outlets (one is blanked off)  
min-max wall mount 40-65mm  
minimum operating pressure  
0.2 bar LP (shower) 1.5 bar MP (bath)

chrome  
AX-AVA-147A-CP



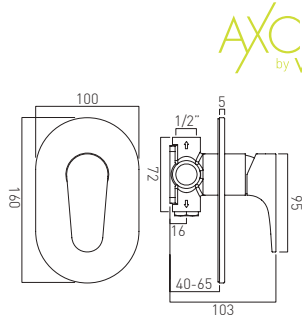

**AXCES**  
by VADO

Ava  
concealed 1 outlet shower valve  
single lever  
wall mounted  
with oval backplate  
ceramic cartridge W-001-N35  
2 x 1/2" female inlets  
2 x 1/2" female outlets (one is blanked off)  
min-max wall mount 40-65mm  
minimum operating pressure  
0.2 bar LP (shower) 1.5 bar MP (bath)

chrome  
AX-AVA-145A-CP

**1** outlet

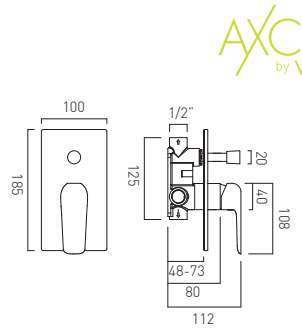

**AXCES**  
by VADO

Vala  
concealed 2 outlet shower valve with diverter  
single lever  
wall mounted  
with rectangular backplate  
ceramic cartridge W-001-N35  
2 x 1/2" female inlets  
2 x 1/2" female outlets (one is blanked off)  
min-max wall mount 40-65mm  
minimum operating pressure  
0.2 bar LP (shower) 1.5 bar MP (bath)

chrome  
AX-VAL-147A-CP

**2** outlet

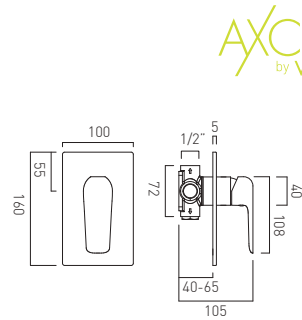

**AXCES**  
by VADO

Vala  
concealed 1 outlet shower valve  
single lever  
wall mounted  
with rectangular backplate  
ceramic cartridge W-001-N35  
2 x 1/2" female inlets  
2 x 1/2" female outlets (one is blanked off)  
min-max wall mount 40-65mm  
minimum operating pressure  
0.2 bar LP (shower) 1.5 bar MP (bath)

chrome  
AX-VAL-145A-CP

**1** outlet

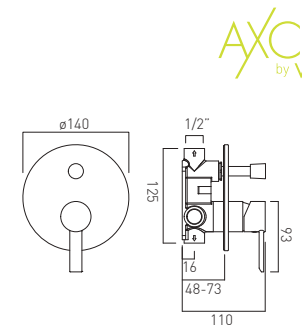

**AXCES**  
by VADO

Kore  
concealed 2 outlet shower valve with diverter  
single lever  
wall mounted  
with round backplate  
ceramic cartridge W-001-N35  
2 x 1/2" female inlets  
2 x 1/2" female outlets (one is blanked off)  
min-max wall mount 40-65mm  
minimum operating pressure  
0.2 bar LP (shower) 1.5 bar MP (bath)

chrome  
AX-KOR-147A-CP

**2** outlet

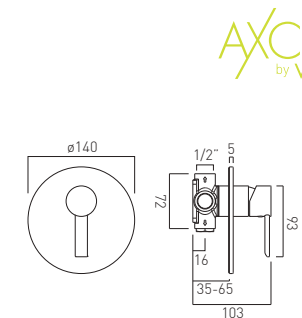

**AXCES**  
by VADO

Kore  
concealed 1 outlet shower valve  
single lever  
wall mounted  
with round backplate  
ceramic cartridge W-001-N35  
2 x 1/2" female inlets  
2 x 1/2" female outlets (one is blanked off)  
min-max wall mount 40-65mm  
minimum operating pressure  
0.2 bar LP (shower) 1.5 bar MP (bath)

chrome  
AX-KOR-145A-CP

**1** outlet



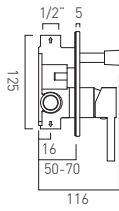
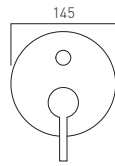

**AXCES**  
by VADO

Nuri  
concealed 2 outlet shower valve with diverter  
single lever  
wall mounted  
with round backplate  
ceramic cartridge W-001-N35  
2 x 1/2" female inlets  
2 x 1/2" female outlets (one is blanked off)  
min-max wall mount 40-65mm  
minimum operating pressure  
0.2 bar LP (shower) 1.5 bar MP (bath)

chrome  
AX-NUR-147A-CP

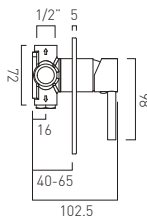
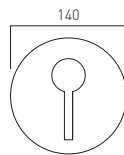

**AXCES**  
by VADO

Nuri  
concealed 1 outlet shower valve  
single lever  
wall mounted  
with round backplate  
ceramic cartridge W-001-N35  
2 x 1/2" female inlets  
2 x 1/2" female outlets (one is blanked off)  
min-max wall mount 40-65mm  
minimum operating pressure  
0.2 bar LP (shower) 1.5 bar MP (bath)

chrome  
AX-NUR-145A-CP

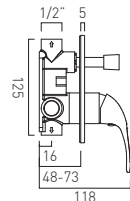
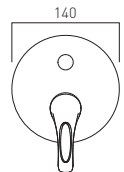

**AXCES**  
by VADO

Matrix  
concealed 2 outlet shower valve with diverter  
single lever  
wall mounted  
with round backplate  
ceramic cartridge W-001-N35  
2 x 1/2" female inlets  
2 x 1/2" female outlets (one is blanked off)  
min-max wall mount 40-65mm  
minimum operating pressure  
0.2 bar LP (shower) 1.5 bar MP (bath)

chrome  
AX-MAT-147A-CP

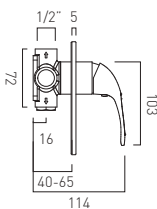
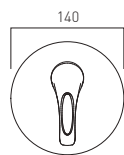

**AXCES**  
by VADO

Matrix  
concealed 1 outlet shower valve  
single lever  
wall mounted  
with round backplate  
ceramic cartridge W-001-N35  
2 x 1/2" female inlets  
2 x 1/2" female outlets (one is blanked off)  
min-max wall mount 40-65mm  
minimum operating pressure  
0.2 bar LP (shower) 1.5 bar MP (bath)

chrome  
AX-MAT-145A-CP



AXCES  
by VADO

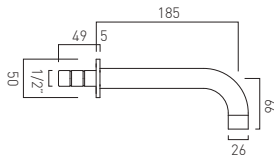

Sirkel  
round bath spout  
wall mounted  
1/2" male inlet  
minimum operating pressure 0.2 bar LP

chrome  
AX-SIR-140/RO



AXCES  
by VADO

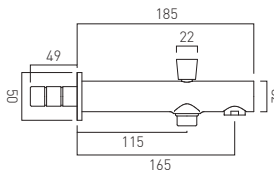

Sirkel  
round bath spout with integrated diverter  
wall mounted  
1/2" male inlet  
1 x 1/2" shower outlet  
minimum operating pressure 1.0 bar MP

chrome  
AX-SIR-140/RO/DIV



AXCES  
by VADO

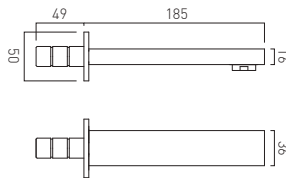

Bokx  
square bath spout  
wall mounted  
1/2" male inlet  
minimum operating pressure 0.2 bar LP

chrome  
AX-BOK-140/SQ



AXCES  
by VADO

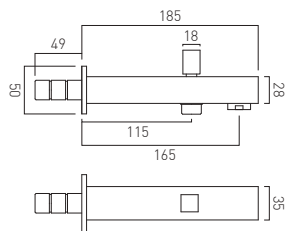

Bokx  
square bath spout with integrated diverter  
wall mounted  
1/2" male inlet  
1 x 1/2" shower outlet  
minimum operating pressure 1.0 bar MP

chrome  
AX-BOK-140/SQ/DIV



| NEW



AXCES  
by VADO



AXCES  
by VADO

paper holder  
wall mounted

chrome  
AX-SIR-180-CP

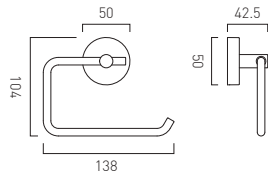

AXCES  
by VADO

covered paper holder  
wall mounted

chrome  
AX-SIR-180A-CP

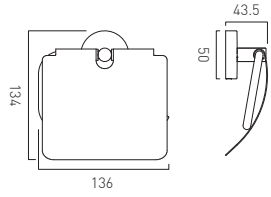

AXCES  
by VADO

towel ring  
wall mounted

chrome  
AX-SIR-181-CP

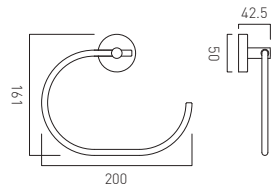

AXCES  
by VADO

frosted glass soap dish and holder  
wall mounted

chrome  
AX-SIR-182-CP

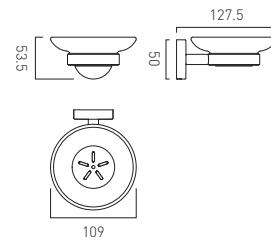

AXCES  
by VADO

frosted glass tumbler and holder  
wall mounted

chrome  
AX-SIR-183-CP

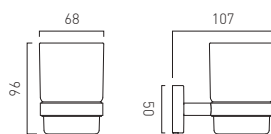



**AXCES**  
by VADO

towel rail  
wall mounted  
450mm (18")

chrome  
AX-SIR-184-45-CP

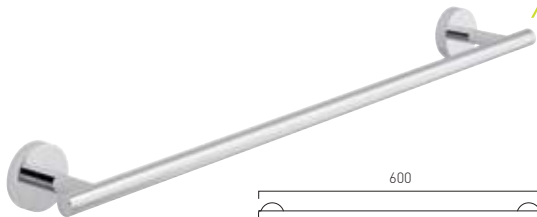
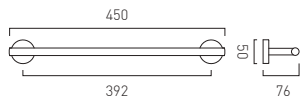

**AXCES**  
by VADO

towel rail  
wall mounted  
600mm (24")

chrome  
AX-SIR-184-60-CP

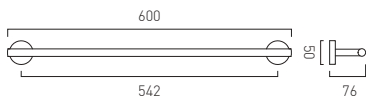

**AXCES**  
by VADO

robe hook  
wall mounted

chrome  
AX-SIR-186-CP

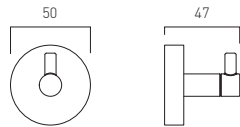

**AXCES**  
by VADO

5 accessory pack

kit comprises:  
**AX-SIR-180-CP**  
**AX-SIR-181-CP**  
**AX-SIR-182-CP**  
**AX-SIR-183-CP**  
**AX-SIR-186-CP**

chrome  
AX-SIR-189-CP



**AXCES**  
by VADO

6 accessory pack

kit comprises:  
**AX-SIR-180A-CP**  
**AX-SIR-181-CP**  
**AX-SIR-182-CP**  
**AX-SIR-183-CP**  
**AX-SIR-184-60-CP**  
**AX-SIR-186-CP**

chrome  
AX-SIR-189A-CP





| NEW



AXCES  
by VADO



AXCES  
by VADO

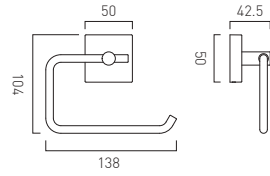

paper holder  
wall mounted

chrome  
AX-BOK-180-CP



AXCES  
by VADO

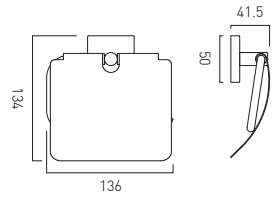

covered paper holder  
wall mounted

chrome  
AX-BOK-180A-CP



AXCES  
by VADO

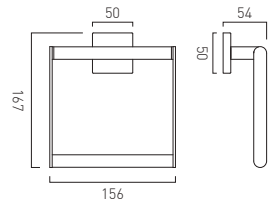

towel ring  
wall mounted

chrome  
AX-BOK-181-CP



AXCES  
by VADO

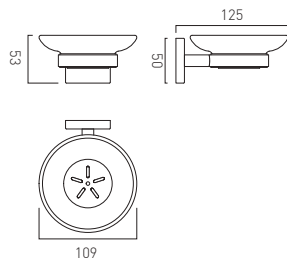

frosted glass soap dish and holder  
wall mounted

chrome  
AX-BOK-182-CP



AXCES  
by VADO

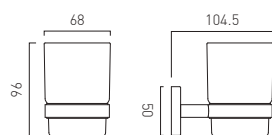

frosted glass tumbler and holder  
wall mounted

chrome  
AX-BOK-183-CP





**AXCES**  
by VADO

towel rail  
wall mounted  
450mm (18")

chrome  
AX-BOK-184-45-CP

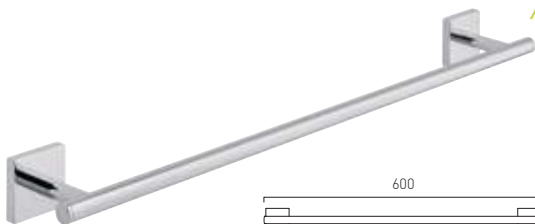
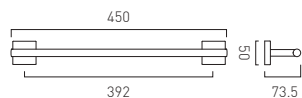

**AXCES**  
by VADO

towel rail  
wall mounted  
600mm (24")

chrome  
AX-BOK-184-60-CP

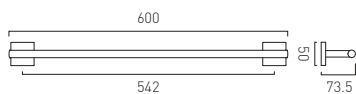

**AXCES**  
by VADO

robe hook  
wall mounted

chrome  
AX-BOK-186-CP

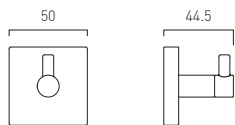

**AXCES**  
by VADO

5 accessory pack

chrome  
AX-BOK-189-CP



kit comprises:  
**AX-BOK-180-CP**  
**AX-BOK-181-CP**  
**AX-BOK-182-CP**  
**AX-BOK-183-CP**  
**AX-BOK-186-CP**



**AXCES**  
by VADO

6 accessory pack

chrome  
AX-BOK-189A-CP



kit comprises:  
**AX-BOK-180A-CP**  
**AX-BOK-181-CP**  
**AX-BOK-182-CP**  
**AX-BOK-183-CP**  
**AX-BOK-184-60-CP**  
**AX-BOK-186-CP**



AXCES  
by VADO

Tournament Accessories

Axces by VADO

AXCES  
by VADO

closed paper holder  
wall mounted

chrome  
AX-TOU-180A-CP

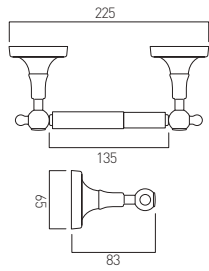

AXCES  
by VADO

ceramic soap dish and holder  
wall mounted

chrome  
AX-TOU-182A-CP



replacement ceramic soap dish  
TOU-082A-CER

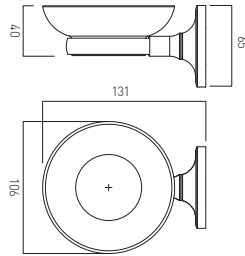

AXCES  
by VADO

ceramic tumbler and holder  
wall mounted

chrome  
AX-TOU-183A-CP



replacement ceramic tumbler  
TOU-083A-CER

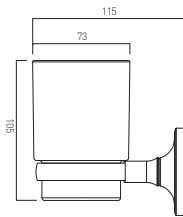

AXCES  
by VADO

towel ring  
wall mounted

chrome  
AX-TOU-181-CP

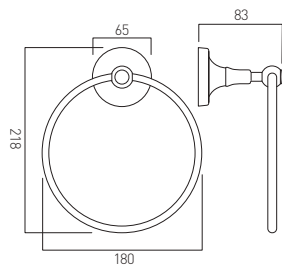

AXCES  
by VADO

towel rail  
wall mounted  
560mm (22")

chrome  
AX-TOU-184-CP

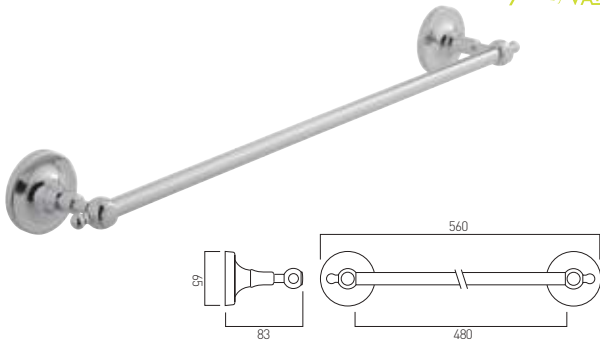

AXCES  
by VADO

clear glass galley shelf  
wall mounted  
510mm (20")

chrome  
AX-TOU-185A-CP

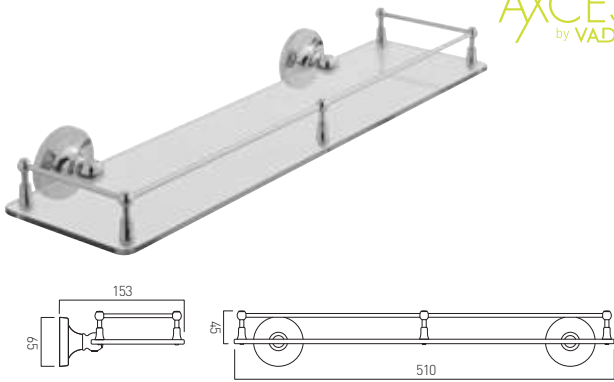

AXCES  
by VADO

robe hook  
wall mounted

chrome  
AX-TOU-186-CP



AXCES  
by VADO

toilet brush  
and polished stainless steel holder  
freestanding

stainless steel  
AX-TOU-188-CP

replacement brush  
TOU-188-BRUSH

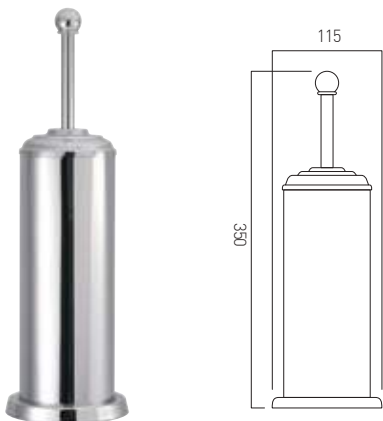



Baskets

VADO

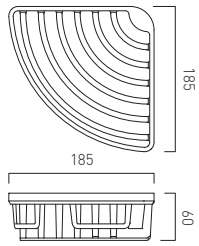

removable triangular corner basket  
wall mounted

chrome  
BAS-2000-C/P

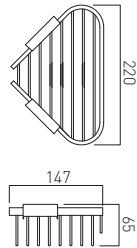

medium triangular corner basket  
wall mounted

chrome  
BAS-2015M-C/P

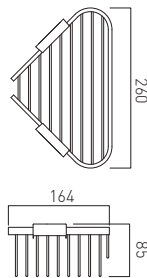

large triangular corner basket  
wall mounted

chrome  
BAS-2015L-C/P

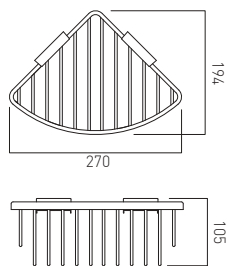

large triangular corner basket  
wall mounted

chrome  
BAS-2012-C/P

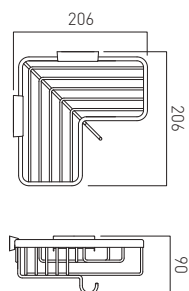

corner basket with hook  
wall mounted

chrome  
BAS-2014-C/P





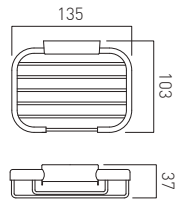

small rectangular basket  
wall mounted

chrome  
BAS-2001-C/P

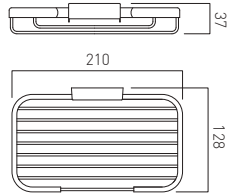

medium rectangular basket  
wall mounted

chrome  
BAS-2002-C/P

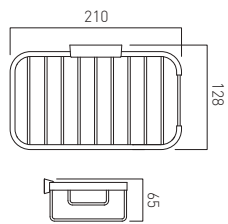

medium rectangular basket  
wall mounted

chrome  
BAS-2016M-C/P

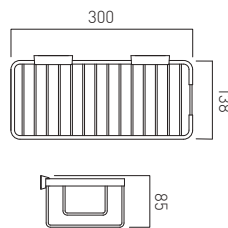

large rectangular basket  
wall mounted

chrome  
BAS-2016L-C/P

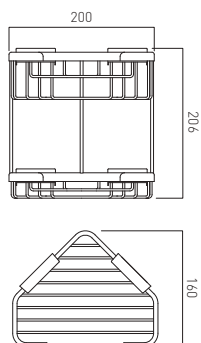

large double triangular corner basket  
wall mounted

chrome  
BAS-2013-C/P



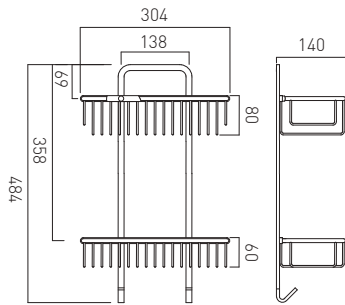

large rectangular double basket  
wall mounted

chrome  
BAS-2003-C/P

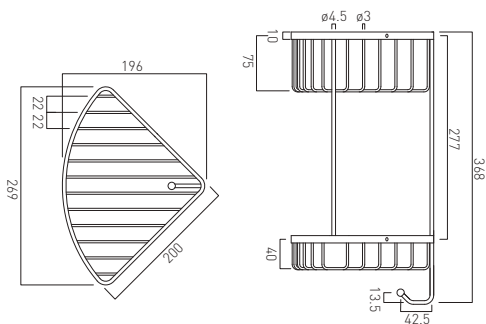
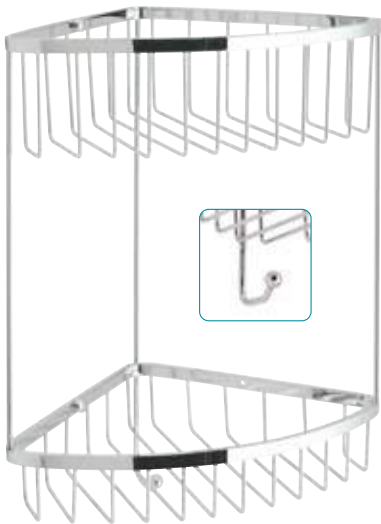

large double triangular corner basket  
with integral hook  
wall mounted

chrome  
BAS-2004-C/P





# Flow regulators for basin and shower mixers

With **VADO** flow regulators fitted to taps and showers, the savings in water, gas and electricity can reduce your carbon footprint.



replaces aerator in most monobasin mixers regulating flow to 5 litres per minute

- FR-100/5-PLA
- FR-100/5-B-PLA



placed in tails of basin pillar taps or between shower head and fixed arm regulating flow to between 4 and 9 litres per minute

- FR-106/4-PLA (tails)
- FR-106/5-PLA (tails)
- FR-106/6-PLA (tails)
- FR-106/9-PLA (tails)
- FR-SHOWER/9-PLA (shower)



placed in flexible tails of some VADO mixers regulating flow to between 5 and 9 litres per minute

- FR-FLEXI/5-PLA
- FR-FLEXI/8-PLA
- FR-FLEXI/9-PLA



placed on shower outlet of all bath and shower mixers or handset inlets regulating flow to 6 or 9 litres per minute

- FR-SHOWER/6-C/P
- FR-SHOWER/9-C/P

## SAVE WATER. SAVE MONEY. SAVE THE PLANET.

**VADO** flow regulators both protect the environment and effectively reduce your carbon footprint

### How to order

Every **VADO** tap or shower that can be fitted with a **VADO** flow regulator has the logo next to it in this catalogue alongside the appropriate product code. For example:

To save up to 80% water usage on a pair of ZOO basin pillar taps you order: ZOO-106-C/P and FR-106/4-PLA (2 are required)



To save up to 75% water usage on an AQUABLADE shower head you order: AQB-RO/20-C/P and FR-SHOWER/9-PLA



To save up to 75% water usage with a LIFE basin mixer you order: LIF-100/SB-C/P and FR-100/5-B-PLA



To save up to 60% water usage with an EVOLVE showering handset you order: EVO-HANDSET/MF-DB-CP and FR-SHOWER/9-C/P



### - SAVE WATER

**VADO** flow regulators are designed to regulate and control the flow of water to taps and showers without hampering the performance or design of the product. **VADO** products can save up to 80% water usage.

### - SAVE MONEY

In an average household, **VADO** delivers a potential £360 saving on utility bills in one year.\*  
\*source: **VADO** study  
In commercial applications the savings are even greater. The Marriott Hotel Group saved approximately 41,000 litres of water which reduced annual costs by £38,000 after installing **VADO** flow regulators in one hotel.

### - SAVE THE PLANET

With **VADO** flow regulators fitted to your taps and showers, the savings in water, gas and electricity can reduce your carbon footprint.

## RETURNS AND RE-FIXING

### RETURNS PROCEDURE

Note to retailers: We do not operate a sale or return policy. However in the event that you need to return products to us for any reason the following procedure should help to ensure that we handle your request efficiently.

Please note goods which are no longer required and that have been held by you for longer than three months from date of invoice cannot be considered for return and credit.

A Collection Request in the form of a Debit Note or VADO Collection Request Note should be emailed to our Collections Department:

- e-mail: [vado.collection@vado.com](mailto:vado.collection@vado.com)
  - Direct Telephone No: 01934 745154

We require the following details in order to process the necessary paperwork: Item stock code, finish & quantity of item(s) to be returned. The relevant Invoice Number or Delivery Note Number and the reason for return of the item(s).

- Our Collections Department will process the paperwork and after the collection request has been authorised, we will forward by post a self-adhesive label(s) for you to confirm all details and attach to the parcel(s). You will also receive a Returned Goods Authorisation Note. The details of this note need to be checked and signed by you. This note is to be enclosed in the parcel being returned. A copy of the Returned Goods Authorisation Note for your records will also be enclosed with the label. If you have any queries whatsoever, regarding the collection, please telephone our Collections Department, on receipt of label(s) 01934 745154

- All goods are to be suitably packaged before despatch to VADO, i.e. presentation boxes packed inside an outer box. Goods received back in anything other than re-saleable condition, may result in a request for credit being refused.
- With the exception of faulty or damaged goods, all goods being returned will be subject to a 25% re-stocking charge with a minimum £15 charge being applicable.
- If items are received damaged or faulty, no charge is made for returning the goods to us. Please note: shortages and damages must be notified within 2 days of receipt of goods. Notification outside of the 2-day period will void any claim. If after our inspection a product is found to be defective due to a manufacturing fault, we will issue a credit or a free of charge replacement.
- Our collections department will liaise with your designated contact, confirming the total number of boxes packed ready for collection and a mutually convenient collection date will be arranged.

### CLAIMS FOR RE-FIXING

In the event that you have a claim for re-fitting or repair of a faulty product, please contact our Technical department on 01934 745163. All claims for re-fixing charges must be authorised by us before any work is undertaken. Claims for re-fixing that are made after work has been undertaken will be rejected.

## GUARANTEE

All VADO products come with a 2 year guarantee as standard. Within this guarantee period VADO will provide replacement parts and any labour [SEE NOTE 1] needed to complete the product repair. This standard guarantee may be extended by registering your product to give up to a 15 year guarantee period. Once registered:

Booth & Co. chrome and nickel brassware products have a 15 year guarantee (2 years parts and labour plus 13 years parts only).

VADO chromed brassware and stainless steel products have a 15 year guarantee (2 years parts and labour plus 13 years parts only).

Brassware products from the Individual by VADO collection have a 15 year guarantee (2 years parts and labour plus 13 years parts only).

VADO Sensori SmartTouch and SmartDial products have a 5 year guarantee (parts and labour).

VADO Identity and i-tech products have a 5 year guarantee (2 year parts and labour plus 3 years parts only).

Ances by VADO products have a 10 year guarantee (2 years parts and labour plus 8 years parts only). Aces by VADO electric showers have a 2 years parts and labour guarantee.

All other VADO products have a 3 year guarantee (2 years parts and labour plus 1 year parts only) [SEE NOTE 2].

### GUARANTEE CONDITIONS

Our products are guaranteed against manufacturing defects from the date of purchase until the expiry of the relevant guarantee period shown above.

The guarantee is only valid if:

- The product has been installed, used and maintained (maintenance guidelines can be viewed here) in accordance with VADO's instructions and subjected to normal use only.
- The defect is not due to use of an unsuitable or inadequate water or power supply.
- The defect is not due to accident, misuse, neglect or incorrect/inappropriate repair (other than by VADO or VADO authorised agents) or damage caused by foreign objects or substances.
- The extended guarantee is only available if you have completed the Guarantee Registration Process. This can be done via the VADO website or via phone to our guarantee team. Registration must be completed within 6 months from date of purchase.

Under the extended guarantee period VADO will, at its option, offer to supply any replacement product (or component part) assessed to be defective [SEE NOTE 3].

The guarantee (whether standard or extended) is non-transferable to any subsequent owner.

All claims under the guarantee should be notified in the first instance to our Aftersales department, contact details below, this must be done no later than the last day of the relevant guarantee period. All claims must be accompanied by proof of purchase (sales receipt or delivery note) from an official VADO dealer.

The guarantee does not extend to any consequential loss or damage.

After repair or replacement, the relevant guarantee period will be calculated from the original date of purchase.

VADO operates a policy of continuous product development and therefore reserves the right to change the product, packaging and documentation specifications without notice.

### NOTES:

- Labour via our engineer network is only available in the UK. Attendance by a VADO engineer or sub-contract engineer will be under our standard terms and conditions.
- VADO spare parts and shower hoses are under a parts only guarantee.
- VADO reserves the right to charge in advance for a product (or replacement part) pending collection and investigation (at VADO expense) to confirm a defect is due to a manufacturing issue. If a defect is found the charge will be refunded or cancelled.

This guarantee is in addition to and does not affect your statutory rights as a consumer.

### CLAIMS:

**Tel:** 01934 745163 **Email:** [aftersalescare@vado.com](mailto:aftersalescare@vado.com)

### GUARANTEE:

**Tel:** 01934 315699 **Email:** [guarantee@vado.com](mailto:guarantee@vado.com)

# RETURNS AND RE-FIXING

## DEFINITIONS

In these conditions 'the Company' shall mean VADO, a division of Norcros Group (Holdings) Limited, 'the purchaser' shall mean the person, firm or company to whom any quotation is addressed or with whom any contract is made and 'the goods' shall mean the goods and/or services agreed to be sold by the Company to the purchaser.

## 1. QUOTATION AND ACCEPTANCE

- (a) All quotations are given and all orders are accepted on these terms which shall apply to the exclusion of and shall override any other terms stipulated or referred to by the purchaser whether in its order or any other document, or in any negotiations or communication or course of dealing established between the Company and the purchaser;
- (b) No modification or amendment of these terms or addition thereto shall be effective unless made in writing and signed by a director of the Company.

## 2. DESCRIPTION OF AND STATEMENTS AS TO GOODS

- (a) Save where the goods are stated to be sold as complying with a recognised trade or industry standard, all descriptions, specifications, drawings and particulars of weights and dimensions submitted by the Company or otherwise contained in the Company's catalogues, brochures, price lists, quotations and publicity materials are approximate only and the Company shall not be liable for their accuracy unless they are expressly incorporated into the contract in writing;
- (b) These terms represent the entire agreement between the Company and the purchaser relating to the goods and such terms supersede and the purchaser shall not place any reliance upon any statements, recommendations and advice whether oral or in writing given (whether before or after the acceptance by the Company of the purchaser's order) by the Company, its servants or agents as to any matter relating to the goods save where such statement, recommendations or advice is given in writing and signed by a director of the Company in response to a specific written request from the purchaser before or at the time of the Company's acceptance of the order.

## 3. PRICES

Prices quoted by the Company are those in effect at the date of quotation. Unless otherwise agreed in writing, the Company reserves the right to increase prices when it accepts the purchaser's order so as to reflect one or more of the following:

- (a) any variation that may have occurred in the costs of labour, materials, suppliers overheads and transport;
- (b) any change in duty, tax, surcharge or levy of any kind whatsoever affecting the sale price of the goods;
- (c) any cost to the Company resulting from delay by the purchaser in giving to the Company information sufficient to enable it to supply the goods or provide the services or resulting from any alteration made at the request of the purchaser in the specification of the goods or in the place to which they are to be delivered or shipped;
- (d) any extra cost to the Company resulting from the goods being carried at the request of the purchaser by mode of transport more expensive than the Company's normal form of transport.

## 4. PAYMENT

- (a) Unless otherwise agreed in writing, the price for the goods will be due and payable on the last business day of the month following delivery;
- (b) The Company shall be entitled to charge interest on any part of the price which is not paid in accordance with clause (a) at the rate per annum of 3% above the Base Rate of Lloyds Banking Group from time to time;
- (c) Time of payment is of the essence and if the purchaser defaults in punctual payment of the price the Company shall be entitled to terminate the contract and recover the goods at the purchaser's expense without prejudice to any further rights which the Company may have;
- (d) Any default in payment of an invoice or an instalment payment on an invoice on the due date shall render the entire balance outstanding on all invoices from the Company to the purchaser immediately payable in full without demand being made notwithstanding any contrary provisions as to terms of payment in any one or all invoices;
- (e) If the purchaser fails to give all instructions reasonably required by the Company and all necessary document, licences, consents and authorities for forwarding the goods or is unable to accept delivery of the goods at the time when the goods are due and ready for despatch or delivery or shall otherwise cause or request delay, the purchaser shall pay to the Company all costs and expenses, including storage and insurance charges incurred or arising from such delay during which, at the Company's absolute discretion if its storage facilities permit, the goods will be stored at the purchaser's sole risk. This provision shall be in addition to and not in substitution for any other payment or damages for which the purchaser may be liable in respect of his failure to take delivery at the appropriate date;
- (f) The purchaser shall not be entitled to make any deduction from the price of goods which have been delivered to the purchaser in respect of any set off or counterclaim unless both the validity and the amount thereof have been expressly admitted in writing by the Company and such admission is signed by a director of the Company;
- (g) In the absence of any specific appropriation by the purchaser, the Company shall have the right to appropriate any payment made by the purchaser towards the satisfaction of any invoice outstanding from time to time as the Company shall in its absolute discretion think fit.

## 5. DELIVERY

- (a) Any time or date stated for delivery is given and intended as an estimate only and the Company shall not be liable for any loss or damage whatsoever resulting from any delay in delivery howsoever arising;
- (b) Unless otherwise stated in writing delivery shall be deemed to take place upon the occurrence of the first in time of the following, namely:
  - i. the physical delivery of the goods to the purchaser at the Company's works;
  - ii. the physical delivery of the goods to the purchaser's carrier or agent for the purpose of transmission to the purchaser or his nominee;
  - iii. the physical delivery of the goods to the purchaser's place of business or such other place as he may direct by the Company, its carrier or agent, the purchaser being responsible for unloading;
- (c) Signature of the Company's delivery note by any employee, representative or agent of the purchaser shall be conclusive proof of delivery;
- (d) Where the contract provides for delivery by the Company, its carrier or agent:
  - i. any claims for non-delivery must be made in writing to the Company within three days of receipt of invoice or advice note whichever is the earlier;
  - ii. any claims in respect of goods damaged in transit or shortages in delivery must be made in writing to the Company within three days of delivery; shortages in delivery shall not give rise to a right to reject the goods delivered;
- (e) The Company shall be entitled to make partial deliveries or deliveries by instalments and all the provisions of these terms shall apply to such deliveries;

## 6. PROPERTY AND RISK

- (a) Risk in the goods shall pass to the purchaser at the time at which delivery takes place in accordance with clause 5 above and the purchaser shall be solely responsible for insuring the goods thereafter;
- (b) The Company shall retain ownership of and title in the goods delivered until full payment has been made in respect of all such goods. Until such time the goods shall be:

- i. stored separately from other goods in the possession of the purchaser;
  - ii. marked or otherwise rendered identifiable as being the property of the Company;
  - iii. held by the purchaser as bailee of the Company;
  - iv. held by the purchaser free from any charge, lien or other encumbrance;
- (c) Provided the Company has not requested their return and notwithstanding that payment in full has not been made for all of the goods delivered, the purchaser as principal and not as agent for the Company shall be entitled to use the goods or offer for sale and sell them in the ordinary course of his business;
  - (d) Where the purchaser sells the goods prior to paying for them in full:
    - i. the Company shall be legally and beneficially entitled to the proceeds of sale;
    - ii. the purchaser shall hold the proceeds of sale on trust for the Company and shall not mingle them with other monies and shall not pay them into an overdrawn bank account; he shall deposit the proceeds of sale in a separate bank account, the location and number of which he has previously notified to the Company, and he shall not be entitled to use or deal with the proceeds of sale until payment in full for the goods has been made to the Company;
    - iii. The Company shall have the right at any time by its servants or agents to enter the purchaser's premises where the goods are stored, or are thought the Company to be stored, so as to:
      - i. retake possession of the goods when the Company has requested their return and the purchaser has not immediately complied with the request, such retaking or return to be without prejudice to any other rights the Company may have arising therefrom;
      - ii. inspect the storage of the Company's goods which have not been paid for in full;
      - iii. investigate and ascertain whether all these terms are being complied with;

## 7. GUARANTEE AND LIABILITY

- (a) The Company guarantees all goods which have been manufactured by the Company against any defect of work or materials which can be proved to the Company's satisfaction to have been caused before delivery provided that:
  - i. the goods are used for their normal purpose,
  - ii. full details of any such defect are notified to the Company within thirty days of its first appearance and
  - iii. the goods in which the defect arises are returned at the purchaser's expense to the Company;
- (b) The guarantee shall be for a period of twelve years from the date of delivery for all product except pumps which are 3 years for Monsoon and 1 year for Showermate and products with any other finish that is not chrome, such as gold, which are guaranteed for 3 years. The liability of the Company shall be limited at its option either to supply replacement goods, which will be supplied subject to these terms, or refunding of the goods;
- (c) The Company gives no guarantee in respect of goods not manufactured by it but shall use all reasonable endeavours to procure for the purchaser or assign to the purchaser the benefit of any guarantee obtained by it from the manufacturer or supplier thereof; however the Company shall not be required to commence litigation against such manufacturer or supplier or to incur any expense in connection with any such claim by the purchaser;
- (d) The above guarantee is given in lieu of and to the exclusion of all other warranties, conditions, representations and undertakings express or implied by statute or otherwise in respect of the quality or fitness for purpose of the goods or as to their condition or performance or as to any other matter except where such warranty or condition is implied by statute and by reason of a statutory provision, cannot be excluded;
- (e) Save as provided herein and save in any case where death or personal injury has been caused by the Company's negligence or any case where the Company is liable for a defect in the goods pursuant to Part 1 of the Consumer Protection Act 1987 or any statutory replacement thereof, the Company shall be under no liability whatsoever to the purchaser for any loss or damage whether direct, indirect or consequential arising out of any defect in, failure of or unsuitability for any purpose of the goods or any part thereof whether the same be due to any act, omission, breach of contract, negligence or wilful default in design, workmanship or materials or any other cause.

## 8. INDEMNITY AS TO INDUSTRIAL PROPERTY RIGHTS

- (a) The purchaser shall indemnify the Company against all loss, damages, costs and expenses suffered or incurred by the Company or to which the Company may become liable as a result of any work carried out in accordance with the purchaser's specification(s) which involves infringement or alleged infringement of a patent, registered design or other industrial property right;
- (b) If the purchaser uses or sells the goods in such a manner as to infringe any such rights the company shall not be responsible for such infringement and the purchaser agrees to indemnify the Company from and against all liability arising therefrom.

## 9. TERMINATION

- The Company shall have the right forthwith to cancel the purchaser's order if any of the following events occur and subject to enforcement of the Company's rights to recover the goods and to receive payment of the price or damages, the contract shall be deemed to have terminated:
- (a) the purchaser commits any breach of its obligations to the Company;
  - (b) any distress or execution is levied upon any property of the purchaser;
  - (c) the purchaser makes or offers to make any arrangement or composition with creditors or commits any act of bankruptcy or insolvency;
  - (d) any resolution is passed or petition presented to wind up the purchaser;
  - (e) a receiver or administrator is appointed or any chargee takes possession of all or any part of the undertaking or assets of the purchaser;
  - (f) the purchaser stops payment or ceases or threatens to cease to carry on its business or to pay its debts as and when they fall due;
  - (g) any remittance for payment of the whole or any part of the purchase price of the goods is dishonoured by the purchaser's bankers.

## 10. ASSIGNMENT

- The purchaser shall not assign or transfer or purport to assign or transfer any contract to which these terms apply to any other person without the Company's prior written consent. The Company reserves the right to subcontract the performance of the contract or any part of it.

## 11. FORCE MAJEURE

- If the Company is prevented or delayed (directly or indirectly) from making delivery of the goods or any part thereof or from otherwise performing the contract or any part thereof by reason of war, embargo, riot, strike, lock-out, trade dispute, fire, breakdown of plant or machinery, inclement weather, interruption of transport, Government action, delay in delivery to the Company of any goods or materials, or by any cause whatsoever (whether or not of a like nature to the foregoing) outside its control, it shall be under no liability whatsoever to the purchaser and shall be entitled at its option either to cancel the contract or without any liability to extend the time or times for delivery by a period equivalent to that during which such delivery has been prevented.

## 12. PROPER LAW

- The contract and these terms shall be governed by English law and the purchaser shall submit to the sole jurisdiction of the English Courts.



WHERE  
INSPIRATION  
FLOWS



VADO  
Wedmore Road Cheddar Somerset England BS27 3EB  
tel +44 (0)1934 745160  
fax +44 (0)1934 745161  
www.vado.com  
export@vado.com

due to our policy of continual improvement, VADO reserve the right to change product specification.  
the colours indicated are an approximation of the actual finishes on VADO products. e&oe.  
©2020 VADO LIT-VADO/EXPO-SPEC21

