

Heavy Duty Rails Instructions

(For 5 & 6ft Rails)

1. Insert castor wheels **(F)** into the pre-inserted wheels plugs located in each arm of the legs **(C)** until both leg units have 2 wheels attached. This may require some force. the wheels will click when fully inserted.
2. With the uprights **(B)** held inverted (right angle bar facing the ground) , take the legs **(C)** also inverted, and place down onto the uprights **(B)**. Press in the spring clips in then slide the legs down until the clips lock into place.
3. Attach the middle bar **(A)** to one upright **(B)** on the right angle bar, then align and pull in the other upright to connect it to the other end of the middle bar **(A)**
4. Take the bottoms bar **(E + D)** and insert them into one of the remaining bottom openings in the legs **(C)** Press in the spring clips and insert up into the legs until the clips lock into place.
5. Pull each bottom bar **(E+ D)** apart and connect the two ends. Press the spring clip in on **(E)** until it locks into place. This completes the rail.

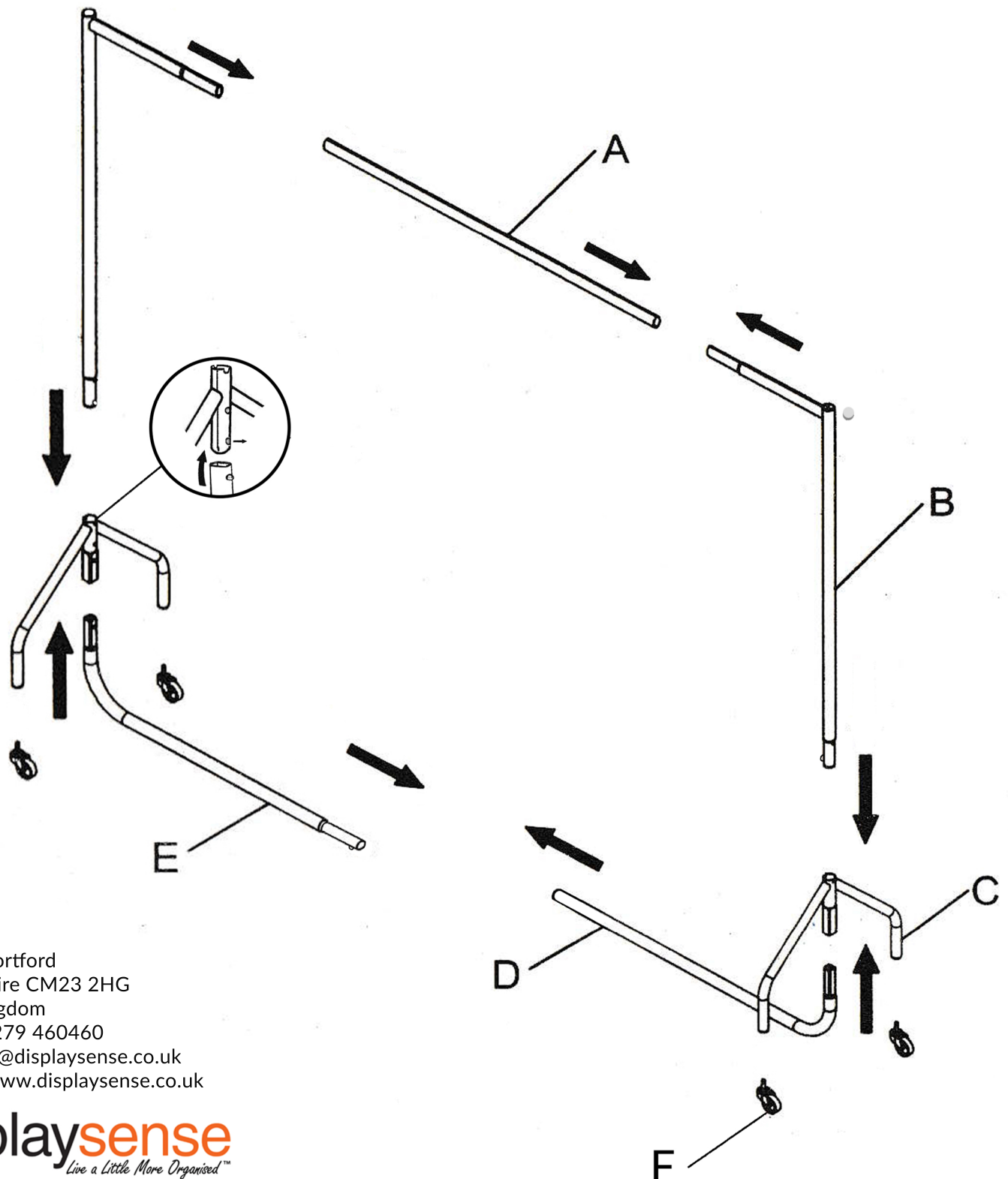

Rye Street
Bishops Stortford
Hertfordshire CM23 2HG
United Kingdom
Phone: 01279 460460
Email: help@displaysense.co.uk
Website: www.displaysense.co.uk

Displaysense
Live a Little More Organised™