

VIELIGHT
NeURO DUO
ALPHA
GAMMA

USER GUIDE
NEURO 4

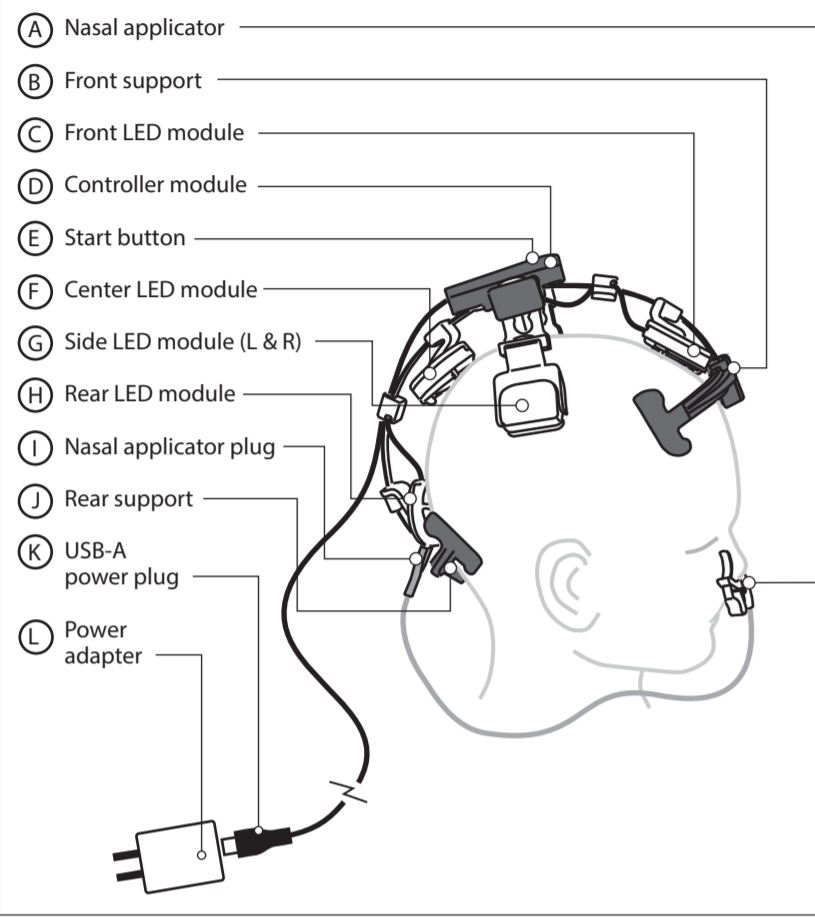

Recommendation: Usage of Vielight Neuro Alpha, Gamma, and Duo

The Neuro Duo has a selector switch [M] for Alpha and Gamma frequencies. The Neuro Alpha and Neuro Gamma are single frequency mode devices. We recommend users with a healthy brain to use the Alpha or Gamma frequencies once every two days for maintenance. Users looking to try to recover brain functions, should try the Alpha or the Gamma frequencies once daily for up to 6 days a week. To avoid over stimulation, always take a rest from using the device on the 7th day and avoid using the Gamma frequency close to bedtime. Reduce usage to once every 2 days when significant improvements are observed. Usage of the device should not exceed one session of up to and not exceeding 20 minutes per day. Everyone is different and can have different responses. If any discomfort is experienced, users should reduce the time of each session by shutting off the device before its 20-minute session is up, by reducing the number of days used per week, or by doing both.

NEURO DUO CONTROLLER

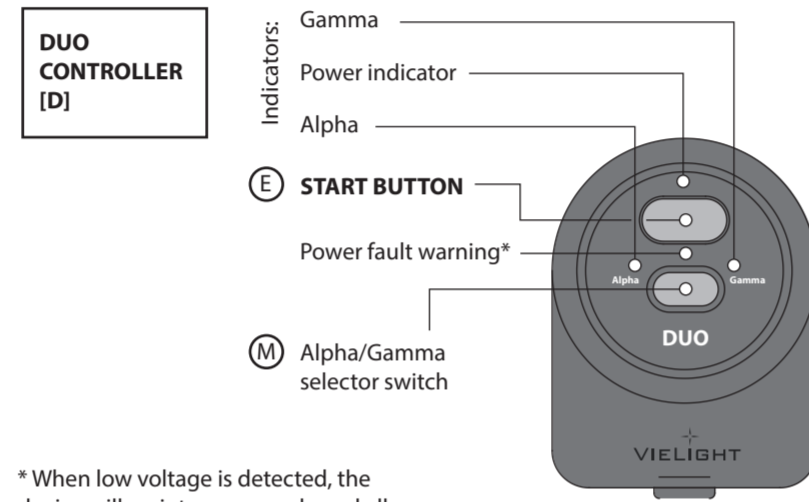

* When low voltage is detected, the device will go into error mode and all the LED modules will not function.

NEURO ALPHA/GAMMA CONTROLLER

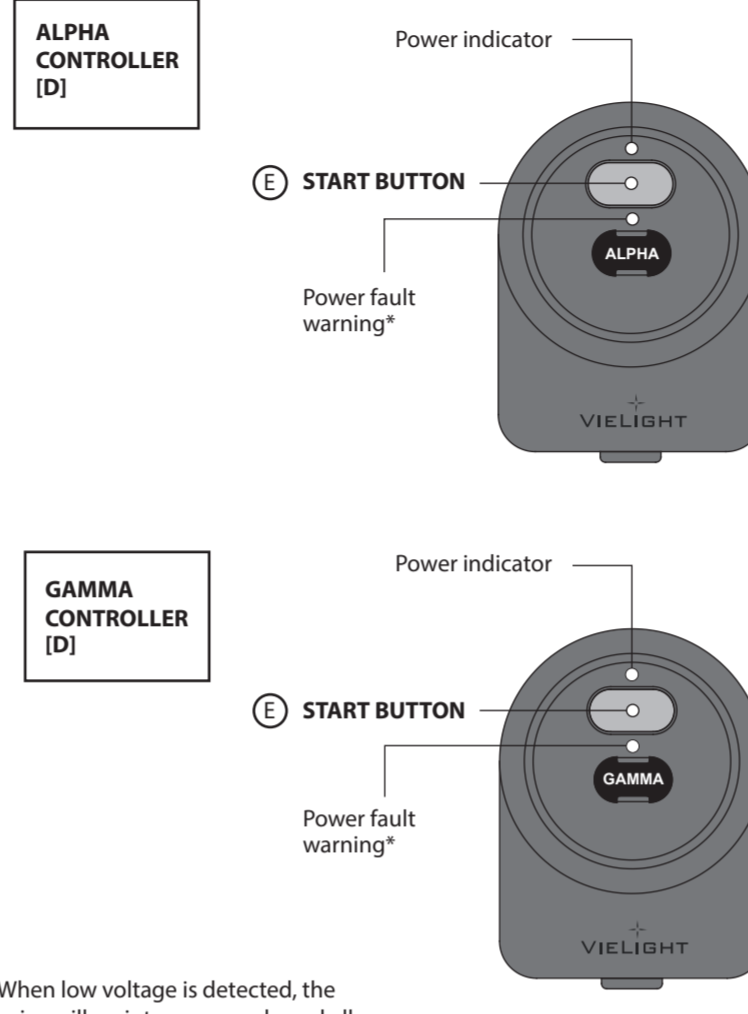

* When low voltage is detected, the device will go into error mode and all the LED modules will not function.

USING THE VIELIGHT NEURO

- 1 Insert the nasal applicator plug [I] into the rear LED module [H] as shown on page 1.
- 2 Insert the power plug [K] into the Vielight power adapter [L]. Connect the power adapter [L] into an electrical outlet.
- 3 Press the start button [E] to begin a session. The unit switches off automatically after about 20 minutes.
- 4 Place the headset on the head as shown on page 5.
 - Position the front headset module [C] at the mid point between the eye level and the apex of the head.
 - Position the center module [F] on the crown of the head.
 - Position the rear module [H] aligned with the mid-ear level.
 - Position the side modules [G] behind the apex.
- 5 Insert the nasal applicator [A] into either the right or left nostril with the clip on the exterior and the lens inside the nostril.

USING THE NASAL APPLICATOR

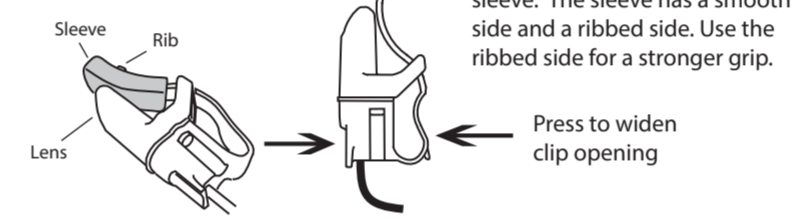

POSITIONING THE HEADSET MODULES

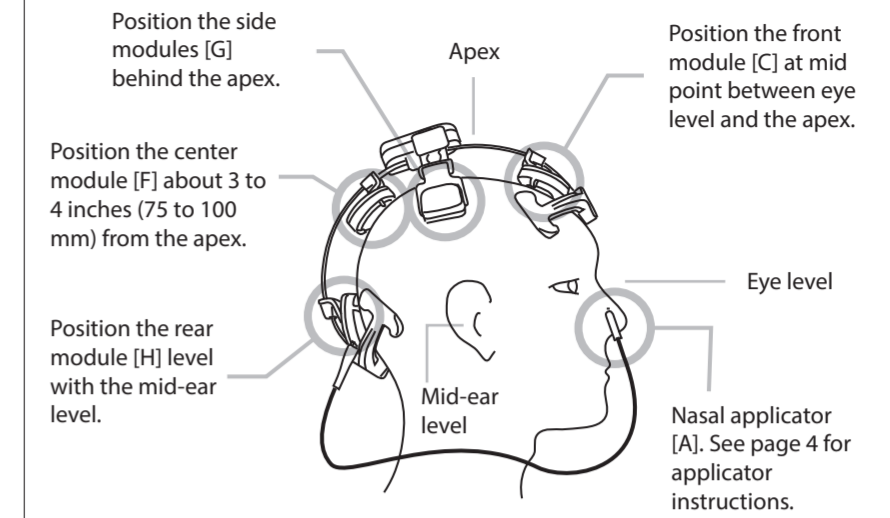

NOTE

When using the Vielight Neuro, users should not experience any adverse physical sensation. If you experience discomfort, contact Vielight at +1 877 355 8012 (North America), info@vielight.com, or chat at www.vielight.com.

CARE AND CLEANING

1. To clean the nasal applicator, wipe gently with 70% alcohol or antiseptic wipes, clean gently with soap and water, or sanitize with a UV lamp.
2. Use a soft, dry cloth to clean the other surfaces. Do not use abrasive cleaners.
3. Do not submerge any of the components on the headset in liquid or cover with other material during use.
4. Store in a dry and dust-free location at temperatures between 0° C to 40° C, away from direct sunlight.
5. We do not recommend sharing devices and nasal applicators as this increases the risk of spreading infectious diseases.

SAFETY ADVICE - INFRARED LIGHT SOURCE

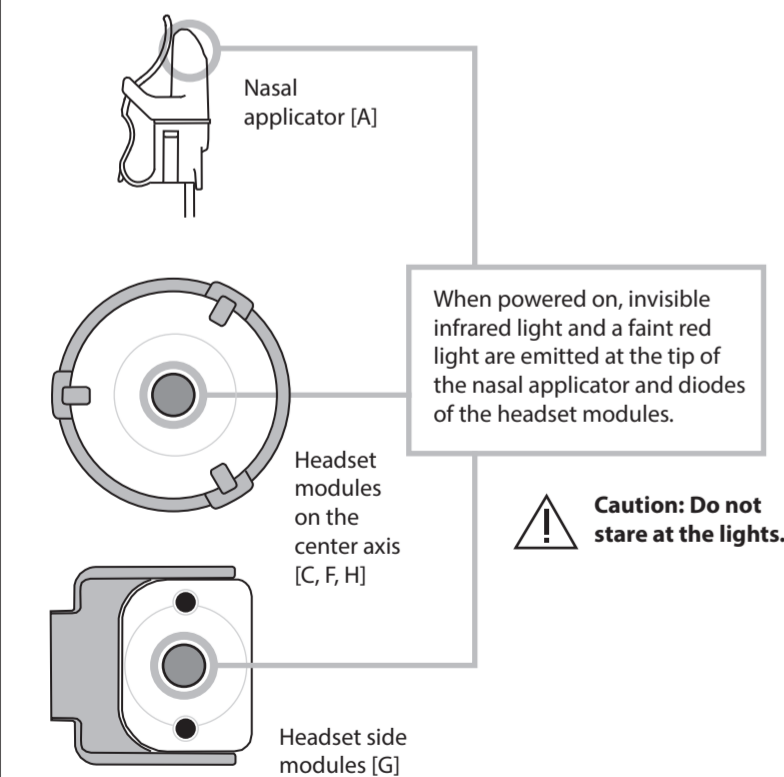

Most people do not experience physical discomfort while using the Neuro, although some feeling of warmth is expected.

TROUBLESHOOTING

Problem	Cause	Remedy
(A) There is no indication of life from the headset.	(1) There is no power input to the device. (2) There is no power from the mains. (3) The power adapter is faulty. (4) The headset is faulty.	Check that the power plug [K] is connected to the power adapter properly [L]. Check that the power adapter [L] is plugged to the mains and switched on. Connect the device to another mains power output. Replace the power adapter. If steps 1, 2, and 3 above are unsuccessful, please contact the manufacturer.
(B) A white or green light is present on the controller [D] but, there is no response when the start button is pressed.	(1) The headset is faulty.	Contact the manufacturer.
(C) There is no light output from one or more LED modules on the headset.	(1) The headset is faulty.	Contact the manufacturer.

(D) There is no light output from the nasal applicator.	(1) The nasal applicator is not plugged in properly.	Unplug the nasal applicator and plug it in again completely. If the applicator still does not work, please proceed with the steps (2) and/or (3) below.
	(2) The nasal applicator is faulty.	Visually inspect the nasal applicator. If there is severe damage to the cable, the plug, or the applicator head, contact the manufacturer. Plug in another nasal applicator (if available), and if it works, the first applicator is faulty. Please contact the manufacturer.
	(3) The headset is faulty.	Inspect the rear LED module [H] and the cable that is attached to it. If there is significant damage, contact the manufacturer. Plug in another nasal applicator (if available), and if it does not work, the headset is faulty. Please contact the manufacturer.
(E) LED modules cannot be moved to the desired locations on the head.	(1) Unfamiliarity with the device.	All headset LED modules have holders that can slide along the steel band. In addition, the side modules [G] can be moved up and down, and also swivel.

SPECIFICATIONS

LED Specifications:
Light source, LED module - center top, left, right: 810 nm LED (100 mW/cm² x 3)
Light source, LED module - front: 810 nm LED (75 mW/cm² x 1)
Light source, LED module - rear: 810 nm LED (20 mW/cm² x 1)
Light source, nasal applicator: 810 nm LED (25 mW/cm² x 1)
Pulse rate: 10 Hz (Alpha), 40 Hz (Gamma)
Phase A: front & nose modules. 50% duty cycle
Phase B: center top, left, right modules, rear module. 50% duty cycle
A and B are anti-phase

General Specifications:
Treatment duration: Automatic shut-off at 20 +/- 0.2 minutes
Low power indicator: Yes
Power adapter: AC Input: 100-240 V, 0.5 A, 50/60 Hz
DC Output: 5 V, 2.0 A

WARNING! IR emitted from this product may cause eye irritation. Do not stare at operating diodes for an extended amount of time.

CAUTION! Interference may occur in the vicinity of known radio frequency (RF) transmitting devices and equipment marked with the following symbol.

This device is operated non-continuously. The device usage needs to be separated by at least 6 hours between each treatment. Each treatment session takes 20 minutes.

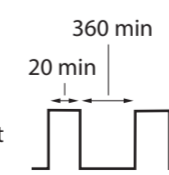

REF Neuro

Follow the instructions in the user guide.

Vielight Inc.
471 Jarvis Street
Toronto
ON M4Y 2G8
Canada

(North America) +1-877-355-8012
info@vielight.com

CISPR 32:2012/ EN 55032:2012
CISPR 24:2012/ EN 55024:2010

LIMITED TWO - YEAR WARRANTY

Your Vielight Neuro 4 is warranted to be free of defect in material and workmanship under normal use.

This warranty is limited to a period of two years from the purchase date. Within this period, repairs or exchanges of parts that are deemed necessary by the company will be made free of charge.

This warranty does not cover damage by the following:
a. Misuse, abuse or alteration to the product
b. Damage caused by accident or neglect
c. Service or repairs made by unauthorized persons

WE SHALL NOT BE RESPONSIBLE FOR ANY INCIDENTAL, SPECIAL, OR CONSEQUENTIAL DAMAGES RESULTING FROM THE USE OF THIS PRODUCT.

www.vielight.com

VIELIGHT
The Life Light

Neuro4DUOAG.060622.0

SIDE A

SIDE B