

Instructions for Use of Lydsto Handheld Dust Collector and Air Inflator

封面

封面背面空白

English 2-13
 Español 15-27
 Deutsch 29-41
 Français 42-55
 Polski 57-69
 Русский язык 71-83
 日本語 85-97
 한국어 99-111
 عربي 113-125

Notes

Read these Instructions carefully before use and properly keep these Instructions. The body and the air pipe will become hot after long use. Use again after they are cooled. Remember to clean the dust box after dust collection to prevent product damage. Do not allow children to use this product as it is not a toy.

Product introduction

- ① Display screen
- ② Touch button
- ③ Battery capacity indicator
- ④ Charging interface
- ⑤ Air pipe interface
- ⑥ Inflator/collector switch
- ⑦ Collector level switch button
- ⑧ Dust box cover flipping button
- ⑨ Suction nozzle
- ⑩ Dust cover

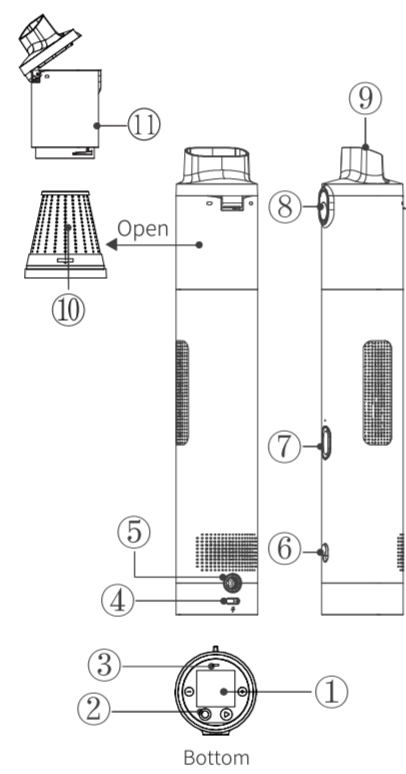

List of Accessories

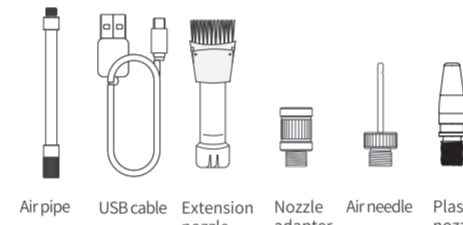

User Guide

I. Battery Capacity Display and Charging

Battery capacity display

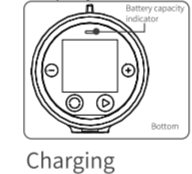

The capacity indicator is always on with different colors to indicate the remaining capacity:
 Green: battery capacity ≥ 50%
 Orange: 20% ≤ battery capacity < 50%
 Red: battery capacity < 20%, charging needed

Charging

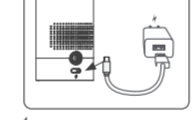

Fully charge the battery before first use. Connect the USB cable between a 5V USB charger (to be separately purchased) and this product to charge. During charging, the capacity indicator displays the following colors to indicate different states:
 Consistently red: charging
 Consistently green: fully charged

II. How to Use the Accessories

How to use the air pipe

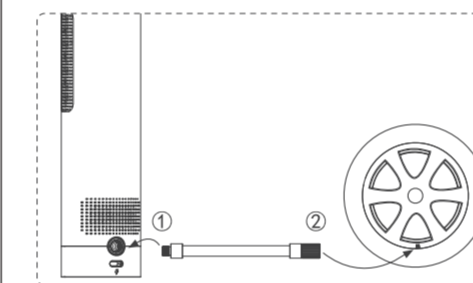

- ① Screw the external thread of the air pipe into the interface on the air pump
- ② Screw the inner thread of the air pipe into the air inlet on the tire

How to use the extension nozzle

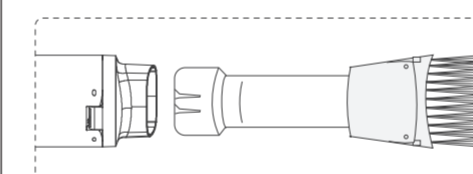

Directly insert the extension nozzle and fix it. Then it can be used.

III. How to Electrically Preset Values

Mode Switch

- Press the "Mode Button" to switch among the following five scenarios. Correctly select the air pressure before inflation. Press down and hold the "Mode Switch" to switch among KPa, PSI and Bar.
- No mode indicator is on: freely adjustable; default value at 240KPa Range of adjustment: 20-990KPa, 3-150PSI, 0.2-10.3Bar
- Ball mode indicator is on: default value at 8PSI Range of adjustment: 4-16PSI
- Bicycle mode indicator is on: default value at 45PSI Range of adjustment: 30-65 PSI
- Motorcycle mode indicator is on: default value at 2.4Bar Range of adjustment: 1.8-3.0Bar
- Car mode indicator on: default value at 2.5 Bar Range of adjustment: 1.8-3.5 Bar

Fine adjustment of the preset value

- After selection of a scenario, press "+" or "-" to adjust the preset value. Press down and hold "+" or "-" to rapidly adjust the pressure value.
- During adjustment of the preset value, if the value is flashing, the target pressure value is being adjusted; if the value is consistently on, it represents the current pressure value.
- Inflation start button.

IV. Inflation

Start air inflation
 Select the Inflation mode (push the switch towards left)

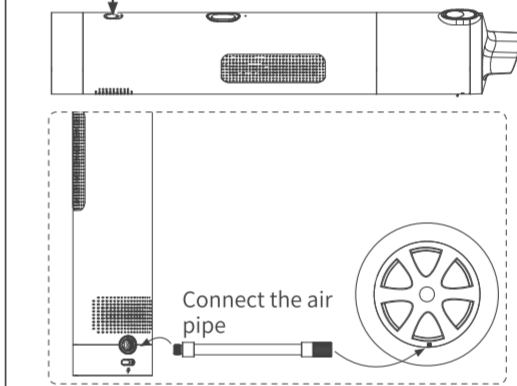

- ① Select air inflation or dust collection (select the air inflation).
- ② Select scenario of air inflation: The tire pressure can be preset depending on the desired pressure.
- ③ Connect the air pipe (as shown in Figure 1).
- ④ Press twice to start air inflation.
- ⑤ Air inflation stops when the pressure reaches the preset value.

目录

V. Dust Collection

Start dust collection

- ① The user may select the level and accessories depending on the demands (see Figure 2).
- ② Select inflation or dust collection (select dust collection). Press the level button once to automatically select dust collection function.

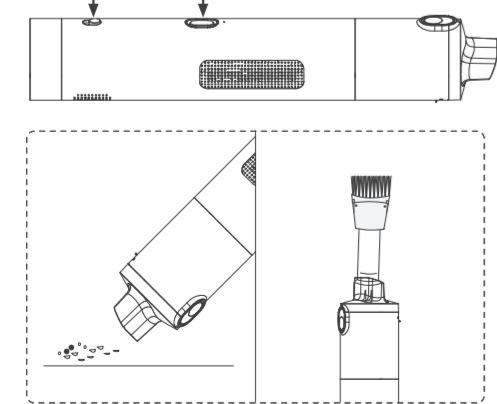
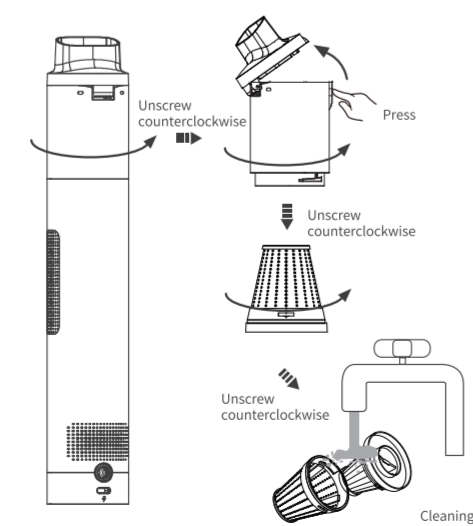

Figure 2

VI. Cleaning

Clean the dust box



- Notes: ① Only the dust box can be cleaned.
 ② Other parts than the dust box must be kept away from water sources.
 ③ The dust cover may be used only after dried. Otherwise dust filtration will be affected.

Technical Parameters

Product name	Lydsto handheld dust collector and air inflator
Product model	HD-SCXCQ02
Standard basis	Q/YM J02001-2020
Rated voltage	5V=
Rated current	2A
Product size	315x54x54mm (bare machine excluding accessories)
Net weight	560g
Range of inflation pressure	3~120PSI
Operating temperature	-10°C~45°C
Charging interface	Type-C
Battery capacity	2500mAh (18.5Wh)
Time of charging	3~5h (maximum charging current: 2A)
Operating noise	Below 90 dB at 1 m away
Air inflation speed	112 min (195/65 R15 tire, 0-35PSI)
Maximum suction pressure	7KPa

Considerations

1. This product is not a toy. Do not allow children to use. Users no younger than 15 years old are suggested. Keep children a safe distance away from this product during inflation.
2. This product is integrated with a lithium battery. Do not throw this product into fire or randomly. The lithium battery may ignite, spontaneously combust or explode due to overheat, impact and water penetration. Please avoid exposure to the sun in vehicles and other high temperature environments.
3. Do not store this product under any temperature below -10°C or above 45°C. Otherwise, the service life of this product will be shortened and the inner battery will be damaged.
4. The inner battery may be damaged if this product is not used for a long time. It is suggested to charge this product at least every three months.
5. This product is integrated with a DC motor which may generate electric sparks during use. Therefore, do not use this product in flammable and explosive environment.
6. Do not use this product for 35 consecutive minutes. It is suggested to turn down this product for 20 minutes every 35 minutes of use. Immediately shut down this product in case of any abnormal noise or overheat during use.
7. Check that the selected measurement unit is correct before setting the inflation pressure. Otherwise the tire burst and other accidents may occur. Conversion between common units is shown below: 1Bar = 14.5 PSI 1bar=100KPa
8. Do not leave this product and observe during inflation to prevent high inflation pressure when there is no preset pressure value.
9. Use this product in a dry and clean environment, because ingress of soil and dust may damage this product. This product is not water proof. Therefore, do not rinse it with water (only the dust box can be washed).
10. Timely wash the dust box after dust collection. The box is suggested to be reinstalled after it is dried.

Troubleshooting

Fault	Solution
The air flow is low.	1. Check if the battery capacity is sufficient. 2. Check if the air pipe is airtight. 3. Check if the air pipe is tightened at both ends. 4. Check if the inflated object is airtight.
This product cannot perform the air inflation function after powered on.	1. Check if the air pipe is well connected. 2. Check if the battery capacity is sufficient. 3. Check if the current tire pressure is higher than the preset value.
The preset pressure value cannot be increased or decreased.	Check if the scenario selected is incorrect. In the Free Mode where no indicator is on, the preset value can be adjusted between 3 psi and 150 PSI.
This product normally perform the air inflation function, but the displayed pressure is zero.	Pressure of balloons and other low-pressure products is not within the measuring range of this product.
Color of the power indicator during inflation is inconsistent with that in the standby state.	The lithium power battery will undergo obvious voltage drop during discharging, causing color of the power indicator during inflation inconsistent with that in the standby state. This is not a fault.
This product cannot collect or sufficiently collect dust.	1. Check if the battery capacity is sufficient. 2. Check if the suction nozzle is well fixed. 3. Check if the filter screen is clogged.

Information about guarantee

The after-sales three-guarantee service is implemented for the Lydsto Handheld Dust Collector and Air Inflator products strictly in accordance with the Law of the People's Republic of China on the protection of consumers' rights and interests and the Law of the People's Republic of China on product quality. The service contents are as follows:
 1. Within 7 days from the day after you sign for the product, if the product has the performance fault, and the fault is tested and determined by after-sales service center, you can enjoy the service of returning or changing goods free of charge;
 2. Within 8-15 days from the day after you sign for the product, if the product has the performance fault, and the fault is tested and determined by after-sales service center, you can enjoy the service of changing goods or repair free of charge;
 3. Within 12 months from the day after you sign for the product, if the product has the performance fault, and the fault is tested and determined by after-sales service center, you can enjoy the repair service free of charge.

Non-warranty regulations

1. Unauthorized repair, misuse, bump, negligence, abuse, liquid entry, accident, alteration, incorrect use of accessories of the product, or tearing up or altering labels;
2. The validity period of the three-guarantee service has been exceeded;
3. Damage caused by force majeure;
4. The product and its accessories have performance faults due to human factors.

Manufacturer:Guangdong Yimu Technology Co., Ltd.
 Address:Room 904, No.419, Jiming Road, Liaobu Town, Dongguan City, Guangdong Province, P.R. China
 Service hotline: +86 4000778387

