

Luggable XL STEM Kit

Assembly videos: <https://www.youtube.com/@cleanairkits>



ELECTRICAL



B DC to 7 Fan Sockets Harness



C 12V 2A UL Power Adapter



D Seven SickleFlow 120mm Fans

COMPONENTS



Two 25x7" Panels



Two 20x7" Side Panels

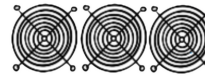

7 Fan Grills



28 Fan Push Pins



Steel Wire (taped to box)

TOOLS



Scissors



Butter or Putty knife



Zip Ties



3M Filtrete 20x25" MPR 1900 or 2200 (Sold Separately)

INSTRUCTIONS

1) Orient the grills in a symmetric pattern (popping outward) and insert push pins. If hard to press, place grill-side down on table and push back of panel around pin(s).

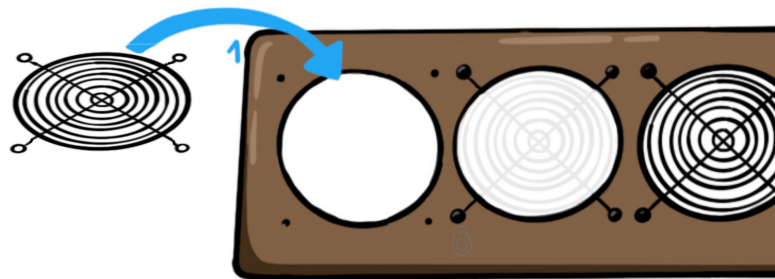

Leave grill-side down for step 2)

2) Fan specs should face grills while pretty hubcap stickers face inside of box. Wires should exit a consistent side. Firmly push fan frames onto pins. Flip over and press pins w/ blunt end wood handle as necessary to seat without gaps to panel.

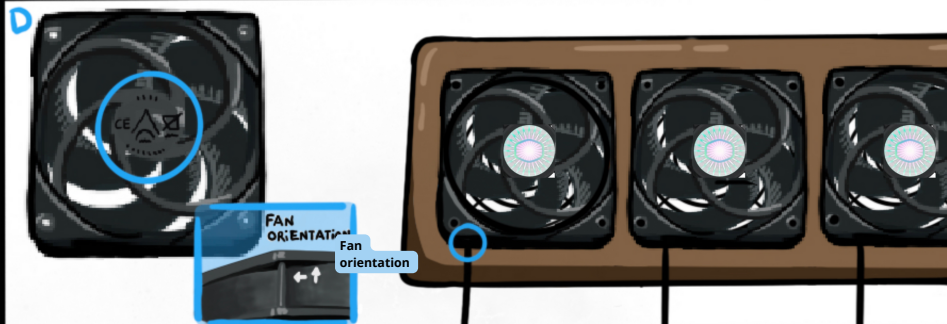

3) Slide panels firmly into slotted panel connectors. Squeeze from opposite ends to seat all the way.

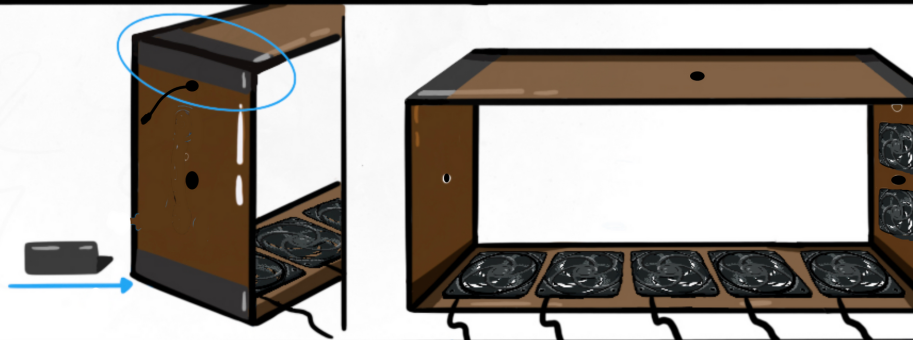

4) Insert retainer clips into panel centers with holes on the side. Hook the tension wire between the tension clips on opposite short sides. Then hook bungee cord from clip at center of long bottom to one of the backside fan screw holes.

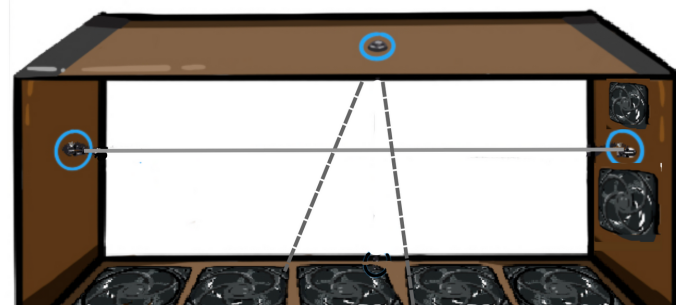

5) Fan harness comes pre-attached to a side panel thru strain-relief grommet. Starting with fan closest to grommet hole, plug 7 pwm fan cables into 7 harness sockets.

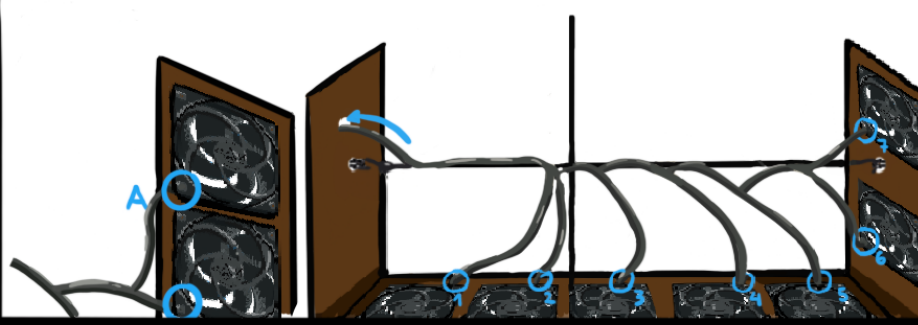

6) Secure the fan harness and cables along the central tension wire with zip ties. Pull any wire excess away from fans & tie toward tension wire.

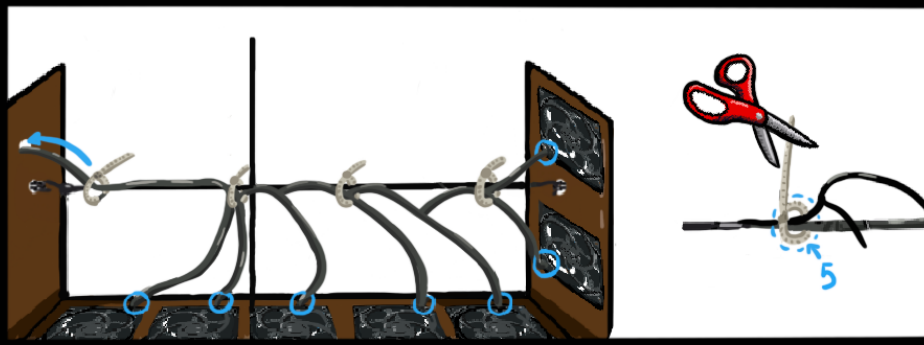

7) Connect the DC barrel plug to the USBC adapter and plug charger brick in to wall for test. All fans should run without hitting any wires or obstructions.

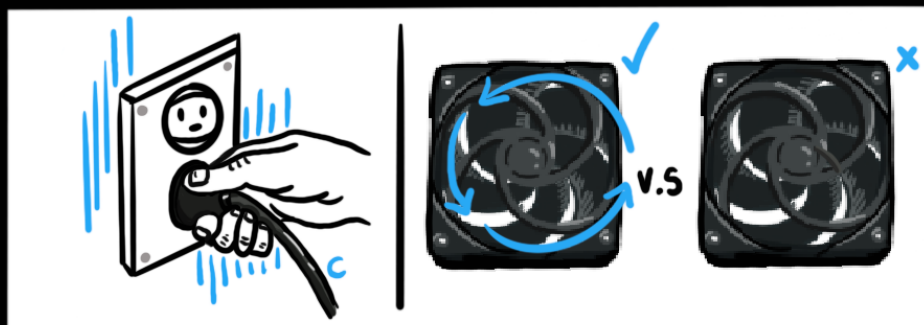

8) Disconnect power. Apply foam tape along insides of short panels only, corner to corner. Push filters in with arrows pointing in. Insert putty knife between to pry any filter or foam edges that catch.

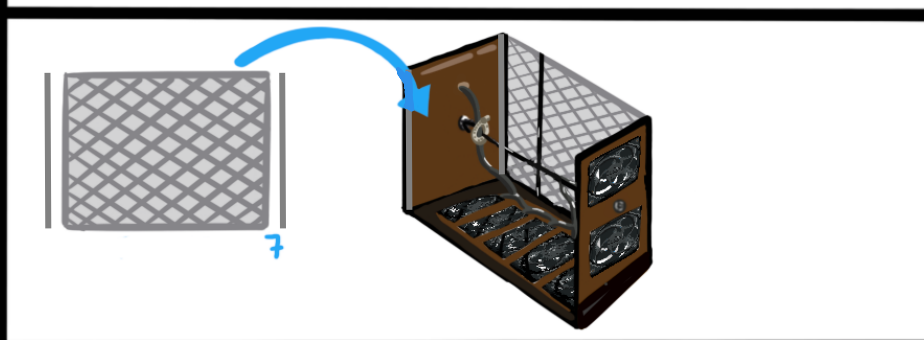

9) **FINAL INSPECTION.** Inspect carefully from all sides. Tighten push pins, panel connectors & bungees. Check filter seal for long light gaps. Reconnect Power.

Place fan & filter sides at least 2" from walls, preferably 12" for full performance!

