

TL1105  
TL1106  
TL1107

# TABLE LOOM FLOOR STAND

## ASSEMBLY



Find out more at [schachtspindle.com](http://schachtspindle.com)  
Schacht Spindle Company 6101 Ben Place Boulder, CO 80301  
303.442.3212

© 2021 Schacht Spindle Company, Inc.

09.21

# TABLE LOOM FLOOR STAND

## ASSEMBLY

### HARDWARE

- 2X metal support bars
- 2X 10-24 x 1-1/4" carriage bolts
- 2X 10-24 lock nuts
- 2X #12 SAE washers
- 2X 1/4-20 x 1-1/2" carriage bolts
- 2X 1/4-20 washer wing nuts
- 2X 1/4-20 x 3" Phillips truss head machine screws
- 2X 1/4-20 x 2" Phillips truss head machine screws
- 4X 1/4-20 barrel nuts

### PARTS

- 2X cross braces
- 2X inside legs with attached blocks
- 2X outside legs
- 1X wooden drill guide (for older looms only)

### TOOLS NEEDED

- slotted (flat) screwdriver
- #2 Phillips screwdriver
- 3/8" wrench
- 7/16" wrench
- drill and 5/16" drill bit (older looms only)



Phillips truss head machine screw



lock nut



washer

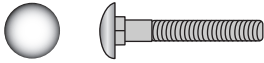
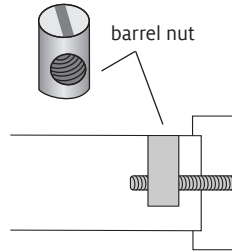

carriage bolt

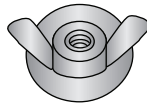

washer wing nut

1. Place the two cross braces horizontally in front of you, with holes facing up.
2. Identify the two inside legs with the blocks attached, and set these parts perpendicular to the cross braces. The blocks should be at the top, facing outward.
3. Attach the lower cross brace: Insert a barrel nut into each hole of one of the cross braces. Insert a 1/4-20 x 2" Phillips truss head machine screw through the bottom hole of an inside leg and tighten into the barrel nut in the lower cross brace (Figure 1). Repeat for the other inside leg.

4. Attach the upper cross brace: Place the outside legs, with pins facing up, on the outer side of the inside legs. Insert a barrel nut into each hole of the second cross brace. Insert a 1/4-20 x 3" Phillips truss head machine screw through the bottom hole of the outside leg, then through the middle hole of the inside leg. Fasten the machine screw into the barrel nut in the upper cross brace (Figure 1). Repeat with the other outside leg.
5. Attach the metal support bars: Insert a 10-24 x 1-1/4" carriage bolt through the square hole in the metal support bar. Orient the support bar as shown in Figure 2, with its jog pointing inward toward the front of the loom,

then from the outer side of the stand, insert the carriage bolt through the top hole in an outside leg. Then place a #12 SAE washer on the carriage bolt and secure the bolt with a 10-24 lock nut.

**6.** From the inner side of the stand, insert a 1/4-20 x 1-1/2" carriage bolt through the top hole of the inside leg. From the outside of the stand, place the round hole in the metal support bar on the carriage bolt. Secure the carriage bolt

with the washer wing nut and tighten by hand. Now go back to the lock nut attached in Step 5 and tighten it as much as possible.

**7.** Repeat steps 5 and 6 for the other side of the stand and the remaining metal support bar.

**8.** Tighten all the bolts. Place the loom on the stand by lining up the pins on the top of the stand in the four holes on the bottom of the loom.

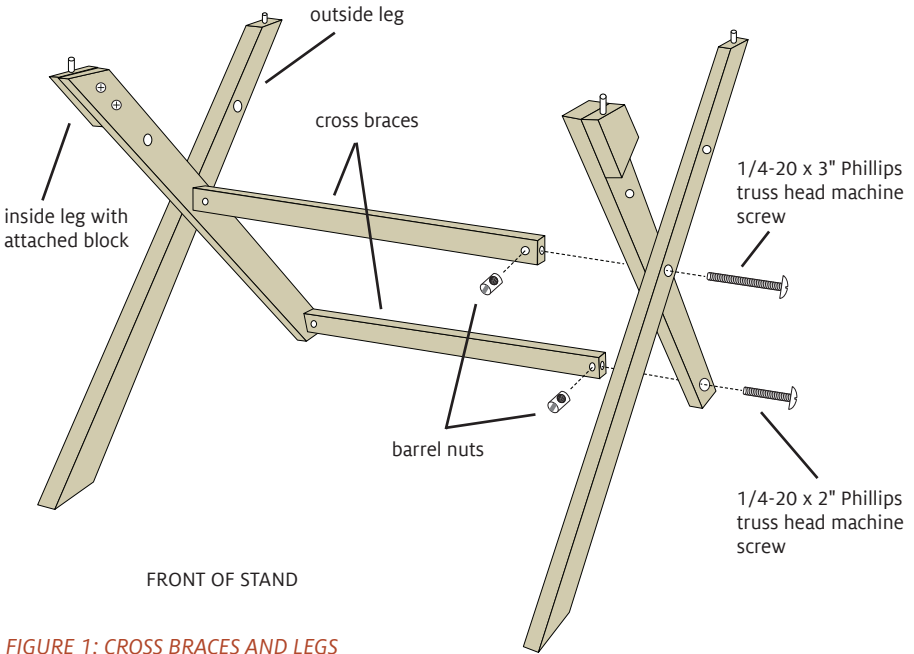

**FIGURE 1: CROSS BRACES AND LEGS**

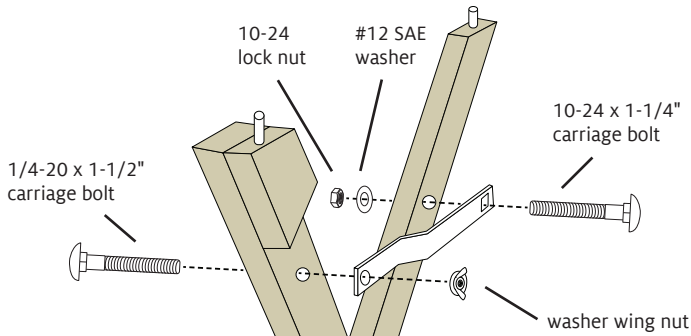

**FIGURE 2: METAL SUPPORT BARS**

## RETROFITTING AN OLDER TABLE LOOM FOR THE FLOOR STAND

If you have an older model table loom without holes in the underside of the base, you need to drill holes in your loom as follows:

1. Remove the castle from the loom. Place the loom upside down on a firm surface.
2. Drill four holes into the loom sides using a 5/16" drill bit and the wooden drill guide provided. Align the guide

firmly against the inside of the table loom leg. Drill each hole to a depth of 3/4".

3. The drill guide has an A and a B end (Figure 3). For a 4-shaft loom, use end A only (Figure 4).

4. The 8-shaft loom has a larger frame, so the holes at the rear of the loom are farther from the back legs. Use end A for the holes at the front of the 8-shaft loom and B for the holes at the rear of the 8-shaft loom (Figure 5). ■

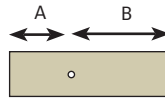

FIGURE 3: DRILL GUIDE

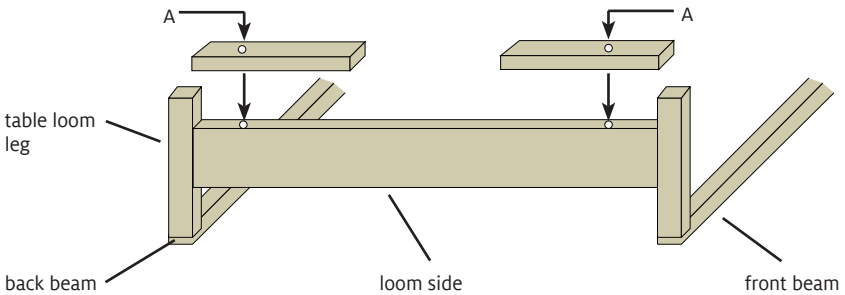

FIGURE 4: 4-SHAFT TABLE LOOM BASE, UPSIDE DOWN WITH CASTLE REMOVED

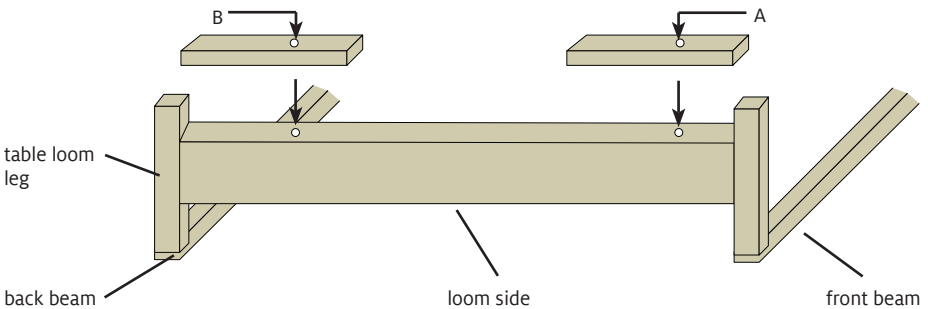

FIGURE 5: 8-SHAFT TABLE LOOM BASE, UPSIDE DOWN WITH CASTLE REMOVED