

# A DOZEN RED

Designed and woven by Judy Pagels



Besides a box of chocolates, what is the quintessential Valentine's Day gift? Having been a floral designer for 11 years (and counting), I can say that the definitive answer is red roses! This is my offering of the same, created with Zoom Loom squares. Make your own, one or a dozen!

Most roses have names so mine will be called Colorado Red. This is the colorway of the yarn I used from Neota Designs, a 50% wool, 50% silk blend. This rich, complex red competes with the loveliest of the fresh varieties.

Each rose uses two squares. I fulled half of the squares to make them smaller for the inside of the rose.

## EQUIPMENT & MATERIALS

- Zoom Loom
- tapestry needle
- yarn for weaving squares and assembling roses
- flocked floral wire
- paper-wrapped floral wire
- green floral tape
- artificial leaves
- green fiber & needle felting tools (optional)



Find out more at [schachtspindle.com](http://schachtspindle.com)  
Schacht Spindle Company 6101 Ben Place Boulder, CO 80301  
p. 303.442.3212

© 2022 Schacht Spindle Company, Inc.

## WEAVING

Weave two squares for each rose that you want to make. Full one square per rose for the inner petals: Soak or rinse in cold water, then hot water. Repeat until the square shrinks slightly.

## ASSEMBLY

1. Fold the smaller square in half. Tack at the folded edge about 1/4" from the side with tapestry needle and yarn.
2. Roll the folded square like a jelly roll. You can line up the folded edge of the roll, or you can stagger it so the inner petals stand up higher than the outer ones. Tack the outermost layer near the folded edge to keep the inner petals together.

3. Fold the larger square so that the bottom layer sits about 1/8" higher than the top layer. Loosely tack the square onto the inner petals. Wind the larger square around the inner petals, adjusting placement to make the best-looking bloom. Again, you can line up the folded edges or stagger them.

4. When you like the look of your rose, tack through all layers near the folded edges. Make sure to catch all the layers so the petals don't unroll. Then wrap the yarn near the bottom of the petals and tighten to draw in the flower's base and flare out the petals. Secure the yarn with a knot and cut off the tail. With a new length of yarn, make a few stitches below the yarn wrap to draw in the base even more.

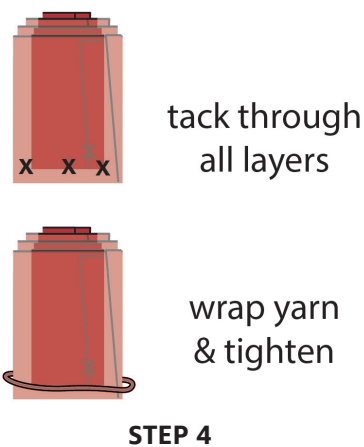
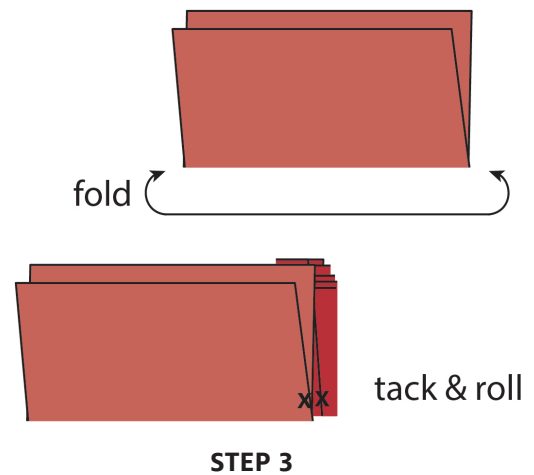
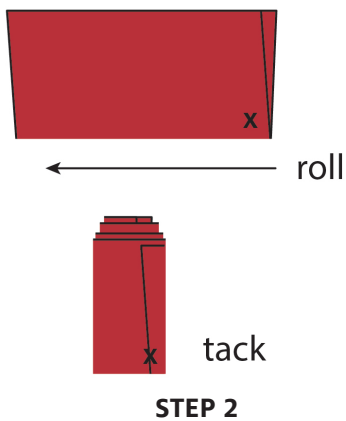
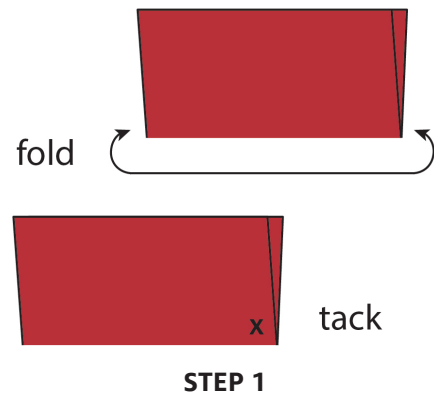
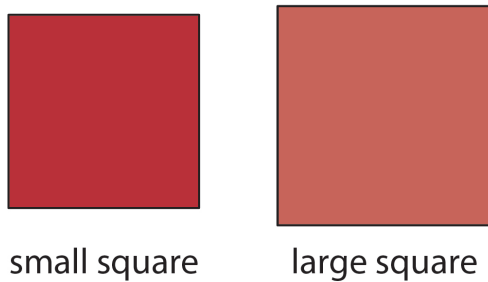

**5.** To attach a stem, thread flocked floral wire on a needle, then poke the needle and wire through the base of the rose, close to the yarn wrap. The flocked floral wire will now stick out on either side of the rose. Cut a length of paper-wrapped floral wire for the stem and poke it into the bottom of the rose. (If necessary, punch the tapestry needle into the bottom to make a hole for the stem.) Twist the flocked wire around the paper-wrapped wire to secure the stem.

**6.** A good floral designer always hides the mechanics! To complete the rose, add artificial leaves and wrap the entire stem with floral tape. I cut strips of green silk fabric into strips, tied them around the stem, and then trimmed the ends into leaves. I also wrapped the base of the bloom with green fiber and needle-felted the fiber into the squares. You could also wrap the base with floral tape or green ribbon. Enjoy a bouquet that will never wither!

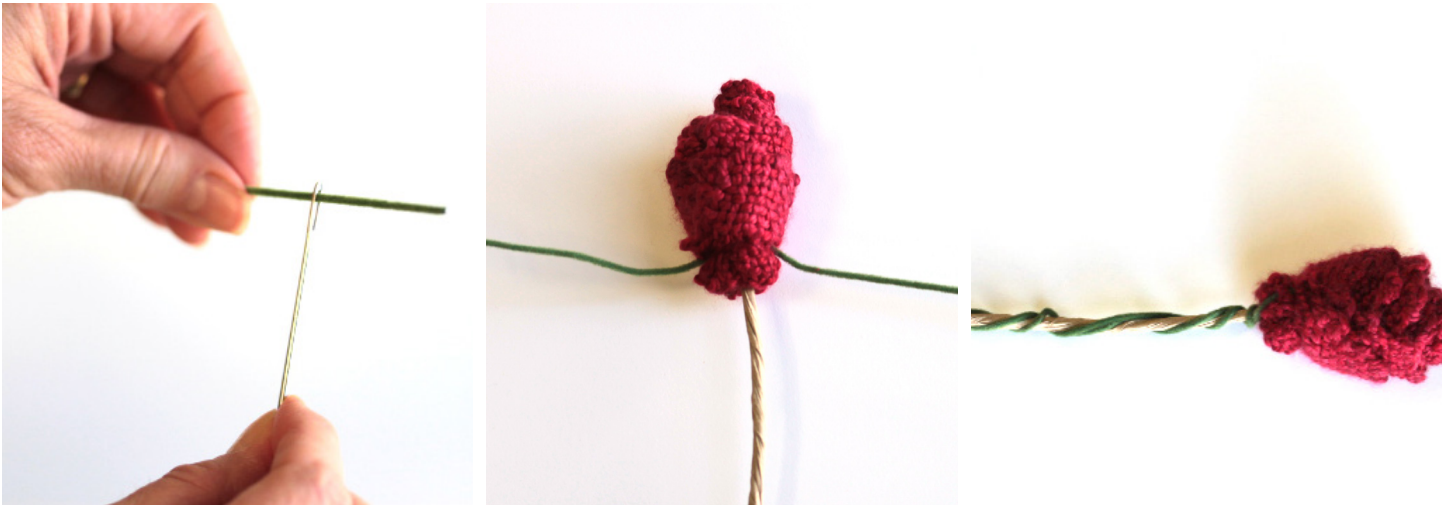

**STEP 5**



**STEP 6**