

INSTALLATION OF OPTIONAL EXTENSION 186-00

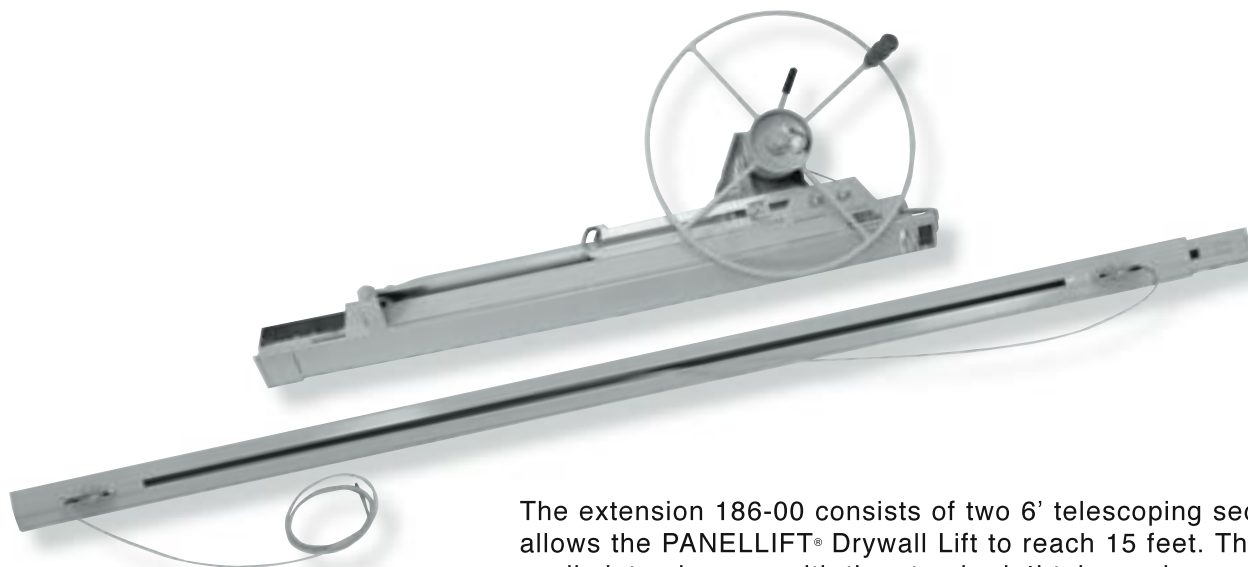

▲ WARNING ▲

The 186-00 extension is designed **ONLY** for use in the PANELLIFT® Model 138-2 frame. **DO NOT** install the 186-00 extension in the PANELLIFT® Model 182 frame or any other brand of drywall lift. Installing the 186-00 extension in any drywall lift frame other than the PANELLIFT® Model 138-2 can subject the assembly to stresses and loads that it was not designed to carry. This can result in failure of the unit possibly resulting in serious property damage and/or serious bodily injury.



The extension 186-00 consists of two 6' telescoping sections and allows the PANELLIFT® Drywall Lift to reach 15 feet. This unit easily interchanges with the standard 4' telescoping sections of the PANELLIFT® Model 138-2 shown here for comparison.

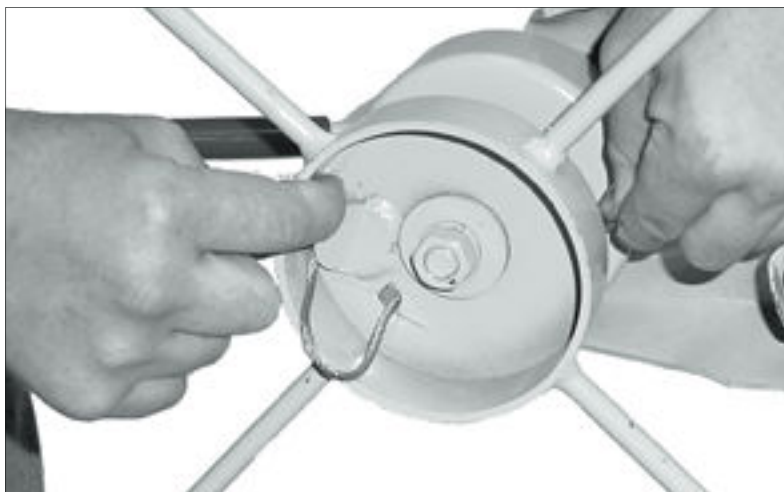

1. Loosen the cable from the mooring tab on the winch and pull it out from the winch drum. **BE CAREFUL!** A worn cable can have frayed strands. Wearing gloves will help protect your hands.

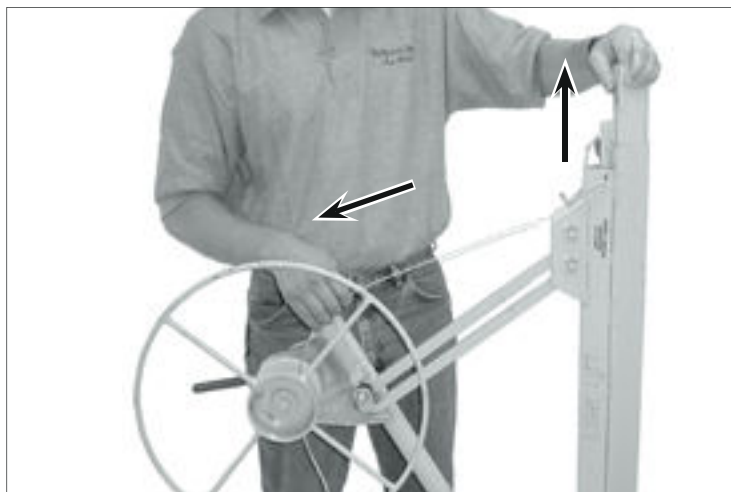

2. Pinch the two telescoping sections together and lift them out as a unit. Pulling the cable will help to raise them.

INSTALLATION OF EXTENSION 186-00



3. Remove the two telescoping sections completely from the frame housing. Pull the cable completely out from the frame along with them. BE CAREFUL for loose strands or frays on the cable.

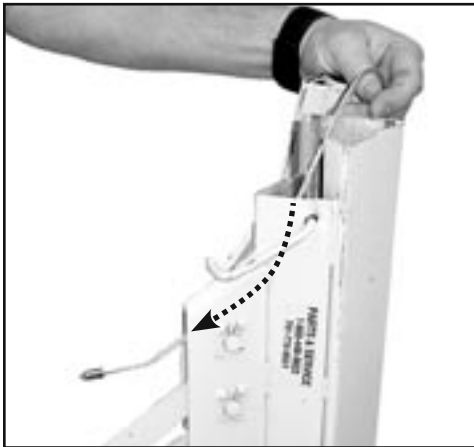

4. Feed the crimped end of the 186-00 cable through the frame sheave pocket from the top. It is VERY IMPORTANT that the cable passes OVER THE TOP of the cable sheave as shown here.



Front View

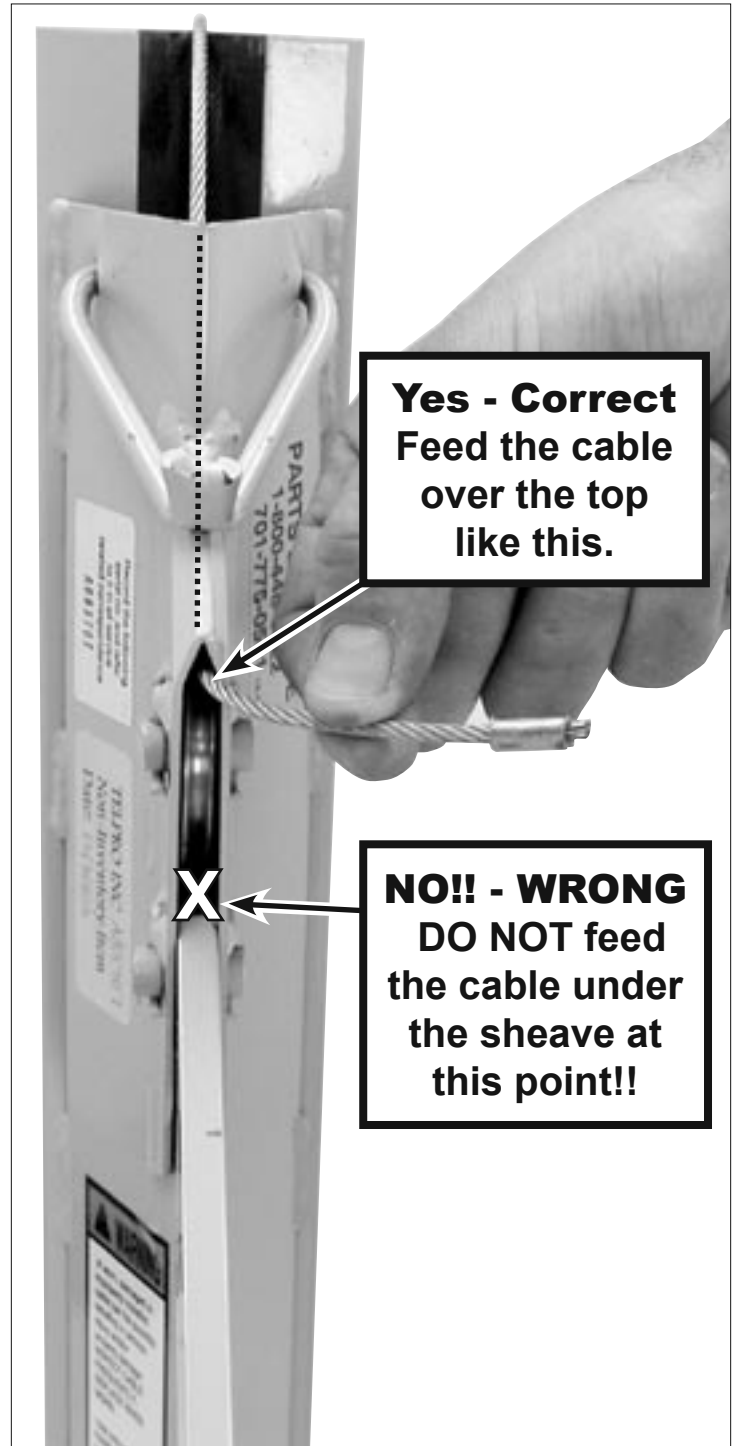

Yes - Correct
Feed the cable
over the top
like this.

NO!! - WRONG
DO NOT feed
the cable under
the sheave at
this point!!

5. MAKE SURE that the cable feeds over the TOP of the cable sheave as shown in the above photo.

⚠ WARNING ⚠

The cable **MUST** feed down from the top of the frame housing and over the top of the sheave exactly as shown in steps 4 - 5 in order to function properly. Failure to install the cable correctly as shown can cause wearing of the cable for which it is not designed which can result in failure of the cable. Failure of the cable while the lift is raised will result in a sudden and rapid lowering of the lift and the load possibly resulting in serious property damage and / or serious personal bodily injury.



DO NOT feed the cable under the cable sheave on the frame as shown in this photo!



6. Pull the slack cable through the sheave pocket and slide the telescoping sections into the frame housing.

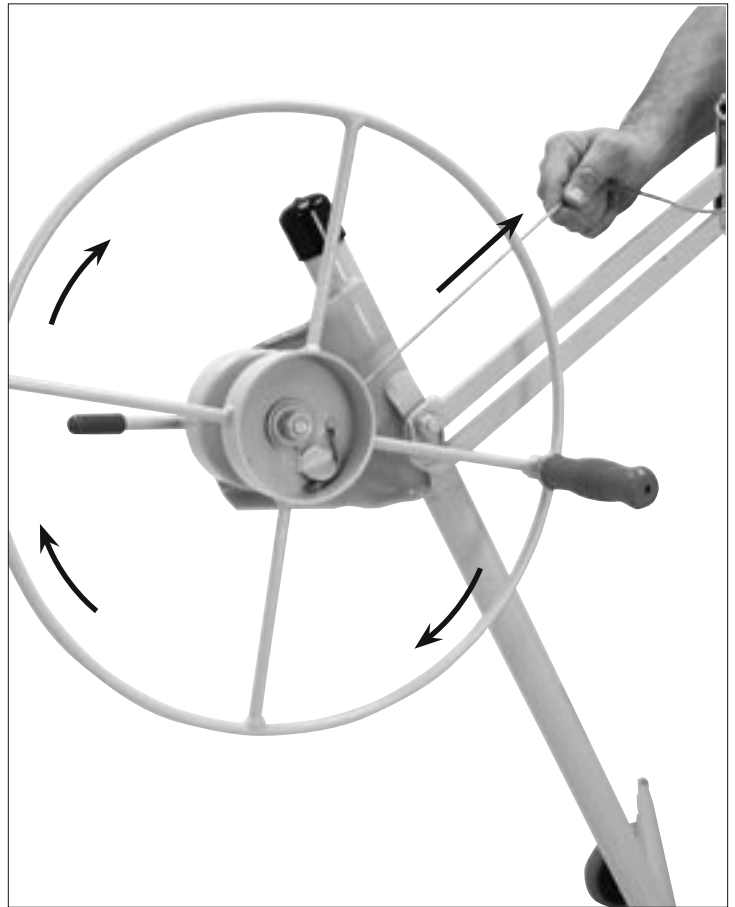

7. Feed the cable through the winch drum and secure it firmly behind the mooring tab as shown. Rotate the winch wheel in the direction indicated to take up the slack in the cable.