

# Sediment Filter

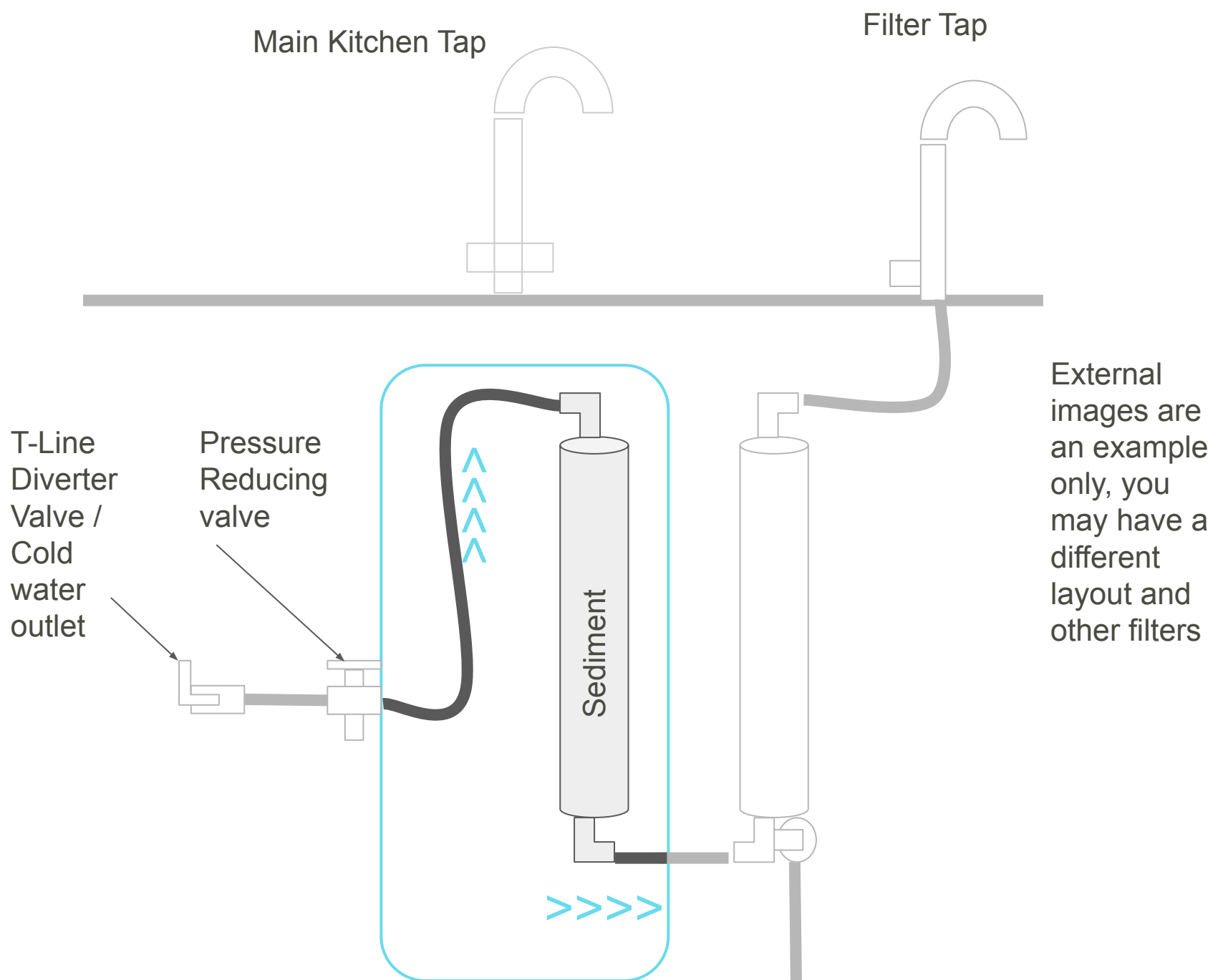

The sediment filter will always be the most upstream filter in your system. Here is an example of where you might position the sediment filter under your sink.

**Do you prefer video Instruction ?**

Scan Code for a brief video on how to insert/remove tube from john guest fittings



**Do you prefer video Instruction ?**

Scan Code for a brief video on how to cut the tubing



## Sediment Filter

**Working Pressure:** 15 – 60 PSI

Please note: the pressure reducing valve needs to be installed for higher water pressures than 55PSI.

**Working Temperature:** 5 – 40°C

Wall brackets are provided for mounting of the System and cartridge to the cupboard wall.

**Waterflow speed:** Tune T-line valve so water flow is approx 2 l/min

**Connecting and disconnecting tubing:**

- To connect tubing; push tubing approx ~ 20 mm into the connector.
- To remove tubing; hold the O-ring back and pull the tubing out of connector.

**“Sediment”** Could be anything, but basically it’s particles in the water. It’s good to remove as much of this as possible with a simple filter to reduce the amount of work the more expensive filters downstream need to do.

**Please note: Professional installation is recommended. Ionza is not responsible for any damage resulting from incorrect installation.**

For more information please refer to the specific product page on our website [www.ionza.co.nz](http://www.ionza.co.nz)