

Hydrogen Water Jug User Manual



User Manual

Please review the safety precautions below carefully to ensure the proper performance of this product and your safety

To safely and correctly use this product, please read the following tips:

- Keep the Jug in a shaded area, away from direct sunlight
- Only put H₂O inside the Jug
- Hand Wash only with warm soapy water, never use bleach or abrasives to clean this Jug
- This is an electronic device, so use dry hands when using it, and keep the base of the jug dry. If you sit the base of the jug in water then dry it off immediately.
- It's good practice to wipe the base dry before charging it, this will help keep it dry and clean.
- Make sure the Jug is plugged in properly, do not mess with the cord, meaning, don't tie it, stretch it, twist it etc while in use
- Drink the water straight after its been generated to obtain the most benefits. Keep in mind that compared to standard Tap water, hydrogen can more easily breed Bacteria.
- Be careful with the device, keep it out of reach of small children and do not drop it.
- Keep the device out of the freezer and microwave
- Clean the pitcher and Cartridge before first use and after 10 cycles. If there is fewer bubble than usual generated when the machine operates, there could be dirt built up at the electrodes. It can be cleaned by taking out the filter in the machine and then pouring in 300ml of edible vinegar. After two hours, shake it for two minutes, then pour out the vinegar and wash it with clean water.

Instructions

Starting Fresh: Open the pitcher's lid and rinse it thoroughly with cool water. Be careful not to wet the electrical connector at the bottom. Remove the filter, rinse it under tap water for one minute, then rinse again with clean water. Place it back into the pitcher, which is now clean and ready.

Filling the Pitcher: Fill the pitcher to the MAX line with high-quality drinking water that meets the "Standards for Drinking Water Quality." You can use either pure water or mineral water.

Assembling: Place the pitcher on its base and close it with the lid, ensuring it fits securely.

Connecting to Power: Plug the power adapter into the machine and into an outlet. When plugged in, a beep will sound, indicating the machine is ready.

Turning On: Press the power button to turn on the machine. It will beep, and the indicator lights will turn on, showing it's ready to be used.

Using the Functions:

- **Magnetic Water:** Press the button to activate this feature. It adds oxygen to the water and shows "10" on the display. The machine will return to standby mode after completing the cycle.
- **H2 Water Standard:** Activate this for a standard hydrogen boost, showing "08" on the display. The cycle lasts until the machine automatically returns to standby.
- **H2 Water Higher:** For a higher hydrogen concentration, press this button. "13" will display, indicating a stronger hydrogen infusion.
- **Self-Cleaning:** Use this function after every 10 cycles to keep the pitcher clean. It displays "01" and cleans the machine.
- **Image Suggestion:** Photos of each function being activated, with a focus on the digital display and blue light.

During Use: The pitcher will generate bubbles and glow with light, indicating the machine is working.

Finishing Up: Once the cycle finishes, the machine will stop, the light will turn off, and it will go into standby mode. Press the power button to stop the machine at any time.

Maintenance Tip: If the machine produces fewer bubbles, it might need cleaning according to the instructions. Do not immerse the machine in water.

Power Adapter Caution: The power adapter should only be used with this machine to avoid damage.

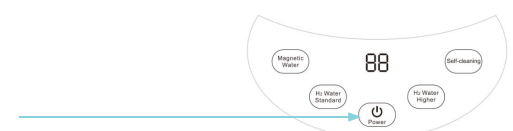
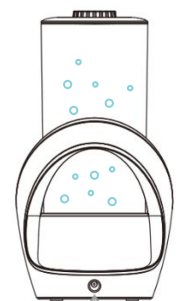
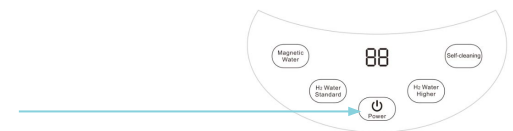
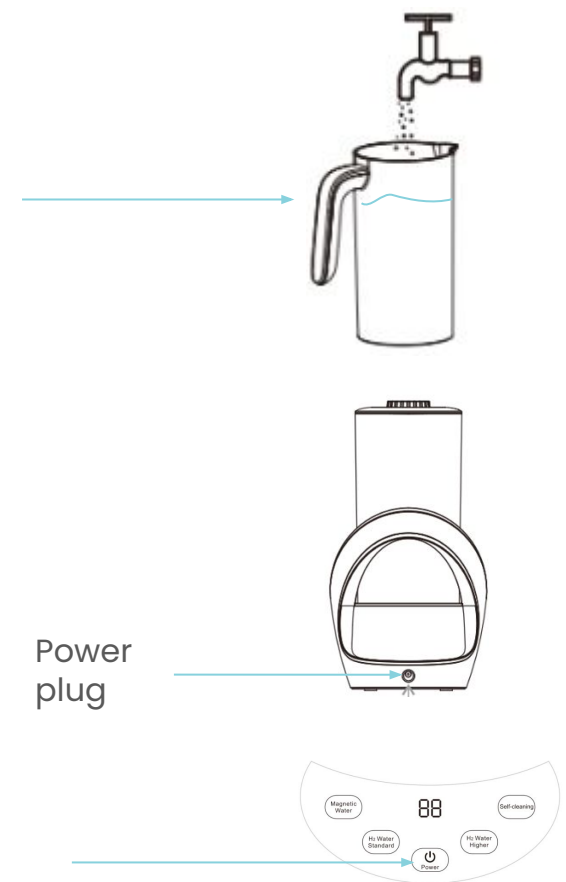

Functions

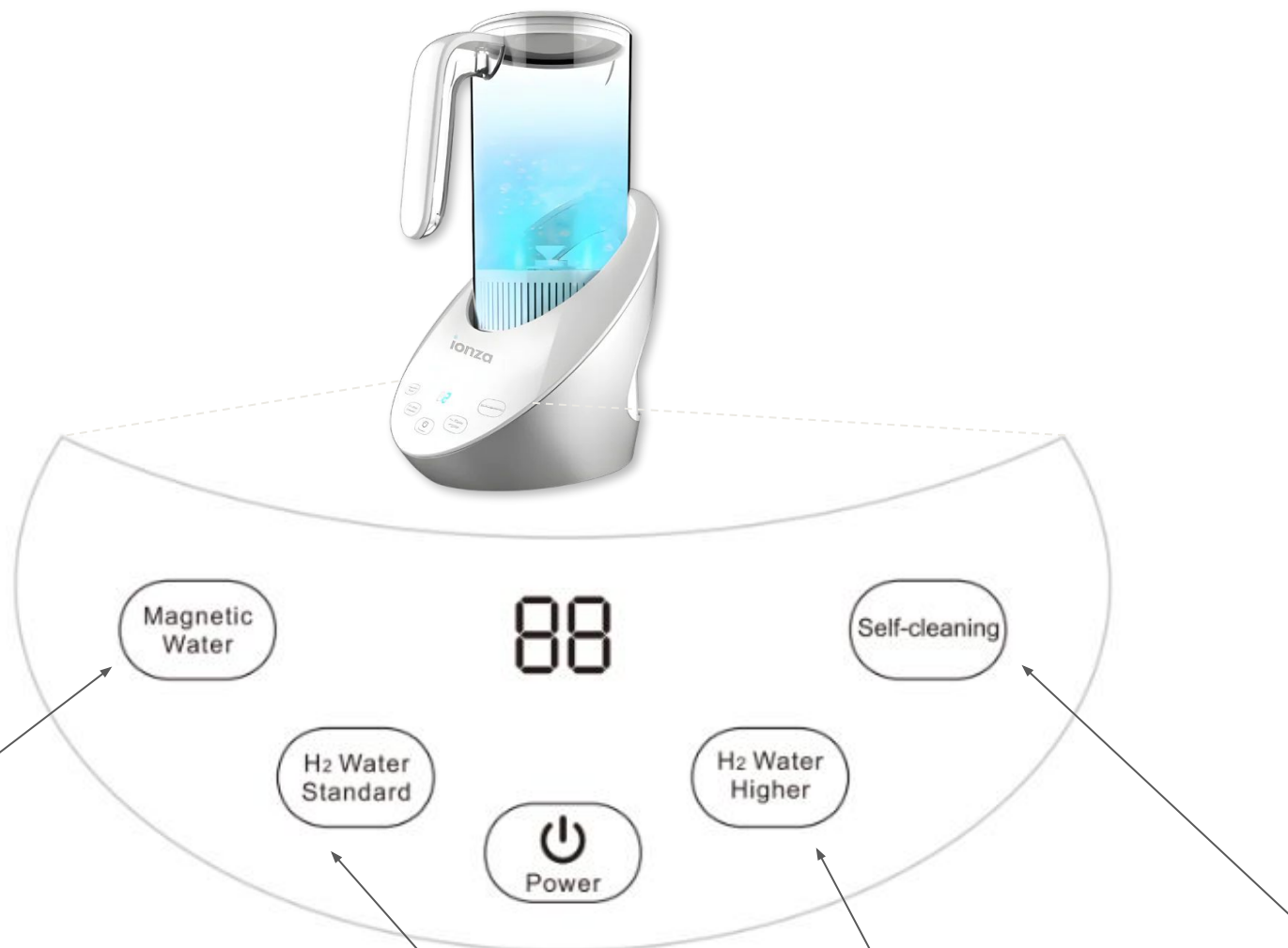

Magnetic Water:

Oxygen Infusion: This function pulls in atmospheric oxygen and lets dissolved oxygen out, similar to the process of breathing. It's a way to refresh and oxygenate your water.

Alkalinity Increase: Swirling the water increases its contact with air, helping to remove chlorine and other volatile compounds. This process can slightly raise the water's pH, making it more alkaline.

Extended Hydrogen Retention: Using this feature before adding hydrogen helps keep the hydrogen in the water up to three times longer, enhancing the water's benefits.

Optimal Use: For the best results, activate the magnetic water function before adding hydrogen to your water.

Self Cleaning:

Freshness Maintenance: This function cleans the pitcher, keeping it fresh. It's recommended to use this after every 10 uses of the hydrogen infusion feature to ensure the pitcher remains in optimal condition.

H2 Water Higher:

Strong Hydrogen Infusion: This is a 13-minute cycle that infuses your drinking water with 800 - 1300ppb of molecular hydrogen, providing a strong hydrogen boost for enhanced hydration.

H2 Water Standard:

Standard Hydrogen Infusion: This 8-minute cycle infuses your drinking water with up to 400ppb - 500 ppb of molecular hydrogen, offering a balanced enhancement to your hydration experience.

Precautions

Water Quality Standards: Ensure the water used meets the "Standards for Drinking Water Quality" (GB5749-2006) for optimal safety and performance.

Initial Use and After Extended Non-Use: Before using the jug for the first time or if it hasn't been used for a while, make sure to clean it thoroughly.

Operating Environment and Temperature: Operate the jug within a temperature range of 5 to 45 degrees Celsius and in dry conditions to ensure its best performance.

Storing Hydrogen Water: For longer preservation of hydrogen water's benefits, seal it tightly in another container and store it in the refrigerator. It is recommended to consume the water as soon as possible for the best quality.

Avoid Direct Sunlight: Do not place the jug in direct sunlight to prevent damage and ensure the longevity of the product.

Preventing Freezing: Avoid exposing the jug to temperatures below 0 degrees Celsius to prevent damage.

Caution Against Consuming Wash Water: Water used for washing the jug should not be consumed.

Product Parameters

Voltage	DC12V/2A	Jug Capacity	1600ml
Power	15W	Material	PC Pitcher, PP Filter Housing Generator Titanium platinum ABS Appearance Silica Gel sealing element
Net Weight	2.2kg		
Product Size Jug Size	210 x 182 x 336mm 124 x 205 x 250mm	Environment Temperature	5-45 degrees Celsius
Water Source	Direct Drinking Water	Environment Humidity	+25 Environment , humidity 80%
Liquid Temperature	5-38 degrees Celsius		