

Alka Fluoride-Free Underbench

Important Instructions:

Filter Placement:

- The FluorEx filter should be installed before any mineral filters to avoid clogging.
- We recommend installing the Active Pure Xtra Filter (a high-performance carbon and KDF filter) before the FluorEx Max to ensure effective fluoride removal.

Water Flow:

- Proper water flow is crucial for filtration. Keep the flow under 2 liters per minute to ensure the system filters effectively.

Flushing Before Use:

- Flush the Active Pure XTRA pre-filter before installing the FluorEx Max filter to prevent clogging.
- After flushing the XTRA, install and then flush the FluorEx Max filter. This step is crucial for optimal performance.

If Using With an Ionizer:

- Flush both filters before connecting them to an ionizer to prevent clogging.

Professional Installation:

- We strongly recommend having a professional install the system. Ionza is not liable for damages due to incorrect installation.

Alka Fluoride-Free Underbench

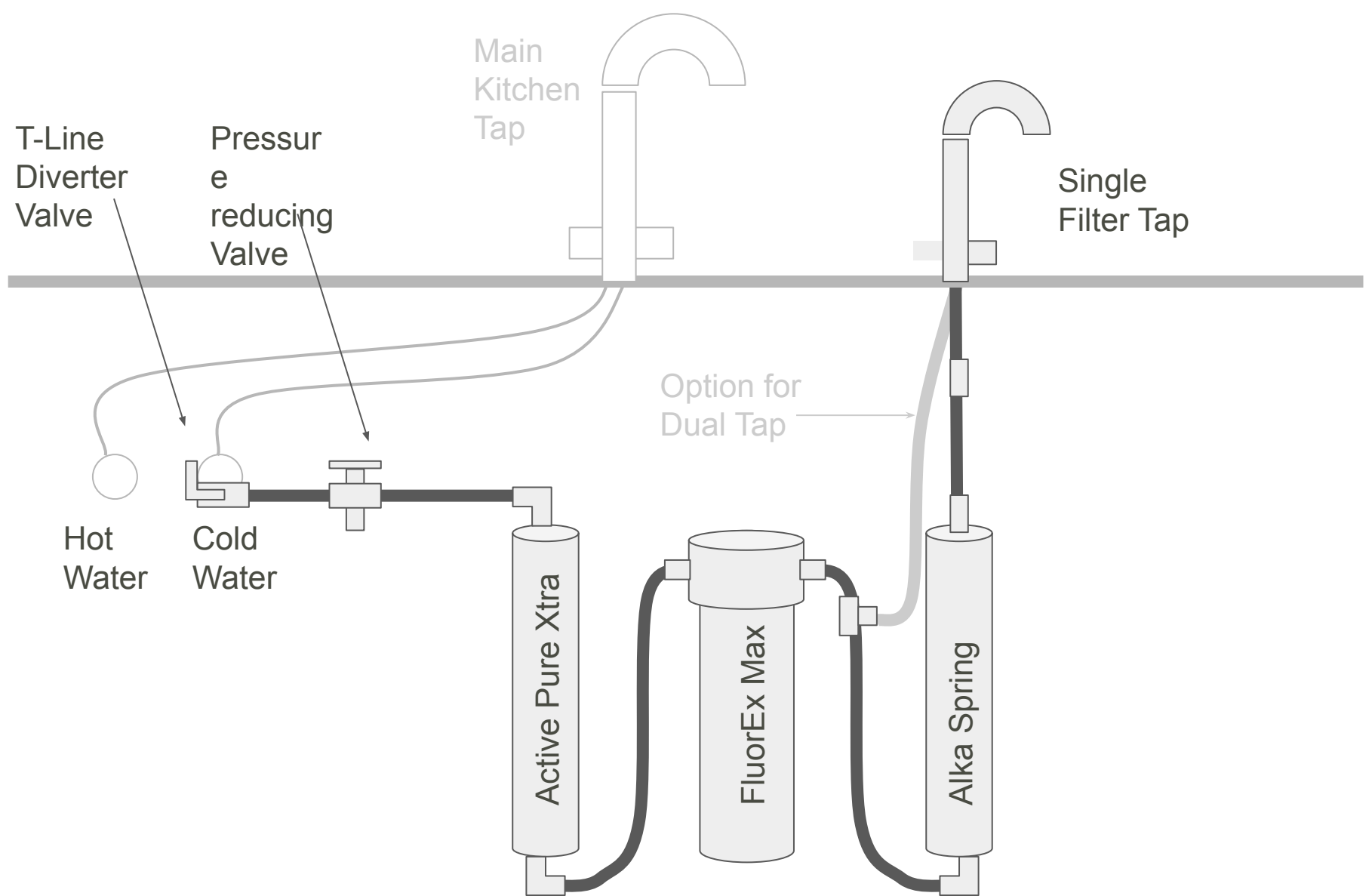

Installation Process:

Determine where to install the tap on your sink and drill the necessary hole.

Install the T-line diverter valve on your cold water line.

Place a pressure reducing valve before the filters if your water pressure is over 55PSI.

Install the filters according to the provided diagram.

System Requirements:

- Pressure: 15 – 60 PSI. Install a pressure reducing valve for pressures above 55PSI.
- Temperature: Operate within 5 – 40°C.
- Wall brackets are included for system mounting
- Water Flow Adjustment: Adjust the T-line valve to achieve a flow rate of about 2 liters per minute.