

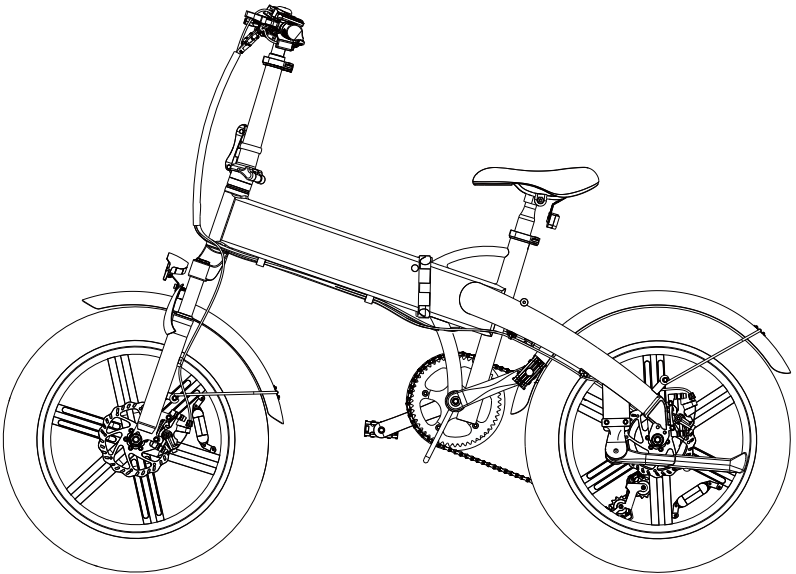

A DECE OASIS

A20F Beast

Original Instructions



Attention!

Please keep the instruction manual properly!
To ensure your safety, please read the instruction manual carefully before using the electric bicycle to better understand the performance of the electric bicycle.

Required preface

Dear user friends:

First of all, thank you for choosing to buy our products. All the staff of our company express their heartfelt thanks for your choice! This manual will introduce you to the common sense and maintenance methods of electric bicycles produced by our company. Please read the manual carefully after purchasing to understand the performance, characteristics, precautions and maintenance common sense of this bicycle, make sure you use the electric bicycle safely in the best driving condition.

In order to ensure the safety of using our electric bicycle, please be sure to use our professional spare parts. If you have any questions, please contact our authorized service station or our company.

Dear users, when purchasing the products of our company, please fill in the "electric bicycle sales (warranty) registration card" in detail completely and clearly and keep the "user warranty" properly, deliver the other two copies to the company's resident service station or distribution unit so that we can contact and serve you in time.

★ Important Tips

- 1.The patterns and text descriptions of this manual are only used as instructions for operation and are not used as the basis for inspection of products;
- 2.The illustration in this manual may not match the actual product, and the actual sales style shall prevail;
- 3.The company has the right to improve product performance and related configurations without prior notice;
- 4.This vehicle can only ride alone, and do not carry people.
- 5.This product is suitable for daily short-distance commuting. Please do not use it for dangerous performances such as competitions and stunts. Otherwise, it may cause damage to the bicycle or cause injury to the rider.
6. Riding in rainy days may lead to fall and injury, which is not recommended.
7. This product is a general-purpose product. Make sure the product complies with local regulations before using it. Otherwise, all legal responsibilities shall be borne by the user.
8. If the user modifies or changes the default state of the electric bicycle without permission,. Users will bear all legal responsibilities by themselves caused therefrom shall be borne by the user.

Your choice-the beginning of our service!" In the following days , we will wholeheartedly provide you with convenient , timely, fast and satisfactory service! Please read the instructions carefully before using, and do not use it before knowing the characteristics of this car (please read carefully for the terms of "danger", "warning" and "attention").



Danger: ignoring this warning can lead to personal accidents. In order to reduce the harm to yourself or others, special warning must be done or not allowed to do.



Warning: ignoring this warning can cause damage to the vehicle and its equipment, especially notifying what to do or not to do.



Note: ignoring this warning may cause slight damage to the vehicle and its equipment or the vehicle cannot run normally, telling what to do or what not to do.

Special tips for using security

Dear users, for your safety and prevention of safety accidents, please read and follow the following tips:

I. When using electric bicycles, you should abide by traffic regulations and pay attention to driving safety.

- (1) It is forbidden for people under 16 years old to drive electric bicycles on the road;
- (2) E-bikes should be driven on non-motorized lanes, lower than the maximum speed specified by local laws and regulations.
- (3) Do not lend electric bicycles to people who will not operate to avoid injury;
- (4) Electric bicycles shall carry personnel or articles according to laws and regulations;
- (5) It is recommended to wear a helmet when riding;
- (6) Riding in rainy and snowy days, the braking distance will be prolonged, pay attention to slow down; Heavy rain and other bad weather, try to avoid traveling.

II. Please pay attention to the safety of electric bicycles.

- (1) Electric bicycles should not be parked in the building foyer, evacuation stairs, walkways and safety exits;
- (2) Electric bicycles should not be charged and parked in residential buildings, and should be kept away from combustibles when charging, and the charging time should not be too long;
- (3) Correct use and maintenance of battery:
 - Please charge the battery for 12 hours for the first time after purchase or long-term storage. When using it normally, charge it for 12 hours every two months. When not in use for a long time, please separate the battery from the vehicle power cord, supplement every half a month.
 - It is forbidden to short circuit the positive and negative poles of the input and output terminals of the battery pack;
 - Keep away from children, fire sources and heat sources, and it is forbidden to put the battery pack into the fire;
 - Strenuous vibration, impact and extrusion of the battery are strictly prohibited;
 - Pay attention to waterproof to prevent battery pack from being exposed to water shower and immersion;
 - The battery pack should be charged with use. When not in use for a long time, be sure to remove it from the whole vehicle for storage;
 - The battery pack should be stored in a clean, dry and ventilated place, and should avoid contact with corrosive substances, away from fire sources and heat sources;
 - Storage Conditions of battery pack: ambient temperature -20~55°C; Ambient humidity ≤65%RH. The temperature of battery operation: -10~45°C.

Warm tips!

1. Water inlet is not guaranteed, please use the original charger to charge;
2. Do not charge in the kitchen, living room, bedroom and other domestic places;
3. It is recommended that the battery life cycle be 2 years to avoid damage caused by aging.
4. Braking will make the brakes and discs become hot, which may burn the human body, please do not touch.
5. If there is any item on the wheel hub, it may cause injury to the rider, so please check and clean up before riding.
6. When riding, you need to please avoid prevent any objects from touching the hub to avoid injury.
7. Avoid touching the wheel hub with any part of body during riding so as to avoid personal injury.
8. This product will not produce a sound of more than 50 dB(A). If there is obvious noise, please stop and check whether the bicycle is abnormal.

 Danger: waste batteries shall not be dismantled without authorization, and shall not be discarded at will to avoid environmental pollution; The waste batteries of this product shall be recycled by the enterprise or distributors or government designated outlets

Special tips for using security

(4) safe use method of charger:

- It is forbidden to place any items on the charger;
- It is forbidden to put any liquid or metal into the charger;
- It is strictly prohibited to disassemble and modify the charger;
- When charging, insert the output of the charger into the charging port of the battery pack first, and then insert the AC power plug of the charger into the Mains socket; It is forbidden to plug and remove the power plug with wet hands;
- Do not use the charger when thunder and lightning;
- Do not play with the charger and battery pack when charging;
- Do not use the charger in unstable, excessive lampblack and dust and excessively humid environments;
- Keep good ventilation and heat dissipation conditions when the charger works, and avoid using the charger in direct sunlight;
- When the output of the charger is not connected to the battery pack, do not connect the charger to the mains for a long time;
- During the charging process, the indicator light of the charger is red. When the indicator light turns green, continue charging for 2 hours to be fully charged;
- The normal charging time is 3-10 hours (no more than 12 hours), and the fast charging station is not allowed to charge.



Note: when replacing the charger, it should match the battery model; The special charger provided by our company must be used, and other Chargers are not allowed to charge the battery pack.

(5) Precautions for washing:

When washing the bicycle, do not directly splash water on the brake drum, motor and front and rear axle to prevent water from affecting the service performance and life;

- Do not use steam or high-pressure water pipes when washing bicycle ;
- Pay special attention to the working condition of the brake after cleaning the vehicle or driving in the water.

After cleaning or driving in the water, the braking effect may decrease. At this time, pay attention to safety when driving slowly.

(6) Adjustment of handlebar and saddle (if applicable);

- When adjusting the handlebar or saddle, be careful not to expose the safety line mark of stem and saddle pipe;
- After adjusting the horizontal pipe, stem, saddle and saddle pipe, pay attention to fastening, and the recommended torque is 18N.m.



WARNING 1 — As with all mechanical components, EPAC is subjected to wear and high stresses. Different materials and components may react to wear or stress fatigue in different ways. If the design life of a component has been exceeded, it may suddenly fail, possibly causing injuries to the rider. Any form of crack, scratches or change in color in highly stressed areas indicates that the component has been reached its service life and should be replaced.



WARNING 2 — For composite components impact damage may be invisible to the user, the manufacturer shall explain the consequences of impact damage and the consequences in the event of an impact; composite components should be returned to the manufacturer for inspection or destroyed and replaced.

Precautions before riding

Dear users, for your safety and to prevent safety accidents, please do the following checks before riding. If there is any abnormality, please repair it in time or find a professional repair!

(1) Inspection of power supply circuit and lighting circuit:

- Check whether the power supply circuit, lighting circuit and device are damaged; Turn on the power supply, operate the lighting switch, check whether the headlights and taillights are on, and whether the brightness of the headlights and taillights is normal;
- Check that the left brake handle is corresponding to the rear brake, while the right brake handle is corresponding to the front brake, and the brake icon is indicated on the display.

(2) Check of brake device:

- Check whether the front and rear brakes can work normally; Check the braking effect of the front and rear brakes to ensure that the brakes are normal and effective;
- Confirm whether the power-off switch is normal when the rear wheels are off the ground with double support of the whole vehicle;
- Please check the fastening status of each axle to ensure that the front and rear axles and handlebars are fastened reliably.

(3) Check the fastening status of handlebar and front and back wheels:

- Shake the handlebar up, down, front, back, left and right to check whether it is loose or pongee;
- Shake left and right front and back wheels to check whether there is looseness; whether the rotating wheel is too tight or stuck.

(4) Tire inspection:

- Check that the wheel inflation pressure is within the range marked on the tire.
- whether the tire has cracks or abnormal wear;
- Whether the tire is embedded with nails, stones and glass;
- When the tire is used to the tread wear mark, the tire should be replaced.

(5) Inspection of reflector and license plate:

- Check whether the reflector is missing. If it is found missing, contact the after-sales service immediately to reassemble the reflector of the same specification and model, and the installation position should be consistent with the original bicycle. Please do not change the position, modify, disassemble, etc. privately.
- Before each use, check that the function of the reflector is normal and the surface of the reflector is kept clean.
- The Reflector device cannot be blocked by luggage, children chair, clothes and other objects, otherwise it will cause potential safety hazards.
- Check whether the license plate is installed firmly, whether the number is clear, whether there is any damage or pollution, and if there is any should, reinforce, clean or replace it in time.
- Check the front brake and rear brake respectively. The left brake handle corresponds to the front brake and right brake handle corresponds to the rear brake. The brake icon is indicated on the display.



Before each ride, please make sure that the following items: whether the frame lock, vertical tube lock, seat tube locking fastener are locked, whether the brake system is normal, and the tires are full of gas to ensure riding safety!



All endurance mileage data of the battery in this manual are from tests done in ADO outdoor test site on the condition that the battery is full, at 25°C, with no wind, and under 65kg load. It is normal that the actual riding mileage may be significantly different due to rider habits, weight, road conditions, weather, etc.

Adjustment methods of each part

I.Adjustment of front and rear brake system: (the adjustment method of front and rear brakes is the same)

1.The rear integrated disc brake(see figure 1); Adjust the upper and lower nuts of the disc brake to make the spacing between disc brake and brake caliper 1.5-3mm, adjust the height of disc brake, and then tighten the nuts.

2.Front integrated disc brake (see figure 2): Adjust the A and B nuts of the disc brake and adjust the height of the disc brake so that the distance between the disc brake and the caliper is 1.5-3mm. If the distance is deviated, use the C screw to adjust, and then tighten the nut.



Note: To ensure driving safety, brake rubber the working face is worn to 1/2 of brake rubber, a new brake rubber should be replaced.

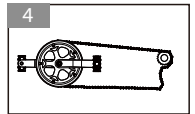
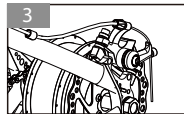
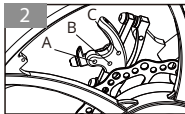
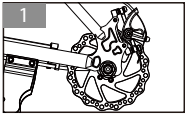

Rotate the Adjusting nut to rotate the Adjusting nut forward, the brake becomes tight, otherwise it becomes loose. When adjusting, hold the brake handle at the same time, so that when the position of the brake handle is 1/3 of the total stroke, the brake rubber block can be tightly attached to the brake drum. (See figure 3)

3.Disc brake: (see Figure 7 and 8)

Key points of disc brake adjustment: there is enough clearance between disc brake and brake pad (there is no interference between the brake disc and the brake skin when rotating, and the best braking effect is appropriate) adjust the nut, lengthen about brake cable, check whether the brake handle has been adjusted to the appropriate tightness; Then test ride to ensure effective and normal braking.

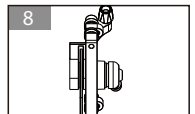
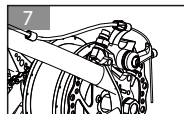
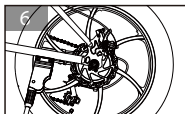
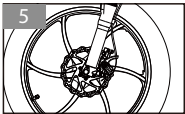

II.Chain adjustment (see figure 4)

1.Loosen the rear axle left and right fastening nuts, adjust the chain regulator, move the rear wheels back and forth, and tighten the tightness of the chain so that the sag in the middle of the chain is 10-15mm.At this time, the tightness of the chain should be suitable for go slick, no abnormal sound.

2.Keep the center surface of the rear wheel basically in the center surface of the frame, and tighten the rear axle left and right fastening nuts. (Recommended torque is not less than 30N.m)

III.Front wheel disassembly (see Figure 5)

1.Loosen the left and rear fastening thread of the front axle, remove the nut, remove the front axle, and remove the front wheel.

2.When assembling, align the center hole of the front wheel with the double arm hole of the hydraulic front fork, penetrate the front axle into the hole, and tighten the left and right fastening nuts of the front axle clock wise.

After installation, rotate the front wheel, and there shall be no stuck or loose phenomenon. (The recommended torque is not less than 18N. m)

IV.Rear wheel disassembly (see Figure 6)

1.Pull the motor cable off the connector, turn the car body over(note: Do not touch the handlebar, head cover, toolbox parts), rotate the rear axle nut, rear brake positioning nut and brake cable in the counterclockwise direction, unpack the chain joint, and then remove the rear wheel in the direction of the opening.

Adjustment methods of each part

V.The folding and expansion methods of folding bicycle are as follows: (the expansion steps are from ⑩ to ①)

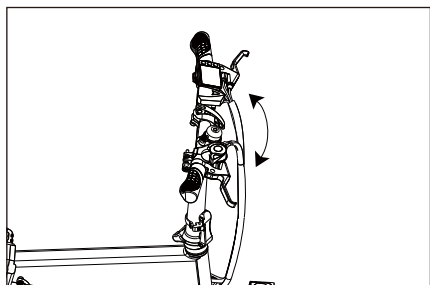

① Rotating T handle

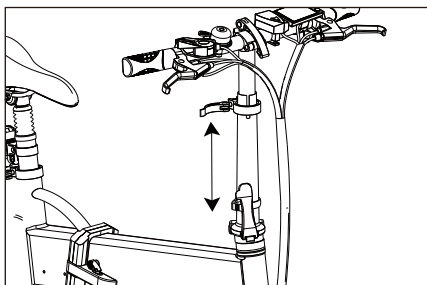

② Lower by vertical tube
The height cannot exceed the limit mark.

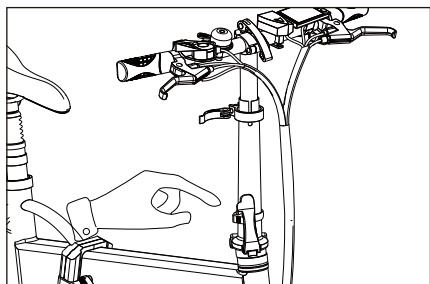

③ Open safety lock

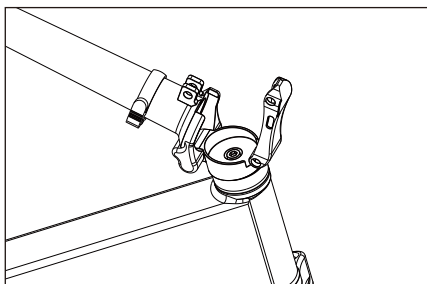

④ Rotate vertical tube

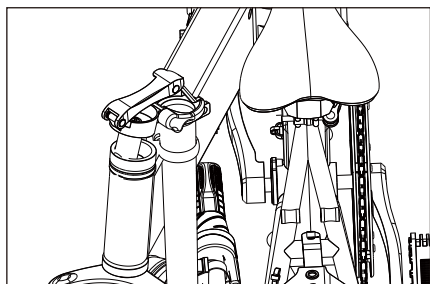

⑤ Folding riser

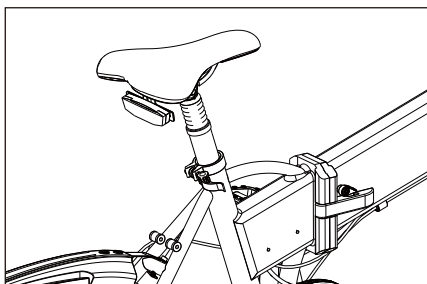

⑥ Lower seat tube
The height cannot exceed the limit mark.

Adjustment methods of each part

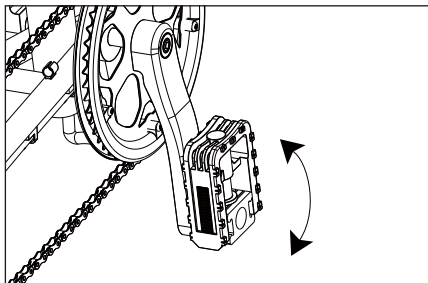

⑦ Folding pedal

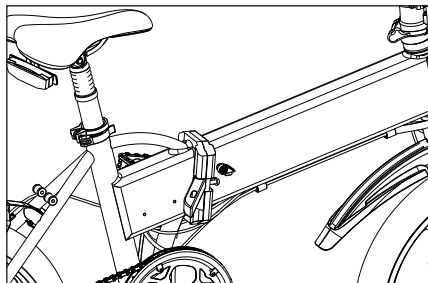

⑧ Open the frame and fold safety lock

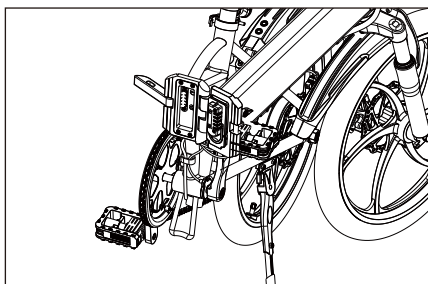

⑨ Folding frame

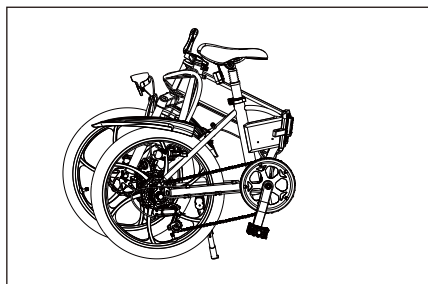

⑩ Finish folding

VI. Battery installation

The battery is mainly composed of two pieces, cell and protection board PCM (power battery is generally called battery management system BMS). Cell is equivalent to the heart of the battery, and the management system is equivalent to the brain of the battery.

Cell is mainly composed of positive electrode material, negative electrode material, electrolyte, diaphragm and Shell, while the protection board is mainly composed of protection chip(or management chip), MOS tube, resistor, capacitor, PCB board, etc.

Open the fixed lock with the key. Dial off the power plug, take out the battery, instead, insert the power plug, lock the battery lock, and confirm that it is safe and firm before riding.

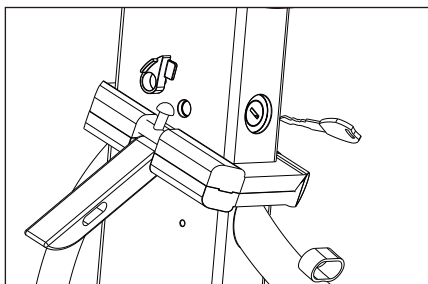

1. Open folding connector

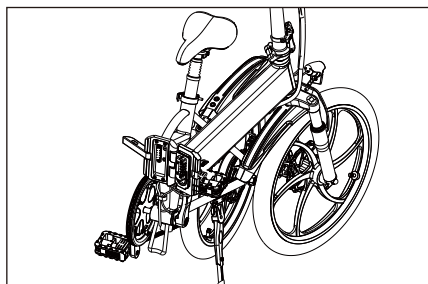

2. Fold the vehicle and pull out the key
insert the key to unlock

Adjustment methods of each part

! Note: Before using the bicycle, insert the key and turn it counterclockwise by 45°, the battery is activated. Finished using the bicycle, turn the key 45° clock wise, the battery is powered off, and take out the key. Remove the battery step, insert the key, press it upward and then rotate it 90° clockwise. Note that need to remove the key and then take out the battery to avoid damaging the key.

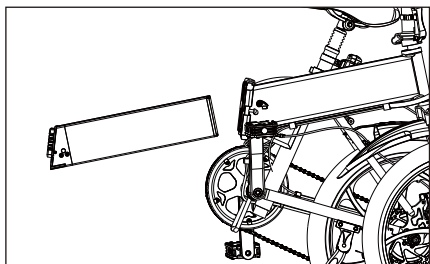

3. Take out the battery and charge the battery separately

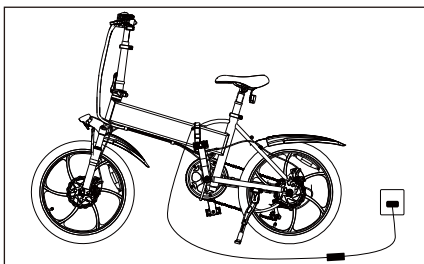

4. You can also choose vehicle charging

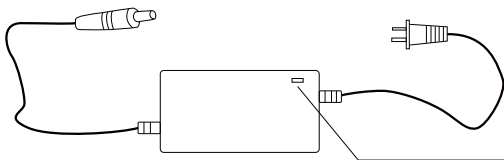

Red light indicates normal charging
Green light indicates charging completed

VIII. Instructions for using the code table:

1. Long press Power key for 3 second to switch on/off the ebike;
2. In the power-on state, press POWER KEY, the multi-function area will display ODO, TRIP, TIME.
 ODO: Total mileage of this bicycle
 TRIP: Miles since the ride
 TIME: Start-up time of this ride
3. Press the "+" button to increase the gear. The higher the gear, the faster the speed.
4. Press the "-" button to lower the gear. The lower the gear, the slower the speed.
5. PAS gear: (After pedaling to 6 km/h, start the power assist)
 Gear 1: Max 15km/h Gear 2: Max 20km/h Gear 3: Max 25km/h

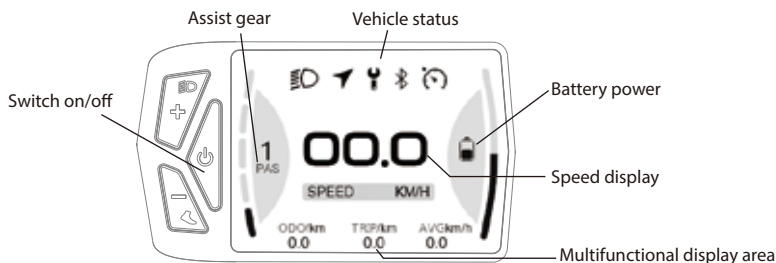

Electric bicycle fault inspection and troubleshooting methods

Serial Number	Fault description	Failure cause analysis	Troubleshooting methods
1	Speed regulation failure or speed less than 10 km/h	1, Low battery voltage 2, Speeder failure 3, Transmission Group failure	1, Fully charge the battery 2, Send to maintenance station for repair
2	Hub motor does not work after power on	1, Loose battery wiring 2, Motor wiring plug loose 3, Speeder failure	1, Take out the battery box and hang it up. 2, Fastening wiring plug 3, Send to maintenance station for repair
3	Insufficient mileage after charging	1, Insufficient tire pressure 2, Insufficient charging or charger failure 3, Battery aging or damage 4, There are many uphill \strong headwinds \heavy load \poor road Mow temperature	1, Sufficient gas 2, Sufficient power or check the charger 3, Replace battery 4, It is recommended to use pedal assist
4	Charger not charging	1, The plug is not inserted properly 2, Charger fuse blown 3, Battery pack fuse blown	1, Fastening socket 2, Send to repair station for replacement 3, Replace fuse
5	The battery has sufficient power but no voltage indicates that the electric wheel hub is difficult to	1, When starting the electric hub, the voltage is lower than 30V 2, Battery switching line fall off 3, Monitor connector loose 4, Controller failure	1, Replace new battery 2, Reconnection \fastening 3, Send to maintenance station for repair
6	After opening electric door lock, it is found that the signal part is normal and the driving part is abnormal.	1, Battery under voltage; 2, Left and right brake handle damage 3, The controller or motor is damaged 4, Abnormal line 5, Motorcycle handlebar damage or line difference	1, Replace motorcycle handlebar and repair lines 2, Timely charging 3, Replace left and right brake handle 4, Replace controller or motor
7	Abnormal zero start mode (switch left and right disk)	1, The startup mode switch or motorcycle handlebar is damaged. 2, Abnormal line	Replace damaged parts/ maintenance lines
8	Non-zero startup mode exception (switch in the middle)	1, Incorrect start-up tax switch overlap or booster damage 2, Abnormal line	Check switch position/replace booster/overhaul line

 Note: When a fault that cannot be eliminated by yourself or a fault that cannot be determined, the internal damage of the motor, controller, charger, battery pack, etc. please send the vehicle to the place of purchase or the company's special maintenance station for inspection and maintenance. During the warranty period, please do not open important parts without authorization, otherwise the company will not guarantee.

 1. When doing bicycle maintenance, the battery must be removed to avoid abnormality that may cause fire or damage to the battery.
2. Original parts should be used in repairing or maintaining the bicycle, otherwise your bicycle may not work properly, or related parts may be damaged.

Maintenance and Repair

Daily maintenance:

- 1.The vehicle should be kept clean and clean, and the vehicle should be wiped with dry cloth in time after being drenched to avoid rusting of parts and short circuit of electrical components.
- 2.Always check the air storage capacity of the tire to keep it in normal use.
- 3.The main transmission parts such as front axle, a rear axle, coner axle, front fork, Flywheel and electric hub should be checked and adjusted frequently to keep the transmission parts flexible without impact sound and noise; Check the screws and nuts of the bicycle, if it is found that it is loose, it should be tightened in time to prevent the parts from being worn out or causing greater damage and fracture due to looseness.



Note that the tightening torque of front wheel, handlebar core screw rod, saddle pipe clamping Bolt and saddle clamping Bolt shall not be less than 18N.m;The tightening torque of rear wheel, bottom bracket Cup and bottom bracket Cup lock nut shall not be less than 30N.m

- 4.The braking part should be checked and adjusted frequently to make it in a flexible state, for example, the gap between the brake rubber and the gate core should not be too large.
- 5.Always check whether the operating parts and cable are flexible, and ensure that there is no stagnation, no stagnation, and properly drip lubricating oil from one end of the hose slowly, and pull the wire rope at the same time, feel that the wire rope slides lightly in the hose.
- 6.Electric bicycle moving parts should be often injected with a small amount of lubricating oil to reduce wear and keep riding light, as shown in the following table:

Lubrication part	Lubricant	Lubrication cycle
Front axle, center axle, a rear axle bearing	3# calcium-based lubricating oil	Six months to one year
front fork headset	3# calcium-based lubricating oil	Half a year
Pedal bearing	3 pieces of calcium-base lubricating oil	Half a year
Chain	30# mechanical oil	Half a month
Double support locking plate side support and transmission parts	30 and mechanical oil	Half a month

Name	Handle horizontal tube	stem	Saddle	Saddle pipe	front axle	rear axle	Center shaft nut
Running torque	18N. m	18N. m	18N. m	18N. m	18N. m	30N. m	30N. m

Location	Method	Time
Center shaft	Check whether the bottom bracket Cup is loose/disassemble the central shaft, wash and change oil, and check the parts.	Check frequently /once every year
Front and rear wheels	Check the wheel swing, spoke tension, spokes, mother spoke for damage; Adjust the wheel	The first month/year after the first new car
brake cable	If there is a steel wire at the root of the rolling head, replace the new brake line.	Once every month
brake handle	If there is a steel wire at the root of the rolling head, replace the new brake line.	Once every three months
Chain	Check whether the pin shaft is loose or bulging, and whether the extension of the chain is too large.	Once every six months
Front and rear nut, handlebar core screw, saddle clamping screw	Check for looseness	Once every six months

Correct use and maintenance methods of motor, controller and battery:

- 1.The motor should be kept clean, no foreign matter, corrosive liquid, gas, etc. should enter the motor, and the motor Shell should not be knocked and baked to avoid damage to the motor.
2. All wires should avoid friction and contact with sharp metal, and the wires should be tied firmly with the frame.
- 3.The controller is a high-tech intelligent computer memory program password. If the user opens the repair by himself, the components will be easily damaged. If the controller fails, please go to the service department to repair it.
- 4.This battery is a special battery for electric bicycles. When the electric bicycle is not used for a long time, the battery should be stored after sufficient electricity, and the electric energy should be replenished regularly to avoid battery vulcanization caused by long-term under power.
- 5.The battery cannot be near open flame or high temperature heat source, and the battery cannot be thrown into the fire. Direct exposure to the sun is strictly prohibited in hot and hot weather.

After-sales service and warranty scope

Provide correct operation methods and maintenance items, provide valid car purchase tickets, warranty cards, and the address and contact number of the warranty unit.

2.Users should operate correctly according to the product manual. Any performance failure caused by production quality, according to relevant laws and national Three Guarantees regulations, the company shall uniformly fulfill the Three Guarantees obligations.

3.The company is responsible for the repair of faults outside the scope of the Three Guarantees and the main components after the Three Guarantees period, but the fees shall be charged as appropriate.

4.If the battery replacement exceeds the Three Guarantees period, the company will supply it at the ex-factory price, but the battery must be recycled one by one and returned to the battery manufacturer to ensure safety and avoid environmental pollution.

(-) warranty period for major parts

Details of warranty scope and term

Part name	Warranty Period (except human factors)	Warranty	Service content
Frame	Natural open welding, desoldering and fracture phenomena	5 years	Free replacement
front fork Frame, Fender, chain cover, Hanger	Paint patches fall off	12months	Free replacement
Handlebar, RIM, Sprocket, crank,	Electroplating parts fall off	12months	Free replacement
Front or rear axle, Flywheel and other rotating parts	Damage or fracture of heat treatment parts	12months	Free replacement
Motor	Rotor breaking, casing cracking. Winding damage	12months	Free replacement
Controller. charger	Circuit damage and component damage	12months	Half-year renewal and half-year maintenance
Lithium battery	Excessive capacity drop, no voltage release, battery safety hazards	12months	Since the date of delivery, the capacity is less than 60%. Free maintenance or replacement
Inner tube	Air leakage caused by internal quality problems such as trachoma will not be replaced after repair.	15 days	Free repair or replacement
Paint parts	Large pieces fall off, obviously fade, blister, crack	6 months	Free replacement
Fuse, Bulb, cable. switch, brake shoe	Vulnerable parts, not covered by warranty		
Outer tire	Replacement for cracking within 1 month (non-human factor)		

It does not belong to the scope and content of the Three Guarantees:

- 1.Failure caused by user's failure to use, maintain and adjust according to the "instruction manual.
- 2.The user disassembles and refits himself, as well as faults caused by non-compliance with the rules of use.
- 3.Faults caused by improper use, storage, or accidents.
- 4.There is no warranty card, and the "receipt link" is not sent back to our company, or vehicles with inconsistent cards and goods.
- 5.Wearing parts and consumables shall not be provided in three packs. Including brake, seat bag, plastic parts, spokes, RIM, brake cable, surface scratch, etc.
- 6.The cost of self-repair without the consent of the special maintenance unit.
- 7.After the accessories leave the factory, the shell is scratched or the shell is damaged without repair. The lead is scratched or broken without repair.

Maintenance record

Date	Maintenance content	Remarks

Warranty description:

- 1.All parts of the vehicle will be guaranteed strictly according to the warranty period.
- 2.The warranty period starts from the factory date.
- 3.If you unpack the controller, charger, battery and motor privately, no warranty will be given.
4. If the parts exceed the warranty period, the warranty will not be granted.
- 5.When the vehicle fails, the maintenance must be carried out at the designated maintenance point, and the accessories must not be disassembled and assembled privately. Controller, battery and charger must ensure that all labeling is complete, and no one is damaged.
- 6.When the vehicle is repaired, relevant certificates such as warranty card, invoice, certificate of conformity and so on must be presented.
- 7.Battery warranty adopts one-to-one warranty. In case of battery problems, the battery must be returned to the manufacturer first. After the battery is tested by the manufacturer, judge whether the battery is broken according to the battery testing standard, and determine whether the battery damage is within the scope of warranty, and then carryout warranty.
- 8.The controller will be maintained for warranty. The replacement of the controller must ensure that the plug-in is complete for testing. If it cannot be repaired, a new controller will be replaced. If the controller is damaged manually, it will not be guaranteed.
- 9.Pay attention to the maintenance of the whole vehicle and avoid riding in the water as much as possible. The damage of electrical devices caused by water inflow will not be guaranteed.
10. If you buy the bicycle from an offline store, please go to the point of purchase for after-sales service.
11. If you bought abuy the bicycle from an online store. When you need to repair it, please bring the proof of purchase and apply for after-sales service at the corresponding online store.
12. If you are dissatisfied with the after-sales service at the point of purchase, please provide the relevant purchase information and contact the following customer service:

After-sales Service email : Support@adoebike.com

Official website : www.adoebike.com

Electrical schematic diagram

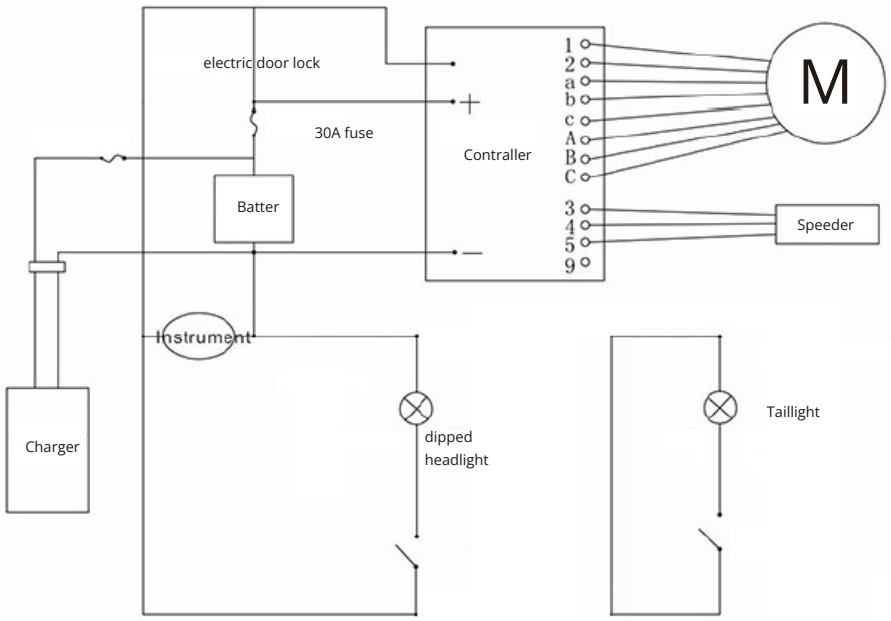
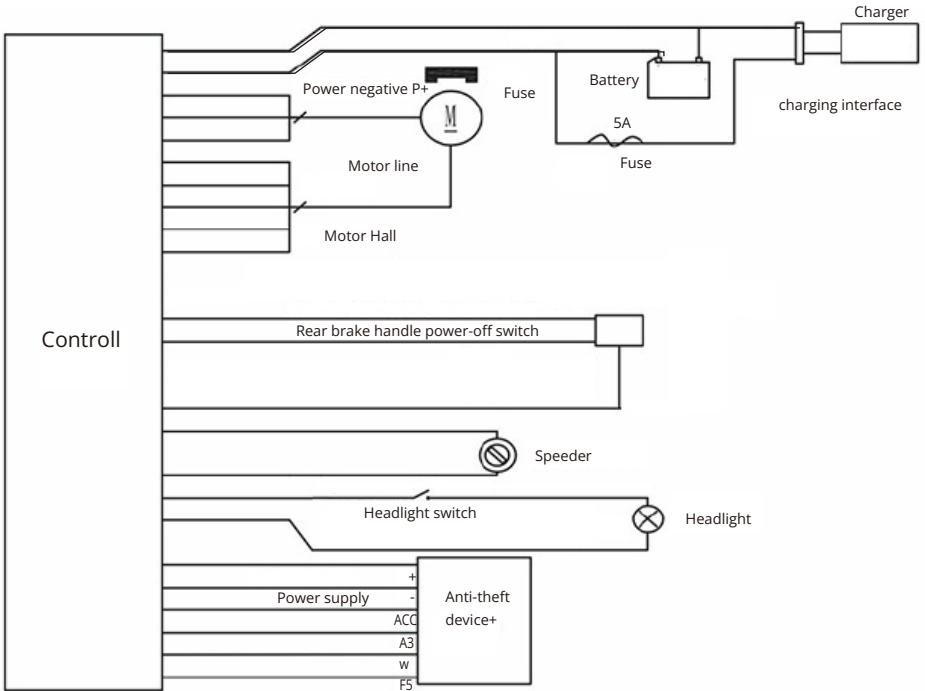

A20F Beast Product Description

Bicycle type	Folding Electric Bicycle
Tires Size:	20*4.0 inches (Fat tire)
Max Speed:	25km/h
Mileage:	<120km
Load Capacity:	120kg
Product Net Weight:	28.5kg
Product Gross Weight:	37.5kg
Overall Unit:(L*W*H)	1740*530*1200mm
After Folding:(L*W*H)	980*450*770mm
Packing size:(L*W*H)	1010*490*730mm

Hardware Configuration

Body Material:	Aluminum alloy 6061
Motor Type:	Hall Brushless DC Motor
Transmission:	Shimano 7 speed
Shock Absorber:	Front fork shock absorber
Brake System:	Front and rear hydraulic disc brakes
Battery Type:	Lithium battery
Battery Capacity:	36V/14.5AH
Battery Charger Power:	42V/2A(CE/ Safety)

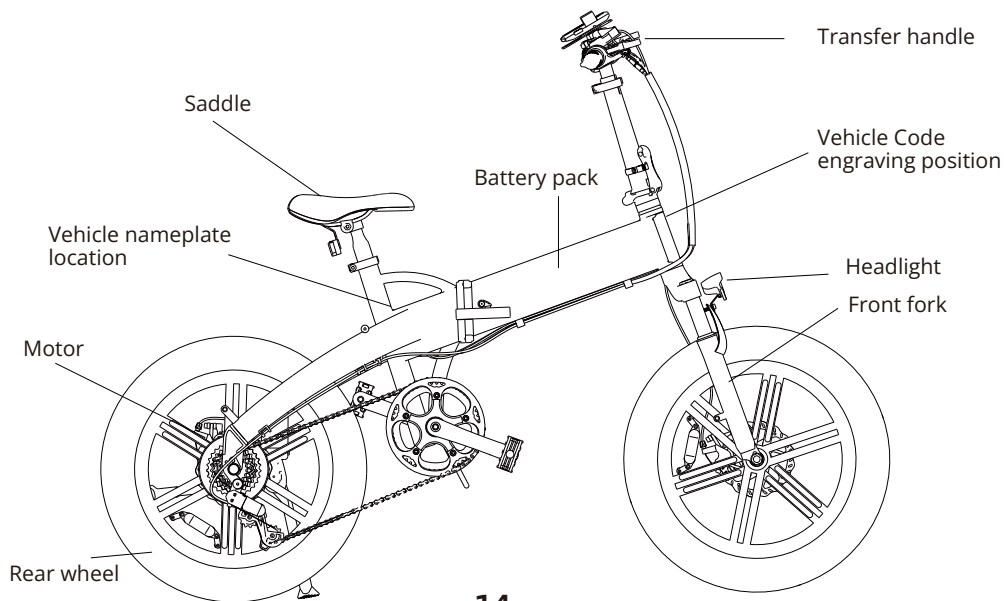

EU Declaration of Conformity

We herewith declare,
Shenzhen UMI Technology Co., Ltd
Rm#1008, Henglu E Era, Pinghu Street, Longgang District, Shenzhen, China

That the following product complies with stated standards and other related documents following the provisions of the Machinery Directive 2006/42/EC.

In case of alteration of the product, not agreed upon by us, this declaration will lose its validity.

Product Name: Electric assist bicycle

Product Type: A20F Beast

..

Product Description: Folding Electric Assist Bicycle

The product has been assessed by the application of the following harmonised standards:

EN 15194: 2017

EN 13849-1: 2015

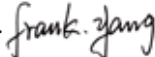
Date/Authorized Signature:  2022.03.01

Title of Signatory:Technical Manager.....

Shenzhen UMI Technology Co., Ltd

Address: Rm#1008, Henglu E Era, Pinghu Street,
Longgang District, Shenzhen, China

E-mail: support@adoebike.com

ADO official website: www.adoebike.com

Work Time: 8:00 -17:00(winter, UTC+1 ; summer, UTC+2)



ADO official website



ADO manual download



ADO quick installation guide