



BLACK INC
www.blackinc.cc

Barstem Installation Instructions

INTRODUCTION

Congratulations on your Black Inc product. Please review thoroughly the following instructions and only follow them for correct operation and use. Should you fail to follow the following instructions and warnings, this could result in damage of the product, damage to the bicycle and in severe situations cause possible injury and or death.

Since specific tools and bicycle service experience is required for proper assembly installation, it is recommended that the product be assembled by a qualified bicycle mechanic. Black Inc assumes no responsibility for damages or injury due to improper assembly and installation of the product(s).

WARRANTY

All of Black Inc products are free of defects from materials and manufacturing defects for a period of two years starting from the original purchase date unless otherwise stated on our warranty policy detailed on our website at www.blackinc.cc.

This warranty is non-transferable and only applicable for the original customer which purchased this product only. Any modification of the product other than for its original intended use such as drilling, sanding, painting and etc. will effectively and immediately void the warranty.

For more information on our warranty policy and instructions for completing a warranty claim please check our website for full details at www.blackinc.cc.

SPECIFICATION

Item Number / Model Name.

BLACK INC CARBON FIBER INTEGRATED BARSTEM

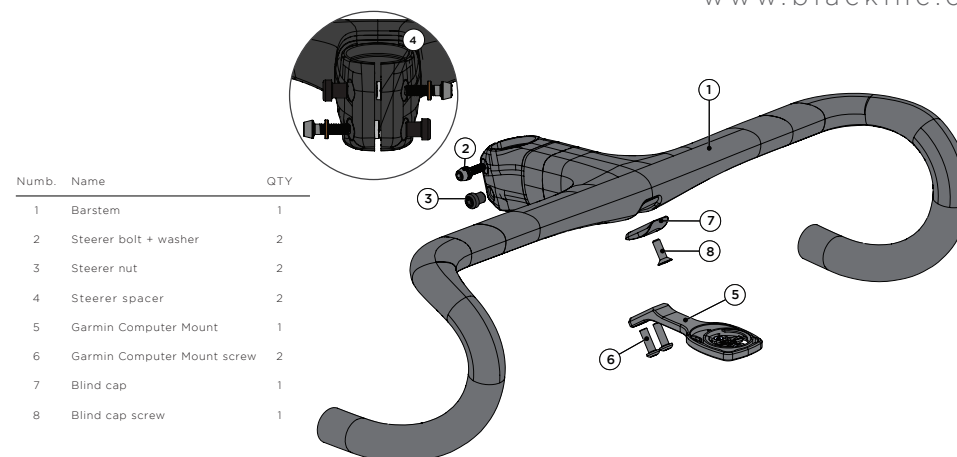

Numb.	Name	QTY
1	Barstem	1
2	Steerer bolt + washer	2
3	Steerer nut	2
4	Steerer spacer	2
5	Garmin Computer Mount	1
6	Garmin Computer Mount screw	2
7	Blind cap	1
8	Blind cap screw	1

BARSTEM INSTALLATION TO FORK STEERER

1. Apply Black Inc Installation Compound onto the fork's steerer tube before installing the barstem. Then insert the barstem onto the fork's steerer tube.

2. Apply grease to the bolts located on the stem steerer side of the barstem (ti-prep for titanium bolts) and tighten the fixing bolts until reaching the recommended torque indicated on the stem. In 1/4 turn increments, please remember to slowly tighten the bolts on the steerer clamp evenly to ensure even load distribution. Failure to do so could result in damaging the product and or improper installation leading to possible injury or death.

⚠ WARNING! Do not go above the maximum torque labeled on the barstem. Please check the barstem for movement or slippage before every ride to ensure safe operation and regular function. If in doubt, please contact an experienced bicycle technician to ensure safe bicycle operation and usage.

⚠ WARNING! Please measure the fork steerer tube before installing the barstem. Please use an accurate measurement device such as a caliper. If installing a stem that has an under sized steerer or handlebar clamp section, this may cause the stem to not function correctly possibly resulting in slippage resulting in possible loss of control of the bicycle and resulting in possible injury to the rider and or death. Please use the Black Inc Installation Compound between the barstem's steerer tube to reduce any possibility of slippage. Please consult the fork manufacturer for exact specifications of the clamp section to ensure safe operation.

GENERAL GUIDELINES

Fork Steerer Tube Diameter 1 1/8" 28.6 mm (+0.0/-0.1)

INSTALLATION PROCEDURE

Necessary tools

Torque wrench with 3, 4, 5, 6mm hex bits

1

Place the barstem on the steerer fork tube with all the spacer quantity needed.

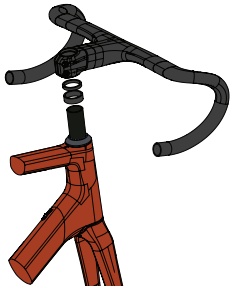

2

Cut the steerer fork tube to a maximum of 5 mm below (or as much as you want on above direction) the top surface of the stem. Grind the fork steerer with fine sandpaper.

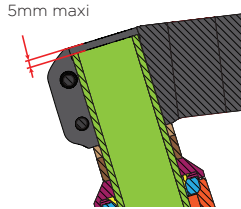

3

Insert the compression plug into the steerer fork tube until contact with the top face and tighten to **8 Nm**.

Apply Black Inc Installation Compound onto the fork's steerer tube before installing the barstem.

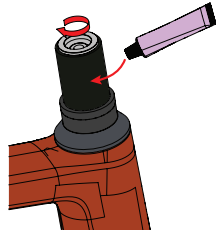

4

Mount the barstem onto the fork's steerer tube.

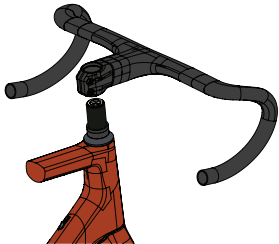

5

Align the barstem with the front wheel in such the same plane.

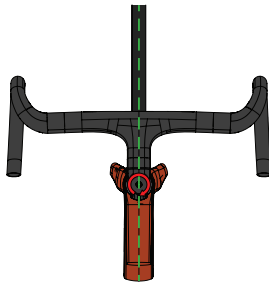

6

Tighten the top cap screw until no more play can be detected but careful not to over tighten. It should be tight but without restricting the headset + barstem assembly from rotating freely.

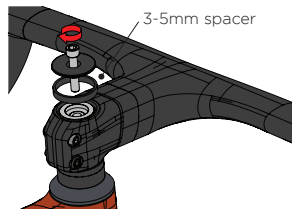

7

Apply grease to the screws located on the stem steerer side of the barstem (ti-prep for titanium bolts) and tighten the fixing screws until reaching the **5.2 Nm**. In ¼ turn increments, please remember to slowly tighten the bolts on the steerer clamp evenly to ensure even load distribution.

Failure to do so could result in damaging the product and or improper installation leading to possible injury or death.

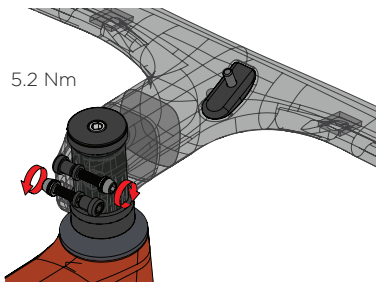

8

Optional : Garmin Computer Mount

Loosen the screw on the blind cap and remove.

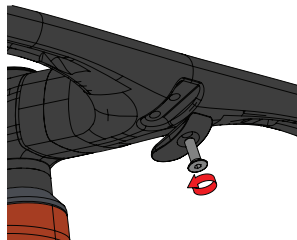

9

Place the computer mount and tighten the two screws to **2.5 Nm**.

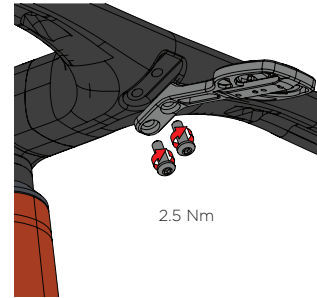

10

Optional: Shimano Di2 JC-200 Assembly

Take the Shimano Di2 JC-130 wire. It should look like that.

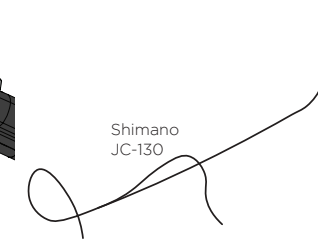

11

Route the JC-130 through the handlebar, respecting the entrance/exit from the picture. The Parktool IR-1 or a Magnet can helps.

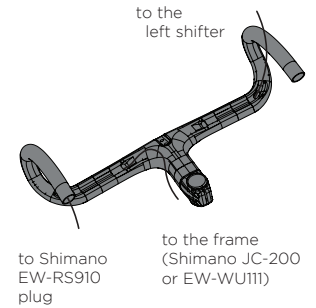

12

Route the right side shifter wire.

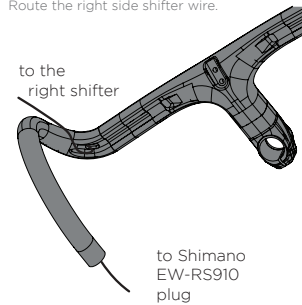

13

Connect the 2 wires with Shimano EW-RS910, and plug into the handlebar.

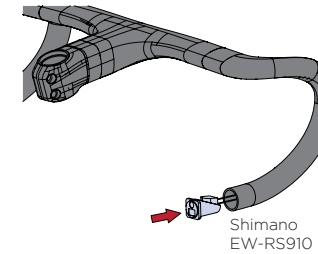

⚠ WARNING! The headset and fork components should be installed before the installation of the barstem. The headset and fork assembly operation requires specialized knowledge of road racing bicycles which requires specific non-standard assembly tools. For certain bicycle components, general bicycle mechanic experience may not be enough to correctly ensure correct installation of premium carbon fiber components.

It is recommended that when in doubt the headset and fork be installed by a qualified bicycle mechanic. Improper assembly of the headset, fork, stem and handle bar could lead to loss of control of the bicycle resulting in personal injury, crash and or in severe cases even death.

⚠ WARNING! Please have your product inspected regularly for possible damage and or cracks from use especially from instances such as from accidents and or crashes. If you were involved in a crash, it is strongly recommended you stop using your bicycle immediately and take your bicycle to a professional bicycle mechanic for inspection to ensure proper function and safety. Failure to do so could result in loss of control, personal injury and or death.

For more information, please visit our website at www.blackinc.co