

Jewenwils

Outdoor Digital Yard Stake Timer

SKU: HOYS16D
[Instruction Manual]

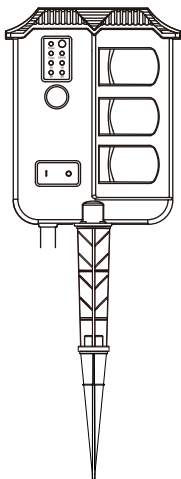

Please pay attention to the warning signs
Read the instructions with caution before operating
and keep it properly

Warning: To reduce the risk of fire, electric shock or personal injury, please strictly follow the instructions.

1. Do not connect any devices which may exceed the maximum ratings of this timer.
2. Do not immerse in water.
3. Children are not allowed to use the timer without supervision.
4. Do not disassemble or repair the product, but only by authorized service personnel.
5. Please always unplug and store indoors when not in use.
6. Used batteries should be disposed safely and environmentally.

Installation

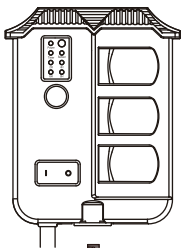

As shown in the figure, connect the three sections together. Be sure to firmly tighten the stake to the body before installing into the ground.



Tips: If the ground is too hard to insert the stake, digging a hole that matches the stake with a hard object will be perfect.



Button Layout

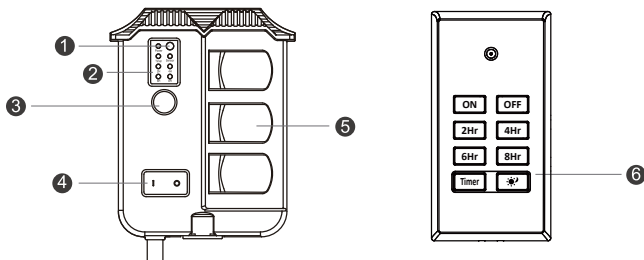

1. Light Sensor: Detects light density to turn the connected devices on or off.
2. Operating Mode Indicator: Indicates current operating mode.
3. Select Button: To select and switch the operating mode.
4. Overload protection switch: Turn on/off the power manually and overload protection.
5. Outlets: To plug the lights or devices to be controlled by the timer.
6. Transmitter

Operating Instructions

Press the overload protection switch to the “I” position and turn on all outlets first. The indicator on the switch will be lighted.

The yard stake timer can be operated via the included transmitter from up to 100ft away or manually press the button on the stake to select desired function. You can choose any one of the following modes:

ON: Power is ON to attached devices. The power indicator will be lighted.

☀️ (Dusk - Dawn): Power will turn on at dusk and remain on until dawn

☀️ +2 H/4H/6H/8H: Power will turn on at dusk and off after hours you selected.

Timer +2 H/4H/6H/8H: Power will turn on immediately and off after hours you selected

OFF: Power is OFF to attached devices. The “power” indicator will go out.

Control by Receiver:

1. Press the timer control button (3) to turn on all outlets On-Always On. The power indicator (2) will be lit.
2. Press the timer control button (3) to Sensor (☀️ dusk-to-dawn). The indicator (2) will be lit and all outlets will be ON when sensing dusk and Off at dawn.
3. Press the timer control button (3) to Sensor plus 2hr, 4hr, 6hr or 8hr. The indicators (2) for the Sensor and specific hour you selected will be lit. All outlets will turn on when sensing dusk and then off after hour your selected.
4. Press the timer control button (3) to Timer 8hr, 6hr, 4hr or 2hr. The indicators (2) for the Timer and specific hour you selected will be lit. All outlets turn on immediately then off after the hour you selected. The current setting will repeat daily.

Control by Transmitter:

1. Press the ON or OFF button to turn the receiver power ON or OFF.
2. Press Timer button plus 2Hr, 4Hr, 6Hr or 8Hr to turn on the receiver on then off after that specific hour you selected. The power will be repeated ON daily.
3. Press Sensor button (☀️ dusk-to-dawn), the receiver will be ON when sensing dusk and Off at dawn.
4. Press Sensor button plus 2Hr, 4Hr, 6Hr or 8Hr to turn on the receiver after sensing dusk then off after specific hour you selected.

Notes

1. The receiver must be located within 100 feet from the remote transmitter. Actual function range may be affected by the following factors: weather, radio frequency interference, low remote battery and obstructions between the transmitter and receiver.
2. The timer repeats daily after setting. In case of power failure, the timer will go back to the off state and need to be reset to the desired operating mode once power is restored.

3. Once programming activates at sensor with the 2H, 4H, 6H, or 8H Mode, the program cycle will complete before the timer being reset. Headlights, porch lights, street lamps and other external lighting sources will not interfere with the active timer program.
4. In the Sensor Mode, temporary light sources like headlights, porch lights and other external light sources will not interfere with the photocell function unless the external light source is on for more than 15 minutes. In that case, the timer will shut off until darkness is restored.
5. When set to "ON", the timer will provide continual power to attached devices until the timer is switched to "OFF", or to any of other operating modes.

Overload Protection

The unit has a reset function for overload protection. If the power turns off unexpectedly, please unplug all devices, press the power switch (resets device) and reconnect devices.

Battery Handling and Usage

- Install the battery observing the positive (+) side up as indicated inside the battery compartment.
- Never throw batteries into a fire. Do not expose batteries to fire or other heat sources.
- Battery contains mercury. Do not put in trash. Recycle or manage as hazardous waste.

Battery Replacement

- Remove the battery compartment cover away from the remote (see diagram below)
- Remove the old battery and place a new Type 3V (CR2032) lithium battery into the battery compartment.
- Ensure the battery is installed correctly with the positive (+) side up.



- Replace the battery compartment cover.
- Dispose or recycle spent/discharged batteries in compliance with all applicable laws. For detailed information, contact your local solid waste authority.

Caution: Failure to properly align the battery polarity can cause personal injury and/or property damage.

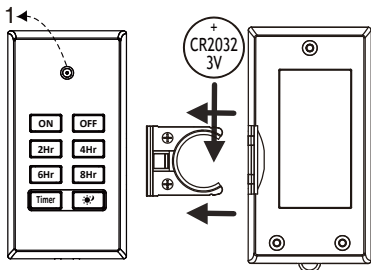

⚠ WARNING:

Do not ingest the battery, Chemical Burn Hazard (The remote control supplied with) This product contains a coin/button cell battery. If the coin/button cell battery is swallowed, it can cause severe internal burns in just 2 hours and can lead to death. Keep new and used batteries away from children. If the battery compartment does not close securely, stop using the product and keep it away from children. If you think batteries might have been swallowed or placed inside any part of the body, seek immediate medical attention.

Specifications

Frequency: 433MHz

Transmitter Power Input: 3V Lithium Battery (CR2032)

Receiver Power input: AC 125V Electrical Outlet

Receiver Power Output: 13 Amps / 125 Volts / 1625W

Cord: 6ft SJTW 16/3C

RECEIVER MODEL: SP-058A

TRANSMITTER MODEL: TR-034-8

FCC ID: PAGTR-033-8

Safety Information

WARNING: Disregarding Cautions may cause damage, fire, or fatal shock. When using outdoor electrical products, basic safety precautions should always be followed to reduce the risk of fire, electric shock, and personal injury.

CAUTION:

- Risk of Fire. Not for permanent installation. Use only with outdoor equipment, Christmas-tree, or other seasonal decorative-lighting products having a total of 13 Ampere maximum. Do not install or use this product for more than a 90-day period.
- If using Christmas tree or decorative-lighting products that are not marked with an ampere rating, connect no more than 140 screw-base lamps (C7 or C9) or 12 strings with midget (push-in) lamps to this cord set.
- Cord sets must be plugged into a GFCI-protected receptacle.
- If using an outdoor-use cord set for an extended period of time (greater than 90 days) please consider hard wiring a permanent outdoor-use receptacle rated for year-round use in the area that power is needed. Please contact a licensed electrician for proper installation of permanent wiring.
- After completion of installation, the connector shall be maintained a minimum of 6 in. above ground.
- SUITABLE FOR INDOOR/UTDOOR USE – STORE INDOORS WHILE NOT IN USE.

Federal Communication Commission Interference Statement

This equipment has been tested and found to comply with the limits for Class B digital device, pursuant to part 15 of the FCC Rules. These limits are designed to provide reasonable protection against harmful interference in a residential installation. This equipment generates, uses and can radiate radio frequency energy and, if not installed and used in accordance with the instructions, may cause harmful interference to radio or television reception, which can be determined by turning the equipment off and on, the user is encouraged to try to correct the interference by one or more of the following measures:

- Reorient or relocate the receiving antenna.
- Increase the separation between the equipment and the receiver.

- Connect the equipment into an outlet on a circuit different from that to which the receiver is connected.
- Consult the dealer or an experienced radio/TV technician for help.

This device complies with Part 15 of the FCC Rules. Operation is subject to the following two conditions: (1) This device may not cause harmful interference, and (2) this device must accept any interference received, including interference that may cause undesired operation.

FCC Caution: Any changes or modifications not expressly approved by the party responsible for compliance could void the user's authority to operate this equipment.

One Year Limited Warranty

Supported by our professional R&D team and QC team, we provide One Year Warranty for materials and workmanship from the purchase date. Please note that the warranty does not cover damage caused by personal misuse or improper installation.

Please attach your Order ID and Name so that our dedicated customer service team can help you better.

