

Jewenwils

Automatic Water Timer

SKU: HDWT02A
[Instruction Manual]

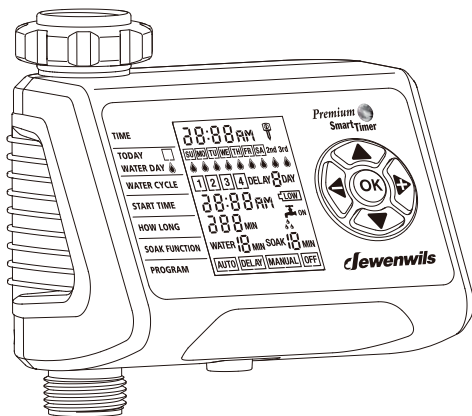

Please pay attention to the warning signs
Read the instructions with caution before operating
and keep it properly

Warning:

- Do not use for industrial purposes or in conjunction with chemicals, foodstuffs and explosive materials.
- Only use clear fresh water.
- Do not pull the hose connected to the Water Timer.
- Children are not allowed to use the water timer without supervision.
- When expecting freezing temperatures, timers should be removed from the hose faucet and stored indoors to avoid potential freeze damage.
- Do not disassemble or repair the product, but only by authorized service personnel.

Features

• Eco Function

You can set any time period to pause and start watering intermittently in your watering time.

• Rain Delay Function

Built-in rain delay pauses your programmed schedule for 1-6 days.

• Manual Override On/Off

Manual mode allow instant watering use without interrupting your set irrigation program.

Product Layout

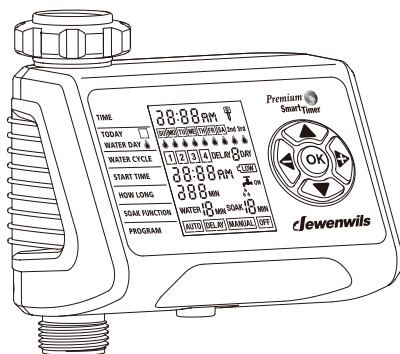

Battery Installation

Install 2AA Alkaline batteries by removing the battery holder from the back of the water timer and insert the battery as indicated. Replace the battery holder, making sure that is firmly and securely placed in the water timer.

Please replace batteries when the indicator reaches **LOW**

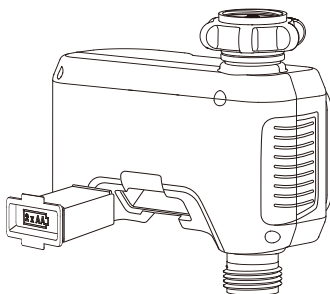

Note:

1. In order to stop the water timer from failing because of a weak battery, if you are away for a long time, the battery must be replaced when the battery still shows "LOW".
2. Do not dispose of batteries in fire. Batteries may explode or leak.

Installation

step1

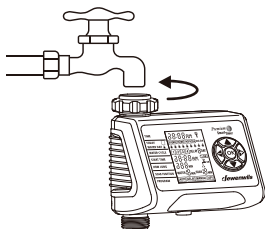

step2

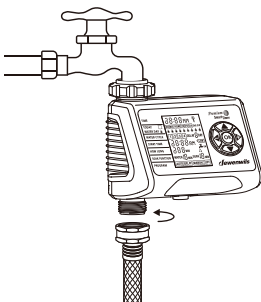

Current Time Setting

1. Set Current Time

When the time line flash,

Press the “-”/“+” button to decrease/increase time to the current time;

Press the “▼” or “OK” button to confirm.

2. Set Current Day

Press the “-”/“+” button to move the indicator “[]” to today’s day of week.

(e.g. “TU” for Tuesday);

Press the “▼” or “OK” to confirm.

Note: Clock is set on 12-hour time. To change to 24-hour time, press the “OK” for 10 seconds. To return to 12-hour time, press the “OK” for 10 seconds again.

Programming

1. Select Water Day

There are 3 kinds of watering day setup for better selection.

a. Fixed Weekday Watering

Press the “-”/“+” to move the flashing tear drop “” to the desired watering day;

Press the “OK” to confirm or cancel the watering day.

b. Every Other Day

c. Every Other 3 Day Watering

2. Select Water Cycle 1

a. Press the “-”/“+” to move the indicator “[]” to “1” and press the “▼” or “OK” to start setting up the first watering cycle [1].

b. Set Start Time

Press the “-”/“+” to decrease/increase time to the required watering start time;

Press the “▼” or “OK” to confirm to next step.

c. Set How Long

Press the “-”/“+” to decrease/increase time to duration (Up to 240 minutes);

Press the “▼” or “OK” to confirm to next step.

d. Activate Eco Function: simply set up WATER and PAUSE MIN.

d-1. Set up WATER MIN:

Press the “-”/“+” to decrease/ increase the WATER duration (the maximum interval is 19MIN)

d-2. Set up PAUSE MIN:

Press the “-”/“+” to decrease/ increase the PAUSE duration (the maximum interval is 19MIN). The Eco Function creates a pause watering cycle, which provides absorption time for the soil. It can also prevent water run-off.

Note: You can skip the step d(d-1 and d-2) if not needed.

Once the Eco function is activated, the set interval is applied on all the set water cycles.

3. Routing the Set up of water Cycle 1,2,3,4.

Now you have completed all the programming.

Activate Programming

To active the setting, the water timer should be in AUTO mode.

1. Press the “-”/“+” to move the indicator “[]” to “AUTO”;
2. Press the “▼” or “OK” to confirm AUTO.

Rain Delay Mode

If there is a rain in the forecast, you can temporarily suspend your watering program on both zones for up to 6 days using the Rain Delay feature.

1. Confirm the [] is in the PROGRAM line;
2. Press the “-”/“+” to move the indicator “[]” to “DELAY” and press the “OK” button;
3. Press the “-”/“+” to decrease /increase the “DELAY DAY”;
4. Press the “▼” or “OK” twice to confirm.

Manual Watering

During non-watering time, you may activate this mode to start watering.

1. Press the “-”/“+” to move the indicator “[]” to “MANUAL”;
2. Press the “▼” or “OK” to confirm to start the manual mode “[MANUAL]”;
3. Programming: routine the programming steps as following:
 - a. Set How Long;
 - b. Activate ECO Function: simply set up “WATER” and “PAUSE MIN”;

Note: you can skip the step “c” if not needed;

Disable the Program

In the case of suspending automatic watering for an extended period.

Press the “-”/“+” to move the indicator “[]” to “OFF” and press “OK” to confirm.

Specifications

- Watering Duration: 1min-240min
- Max. Water Pressure: 120 psi
- Battery: 2 x AA batteries (not included)

Packing List

- Water Hose Timer x 1
- Instruction Manual x 1

One Year Limited Warranty

Supported by our professional R&D team and QC team, we provide One Year Warranty for materials and workmanship from the purchase date. Please note that the warranty does not cover damage caused by personal misuse or improper installation.

Please attach your Order ID and Name so that our dedicated customer service team can help you better.