

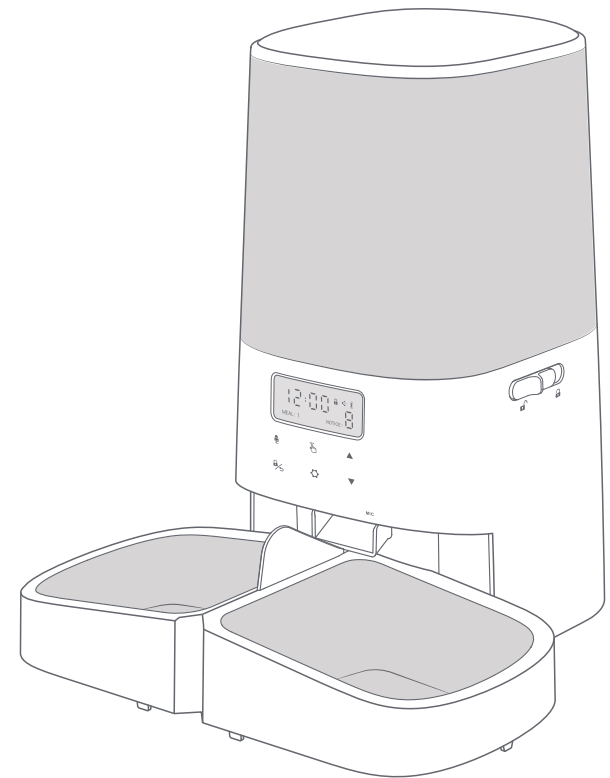

Questions or Concerns?

 support@garfeur.com

 www.garfeur.com



Manufacturer: Shenzhen Mingrun Network Technology Co., Ltd.
Address: Building 2, TOD Technology Center, Bantian Street, Longgang District, Shenzhen

Made in China Rev_1.0_EN



Automatic Pet Feeder

Model: GF-PS001
User Manual

CONTENTS

IMPORTANT SAFETY INSTRUCTIONS	01
EXPLORING YOUR PET FEEDER	02
USING YOUR PET FEEDER	07
CARE AND CLEANING	11
TROUBLESHOOTING	15
WARRANTY AND SERVICE	16

IMPORTANT SAFETY INSTRUCTIONS

READ ALL INSTRUCTIONS BEFORE USE AND SAVE FOR FUTURE REFERENCE

When using an electrical appliance, especially when children are present, basic safety precautions should always be followed, including the following:

INTENDED USE

- Close supervision is necessary when any appliance is used by or near children. Children should be supervised to ensure that they do not play with, in or around the appliance.
- Intended for use with dogs or cats only. Do not use this pet feeder with puppies, kittens, dogs or cats not able to reach the food tray or with any physical disability.
- Use the appliance only for intended household purposes as described in this User Manual.

ELECTRICITY SAFETY

- **DO NOT** operate the appliance if it has a damaged power cord or plug, or if it is malfunctioning or has been damaged in any manner.
- **DO NOT** immerse power cord, plugs, or the device base in water or other liquid or allow moisture to come into contact with these parts.
- To reduce the risk of electrical shock, do not place or store an appliance where it can fall or be pulled into a tub or sink.
- Always unplug the appliance when not in use, before putting on or taking off parts and before cleaning. Never unplug by pulling on power cord.
- Use **ONLY** the provided power adapter and charging cable.

RELATED TO USE

- **DO NOT** attempt to disassemble, repair, modify or replace any part of your product. All servicing should be performed by qualified personnel only. No user serviceable parts inside.
- **DO NOT** allow pets to chew on or swallow any parts. Cover or hide the power cord with care to prevent pets from biting.
- **DO NOT** lift the pet feeder by lid, hopper, bowl or bowl holder. Lift and carry feeder using both hands and hopper base, while keeping unit in upright position.
- Install or store pet feeder on a level surface against wall or in a corner to avoid tripping.
- For dry food use only. Do not use wet, canned, moist food or pet food with special shapes, holes or diameter above 12mm/0.47 inch.
- Install 3 alkaline D batteries (not included) for back-up power in case of a power outage.
- Before leaving for extended time, always replace batteries with new batteries. Check operation frequently to be sure the pet feeder is dispensing properly.
- Dispose of all packaging materials properly. Keep away from children and pets.

SAVE THESE INSTRUCTIONS

Exploring Your Pet Feeder

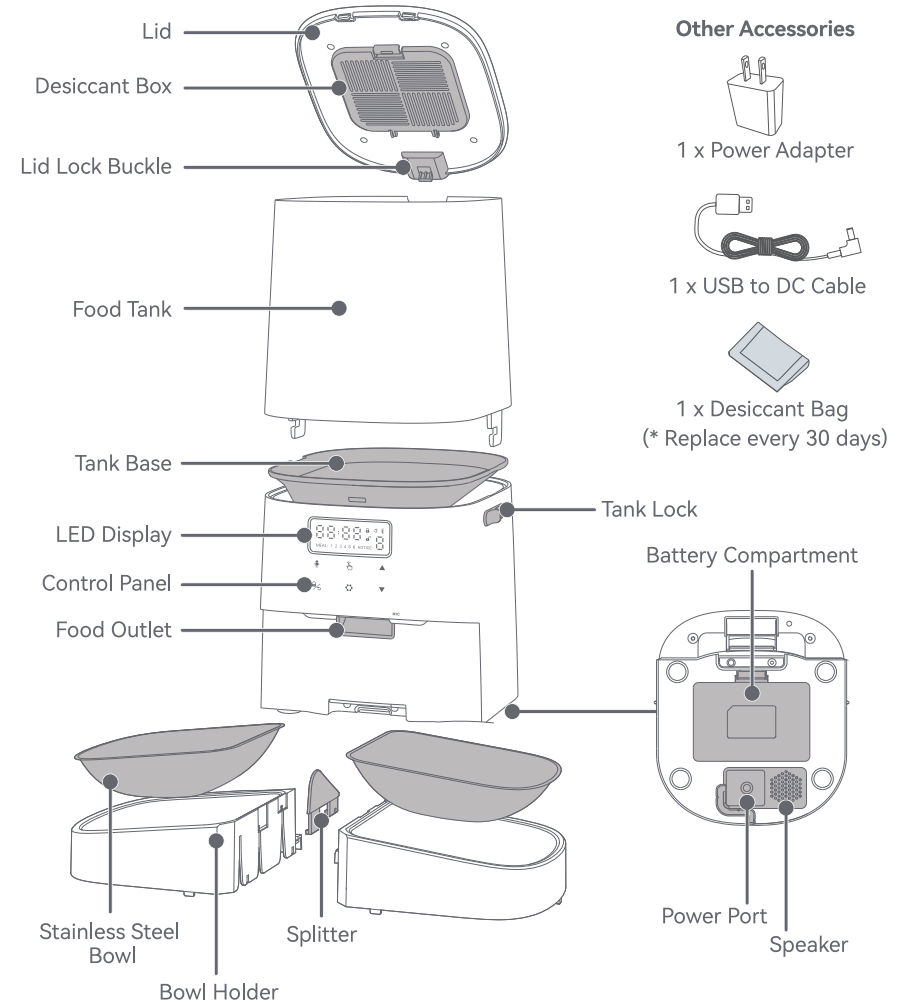

Specifications

Capacity	5L / 1.32 Gal
Applicable Kibble	0.07-0.47 inch / 2-12 mm dry food
Power Supply	DC 5V Power Adapter 3 x Alkaline D Battery (not included) for backup

Assembling Your Pet Feeder

1 Press lock buckle to open lid. Take out all accessories and remove all packing materials.

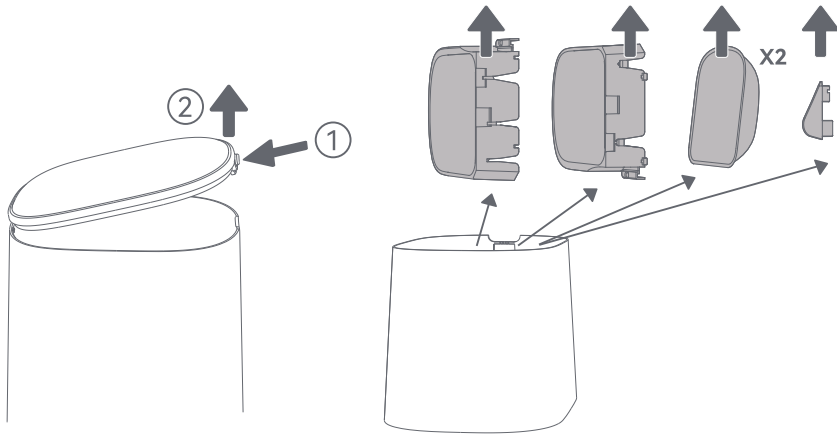

2 Plug in DC cable. Install 3 D batteries (not included) for back-up power in case of a power outage.

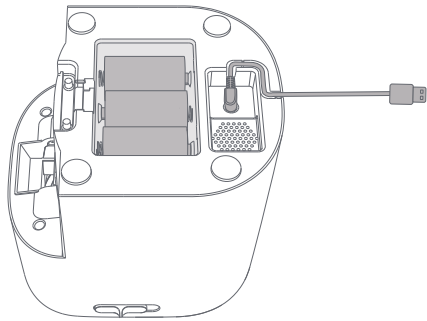

3 Align the notches and snap splitter into the left bowl holder.

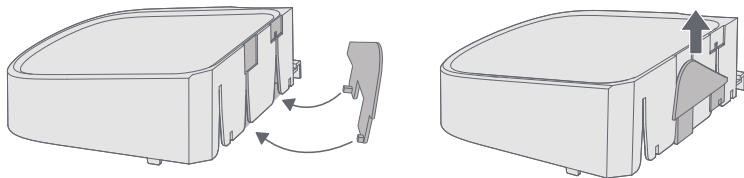

4 Align the notches and snap the right holder into the left one.

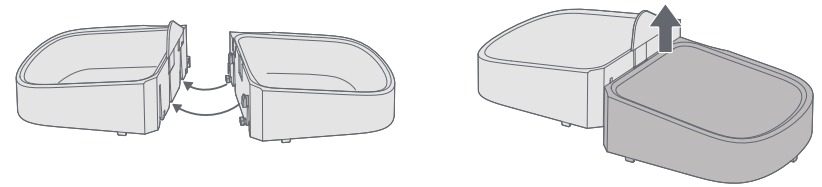

5 Place bowls in bowl holders. Lift feeder and attach the bowls to the notch underneath the base.

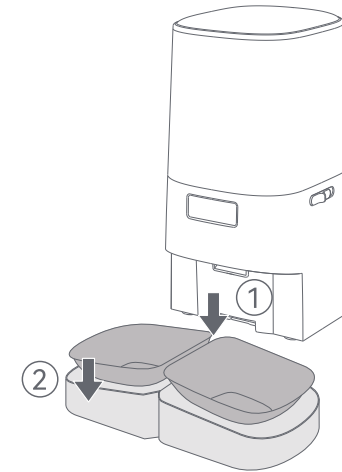

6 Take desiccant bag out from packaging, open desiccant box and place it in. Put the lid back on.

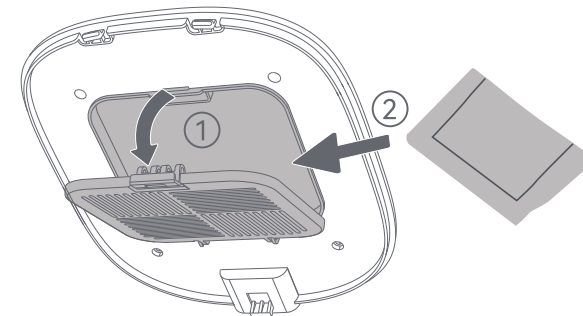

LED Display

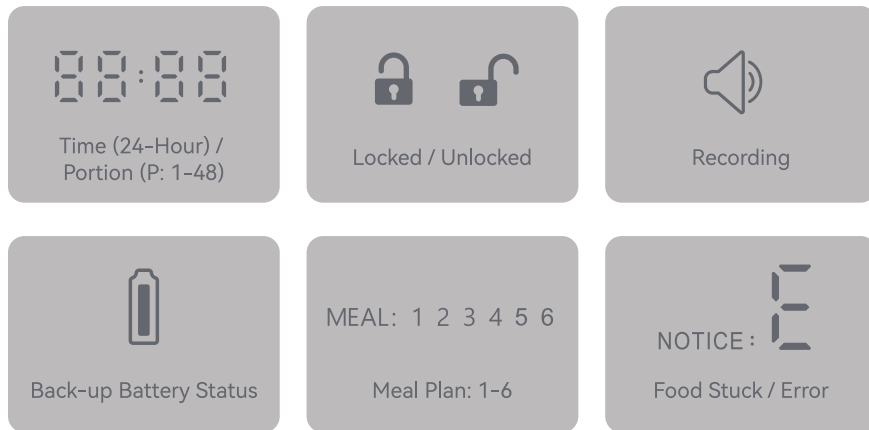
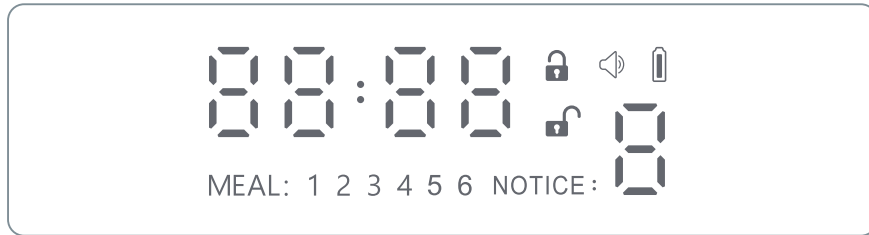

Control Panel

Recording



Unlocked Status:

- Hold for 2s until a beep is heard to start recording (Max. 10s) and release to stop.
- Double tap to play.
- Triple tap (within 1s) to turn on/off recording function.

Manual Feeding





Unlocked Status:

- Tap once to dispense one portion of food. Tap repeatedly to dispense more portions.

Increase



Unlocked Status:

- Tap to increase number.
- Hold  and  for 7s to restore to factory settings.

Locked Status:

- Tap to check feeding plan.

Lock / Unlock / Return



- Hold for 3s to lock or unlock the control panel.

- Auto lock if no operation is done in 60s.
- During setting, tap to return to the previous step.

Settings



Unlocked Status:

- Hold for 2s to set current time.
- Tap once to set meal plan.
- During setting, hold for 2s to confirm and exit.

Decrease



Unlocked Status:

- Tap to decrease number.

Locked Status:

- Tap to check feeding plan.

Using Your Pet Feeder



- Make sure that pet feeder is properly installed before filling the food tank.
- Unlock first (hold  for 3s) before using the control panel.

Manual Feeding

- 1 Fill food tank with dry pet food (0.07-0.47 inch). Cap the lid back and press to snap in place.

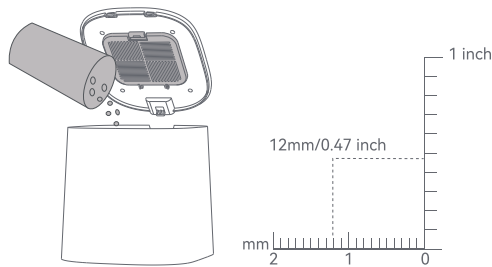

- 2 Plug in the included power adapter. The LED display will light up indicating the feeder is on.

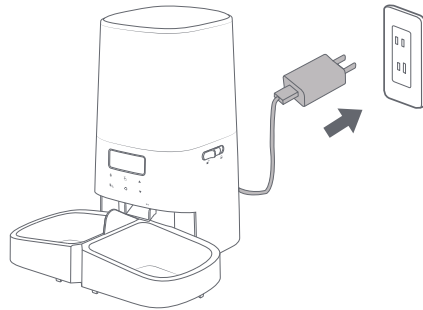

- 3 With the feeder unlocked, tap  once to feed 1 portion manually. You can also set automatic feeding plan as follows.

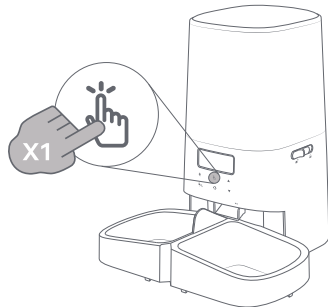

Manual Feeding



Automatic Feeding Plan

Scheduling Feeding Plan

If no feeding plan is set, the feeder will carry out the default feeding plan as follows.





Meal	1	2	3
Time	8:00	12:00	18:00
Portion	8	8	8



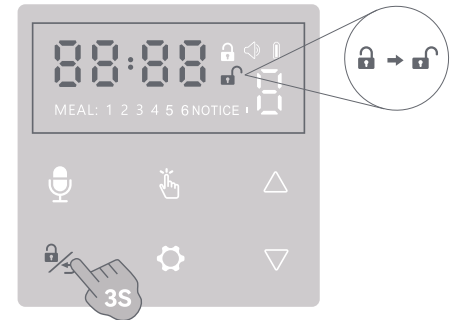

Step 1 - Setting Current Time

- 1 Hold  for 3s to unlock the control panel. If no operation is done in 60s, it will be locked again.

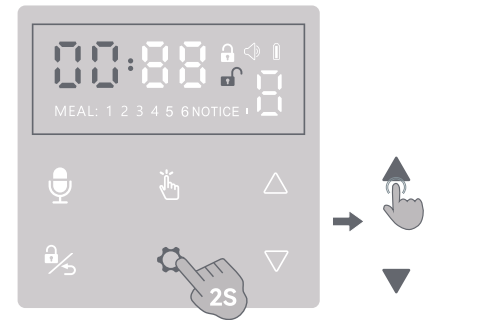

- 2 Hold  for 2s to enter current time setting. Tap  or  to adjust the hour.



- 3 Tap  once to save and move to minute setting. Tap  or  to adjust, then tap  to save and exit.

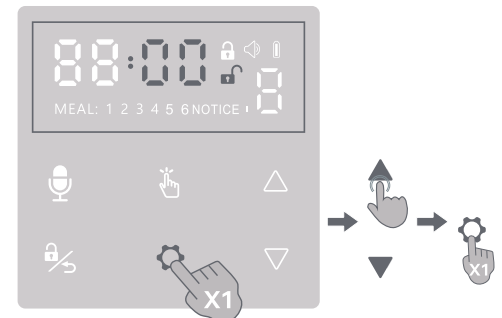

Step 2 – Setting Feeding Time & Portion

- 1 Tap once to enter feeding time setting (for MEAL 1). Tap or to adjust the hour.

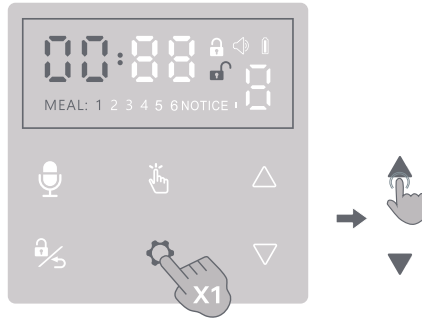

- 2 Tap once to save and move to minute setting. Tap or to the minute.

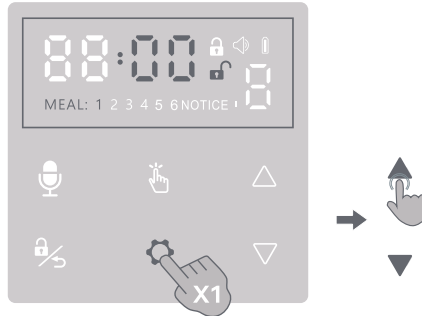

- 3 Tap once to save and move to portion setting. Tap or to adjust the portion (Max. 48) for meal 1.

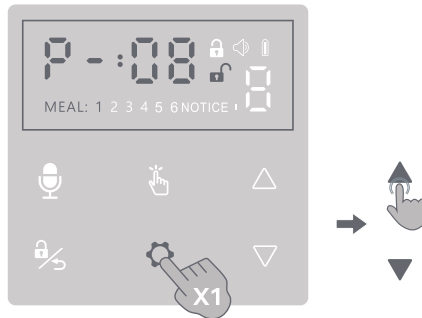

- 2 Tap once to save and repeat for the rest meals (2~6). Or you can hold for 2s to save the current meal and exit.

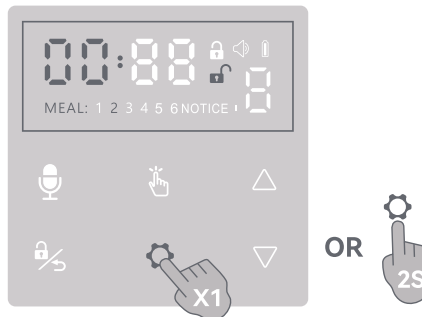

Repeat for Meal 2~6

OR Save and Exit

Additional Features

Recording a Meal Call

- 1 In the unlocked status, hold for 2s until a beep is heard. Keep holding to record your voice (Max. 10s). Release to end or record for 10s.
- 2 The recording plays automatically. You can also tap twice to play manually.
- 3 To turn on/off recording function, tap three times within 1s.

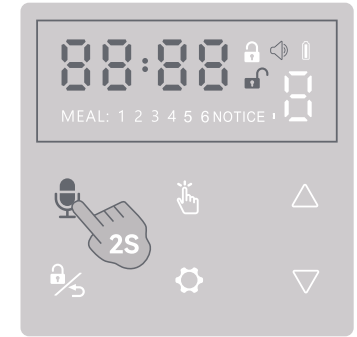

Clearing All Settings

- 1 In the unlocked status, hold and simultaneously for 7s until a beep is heard to restore to factory settings.
- 2 The recording will not be cleared. To update the meal call, hold to record a new one.

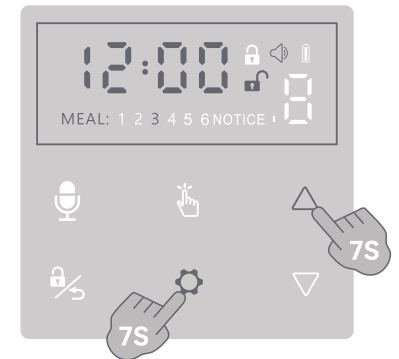

Memory Function

Prevents the current time and your meal schedule from getting lost when the power is off.

Care and Cleaning



- Always dry all parts thoroughly before reassembling for next use.
- It is recommended to clean the feeder regularly for the health of your pets.

Cleaning Bowls & Holders

- 1 Lift the feeder and remove the bowl holder.

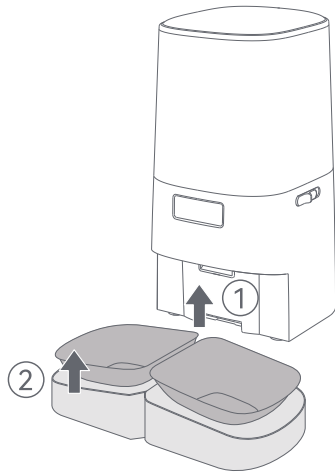

- 2 Rinse clean and air dry thoroughly.

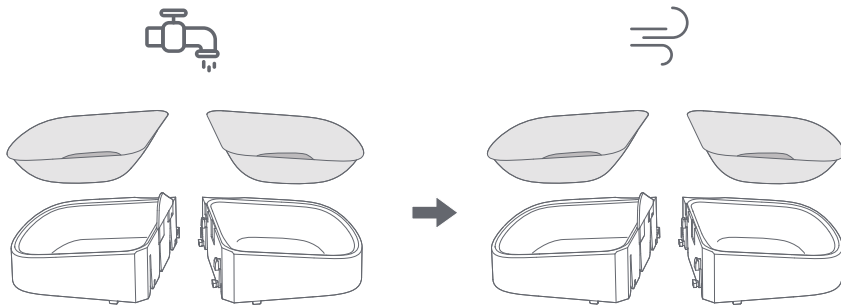

Cleaning Lid, Tank & Tank Base

- 1 In the unlocked status, hold ▲ and ▼ simultaneously for 3s until a beep is heard to unlock the food slider.

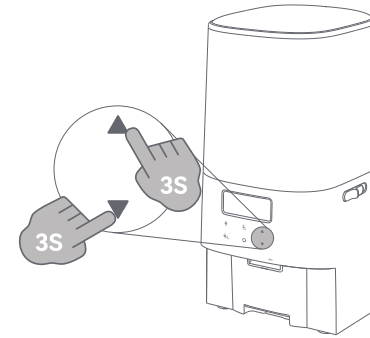

- 2 Press the lock buckle to open the lid. Take out the desiccant bag.

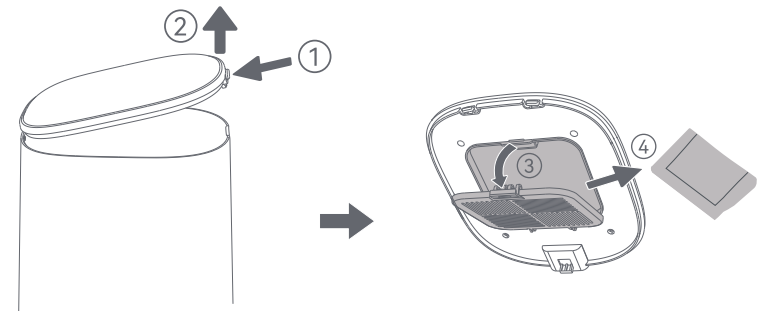

- 3 Slide the lock latches on both sides to  position to remove the tank and tank base.

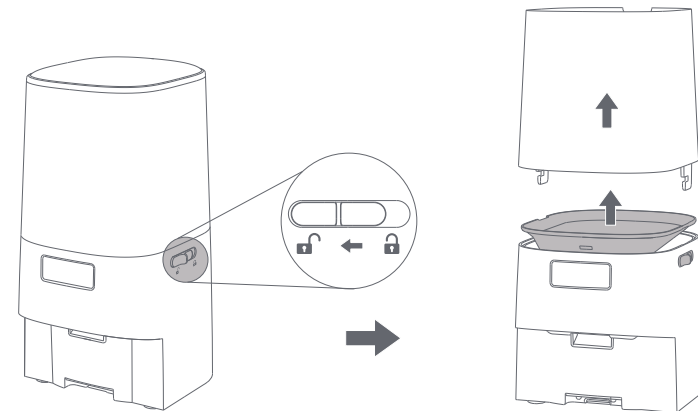

- 4 Rotate the four lock latches to unlocked position, then take out the food slider.

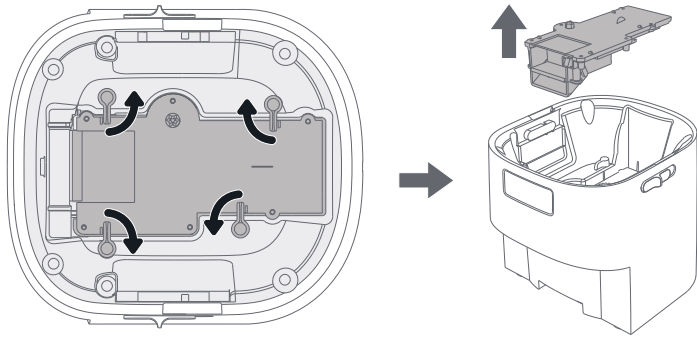

- 5 Rinse clean the lid, tank, tank base and food slider. Dry thoroughly before reassembling.

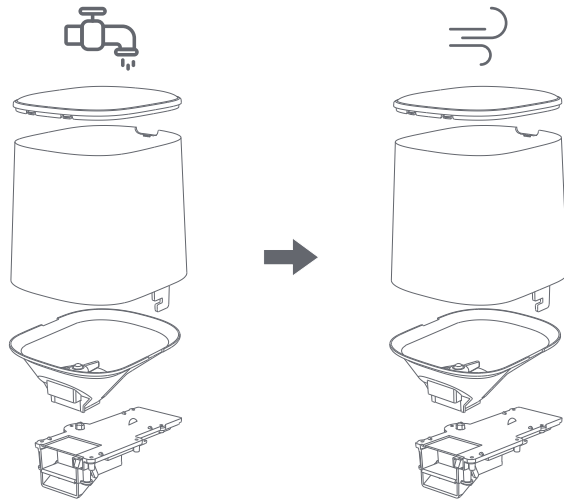

- 6 Wipe the base with a soft and damp cloth. Do not rinse or immerse in water.

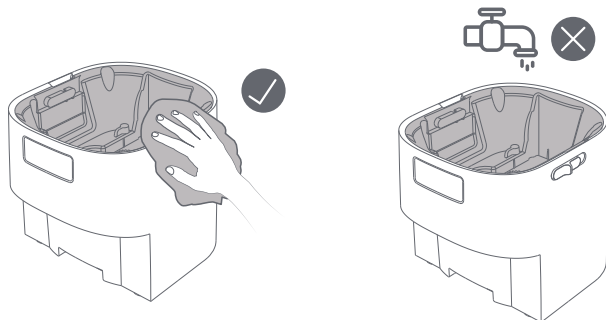

- 7 Hold the food slider and place it back to the base. Rotate the lock latches to lock the slider in place.

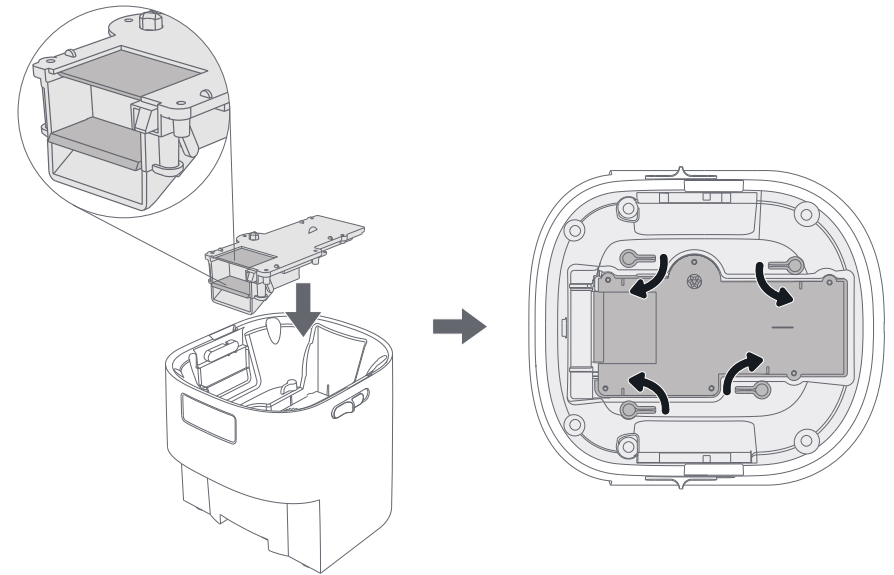

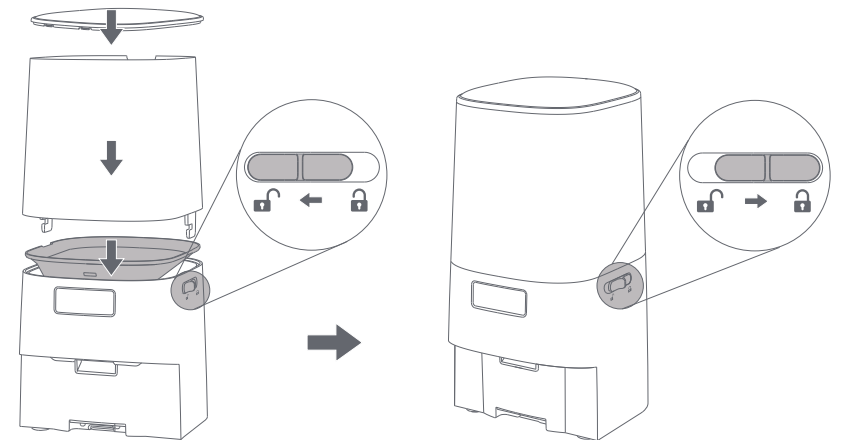

- 8 Align the grooves on both sides and install the tank base, tank and lid back.



Troubleshooting

The troubleshooting guide addresses the most common problems. If problems persist, feel free to contact the Customer Support at support@garfeur.com

Q: LED display OFF.

- A:**
- Check if the pet feeder is properly connected to a powered electrical outlet with the included cable and power adapter.
 - If no operation is done in 60s, the screen will be locked (only  on). Hold  for 3s to unlock and wake up the screen.

Q: Control buttons are not responsive.

- A:** Make sure the control panel is not locked. Unlock first (hold  for 3s) before using the control panel.

Q: Food does not come out.

- A:**
- Be sure to add dry food with size of 0.07-0.47 inch (2-12mm) in diameter.
 - Remove the food tank to check if the tank base is properly installed.
 - Check if the food is stuck or food outlet is blocked.
 - Check if the pet feeder is properly connected to a powered electrical outlet or if outage occurs with no back-up batteries installed.

Q: Cannot hear any voice when feeding.

- A:** Make sure you have recorded successfully. Unlock the control panel, double tap  to play. If no sound is heard, you may need to record again as instructed in Recording a Meal Call.

Warranty and Service

Thank you for choosing Garfeur Automatic Pet Feeder. This product is covered with Garfeur product and labor warranty for 12 months from the date of its original purchase.

The warranty will not apply in cases of:

- Accident, misuse, or repairs performed by unauthorized personnel.
- Any unit that has been tampered with or used for commercial purpose.
- Normal wear and tear of wearable parts.
- Use of force, damage caused by external influences.
- Damage caused by non-observance of the User Manual, e.g. connection to an unsuitable mains supply or non-compliance with the instructions.
- Partially or completely dismantled appliances.
- Defects caused by or resulting from damages from shipping or from repairs, service, or alteration to the product or any of its parts that have been performed by a repair person not authorized.

We can only provide after sales service for products that are sold by Garfeur or Garfeur authorized retailers and distributors. If you have purchased your unit from a different place, please contact your seller for return and warranty issues.

* Please have your invoice and order ID ready before contacting Customer Support.

FCC Compliance

This device complies with Part 15 of the FCC Rules. Operation is subject to the following two conditions: (1) this device may not cause harmful interference, and (2) this device must accept any interference received, including interference that may cause undesired operation.