



RV/MARINE WATER PRESSURE PUMP

INSTRUCTION

5 4 0 E / 5 3 0 E / 5 4 0 F / 5 3 0 F

with Warranty Card



Cautions

1. After unpacking the pump, please check if it has been damaged during transport. If so, please contact TDRFORCE online services at the first time.
2. Make sure that the main voltage corresponds to the voltage specified on the instruction manual.
3. The motor must be absolutely grounded before any other operation.
4. Do not submit the pump body to mechanical stress.
5. The pump must be sheltered from weather (sun- rain- wind- snow- chill).
6. The pump could be only used in fresh water circulating.
7. The pump should be installed on a solid surface.
8. The pump should be connected to proper sized wiring.

9. The pump should be installed under proper electrical protection.

10. The pump should be installed in minimized flow restrictions in the system.

Technical Specifics

MODEL	VOLTS	CHAMBERS	Pressure (PSI)	Pressure (BAR)	FLOW RATE	H-MAX	REV	POWER	CERTIFICATION	MOTOR LIFE	CONTINUOUS WORKING TIME
540E	110V AC	4	75	5.1 BAR	5.5 GPM	170FT	2400rpm	172.5W	CE	more than 1500 hours	40mins
540F	12V DC	4	70	4.8 BAR	5 GPM	157FT	2300rpm	180W	CE	more than 1500 hours	40mins
530E	110V AC	3	45	3.1 BAR	4 GPM	102FT	2400rpm	143W	CE	more than 1500 hours	40mins
530F	12V DC	3	45	3.1 BAR	4 GPM	102FT	2300rpm	105W	CE	more than 1500 hours	40mins

GENERAL INFORMATION

The patent has been designed for delivering smooth and consistent flow at all ranges of operation while drawing low current. The balanced motor design incorporates with precision ball bearings for long life, and is equipped with an integral thermal breaker. Full corrosion-resistant shell and environmental thermoplastic construction ensure less prone to mechanical failure. What's more, the submersible pump impeller blade features highly corrosion-resistant impeller that automatically adjusts to speed and fluid viscosity to ensure long service life.

Tips:

The manufacturer will do test for every single product, for which a small amount of water may remain in the pump. This does not mean that the pump has been used.

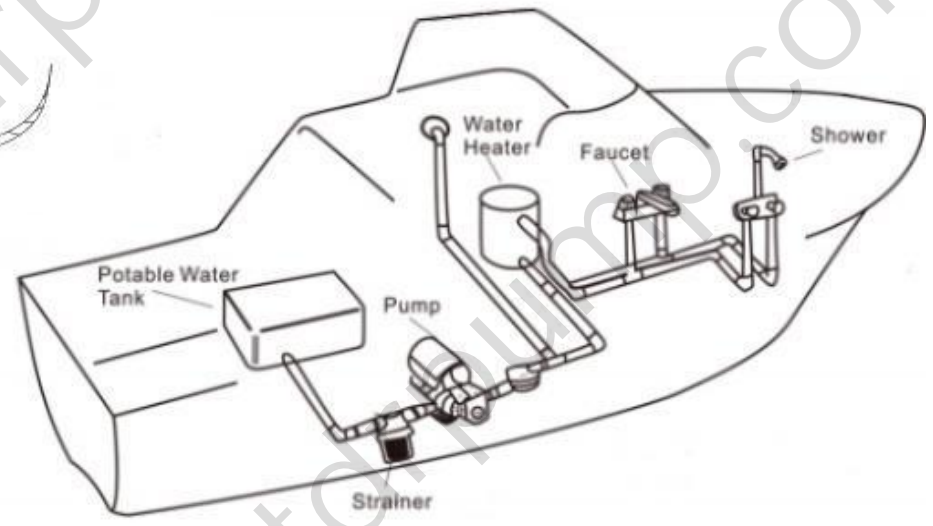
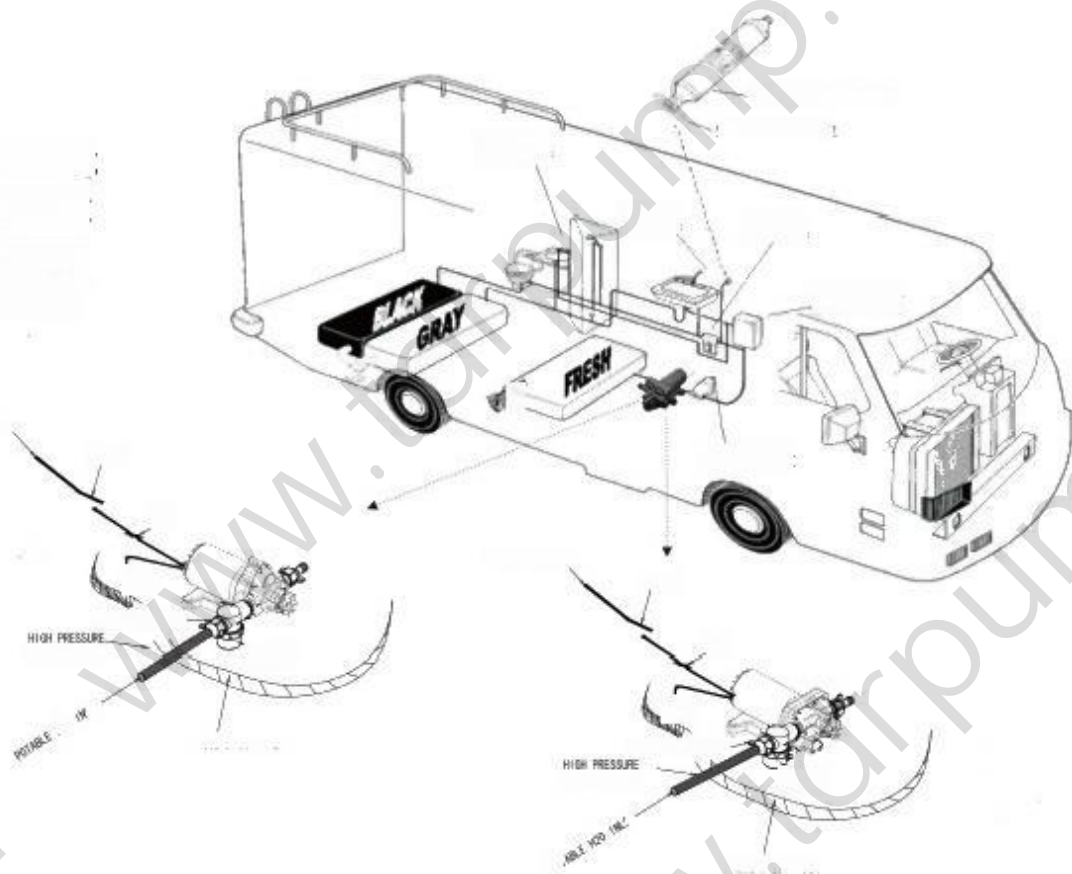

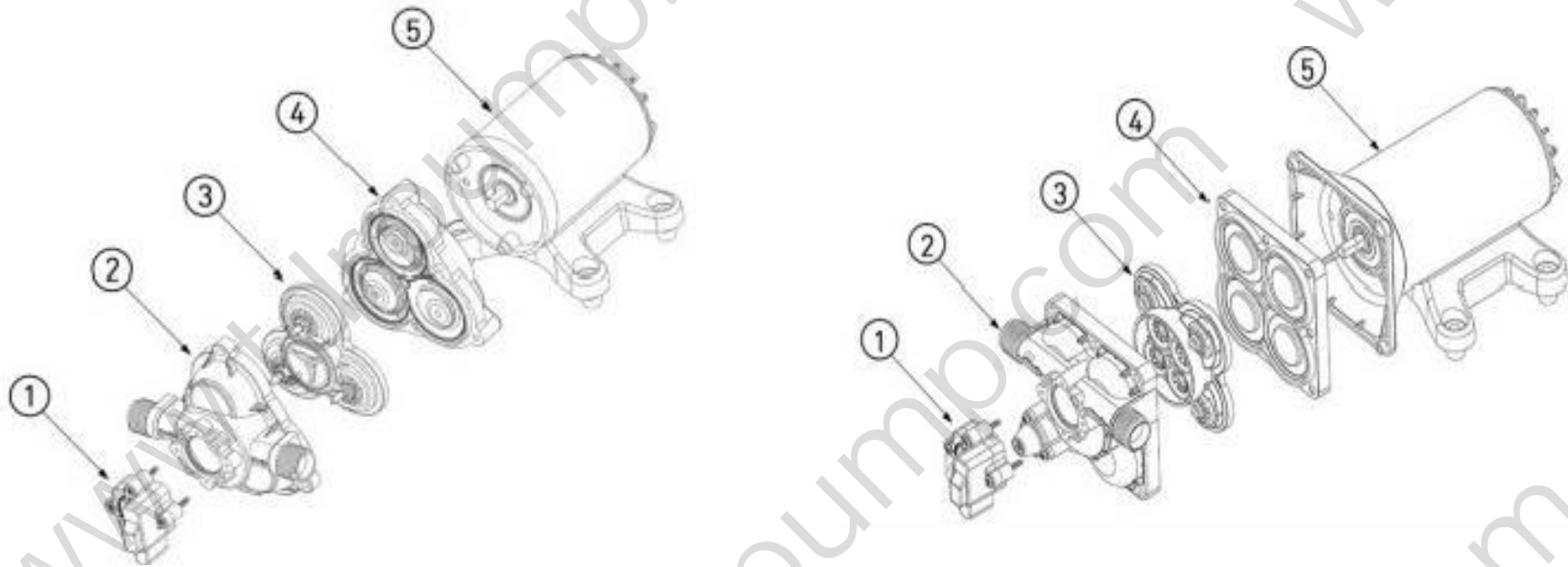

NO	Component
1	Pressure switch
2	Pump head
3	Valve plate assembly
4	Diaphragm/ Drive assembly
5	Motor

Troubleshooting

TYPE OF DEFECT	CAUSE	SOLUTION
The motor does not start	<ul style="list-style-type: none"> - False electric connections - Low inlet water pressure 	<ul style="list-style-type: none"> - Make sure the power cord is accurately plugged - Increase water flow of inlet
The motor is running, but no water pumped	<ul style="list-style-type: none"> - The operating voltage is unstable - The water inlet pipe is bent or attached to the barrel wall - Some blockages in the pump or motor 	<ul style="list-style-type: none"> - Ensure that the power source is in accord with the instructions - Unblock the pipeline to make the water run smoothly - Remove the blockages and avoid pumping impurity water
	<ul style="list-style-type: none"> - The water pump was used to pump corrosive liquid, which caused the 	<ul style="list-style-type: none"> - Avoid pumping corrosive liquids

	rubber sealing ring to shrink, expand, oxidize and become non-sealing.	
	- Thread damage of the screw	- Connect proper screw and seal with Teflon tape
Pump starts and stops frequently	- Diaphragm broken	- Disposal
Pump does not stop	- The pump is over-pressure - The pump does not provided sufficient pressure - Leakage on the outlet plumbing	- Adjust the pressure screw counterclockwise to release the pressure - Adjust the pressure screw clockwise to increase the pressure - Fix the leakage

Pump suddenly quit working	<ul style="list-style-type: none"> - Overheat protection starts - Power off - Motor burns out - Switch burns out 	<ul style="list-style-type: none"> - Restart the pump until it's cooling - Turn on again - Disposal - Disposal
Pump vibrates and operates noisily	<ul style="list-style-type: none"> - Air in the water inlet pipe 	<ul style="list-style-type: none"> - Fix the inlet leakage and make the pipes firmly connected
Pump head leakage	<ul style="list-style-type: none"> - Diaphragm broken. - The screw of the pump head is loose. - The bypass switch is loose. - Pump pressure setting is too high. - Pump head is damaged. 	<ul style="list-style-type: none"> - Disposal - Tighten the screw - Tighten the screw - Adjust the pressure switch. - Disposal
Pressure switch burned out	<ul style="list-style-type: none"> - Frequent on and off 	<ul style="list-style-type: none"> - Disposal

	<ul style="list-style-type: none"> - Pressure setting too high, overloaded operation 	<ul style="list-style-type: none"> - Adjust the pressure screw counterclockwise to release pressure
Pump supplies insufficient flow	<ul style="list-style-type: none"> - The diaphragm is jammed or blocked - The inlet flow rate is too small 	<ul style="list-style-type: none"> - Disposal - Increase the inlet water flow

Customer contact, please keep it properly.

Dear customer:

Thank you for choosing products of *TDRFORCE*. In order to provide you with more satisfactory service and better protect your rights, please read this regulation carefully and keep the warranty card properly.

Regulations:

1. For any quality issue of *TDRFORCE* product within 180 days after sale, we offer no-hassel return service for our customers;
2. Please contact our Amazon online customer service or sales04@tdrshine.com before return;
3. Valid evidence of purchase will be essential such as order ID or warranty card;
4. Valid evidence showing product problems shall be provided in the contact such as videos, photos or detailed descriptions.
5. Warranty card shall be filled out and attached with the return product.

Please notice:

The following situations are not applicable to our no-hassel return policy.

1. Product damage caused by installation or use not in accordance with the instruction manual;
2. Product beyond 180 days after sale;
3. Product return with no reason;
4. Product damage caused by self-disassembly or sabotage;
5. Product damage caused by force majeure such as earthquakes, fires, etc.



green power for life
www.tdrpump.com

Warranty Card

Buyer's Name: _____

Tel: _____

E-mail: _____

Order ID: _____

Return Address: _____

Product Problem Description:
