



# GT-Lite

**WARNING:**  
**TO AVOID RISK OF ELECTRICAL SHOCK**  
**TURN OFF OR DISCONNECT FROM POWER**  
**WHILE INSTALLING OR SERVICING UNIT**

**Installation Instructions: GT-FP-22BLPBLK-2PK | 2ft x 2ft 4200 Lumen LED Flat Panel Light**

**WARNING**



- When using product, basic precautions should always be followed.
- Read and follow these instructions and heed all warnings.
- Carefully read and understand the information given in this manual before beginning installation. Failure to do so could lead to electric shock, fire, or other injuries which could be hazardous or even fatal.
- Save these instructions and warnings.

**CAUTION**



- Compatible with TRIAC Dimmer switches
- Do not install on radiant heated ceiling.
- This item is designed for dry use and is not waterproof.
- Do not place this item in a humid or dusty environment.
- Do not use in areas with temperature higher than 104° Fahrenheit.
- Do not use in areas near a gas source.

## PRE-INSTALL

1. Before assembly compare package contents with list to make sure all parts are present.
2. Shut off power at circuit breaker before removing existing fixture. If you are unfamiliar with electrical installations, it is recommended to have a qualified electrician complete your installation.
3. Select suitable location that can support the weight of the fixture. Determine mounting method (Page 2.).
4. Using the Color Temperature Selection Switch to select the color temperature that best fits your environment. See Figure 11.

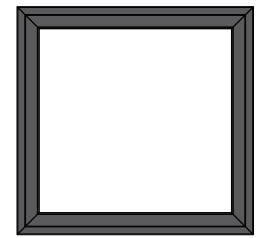

### Tools Required

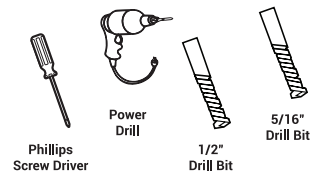

## HARDWARE

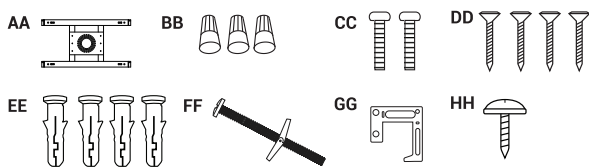

Part	Description	Qty	Part	Description	Qty
AA	Mounting Plate	1	EE	Drywall Anchors	4
BB	Wire Nuts	3	FF	Toggle Bolts	4
CC	Mounting Screws	2	GG	Drop Ceiling Clip	4
DD	Drywall Screws	4	HH	Small Screws	8

**Question/Comment/Missing Part?**

Contact GT-Lite 1-800-865-6799  
[www.gt-liteled.com](http://www.gt-liteled.com)





# GT-Lite

**WARNING:**  
TO AVOID RISK OF ELECTRICAL SHOCK  
TURN OFF OR DISCONNECT FROM POWER  
WHILE INSTALLING OR SERVICING UNIT

## Installation Instructions: GT-FP-22BLPBLK-2PK | 2ft x 2ft 4200 Lumen LED Flat Panel Light

### INSTALLATION INSTRUCTIONS

#### Flush Mount Install Option

1. Safety concern! Always turn off the power at the breaker when installing light fixtures.
2. Locate hot, neutral, and ground wires at installation location.
3. Attach the mounting plate to the junction box using the provided mounting screws (CC). Be sure your mounting plate (AA) is oriented in the desired direction for final light installation (Figure 1).
4. Using the installation plate as a guide, mark the four points to be used as anchor points for toggle bolts or drywall anchors (Figure 2).
5. Remove the mounting plate from the junction box and drill 1/2" holes for toggle bolts or 5/16" holes for drywall anchors.
6. Place wires from the junction box through the main hole of the mounting plate.
  - For toggle bolt mounting: Attach bolts to the mounting plate before re-attaching the plate to the junction box (Figure 3). Feed toggle bolts through the drilled holes and tighten after clips have expanded behind the mounting surface (Figure 4).
  - For drywall anchors: Insert the drywall anchors into the 5/16" holes before re-attaching the mounting plate to the junction box. Screw drywall screws into anchor through the mounting plate holes to secure the plate completely.
7. Attach safety wires on flat panel light to their corresponding hooks on the mounting plate.
8. Connect the corresponding wires from the junction box to the flat panel light through the knockout in the mounting plate using the provided wire nuts. Black supply wire to the fixture's black wire, white neutral wire to the fixture's white wire, and grounding wire to the fixture's yellow green grounding wire. It is recommended to insulate with electrical tape for added security by wrapping the electrical tape around and below the wire nut connection.
9. Slide the LED flat panel light into the non-beveled mounting brackets. Once in position raise the LED flat panel light into position so that it is flush with the mounting surface (Figure 5). Push the LED flat panel so that it slides into the beveled mounting brackets on the mounting plate. Test to make sure that it is securely attached (Figure 6).
10. Return power to the fixture to ensure it operates properly.
11. On the side of the flat panel light, select the desired color temperature and wattage using the built in switch.

Figure 1

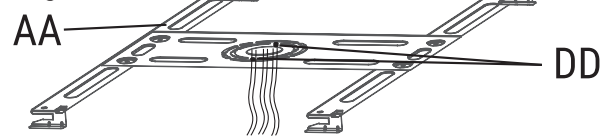

Figure 2

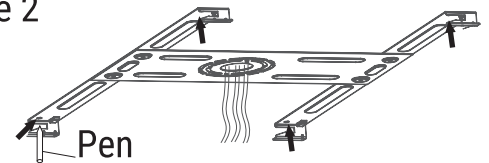

Figure 3

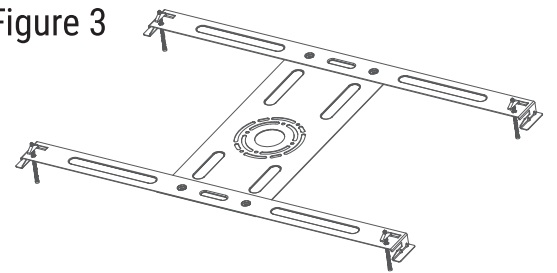

Figure 4

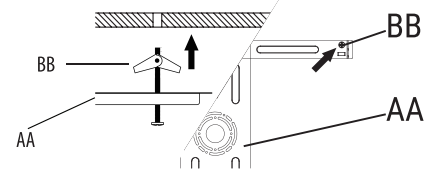

Figure 5

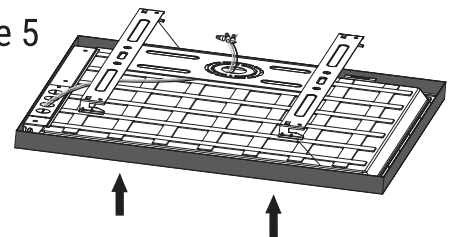
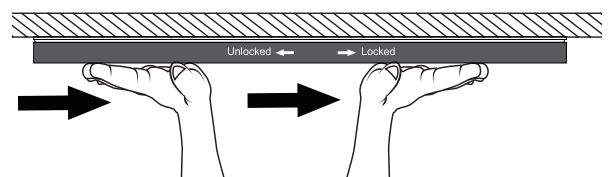

Figure 6



**Question/Comment/Missing Part?**

Contact GT-Lite 1-800-865-6799  
[www.gt-liteled.com](http://www.gt-liteled.com)





# GT-Lite

**WARNING:**  
**TO AVOID RISK OF ELECTRICAL SHOCK**  
**TURN OFF OR DISCONNECT FROM POWER**  
**WHILE INSTALLING OR SERVICING UNIT**

## Installation Instructions: GT-FP-22BLPBLK-2PK | 2ft x 2ft 4200 Lumen LED Flat Panel Light

### INSTALLATION INSTRUCTIONS

#### Drop Ceiling Install Option

1. Safety concern! Always turn off the power at the breaker when installing light fixtures.
2. Place the LED light, into the open ceiling space of your choosing (Figure 7).
3. Remove the small screws (HH) from each corner. Attach the drop ceiling clips (GG) where the screws were removed with the small screws (HH). Fold the four clips, so the clip is perpendicular to the flat panel light (Figure 9).
4. Set the Light into place by connecting each clip to the frame of the drop ceiling.
5. With the light safely placed on the ceiling, removed the metal plate from the LED flat panel light's junction box, and remove the metal knockouts.
6. Connect the corresponding wires from the junction box to the flat panel light through the knockout in the mounting plate using the provided wire nuts (Figure 9). Black supply wire to the fixture's black wire, white neutral wire to the fixture's white wire, and grounding wire to the fixture's yellow green grounding wire. It is recommended to insulate with electrical tape for added security by wrapping the electrical tape around and below the wire nut connection.
7. Once power is connected, re-attach the metal plate to the junction box (Figure 10).
8. Return power to the fixture to ensure it operates properly.

Figure 7

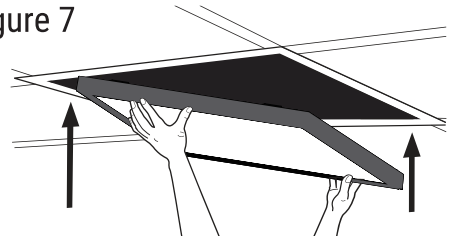

Figure 8

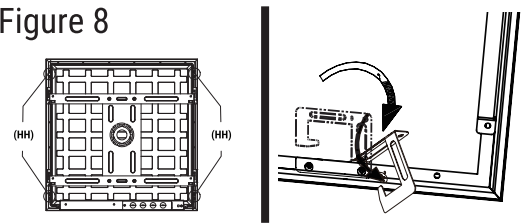

Figure 9

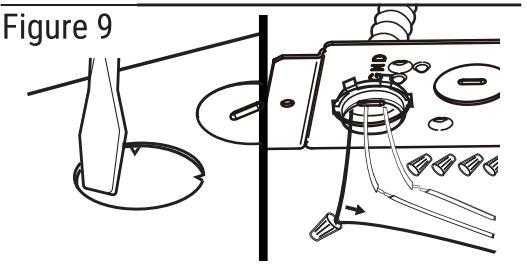
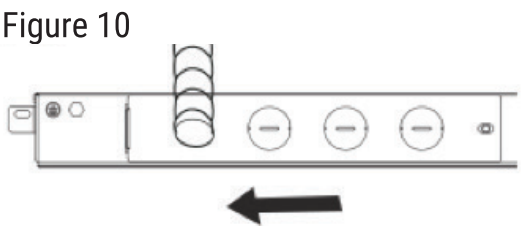

Figure 10



### TROUBLESHOOTING

Problem	Possible Cause	Solution
The fixture does not light.	The power is off.	Check that the power supply is ON.
	There is a bad wire connection.	Check the wiring.
	The switch is defective.	Test or replace the switch.
Circuit breaker trips when power is sent to the light.	Incorrect wire connections, or hot wires are grounding out.	Ensure wires are connected correctly.
Dimmer switch does not work.	Incompatible dimmer switch	Check compatibility chart on the next page.

**Question/Comment/Missing Part?**

Contact GT-Lite 1-800-865-6799  
[www.gt-liteled.com](http://www.gt-liteled.com)





# GT-Lite

**WARNING:**  
 TO AVOID RISK OF ELECTRICAL SHOCK  
 TURN OFF OR DISCONNECT FROM POWER  
 WHILE INSTALLING OR SERVICING UNIT

**Installation Instructions: GT-FP-22BLPBLK-2PK | 2ft x 2ft 4200 Lumen LED Flat Panel Light**

Figure 11

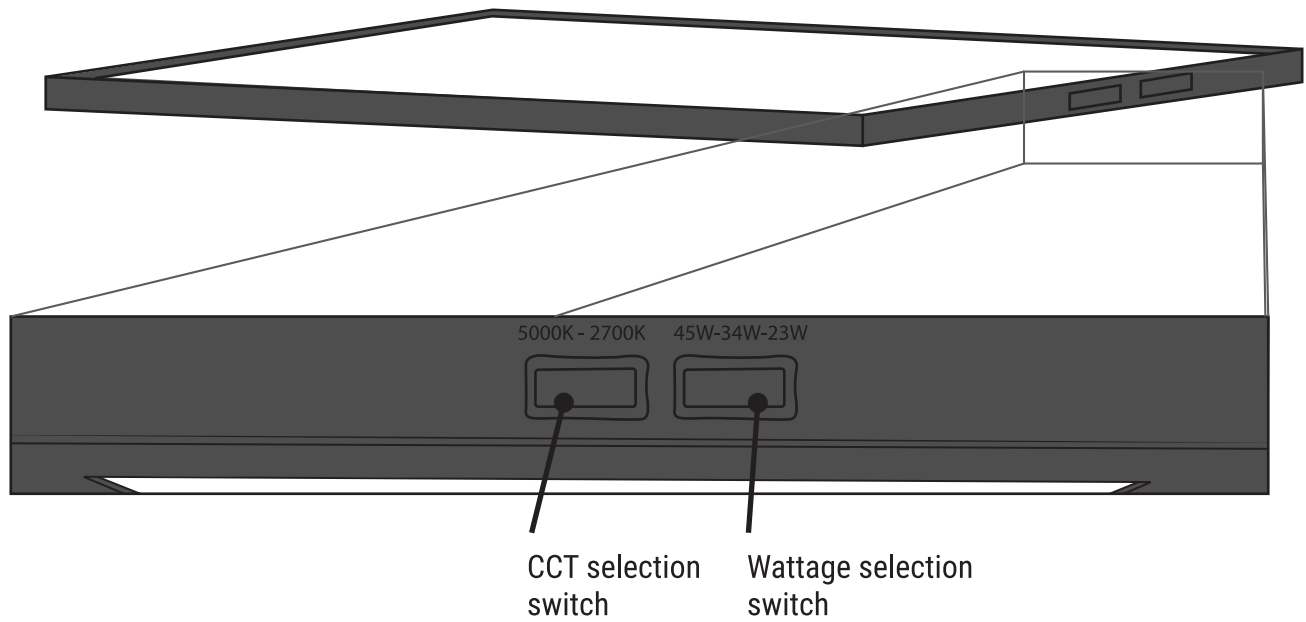

Selectable Color Temperature	LOW (23 WATTS)	MEDIUM (34 WATTS)	HIGH (45 WATTS)
2700K (WARM WHITE)	1910 Lumens	2610 Lumens	3600 Lumens
3000K (SOFT WHITE)	2030 Lumens	2740 Lumens	3700 Lumens
3500K (NEUTRAL)	2090 Lumens	2800 Lumens	3850 Lumens
4000K (BRIGHT WHITE)	2140 Lumens	2950 Lumens	4200 Lumens
5000K (DAYLIGHT)	2160 Lumens	2970 Lumens	4200 Lumens

**Question/Comment/Missing Part?**

Contact GT-Lite 1-800-865-6799  
[www.gt-liteled.com](http://www.gt-liteled.com)





# GT-Lite

**WARNING:**  
TO AVOID RISK OF ELECTRICAL SHOCK  
TURN OFF OR DISCONNECT FROM POWER  
WHILE INSTALLING OR SERVICING UNIT

**Installation Instructions: GT-FP-22BLPBLK-2PK | 2ft x 2ft 4200 Lumen LED Flat Panel Light**

## CARE AND CLEANING

Your fixture is made from quality materials that will last many years with minimal care. You may want to periodically clean the diffuser or interior of the fixture.

- Use a mild, non-abrasive glass cleaner. Do not use any solvents or harsh cleaning agents.
- Use a soft, non-abrasive cloth.
- When cleaning, make sure that the power is off. Do not spray liquid cleaner directly onto LEDs driver, or wiring.

## DIMMING FEATURE

This fixture is compatible with most residential dimmers, though dimming performance is impacted differently by each dimmer model. A dimmer's settings for brightness range, as well as the number of other LED lights wired on the same circuit can change this fixture's dimming ability.

Preferred dimmers for this model include; Leviton's IPL06, DSM10, Decora 6674, 6672, Decora DDL06; Lutron's DVSCCL-153P, CTCL-153P, DVELV-300P, TGCL-153PH-WH, DVCL-153PH, MACL-153MLH-WH, RCL-153PNLH; Legrand's WSCL450TCCCV4, DRCL453PWCCV4.

**EYES**



- Do not look directly at the LED lights for any length of time.
- Do not remove protective lens covering LED lights.



This product is guaranteed against failure due to factory defects in materials or workmanship for five (5) years from the date of purchase. This warranty is non-transferable and applies only to the original owner. Proof of purchase required for repair or replacement. This warranty does not cover normal wear of parts or damage resulting from any misuse of the product. Misuse of the product includes but is not limited to: using in extreme weather conditions, opening the housing of the product, or attempted remodel/alterations made to product.

**Question/Comment/Missing Part?**

Contact GT-Lite 1-800-865-6799  
[www.gt-liteled.com](http://www.gt-liteled.com)



**GT-Lite**