

**EASY
SPACE**

**4 Layer
Double Drawer**

Dimension:
766 x 516 x 650 mm

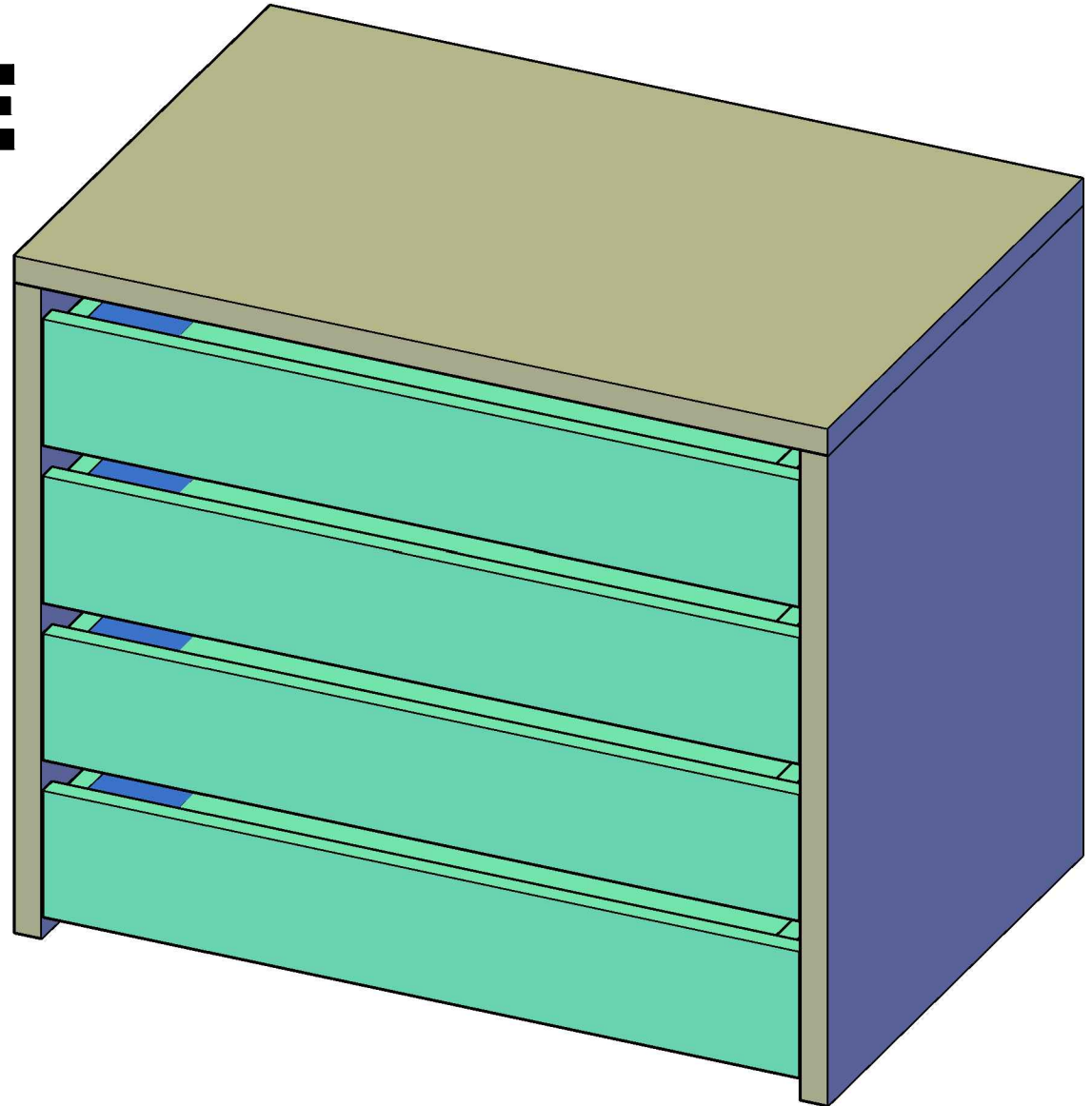

Assembly Guide

Step 1

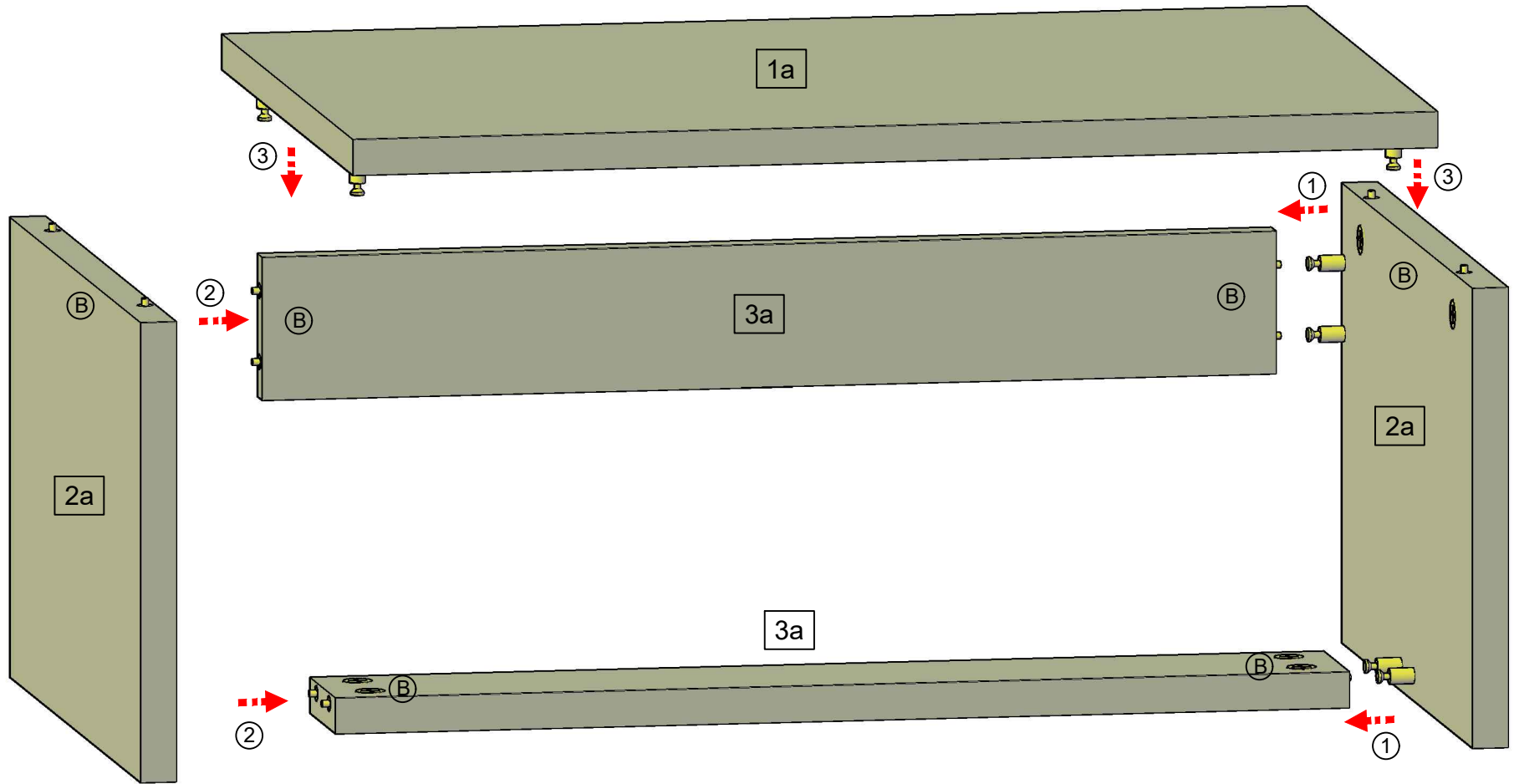

Parts List:

1a. Top Panel Board x 1pc.

2a. Left & Right Panel Board x 2pcs.

3a. Base Panel Board x 2pcs.

1b. Drawer Left & Right Panel Board x 8pcs.

2b. Drawer Front & Back Panel Board x 8pcs.

3b. Drawer Bottom Panel Board x 4pcs.

Assembly Guide

Drawer Assembly Guide

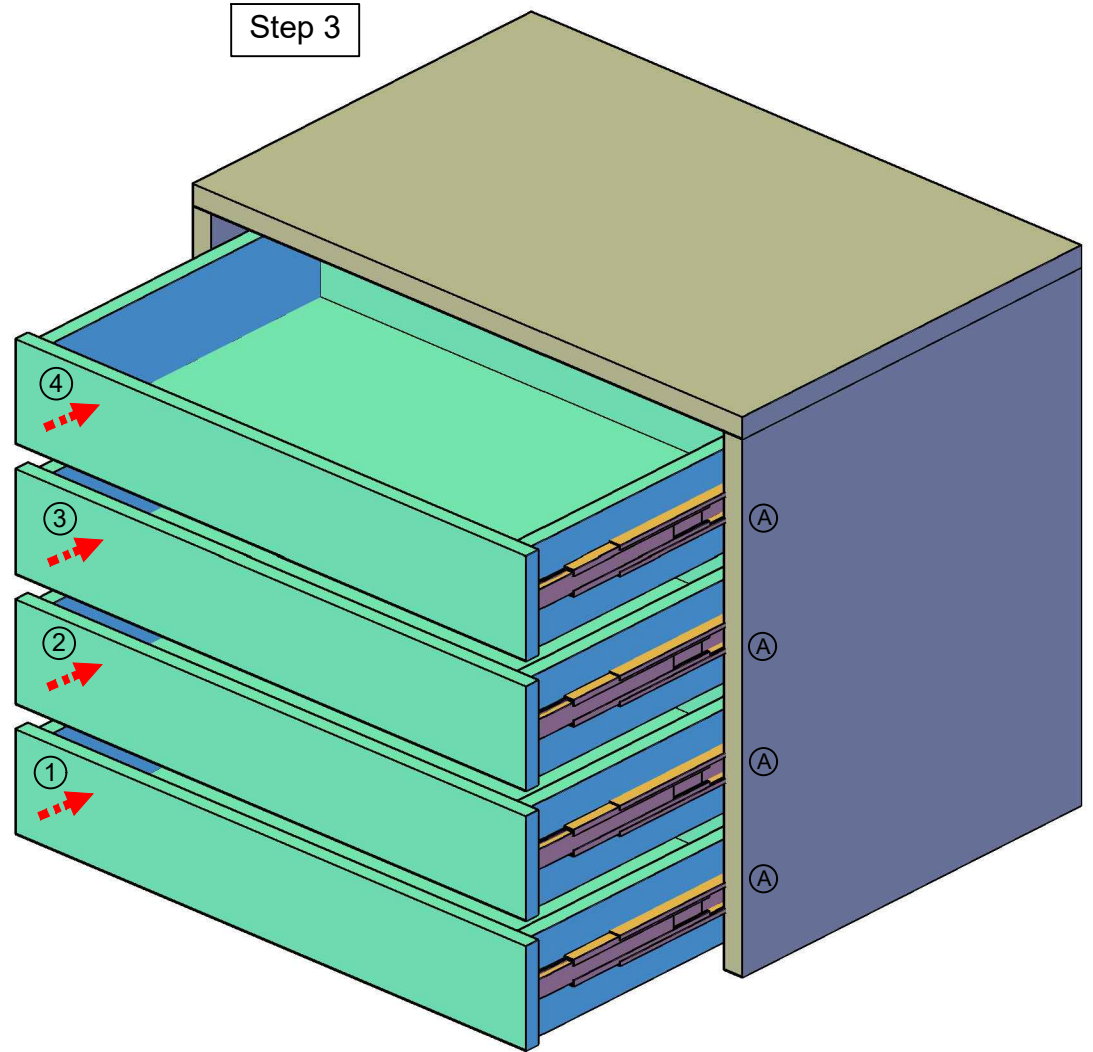
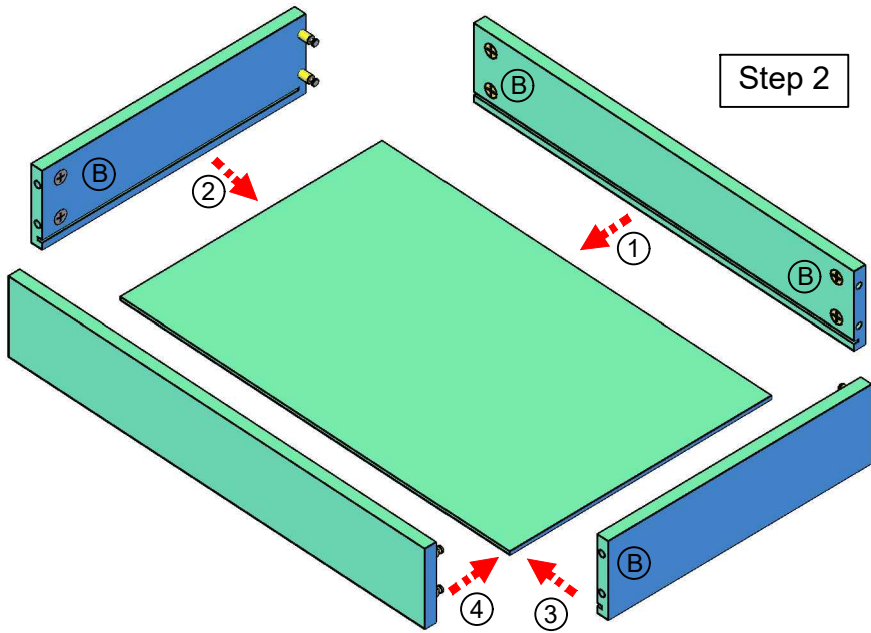

ACCESSORIES:

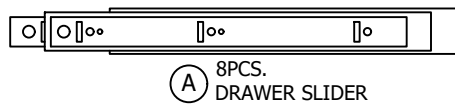
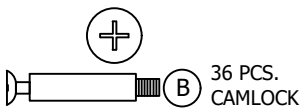

HOW TO USE CAMLOCK & PIN:

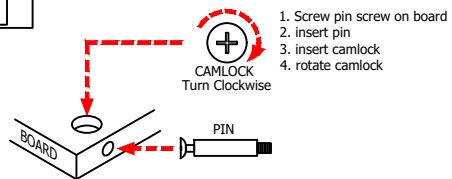

TOOLS:

