

Assembly Guide

Step 1

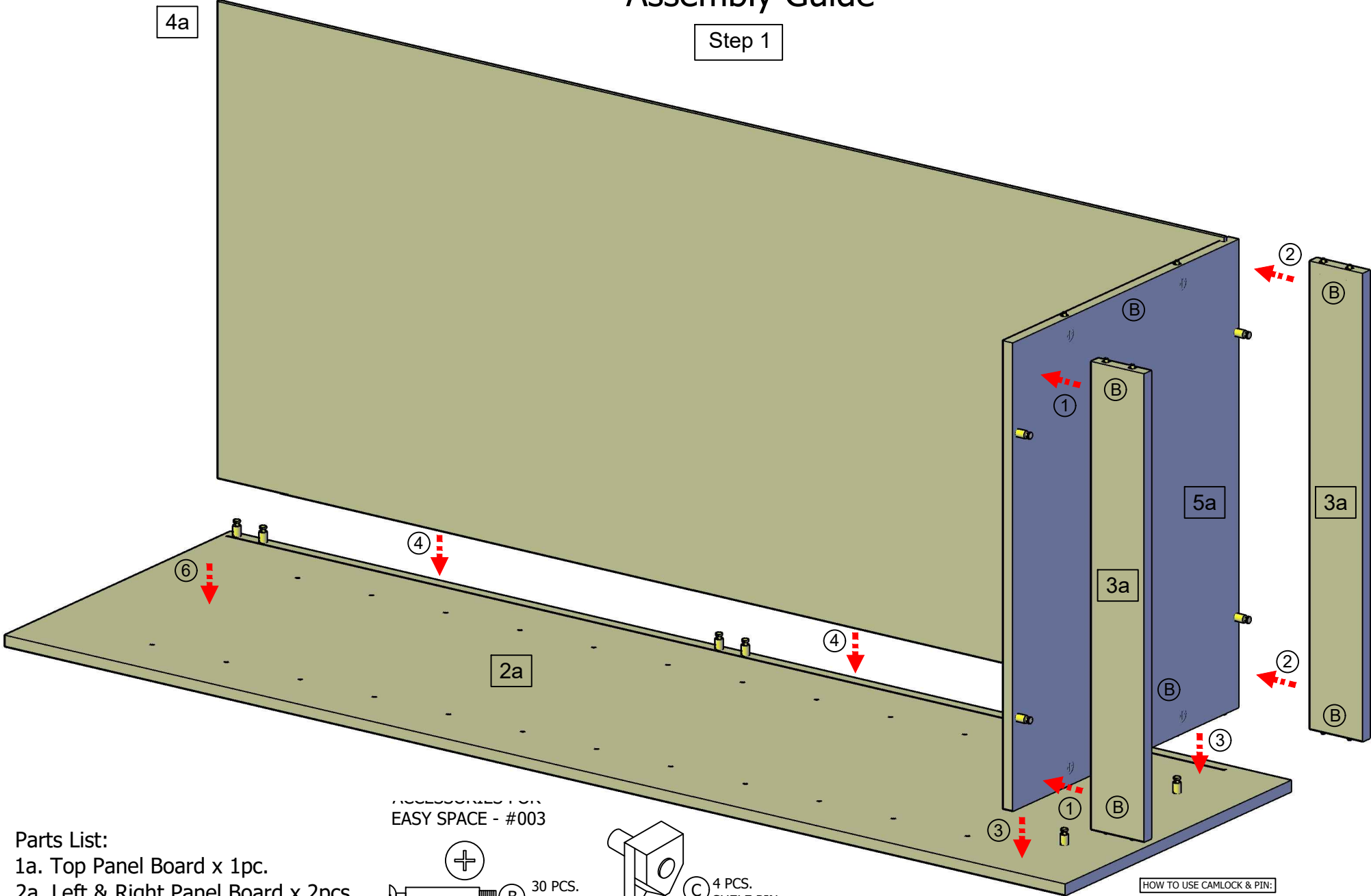

- Parts List:
- 1a. Top Panel Board x 1pc.
 - 2a. Left & Right Panel Board x 2pcs.
 - 3a. Base Panel Board x 4pcs.
 - 4a. Back Panel Board x 1pc.
 - 5a. Bottom Panel Board x 1pc.
 - 6a. Shelf Panel Board x 1pc.

NECESSARY FOR
EASY SPACE - #003

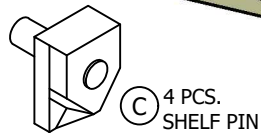
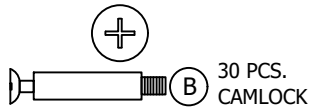

TOOLS:



HOW TO USE CAMLOCK & PIN:

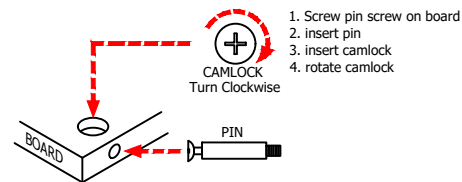

Assembly Guide

Step 1

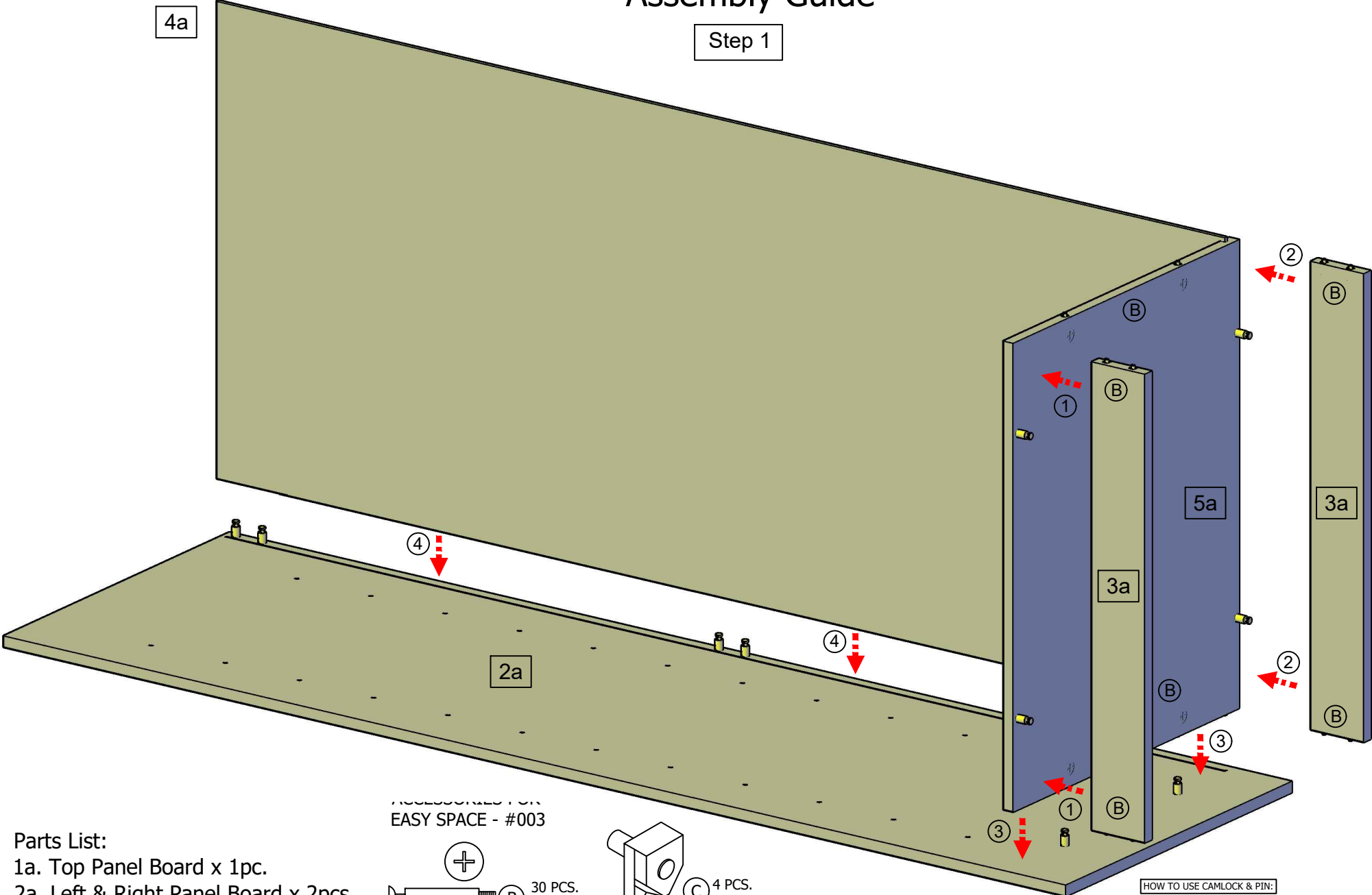

- Parts List:**
- 1a. Top Panel Board x 1pc.
 - 2a. Left & Right Panel Board x 2pcs.
 - 3a. Base Panel Board x 4pcs.
 - 4a. Back Panel Board x 1pc.
 - 5a. Bottom Panel Board x 1pc.
 - 6a. Shelf Panel Board x 1pc.

NECESSARY FOR
EASY SPACE - #003

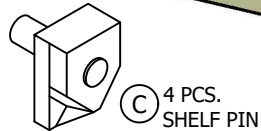
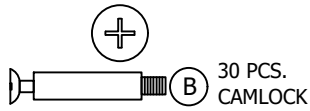

TOOLS:



HOW TO USE CAMLOCK & PIN:

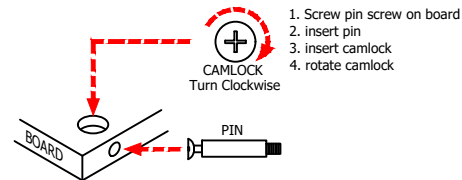

Assembly Guide

Step 2

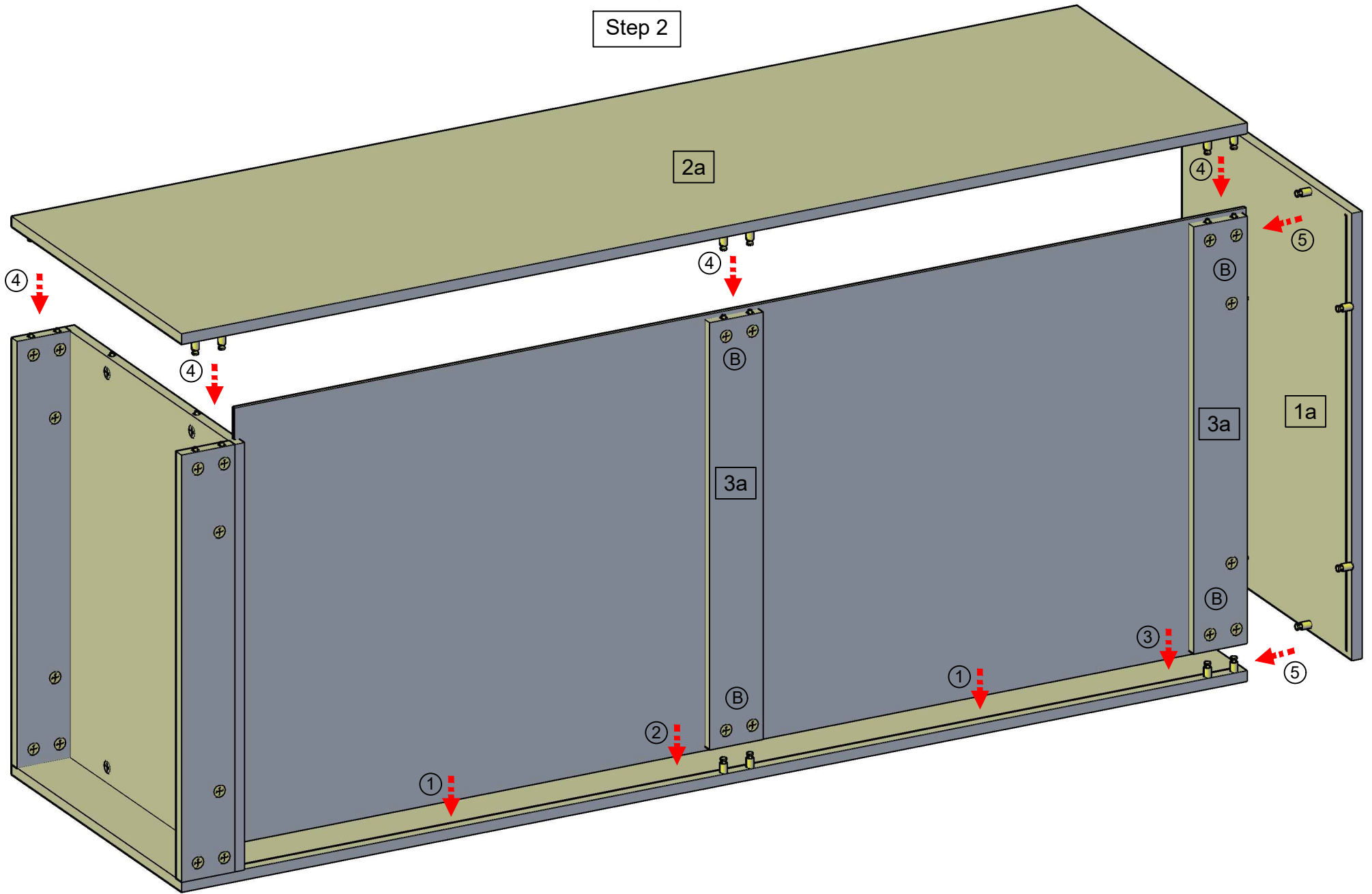

Assembly Guide

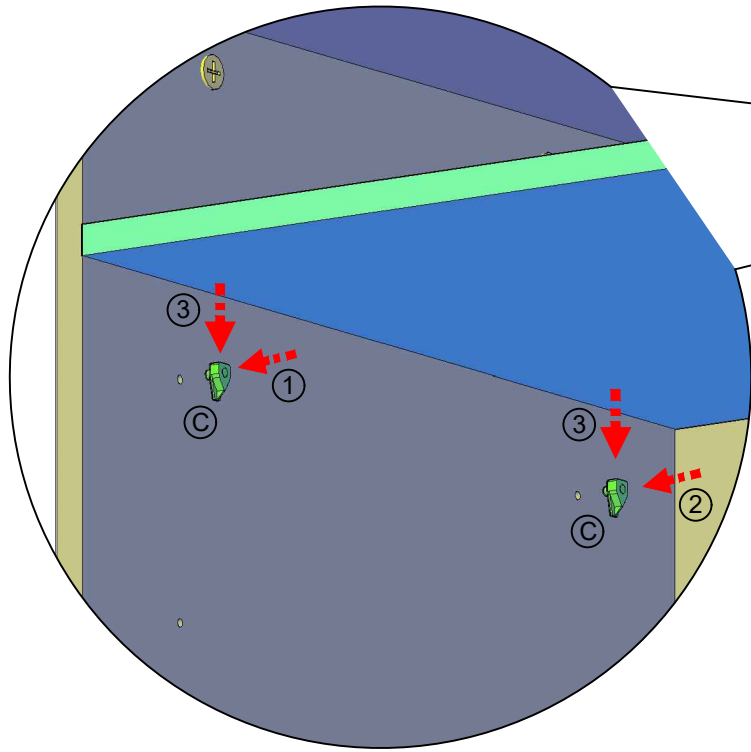

Step 4

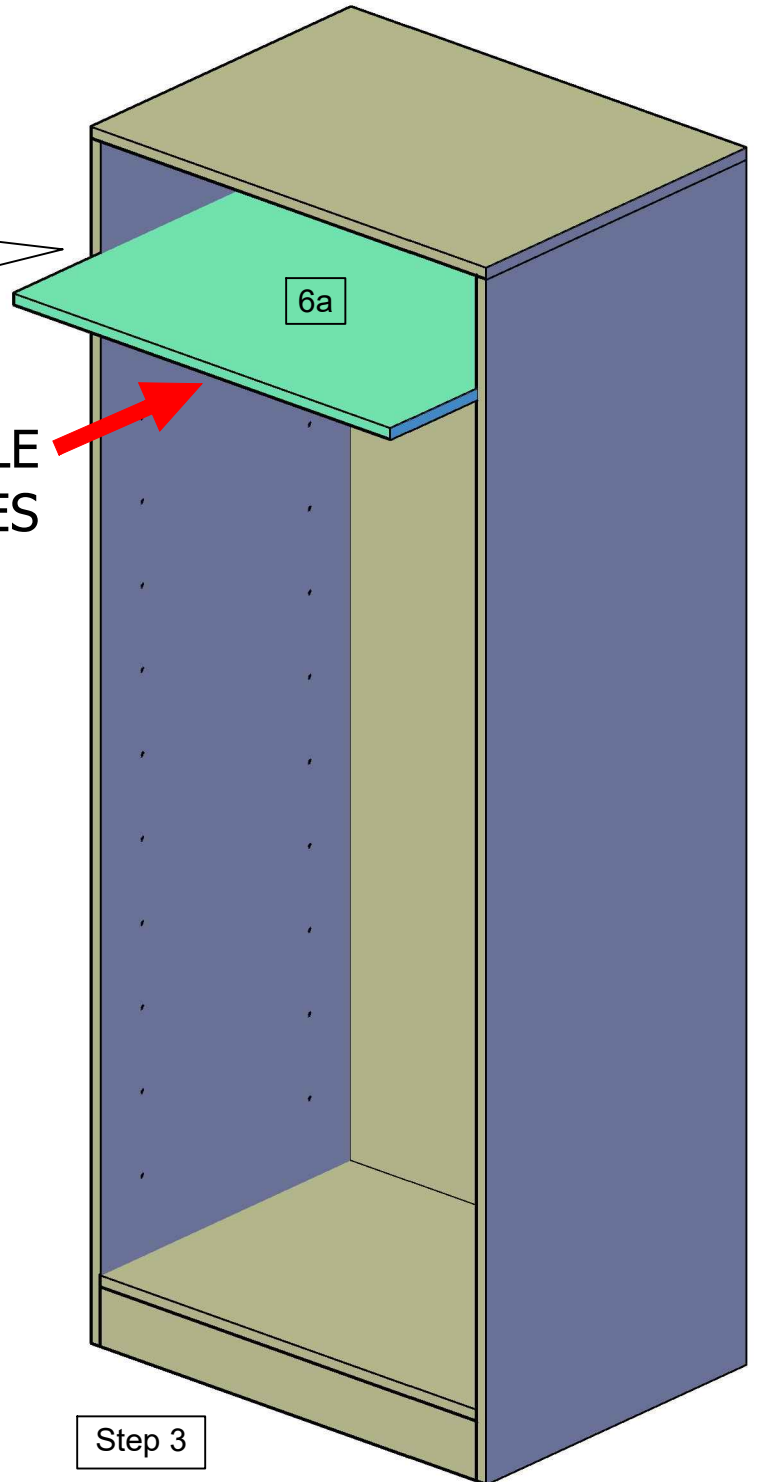

Step 3

ACCESSORIES FOR
EASY SPACE - #003

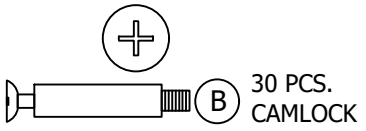

30 PCS.
CAMLOCK

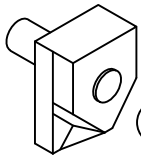

4 PCS.
SHELF PIN

TOOLS:

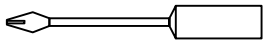

SCREW DRIVER

Assembly Guide

Step 5

- 1. FLANGE
- 2. SCREW
- 3. WARDROBE OVAL ROD

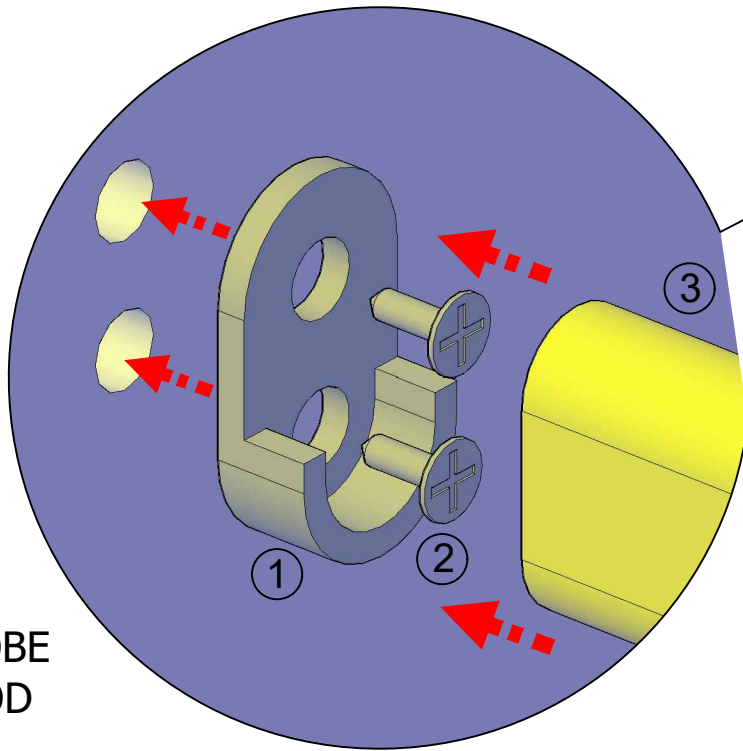

Double Drawer 2L

