

**EASY
SPACE**

ES-020-2

Dimension:
918 x 350 x 706 mm

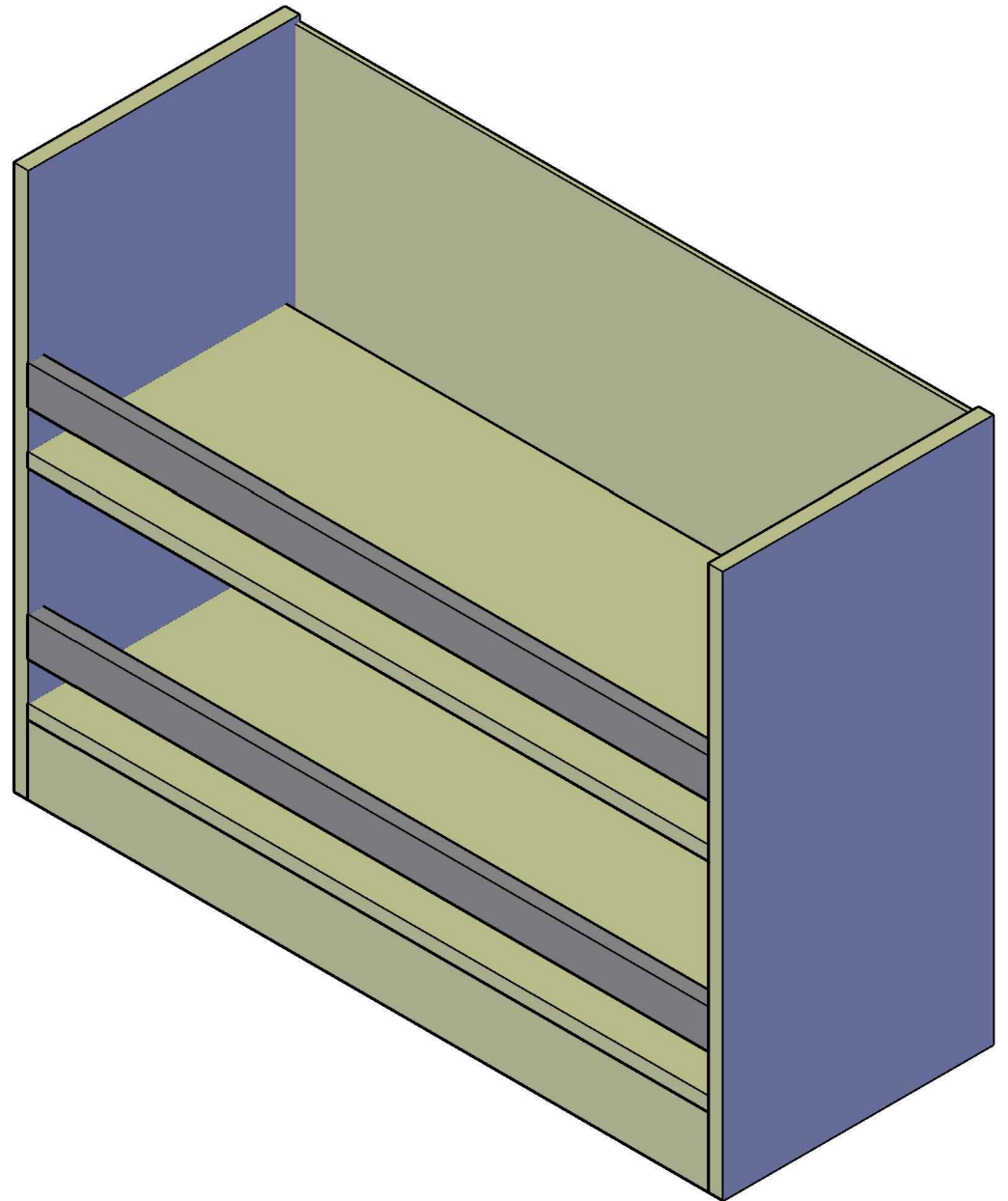

Assembly Guide

Step 1

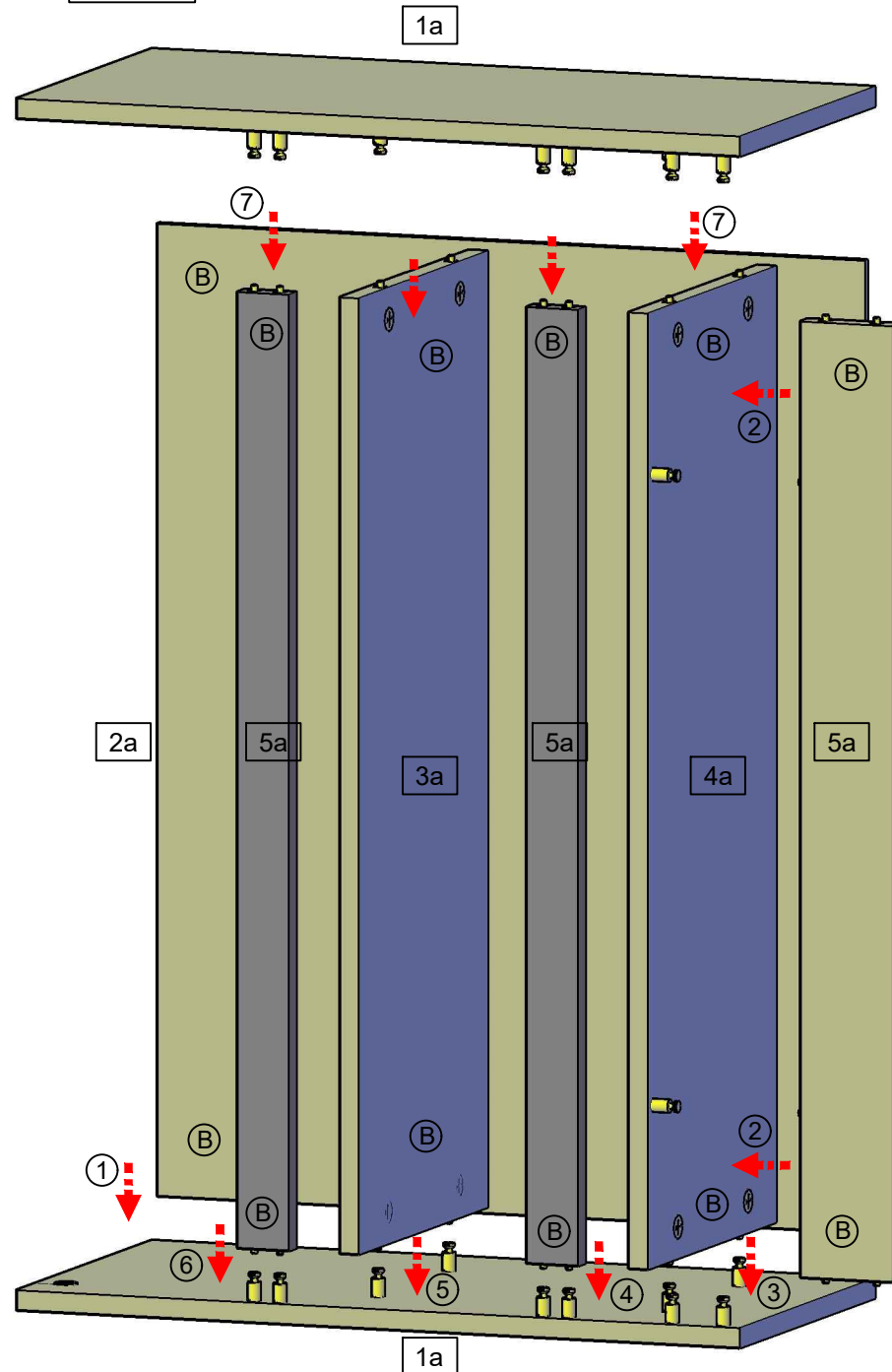

ACCESSORIES:

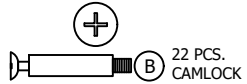

TOOLS:

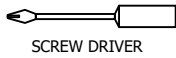

SCREW DRIVER

HOW TO USE CAMLOCK & PIN:

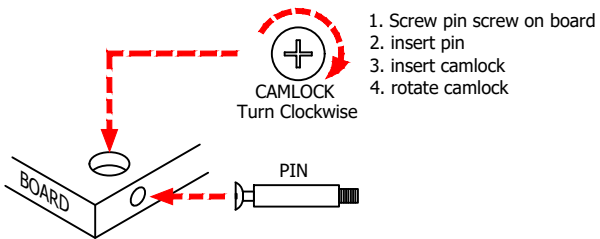

1. Screw pin screw on board
2. insert pin
3. insert camlock
4. rotate camlock

Parts List:

- 1a. Left & Right Panel Board x 2pcs.
- 2a. Back Panel Board x 1pc.
- 3a. Middle Panel Board x 1pc.
- 4a. Bottom Panel Board x 1pc.
- 5a. Base Panel Board 3pcs.