

EASY SPACE

ES-016

Dimension:
1194 x 600 x 2026 mm

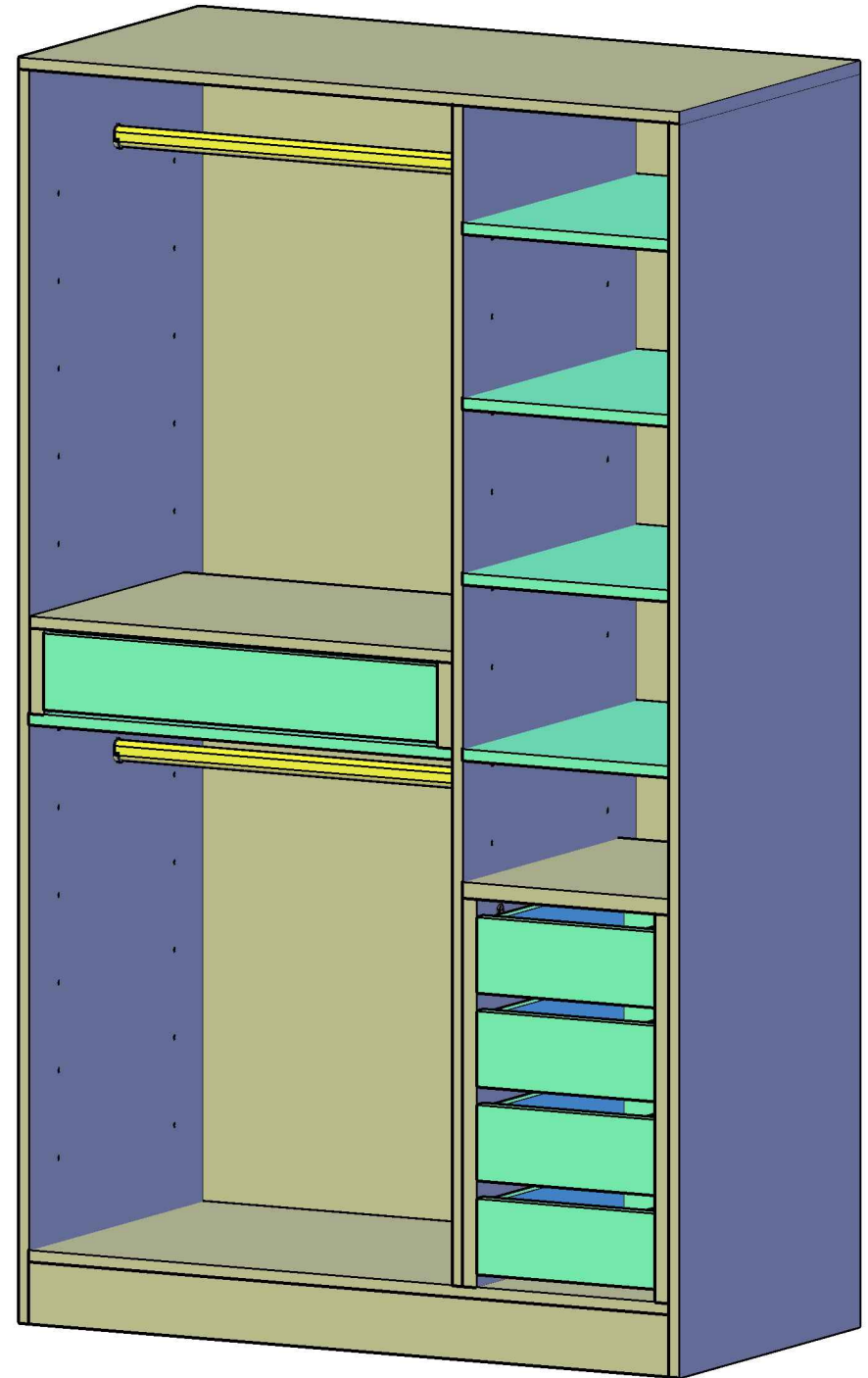

Assembly Guide

Step 1

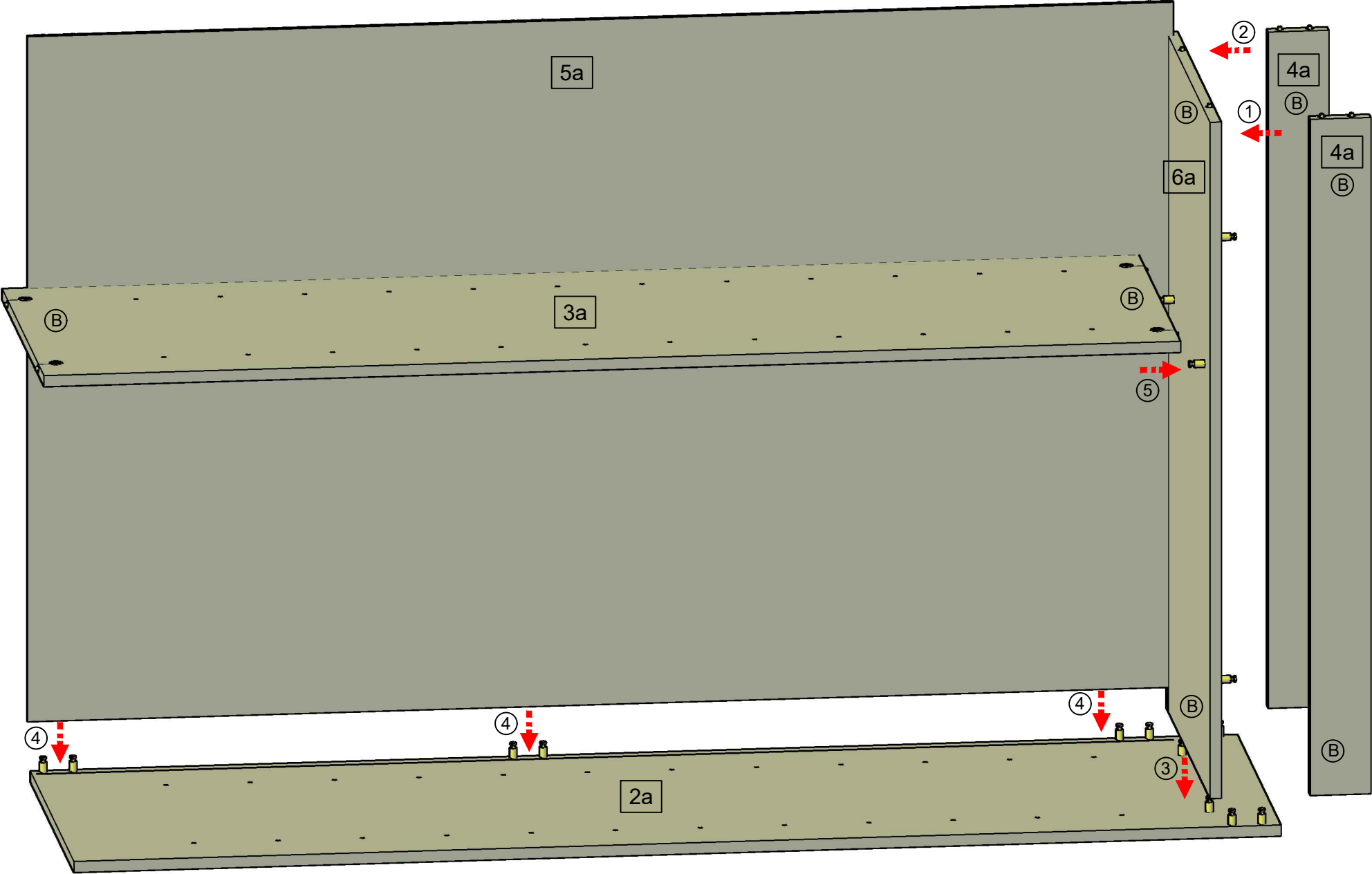

Assembly Guide

Step 2

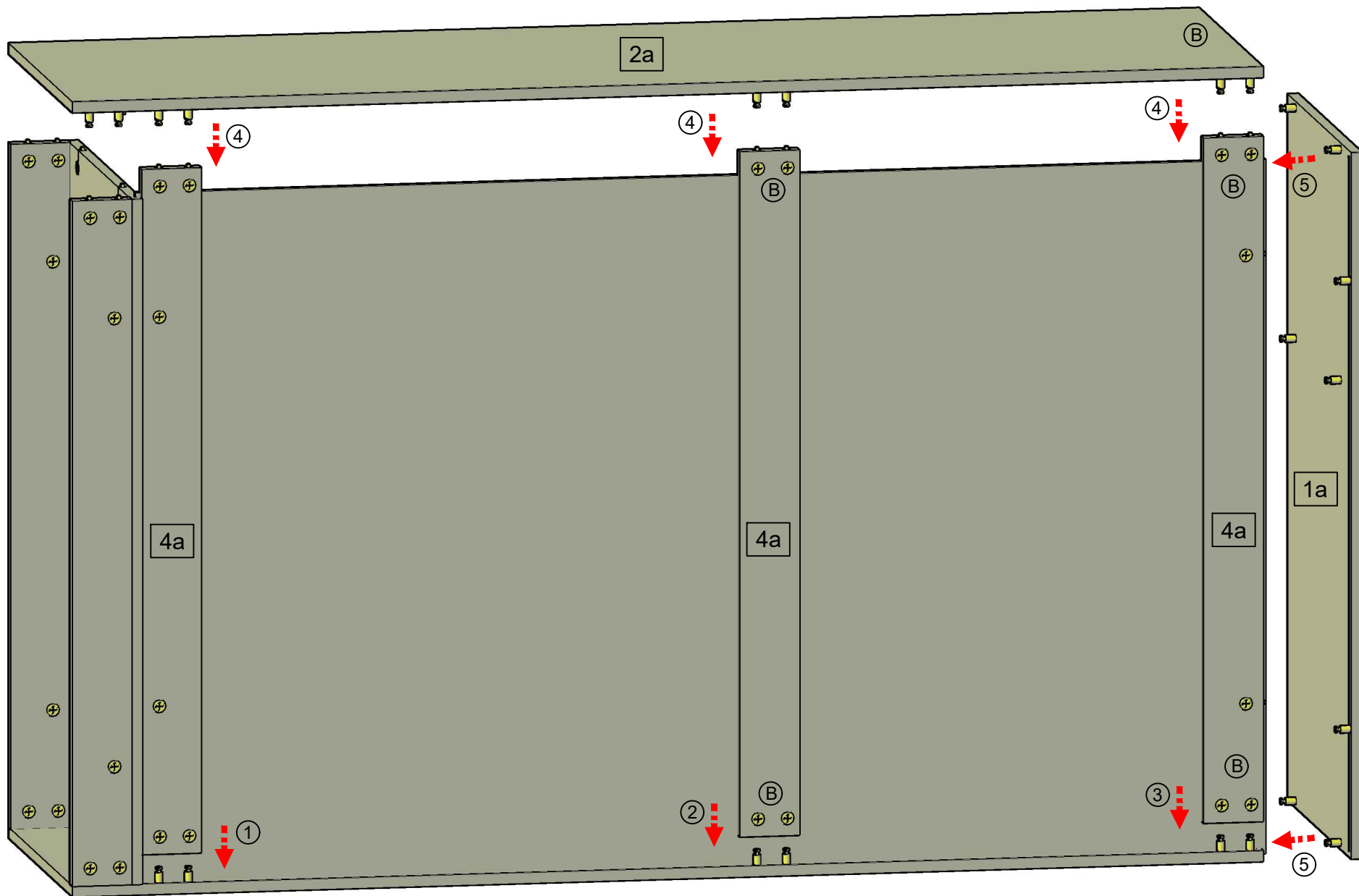

Assembly Guide

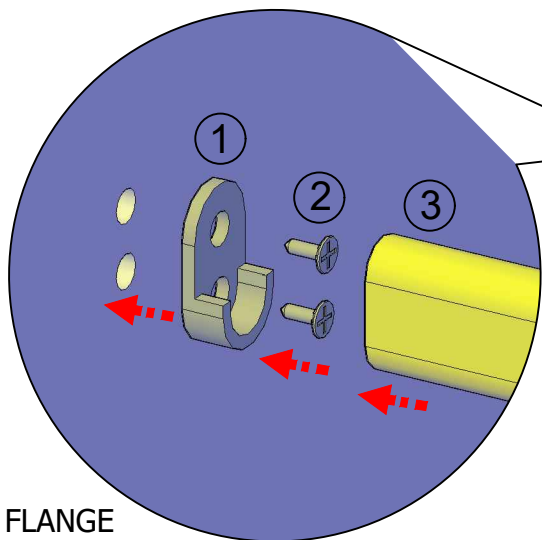

- 1. FLANGE
- 2. SCREW
- 3. WARDROBE OVAL ROD

Step 3

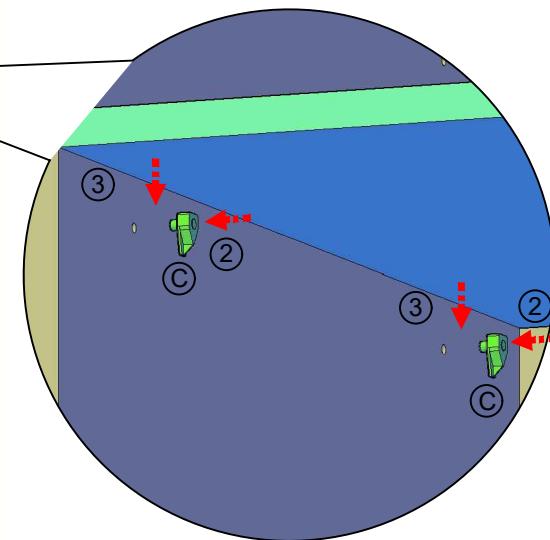

Step 4

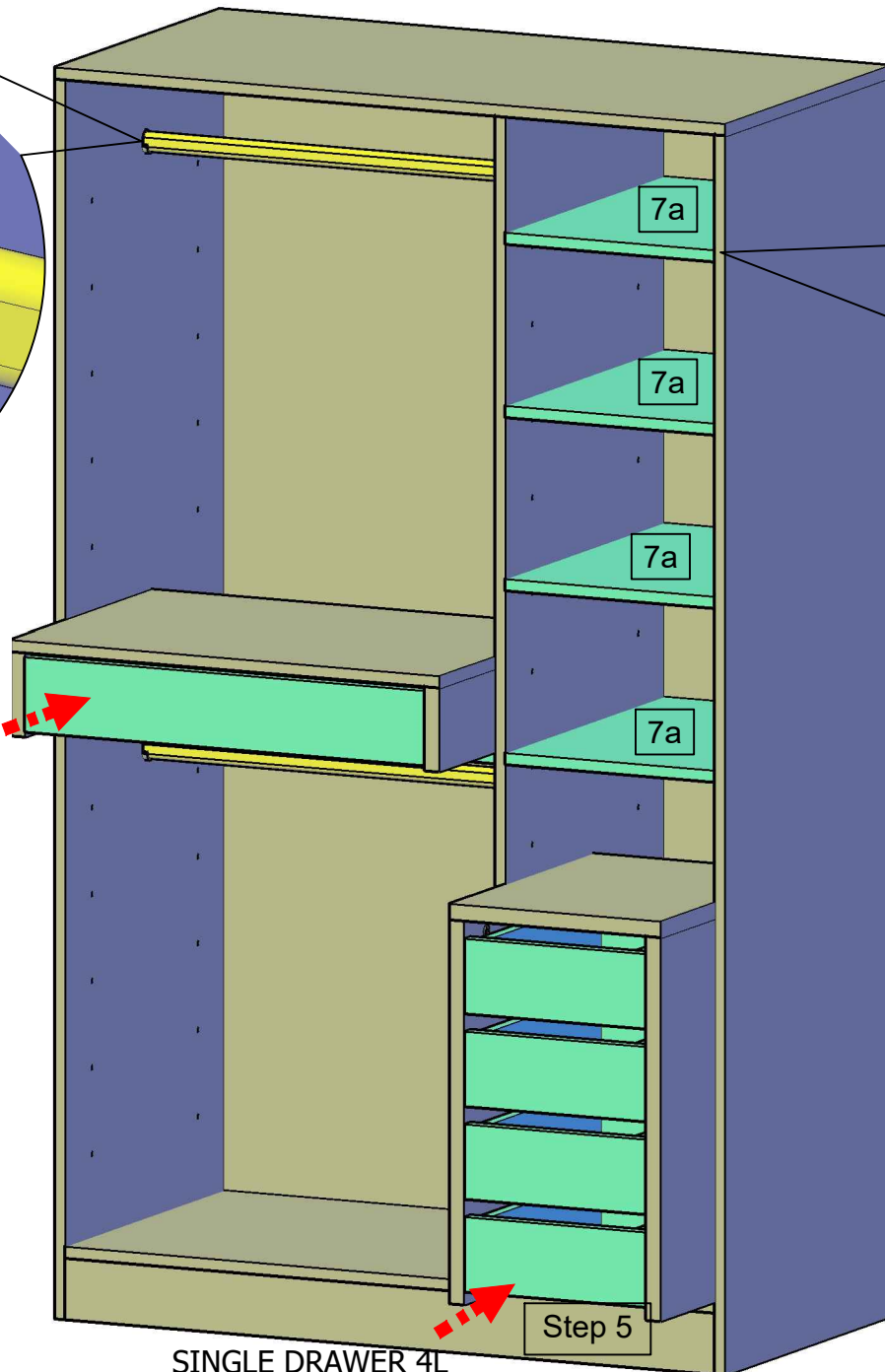

Step 6
JEWELRY DRAWER

Step 5

ACCESSORIES:

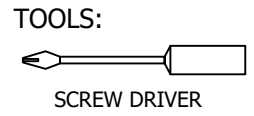
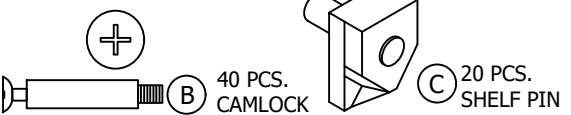

HOW TO USE CAMLOCK & PIN:

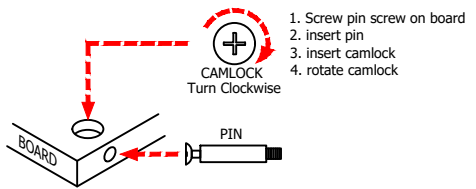

- Parts List:
- 1a. Top Panel Board x 1pc.
 - 2a. Left & Right Panel Board x 2pcs.
 - 3a. Middle Panel Board x 1pc.
 - 4a. Base Panel Board x 5pcs.
 - 5a. Back Panel Board x 1pc.
 - 6a. Bottom Panel Board x 1pc.
 - 7a. Shelf Panel Board x 5pcs.