

**EASY
SPACE**

ES-011

Dimension:
410 x 600 x 2026 mm

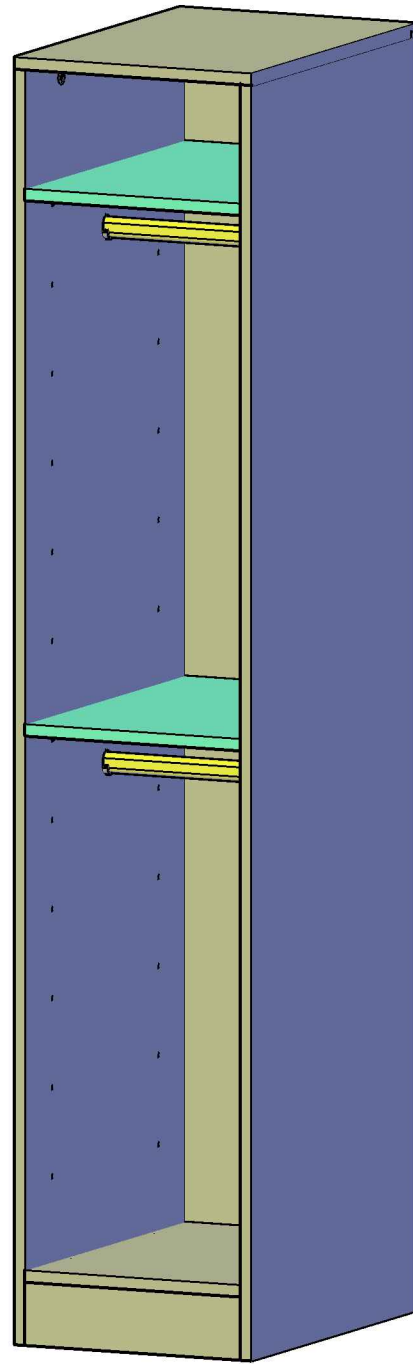

Assembly Guide

Step 1

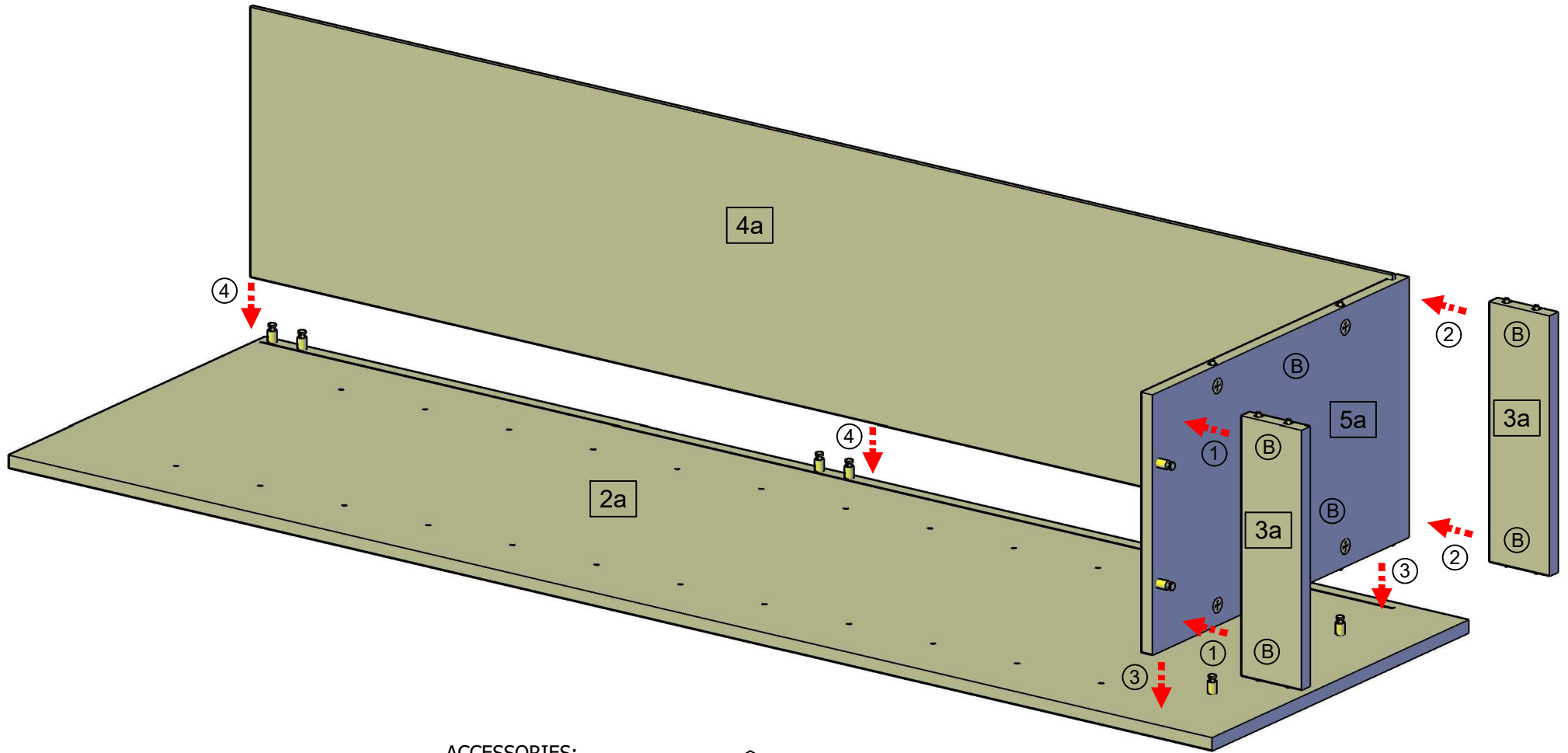

Parts List:

- 1a. Top Panel Board x 1pc.
- 2a. Left & Right Panel Board x 2pcs.
- 3a. Base Panel Board x 4pcs.
- 4a. Back Panel Board x 1pc.
- 5a. Bottom Panel Board x 1pc.
- 6a. Shelf Panel Board x 2pcs.

ACCESSORIES:

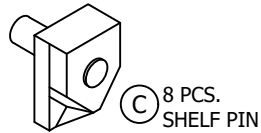
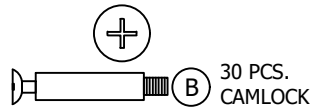

TOOLS:



HOW TO USE CAMLOCK & PIN:

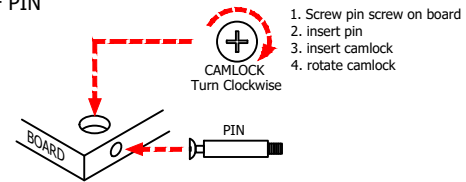

Assembly Guide

Step 2

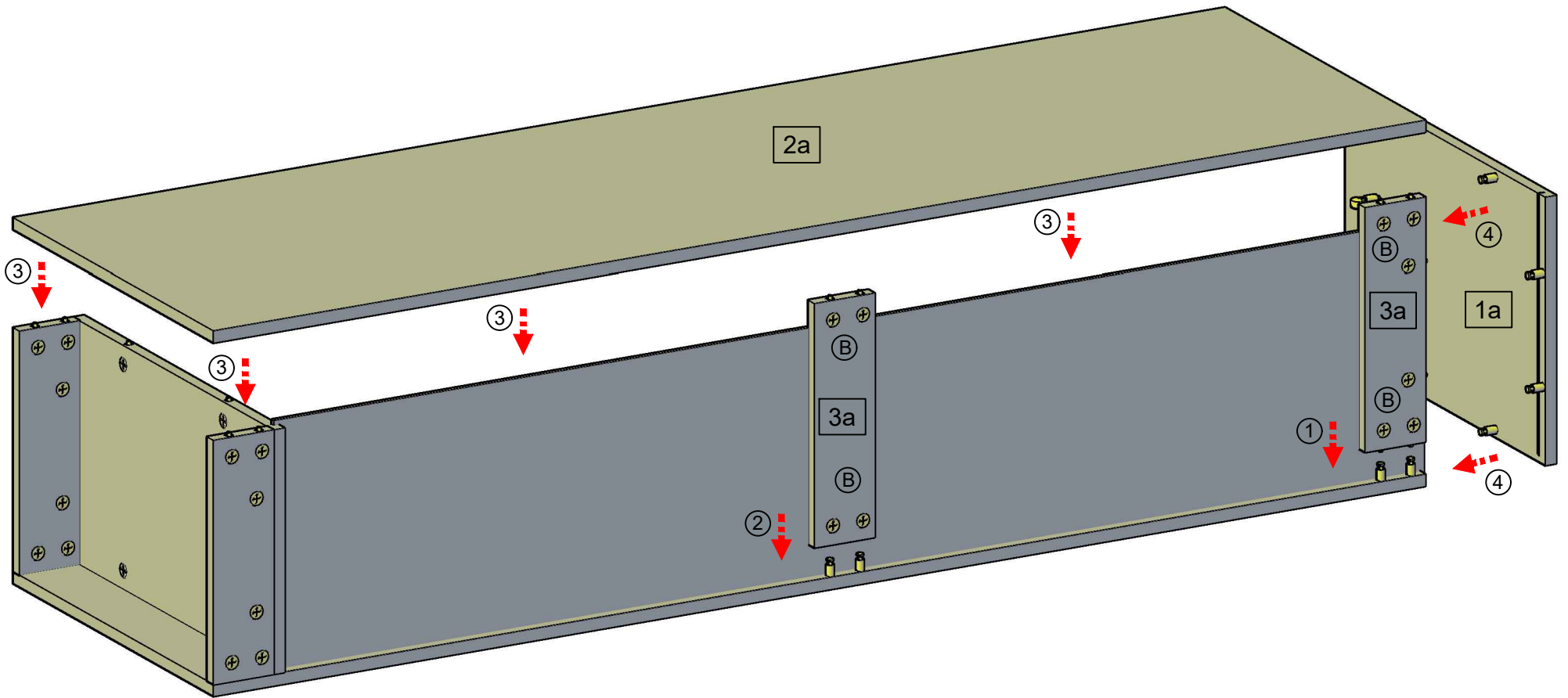

Assembly Guide

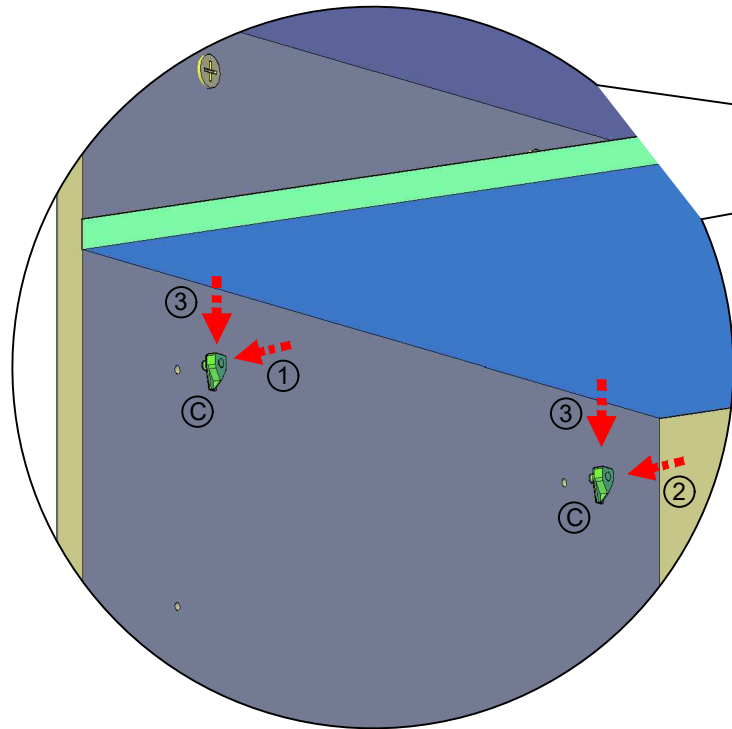

Step 4

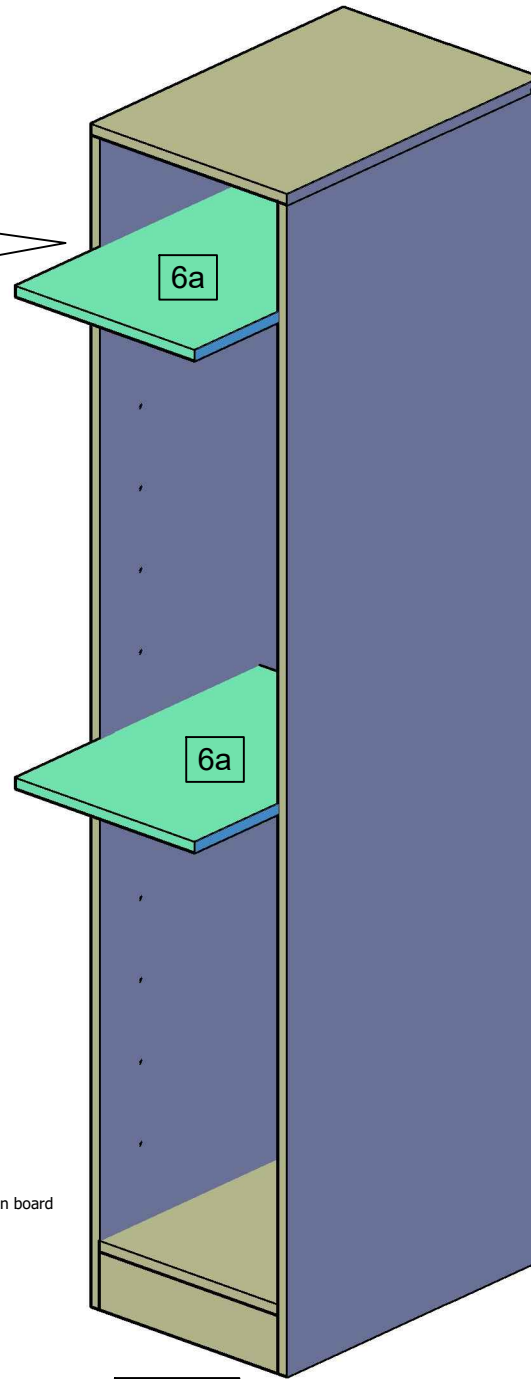

Step 3

ADJUSTABLE SHELVES

ACCESSORIES:

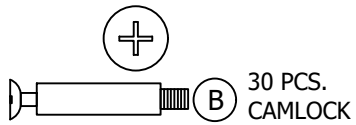

TOOLS:

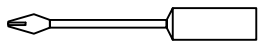

SCREW DRIVER

HOW TO USE CAMLOCK & PIN:

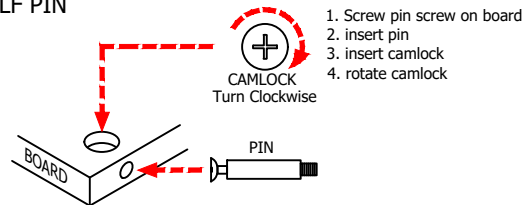

Assembly Guide

Step 4

- 1. FLANGE
- 2. SCREW
- 3. WARDROBE OVAL ROD

