

**EASY
SPACE**

ES-010

Dimension:
410 x 600 x 2026 mm

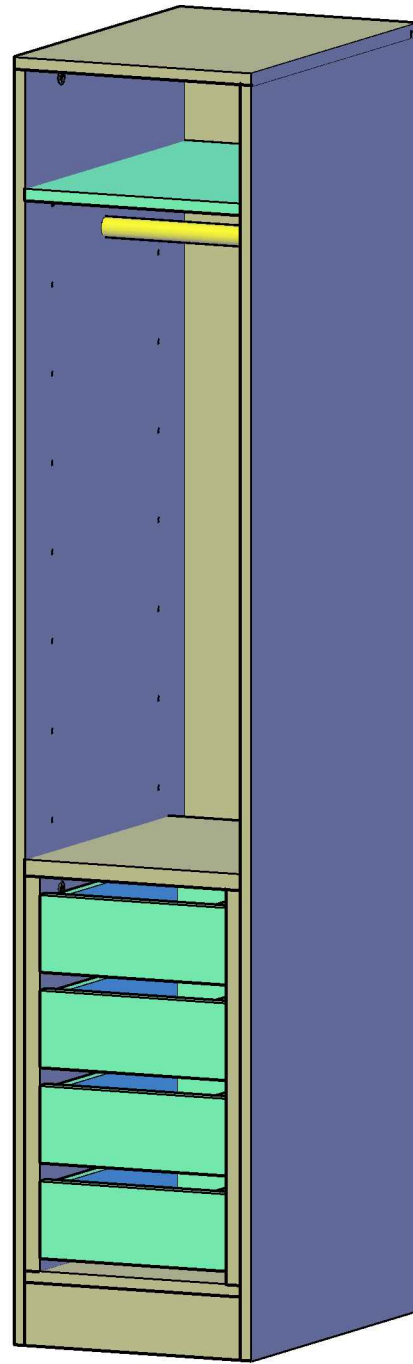

Assembly Guide

Step 1

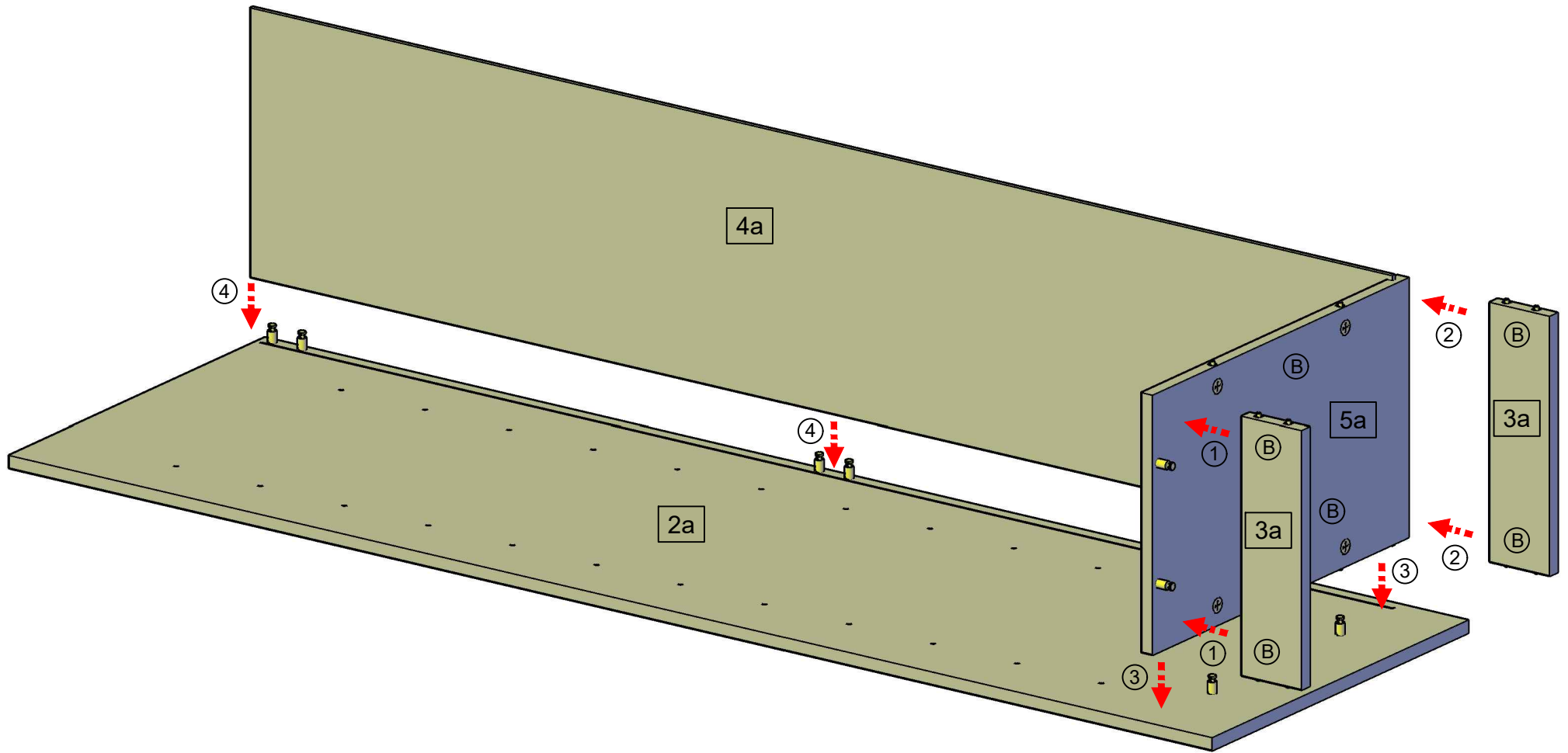

Parts List:

- 1a. Top Panel Board x 1pc.
- 2a. Left & Right Panel Board x 2pcs.
- 3a. Base Panel Board x 4pcs.
- 4a. Back Panel Board x 1pc.
- 5a. Bottom Panel Board x 1pc.
- 6a. Shelf Panel Board x 1pc.

ACCESSORIES:

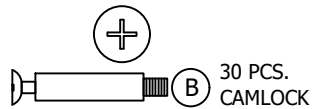

30 PCS. CAMLOCK

4 PCS. SHELF PIN

TOOLS:

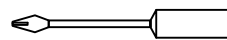

SCREW DRIVER

HOW TO USE CAMLOCK & PIN:

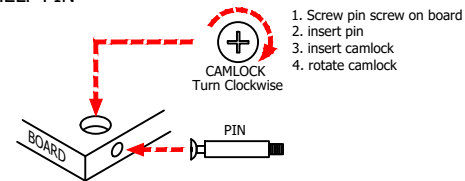

1. Screw pin screw on board
2. insert pin
3. insert camlock
4. rotate camlock

Assembly Guide

Step 2

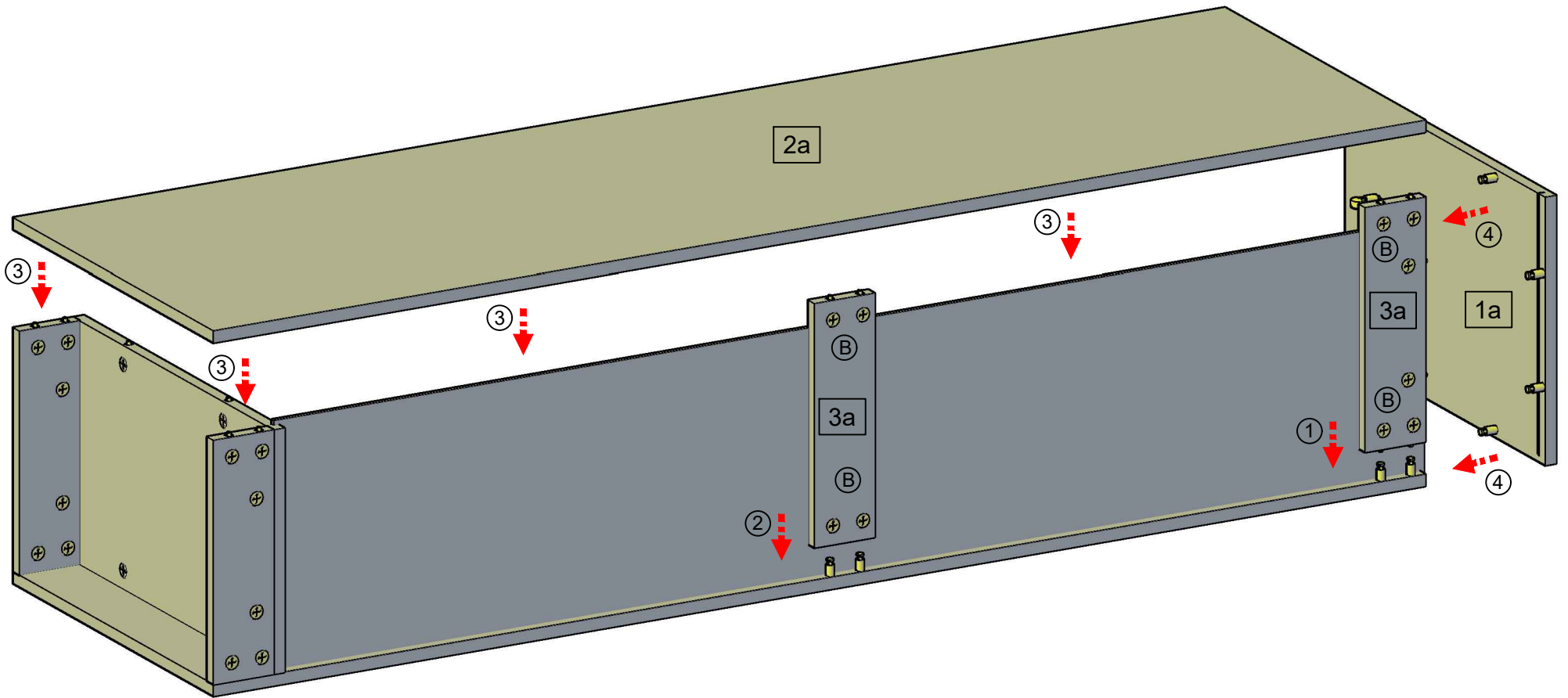

Assembly Guide

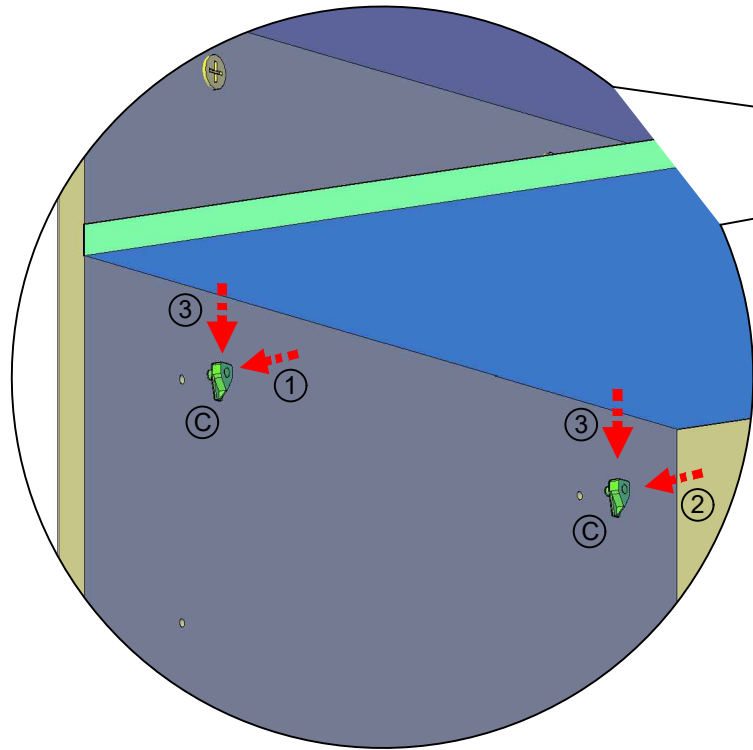

Step 4

ADJUSTABLE
SHELVES

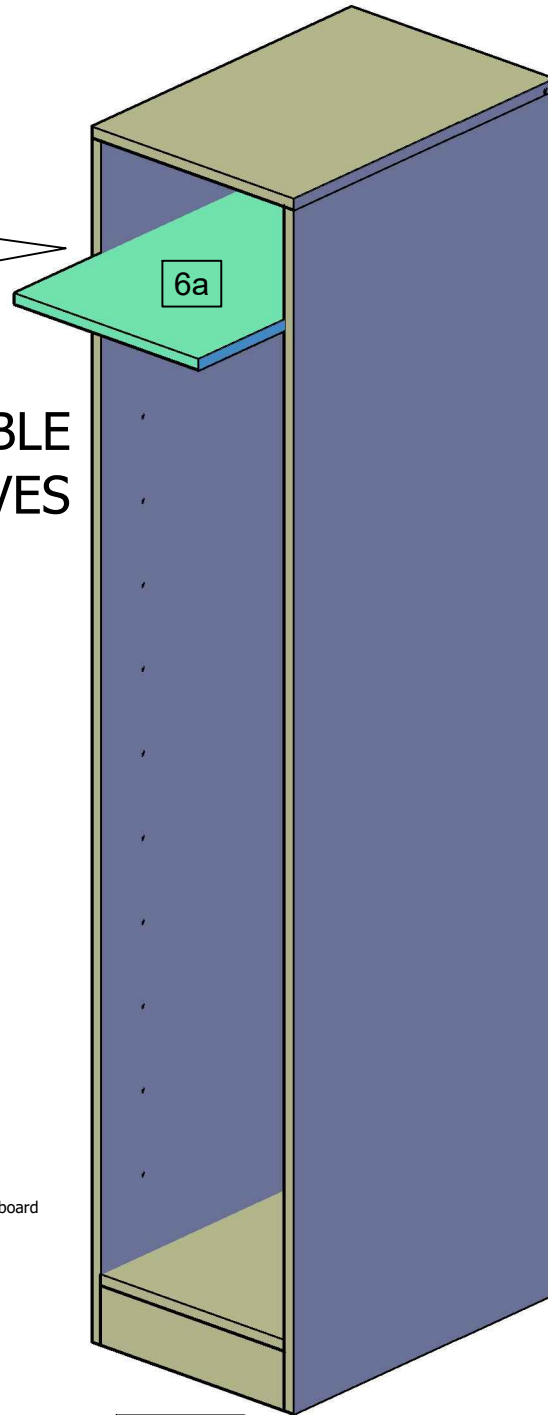

Step 3

ACCESSORIES:

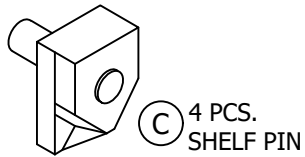
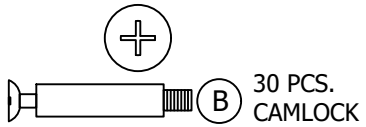

HOW TO USE CAMLOCK & PIN:

1. Screw pin screw on board
2. insert pin
3. insert camlock
4. rotate camlock

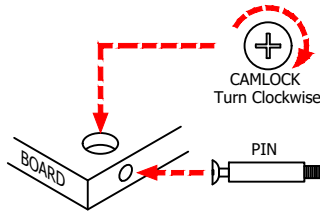

TOOLS:

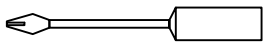

SCREW DRIVER

Assembly Guide

Step 5

- 1. FLANGE
- 2. SCREW
- 3. WARDROBE OVAL ROD

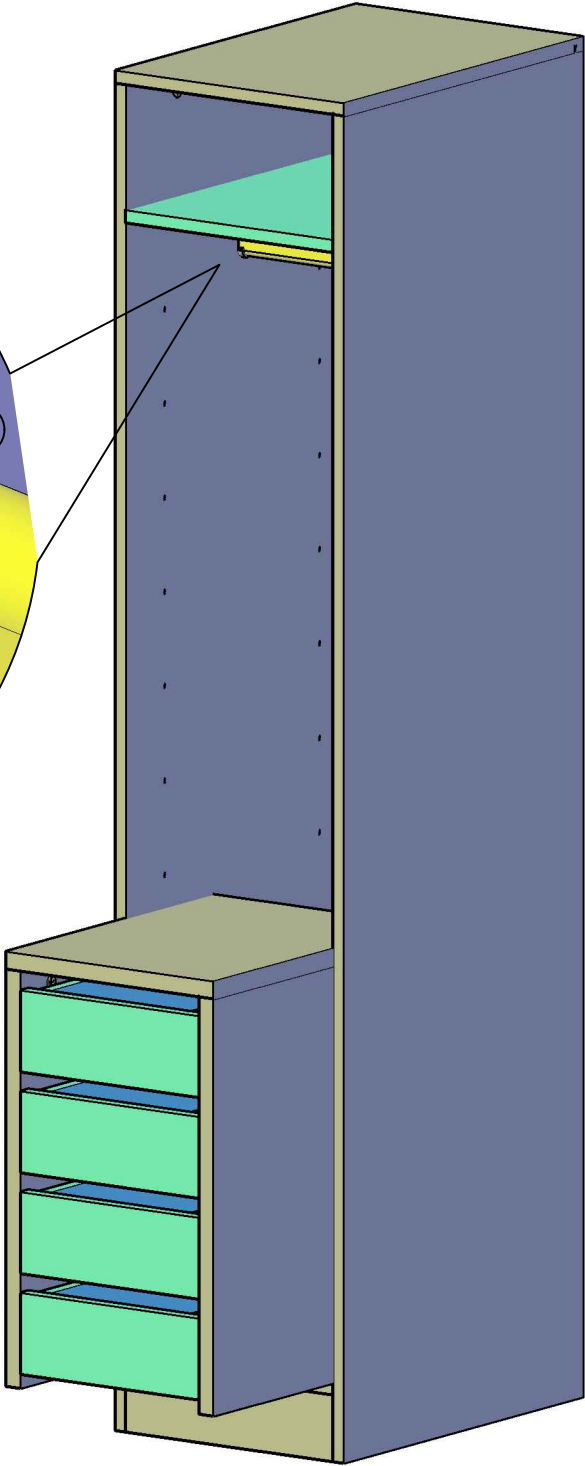
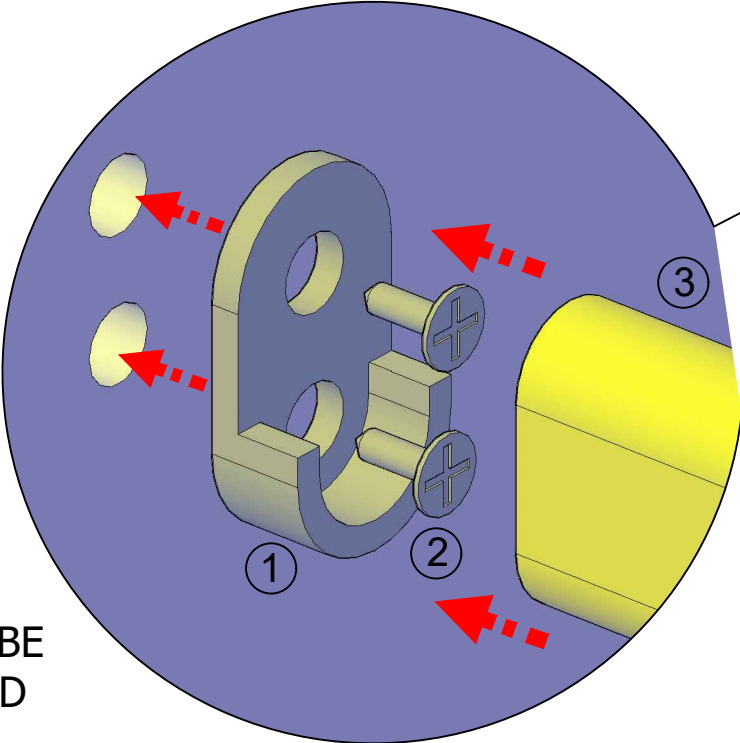

Single Drawer 4L