

**EASY  
SPACE**

**ES-009**

Dimension:  
410 x 600 x 2026 mm

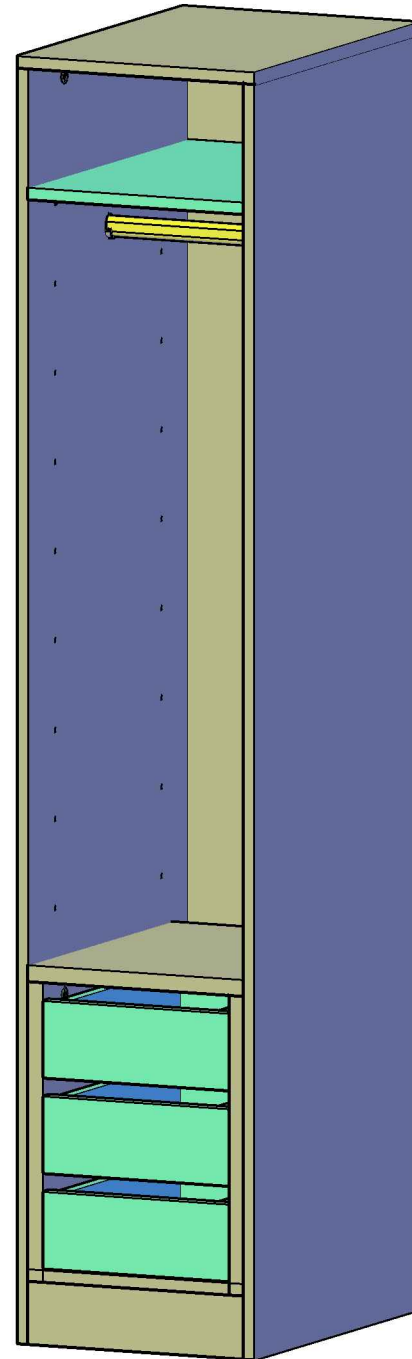

# Assembly Guide

Step 1

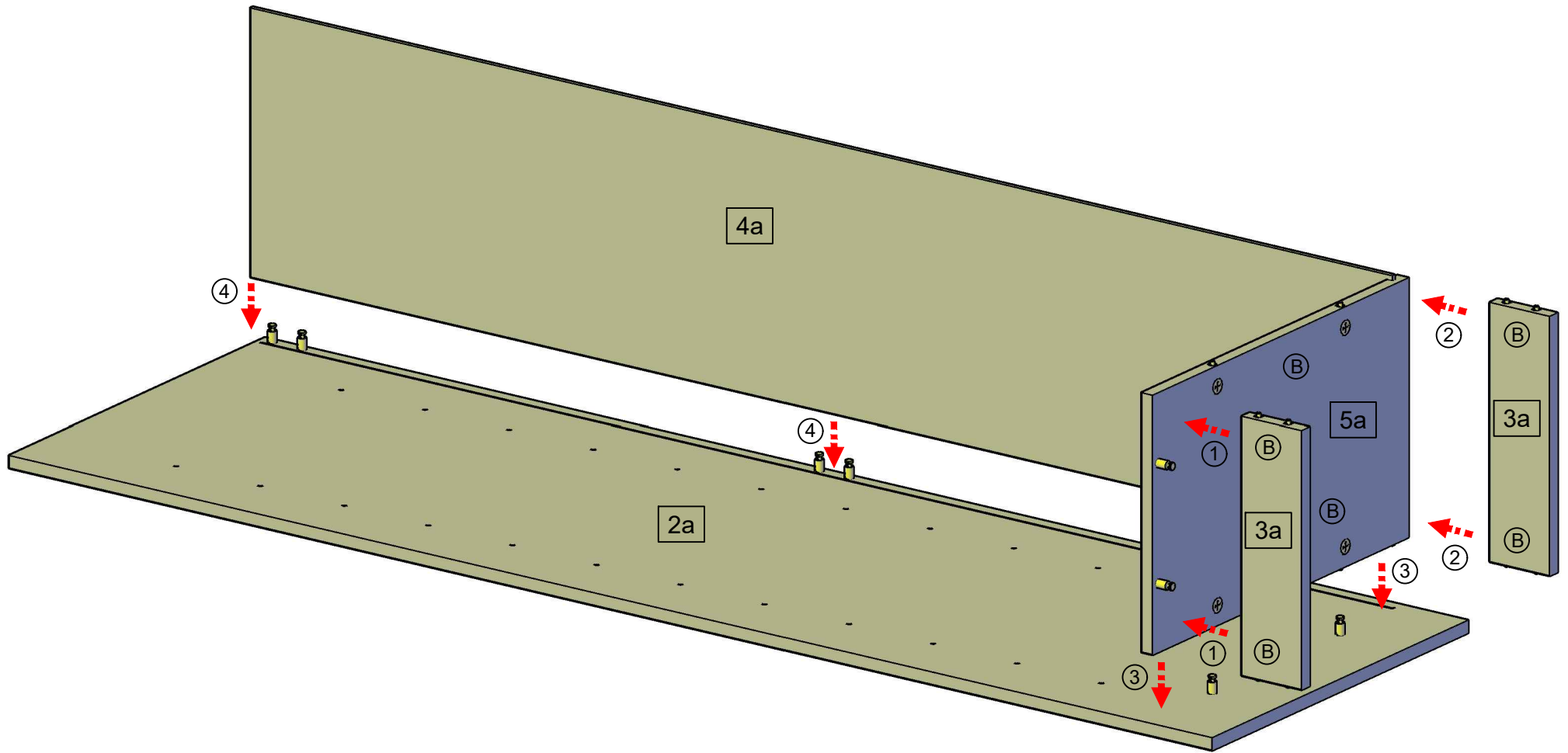

## Parts List:

- 1a. Top Panel Board x 1pc.
- 2a. Left & Right Panel Board x 2pcs.
- 3a. Base Panel Board x 4pcs.
- 4a. Back Panel Board x 1pc.
- 5a. Bottom Panel Board x 1pc.
- 6a. Shelf Panel Board x 1pc.

## ACCESSORIES:

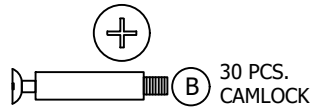

30 PCS. CAMLOCK

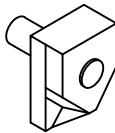

4 PCS. SHELF PIN

## TOOLS:



SCREW DRIVER

## HOW TO USE CAMLOCK & PIN:

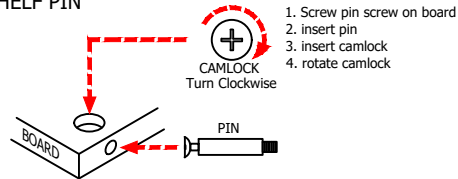

# Assembly Guide

Step 2

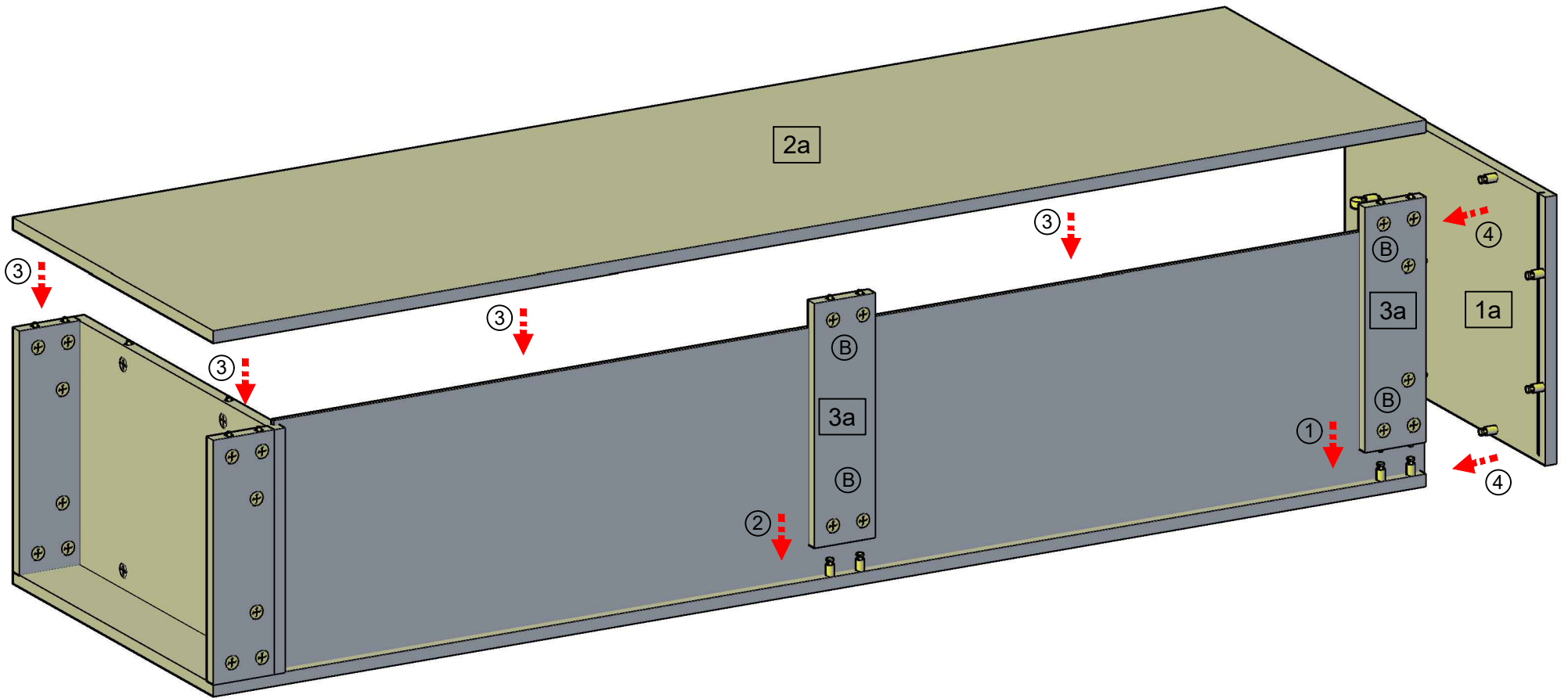

# Assembly Guide

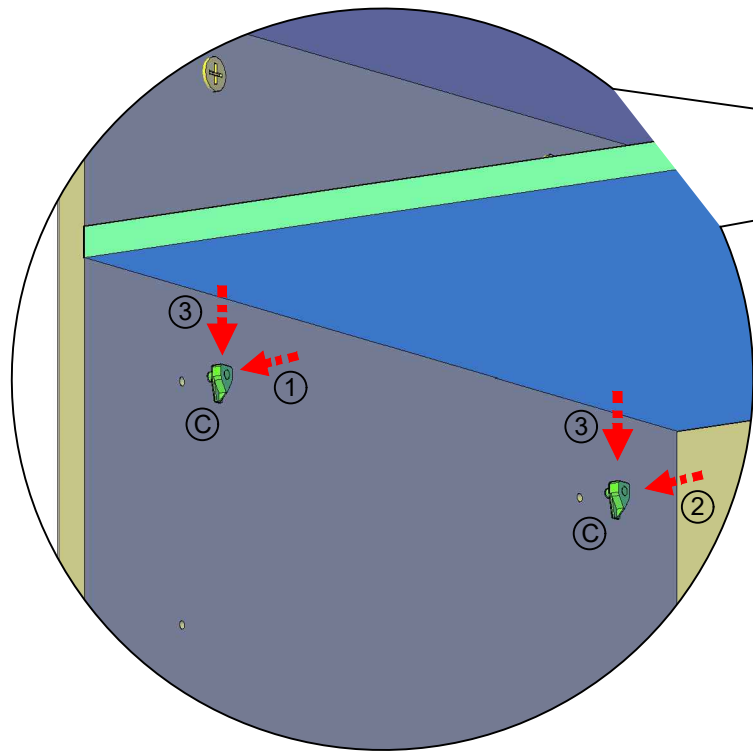

Step 4

ADJUSTABLE  
SHELVES

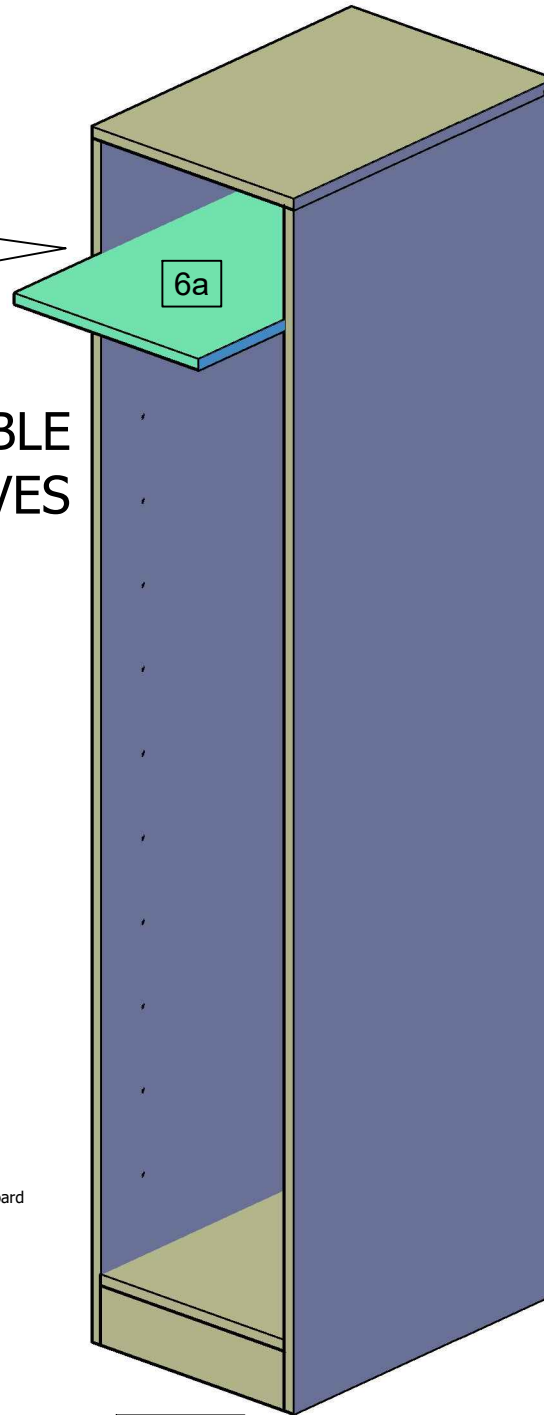

Step 3

## ACCESSORIES:

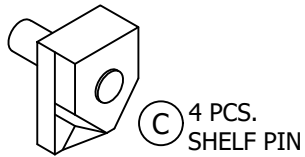
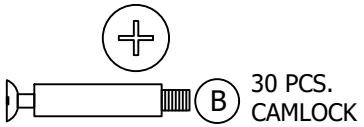

## HOW TO USE CAMLOCK & PIN:

1. Screw pin screw on board
2. insert pin
3. insert camlock
4. rotate camlock

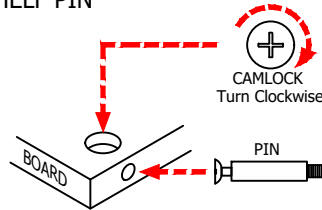

## TOOLS:

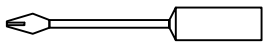

SCREW DRIVER

# Assembly Guide

Step 5

- 1. FLANGE
- 2. SCREW
- 3. WARDROBE OVAL ROD

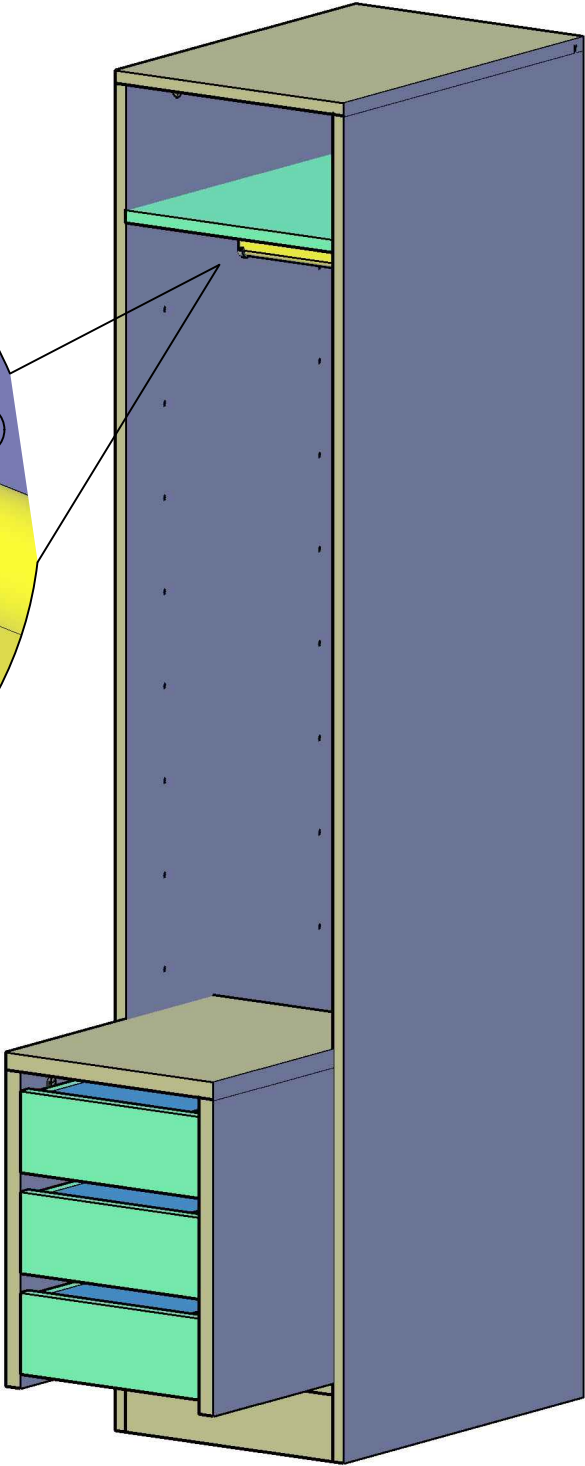
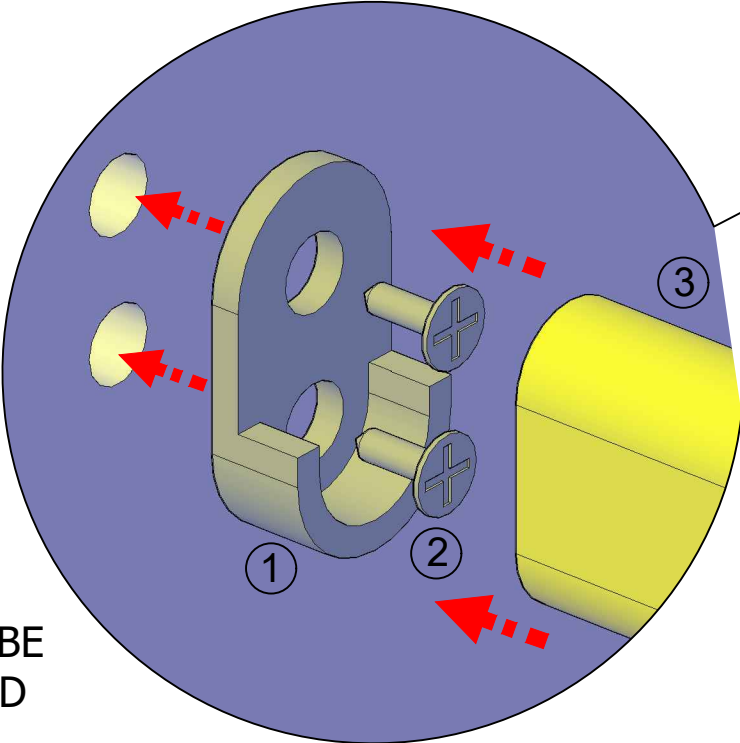

Single Drawer 3L