

08591000 Diesel Glowplug Repair Kit M8 x 1.0

* Patent pending

1



2



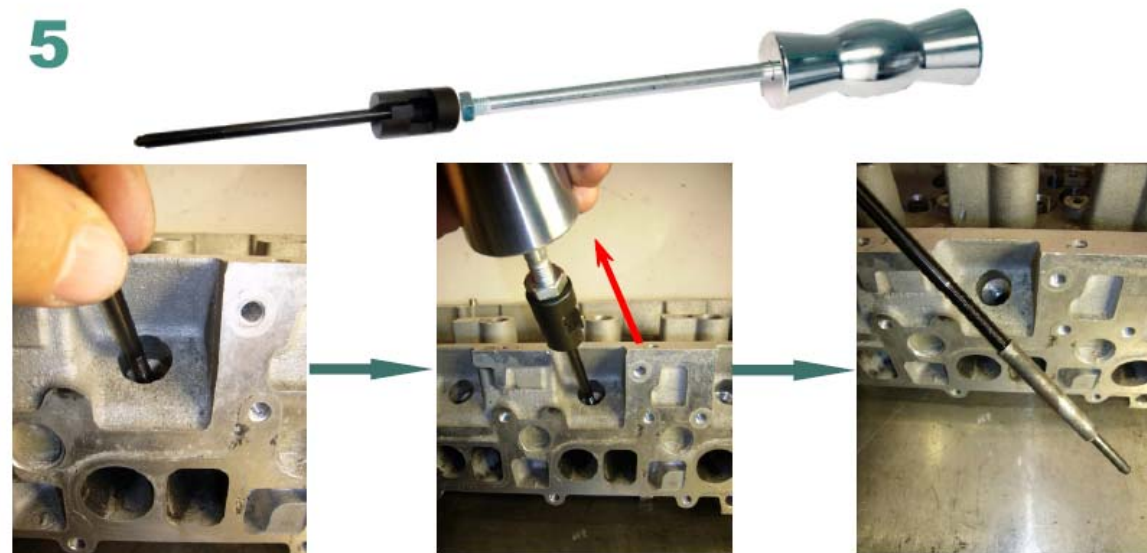
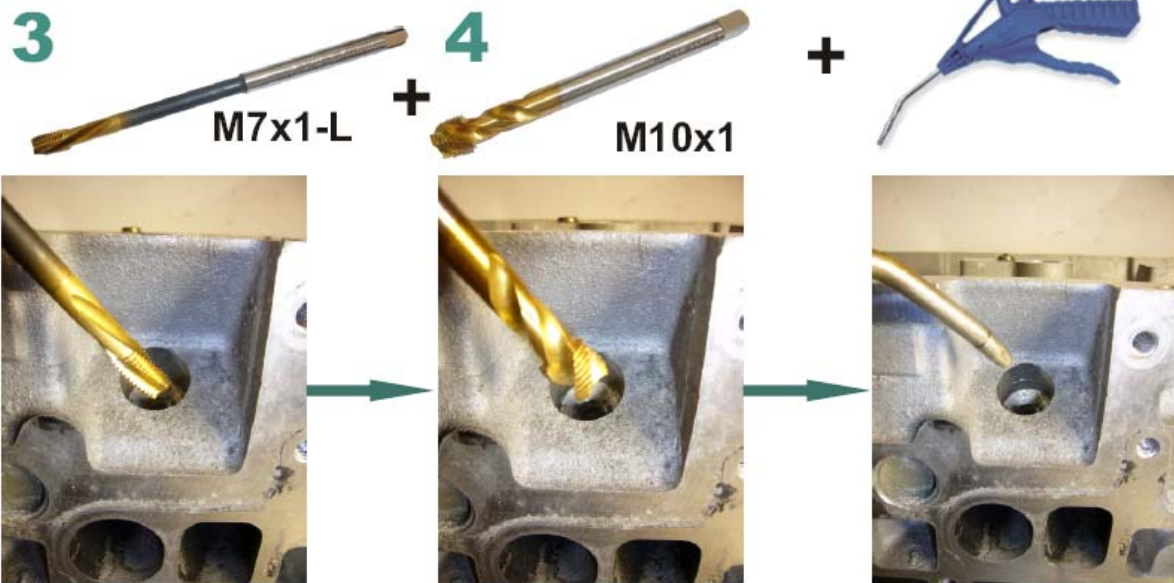

CONTENTS

- Extractor socket set 3pc - 1
- Special left drill 3 fluted 2 steps - 2
- Screw tap M6x1 left - 3
- Screw tap M8x1 - 4
- Removal tool M6x1 left - 5
- Adaptor for slide hammer M10 - 5

