



MAMMOTH
VALVE

Manual

This manual contains parts list with disassembly and reassembly instructions for the Mammoth Valve MV60TTF Series



McFinn Technologies, LLC
8920 58th Place, Suite 100
Kenosha, WI 53144
(262) 909-7267



Valve Disassembly

1. Ensure valve is in open position and tank is empty. Valve stem is open and in locked position
2. Remove spring clip from valve stem
3. Using a standard 3" fitting wrench (turn counterclockwise) loosen and remove the bonnet nut

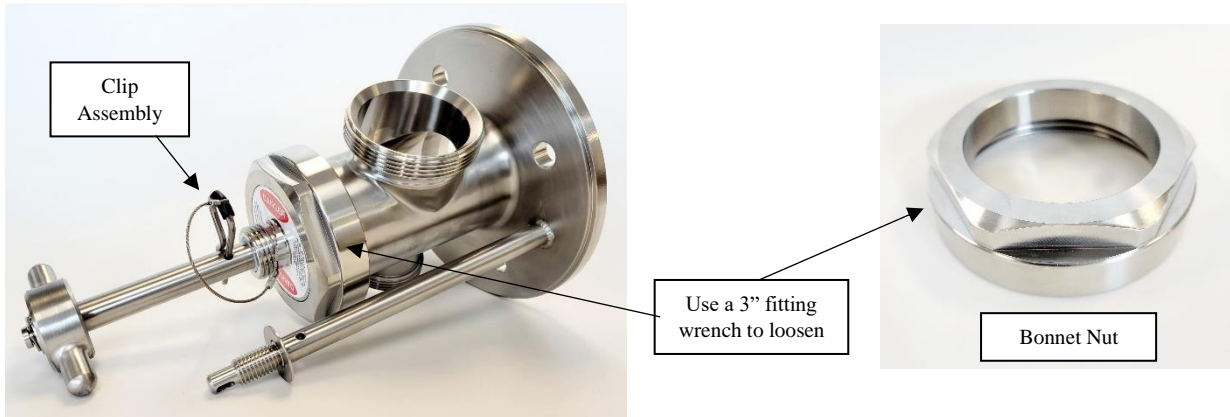

4. Remove the entire valve stem and bonnet assembly from valve body.
5. Remove the spring clip from stem nut and then remove stem nut and bonnet nut from valve stem assembly.

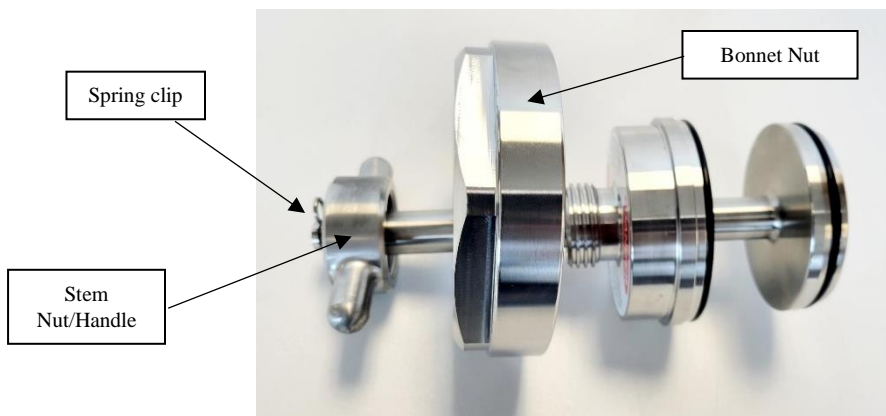

6. Slide valve bonnet off valve stem
7. Begin component inspection

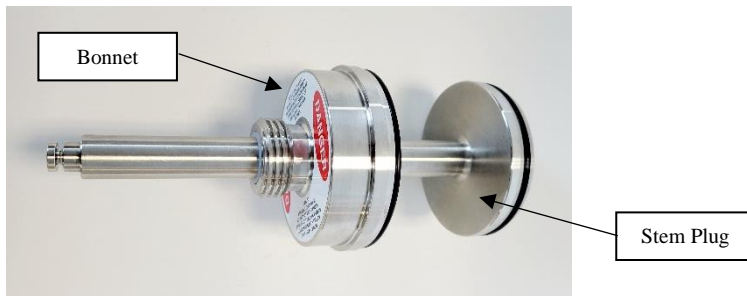

Note:

- Inspect all O rings for cuts, nicks, abrasions, or any damage that would allow leakage or ineffective cleaning

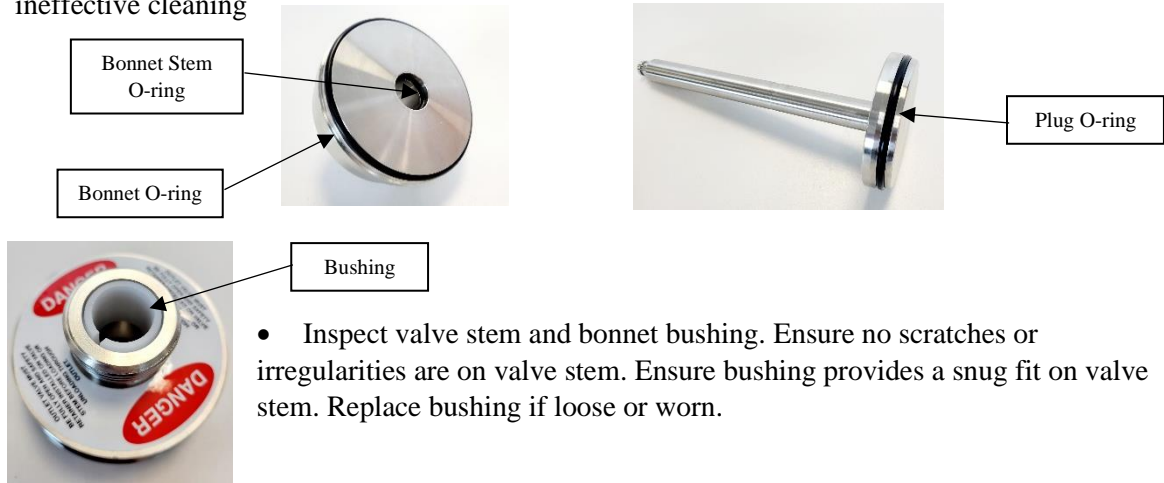

- Inspect valve stem and bonnet bushing. Ensure no scratches or irregularities are on valve stem. Ensure bushing provides a snug fit on valve stem. Replace bushing if loose or worn.

- Inspect valve seat in valve body for any nick, scratches or irregularities that could damage plug or cause valve to not seal or clean properly.



Re-assembly

1. Insert bonnet on valve stem. Ensure stem slides tightly through bonnet stem O ring and bushing.
2. Insert valve stem and bonnet into valve body. Ensure bonnet O ring is not kinked or pinched when seated on valve body.





MAMMOTH VALVE



Bonnet Nut

1. Place bonnet nut onto valve body and tighten
2. Attach stem nut with spring clip assembly



3. Cycle valve stem to open position
4. Close valve and hand tighten stem nut closed



5. Check valve stem plug and seat. Cycle valve and re-check.

Operating MV60TTF Valve



**DO NOT ATTEMPT TO UTILIZE THE MV60TTF VALVE FOR METERING
DO NOT TOUCH VALVE WHILE HOT LIQUIDS, CAUSTICS OR ACID
SOLUTIONS ARE IN USE**

Closed position

1. Ensure bonnet nut and stem nut are secured tightly
2. Ensure valve cover is in place and secured

Open position

1. Ensure bonnet nut is secure
2. Ensure valve stem is locked in the open position using the stem clip
3. Do not attempt to cycle valve or meter product with this valve.

Cleaning

Clean valve in accordance with approved local cleaning protocols



McFinn Technologies, LLC
8920 58th Place, Suite 100
Kenosha, WI 53144
(262) 909-7267



MAMMOTH VALVE

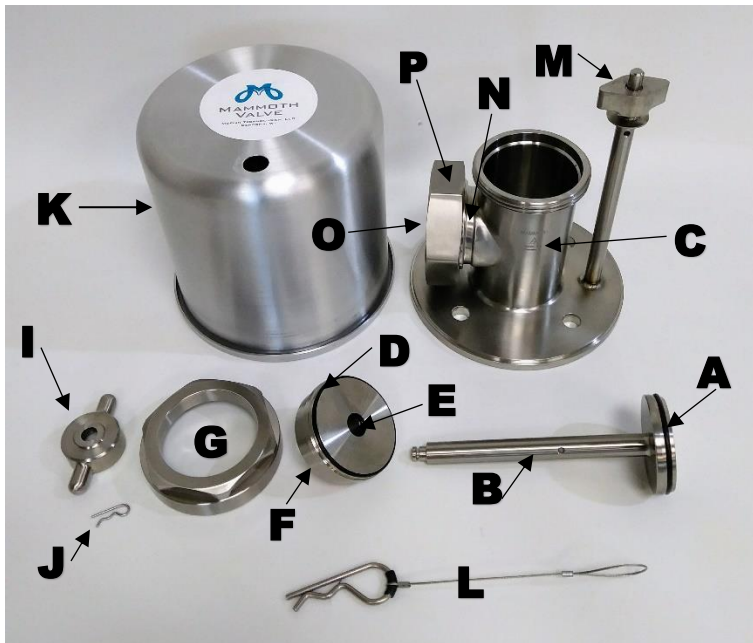
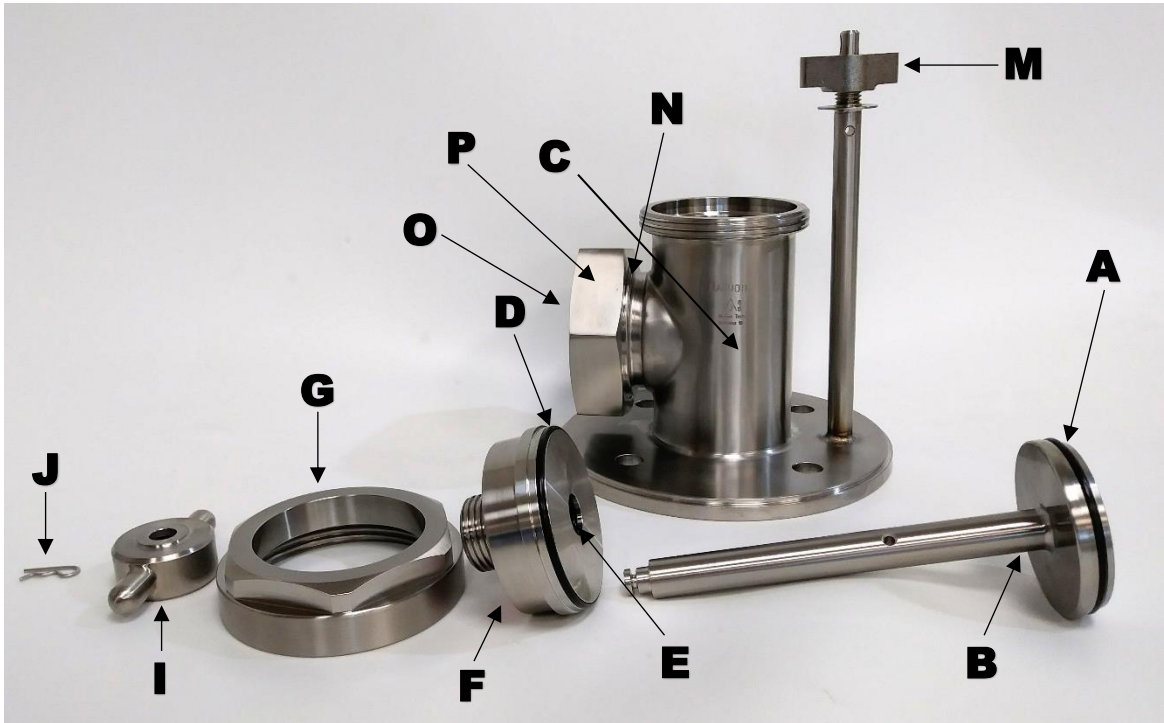

McFinn Technologies, LLC
8920 58th Place, Suite 100
Kenosha, WI 53144
(262) 909-7267



MAMMOTH VALVE

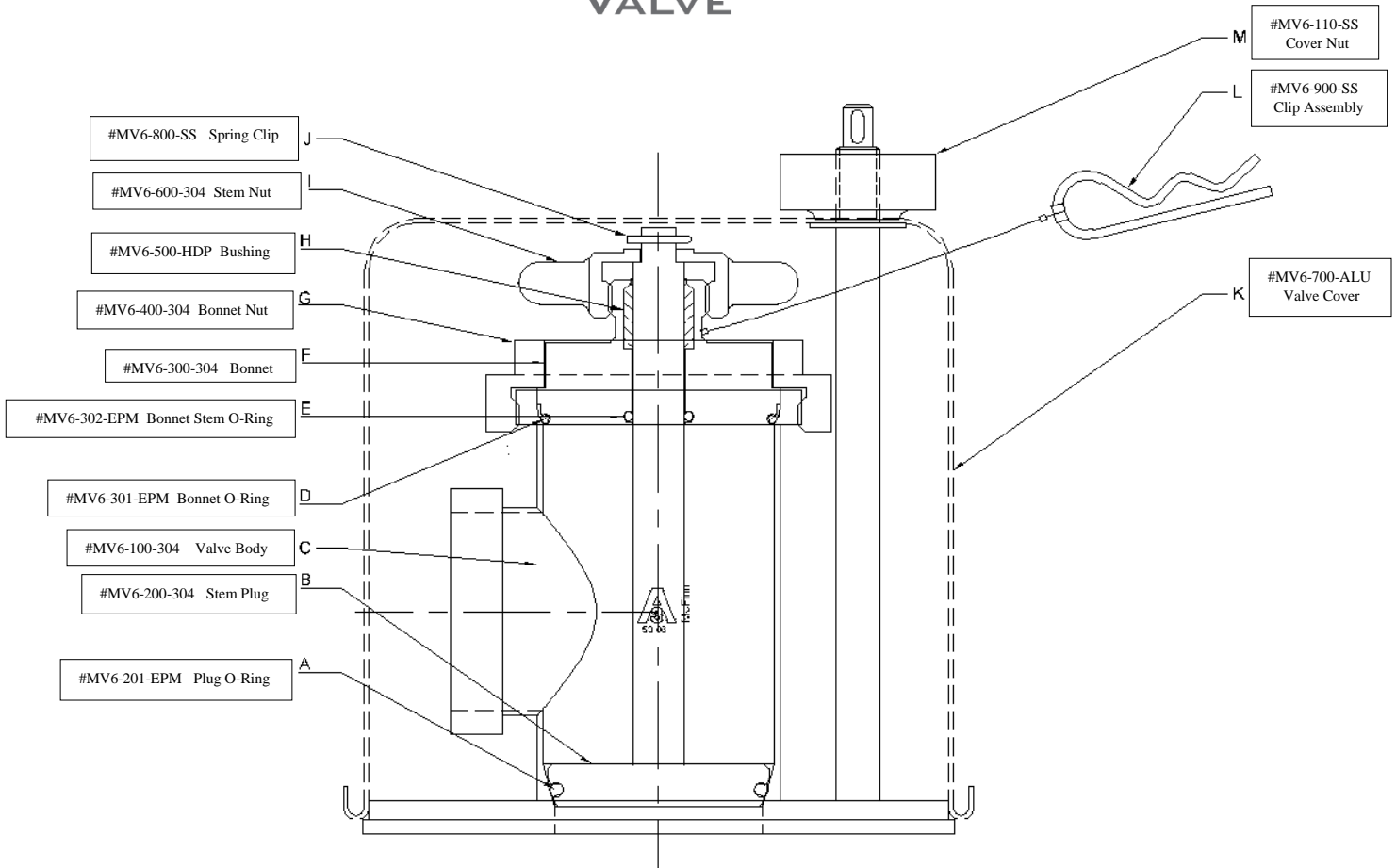

	PART #	DESCRIPTION
A	MV6-201-EPM	Plug O-Ring
B	MV6-200-304	Stem Plug
C	MV6-100-304	Valve Body
D	MV6-301-EPM	Bonnet O-Ring
E	MV6-302-EPM	Bonnet Stem O-Ring
F	MV6-300-304	Bonnet
G	MV6-400-304	Bonnet Nut
H	MV6-500-HDP	Bushing
I	MV6-600-304	Stem Nut / Handle
J	MV6-800-SS	Spring Clip
K	MV6-700-ALU	Cover
L	MV6-900-SS	Clip Assembly
M	MV6-110-SS	Cover Nut
N	MV6-40BS-BUN-3	3" Gasket
O	FTG 3" END CAP	3" End Cap
P	FTG 3" Bevel Nut	3" Bevel Nut



McFinn Technologies, LLC
 8920 58th Place, Suite 100
 Kenosha, WI 53144
 (262) 909-7267