

## Assembly

Do not cut your stethoscope tubing. Remove the chestpiece from your stethoscope and use the included tubing adaptors to connect CORE to your stethoscope. Tubing connectors for multiple stethoscope sizes are included.

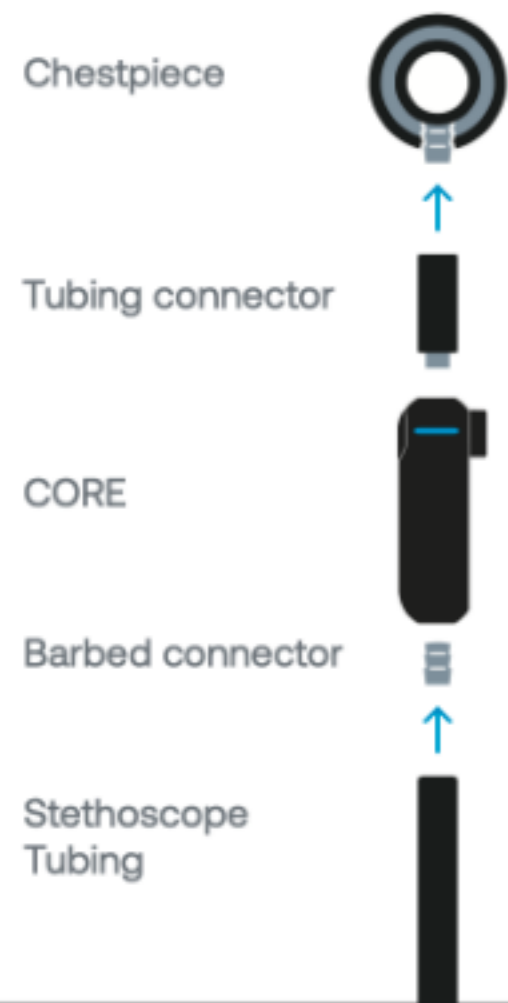

# CORE Attachment

## Quick Start Guide

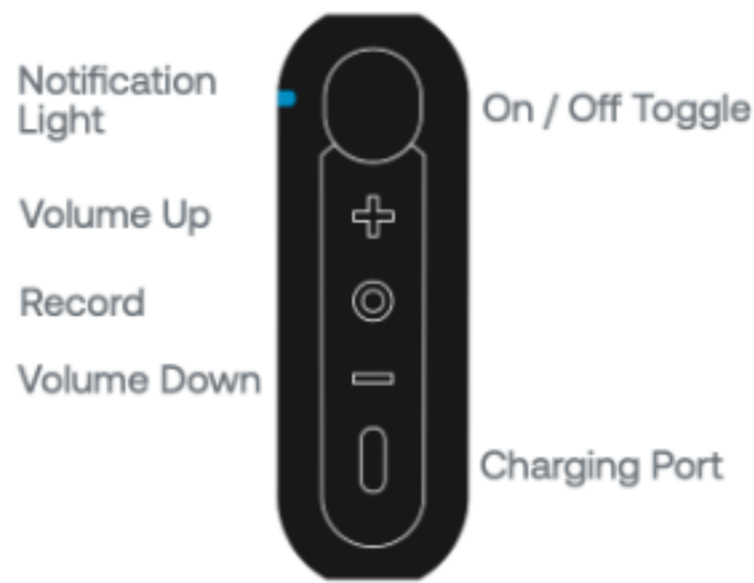

## Download the Eko App

The app is available in the App Store or Play Store. Enable bluetooth on your phone, open the app, and turn on CORE.

## In the Box

CORE, small and large tubing adaptors, and USB charging cable

## Compatibility

CORE is designed and tested to work with most acoustic stethoscopes.

## Turn On and Off

When CORE is off, it functions as a traditional stethoscope. To turn it on, press the toggle in. The light will begin flashing. You will hear amplified and filtered sound in the eartips.

## Volume

Use the (+) and (-) buttons to adjust volume. There are 7 volume levels.



CORE is on & seeking device



CORE is off & charging



CORE is low on battery



CORE is on & connected



CORE is fully charged



CORE is recording

## Charging

Connect the micro USB cable to the CORE and use a standard USB wall plug. The CORE will take about 2 hours to fully charge. The light will stop flashing when it is fully charged.

## Amplification

CORE provides up to 40x amplification for hearing support. CORE does not connect wirelessly to hearing aids.

## Active Noise Cancelling

The CORE includes active noise cancelling to remove ambient noise from the environment. Active Noise Cancelling can be turned off or on through the Eko app.



## User Manual and Support

Review the user manual before using your Eko CORE. To view the manual visit: [ekohealth.com/getstarted](http://ekohealth.com/getstarted)

For support, please email: [contact@ekohealth.com](mailto:contact@ekohealth.com)