

Quick Start Guide

CORE 500™
Digital Stethoscope



Step 1: Download the Eko App to Complete CORE 500™ Setup



Scan me

Step 2: Set Up CORE 500™

Attach earpiece

- Plug the earpiece into the CORE 500™.
- Twist the earpiece clockwise with a quarter turn until it locks.

Detach earpiece

- Twist the earpiece counterclockwise with a quarter turn until it unlocks.
- Remove the earpiece from the CORE 500™.

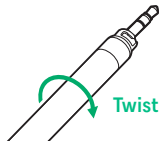
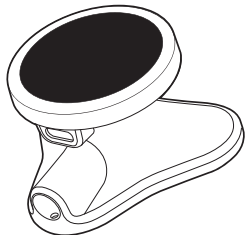

Twist Earpiece

Turn on

Press the top button.

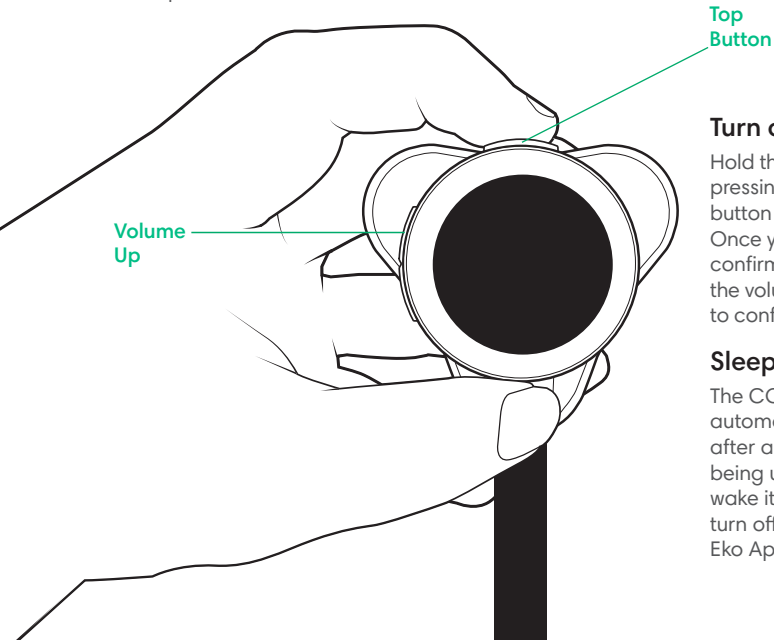

Turn off

Hold the top button while pressing the volume-up button once to turn it off. Once you see the confirmation screen, press the volume-up button again to confirm.

Sleep

The CORE 500™ automatically goes to sleep after a short period of not being used. Pick it up to wake it up again. You can turn off this setting in the Eko App.

Step 3: Connect CORE 500™ with Eko App

1. Open the Eko App and sign in.
2. Follow the onscreen instructions for pairing your device.
3. Press the volume up button to confirm the pairing if pairing for the first time.
4. The Bluetooth icon shows on the CORE 500™ screen when connected.

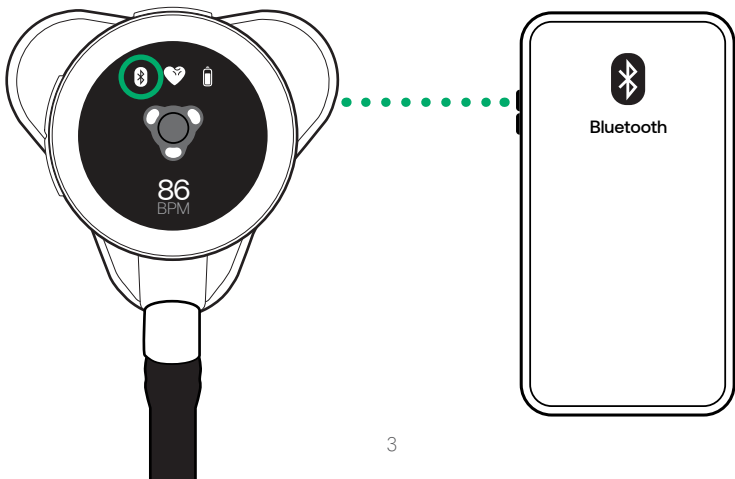

Understand CORE 500™ Screen

Resting state

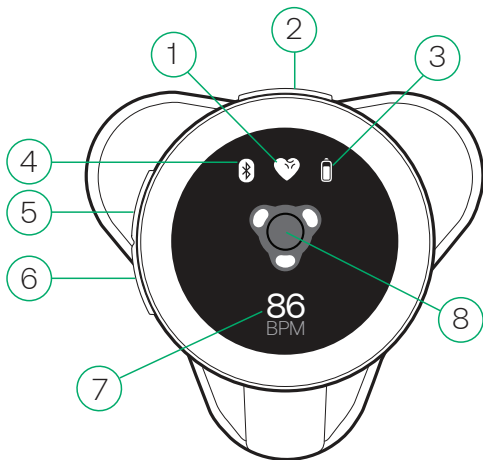

1. Current audio filter:

- Wide (for all use cases)
- Cardiac (with ECG)
- Pulmonary (with lung sounds)

2. Top button:

a. Change filter:

= short press for <1 second

b. Start recording:

= long press for 2 seconds

3. Battery level

4. Bluetooth connected

5. Volume up button

6. Volume down button

7. Real-time heart rate in beats per minute

8. Leads indicator:

- a. O= No skin contact detected
- b. ✓= Skin contact detected

Understand CORE 500™ Screen

Active state

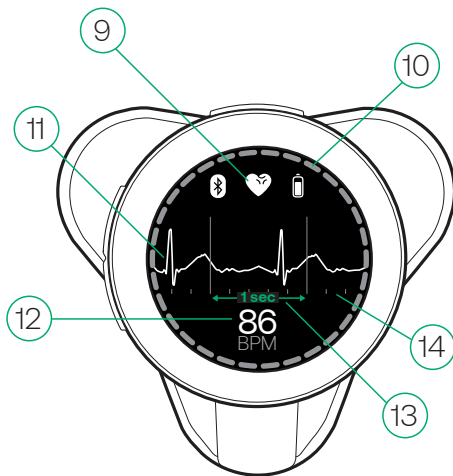

- 9. Current audio filter
- 10. Recording in progress
- 11. ECG waveform (shown in cardiac and wide filter)
- 12. Real-time heart rate in beats per minute
- 13. 1-second intervals
- 14. 0.2-second intervals

Tips to Improve ECG Signal

Placement

Place the CORE 500™ firmly on the patient's chest to get a clean ECG signal.

Interpret in Eko App

Use Eko App to read and interpret the 3-lead ECG. The ECG tracing on the CORE 500™ is the same as the 1st channel shown in the Eko App.

Skin preparation

- Clean the skin and/or electrodes with 70% IPA wipes to get a better ECG signal. Some wipes are included in the product box.
- ECG gel is recommended for patients with dry skin or significant body hair.

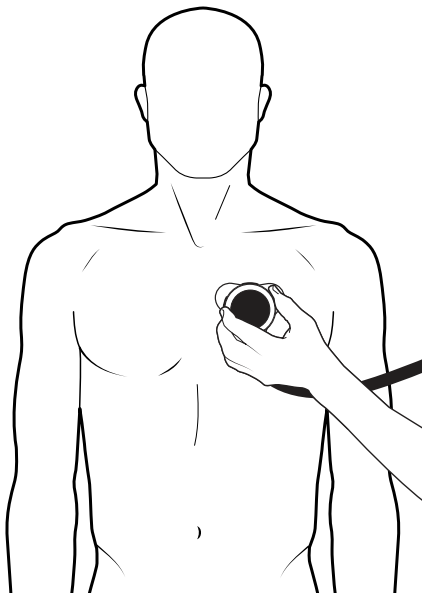

Learn More

To view the CORE 500™ Instructions for Use, or to visit our Eko Help Center, go to support.ekohealth.com.

Enterprise software users can contact their IT partner and/or Eko representative with onboarding questions.

Scan here to watch a getting started video:



Eko Health, Inc.
2100 Powell St, Suite 300
Emeryville, CA 94608 USA
www.ekohealth.com



©2023 Eko Devices, Inc.
LBL391 Rev 1.0 February 2023