

1. Prepare

Find and remove the buffer pot from the end of the test device.

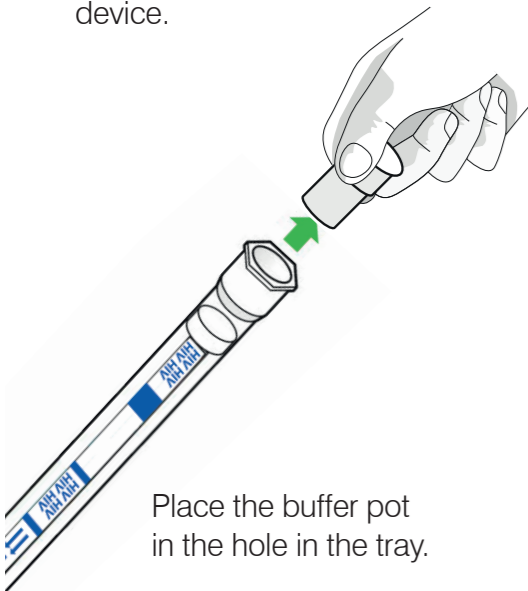

Place the buffer pot in the hole in the tray.

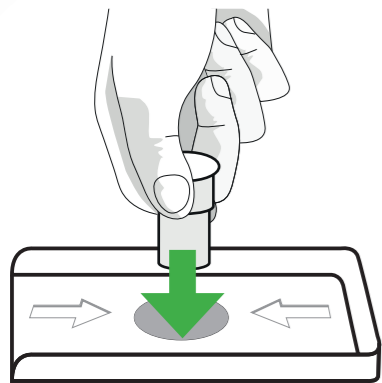

2. Sample

Remove cover.

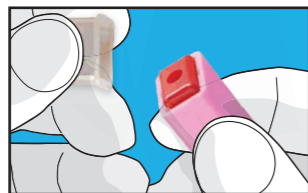

Place the red pad of lancet on side of finger.

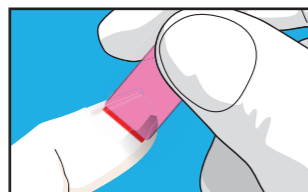

Push the lancet down until it "clicks".

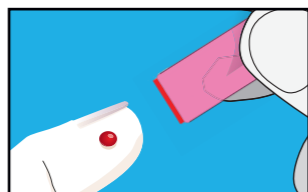

You can squeeze to make the drop bigger.

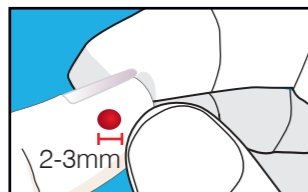

3. Collect

Touch the tip of your test onto the drop of blood. The tip will automatically fill.

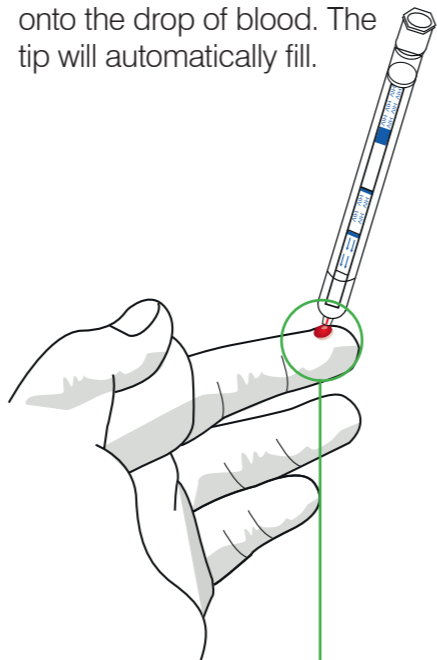

This is all you need...



4. Test

Push the tip of your test through the foil lid into the buffer pot: **PUSH DOWN HARD.**

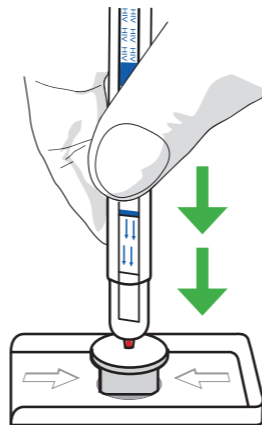

You **must** make sure that you **push completely down to the bottom of the buffer pot.**

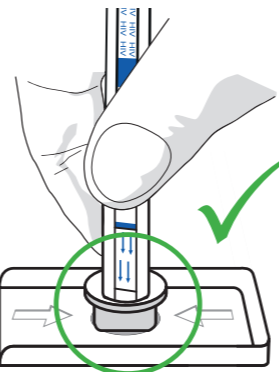

Now wait...



Start your timer. You need to time **15 minutes.**



After about **3 minutes**, **CHECK** to make sure your test is running.

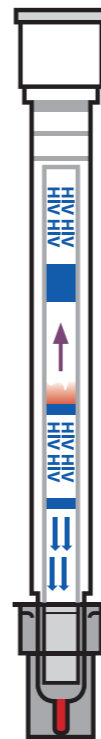

If your test is running, you will see colour moving up the test strip.

If not, push the test down to the bottom of the buffer pot.

5. Result

My test has...

1 LINE



My test result is **NEGATIVE**

2 LINES

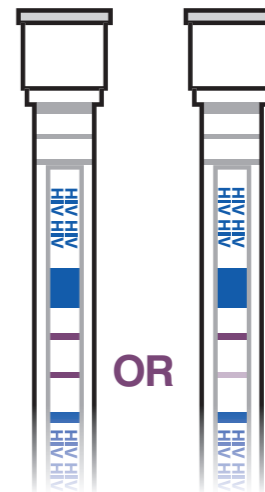

My test result is **POSITIVE**

NO LINES



My test did **NOT** work.

OPEN HERE

LAY YOUR TEST HERE.

5. Results

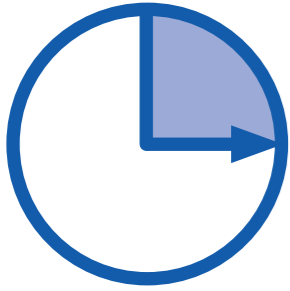

Wait 15 minutes for your test to run...

Then turn this page and read your test result.

You **MUST** have a positive test result confirmed by a healthcare professional.

31012HST EN REV.D.1 

HELPFUL TIPS

 Wash your hands and ensure that they are clean and dry before starting.

 It is recommended that you perform your test in a well lit area.

 If you normally wear spectacles to read, you should wear them while performing your test and reading your result.

 The lines on your test can only appear in the positions shown, but the line strength and shade can vary (See 5. Results)

 Do not read your result more than 1 hour after performing your test.

 The test and the lancet will only work once

 If you have any other questions please refer to the product insert supplied with your test.



You may see a faint **red mark** appear here.

THIS IS FROM YOUR BLOOD SAMPLE, IT IS NOT A LINE.

Disposal

To dispose of your BioSURE HIV Self Test, place all components back into the box and slip into the opaque disposal bag included. Seal the bag and discard with your normal household rubbish.

Not suitable for recycling.

For more information:

Visit www.hivselftest.com where you can also view our short instruction video.

 **BioSURE**
HIV Self Test

Before you start

You can watch our short instruction video.



When you are ready

Make sure your hands are clean and dry. Open the pouch by tearing here

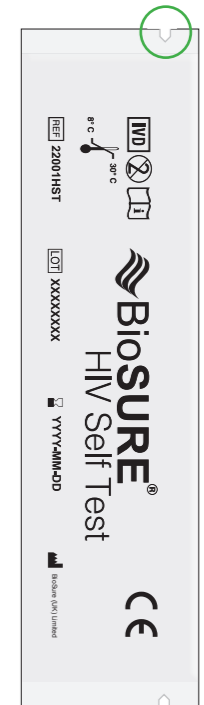

Your pouch contains:

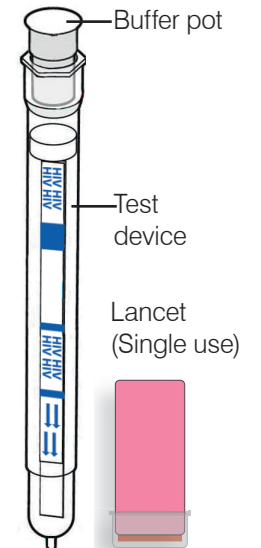

Copyright © 2019 BioSure (UK) Limited. All rights reserved.