

Ultra Slim Linear - 0.73" LSU7331

Architectural Linear with Integral Driver



PROJECT: TYPE: DATE:

NOTES:



Minimalistic specification grade architectural LED Profile delivers distinctive lines that are able to endorse any design for residential and commercial spaces.

- **Integral driver**
- 3,100 lumens per 4 foot section
- Direct, Indirect, Direct/ Indirect
- Extruded aluminum profile
- Suspended & Wall mount
- 83+CRI, 90+ CRI
- Offered in 4 foot sections (linkable up to 40ft)



ORDERING GUIDE Example: LSU7331-48D-04-30K-U-DM-83-WH-WH-SC

MODEL	SIZE/LUMENS	COLOUR TEMP.	VOLTAGE	DIMMING	CRI	FINISH
Select Model from Technical Information Table on P3	02 24" 1,938LM	30K 3000K	U 120V-277V	DM 0-10V	83 83+ CRI	WH White
	04 48" 3,100LM	40K 4000K				BK Black
	05 59" 3,100LM	Custom 2700K 3500K				GR Grey (RAL#9006)
	04L 48" 2,490LM					
R-FT Continuous Row	Specify "FT" in feet (Maximum 40ft)					
ONLY 4ft can be linkable		CANOPY FINISH		MOUNTING OPTION		
		WH White		SC Suspended canopy Suspended Wire Cable & Power Cable Length STSC -Standard 5ft (60" 1500mm)		
		BK Black		WM Wall mount Wall Mount Power Cable Length STWM -Standard 1ft (11.8" 300mm)		
		GR Grey (RAL#9006)		Custom length		
		Canopy for Suspended mounting only				

Ultra Slim Linear - 0.73" LSU7331

Architectural Linear with Integral Driver



SPECIFICATION

Construction

Extruded aluminum housing
Polycarbonate lens

Beam Angle

101°

Certification

ETL and cETL.
Rated Lifetime of L70 50,000 hrs

Electrical

0-10V dimming: 100%-10%
Power factor >0.9
Integral Driver Standard

Finish

Standard: Polyester powder coat white,
black or Grey

Warranty

5 year limited parts warranty

LED System

Available in 3000K, 4000K
Custom: 2700K, 3500K
83+CRI, 90+ CRI

Environment

Suitable for dry or damp locations
Indoor use only
-20°C to 40°C (-4°F to 104°F)

DIMENSIONS

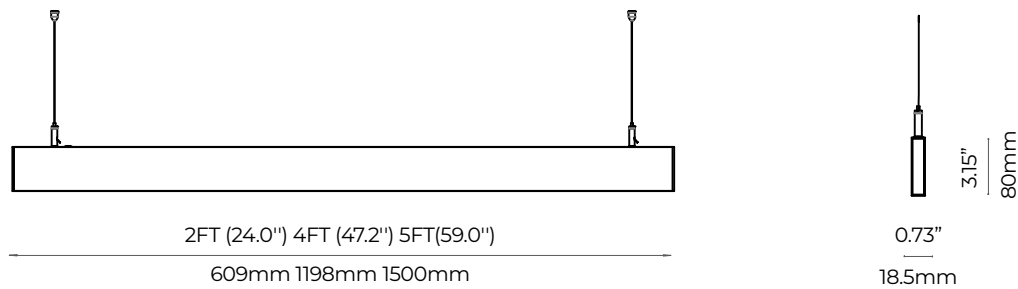

MOUNTING OPTIONS



SC

Suspended canopy

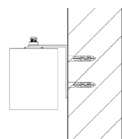

WM

Wall mount

Ultra Slim Linear - 0.73" LSU7331

Architectural Linear with Integral Driver



TECHNICAL INFORMATION

Size	Model	Lighting			Lumens	Wattage	lumen/W	lumen/ft	Watt/ft
2ft (02)	24D	Direct	Direct (Downlight)	100%	1,938	25.0	77.5	484.4	12.5
	24ID	Indirect	Indirect (Uplight)	100%	1,938	25.0	77.5	484.4	12.5
	24DID	Direct / Indirect	Indirect (Uplight)	26%	504	6.5	20.2	125.9	2.6
			Direct (Downlight)	74%	1,434	18.5	57.4	358.4	7.4
			Total	100%	1,938	25.0	77.5	484.4	12.5
4ft (04) (3,100 lumens)	48D	Direct	Direct (Downlight)	100%	3,100	40.0	77.5	775.0	10.0
	48ID	Indirect	Indirect (Uplight)	100%	3,100	40.0	77.5	775.0	10.0
	48DID	Direct / Indirect	Indirect (Uplight)	26%	806	10.4	20.2	201.5	2.6
			Direct (Downlight)	74%	2,294	29.6	57.4	573.5	7.4
			Total	100%	3,100	40.0	77.5	775.0	10.0
5ft (05)	59D	Direct	Direct (Downlight)	100%	3,100	40.0	77.5	775.0	10.0
	59ID	Indirect	Indirect (Uplight)	100%	3,100	40.0	77.5	775.0	10.0
	59DID	Direct / Indirect	Indirect (Uplight)	26%	806	10.4	20.2	201.5	2.6
			Direct (Downlight)	74%	2,294	29.6	57.4	573.5	7.4
			Total	100%	3,100	40.0	77.5	775.0	10.0
4ft (04L) (2,490 lumens)	48DL	Direct	Direct (Downlight)	100%	2,490	32.0	77.8	622.5	8.0
	48IDL	Indirect	Indirect (Uplight)	100%	2,490	40.0	62.3	622.5	10.0
	48DIDL	Direct / Indirect	Indirect (Uplight)	26%	647	8.3	20.2	161.9	2.6
			Direct (Downlight)	74%	1,843	23.7	57.6	460.7	7.4
			Total	100%	2,490	32.0	77.8	622.5	10.0

Ultra Slim Linear - 0.73" LS7331

Architectural Integral Driver Linear



DISTRIBUTION & OPTICAL

