

# M3-5656

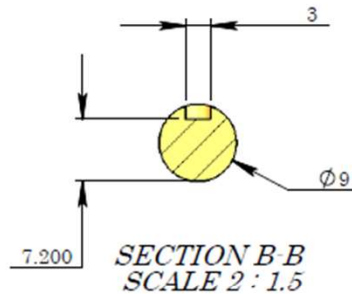

Description: M3 Brushed DC motor 9mm shaft with 3mm key slot; 80mm flange (65mm PCD) – D56B14	Drawing # M3-5656 Revision # 1
	Drawn By: Date:
Notes:	Approved By: C.Matheou Date: 14/07/2005
	Part Number: M3-5656

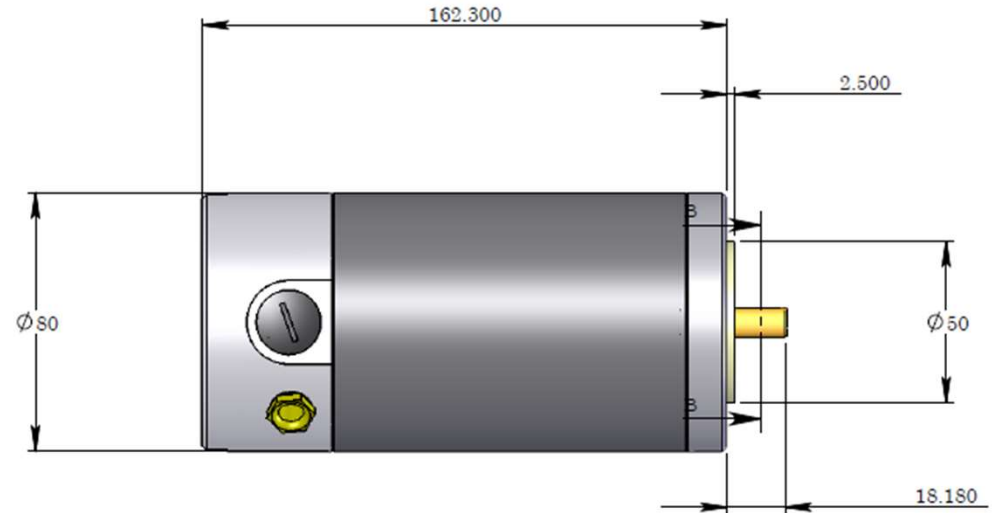
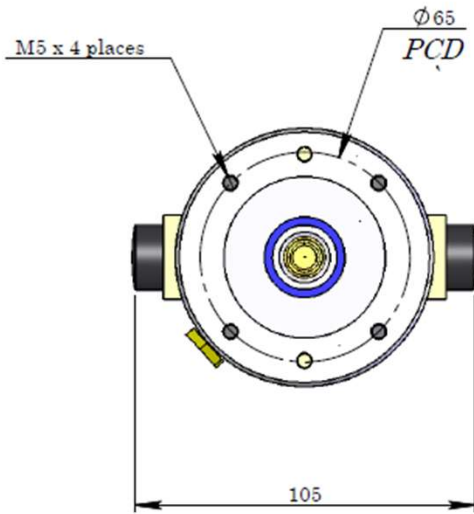

# M3-6364

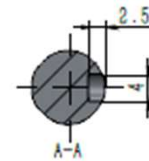
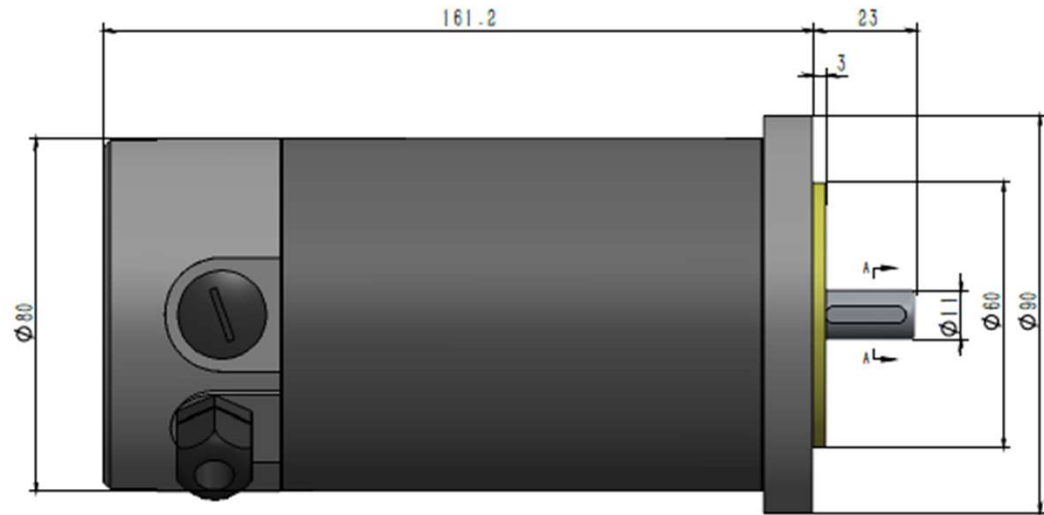
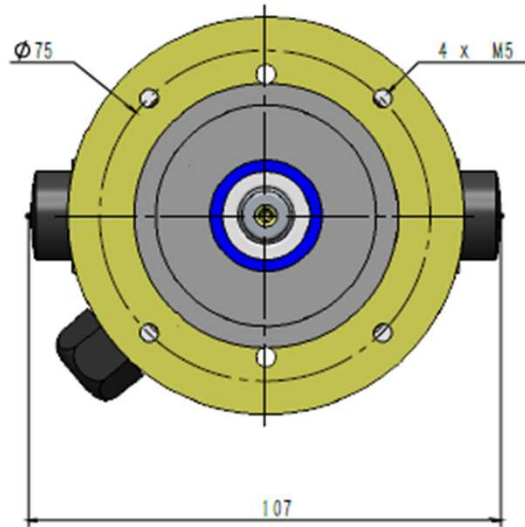

Description: M3 Brushed DC motor 11mm shaft with 4mm key slot; 90mm flange (75mm PCD) – D63B14	Drawing # M3-6364 Revision # 1
	Drawn By: Date:
Notes:	Approved By: C.Matheou Date: 14/07/2005
	Part Number: M3-6364



# M3-6363

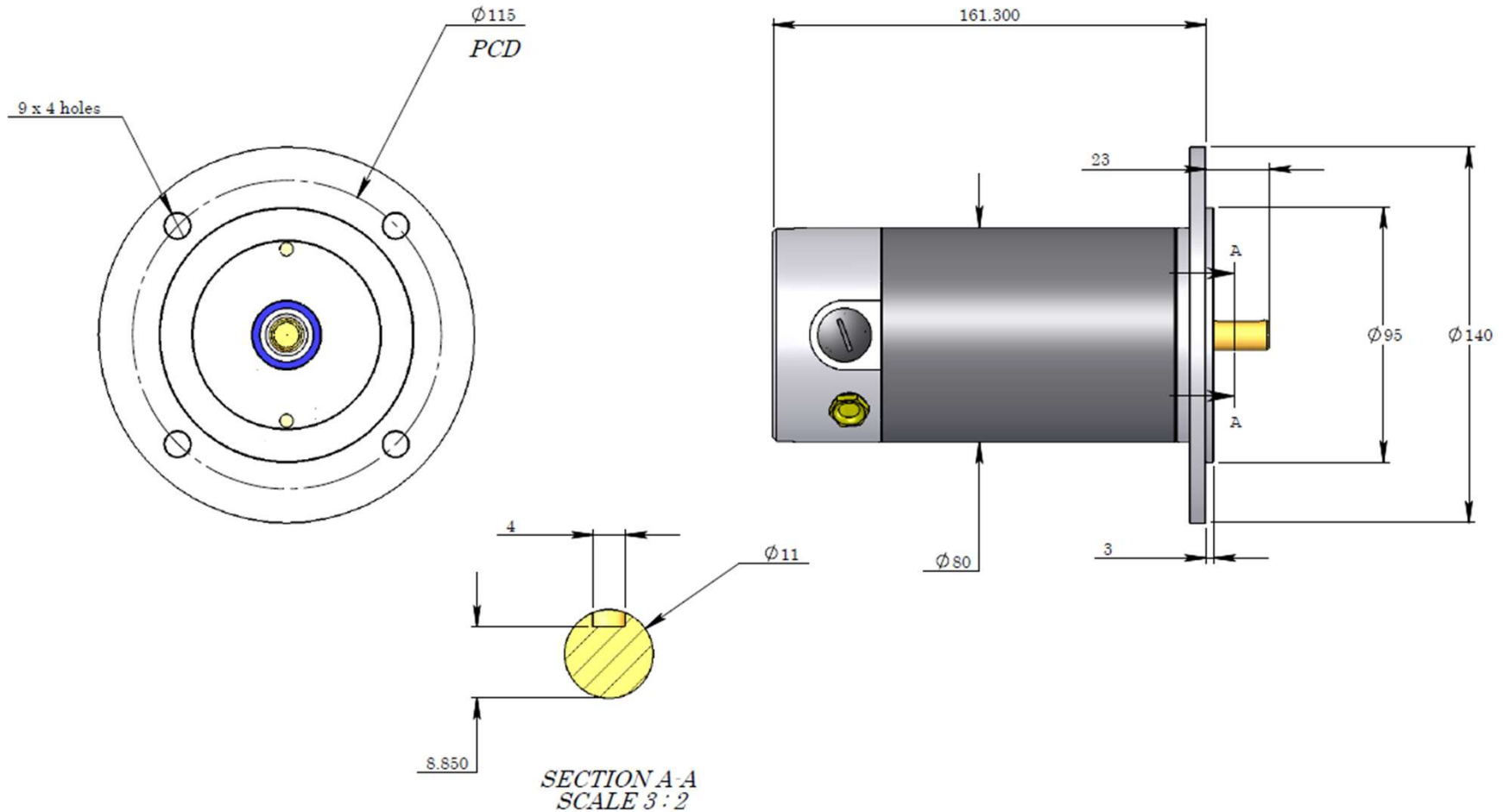

Description: M3 Brushed DC motor 11mm shaft with 4mm key slot; 140mm flange (151mm PCD) – D63B5	Drawing # M3-6363 Revision # 1
	Drawn By: Date:
Notes:	Approved By: C.Matheou Date: 14/07/2005
	Part Number: M3-6363

