

Lansinoh®

Compact Single Electric Breast Pump

Instructions for Use



Important Safeguards

The Lansinoh® Compact Single Electric Breast Pump is a personal care item and for hygienic reasons should never be shared between mothers or resold from one mother to another. Either of these actions will void the warranty.

If you are a mother who is infected with Hepatitis B, Hepatitis C or Human Immunodeficiency Virus (HIV), pumping breastmilk using the Lansinoh® Compact Single Electric Breast Pump will not reduce or remove the risk of transmitting the virus to your baby through your breastmilk.

When using electrical products, especially when children are present, basic safety precautions should always be maintained, including the following:

Intended Use of Breast Pump

Lansinoh Compact Single Electric Pump is intended to express and collect the breastmilk of a nursing woman for the purpose of feeding collected breastmilk to a baby. Lansinoh Compact Single Electric Pump is intended for a single user.

Indications of Breast Pump

Lansinoh Compact Single Electric Pump enable mothersto provide breast milk for babies who cannot feed directly at the breast for a variety of reasons, such as latch-on problems, premature or unwell babies.

Contraindication of Breast Pump

There are no known contraindications.

Warning: To reduce the risk of burns, electrocution, fire, or injury to persons:

- This product should never be left unattended when plugged in.
- Close supervision is necessary when this product is used near children.
- Use this product only for its intended use as described in this manual. Do not use attachments not recommended by the manufacturer.
- Never operate this product if it has a damaged cord or plug, if it is not working properly, if it has been dropped or damaged, or dropped into water.
- Keep the cord away from heated surfaces.
- Never use while sleeping or drowsy.
- Never drop or insert any object into any opening or tubing.
- Do not use this product if it is broken or any parts are missing.
- Do not allow small children or pets to play with the pump unit, AC adapter, etc.
- Do not use outdoors with the AC adapter or operate where aerosol spray products are being used or where oxygen is being administered.

Packaging materials are not part of the product. For your child's safety, please remove and discard all packaging materials prior to use but read and retain the instructions for future reference.

Save these instructions and your receipt for future reference.

Read All Instructions Before Using

Danger: To reduce the risk of electrocution:

- Always unplug this product immediately after using.
- Do not use while bathing.
- Do not place or store this product where it can fall or be pulled into a tub or sink.
- Do not place or drop pump into water or other liquid.
- Do not reach for an electrical product that has fallen into water. Unplug immediately.

1. QUICK START GUIDE	2
2. PUMP	2
2.1 Breast Pump Parts and Accessories	2
2.2 Cleaning Instructions	4
2.3 Assembling the Breast Pump	4
2.4 Using the Breast Pump	4
2.5 Breast Flange Sizing	5
2.6 Pumping Tips	5
2.7 Troubleshooting	6
3. BREASTMILK STORAGE GUIDELINES	7
4. TECHNICAL DATA	8
4.1 Power Supply	8
4.2 Control System	8
4.3 Regulatory Compliance	8
5. CUSTOMER SERVICE	8
6. WARRANTY	8

Please do not return this pump to the retailer.

Lansinoh's Customer Service team is here to help. If you experience any issues with the product, please call our Customer Service Department at +86 400 821 0385, email customerservice@lansinoh.cn, visit our website www.lansinoh.cn, or contact your country distributor.

Health protection & Hygiene i.e. for health protection and hygiene reasons, breast pumps may not be returned or exchanged once the hygiene seal has been broken. If your product is faulty, please contact our Customer Service Department.

1. QUICK START GUIDE

DO NOT wash tubing.

Before first use, clean all parts that will come into contact with milk according to instructions on page 3, section 2.2.

Assembly

See detailed instructions on page 3, section 2.2. Proper assembly is essential to ensure proper function and suction.



Insert purple diaphragm so that feet align with the cutouts on the breast flange body



Attach clear cover and twist so tubing connector is at the back



Attach breast flange



Insert valve



Attach bottle



Attach tubing



Secure connector







Attach to electric pump unit

Only use the Lansinoh® Compact Single Electric Breast Pump with Lansinoh® Breastmilk Expression Set.

Getting Started

Hold Breastmilk Expression Set to your breast so your nipple will extend straight toward the nipple tunnel of the breast flange. Make sure the breast completely fills the ComfortFit® breast flange so that a vacuum is formed and no air escapes. Make sure the set is tilted slightly downward to allow milk to flow into the bottle.

Using Let-Down and Expression Phases

- Press the power button  to start the pump in Let-Down Phase . Let-Down Phase will run automatically for 2 minutes.
- To begin the Expression Phase sooner, press the Let-Down/Expression toggle button  to move to the Expression Phase. Press the Let-Down/Expression toggle button  again at any point to switch back to Let-Down Phase.
- Let-Down Phase is a faster pumping style that mimics the short, rapid sucking your baby uses to initiate milk flow.
- Expression Phase mimics the slower, deeper sucking of feeding, and features 5 adjustable suction levels that can be tailored for your comfort.
- The breast pump features LED lights beneath the purple keypad to indicate which setting you are on. Let-Down Phase is identified on the keypad with slowly dimming LED lights. Expression Phase is identified on the keypad with still LED lights.

2. PUMP

2.1 Breast Pump Parts and Accessories

Breast pump unit

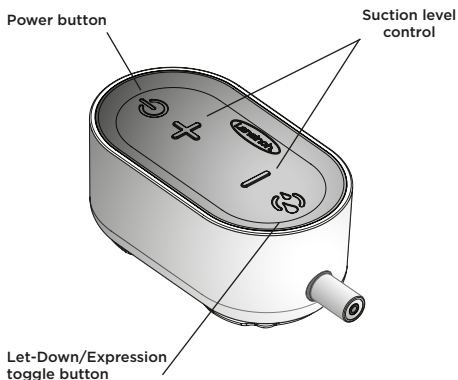

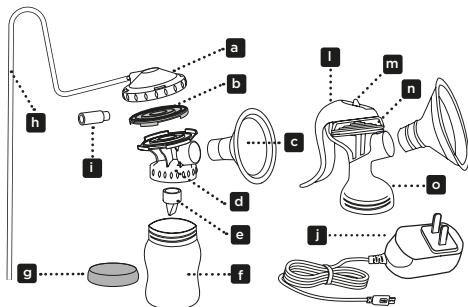

Breastmilk Expression Set	
a	Diaphragm Cap
b	Diaphragm
c	ComfortFit® Breast Flange (25mm)
d	Breast Flange Body for Electric Pump
e	White Valve
f	Soz (160ml) Bottle
g	Sealing Cap
Breast Pump Parts and Accessories	
h	Silicone Tube (800mm)
i	Pump Connector
j	AC Adapter
Manual Breast Pump Parts	
l	Handle
m	Stem
n	Silicone Diaphragm
o	Breast Flange Body for Manual Pump

2.2 Cleaning Instructions

*Unless otherwise instructed by your health care provider, follow these instructions.

**DO NOT wash tubing or connector.

Cleaning of Breastmilk Expression Set Before First Use

1. Always wash and dry hands thoroughly with soap and water before handling the Breastmilk Expression Set.
2. Disassemble the Breastmilk Expression Set and place parts in a large pot.
3. Cover the parts in water making sure there is room for all of the parts to float freely in the pot.
4. Bring the water to the boil and allow the parts to a boil for 5 minutes.
5. After boiling remove the parts from the pot with tongs and place the pieces neatly on a clean paper towel or in a clean drying rack and allow them to air dry.
6. Allow the parts to dry completely before assembly and use. Partially dried parts may affect the operation of

the pump.

7. Once parts are dry they can be stored in a clean plastic tub with a lid or in a clean plastic zipper bag.

Cleaning of Breastmilk Expression Set Before Each Use

1. Always wash and dry hands thoroughly with soap and water before handling the Breastmilk Expression Set.
2. Before assembling the Breastmilk Expression Set, be sure that all of the parts are completely dry.
3. Visually inspect the individual components for cracks, chips, tears, discoloration or deterioration. These may affect the functionality of the pump.
4. Should you have any questions or concerns about your parts please contact Lansinoh at **+86 400 821 0385**, Wechat account:lansinoh520, visit our website www.lansinoh.cn, for further guidance.

Cleaning of Breastmilk Expression Set After Each Use

1. Disassemble the Breastmilk Expression Set, setting aside tubing and connectors
2. Rinse all parts with cold water immediately after use. Place pump parts in a clean wash basin used only for washing infant feeding equipment. Do not place pump parts directly in the sink because germs in sinks or drains could contaminate the pump.
3. Hand wash all parts of the Breastmilk Expression Set using warm soapy water. A teat brush may be used to scrub the hard plastic pieces of the Breastmilk Expression Set, but should not be used on the white valve or diaphragm.
4. Rinse parts with running clean, warm water, or by submerging in fresh water in a separate basin that is only used for cleaning infant feeding equipment.
5. Place parts in a pot and cover with water making sure there is room for all of the parts to float in the pot.
6. Bring the water to a boil and allow to boil for 5 minutes.
7. After boiling remove the parts from the pot with tongs and place the pieces neatly on a clean paper towel or in a clean drying rack and allow them to air dry. Do not use a dish towel to rub or pat items dry because doing so may transfer germs to the items.
8. Allow the parts to dry completely before assembly and use. Partially dried parts may affect the operation of the pump.
9. Once parts are dry they can be stored in a clean plastic tub with a lid or in a clean plastic zipper bag.
10. Clean your wash basin and bottle and/or teat brush after each use.
11. Electric unit should be wiped down with a clean paper towel or soft cloth after use. The electric unit should never be put into water or other liquids for cleaning.

WARNING: Use caution when cleaning the small white valve. It is important for proper suction. Do not use excessive force and do not clean with a baby bottle brush or a nipple brush. Gently wash by hand in hot, soapy water and rinse under hot running water.

WARNING: It is highly recommended not to use any method other than the above mentioned cleaning methods.

To use steam or microwave sterilisers: Follow the manufacturers instructions. Ensure all openings are face down in the steriliser. Ensure you wash your hands before removing equipment from the steriliser.

2.3 Assembling the Breast Pump

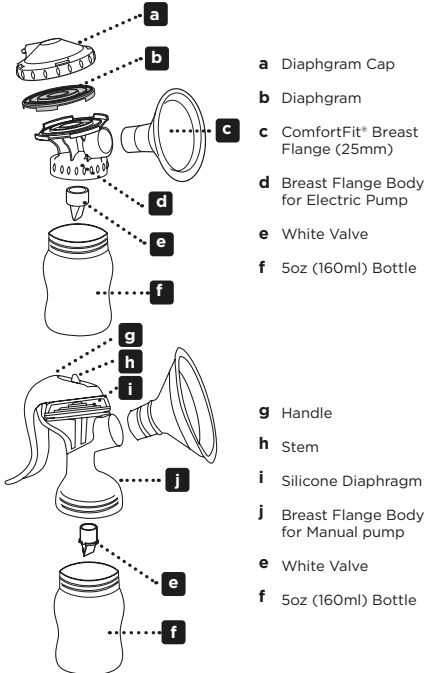

2.4 Using the Breast Pump

The Lansinoh® Compact Single Electric Breast Pump is very easy to use, offering several settings that you can customise to maximise your milk production and comfort. There are 2 elements which you can customise whilst expressing, and the breast pump features LED lights beneath the purple keypad to indicate which setting you are on.

Let-Down and Expression Phases



When babies breastfeed, they start with quick sucking to stimulate your milk let-down and flow. Once your milk has let down, the baby draws the milk out with slower, deeper sucks. To simulate this natural rhythm, the The Lansinoh® Compact Single Electric Breast Pump offers two phases – the Let-Down Phase and the Expression Phase.

- Let Down-Phase is a faster pumping style which mimics the short, rapid sucking your baby uses to initiate milk flow
- Expression Phase mimics the slower, deeper sucking of feeding and features 5 adjustable suction levels that can be tailored for your comfort.

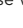
The switch between the 2 phases can be easily operated using the Let-Down/Expression toggle button. Let-Down Phase is identified on the keypad with slowly dimming LED lights. Expression Phase is identified on the keypad with still LED lights.

When the pump is turned on, it starts in Let Down-Phase and will automatically switch to the Expression Phase after 2 minutes. If your milk starts flowing before the 2 minute transition, you can switch to Expression Phase at any point by pressing the  button. You can always return to the Let-Down Phase when needed by pressing the  button again.

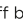
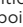
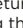
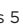
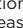
Operating the Breast Pump

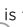
1. Ensure that the breast pump has been properly cleaned. Wash your hands thoroughly and make sure your breasts are clean.
2. Ensure the breast pump and Breastmilk Expression Set have been correctly assembled and the silicone tube is securely attached to the pump via the tubing connector and to the diaphragm cap.
3. Hold the Breastmilk Expression Set to your breast with the centre of your nipple extending towards the tunnel of the ComfortFit® breast flange.
4. Make sure the breast completely fills the ComfortFit® breast flange so that a vacuum is formed and no air escapes.
5. The Breastmilk Expression Set and nipple tunnel must tilt slightly downward to allow milk to flow naturally toward the bottle.
6. Press and hold the On/Off button  for a few seconds to turn the pump on.
7. The breast pump will always start in Let-Down Phase Level 3 and will automatically switch to Expression Phase after 2 minutes. If your milk starts flowing before the 2 minute transition, you can switch to Expression Phase at any point by pressing the  button. You can always return to the Let-Down Phase when needed by pressing the  button again.
8. The Expression Phase has 5 adjustable suction levels. You can increase the suction level by pressing the  button. You can decrease the suction level by pressing the  button. A maximum of 5 LED lights will illuminate depending on the selected suction level.
- **Note: If at any time the suction becomes uncomfortable, reduce it by pressing the  button.**
9. When a pumping session is finished, turn the pump off with the On/Off Button . Ensure there is no suction on the nipple before removing the ComfortFit® breast flange from the breast. If necessary, break the suction

by inserting a finger between the breast flange and the breast. Once the suction is broken, the ComfortFit® breast flange can be removed safely.

- Carefully remove the bottle from the breast flange body and close the bottle with the sealing cap provided. Please follow the breastmilk storage guidelines as outlined in Section 3.

● **Note: If the pump unit is left on and unattended for more than 60 minutes, it will automatically power off.**

Power Options

The pump may be operated using the following power supply modes:

- **AC adapter**
Connect the AC Adapter to the power connector socket located on the On/Off button side of the pump. Plug the AC Adapter into an available electrical outlet. Electrical safety can only be achieved when the breast pump is connected to the AC Power Adapter supplied with the product (See “Technical Data” section).
- **Power bank (not included)**
Connect the power bank USB cable to the power connector socket located on the On/Off button side of the pump. Electrical safety can only be achieved when the breast pump is connected to the power bank specified power supply (See “Technical Data” section).

We recommend using your pump with the AC adapter provided.

The Lansinoh® Compact Single Electric Breast Pump can easily switch to Manual Breast Pump.

Note: Prior to assembling the Lansinoh® Manual Breast Pump, ensure that all parts have been cleaned.

1. Wash your hands thoroughly.
2. Insert the stem into the silicone diaphragm.

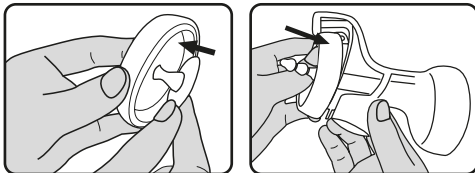

3. Place the silicone diaphragm and stem on top of the breast flange body (for manual breast pump). Make sure it fits securely around the rim by pressing down with your fingers to ensure a perfect seal. (These parts are designed to fit snugly.)

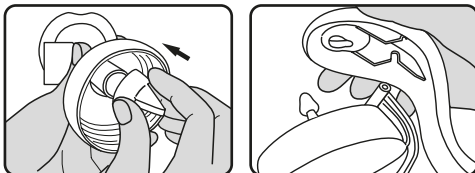

4. Gently secure the white valve onto the breast flange body from underneath, making sure white valve is flush with the breast flange body. It is not necessary to use excess force when attaching the white valve.
5. Align the groove in the handle with the breast flange body and gently press the handle down. Push until you hear it click.
6. Adjust the stem and handle so that the stem fits the first notch of the handle, known as the Let-Down Phase setting.



7. Attach the ComfortFit® breast flange to the breast flange body.
 - To switch to Expression Phase, gently press the “PUSH” part at the tip of the handle to set the handle to the second(bottom) notch of the stem. Continue to squeeze and release the handle to find the appropriate suction pressure.
 - To return to the Let Down Phase from the Expression Phase,(1) Pull the tip of the stem towards you,(2) gently squeeze the handle, and set it in the first(top) notch.

2.5 Breast Flange Sizing

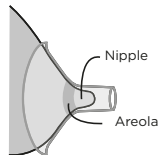

When you are pumping only your nipple and a small amount of your areola should be pulled into the breast flange tunnel. If a large amount of areola is being pulled into the tunnel, this indicates that the breast flange is too large. You need a smaller size.

When you are pumping your nipple should move in and out of the tunnel freely. If you notice that your nipple is touching or rubbing along the sides of the tunnel, this indicates that the breast flange is too small. You need a larger size.

The breast cushion you received with the pump is 25mm. 21mm, 28mm, 30.5mm and 36mm ComfortFit® breast cushions are available for purchase. Simply visit www.lansinoh.cn, or call +86 400 821 0385 or contact your country distributor for guidance.

2.6 Pumping Tips

Breastmilk is produced on a supply and demand basis. Expressing your breastmilk regularly will stimulate your body and help you maintain your milk supply. If you have any breastfeeding or breast pump related questions, consult an International Board Certified Lactation Consultant (IBCLC), breastfeeding counselor, or other healthcare provider such as your midwife or health visitor.

Top Tips for Pumping Sessions

- If you and baby are apart, look at their pictures or videos, or have something with your baby's scent on it. These cues will help to trigger let-down.
- If baby is with you, skin-to-skin contact and scent will help to trigger let-down. You may pump one breast while nursing baby on the other. This allows you to maximize pumping effectiveness by using the let-down reflex stimulated by your baby's sucking.
- Give yourself sufficient time to pump. Stress can negatively impact milk production.
- Stay hydrated; having a glass of water before and during each session is important for milk production.
- Many mums find that they have a high milk supply in the morning after sleeping, so you may find it helpful to try a morning pumping session.
- Some mums can achieve more than one let-down during a pumping session. You may be able to achieve a second by returning to the Let-Down Phase by pressing the Let-Down/Expression toggle button.
- Track the date, time, and duration of your feeding and pumping sessions as well as the amount of milk expressed from each breast. Keeping these records can help you identify trends or patterns so you can establish your optimal feeding and pumping routine. If you're having any difficulties, it can be helpful to share this information with your healthcare professional.
- You can save time and prevent messy milk transfers or spills by pumping directly into Lansinoh® Breastmilk Storage Bags. Just ensure that your Lansinoh® Breastmilk Storage Bag has white and purple flowers and a white line above the logo. If your bag does not have this design, it is not compatible with pumping directly into the bag. NOTE: Pumping directly into bags requires two hands to safely remove milk storage bags. Visit www.lansinoh.cn to learn more.

2.7 Troubleshooting

Issue	Solution
The pump does not turn on	<p>If you experience an interruption in the normal operation of the electrical and/or mechanical functioning of the pump, simply do the following:</p> <ul style="list-style-type: none"> ● Check to confirm the AC adapter or power bank is securely connected to the pump. ● If you are using the AC adapter, unplug it from the electrical outlet, wait a few seconds, and then plug it back into the electrical outlet. ● If you are using a power bank, unplug it from the pump, wait a few seconds, and then plug it back in. <p>If you encounter further problems, please visit www.lansinoh.cn, call +86 400 821 0385, or contact your country distributor for guidance.</p>
I experience pain when I express	<p>If you feel any discomfort, you may need a different size breast flange. Visit www.lansinoh.cn, or call +86 400 821 0385, or contact your country distributor.</p>
I do not feel any suction or the suction is very low	<p>If it feels like the suction has decreased, try the following:</p> <ul style="list-style-type: none"> ● While pump is on, remove the tubing from the diaphragm cap and place a finger over the tubing connector. If you feel suction, the pump is operating properly, but the Breastmilk Expression Set may not be correctly assembled or the white valve may be damaged. If you don't feel any suction, try unplugging the pump, wait a few seconds, and plug it back into the electrical outlet. ● Make sure the Breastmilk Expression Set has been properly assembled. Check the assembly information in Section 2.3, page 4. ● Confirm that all connections (especially the tubing) are secure. Make sure the breast flange forms a complete seal around the breast. ● Inspect the white valve for a tear or pinhole. This component is critical to achieving proper suction. Replace the white valve with one of the spare valves provided with the product.

3. BREASTMILK STORAGE GUIDELINES

Breastmilk Storage and Thawing Guidelines for Healthy Term Babies

Check with your healthcare professional or an International Board Certified Lactation Consultant for specific storage instructions. When freezing breastmilk, store in the back of the freezer. Do not store breastmilk in the freezer door as the temperature can fluctuate when the door is opened and closed.

Before storing, date all breastmilk and use the oldest breastmilk first.

Milk Storage Guidelines, Full term infant			
WHERE	TEMPERATURE	TIME	ACTION
At Room Temperature	60-80°F (16-26°C)	4 hours (ideal) up to 6 hours (acceptable)	Contents should be covered and kept as cool as possible; covering the container with a damp towel may keep milk cooler
Insulated Cooler Bag	39-59°F (4 - 15°C)	24 hours	Keep ice packs in constant contact with milk containers; limit opening cooler bag
In a Refrigerator	<39°F (<4°C)	4 days (ideal) up to 5 days (acceptable)	Store milk in the back of the main body of the refrigerator
Freezer	0°F (-18°C)	3 months (ideal) up to 6 months (acceptable)	Store milk away from sides and toward the back of the freezer where temperature is most constant
Deep Freezer	-4°F (-20°C)	6 months (ideal) up to 12 months (acceptable)	

Source: La Leche League International 2017

These breastmilk storage guidelines are a recommendation. Contact your health professional or consult your country's national guidelines for further information.

Thawing Breastmilk

Thaw frozen milk in the refrigerator or place the containers under cool running water, gradually warming the water until the milk is thawed. Thawed milk can be kept in a refrigerator for up to 24 hours.

DO NOT refreeze milk once it is thawed.

Gently swirl thawed milk before feeding to mix the layers that have separated. Breastmilk is not homogenized and the "cream" will rise to the top. Breastmilk can vary in colour and consistency depending upon the time of the day that the milk was expressed, what you have eaten, and the age of the baby at the time of pumping. For further advice, please contact your health care professional.

DO NOT microwave breastmilk!

Microwaving alters the composition of the milk. Microwaving also may create "hot spots" in the milk that could burn the infant.

DO NOT thaw breastmilk in hot or boiling water.

4. TECHNICAL DATA

Power Supply

AC Adapter operation: 100V/240V wall plug type AC adapter, galvanically isolated with 5V DC output voltage.

Pump power dissipation: 10 watts maximum

Voltage regulation: Linear voltage regulator with low dropout voltage and short circuit protection.

Power bank operation: CE marked and 5V/2A power bank can be used.

Control System

The expected service life of the pump is 500 hours.



Control unit: Microcontroller with integral program memory











Program memory: 8K flash ROM, 1K RAM memory
There are 2 phases: Let Down and Expression selectable from keypad.

Adjustable suction level: 5 suction levels are selectable and controlled from keypad.

Suction vacuum level(Expression): Minimum 120 mmHg, maximum 270 mmHg

Regulatory Compliance

SYMBOLS	MEANING OF THE SYMBOLS
	Follow instructions for use
	Identifies the manufacturer
	Indicates the date of manufacture

SYMBOLS	MEANING OF THE SYMBOLS
	Type BF applied part
	Class II equipment
	Keep the device dry
	Keep the device away from sunlight
	Indicates the temperature limitation for operation, transport and storage
	Indicates the humidity limitation for operation, transport and storage
	Indicates the atmospheric pressure limitation for operation, transport and storage
IP22	Indicates the protection against ingress of solid foreign objects and against harmful effects due to the ingress of water
	This pump is made of various metal and plastics. Before disposal, the device is to be rendered unusable and it must be disposed of as sorted waste in accordance with local waste electrical and electronic equipment regulations. To avoid the harmful effects on the environment and public health align with your defined local return and collection rules for waste electrical and electronic equipment (incl. batteries).
	Indicates that the packaging contains products intended to come in contact with food
	Indicates to handle the fragile device with care

 **Warning: Children have STRANGLED in cords.**
Keep the cords out of the reach of children.

LANSINOH MAKES NO EXPRESS WARRANTY OF ANY KIND REGARDING THE PRODUCT OTHER THAN THOSE WARRANTIES EXPLICITLY SET FORTH HEREIN. ANY IMPLIED WARRANTY, INCLUDING ANY IMPLIED WARRANTY OF MERCHANTABILITY OR ANY IMPLIED WARRANTY OF FITNESS FOR A PARTICULAR PURPOSE, TO THE EXTENT PERMITTED BY LAW, SHALL BE LIMITED IN DURATION TO A PERIOD OF 90 DAYS FROM THE DATE OF PURCHASE BY THE ORIGINAL PURCHASER.

In the event the product is found by Lansinoh® to not meet the above limited warranty, as purchaser's sole and exclusive remedy Lansinoh® will repair or, at the option of Lansinoh®, replace this product without charge for such replacement or parts of labour.

NOTE: The purchaser shall bear all expense for returning this product to Lansinoh®. This warranty does not apply to any product that has been subjected to misuse, abuse, or alteration. Only Lansinoh® replacement parts and accessories are recommended for use with Lansinoh® breastfeeding products. Improper or incorrectly performed maintenance or repair or use of non-Lansinoh® replacement parts or accessories may invalidate this warranty.

TO THE EXTENT PERMITTED BY LAW, LANSINOH SHALL NOT BE LIABLE FOR ANY INCIDENTAL OR CONSEQUENTIAL DAMAGES INCLUDING, BUT NOT LIMITED TO, REPLACEMENT COSTS RESULTING FROM THE BREACH OF ANY WRITTEN OR IMPLIED WARRANTY.

If you wish to make a claim under this warranty, please telephone +86 400 821 0385, email customerservice@lansinoh.cn, or contact your country distributor. You will be given a Freepost address to return the product, if necessary, together with your original dated bill of sale or other dated proof of purchase and a brief statement of the problem.

Declaration for Electromagnetic Compatibility (EMC)

For information use only

FCC Statement

This device complies with part 15 of the FCC rules. Operation is subject to the following two conditions: (1) This device may not cause harmful interference, and (2) this device must accept any interference received, including interference that may cause undesired operation.

Recommended separation distance between Portable and mobile RF communications equipment and the model @ 3Vrms

The Lansinoh® Compact Single Electric Breast Pump is intended for use in an electromagnetic environment in which radiated RF disturbances are controlled. The customer or the user of the Lansinoh® Compact Single Electric Breast Pump can help prevent electromagnetic interference by maintaining a minimum distance between portable and mobile RF communications equipment (transmitters) and the Lansinoh® Compact Single Electric Breast Pump as recommended below, according to the maximum output power of communications equipment.

5. CUSTOMER CARE

Lansinoh is here to support you in your breastfeeding journey, so if you have any questions, please call our Customer Service Department at **+86 400 821 0385**, email customerservice@lansinoh.cn, visit our website www.lansinoh.cn, or contact your country distributor.

6. WARRANTY

Limited Consumer Product Warranty

This product is warranted to the original consumer purchased (the "purchaser") to be free from defects in material and workmanship which are not commercially acceptable for the period of one year from the date of purchase on the pump mechanism and the period of 90 days on all other product components. Warranty coverage terminates if you sell or otherwise transfer this product to another person. This warranty gives you specific legal rights and you may also have other rights, which vary by location.

Separation distance according to frequency of transmitter m
 Rated Maximum output power of transmitter W

Wireless Statement

Wireless communications equipment such as wireless home network devices, mobile phones, cordless telephones and their base stations, walkie-talkies can affect this equipment and should be kept at least a distance of 3.5m away from the equipment.

Stacking

This device should not be used adjacent to or stacked with other equipment. And if adjacent or stacked use is necessary, this device should be observed to verify normal operation in the configuration in which it will be used.

This product is a personal care product and therefore cannot be returned once opened. If you experience any problems with this product, please telephone our free customer service line at +86 400 821 0385 in China or contact your country distributor, or contact your country distributor. Our representative will be happy to assist you.

Serious events experienced from using this product should be reported immediately to Lansinoh Laboratories and to the local competent Authority.

**Manufacturer: LANSINOH LABORATORIES SAG.
 GERIC. TAS. SAN. TIC. LTD. STI.**

**Zafer SB Mah. Gunduz Sk. No:13 E.S.B. 35410
 Gaziemir – İzmir - Turkey**

**Lansinoh Laboratories UK Ltd | lansinoh.co.uk
 Ground Floor, West Mayesbrook House,
 Lawnswood Business Park,
 Leeds, LS16 6QY,
 UK**

Lansinoh® is a registered trademark of Lansinoh Laboratories, Inc. ©2021 Lansinoh Laboratories, Inc. All rights reserved.

Date IFU issued: 13 July 2021

Version: Second Version

Recommended separation distance between Portable and mobile RF communications equipment and the model @ 3Vrms			
The Lansinoh® Compact Single Electric Breast Pump is intended for use in an electromagnetic environment in which radiated RF disturbances are controlled. The customer or the user of the Lansinoh® Compact Single Electric Breast Pump can help prevent electromagnetic interference by maintaining a minimum distance between portable and mobile RF communications equipment (transmitters) and the Lansinoh® Compact Single Electric Breast Pump as recommended below, according to the maximum output power of communications equipment.			
Separation distance according to frequency of transmitter m			
Rated Maximum output power of transmitter W	150 khz to 80 Mhz	80 Mhz to 800 Mhz	800 Mhz 2,5 Ghz
0,01	0,12	0,12	0,23
0,1	0,37	0,37	0,74
1	1,17	1,17	2,33
10	3,69	3,69	7,36
100	11,67	11,67	23,33

吸奶器的使用注意事项

兰思诺便携式单边电动吸奶器属于个人护理产品，为保证卫生，请勿与他人共用或转售。否则将使保修失效。

若您感染了乙型肝炎、丙型肝炎或人体免疫缺陷病毒（HIV），使用兰思诺便携式单边电动吸奶器吸出母乳并不能降低或消除通过母乳将病毒传播给宝宝的风险。

使用本产品时，尤其是有儿童在场时，必须始终遵循基本的安全预防措施，包括

使用前请阅读所有说明

危险：为降低触电风险

- 请务必在使用完后立即拔掉吸奶器插头。
- 切勿在洗浴时使用本品。
- 切勿将本品放置或存储在可能落入或被拽入到水盆或水槽中的地方。
- 切勿将吸奶器放置到或使其落入水中或其他液体中。
- 切勿触碰掉落到水中的电气产品。立即拔掉插头。
- 如果本产品电线或插头受损、无法正常工作、被摔过或受过损伤，或曾经落入水中，切勿再使用。

使用目的

兰思诺便携式单边电动吸奶器用以吸取和收集哺乳妈妈的母乳，妈妈可以用收集到的母乳来喂养给宝宝。建议兰思诺便携式单边电动吸奶器专人专用。

适用范围

兰思诺便携式单边电动吸奶器适用于消除因排乳不足引起的乳内淤积、肿胀等情况，帮助通过吸力吸引扁平凹陷的乳头。此外，便携式单边电动吸奶器使母亲能够为那些由于各种原因不能直接亲喂的宝宝提供母乳，如含接问题、早产或身体不适的宝宝。
无已知禁用情况。

警告：为降低灼伤、火灾或人身伤害风险

- 在本产品已连接电源插座的情况下，切勿使其处于无人看护的状态。
- 如果使用本产品时有儿童在附近，务必密切留意。
- 本产品只可用于本手册所述预期用途。禁止使用非制造商推荐的配件。
- 将电线远离受热表面。
- 切勿在睡觉或瞌睡时使用。
- 切勿使任何物体落入或插入到任何开口或管子中。
- 如果本产品已破损或有任何零部件缺失，切勿使用。
- 切勿让儿童或宠物摆弄吸奶器以及电源适配器等附件。
- 电源适配器只可在室内使用，禁止在使用气溶胶产品或氧含量受到管控的地方使用本产品。

包装材料不属于该产品的一部分。为保证儿童安全，请在使用前取出并丢弃所有包装材料，但应阅读说明书并将其保留好，以备日后参考。

请保存好说明书以及收据，以备日后参考。

使用说明书

目录

1. 快速入门指南	12
2. 吸奶器	12
2.1. 吸奶器零配件	12
2.2. 清洁说明	13
2.3. 吸奶器的组装	14
2.4. 吸奶器的使用	14
2.5. 乳杯尺寸	15
2.6. 吸奶操作提示	15
2.7. 故障排除	16
3. 母乳保存指南	16
4. 技术数据	17
4.1. 电源	17
4.2. 控制系统	17
4.3. 合规性	17
5. 客户关怀	17
6. 质保	17
7. 产品部件表	18

请勿将本产品退货至零售商。

兰思诺的客服团队将为您提供相关帮助。若您遇到任何产品问题，请联系我们的客服部（电话：**4008-210-385**；电子邮箱：customerservice@lansinoh.cn），或登陆我们的网站（www.lansinoh.cn），或联系当地经销商。

出于健康和卫生防护方面的原因，包装开启后将不能再作退货或更换。如果您的产品存在问题，请联系我们的客服部。

1. 快速入门指南

切勿清洗导管。

首次使用前，按照13页上2.2节中的指导说明清洁所有将与母乳发生接触的部件（导管和导管接口除外）。

组装吸乳部件

参见14页的详细说明。正确的组装对于确保产品发挥正常功能和吸乳作用必不可少。



将紫色隔膜放在吸奶器本体顶部，注意要同吸奶器本体顶部的开口对齐



安接隔膜盖并旋拧，以便使导管接口位于背部



将comFORTFIT舒适贴合乳杯转入吸奶器本体



插入吸奶阀



将奶瓶放入吸奶器本体



安接导管



紧固好接口





安接到电动吸奶器上

兰思诺便携式单边电动吸奶器只可与兰思诺的吸乳部件配套使用。

启动

将吸乳部件紧贴到乳房上，注意乳头对准乳杯的中心位置。确保乳房完全贴在ComFORTFIT舒适贴合乳杯中，从而形成真空，不会跑气。确保吸乳部件和乳杯通道稍微向下倾斜，使乳汁能够自然流到瓶中。

吸乳准备阶段和吸乳阶段

- 按下电源按钮 ，吸奶器将会启动并进入吸乳准备阶段，吸乳准备阶段将会自动运行2分钟。
- 要想更快地进入吸乳阶段，按下“吸乳准备/吸乳”切换按钮  以切换到吸乳阶段。任何时候再次按下“吸乳准备/吸乳”切换按钮 ，可返回到吸乳准备阶段。
- 吸乳准备阶段采用的是一种较快速的吸乳方式。
- 吸乳阶段是更为缓慢、深入的吸吮，它具有5个不同吸力强度可供调节，以保证提供您所需要的舒适度。
- 在紫色按键面板的下面设计有LED灯，用于显示目前所采用的设置。吸乳准备阶段LED灯为闪烁的状态，吸乳阶段LED灯为常亮的状态。

2. 吸奶器

2.1 吸奶器零配件

吸奶器电动本体

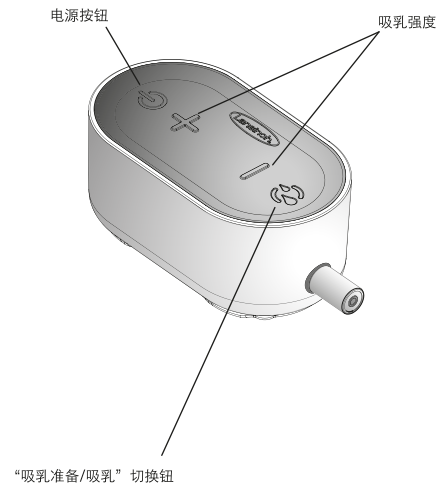

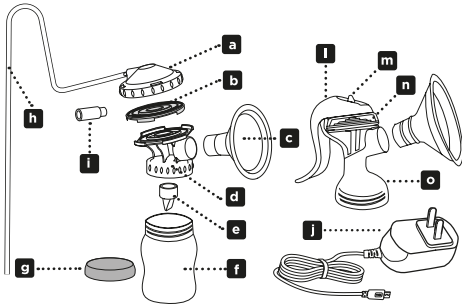

吸奶器吸乳部件

a	隔膜盖
b	隔膜
c	ComfortFit舒适贴合乳杯 (25mm)
d	电动吸奶器本体
e	吸奶阀
f	自然波浪奶瓶 (160ml)
g	瓶盖
吸奶器电动本体相关部件	
h	800mm硅胶导管
i	导管接口
j	电源适配器
手动吸奶器部件	
l	手动吸奶器把手
m	手动吸奶器活塞
n	手动吸奶器隔膜
o	手动吸奶器本体

2.2. 清洁说明

***除非您的保健服务人士有其他建议, 否应遵守本说明。**

****切勿清洗导管或接口。**

首次使用吸乳部件前

1. 每次操作吸乳部件前, 都要使用肥皂水仔细洗手并晾干。
2. 拆解吸乳部件, 然后将各部件放在一个大锅内。
3. 向锅内加入足够多的水, 让所有部件都能获得自由浮动的空间。
4. 水烧开后, 将这些部件煮5分钟。
5. 然后, 使用夹钳将部件从锅内取出, 整齐置于洁净的纸巾或干燥架上, 让其风干。
6. 在组装和使用前, 要让各部件完全晾干。如果只是部分晾干, 可能会影响吸奶器的工作。

7. 部件晾干后, 可将其存放到一个干净的带盖塑料盆或拉链式塑料袋中。

每次使用吸乳部件前

1. 每次操作吸乳部件前, 都要使用肥皂和水仔细洗手并晾干。
2. 组装吸乳部件前, 确保所有部件均完全晾干。
3. 目视检查各部件有无开裂、碎屑、撕损、褪色或老化。这些问题可能会影响吸奶器的正常功能。
4. 如果您对部件存在任何疑问或问题, 欢迎联系兰思诺, 电话: 4008-210-385, 微信: Lansinoh520, 或登陆我们的网站 (www.lansinoh.cn)。

每次吸乳后清洗吸乳部件

1. 拆解吸乳部件, 将导管和接口放在一旁。
2. 使用后立即用冷水冲洗所有部件。将各个吸乳部件放置在一个干净的清洗盆中, 且这个盆只能用于清洗宝宝的喂养产品。切勿将吸奶器部件直接放到水槽中, 因为水槽中的细菌或下水管可能会污染吸奶器。
3. 使用温肥皂水手动清洗组件中的所有部件。对于组件中较硬的塑料件, 可使用奶嘴刷来擦洗, 但不可将其用于吸奶阀或隔膜。
4. 用洁净、流动的温水冲洗部件或者将其浸入到盛有清水的盆中 (该盆专门用来清洗宝宝的喂养产品)。
5. 将部件放入锅内并用足够多的水浸没, 让所有部件都能获得自由浮动的空间。
6. 将水烧开, 煮5分钟。
7. 然后, 使用夹钳将部件从锅内取出, 整齐置于洁净的纸巾或干燥架上, 让其风干。禁止使用擦盘纸巾擦拭或拍打各部件, 否则可能会使部件沾染细菌。
8. 在组装和使用前, 要让各部件完全晾干。如果只是部分晾干, 可能会影响吸奶器的工作。
9. 部件晾干后, 可将其存放到一个干净的带盖塑料盆或拉链式塑料袋中。
10. 每次使用后, 清洗盆和奶瓶以及/或奶嘴刷。
11. 对于电动本体, 应在使用后干净的纸巾或软布擦拭。切勿将电动本体放到水中或其他液体中进行清洗。

注意: 清洗吸奶阀时应小心谨慎。吸奶阀对于吸奶器的使用十分重要。清洗吸奶阀时不要过于用力。不要使用奶瓶刷或者奶嘴刷去清洗。在温热的清洗液中用手清洗。并用流动的温水冲洗干净。

注意: 不建议使用除了以上消毒方式之外的其他消毒方式。

注意: 使用电子蒸汽消毒器时, 请遵照其说明书要求进行。确保部件开口都向下。消毒完毕后, 请先洗净双手再取出产品。

2.3 吸奶器的组装

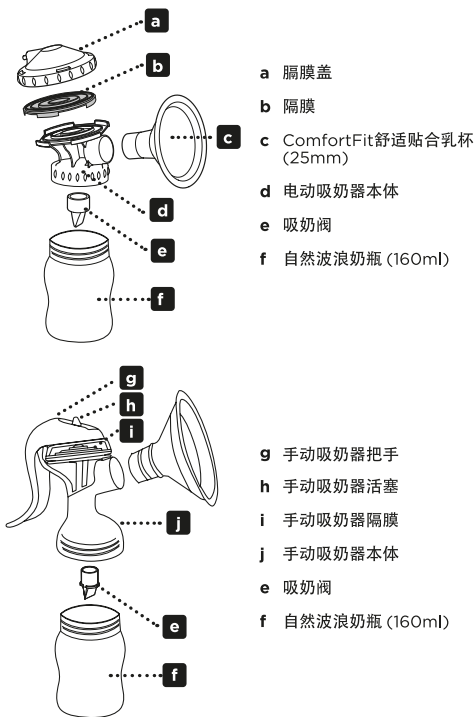

2.4 吸奶器的使用

兰思诺便携式单边电动吸奶器使用简便，有多种设置可供选择，使用户获得较多的产乳量和更好的舒适度。吸乳时，您可以根据自己的情况选用两种不同阶段，紫色按键面板的下面设有LED灯，用于显示目前所采用的设置。

吸乳准备阶段和吸乳阶段



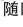

在对宝宝进行母乳喂养时，他们一开始会快速吮吸来刺激乳汁分泌。宝宝吮吸到乳汁后，他们会立即转变为更加缓慢、深入的吮吸。为了模拟这种自然的节律，兰思诺便携式单边电动吸奶器提供了两种阶段：吸乳准备阶段和吸乳阶段。

- 吸乳准备阶段采用的是一种较快速的吸乳方式。
- 吸乳阶段是更为缓慢、深入的吮吸，它具有5个不同吸吮度可供调节，使用户获得较多的产乳量和更好的舒适度。

通过“吸乳准备/吸乳”切换按钮，可以在两个阶段之间轻松进行转换。如果按键面板上是慢慢闪烁的LED灯，说明处于吸乳准备阶段。如果是常亮LED灯，则为吸乳阶段。

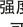
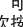
当吸奶器启动时，会先从吸乳准备阶段开始，2分钟后自动切换到吸乳阶段。如您想要跳过第一阶段，可随时按下按钮，切换到吸乳阶段。您还可在需要时再次按下按钮，随时回到吸乳准备阶段。

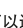
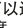
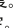
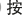
吸奶器的运行

1. 确保吸奶器正确清洁。彻底清洁手部并确保乳房的清洁。
2. 确保吸奶器和吸乳部件正确组装，硅胶管通过导管接口牢固安接到吸奶器上，并且安接到隔膜盖上。
3. 将吸乳部件件贴到您的乳房上，乳头对准乳杯的中心位置。
4. 确保乳房完全贴在ComfortFit舒适贴合乳杯中，确保形成真空，不会跑气。
5. 吸乳部件和乳杯通道必须稍微向下倾斜，让乳汁自然流向奶瓶。
6. 持续按住On/Off按钮几秒钟，可启动吸奶器。
7. 每次启动后，吸奶器都会先从吸乳准备阶段3级开始，可通过按钮增大吸力强度，或通过按钮减少吸力强度，2分钟后自动切换到吸乳阶段。如您想要跳过第一阶段，可随时按下按钮，切换到吸乳阶段。您还可在需要时再次按下按钮，随时回到吸乳准备阶段。
8. 吸乳阶段具有5种不同的吸力强度可供选择。您可以通过按钮增大吸力强度，或通过按钮减小吸力强度。最多会有5种不同的LED灯亮起，具体视所选吸力强度而定。
 - 注：如果吸乳强度令您感到不适，可随时通过按钮来减小强度。
9. 当整个吸乳活动结束后，可通过On/Off按钮关闭吸奶器。确保乳头上没有吸力之后方可将ComfortFit舒适贴合乳杯从乳房上取下。必要时，可将手指插到乳杯与乳房之间，以卸去吸力。吸力被卸除后，即可安全取下ComfortFit舒适贴合乳杯。
10. 小心地将奶瓶从吸奶器本体上拆下，并使用随附的瓶盖盖好奶瓶。请遵守第3章介绍的母乳保存指导。
 - 注：如果吸奶器装置保持开启状态且无人看护超过60分钟，将会自动关停。

电源选项

吸奶器可采用以下供电模式来运行：

● 电源适配器

将电源适配器接到吸奶器On/Off按钮侧的电源插口上。将电源适配器另一头接到电源插座中。只有采用原带的电源适配器(参见“技术数据”一章)，才能保证吸奶器的电气安全。

● 移动电源(不含)

将移动电源的USB线连接至吸奶器On/Off按钮侧的电源插口上。只有采用移动电源指定的供电规格，才能保证吸奶器的电气安全。(参见“技术数据”一章)

我们推荐使用产品随附的交流电源适配器来运行吸奶器。

兰思诺便携式单边电动吸奶器可以轻松切换成手动吸奶器。

注：在组装兰思诺手动吸奶器之前，应确保对所有部件完成清洁。

1. 认真洗手。

2. 将活塞插入手动吸奶器隔膜。

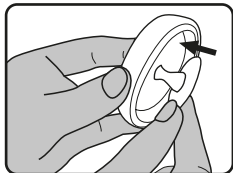

3. 隔膜和活塞置于手动吸奶器的吸奶器本体顶部。用手指按压以确保完全密封，使其牢固固定在垫环周围。（这些部件设计为紧密适配。）

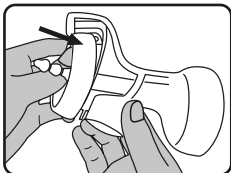

4. 从下面将吸奶筒轻轻固定到吸奶器本体上，确保吸奶筒与吸奶器本体保持齐平。安装吸奶筒时，切勿用力过大。

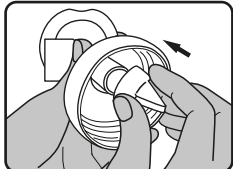

5. 把手上的沟槽同吸奶器本体对齐，并轻轻下压把手，直至听到“咔嚓”声。

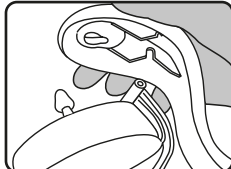

6. 调整活塞和把手，使杆子与把手的第一个槽口相适配，也就是设为“吸乳准备阶段”。



7. 将ComfortFit舒适贴合乳杯安接到手动吸奶器本体。

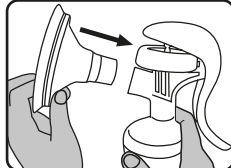

- 若要切换到吸乳阶段，轻轻按压手柄尖端的“PUSH”部分，将把手设到活塞的第二个（底部）凹槽上。继续挤压并释放把手，以找到适当的抽吸压力。
- 若要从吸乳阶段返回到吸乳准备阶段，(1) 朝自己方向拉动活塞尖端，(2) 轻轻挤压把手将其设在第一个（顶部）凹槽中。

2.5 乳杯尺寸

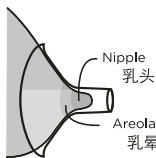

如果您仅针对乳头进行抽吸，应当只有较小部分的乳晕被吸入到乳杯通道中。如果被吸到通道内的乳晕部分较大，则表明乳杯过大。您需要一个更小尺寸的。

吸奶时，乳头应当能够自由进出通道。乳头若与通道侧壁有接触或摩擦，则说明乳杯过小。您需要一个更大尺寸的。

本吸奶器所带的乳杯尺寸为25mm。另外您还可以选择

21mm, 28mm, 30.5mm以及36mm

的ComfortFit舒适贴合乳杯。欲获取相关指导，欢迎登陆

www.lansinoh.cn或致电4008-210-385或联系当地经销商。

2.6 吸奶操作提示

母乳属于按需/需而产生。定期分泌乳汁可以刺激您的身体，帮助维持母乳供应。如果您在母乳喂养或吸奶器方面存在疑问，可向国际认证专业哺乳顾问（IBCLC）、母乳喂养顾问，或其他医疗保健人员（如助产士或上门护理人员）咨询。

吸乳操作方面的重要提示

- 在开展吸乳操作前，需要确保自己处于舒适状态，并且与吸奶器保持近距离。
- 保持直立坐姿，确保肩部与胳膊得到良好支撑。
- 成功吸乳最重要的是要能触发奶阵反射。之后乳汁才能自由流出。在吸乳之前和吸乳中用热湿毛巾热敷乳房，并以画圈的方式轻柔按摩，有助于刺激自然反射。加热后的兰思诺Thera® Pearl 3合1冷热热敷垫产品包可以很好地达到此目的。
- 与宝宝分离时，看着宝宝的照片/视频或是闻到带宝宝气味的东西，都有助于刺激奶阵。
- 如果宝宝同您在一起，那么皮肤的接触以及气味将帮助刺激奶阵。您可以在用一侧乳房给宝宝哺乳的同时，对另一侧乳房进行吸乳。这样可以利用宝宝的吮吸来刺激奶阵，从而提高吸乳效率。
- 为您提供充分的吸乳时间。压力可能会给乳汁分泌带来不利影响。
- 注意补充水分；每次吸乳前及吸乳过程中饮用一杯水对乳汁分泌会起到重要作用。
- 很多妈妈发现她们在早上起床后产乳量较高，因此在早上吸乳可能会获得更好的效果。
- 有些妈妈在吸奶时会有多次奶阵。如果通过“吸乳准备/吸乳”切换按钮返回到吸乳准备阶段，您可以再次获得成功的刺激。
- 对哺乳和吸乳的日期、时间及时长，以及每个乳房的产乳量进行跟踪。保存好这些记录有助于找出趋势或特性，以建立最佳哺乳和吸乳时间计划。如果您有任何疑问，可以向医疗保健专业人士反映该情况。
- 您可以将乳汁直接吸入兰思诺储奶袋中，既节省时间，又能防止乳汁发生不必要的转移或溅洒。只需要注意可以直接吸入袋中的兰思诺储奶袋上印有白/紫色花，并且logo上有一条白线。如果您的储奶袋上没有此设计，则不适于直接取入袋中。注：要想直接吸入袋中，需要双手操作才能安全地取下储奶袋。更多信息，敬请访问兰思诺官网 www.lansinoh.cn 或微信：**Lansinoh520**

2.7. 故障排除

问题	解决方案
吸奶器无法启动	<p>如果吸奶器的电气和/或机械功能在正常运行中突然中止，只需作如下操作：</p> <ul style="list-style-type: none"> - 检查并确认电源适配器或移动电源与吸奶器牢牢连接。 - 如果使用的是电源适配器，将插头从电源插座上拔下，等待几秒钟，然后再重新插入。 - 如果使用移动电源，将其从吸奶器上拔下，等待几秒钟，然后再重新插入。 <p>如果仍有问题，请登陆www.lansinoh.cn微信：Lansinoh520 或致电 4008-210-385 或联系当地经销商，获取相关指导。</p>
分泌乳汁时感到疼痛	<p>如果您有任何不适，可能需要更换一个不同尺寸的乳杯。请登陆www.lansinoh.cn微信：Lansinoh520 或致电 4008-210-385 或联系当地经销商。</p>
感觉不到任何吸力或吸力很小	<p>如果觉得吸力变小，可尝试如下操作：</p> <ul style="list-style-type: none"> ● 吸奶器运行时将导管从隔膜盖上拆下并将手指放在导管接口上。如果能感觉到吸力，则说明吸奶器正常工作，但吸乳部件可能没有正确组装或吸奶阀受损。如果感觉不到任何吸力，尝试拔下吸奶器的电源插头，等待几秒钟，然后重新插到电源插座中。 ● 确保吸乳部件正确组装。查看 14 页上第 2.3 节中的组装说明。 ● 确认所有连接（尤其是导管）全都牢牢。确保整个乳杯在乳房上形成可靠密封。检查吸奶阀有无撕损或针孔。该部件对于获得正常吸力来说至关重要。更换吸奶阀（产品随附有备用吸奶阀）。

3. 母乳保存指南

健康足月宝宝的母乳保存和解冻基本指导

同您的医疗保健专业人士或国际认证专业哺乳顾问请教具体的保存方法。冷藏母乳时，应将其存放于冰箱的后部。不要将母乳存放于冰箱门上，因为该处温度可能会随着门的开合而发生波动。

存放前应记下所有母乳的日期，使用时应先挑选日期最早的母乳。

母乳保存基本指导（足月宝宝）			
保存环境	温度	时间	备注
室温	16-26°C (60-80°F)	4 小时（最佳）-6 小时（可接受）	将母乳装入容器并盖好，并尽可能低温保存；使用湿巾盖住容器可能会使母乳温度更低一些
冰包	4-15°C (39-59°F)	24 小时	让冰袋一直同母乳容器保持接触；限制冰包的打开
冰箱冷藏室	<4°C (<39°F)	4 天（最佳）-5 天（可接受）	将母乳存放在冰箱主体的后部
冰箱冷冻室	-18°C (0°F)	3 个月（最佳）-6 个月（可接受）	母乳应远离冰箱两侧并靠向后部——该处温度最稳定。
专用冰柜	-20°C (-4°F)	6 个月（最佳）-12 个月（可接受）	

信息来源：2017 国际母乳会

这些母乳保存指导为我们的建议。更多信息请咨询保健专业人士或查询所在国家的指导规范。

母乳解冻

对冰箱内的母乳解冻或将容器置于流动的凉水下，逐渐使水变暖，以解冻母乳。解冻后的母乳可在冰箱内存放，但存放时间不能超过 24 小时。

请勿重新冷冻已解冻的母乳。

用解冻后的母乳哺喂宝宝前，请轻轻摇晃奶瓶，以混合分层的母乳。如果母乳不均匀，会有“乳脂”浮到表面上。母乳的颜色和浓度因吸乳时间、您的饮食、以及吸乳时宝宝的月龄而存在个体差异。更多建议请咨询医疗保健专业人士。

切勿使用微波炉加热母乳！

微波会破坏母乳成分。微波还会导致母乳局部过热，可能烫伤宝宝。

请勿在热水或沸水中解冻母乳。

4. 技术数据

电源

本产品预计使用寿命约为500小时。

使用电源适配器：100V/240V 壁式插座型交流电源适配器，经过电镀绝缘，输出电压为 5V DC。

吸奶器功耗：最高 10W

电压调节：线性稳压器，回电电压低，带短路保护。

移动电源：带 CE 标志，可使用 5V/2A。

吸奶器功耗：最高 10W

控制系统

控制单元：微控制器，带一体式程序内存

程序内存：8K 闪存 (ROM), 1K 内存 (RAM)

2 个不同阶段：吸乳准备和吸乳 (可从按键面板上选择)。

吸力强度：5 种强度可选。

吸力水平 (吸乳阶段)：最小120mmHg，最大270mmHg。

合规性



参考说明书



生产高信息



生产日期



BF型应用



I类器具



保持干燥



防止日晒



运输/存储



运行



运输/存储



运行

IP22



按当地电器类
垃圾分类处理



小心轻放



警告：儿童可能会被线缆勒伤
请将线缆置于儿童伸手范围之外。

若兰思诺证实产品不满足以上有限保修条款，购买者可获得的唯一补偿是由兰思诺维修或更换产品 (由兰思诺决定)，且不向购买者收取任何有关更换部件或人工费用。

注意：将产品返回兰思诺的费用应由购买者全权承担。此保修条款不适用于任何被误用、滥用或变更的产品。兰思诺母乳泵产品仅推荐使用兰思诺品牌的备用部件。维护不当或不正确，或者维修或使用非兰思诺品牌的备用部件可能导致本保修失效。

在法律规定范围内，对于附带补偿损失或间接损失，包括但不限于违反任何书面或暗示质保条款所引起的更换成本，兰思诺不承担任何责任。

若您希望依据本保修条款提出索赔，请致电 4008-210-385 (中国) 或发送电子邮件 customerservice@lansinoh.cn，或联系当地经销商。为方便您寄回本产品，我们将为您提供一个免费邮递地址。必要时请将带有日期的原始购买凭证或其他带有日期的购买证明一并寄回，并简短描述具体问题。

电磁兼容性 (EMC) 声明

仅作为信息参考。

FCC 声明

本设备符合 FCC 规则第 15 款。操作要满足以下两个条件：(1) 本装置不可造成有害干扰；且 (2) 本装置必须可接受任何收到的干扰，包括可能导致意外操作的干扰。

无线声明

无线家庭网络设备、移动电话、无绳电话及其基站、步话机等无线通信设备可能会影响本设备，因此应同本设备保持至少 3.5 米的距离。

堆叠

本设备使用时不得靠近其他设备或与其他设备堆放在一起。如果需要靠近或堆叠使用，应观察本设备，确定其在使用时可按配置正常工作。

本产品为个人护理用品，包装开启后不可退货。若您有任何问题，可拨打我们的免费客服热线 4008-210-385 (中国) 或联系当地经销商。我们的客服代表将热忱为您服务。

5. 客户关怀

在您的母乳喂养过程中，兰思诺将伴您左右。若您有任何问题，请联系我们的客服部 (电话：4008-210-385；电子邮箱：customerservice@lansinoh.cn)，或登陆我们的网站 (www.lansinoh.cn)，关注我们的微信号：**Lansinoh520** 或联系当地经销商。

6. 质保

消费类产品有限质保

我们对原始购买者 (“购买者”) 承诺，本产品没有任何材料和工艺缺陷，吸奶器主体保修一年 (自购买之日起)，其他所有部件保修 90 天 (自购买之日起)。转售本产品或将本产品转与他人将致使保修无效。本保修条款将赋予您一些特定的法律权限，具体因地而异。

除此外明确说明的保修条款以外，兰思诺不会提供任何类型的明示保证。任何暗示保证，包括任何对适用性和特定用途适用性的暗示保证，其有效期为自原始购买者购买之日起 90 天内。

便携式及移动式射频通讯设备与产品

(在电压有效值为3的情况下) 之间的推荐间隔距离

兰思诺便携式单边电动吸奶器可用于射频辐射干扰可控的电磁环境下。为避免电磁干扰，兰思诺便携式单边电动吸奶器的客户或用户可根据通信设备的最高输出功率，使便携式可移动射频通信设备 (发射机) 与兰思诺便携式单边电动吸奶器之间至少保持下面建议的分隔距离。

建议分隔距离 (单位: 米)

发射器的额定最大输出功率, 单位W	150千赫至80兆赫	80兆赫至800兆赫	800兆赫至2.5千兆赫
0.01	0.12	0.12	0.23
0.1	0.37	0.37	0.74
1	1.17	1.17	2.33
10	3.69	3.69	7.36
100	11.67	11.67	23.33

7. 产品部件表

*本产品中与食品接触部件符合GB4806系列对应的食品安全国家标准。

下表内各部件数量均为1个。

部件	材质	消毒耐热温度	材质执行标准	消毒方法	
电动吸奶器本体	PP	120° C	GB4806.7	煮沸、蒸汽、微波炉	食品接触用 II
手动吸奶器本体	(CAS号: 9010-79-1)				
ComfortFit 舒适贴合乳杯	乳杯本体: PP (CAS号: 9010-79-1)	120° C	GB4806.7	煮沸、蒸汽、微波炉	食品接触用 III
	紫色贴合圈*: 热塑性弹性体	120° C	—		非食品接触用
隔膜盖	PP (CAS号: 9010-79-1)	120° C	GB4806.7		
瓶盖		110° C			
160ml奶瓶					
吸奶阀	硅橡胶	120° C	GB4806.11	煮沸、蒸汽、微波炉	食品接触用 II
隔膜					
手动吸奶器隔膜					
手动吸奶器活塞					
手动吸奶器把手	聚丙烯 (PP)	—	—	—	非食品接触用
导管接口	聚丙烯 (PP)				
导管	硅橡胶				
电动本体 (含电源适配器)	—	—	—	—	—

*紫色贴合圈在实际使用中不作为食品接触部件。

制造商: LANSINOH LABORATORIES SAG, GERIC,
TAS, SAN, TIC, LTD, STI
Zafer SB Mah, Gunduz Sk, No:13 E.S.B, 35410
Gaziemir-Izmir-Turkey

进口商: 尔儿诗(上海)商贸有限公司
地址: 中国(上海)自由贸易试验区富特北路456号南楼五层533室

说明书发布日期: 2021年6月

说明书版本: 第四版

Lansinoh®

Lansinoh Laboratories UK Ltd | lansinoh.co.uk

Ground Floor, West Mayesbrook House,
Lawnswood Business Park,
Leeds, LS16 6QY, UK

Lansinoh® is a registered trademark
of Lansinoh Laboratories, Inc.
©2021 Lansinoh Laboratories, Inc.
All Rights Reserved

SE540971F0721



Lansinoh Laboratories Saglik Gereçleri Tasarim San. Tic. Ltd. Sti.
Zafer SB Mah. Gunduz Sk. No:13 E.S.B Gaziemir/ Izmir/ Turkiye