



# Operator's Manual

## TORNADO

Rotary Cutter

**BRC-142, BRC-148, BRC-160, BRC-172**  
**BRC-242, BRC-248, BRC-260, BRC-272**

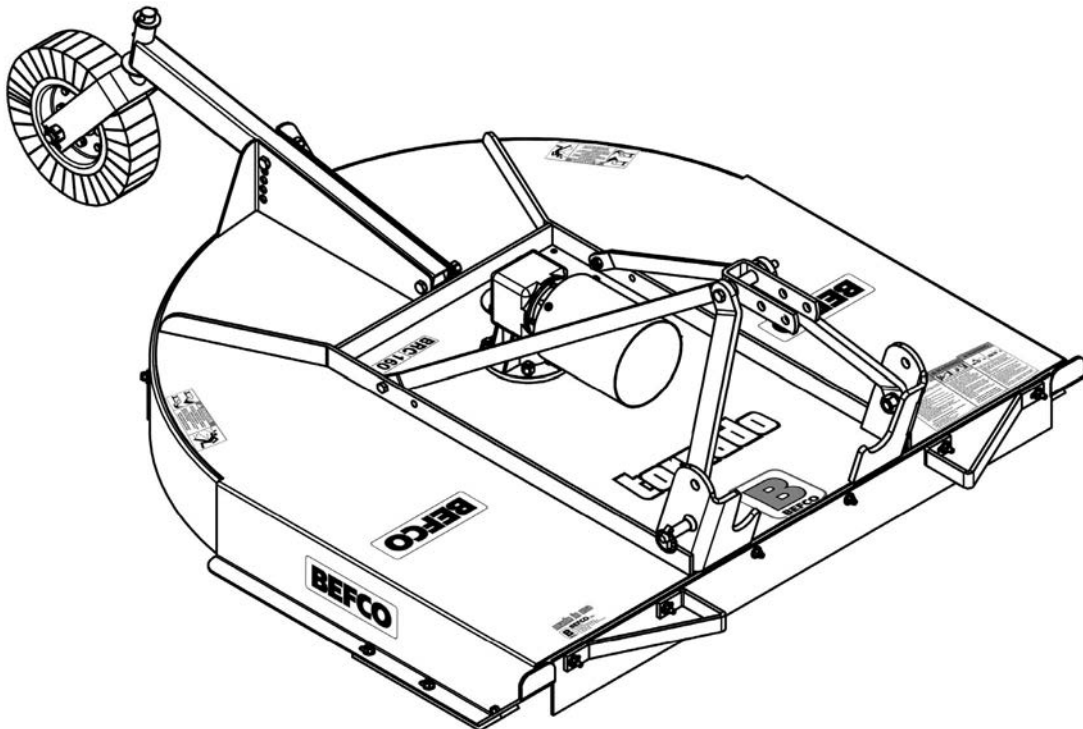

The operator's manual is a technical service guide and must always accompany the machine.

**Manual 971-404B**  
**September 2024**

# SAFETY

Take note! This safety alert symbol found throughout this manual is used to call your attention to instructions involving your personal safety and the safety of others. Failure to follow these instructions can result in injury or death.



*This symbol means:  
ATTENTION!  
BECOME ALERT!  
YOUR SAFETY IS INVOLVED!*

## Signal Words

Note the use of the signal words DANGER, WARNING and CAUTION with the safety messages. The appropriate signal words for each have been selected using the following guidelines:



**DANGER:** Indicates an imminently hazardous situation that, if not avoided, will result in death or serious injury.



**WARNING:** Indicates a potentially hazardous situation that, if not avoided, could result in death or serious injury, and includes hazards that are exposed when guards are removed. It may also be used to alert against unsafe practices.



**CAUTION:** Indicates a potentially hazardous situation that, if not avoided, may result in minor or moderate injury.

# INDEX

|  |    |
|--|----|
| <b>1 - GENERAL INFORMATION</b>                 | 4  |
| 1.01 - General                                 | 4  |
| 1.02 - Warranty Information                    | 4  |
| 1.03 - Model and Serial Number ID              | 5  |
| <b>2 - SAFETY PRECAUTIONS</b>                  | 6  |
| 2.01 - Preparation                             | 6  |
| 2.02 - Starting and Stopping                   | 7  |
| 2.03 - Messages and Signs                      | 7  |
| <b>3 - OPERATION</b>                           | 10 |
| 3.01 - Operational Safety                      | 10 |
| 3.02 - Setup                                   | 12 |
| 3.03 - Assembly Instructions                   | 12 |
| 3.04 - Skid Shoes (Option)                     | 16 |
| 3.05 - Cutting Height Adjustment               | 17 |
| 3.06 - Pre-Operational Check                   | 17 |
| 3.07 - Attaching to the Tractor                | 18 |
| 3.08 - Start Up                                | 20 |
| 3.09 - Working Speed                           | 21 |
| 3.10 - Uneven Terrain                          | 21 |
| 3.11 - Removing Rotary Cutter from the Tractor | 22 |
| 3.12 - Transport                               | 22 |
| <b>4 - MAINTENANCE</b>                         | 24 |
| 4.01 - Maintenance Safety                      | 24 |
| 4.02 - Service                                 | 25 |
| 4.03 - Blade Maintenance                       | 27 |
| 4.04 - Rotor & Stump Jumper Assembly           | 29 |
| 4.05 - Driveline                               | 30 |
| 4.06 - Safety Shear Bolt                       | 31 |
| 4.07 - Safety Slip Clutch                      | 32 |
| <b>5 - REPAIR PROCEDURES</b>                   | 35 |
| 5.01 - Gearbox                                 | 35 |
| 5.02 - Suggested Spare Parts                   | 36 |
| 5.03 - Storage                                 | 36 |
| <b>6 - TROUBLESHOOTING</b>                     | 37 |
| <b>7 - PRE-DELIVERY CHECKLIST</b>              | 38 |
| <b>8 - WARRANTY</b>                            | 39 |
| <b>PARTS MANUAL</b>                            | 43 |

# 1 - GENERAL INFORMATION

Thank you and congratulations for having chosen our implement. Your new rotary cutter is a technologically advanced machine constructed of high quality, sturdy components that will fulfill your working expectations. Read this manual carefully. It will instruct you on how to operate and service your mower safely and correctly. Failure to do so could result in personal injury and/or in equipment damage.

## 1.01 - General

The implement described in this manual is to be used with tractors with PTO at 540 rpm and clockwise rotation.



**CAUTION:** Always ensure that the coupling of the implement with the tractor is done at the same PTO speed and direction of rotation. Do not operate this implement at a PTO speed or direction of rotation other than that shown on the implement. Serious damage can occur to the machine and/or the operator.



**CAUTION:** Hardware used on the implement may be metric. Use only metric tools on metric hardware. Other tools that do not fit properly can slip and cause injury.



**CAUTION:** Right hand and left hand sides of the implement are determined by facing in the direction the implement will travel when going forward (see fig. 2).

## 1.02 - Warranty Information

Carefully read the Warranty section<sup>1</sup>, detailing coverage and limitations of this warranty. **Warranty** is provided for customers who operate and maintain their equipment as described in this manual. Warranty registration is accomplished by the dealer by completing and forwarding the **Warranty Registration** form to the Company, along with a copy of the dealer's invoice. It is in your best interest to insure that this has been done.

Warranty does not cover the following:

1. Cleaning, transporting, mailing and service call charges.
2. Normal wear items such as blades, bearings, wheels, drivelines, shear pins, slip clutches, etc.

---

<sup>1</sup> See Chapter 8 - Warranty.

3. Depreciation or damage caused by normal wear, accidents, improper maintenance, improper protection or improper use.
4. The use of non-original spare parts and accessories.

Your Authorized Company Dealer has genuine parts in stock. Only these approved replacement parts should be used.

This limited warranty covers defective material and workmanship. The cost of normal maintenance or repairs for accidents or improper use and related labor will be borne by the owner.

### 1.03 - Model and Serial Number ID

Attached to the frame is an ID plate showing the model and the serial number. Record your implement model and serial number in the space provided below. Your dealer needs this information to give you prompt, efficient service when you order parts.

|                 |   |
|-----------------|---|
| <b>BEFCO</b>    | 1781 S. Wesleyan Blvd. – P.O. Box 6036<br>Rocky Mount, N.C. 27802 – U.S.A.<br>Tel: 1.252.977.9920 Fax: 1.252.977.9718 |
| <b>MODEL:</b>   |   |
| <b>SERIAL:</b>  |   |
| <b>VERSION:</b> |   |

## 2 - SAFETY PRECAUTIONS

Safety is the primary concern in the design and manufacture of our products. Unfortunately our efforts to provide safe equipment can be wiped out by a single careless act of an operator.

In addition to the design and configuration of equipment, hazard control and accident prevention are dependent upon the awareness, concern, prudence and proper training of personnel involved in the operation, transport, maintenance and storage of equipment. It is the operator's responsibility to read and understand all safety and operating instructions in the manual and to follow these.

Allow only properly trained personnel to operate the mower. Working with unfamiliar equipment can lead to careless injuries. Read this manual, and the manual for your tractor, before assembly or operation, to acquaint yourself with the machines. It is the mower owner's responsibility, if this machine is used by any person other than yourself, is loaned or rented, to make certain that the operator, prior to operating, reads and understands the operator's manuals and is instructed in safe and proper use.



**WARNING: Because of possible injury from thrown objects, all rotary cutters are potentially dangerous. Any rotary cutter intended for use along roadways or other locations where people may be present, must be used with safety shields in place.**

### 2.01 - Preparation



1. Before operating equipment read and understand the operator's manual and the safety signs (**see fig. 2**).
2. Thoroughly inspect the implement before initial operation to assure that all packaging materials, i.e. wires, bands, and tape have been removed. Ensure that tape has been removed from blades prior to use.
3. Personal protection equipment including hard hat, safety glasses, safety shoes, and gloves are recommended during assembly, installation, operation, adjustment, maintaining and/or repairing the implement.
4. Operate the rotary cutter only with a tractor equipped with an approved Roll-Over-Protective-System (ROPS). Always wear your seat belt. Serious injury or even death could result from falling off the tractor.
5. Clear area to be cut of stones, branches or other debris that might be thrown, causing injury or damage.
6. Operate only in daylight or good artificial light.
7. Ensure rotary cutter is properly mounted, adjusted and in good operating condition.

8. Ensure that all safety shielding and safety signs are properly installed and in good condition.

## 2.02 - Starting and Stopping



1. Be sure that no one is near the machine prior to engaging or while the machine is working.
2. Be sure the tractor is in "Neutral" before starting engine.
3. Mower operating power is supplied from tractor PTO. Refer to your tractor manual for PTO engagement and disengagement instructions. Always operate PTO at 540 rpm. Know how to stop the tractor and mower quickly in case of an emergency.
4. When engaging PTO, the engine rpm should always be low. Once engaged and ready to start cutting, gradually raise PTO speed to 540 rpm and maintain throughout cutting operation.
5. Check the tractor master shield over the PTO stub shaft. Make sure it is in good condition and fastened securely to the tractor. Purchase a new shield if old shield is damaged or missing.
6. Ensure that the shield provided for the driveline's slip clutch or shear bolt is properly mounted to the gearbox and in good condition.
7. After striking an obstacle, disengage the PTO, shut the tractor down and thoroughly inspect for damage before restarting.
8. Never engage the PTO until the cutter is in the down position and resting on the ground. Never raise the cutter until all blades have come to a complete stop.
9. To park the vehicle safely, stop vehicle on a level surface (not on a slope), disengage PTO, engage the parking brake, stop the engine, remove the key, and wait for engine and all moving parts to stop before leaving the operator's seat.
10. Stay clear of rotating drivelines. Entanglement in rotating driveline can cause serious injury or death. Wear close fitting clothing. Stop the engine and be sure PTO driveline is stopped before getting near it.

## 2.03 - Messages and Signs



1. Read and adhere to all safety and operating decals on this machine (**see fig. 2**).
2. Before dismounting tractor: Allow moving parts to stop, stop engine, set brake and remove the key of unattended equipment.
3. Keep away from rotating blades and driveline.
4. Keep guards and shields in place and in good condition.
5. Do not mow with bystanders in area.
6. Allow no riders on tractor or mower.
7. Allow moving parts to stop before repair.

8. Securely support cutter before working underneath.

Additional warning and operating decals are available at no extra charge. Please specify model and serial number when ordering.

**Fig. 2 - Safety decals - driveline; replace immediately if damaged.**

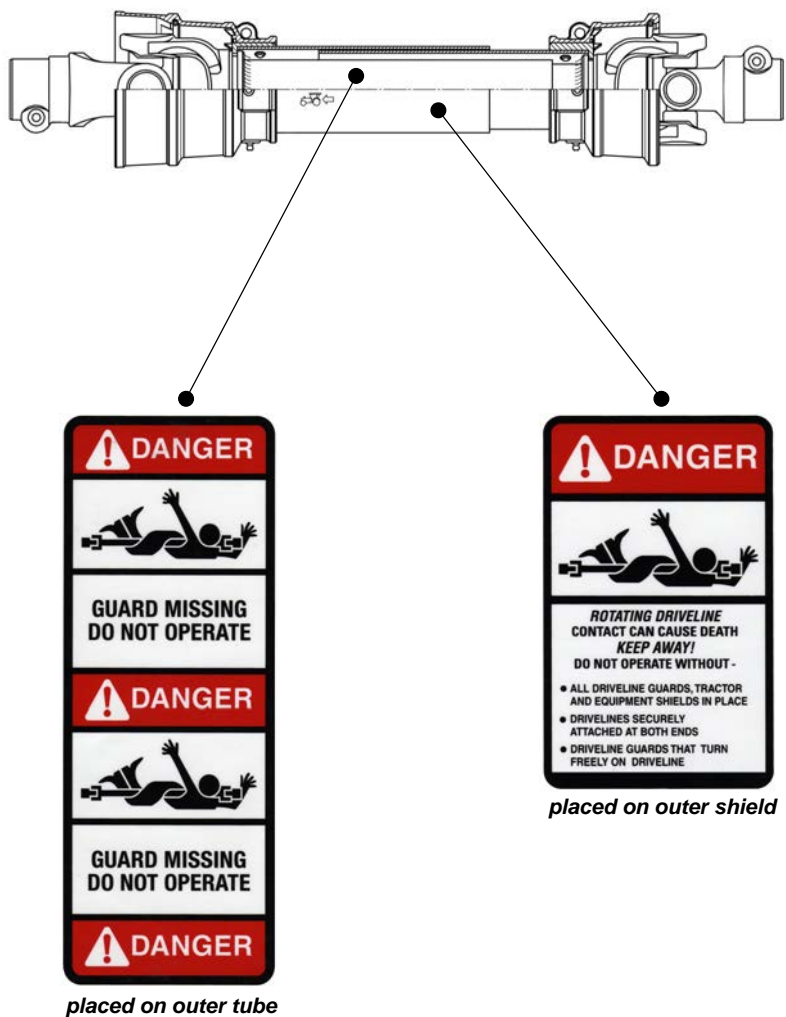



**Safety decals - implement; replace immediately if damaged.**

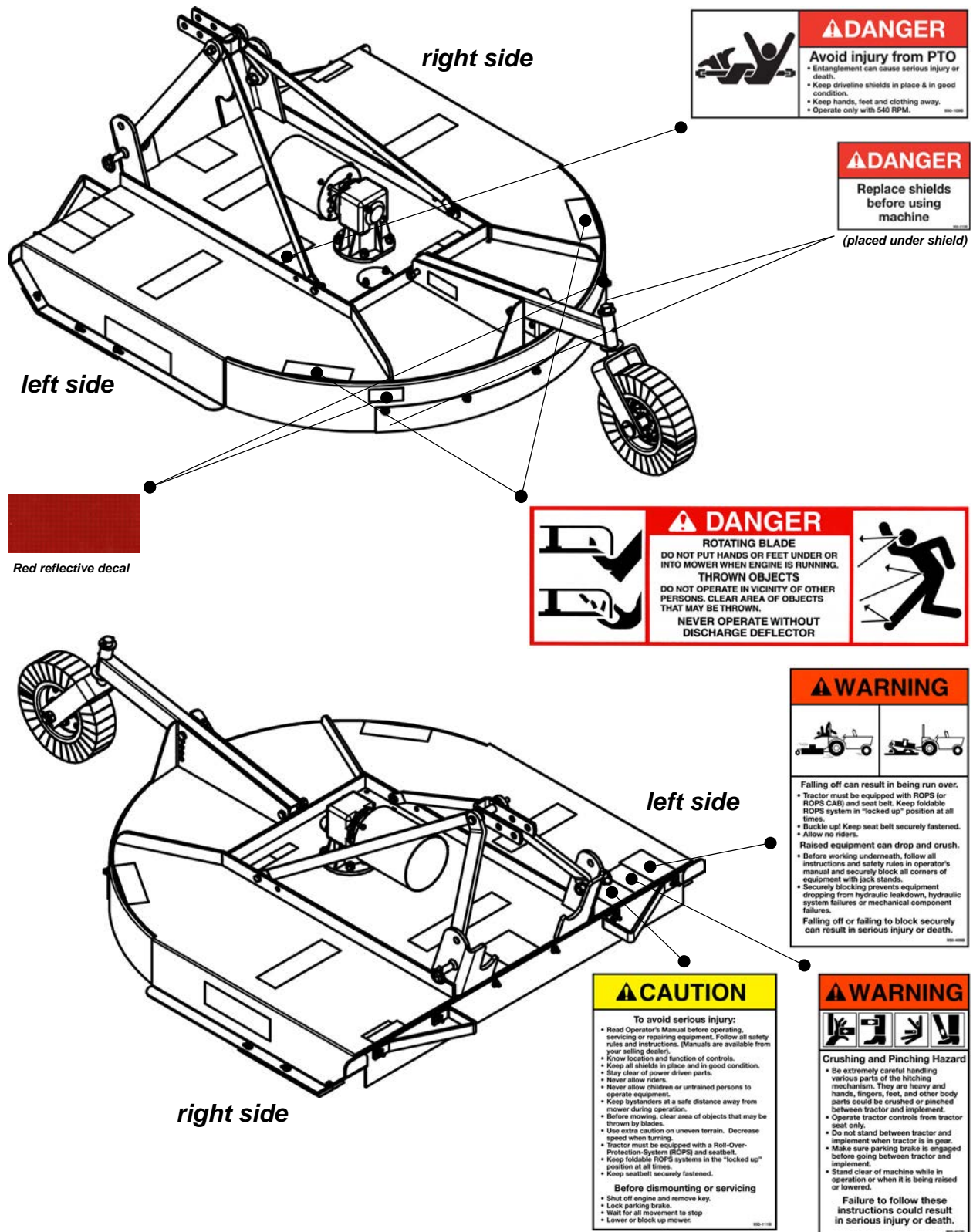

## 3 - OPERATION

You have purchased a rotary cutter which is solid, dependable, and built to last. Our rotary cutters are ideal for use in farms, industrial sites, airports, highways, hospital grounds and many other applications. The Tornado BRC handles the tallest grass and toughest mowing assignments; including light bushes with limbs of up to 1" in diameter. It can also be used for chopping wheat, cornstalks, sunflowers, artichokes and potatoes. The residue is pulverized for easy incorporation into the ground.

On the rotary cutter, the tractor PTO transmits its power through a driveline to a speed multiplier gearbox. The pinion gear shaft of the gearbox transmits the power to the blade holder.

The Tornado BRC rotary cutters, for tractors up to 60 HP, are standard duty models with working widths of 42", 48", 60" and 72". The PTO runs at 540 rpm and the rotor turns at 1042 rpm on the 42" and 48" models and at 794 rpm on the 60" and 72" models.

The balanced rotor is equipped with two 3/8"x2-3/4" free swing spring steel blades on the 42" and 48" models and two 1/2"x3" free swing spring steel blades on the 60" and 72" models. The implement comes with a cutting height control tail wheel and with a 4"x8"x15" laminated tire. The cutting height varies from 1" to 9 1/4". The 48", 60" and 72" models come with a standard stump jumper to protect the blade holder rotor.

### 3.01 - Operational Safety



**CAUTION:** Our rotary cutters are designed considering safety as the most important aspect and are the safest available in today's market. Unfortunately, human carelessness can override the safety features built into our machines. Injury prevention and work safety, aside from the features on our cutters, are very much due to the responsible use of the equipment. It must always be operated prudently following with great care, the safety instructions laid out in this manual.



**WARNING:** Because of possible injury from thrown objects, all rotary cutters are potentially dangerous. Any rotary cutter intended for use along roadways or other locations where people may be present, must be used with safety shields in place.



1. The use of this equipment is subject to certain hazards which cannot be prevented by mechanical means or product design. All operators of this equipment must read

and understand this entire manual, paying particular attention to safety and operating instructions, prior to using.

2. Do not operate the tractor and rotary cutter when you are tired, sick or when using medication.
3. Keep all helpers and bystanders at least 300 feet from a rotary cutter. Only properly trained people should operate this machine.
4. When this machine is operated in populated areas where thrown objects could injure persons or property, front and rear safety shields (which come standard on our rotary cutter and are designed to reduce the possibility of thrown objects) must be installed.
5. The majority of accidents involve entanglements on the driveline, injury of bystanders by objects thrown by the rotating blades, and operators being knocked off the tractor by low hanging limbs and then being run over by the rotary cutter. Accidents are most likely to occur with machines that are loaned or rented to someone who has not read the operator's manual and is not familiar with a rotary cutter.
6. Always stop the tractor, set brake, shut off the tractor engine, remove the ignition key, lower implement to the ground and allow rotary cutter blades to come to a complete stop before dismounting tractor. Never leave equipment unattended with the tractor running.
7. Never place hands or feet under rotary cutter with tractor engine running or before you are sure all motion has stopped. Stay clear of all moving parts.
8. Do not allow riders on the rotary cutter or tractor at any time. There is no safe place for riders.
9. Do not operate unless all personnel, livestock and pets are at least 300 feet away to prevent injury by thrown objects.
10. Before backing up, disengage the rotary cutter and look behind carefully.
11. Install and secure all guards and shields before starting or operating.
12. Keep hands, feet, hair and clothing away from moving parts.
13. This rotary cutter is designed for use only on tractors with 540 rpm power take off.
14. Never operate tractor and rotary cutter under trees with low hanging limbs. Operators can be knocked off the tractor and then run over by the rotating blades.
15. The rotating parts of this machine have been designed and tested for rugged use. However, they could fail upon impact with heavy, solid objects such as steel guard rails and concrete abutments. Such impact could cause the broken objects to be thrown outward at very high velocities. To reduce the possibility of property damage, serious injury, or even death, never allow the cutting blades to contact such obstacles.
16. Frequently check rotary cutter blades. They should be sharp, free of nicks and cracks and securely fastened.
17. Stop rotary cutter immediately upon striking an obstruction. Turn engine off, remove key, inspect and repair any damage before resuming operation.
18. Stay alert for holes, rocks and roots in the terrain and other hidden hazards. Keep away from drop-offs.

19. Use extreme care and maintain minimum ground speed when transporting on hillside, over rough ground and when operating close to ditches or fences. Be careful when turning sharp corners.
20. Reduce speed on slopes and sharp turns to minimize tipping or loss of control. Be careful when changing directions on slopes. Do not start or stop suddenly on slopes. Avoid operation on steep slopes.
21. When using a unit, a minimum 20% of tractor and equipment weight must be on tractor front wheels. Without this weight, tractor could tip over, causing personal injury or death. The weight may be attained with a front end loader, front wheel weights, ballast in tires or front tractor weights. When attaining a minimum 20% of tractor and equipment weight on the front wheels, you must not exceed the ROPS weight certification. Weigh the tractor and equipment. Do not guess or estimate!
22. Inspect the entire machine periodically<sup>2</sup>. Look for loose fasteners, worn or broken parts, and leaky or loose fittings.
23. Use only the driveline supplied with the rotary cutter. Do not use it if it is missing any shield or safety protection.
24. Pass diagonally through sharp dips and avoid sharp drops to prevent "hanging up" tractor and implement.
25. Avoid sudden starts and stops while traveling up or downhill.
26. Always cut down slopes; never across the face. Avoid operation on steep slopes. Slow down on sharp turns and slopes to prevent tipping and/or loss of control.

### 3.02 - Setup

**Notice to dealer:** Pre-delivery setup and service including lubrication is the responsibility of the authorized dealer. It is up to him to assure that the machine is in perfect condition and ready to be used. It is his responsibility to ensure that the customer is aware of all safety aspects and operational procedures for the rotary cutter. He must also fill out the Pre-Delivery Checklist<sup>3</sup> prior to delivering the rotary cutter.

### 3.03 - Assembly Instructions

For transportation purposes the three point hitch of the rotary cutter is shipped loosely assembled on the frame.



**WARNING:** Secure rotary cutter with a hoist before removing the crate from the unit, carefully lower it to the ground after hardware and crating material has been removed. The implement is very heavy and a sudden fall could cause serious injury or death.

---

<sup>2</sup> See Chapter 4 - Maintenance.

<sup>3</sup> See Chapter 7 - Pre-Delivery Checklist.



**CAUTION:** Stand clear of bands when cutting as they could be under sufficient tension to cause them to fly loose. Take care in removing bands and wire. They often have extremely sharp edges and cut very easily.

To assemble the **three point hitch** proceed as follows (see fig. 3):

1. Vertical supports come installed, but are lowered on the frame. Loosen bolts to raise them and ensure they are installed to the **inside** of the front support plates welded on the front of the cutter frame.
2. Horizontal supports are loosely installed and lowered on the frame. Raise them and ensure they are installed to the **inside** of the rear cutter frame using the M14x40 bolts and the M14 nuts provided.
3. Tighten all hardware using the proper torque and ensure that **the top hitch plate swings freely**.
4. **Install the two front metal guards using the carriage bolts provided. (The front rubber shield and rear metal shield come already installed on the cutter).**
5. Grease the wheel yoke, the wheel hub, the PTO shaft and check the gearbox for oil. It should be approximately  $\frac{1}{2}$  filled.
6. Ensure all hardware is properly tightened.

**Fig. 3 - Three point hitch assembly.**

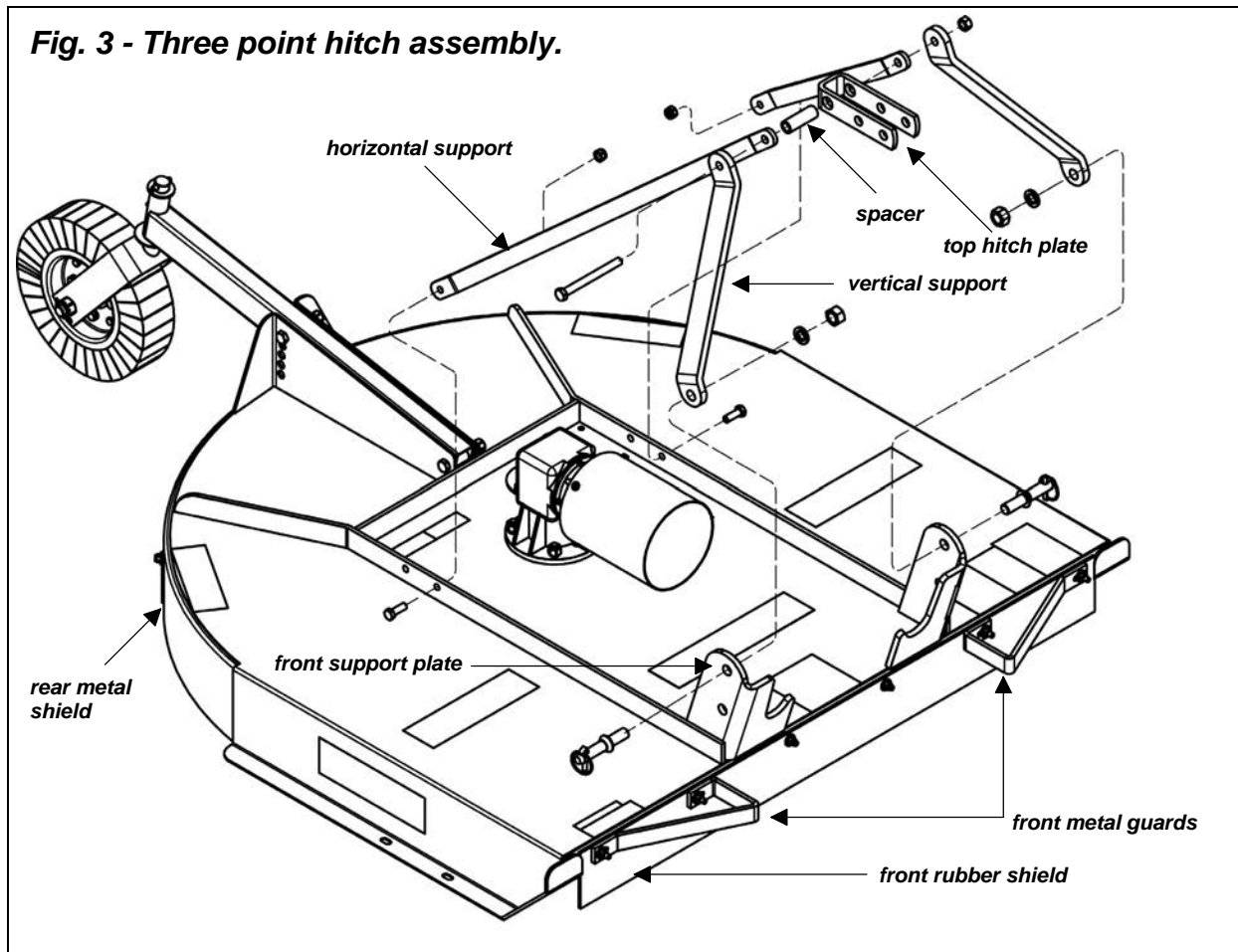

On the 60" and 72" BRC rotary cutters the three point hitch can be assembled in 2 different positions depending on the tractor that will be used (**see fig. 4**):

- **Position 1**, is used for tractors with a category 1 hitch.
- **Position 2**, is generally used for sub-compact tractors with a limited category 1 hitch that need the additional lifting capability during transportation.

Both positions can be used with a category 1 Quick-Hitch.

The rotary cutter is set up at the factory on position 1, to change the position of the three point hitch to position 2, simply remove the hardware that holds the horizontal supports on the cutter frame and the hardware that holds the vertical supports on the front support plates. Slide the horizontal supports towards the rear hole on the deck and bolt loosely. Lower the vertical supports towards the bottom hole on the support plates and install hardware. Tighten all hardware.

**Fig. 4 - Two hitching possibilities to better fit compact & sub-compact tractors (rotary cutter shown with optional quick hitch).**

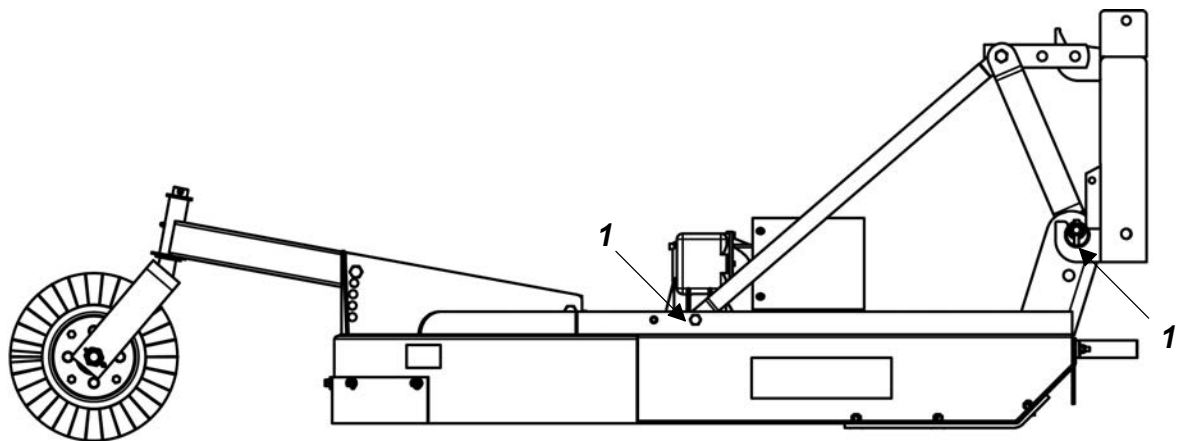

*Position 1 should be used for larger tractors.*

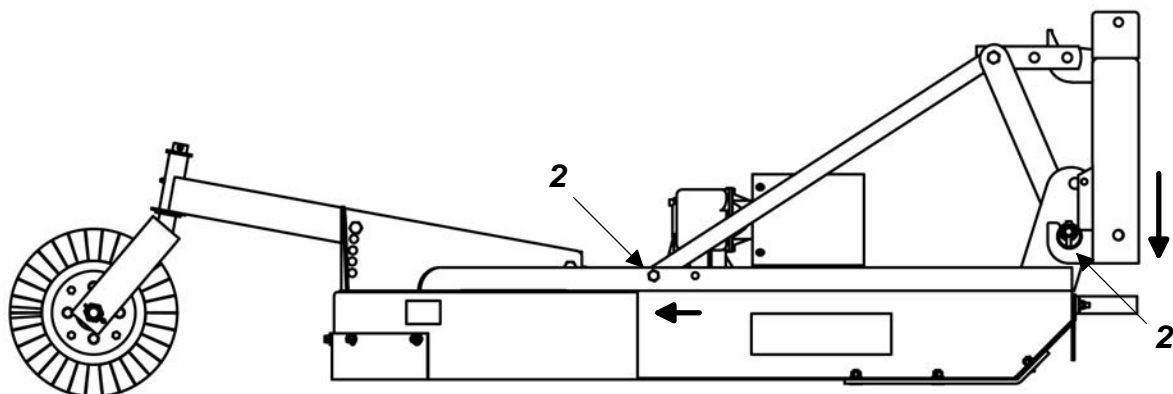

*Position 2 should be used for smaller tractors with limited 3 point lifting capacity.*

To assemble the **driveline** proceed as follows:

1. Install driveline and ensure it has at least 2" from bottoming out in its shortest working position and has the minimum 6" overlap in its longest working position. Refer to **Section 4.05<sup>4</sup>** of this manual, if it is determined that the driveline is too long and needs to be shortened. Contact your local dealer if it is determined that the driveline is too short for your tractor. After having determined that the driveline is of the correct length for your tractor, proceed to step 5.
2. **For models with shear bolt driveline (see fig. 5):** Slide driveline yoke onto gearbox input shaft. Loosen the M6x12 pan head bolts and slide the rubber guard on driveline. Install snap ring onto groove on input shaft. The snap ring is for added security in case the shear bolt should break. Install ½"-13x3.5" grade 2 shear bolt through yoke and input shaft and secure with ½" elastic stop nut. Replace rubber guard and tighten retaining bolts.
3. **For models with slip clutch driveline (see fig. 6):** Slide slip clutch yoke onto gearbox input shaft. Loosen the M6x12 pan head bolts and slide the rubber guard on driveline. Secure slip clutch yoke with M12-1.25x70 C8.8 bolt, lock washer and M12-1.25 nut. Replace rubber guard and tighten retaining bolts.
4. Install both driveline safety chains. One should be hooked in a hole on the outer driveline yoke shield and to the tractor to restrict outer shield rotation. The second one should be hooked in a hole on the inner driveline yoke shield and to the rotary cutter to restrict inner shield rotation.

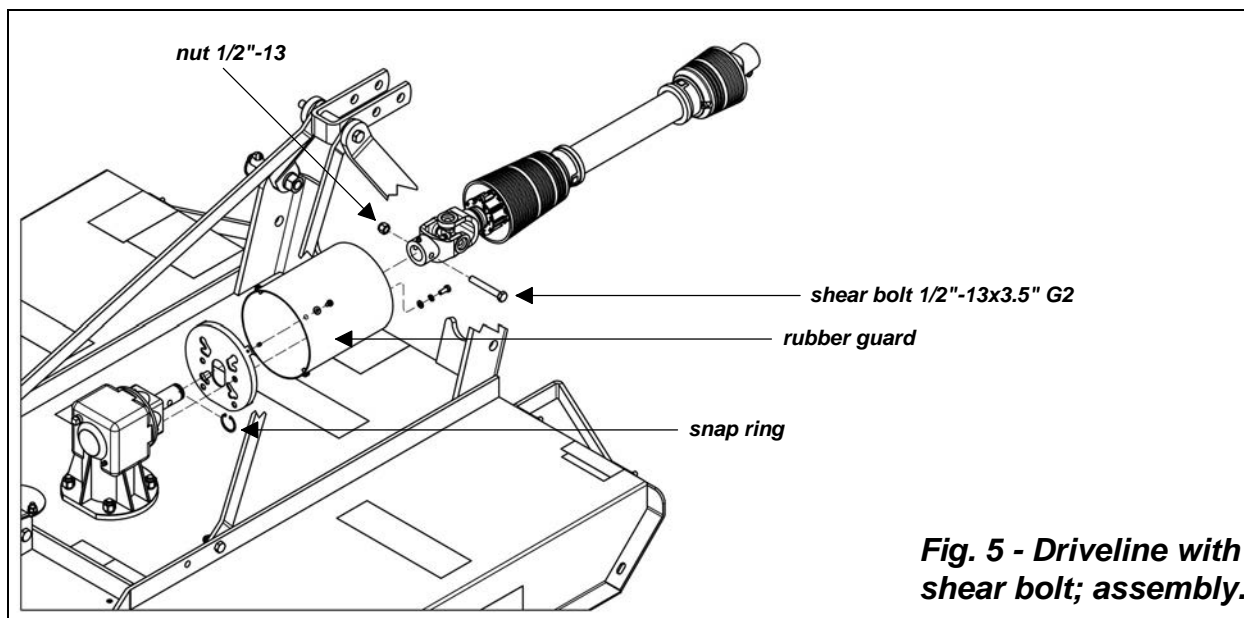

**WARNING:** For models with a shear bolt driveline: Failure to install the snap ring on input shaft will allow driveline to swing freely if bolt is sheared causing possible injury or death.

<sup>4</sup> See Section 4.05 - Driveline, for instructions on how to determine correct driveline length and procedures for shortening the driveline.

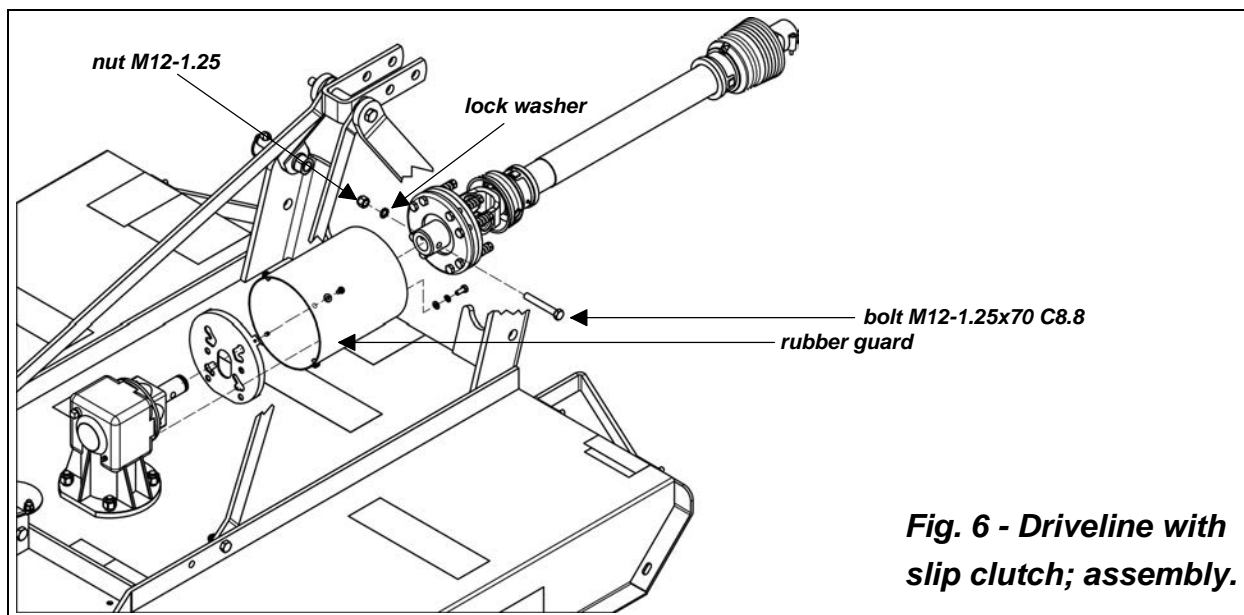

### 3.04 - Skid Shoes (Option)

As an option replaceable skid shoes are available to preserve the deck of the rotary cutter.

To assemble proceed as follows:

1. Raise rotary cutter deck and install blocks or stands under the deck to prevent it from falling. Never rely on the tractor lift system.
2. Install skid shoes (**see fig. 7**) using M12-1.75x30 counter sunk bolts, Ø12 flat washers and M12 prevailing torque nuts. Tighten hardware securely.

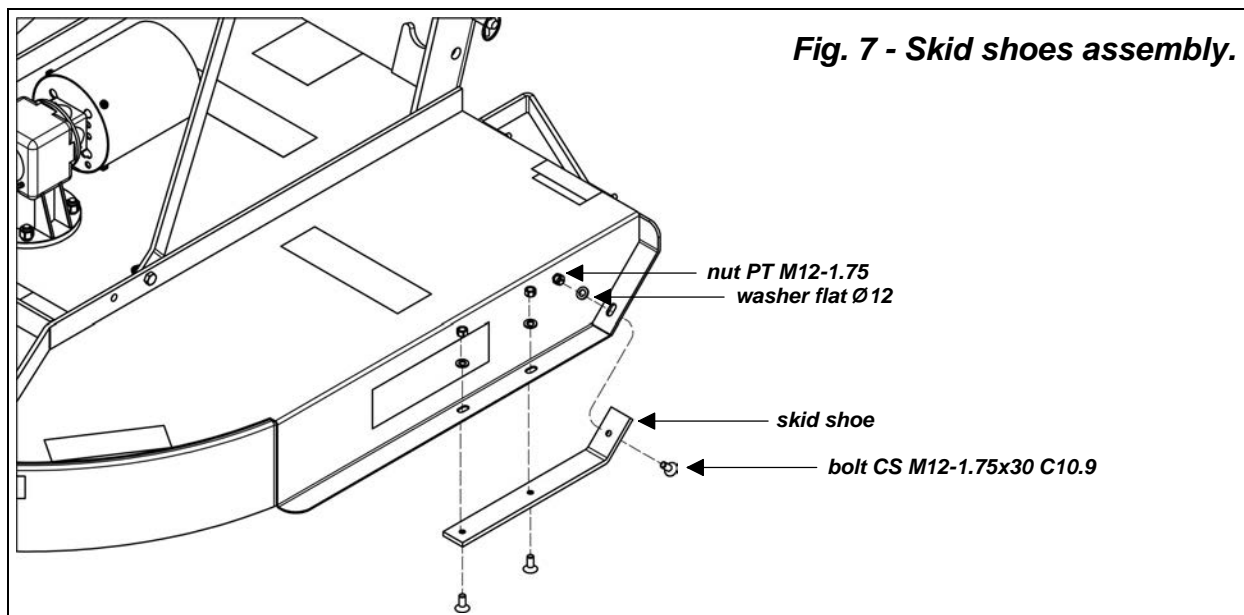



### 3.05 - Cutting Height Adjustment



**WARNING:** Keep hands and feet away from moving blades.

Be sure tractor engine is off, parking brake is locked, and key is removed before making any adjustments.

Never rely on the tractor lift system. Install blocks or stands under the rotary cutter deck to prevent it from falling.

*Fig. 8 - The cutting height is adjustable by moving the wheel arm up or down on the height adjustment brackets.*

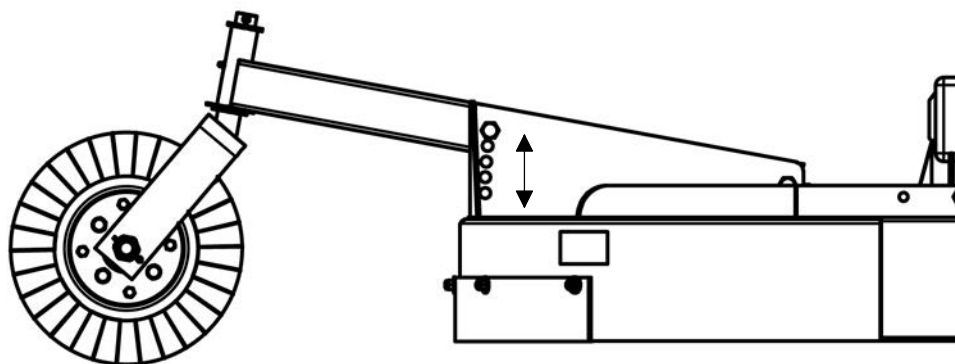

The cutting height is the distance from the blades to the ground which is determined by the position of the tail wheel.

The cutting height is adjusted by **moving the wheel arm up or down on the height adjustment brackets which are part of the deck (see fig. 8)**. Raising the wheel arm lowers the cut.

The cutting height is adjustable from 1" to 9¼".

**IMPORTANT:** Very low cutting heights should be avoided. Damaging shock loads occur when the blades strike the ground repeatedly. This can cause damage to the cutter.

### 3.06 - Pre-Operational Check

**IMPORTANT:** Check each of the following, carefully, prior to engaging the equipment:

1. Oil in the gearbox. The oil should be up to the bottom threads of the oil level hole.
2. The wheel arm and wheel bearing have been greased (**see fig. 10**).

3. The driveline cross and bearings and the inner and outer locking rings have been greased (**see fig. 11**).
4. No wrappings or foreign objects are around the blades, rotor or driveline.
5. The blades are properly installed and the blade bolts properly torqued<sup>5</sup>.
6. All hardware is tight<sup>6</sup>.
7. The tractor, to ensure correct direction of PTO and rpm speed.
8. All safety shields and guards are in place and tightly attached.
9. No people or animals are in the work area.



**DANGER:** Stay clear of rotating driveline. Entanglement in rotating driveline can cause serious injury. Disengage PTO, engage parking brake or place transmission in “Park”, shut off the tractor and remove the key before working around hitch, attaching or detaching driveline, making adjustments, servicing or cleaning the machine.

### 3.07 - Attaching to the Tractor

Unit may be used on tractors ranging from 20 to 60 HP equipped with a standard rear PTO and category 1 or limited category 1 three point hitch or a category 1 Quick-Hitch<sup>7</sup>. **Never use this rotary cutter with tractors over 60 HP.**



**CAUTION:** Check the tractor PTO rpm and its direction of rotation to ensure that they correspond to what is indicated on the machine.



**WARNING:** Disengage PTO, wait for all movement from the implement and tractor to stop, engage parking brake or place transmission in “Park”, shut off the tractor and remove the key before attaching the implement to the tractor.



**DANGER:** Tractor-implement combinations can create unstable unions with a chance of rollover. If necessary, front weights need to be added to the tractor in order to maintain balance. Always ensure that the tractor tire pressure is correct according to the tractor operator's manual.

**To attach the rotary cutter to the tractor do the following:**

1. Back the tractor up to the rotary cutter in order to slip the tractor hitch arms over the pins bolted on the rotary cutter. **Turn off the tractor engine.** Secure the hitch arms

<sup>5</sup> See Removing or Installing Blades in section 4.03 - Blade Maintenance, for details.

<sup>6</sup> See Table 1, page 34.

<sup>7</sup> See Table 2, page 34.

in place with the lynch pins. **Failure to ensure a secure coupling of the implement to the tractor can cause injury and damage to the implement or tractor.**

2. Adjust the tractor sway blocks or chains to remove all side movement.
3. Attach the top link. Adjust tractor top link to allow the rotary cutter to follow the contour of the ground (**see work position, fig. 9**). In this position the top hitch plate is able to float.
4. Install the shielded driveline to the tractor by first lining up the splines and depressing the snap pin. Push the yoke onto the PTO shaft as far as it will go. Release the pin and pull back slowly until the pin clicks in place<sup>8</sup>.
5. Attach the driveline chains to the tractor and to the rotary cutter to keep the driveline protection from turning. The chains should not be too tight.

**Fig. 9 - Tractor top link adjustment.**

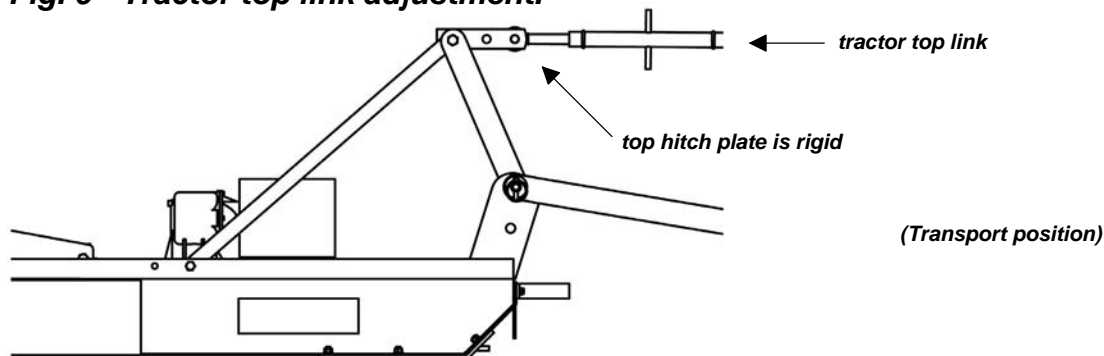

ground

*Top link in transport position (rigid), this position prevents the cutter from bouncing during transport.*

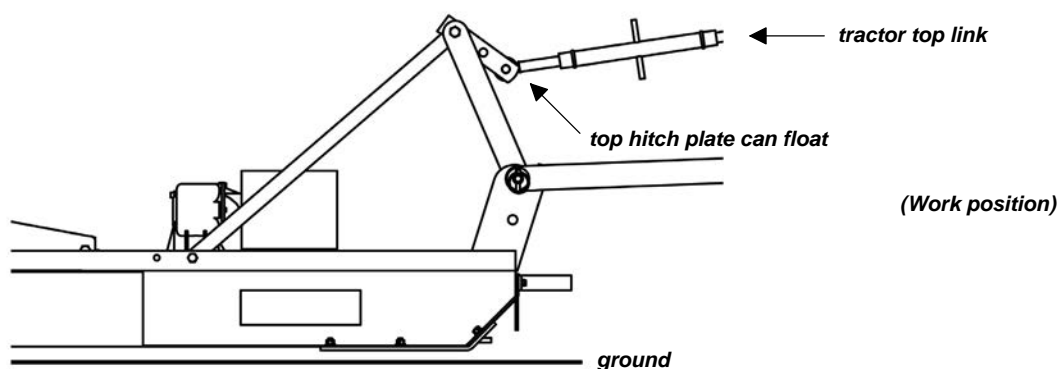

ground

*Top link in operating position (float), this position allows the cutter to follow the contour of the ground.*

<sup>8</sup> See Section 3.03 - Assembly Instructions, for proper installation of the driveline to the rotary cutter.

## 3.08 - Start Up



**DANGER:** The rotary cutter must always be lowered to the ground before starting tractor engine or engaging PTO lever.

Lower the implement with the tractor rockshaft control lever until the deck is horizontal to the ground or slightly tilted so that the front of the deck is lower than the rear. In normal working conditions it is generally recommended to tilt the deck forward by 1" to 2" so that the blades cut material only at the front of the deck. This cutting position will prolong the life of the blades and to use less horsepower throughout the operation.

If, instead, a better shredding of the material is desired, level the deck horizontal or slightly raise the front of the deck so that the front is higher than the rear.

If the cutting height is not correct, change the setting using the tail wheel<sup>9</sup>.

With the engine idling, slowly engage the PTO drive. Move the throttle lever until the PTO speed indicated on the cutter is obtained. The machine is normally set for a PTO speed of 540 rpm.

Shift the transmission to a slow speed gear and start forward, increase the ground speed by shifting upward until the desired speed is obtained.

Do not mow in reverse unless absolutely necessary and only after careful observation of the area behind the rotary cutter.



**CAUTION:** Do not operate this rotary cutter at a PTO speed or direction of rotation other than that shown on the rotary cutter. Serious damage can occur to the machine and/or the operator.

Before starting to mow, never forget that the **operator is responsible** for the following:

1. Safe and correct driving of the tractor and rotary cutter.
2. To learn precise safe operating procedures for both the tractor and the rotary cutter.
3. To ensure all maintenance and lubrication has been performed on the rotary cutter.
4. To have read and understood all safety aspects for the rotary cutter in the operator's manual.
5. To have read and understood all safety decals on the rotary cutter.
6. Checking the condition of the blades. Worn or damaged blades should be changed before starting<sup>10</sup>.
7. Checking to ensure that the cutting edge is the leading edge of the blade.
8. Checking that there is no wire, weed, grass or other material wrapped around blades.

---

<sup>9</sup> See Section 3.05 - Cutting Height Adjustment.

<sup>10</sup> See Section 4.03 - Blade Maintenance.

9. Checking to see if front weights need to be added to the tractor in order to maintain balance.
10. Checking the tractor tires for the proper pressure in accordance with the tractor operator's manual.
- 11. Checking that the driveline guard, the front and rear shields, the front metal guards and all other shielding are on the machine and securely in place.**
12. Making sure the proper attire is worn. Avoiding loose fitting clothing which can become entangled. Wearing sturdy, tough-soled work shoes and protective equipment for eyes, hands, ears and head. Never operate tractor or implement barefoot, or wearing sandals or sneakers.
13. Checking area for stones, branches and other debris that might be thrown.
14. Ensuring proper lighting is available, sunlight or good artificial lighting.

### 3.09 - Working Speed

The mowing speed depends on ground conditions, tractor HP, mowing height and grass thickness. Only a test run will enable you to gauge the optimal working speed for your conditions. Under most conditions a 2 to 6 mph ground speed is best. In order to obtain the best cut possible, always keep the tractor rpm up to the speed indicated on the rotary cutter. When increasing or decreasing mowing ground speed, always use gear selection, not engine speed. This will maintain the constant maximum blade speed necessary for a clean cut.



**WARNING:** Never operate without all shields on the machine and securely in place. The cutter blades can throw objects hundreds of feet which could result in personal or property damage. Pick up all rocks and other debris before mowing. Enter new areas carefully. Cut grass higher at first, allowing the machine to clear hidden objects.



**CAUTION:** For emergency reasons learn how to stop the tractor and cutter quickly. On the rotary cutter always disengage the PTO, lock parking brake, stop engine and allow the blades to come to a complete stop before dismounting the tractor.

### 3.10 - Uneven Terrain



**DANGER:** Be careful of rollover when operating tractor and rotary cutter over uneven ground.

The following precautions should always be observed when working on uneven terrain:

1. In extremely uneven terrain rear wheel weights, front tractor weights, and/or tire ballast should be used to improve stability.
2. Observe the type of terrain and develop a safe working pattern.
3. Whenever traction or stability is doubtful, first test drive over the terrain with the PTO disengaged.
4. Operate the implement up and down steep slopes, not across slopes, to prevent the tractor from tipping. Avoid sudden stops and starts, and slow down before changing directions on a slope.
5. Pass diagonally through sharp dips and avoid sharp drops to prevent hanging up the tractor and implement.
6. Slow down on sharp turns and slopes to prevent tipping or loss of control.
7. Avoid tipping the mower while cutting.
8. Watch for holes, roots or other hidden objects. Do not use near the edge of a gully, ditch or stream bank.

### 3.11 - Removing Rotary Cutter from the Tractor



**CAUTION:** Disengage tractor PTO. Set parking brake. Stop engine and remove key from ignition. Disconnect rotary cutter driveline from tractor PTO shaft. Collapse driveline and store in appropriate place. Disconnect three point linkage and carefully drive tractor away from rotary cutter.

### 3.12 - Transport

Before raising the rotary cutter for transport, the tractor top link must be adjusted so when lifted, the rear of the machine is higher than the front. To do this, shorten the tractor top link until the top hitch plate is locked forward and no longer able to pivot (**see transport position, fig. 9**). This will keep the rotary cutter locked in position and minimize the shaking and bouncing during transport which can damage the hitch or frame.



**CAUTION:** Make sure PTO is disengaged and blades have stopped turning before raising rotary cutter to full transport position. Do not tow tractor and rotary cutter behind other vehicles. Use a properly equipped trailer with heavy tie-downs for towing operations.

Before transporting:

1. Always select a safe ground speed that is appropriate for the terrain.
2. Beware of traffic on public roads. Install a SMV (Slow Moving Vehicle) sign when traveling on roads or streets. Comply with all federal, state and local laws.

3. Reduce ground speed when turning and take care that the implement does not strike obstacles such as trees, fences or buildings.
4. Always disengage PTO before raising the implement to transport position.
5. When raising the mower be sure the PTO driveline does not hit either the mower or the tractor.
6. During transport the mower should not be lifted over 14"-16" from the ground.

## 4 - MAINTENANCE



**DANGER:** Stop engine, lock parking brake and remove key before performing any service or maintenance.

Never rely on the tractor lift system. Install blocks or stands under the rotary cutter deck to prevent it from falling.

Always use personal protection devices, such as glasses or gloves when performing maintenance.

Keep fingers out of slots to prevent injury.

### 4.01 - Maintenance Safety



1. Good maintenance is your responsibility.
2. Keep service area clean and dry. Be sure electrical outlets and tools are properly grounded. Use adequate light for the job at hand.
3. Make sure there is plenty of ventilation. Never operate the engine of the towing vehicle in a closed building. The exhaust fumes may cause asphyxiation.
4. Make no repair or adjustments with the tractor engine running. Before working on the machine, disengage the PTO, shut off the engine, set the brakes, and remove the ignition key.
5. Be certain all moving parts on attachment have come to a complete stop before attempting to perform maintenance.
6. Never work under equipment unless it is blocked securely.
7. Always use personal protection devices such as eye, hand and hearing protectors, when performing any service or maintenance.
8. Frequently check rotary cutter blades. They should be sharp, free of nicks and cracks and securely fastened.
9. Periodically tighten all bolts, nuts and screws and check that all cotter pins are properly installed to ensure unit is in a safe condition.
10. When completing a maintenance or service function, make sure all safety shields and devices are installed before placing unit in service.
11. After servicing, be sure all tools, parts and service equipment are removed.
12. Never replace hex bolts with less than grade five bolts unless otherwise specified, i.e. shear bolts<sup>11</sup>.
13. Where replacement parts are necessary for periodic maintenance and servicing, genuine replacement parts must be used to restore your equipment to original

---

<sup>11</sup> Refer to Table 1 - Torque Specifications, page 34.



specifications. The company will not claim responsibility for use of unapproved parts and/or accessories and other damages as a result of their use.

14. Unauthorized modifications to the machine may impair the function and/or safety of the machine and reduce its life. If equipment has been altered in any way from original design, the manufacturer does not accept any liability for injury or warranty.

## 4.02 - Service

The accompanying illustrations show lubrication points. The chart gives the frequency of lubrication in hours, based on normal operating conditions. Severe or unusual conditions may require more frequent lubrication.

Use a good quality SAE multipurpose type grease for all locations shown. Be sure to clean fittings thoroughly before using grease gun.

Use 90 wt. gear oil in gearbox.

**Fig. 10 - Implement lubrication points.**

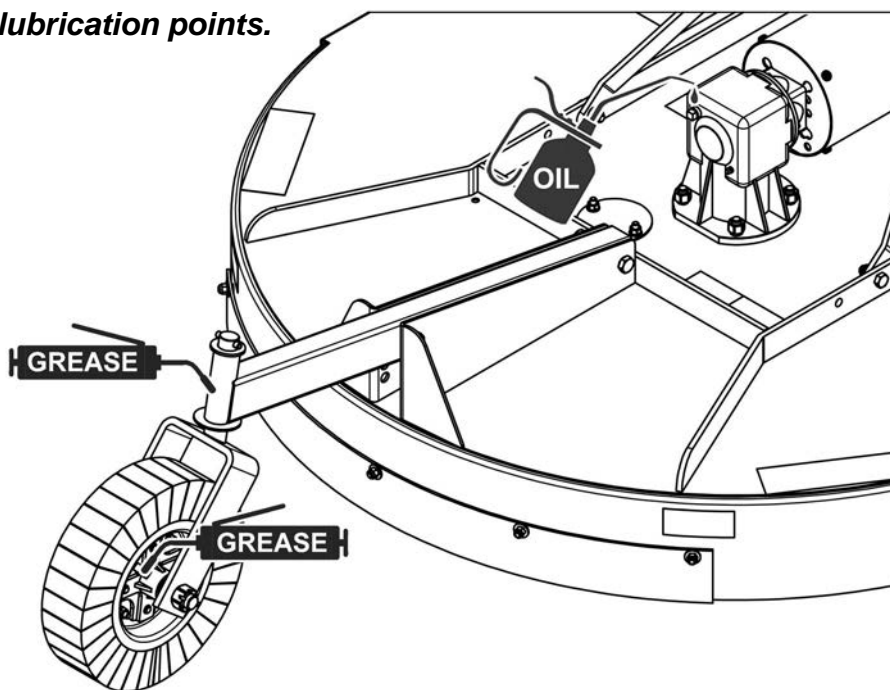

### Hourly:

1. Check the condition of cutter blades for nicks or dull edges.
2. Sharpen if necessary. Replace bent or damaged blades<sup>12</sup>.
3. Also check blades for damage after hitting an obstruction.
4. Clean foreign material from the deck.

<sup>12</sup> See Removing Blades in section 4.03 - Blade Maintenance, for details.

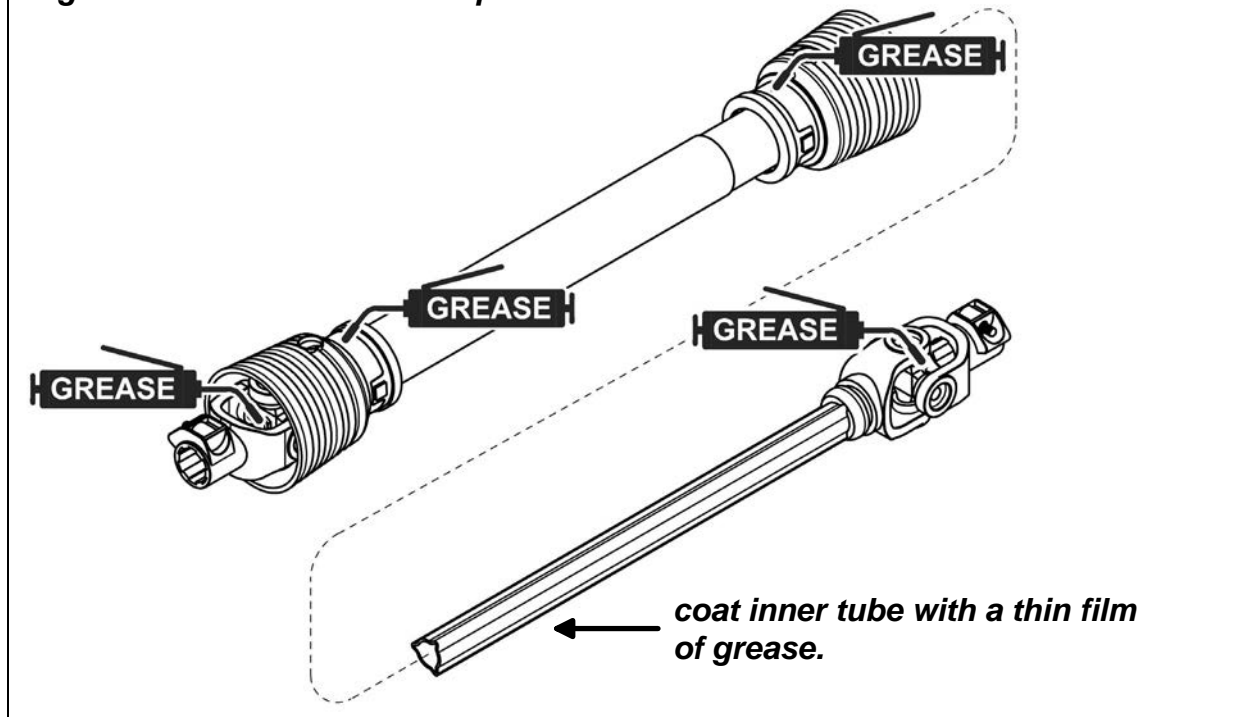
**Fig. 11 - Driveline lubrication points.****Every 8 hours:**

1. **Lubricate driveline, lubricate caster wheel and tail wheel yoke (see fig. 10 & 11):** Apply two or three shots of grease to the driveline cross and bearings and to the inner and outer locking rings (see fig. 11); apply the same amount to the wheel yoke grease fittings and the wheel grease fittings (see fig. 10). (See the driveline manufacturer operator's manual for further information on the driveline.)
2. **Gearbox oil level (see fig. 12):** Check the oil by removing the oil level plug on the back side of the gearbox casing. The oil should be up to the bottom threads of the oil level hole. If needed remove the fill plug and add SAE 90W gear oil. When fully drained the gearbox requires approximately 26 fl. oz. (0.8 qt.) of oil.

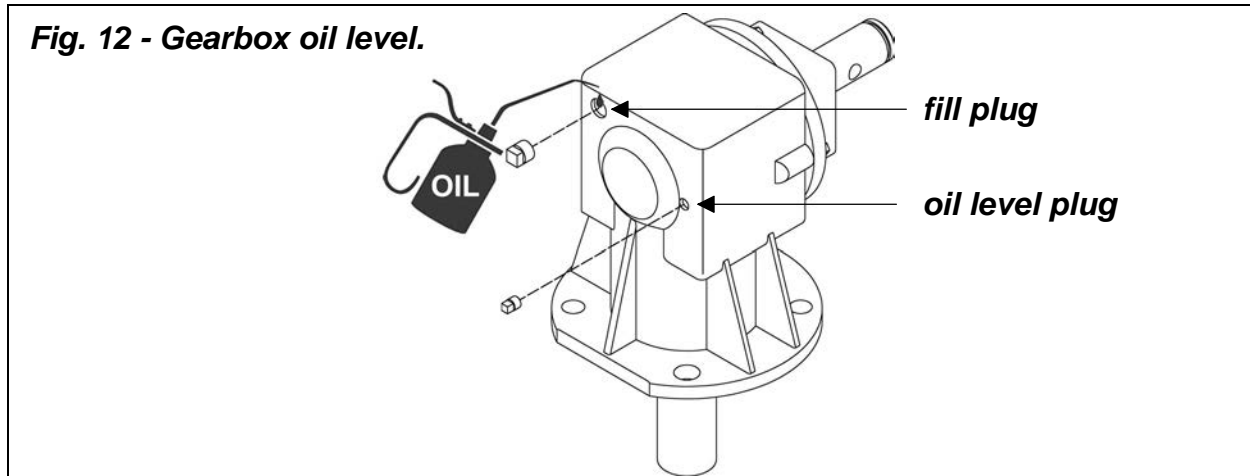
**Fig. 12 - Gearbox oil level.**

**Every 20 hours: Lubricate the driveline telescoping shafts:** Apply a thin film of grease on the inner tube of the driveline (see fig. 11).

**Every 25 hours: Check hardware tightness;** rotary cutter vibrations can loosen bolts. Check tightness of the hardware periodically, using **Table 1** as a guide<sup>13</sup>.

### 4.03 - Blade Maintenance



**WARNING:** To avoid possible injury, wear proper eye and hand protection when servicing cutter blades.

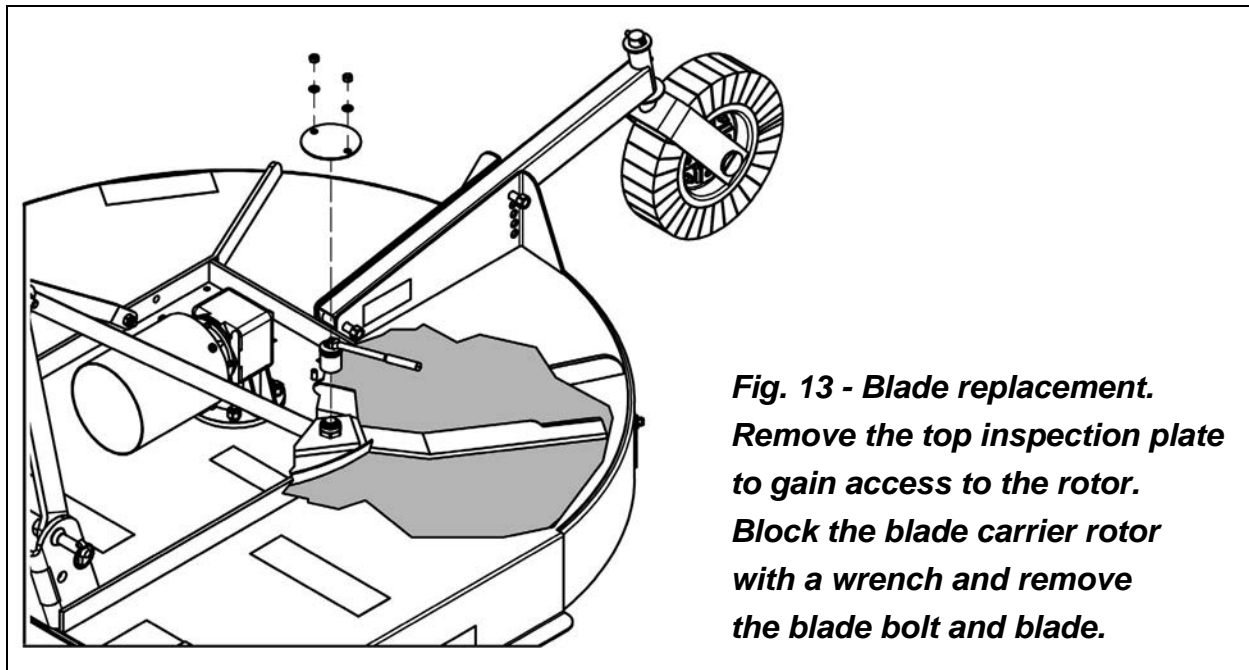

Proper blade maintenance is important in order for the cutter to work properly, to always obtain a precision cut and to lower HP requirements thus keeping costs down. Blades must be kept sharp, at their original length and with corners intact. A blade must be replaced if, due to wear or damage, its original shape has been distorted. Blade sharpening is extremely important in order to get the best cutting results.

#### Removing or installing blades

Never rely on the tractor lift system to support the machine while working underneath. Install blocks or stands under the cutter deck to prevent it from falling.

To replace the blades, proceed as follows (see fig. 13):

1. Remove the top inspection plate to gain access to the rotor.
2. Block the blade carrier rotor with a wrench and remove the blade bolt nut.

<sup>13</sup> See Table 1, Torque Specifications, page 34.

3. Remove the blade bolt and blade.
4. Check the bolt for wear. Replace if necessary.
5. Place the new blade making sure that the cutting edge is towards the direction of rotation. The blade turns in a clockwise direction when viewed from the bottom of the deck (**see fig. 14**).
6. Insert the blade bolt into the new blade and install into blade carrier rotor.
7. Properly torque the blade nut (M27-2.00 C6.8) to **265 lb.ft.**

**IMPORTANT:** Check blade bolt torque every 8 hours. Ensure the blades are able to free-swing. This is extremely important to prevent damage to the cutter.

**IMPORTANT:** When installing new blades, it is important that they be the same type and the same weight to ensure balance. An unbalanced rotor blade carrier can damage the cutter.

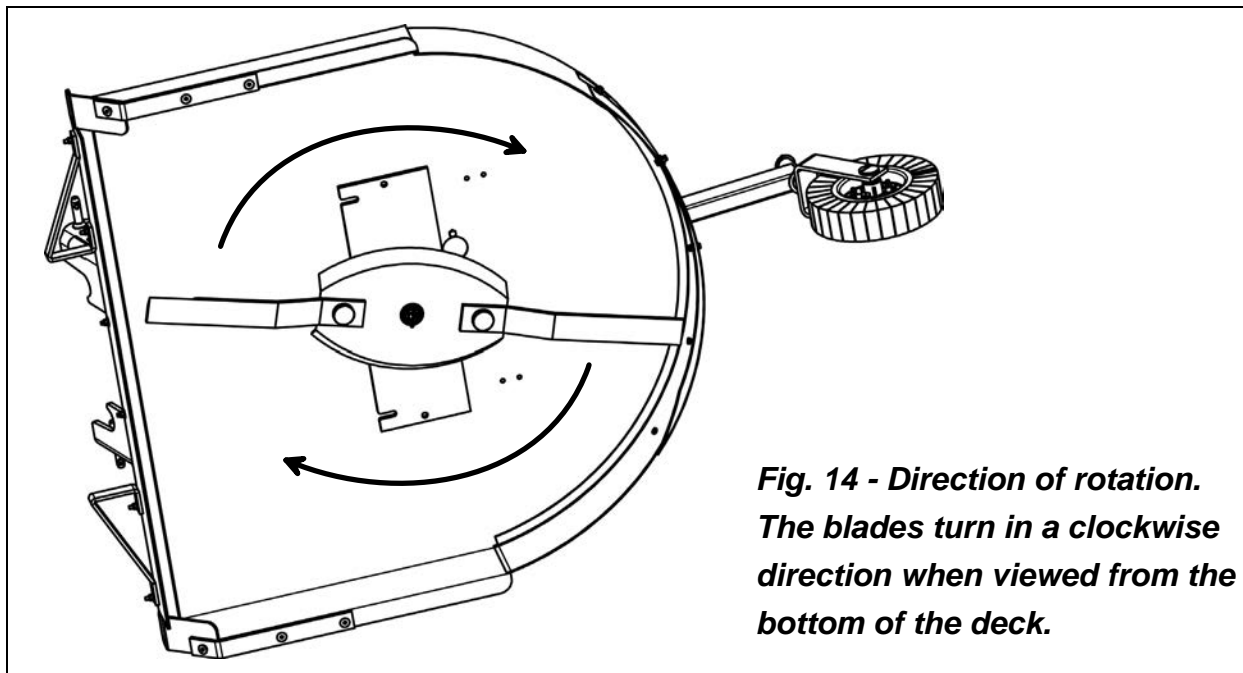

**Fig. 14 - Direction of rotation.**  
*The blades turn in a clockwise direction when viewed from the bottom of the deck.*



**WARNING:** Do not substitute blades or the blade retaining bolt with non original parts. Company blades and blade retaining bolts are specially made for this application. Using non original parts can affect the quality of cut and may also cause damage to the rotary cutter.



**DANGER:** Proper torque must be used when tightening the blade retaining bolt. If these safety precautions are not followed, the blade could come off during operation and be thrown hundreds of feet from the rotary cutter.

#### 4.04 - Rotor & Stump Jumper Assembly

To assemble the stump jumper to the rotor do the following (see fig. 15):

1. Position the rotor bar on the stump jumper so the holes line up.
2. Attach the blades making sure the cutting edge is towards the direction of rotation (see fig. 14).
3. Torque blade nut (see #1, fig. 15) to 265 lb.ft.

Note: The 42" BRC does not come with a stump jumper, therefore the blades should be assembled directly on the rotor.

To assemble the rotor/stump jumper assembly on the rotary cutter do the following:

1. Insert the rotor/stump jumper assembly on the pinion shaft.
2. Bolt on the castle nut (see #6, fig. 15) and torque to 350 lb.ft.
3. Insert the castle nut cotter pin (see #7, fig. 15) and ensure it is seated into the rotor properly.

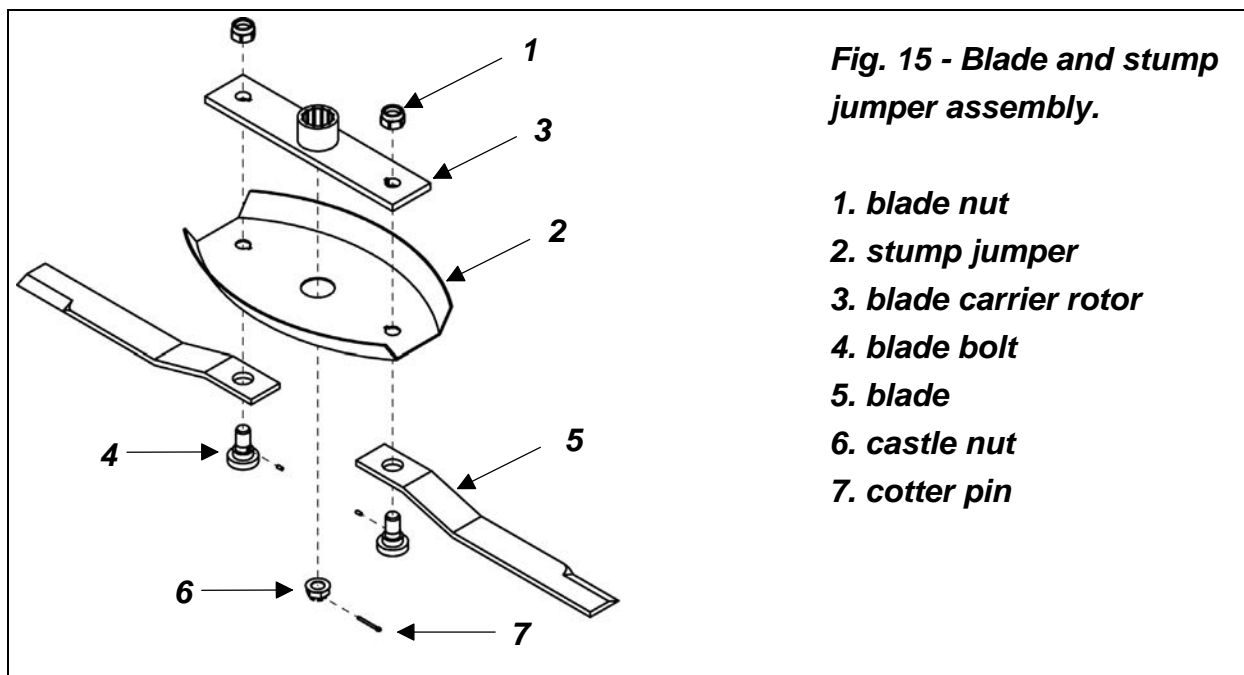

## 4.05 - Driveline



**DANGER:** Only use the original driveline supplied with this machine and always with the safety shielding. Carefully read and file away the driveline operator's manual supplied by the manufacturer. The following does not substitute the information found in the driveline manual.

**IMPORTANT:** Always check driveline length during initial setup and when connecting to a different tractor.

In the collapsed position the driveline should be approximately 2" from bottoming out to prevent possible damage to the tractor or implement. When the driveline is in the maximum extended position, the ideal minimum overlap of the two halves should be approximately 6" (see fig. 16).

Fig. 16

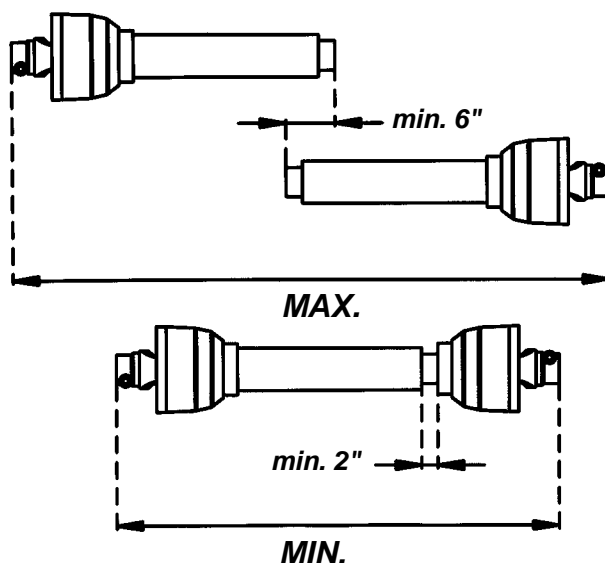

If determined that the driveline is too long, follow these procedures to adjust the length:

1. Separate the two driveline halves. Connect one half to the tractor PTO and the other half to the rotary cutter.
2. Raise and lower the rotary cutter with the 3 point hitch to find the position where the driveline is shortest. Hold the half shafts side by side and mark the desired length on the outer female tube guard leaving a 2" gap between the end of the guard tube and bell guard.
3. Cut off both guard tubes the same amount as marked in step 2.
4. Shorten both drive tubes the same amount as guard tubes.
5. De-burr and clean filings from drive tubes and apply grease to outside of inner telescoping tube.

6. Reassemble the driveline halves and connect to tractor and rotary cutter. Raise and lower rotary cutter again to be sure driveline does not bottom out in its shortest position and has a minimum overlap of 6" in the longest position.
7. Install both driveline safety chains. One should be hooked in a hole on the outer driveline yoke shield and to the tractor to restrict outer shield rotation. The second one should be hooked in a hole on the inner driveline yoke shield and to the rotary cutter to restrict inner shield rotation.

If determined that the driveline is too short for your tractor, contact your local dealer.



**CAUTION:** Always work with the driveline as straight as possible. This will prolong its life and that of its components. It is advised not to work at an angle greater than 15 degrees.

#### 4.06 - Safety Shear Bolt



**CAUTION:** When this machine is equipped with a shear bolt driveline, for the protection of the PTO and gearbox, never replace the shear bolt with anything harder than a grade 2 bolt. All warranties will be void if a bolt harder than a grade 2 is used.

**IMPORTANT:** To install the driveline with the safety shear bolt: Slide driveline yoke onto gearbox input shaft. Loosen guard retaining bolts and slide guard onto the driveline. Install snap ring onto groove on input shaft. The snap ring is for added security in case the shear bolt should break. Install  $\frac{1}{2}$ "-13x3.5" grade 2 shear bolt through yoke and input shaft and secure with  $\frac{1}{2}$ " nut<sup>14</sup>. Replace rubber guard and tighten retaining bolts.

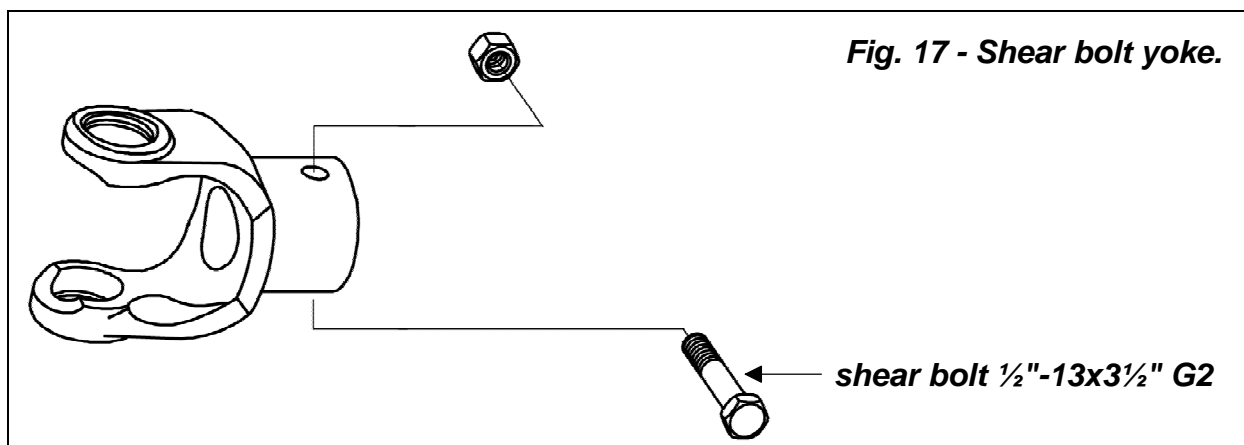

<sup>14</sup> Refer to Section 3.03 - Assembly Instructions, for additional information on proper driveline installation.



**WARNING:** Failure to install the snap ring on input shaft will allow driveline to swing freely if bolt is sheared causing possible injury or death.

In the case of a shear bolt breaking (the operator will notice that the cutter will stop even though the tractor PTO is still engaged), disengage the PTO, stop and turn off the tractor. **Replace the broken shear bolt with another having the identical characteristic of the original (see fig. 17).**

Substituting different shear bolts other than those indicated by the manufacturer can render the safety inoperable.

## 4.07 - Safety Slip Clutch

**IMPORTANT:** To install the driveline with the safety slip clutch: Slide slip clutch yoke onto gearbox input shaft. Loosen guard retaining bolts and slide guard onto the driveline. Secure slip clutch yoke with M12-1.25x70 C8.8 bolt, lock washer and M12-1.25 nut<sup>15</sup>. Replace rubber guard and tighten retaining bolts.

When the driveline is supplied with the safety slip clutch, it is important to ensure it is working properly. The slip clutch delivered with your machine is set at a specific torque for normal working conditions.

While working, if the clutch slips frequently for no apparent reason, the spring nuts need to be tightened by ½ turn. Check the clutch after 600-800 ft., if necessary repeat the operation. If, after tightening the nuts down, the clutch continues to slip, the discs will have to be replaced (see fig. 18). Follow the instructions in reverse, if while working under normal conditions the clutch does not slip at all.

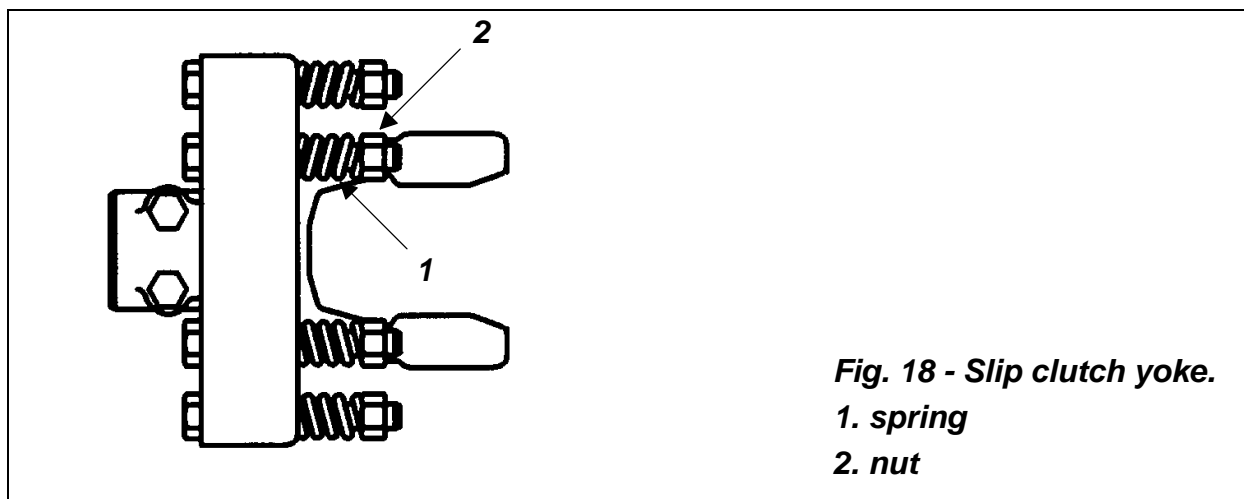







<sup>15</sup> Refer to Section 3.03 - Assembly Instructions, for additional information on proper driveline installation.





**CAUTION:** Check the tractor master shield over the PTO stub shaft. Make sure it is in good condition and fastened securely to the tractor. Purchase a new shield if old shield is damaged or missing. When you are using a driveline equipped with a slip clutch, ensure that the metal slip clutch shield is properly mounted to the gearbox and in good condition.

**TABLE 1 - TORQUE SPECIFICATIONS**

| Metric (ISO)<br>treaded<br>bolts head<br>marking |               | <br>Class 5.8 |       | <br>Class 8.8 |       | <br>Class 10.9 |       | Inch (SAE)<br>treaded<br>bolts head<br>marking |               | <br>Grade 2 |       | <br>Grade 5 |       | <br>Grade 8 |       |
|--|---------------|--|-------|--|-------|---|-------|--|---------------|---|-------|--|-------|--|-------|
|  |               | N.m  | ft-lb | N.m  | ft-lb | N.m   | ft-lb |  |               | N.m   | ft-lb | N.m  | ft-lb | N.m  | ft-lb |
| <b>Bolt size</b>                                 | <b>Thread</b> |  |       |  |       |   |       | <b>Bolt size</b>                               | <b>Thread</b> |   |       |  |       |  |       |
| mm   | mm            |  |       |  |       |   |       | inch   | inch tpi      |   |       |  |       |  |       |
| M5   | 0.8           | 4  | 3     | 6  | 4     | 9   | 7     | 1/4"   | 20            | 7   | 5     | 11   | 8     | 16   | 12    |
| M6   | 1             | 6  | 4     | 10   | 7     | 15  | 11    | 1/4"   | 28            | 8   | 6     | 13   | 10    | 19   | 14    |
| M8   | 1.25          | 16   | 12    | 25   | 18    | 36  | 27    | 5/16"  | 18            | 15  | 11    | 24   | 17    | 33   | 25    |
| M8   | 1             | 17   | 13    | 26   | 19    | 38  | 28    | 5/16"  | 24            | 17  | 13    | 26   | 19    | 37   | 27    |
| M10  | 1.5           | 31   | 23    | 48   | 35    | 71  | 52    | 3/8"   | 16            | 27  | 20    | 42   | 31    | 59   | 44    |
| M10  | 1.25          | 33   | 24    | 51   | 38    | 75  | 55    | 3/8"   | 24            | 31  | 23    | 47   | 35    | 67   | 49    |
| M10  | 1             | 35   | 26    | 53   | 39    | 78  | 58    | 7/16"  | 14            | 43  | 32    | 67   | 49    | 95   | 70    |
| M12  | 1.75          | 54   | 40    | 84   | 62    | 123   | 91    | 7/16"  | 20            | 48  | 36    | 75   | 55    | 106  | 78    |
| M12  | 1.5           | 56   | 41    | 87   | 64    | 128   | 94    | 1/2"   | 13            | 66  | 48    | 102  | 75    | 144  | 106   |
| M12  | 1.25          | 59   | 44    | 90   | 66    | 133   | 98    | 1/2"   | 20            | 75  | 55    | 115  | 85    | 163  | 120   |
| M14  | 2             | 84   | 62    | 133  | 98    | 195   | 144   | 9/16"  | 12            | 95  | 70    | 147  | 109   | 208  | 154   |
| M14  | 1.5           | 94   | 69    | 142  | 105   | 209   | 154   | 9/16"  | 18            | 106   | 79    | 164  | 121   | 232  | 171   |
| M16  | 2             | 131  | 97    | 206  | 152   | 302   | 223   | 5/8"   | 11            | 132   | 97    | 203  | 150   | 287  | 212   |
| M16  | 1.5           | 141  | 104   | 218  | 161   | 320   | 236   | 5/8"   | 18            | 149   | 110   | 230  | 170   | 325  | 240   |
| M18  | 2.5           | 181  | 133   | 295  | 218   | 421   | 310   | 3/4"   | 10            | 233   | 172   | 361  | 266   | 509  | 376   |
| M18  | 2             | 196  | 145   | 311  | 229   | 443   | 327   | 3/4"   | 16            | 261   | 192   | 403  | 297   | 569  | 420   |
| M18  | 1.5           | 203  | 150   | 327  | 241   | 465   | 343   | 7/8"   | 9             | 226   | 167   | 582  | 430   | 822  | 606   |
| M20  | 2.5           | 256  | 189   | 415  | 306   | 592   | 437   | 7/8"   | 14            | 249   | 184   | 642  | 473   | 906  | 668   |
| M20  | 1.5           | 288  | 212   | 454  | 335   | 646   | 476   | 1"   | 8             | 339   | 250   | 873  | 644   | 1232   | 909   |
| M22  | 2.5           | 344  | 254   | 567  | 418   | 807   | 595   | 1"   | 12            | 371   | 273   | 955  | 704   | 1348   | 995   |
| M22  | 1.5           | 381  | 281   | 613  | 452   | 873   | 644   | 1-1/8"   | 7             | 480   | 354   | 1077   | 794   | 1746   | 1288  |
| M24  | 3             | 444  | 327   | 714  | 526   | 1017  | 750   | 1-1/8"   | 12            | 539   | 397   | 1208   | 891   | 1958   | 1445  |
| M24  | 2             | 488  | 360   | 769  | 567   | 1095  | 808   | 1-1/4"   | 7             | 677   | 500   | 1519   | 1120  | 2463   | 1817  |
| M27  | 3             | 656  | 484   | 1050   | 774   | 1496  | 1103  | 1-1/4"   | 12            | 750   | 553   | 1682   | 1241  | 2728   | 2012  |
| M27  | 2             | 719  | 530   | 1119   | 825   | 1594  | 1176  | 1-3/8"   | 6             | 888   | 655   | 1992   | 1469  | 3230   | 2382  |
| M30  | 3.5           | 906  | 668   | 1420   | 1047  | 2033  | 1499  | 1-3/8"   | 12            | 1011  | 746   | 2268   | 1673  | 3677   | 2712  |
| M30  | 2             | 1000   | 738   | 1600   | 1180  | 2250  | 1659  | 1-1/2"   | 6             | 1179  | 869   | 2643   | 1949  | 4286   | 3161  |
| M36  | 4             | 1534   | 1131  | 2482   | 1830  | 3535  | 2607  | 1-1/2"   | 12            | 1326  | 978   | 2974   | 2194  | 4823   | 3557  |

When using lock washers with nuts, increase torque values by 5%.

**TABLE 2 - TORNADO BRC ROTARY CUTTERS - TECHNICAL FEATURES**

| Series BRC, for tractors up to 60 HP, PTO 540 rpm, 3 point hitch cat. 1 |       |               |               |            |               |               |                         |                    |                |                      |                              |
|---|-------|---------------|---------------|------------|---------------|---------------|-------------------------|--------------------|----------------|----------------------|------------------------------|
| Model   | HP    | Working width | Overall width | Weight lb. | Deck          | Rotor rpm/min | Blades tip speed ft/min | # of blades & size | Cutting height | Laminated wheel size | Driveline 1 3/8" ASAE Cat. 4 |
| BRC-142<br>BRC-242  | 20-60 | 42"           | 47"           | 383<br>401 | 1 piece round | 1042          | 11437                   | 2; 3/8"x2 3/4"     | 1"-9 1/4"      | 4"x8"x15"            | w/shear pin<br>w/slip clutch |
| BRC-148<br>BRC-248  | 25-60 | 48"           | 56"           | 443<br>461 | 1 piece round | 1042          | 12560                   | 2; 3/8"x2 3/4"     | 1"-9 1/4"      | 4"x8"x15"            | w/shear pin<br>w/slip clutch |
| BRC-160<br>BRC-260  | 30-60 | 60"           | 68"           | 528<br>539 | 1 piece round | 794           | 11948                   | 2; 1/2"x3"         | 1"-9 1/4"      | 4"x8"x15"            | w/shear pin<br>w/slip clutch |
| BRC-172<br>BRC-272  | 35-60 | 72"           | 79"           | 601<br>612 | 1 piece round | 794           | 14232                   | 2; 1/2"x3"         | 1"-9 1/4"      | 4"x8"x15"            | w/shear pin<br>w/slip clutch |

\*Because of possible injury from thrown objects, all rotary cutters are potentially dangerous. Any rotary cutter intended for use along roadways or other locations where people may be present must be used with front and rear safety shielding in place.

## 5 - REPAIR PROCEDURES



**CAUTION:** All repair procedures must be done by authorized dealerships. It is not recommended that untrained individuals perform any repair work. The following operations are detailed for qualified personnel only.

### 5.01 - Gearbox

To remove the gearbox from the frame do the following (see fig. 19):

1. Never rely on the tractor lift system. Install blocks or stands under the cutter deck to prevent it from falling.
2. Remove the castle nut safety pin.
3. Remove the castle nut securing the blade carrier rotor to the pinion shaft. Remove the rotor.
4. Remove the nuts holding the gearbox to the frame and remove the gearbox.

If it is necessary to open the gearbox and replace internal parts, be sure to replace any oil seals or gaskets to ensure a tight fit when reassembling.

To replace the gearbox, reverse the above operations, making sure the castle nut securing the blade carrier rotor is torqued to **350 lb.ft.** and that the safety pin is installed properly.

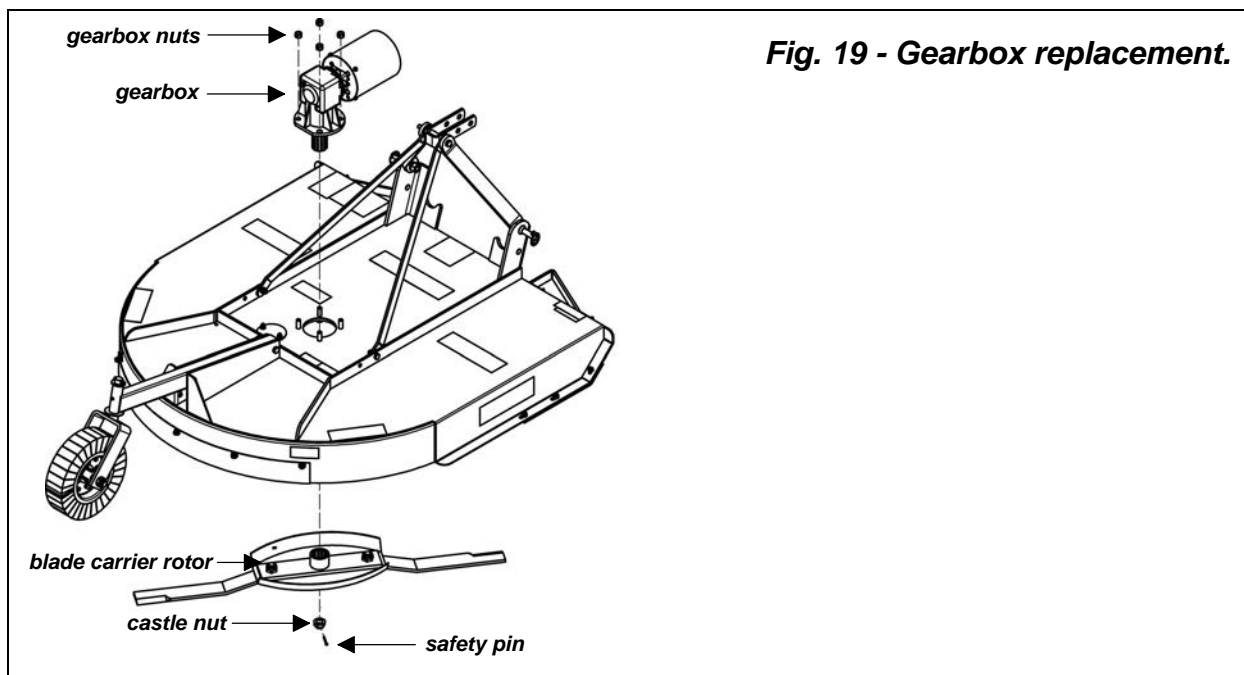

## 5.02 - Suggested Spare Parts

It is suggested that the following spare parts be kept on hand for the rotary cutter at all times to prevent a minor problem from delaying work.

| Description | Quantity |
|-------------|----------|
| Blades      | 2        |
| Blade bolts | 2        |

## 5.03 - Storage

After seasonal use it is important to perform the following for prolonged storage:

1. Wash the rotary cutter carefully.
2. Inspect the rotary cutter and replace worn or damaged parts.
3. Tighten all hardware.
4. Grease all areas indicated under Maintenance<sup>16</sup>.
5. Touch up scratches by sanding the area and applying a light coat of primer and paint to prevent rust from forming.
6. Cover the rotary cutter from the elements in order to have it in perfect condition for the start of the next season.
7. Store driveline in dry area. A slip clutch can become inoperative if the discs stick together. Be sure to check the clutch before using the rotary cutter after prolonged storage.
8. Make sure all parked machines are on a hard, level surface, and engage all safety devices.
9. Do not permit children to play on or around the stored unit.

| Touch up paint available: |   |
|---------------------------|---|
| Part #                    | Description                             |
| 7300007                   | Primer, gray - aerosol spray can        |
| 7300008                   | Paint, Befco orange - aerosol spray can |
| 7300010                   | Paint, Befco black - aerosol spray can  |



**WARNING:** Be sure to store the implement on a hard level surface and away from people especially children.

Note: The machine demolition operations should be carried out in compliance with all federal, state and local environment protection laws.

<sup>16</sup> See Chapter 4 - Maintenance.

## 6 - TROUBLESHOOTING



**WARNING:** Be sure tractor engine is off, parking brake is locked, and key is removed before making any adjustments.

| PROBLEM  | POSSIBLE CAUSE  | SOLUTION   |
|--|---|--|
| Irregular cut.                                   | Cutter is not hooked up level.<br>Blades are worn or bent.  | Adjust three point hitch to level out the cutter.<br>Replace blades.   |
| Material not cut or laid over.                   | Wrappings around rotor.<br>Cutter is not hooked up level.<br>Tractor PTO speed too slow.<br>Slip clutch slipping. | Remove wrappings.<br>Adjust three point hitch to level out the cutter.<br>Check tractor PTO speed.<br>Check slip clutch. |
| Cutter is noisy.                                 | Loose hardware.<br>Gearbox oil level is low.  | Tighten hardware.<br>Add oil to gearbox.   |
| High wear on blades.                             | Blades hitting ground.  | Raise cutting height.  |
| High wear on blade mounting holes (blade bolts). | Cutter is not working at the proper PTO rpm speed.  | Check tractor PTO speed.   |
| Vibrations.                                      | Wrappings around blades.<br>Improper tractor PTO speed.<br>Unbalanced blades.                                     | Remove wrappings.<br>Check tractor PTO speed.<br>Replace blades with identical pairs (the same weight).                  |
| Material bunching.                               | Material is too wet.<br>Material is too high.   | Allow material to dry.<br>Raise cutting height.<br>Reduce ground speed.<br>Make two passes to cut.                       |
| Machine smells hot or begins to smoke.           | Slip clutch slipping.<br>Gearbox oil low.   | Check slip clutch.<br>Check oil level in gearbox.  |
| Oil blowing out of gearbox breather cap          | Gearbox overfilled.   | Drain excess oil out of gearbox by removing the oil plug on the back side of the gearbox casing.                         |

## 7 - PRE-DELIVERY CHECKLIST

**To the dealer:** Inspect the machine thoroughly after assembly to assure it is functioning properly before delivering it to the customer. The following checklist is a reminder of points to cover. Check off each item as it is found satisfactory or after proper adjustment is made.

- ☐ Gearbox oil level.
- ☐ Guards and shield properly fastened.
- ☐ Lubrication of grease fittings.
- ☐ All hardware properly tightened.
- ☐ All decals properly located and readable (**see fig. 2**).
- ☐ Blades properly installed, blade bolts and nuts tightened.
- ☐ Overall condition (touch up scratches, clean and polish).
- ☐ Test run, check for excessive vibration or overheating of bearings.
- ☐ Operator's Manual.

**Review the Operator's Manual with the customer. Explain the following:**

- ☐ Warranty.
- ☐ Safe operation and service.
- ☐ Correct machine installation and operation.
- ☐ Daily and periodic lubrication, maintenance and inspections.
- ☐ Troubleshooting.
- ☐ Operational procedures and storage.
- ☐ Parts and service.
- ☐ Fill out the Pre-Delivery Checklist and Warranty Registration form.
- ☐ Give customer the Operator's Manual and encourage the customer to read the manual carefully.

**IMPORTANT:** Warranty is not valid unless Pre-Delivery Checklist and Warranty Registration form in Operator's Manual is completed in detail and mailed to the Company.

Model Number: \_\_\_\_\_

Serial Number: \_\_\_\_\_

Delivery Date: \_\_\_\_\_

Dealer's Signature: \_\_\_\_\_

## 8 - WARRANTY

BEFCO's responsibility will be limited to substitution of the acknowledged defective merchandise to the same place of delivery as the previous one was supplied.

### 1. LIMITED WARRANTY

BEFCO, Inc. herein referred to as the Company, warrants its machines and related accessories, hereafter referred to as the Machine, to be free from defects in material and workmanship, for a period of twelve (12) months from the date of invoice to the first registered owner; this limited warranty does not apply to common wear items and excludes belts, shear pins, oil, grease, tires, tubes, hydraulic hoses, knives and PTO shafts.

Labor will be reimbursed at \$40.00 per hour based on BEFCO's time schedule.

Cost of transport to the servicing dealer is the responsibility of the customer.

Warranty coverage shall not be transferable from the first owner to any subsequent owner.

### 2. DISCLAIMER OF ALL OTHER WARRANTIES AND REMEDIES

Neither the Company nor any company affiliated with the Company makes any warranties, representations or promises, expressed or implied, as to the quality, performance or application of its products other than those set forth herein and does not make any implied warranty of merchantability or fitness.

The only remedies the purchaser has in connection with the breach, or performance of any warranty on the Company's Machine are those set forth herein. In no event will the dealer, the Company, or any company affiliated with the Company, be liable for:

- a. Injuries or damages of any kind or nature, direct, consequential or contingent to person or property.
- b. Any expenses incurred by the owner to repair, replace or rework any allegedly defective item.
- c. Any loss, cost, forfeiture or damages (including loss of profits; loss of crops; loss because of delay in field operations; any expenses or loss incurred for labor, supplies, substitute machine rental; liabilities of the owner to its customers or third persons; and all other consequential damages, losses, liabilities or damages for any other reasons) whether direct or indirect, and whether or not resulting from or contributed to by the default or negligence of the Company, its agents, employees and subcontractors which might be claimed as a result of the use or failure of the equipment delivered.

The Company's liability based on this limited warranty or any other applicable laws shall be limited to replacement or refund of the purchase price of the product.

The limited warranty extended herein gives you specific rights and you may also have other rights which vary from state to state. Neither the dealer nor the Company personnel has the authority to make any representation or to modify the terms and limitations of this warranty in any way.

**Other than the limited warranty extended hereby there is no other expressed warranty in connection with the design, safety or use of any of the Company's products except as to title. All implied warranties are expressly disclaimed pursuant to the terms of this warranty.**

### **3. CUSTOM WORK**

If the Machine is used for commercial purposes such as custom work, the period warranted for the Machine is limited to six (6) months from the date of delivery to the first registered owner and does not cover any labor charges incurred.

### **4. RENTAL**

If the Machine is used for rental purposes the period warranted for the Machine is limited to thirty (30) days from the date of delivery to the first registered owner and does not cover any labor charges incurred.

### **5. REGISTRATION**

In order to qualify for coverage on this limited warranty, the product and name of the original purchaser must be registered with the Company by a completed Machine Pre-Delivery Checklist and Warranty Registration along with a copy of the dealer's invoice to the first registered owner to the Company within fourteen (14) days after the date of delivery to the original purchaser.

### **6. WARRANTY SERVICE**

Warranty Service must be performed by a dealer authorized by BEFCO. If the warranty service requested is approved, the owner shall pay only for labor beyond the rate allowed, for overtime labor, and for any mileage charge for transporting the equipment to and from the dealer's shop. It is assumed that the dealer has the appropriate general and special tools to service the Machine. Time required for replacement of knives, oil, grease and to remove excessive dirt from the Machine is not subject to reimbursement by the Company. The owner is required to clean the Machine before presenting it to the dealer for service work. The Machine must be delivered within thirty (30) days after failure date by the owner to the dealer to be eligible for warranty consideration.

### **7. UNAPPROVED SERVICE OR MODIFICATION**

All obligations of the Company under this limited warranty shall be terminated if:

- a. Proper service and operation instructions as outlined in the Operator's Manual and on the instruction sticker on the Machine, are not followed.
- b. The Machine is modified or altered in any way not approved by the Company.
- c. The Company does not receive a copy of the dealer's invoice to the first registered owner within fourteen (14) days from the date of delivery.
- d. The Company has not been paid in full, by the dealer, for the Machine.

### **8. ACCIDENTS AND NORMAL MAINTENANCE**

This limited warranty covers defective material and workmanship. It does not cover depreciation or damage caused by normal wear, accidents, improper maintenance, improper protection or improper use. The costs of normal maintenance or repairs for accidents or improper use, and related labor will be borne by the owner.

### **9. REPLACEMENT PARTS**

BEFCO, Inc. warrants replacement parts to be free from defect in material and workmanship for a period of thirty (30) days from the date of delivery to the original purchaser.



# WARRANTY REGISTRATION

**BEFCO, Inc.**  
**P.O. Box 6036**  
**Rocky Mount, NC 27802-6036**

**Tel: (252) 977.9920 - Fax: (252) 977.9718**

|   |                       |   |
|---|-----------------------|---|
| Dealer _____  | Acct. # _____         | Retail Customer _____   |
| Street _____  | Country _____         | Street _____  |
| Town _____  | State _____ Zip _____ | Town _____ State _____ Zip _____  |
| Date of delivery _____  | Invoice # _____       | Phone _____   |
| Model # _____   | Serial # _____        |   |
| <p>Pre-Delivery Checklist:</p> <p><input type="checkbox"/> Oil in gearbox.</p> <p><input type="checkbox"/> Greased fittings.</p> <p><input type="checkbox"/> Safety guards in place.</p> <p><input type="checkbox"/> All hardware tight.</p> <p><input type="checkbox"/> Bolts torqued correctly.</p> <p><input type="checkbox"/> Attached unit to tractor. Yes/No.</p> <p><input type="checkbox"/> Field adjusted. Yes/No.</p> <p><input type="checkbox"/> Test run. Dry/Infield.</p> <p><input type="checkbox"/> Safety decals.</p> <p><input type="checkbox"/> Operator's Manual.</p> <p>The machine described above, had been prepared for delivery according to the Pre-Delivery Checklist and the Customer has been instructed in its care and operation and the condition of warranty.</p> |                       | <p>Tractor make: _____</p> <p>Model: _____; HP _____</p> <p>Type of operation: Private homeowner, Landscaping, Commercial maintenance, Golf Course, Municipality, Turf Farm, others: _____</p> <p>Approximate number of acres machine will be used on annually: _____</p> <p>I hereby acknowledge that:<br/> I have received and accepted delivery of the machine described.<br/> The equipment was checked thoroughly for loose or missing parts and has been adjusted in accordance with the Pre-Delivery Checklist.<br/> I have read and understand the nature and extent of the warranty and understand clearly that there were and are no other representations of warranties either expressed or implied, made by anyone. I have been advised on proper operation, maintenance and lubrication procedure of this equipment.<br/> I have been instructed on and do understand the application, limitation and capacities this equipment was designed and recommended for, all as described in the Operator's Manual and literature published by the Company.</p> |
| Inspected by: _____   |                       |   |
| Date: _____   |                       | Date: _____   |
| Dealer's Signature: _____   |                       | Customer's Signature: _____   |

**This registration along with a copy of the invoice must be sent to BEFCO, Inc. within 14 days of date of purchase.**

**Sender:**

*Fold here*

---

*Place stamp  
here*

**BEFCO, Inc.**

Warranty Department

P.O. Box 6036

Rocky Mount, NC 27802-6036

*Cut along this line*

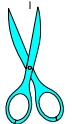



## Parts Manual

# TORNADO

Rotary Cutter

**BRC-142, BRC-148, BRC-160, BRC-172**  
**BRC-242, BRC-248, BRC-260, BRC-272**

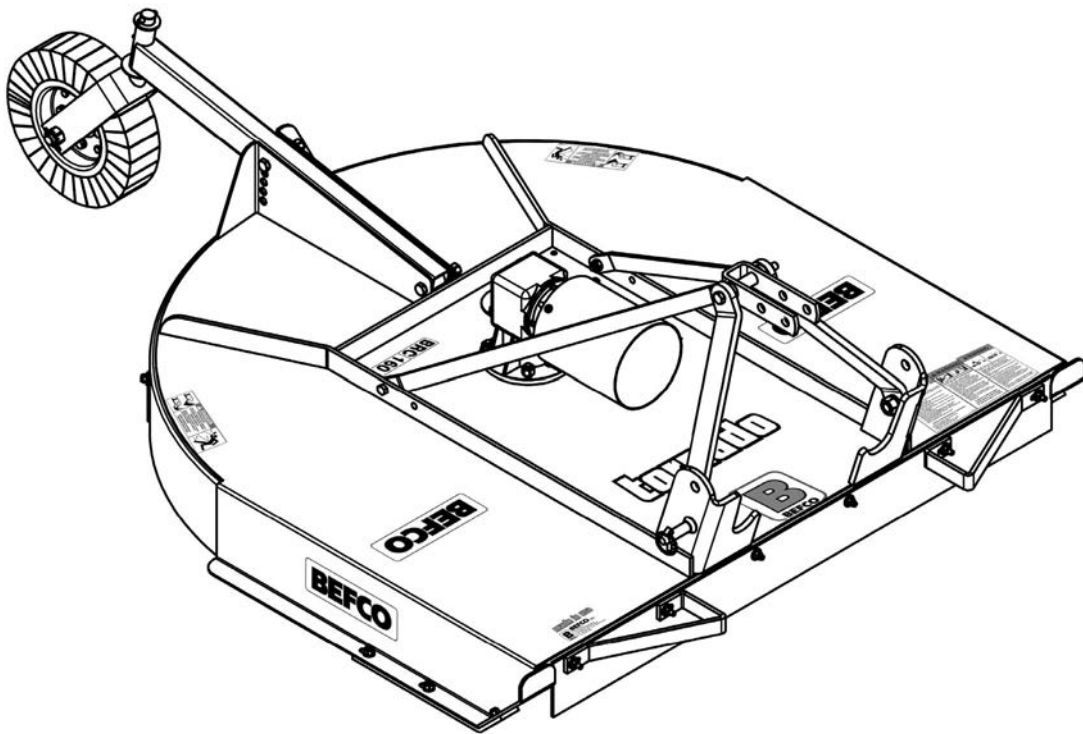

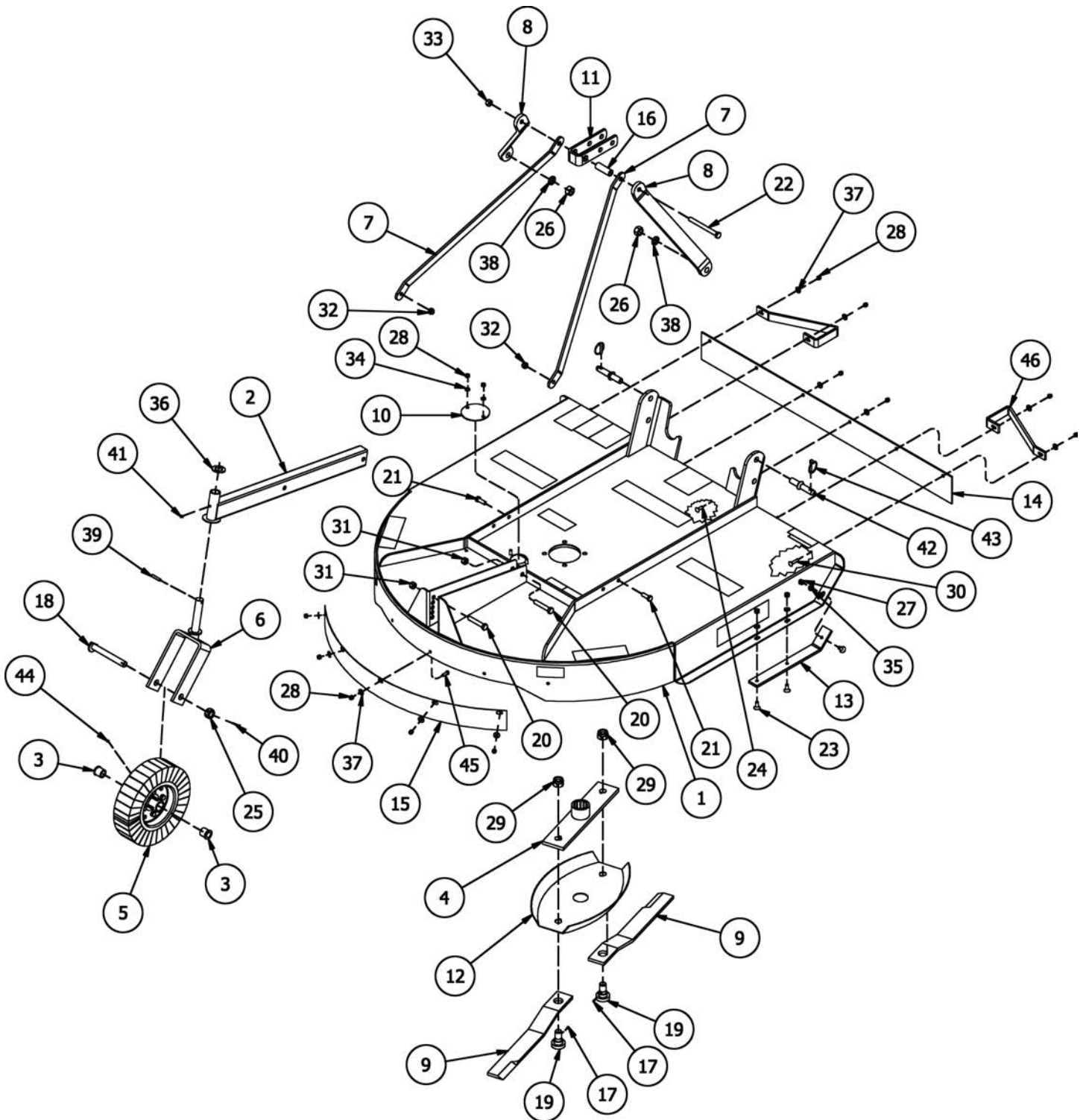

## BRC-142, 148, 160, 172, 242, 248, 260, 272

| Ref. | Part #   | Description                                       | Qty. |
|------|----------|---|------|
| 1    | 7900649  | Frame 42"; BRC-X42                                | 1    |
|      | 7900650  | Frame 48"; BRC-X48                                | 1    |
|      | 7900651  | Frame 60"; BRC-X60                                | 1    |
|      | 7900652  | Frame 72"; BRC-X72                                | 1    |
| 2    | 7900426  | Wheel arm 42"; BRC-X42                            | 1    |
|      | 503-720B | Wheel arm 48"-72"; BRC-X48, X60, X72              | 1    |
| 3    | 503-913B | Bushing, wheel                                    | 2    |
| 4    | 015-5831 | Rotor w/hub 42"; BRC-X42                          | 1    |
|      | 005-5831 | Rotor w/hub 48"-72"; BRC-X48, X60, X72            | 1    |
| 5    | 503-961B | Wheel laminated, complete                         | 1    |
|      | 005-2895 | Wheel laminated (not illustrated)                 | 1    |
|      | 503-914B | Hub, wheel (not illustrated)                      | 1    |
| 6    | 503-911B | Wheel yoke; #330101- <sup>17</sup>                | 1    |
|      | 7900430  | Wheel yoke; #330102-380554 <sup>18</sup>          | 1    |
|      | 7900653  | Wheel yoke; #380555+                              | 1    |
| 7    | 7900368  | Horizontal support BRC-X42 #313804-               | 2    |
|      | 7900371  | Horizontal support BRC-X42 #313805+, BRC-X48, X60 | 2    |
|      | 7900372  | Horizontal support BRC-X72                        | 2    |
| 8    | 7900370  | Vertical support                                  | 2    |
| 9    | 000-5627 | Blade, rotary cutter 42"-48"; BRC-X42, X48        | 2    |
|      | 000-5628 | Blade, rotary cutter 60"; BRC-X60                 | 2    |
|      | 000-5629 | Blade, rotary cutter 72"; BRC-X72                 | 2    |
| 10   | 7900425  | Access plate 42"; BRC-X42                         | 1    |
|      | 005-5826 | Access plate 48"-72"; BRC-X48, X60, X72           | 1    |
| 11   | 000-6828 | Top hitch plate                                   | 1    |
| 12   | 000-5965 | Stump jumper 48"-72"; BRC-X48, X60, X72           | 1    |
| 13   | 005-2709 | Side skid (option)                                | 2    |
| 14   | 7900356  | Safety shield, front 42"; BRC-X42                 | 1    |
|      | 7900358  | Safety shield, front 48"; BRC-X48                 | 1    |
|      | 7900363  | Safety shield, front 60"; BRC-X60                 | 1    |
|      | 7900364  | Safety shield, front 72"; BRC-X72                 | 1    |
| 15   | 7900357  | Safety shield, rear 42"; BRC-X42                  | 1    |
|      | 7900359  | Safety shield, rear 48"; BRC-X48                  | 1    |
|      | 7900361  | Safety shield, rear 60"; BRC-X60                  | 1    |
|      | 7900362  | Safety shield, rear 72"; BRC-X72                  | 1    |
| 16   | 000-6829 | Spacer  | 1    |
| 17   | 000-5635 | Stop pin, blade bolt                              | 2    |
| 18   | 503-912B | Bolt SP M24-2.00x185 Z P; #330101-                | 1    |
|      | 7900431  | Bolt SP M25-3.00x205 C8.8 Z P; #330102-380554     | 1    |
|      | 7900654  | Bolt SP M25-2.00x180 C8.8 Z P; #380555+           | 1    |
| 19   | 000-5956 | Blade bolt SP M27-2.00x55 N; BRC-X42, X48         | 2    |
|      | 000-5960 | Blade bolt SP M27-2.00x62 N; BRC-X60, X72         | 2    |
| 20   | 000-5530 | Bolt HH M16-2.00x80 C8.8 Z P                      | 2    |
| 21   | 007-4232 | Bolt HH M14-2.00x40 C8.8 Z F                      | 2    |
| 22   | 000-6834 | Bolt HH M16-2.00x150 C8.8 Z P                     | 1    |
| 23   | 004-4023 | Bolt CS M12-1.75x30 C10.9 Z F                     | 6    |

<sup>17</sup> Wheel yoke no longer available, interchangeable with part #7900653 provided bolt #7900654 and nut #7900655 are also ordered.

<sup>18</sup> Wheel yoke no longer available, interchangeable with part #7900653 provided bolt #7900654 and nut #7900655 are also ordered.

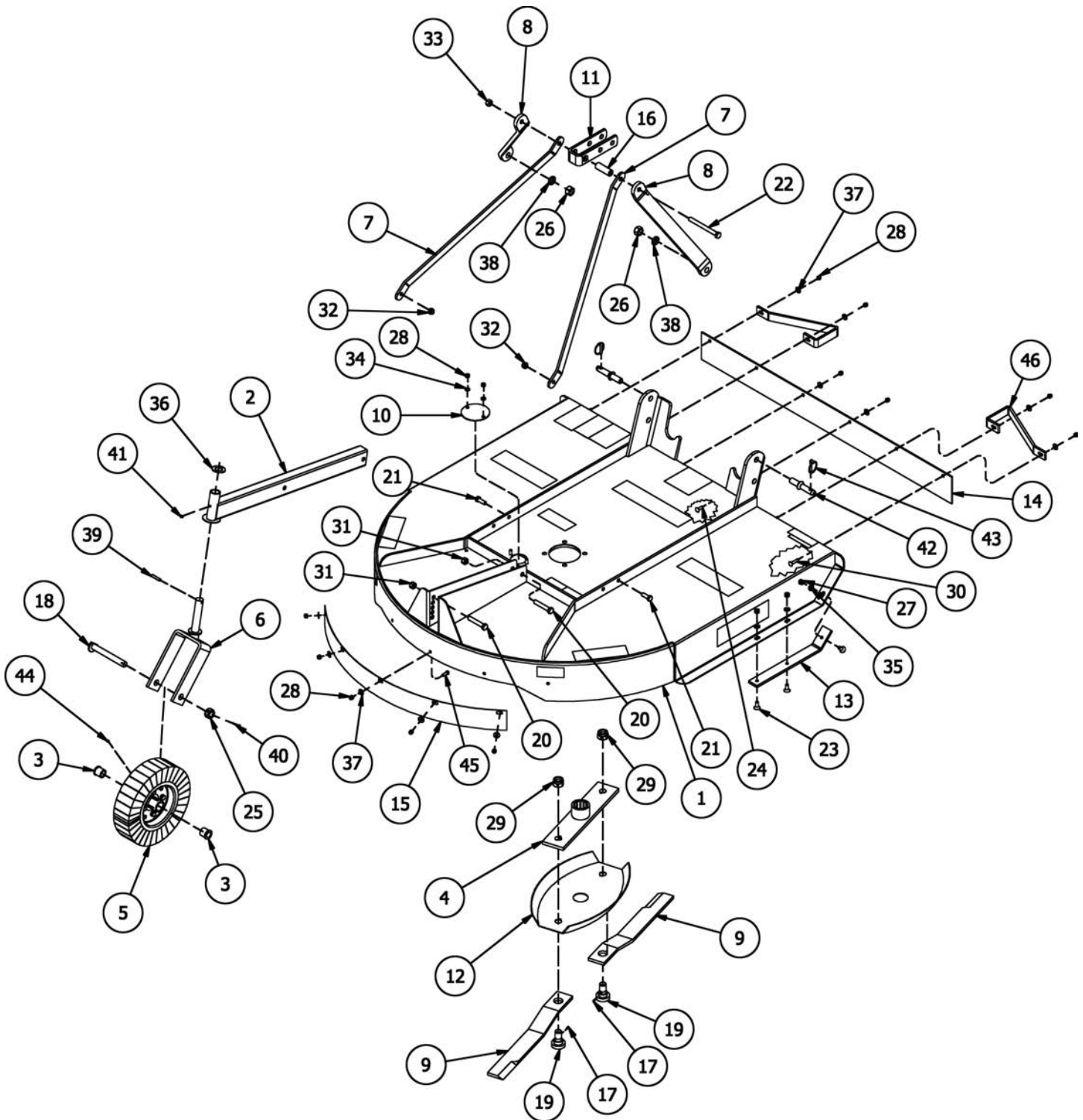

BRC-142, 148, 160, 172, 242, 248, 260, 272

| Ref. | Part #   | Description                          | Qty. |
|------|----------|--------------------------------------|------|
| 24   | 006-0509 | Bolt CR M10-1.50x25 C8.8 Z           | -    |
| 25   | 503-909B | Nut CA M24-2.00 Z; #330101-          | 1    |
|      | 7900432  | Nut CA M25-3.00 Z; #330102-380554    | 1    |
|      | 7900655  | Nut CA M25-2.00 Z; #380555+          | 1    |
| 26   | 502-860B | Nut HH 7/8"-14 G2 Z                  | 2    |
| 27   | 003-0064 | Nut PT M12-1.75 C6 TK Z              | 6    |
| 28   | 001-4106 | Nut ES M10-1.50 Z TK                 | -    |
| 29   | 000-5570 | Nut ES M27-2.00 Z TN                 | 2    |
| 30   | 000-1038 | Bolt CR M10-1.50x35 C4.6 Z           | 4    |
| 31   | 000-5581 | Nut PT M16-2.00 C6 Z TK              | 2    |
| 32   | 003-0358 | Nut PT M14-2.00 C6 Z TK              | 2    |
| 33   | 000-5581 | Nut PT M16-2.00 C6 Z TK              | 1    |
| 34   | 000-2034 | Washer flat Ø10 W; BRC-X42           | 1    |
|      | 000-2034 | Washer flat Ø10 W; BRC-X48, X60, X72 | 2    |
| 35   | 000-2265 | Washer flat Ø12 W                    | 6    |
| 36   | 503-915B | Washer flat Ø33 Z                    | 1    |
| 37   | 003-0157 | Washer fender Ø10 Z                  | -    |
| 38   | 502-859B | Washer lock 7/8" Z                   | 2    |
| 39   | 000-5522 | Roll pin Ø10x50                      | 1    |
| 40   | 502-259B | Cotter pin Ø5x45; #330101-           | 1    |
|      | 011-2087 | Cotter pin Ø4x50; #330102+           | 1    |
| 41   | 503-655B | Grease fitting 5/16" PR STR Z        | 1    |
| 42   | 502-858B | Hitch pin 7/8"-14x3.00" Z            | 2    |
| 43   | 001-8266 | Lynch pin Ø11x45 (option)            | 2    |
| 44   | 306-002F | Grease fitting M08-1.25 STR Z        | 1    |
| 45   | 003-3176 | Bolt HH M10-1.50x25 C8.8 Z F         | -    |
| 46   | 7900354  | Safety guard, front 42"; BRC-X42     | 2    |
|      | 7900355  | Safety guard, front 48"; BRC-X48     | 2    |
|      | 7900365  | Safety guard, front 60"; BRC-X60     | 2    |
|      | 7900366  | Safety guard, front 72"; BRC-X72     | 2    |

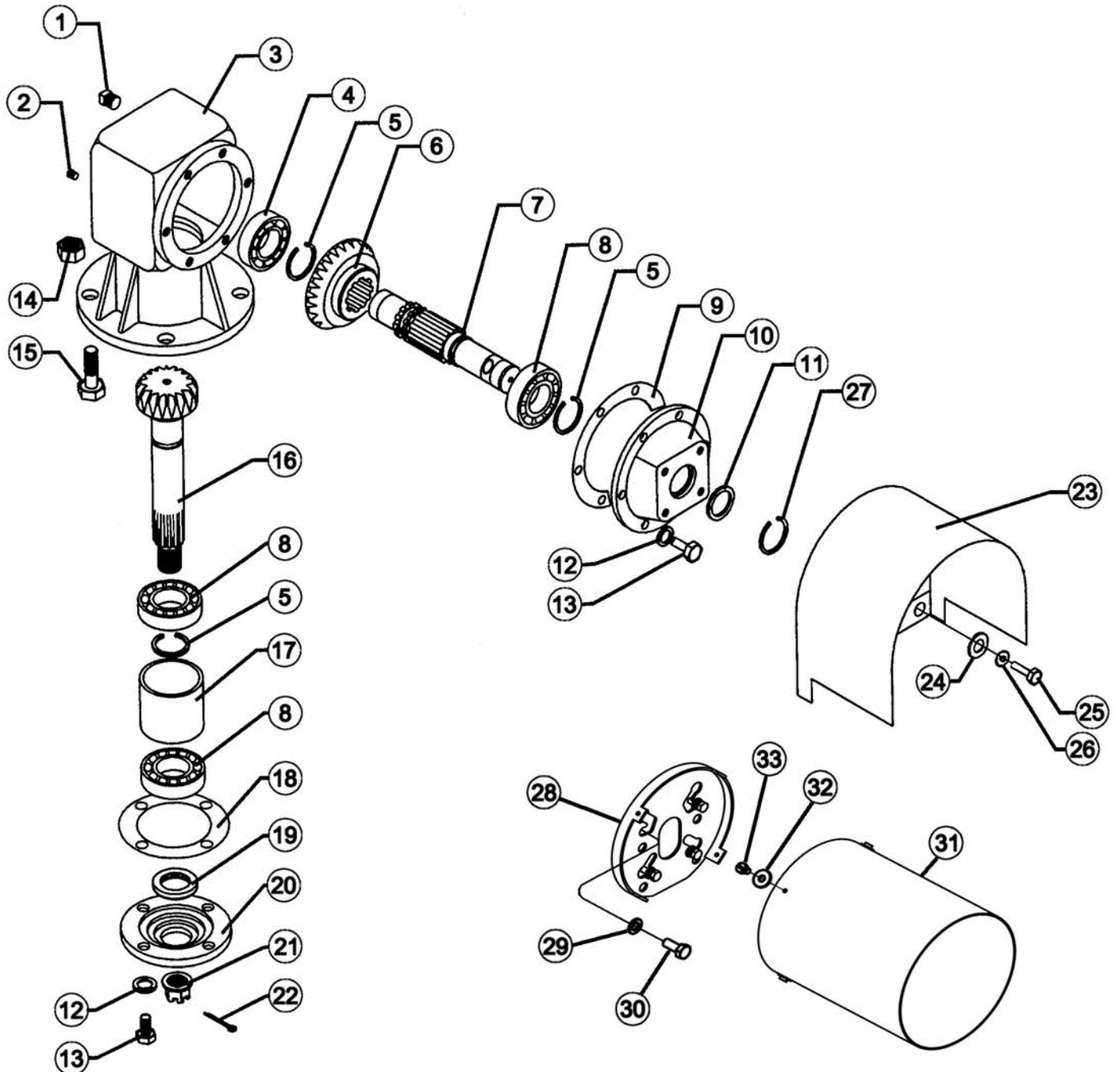



## BRC-142, 148, 160, 172, 242, 248, 260, 272

| Ref. | Part #    | Description  | Qty. |
|------|-----------|--|------|
| 1    | 502-257B  | Fill plug 1/2"   | 1    |
| 2    | 503-428B  | Check plug   | 1    |
| 3    | 503-429B  | Housing, gearbox                                       | 1    |
| 4    | 002-5332A | Bearing 6207   | 1    |
| 5    | 503-430B  | Snap ring, outer Ø36                                   | 3    |
| 6    | 503-659B  | Ring gear; BRC-X42, X48                                | 1    |
|      | 503-431B  | Ring gear; BRC-X60, X72                                | 1    |
| 7    | 503-432B  | Input shaft  | 1    |
| 8    | 001-2149A | Bearing 6208   | 3    |
| 9    | 503-433B  | Gasket, input shaft 0.50                               | -    |
|      | 503-379B  | Gasket, input shaft 0.25                               | -    |
| 10   | 503-434B  | Cover, gearbox   | 1    |
| 11   | 503-435B  | Oil seal 35.54.8                                       | 1    |
| 12   | 000-1280  | Washer lock Ø10 Z                                      | 10   |
| 13   | 503-837B  | Cap screw 3/8"-16x1.00"                                | 10   |
| 14   | 000-5581  | Nut PT M16-2.00 C6 Z TK                                | 4    |
| 15   | 003-3218  | Bolt HH M16-2.00x55 C8.8 Z P                           | 4    |
| 16   | 503-660B  | Pinion gear; BRC-X42, X48                              | 1    |
|      | 503-436B  | Pinion gear; BRC-X60, X72                              | 1    |
| 17   | 503-437B  | Spacer   | 1    |
| 18   | 503-438B  | Gasket, output shaft 0.50                              | -    |
|      | 503-380B  | Gasket, output shaft 0.25                              | -    |
| 19   | 503-439B  | Oil seal 40.54.7                                       | 1    |
| 20   | 503-440B  | Cover, output shaft                                    | 1    |
| 21   | 503-441B  | Nut CA 1"-14   | 1    |
| 22   | 502-259B  | Cotter pin Ø5x45                                       | 1    |
| 23   | 503-715B  | Shield, driveline w/slip clutch; BRC-2XX <sup>19</sup> | 1    |
| 24   | 001-4514  | Washer fender Ø08 Z                                    | 2    |
| 25   | 001-5012  | Bolt HH M08-1.25x20 C8.8 Z F                           | 2    |
| 26   | 000-3144  | Washer lock Ø8 Z                                       | 2    |
| 27   | 004-2122  | Snap ring, outer Ø35, driveline w/shear bolt; BRC-1XX  | 1    |
| 28   | 001-1201  | Guard support  | 1    |
| 29   | 001-4514  | Washer fender Ø08 Z                                    | 4    |
| 30   | 001-5012  | Bolt HH M08-1.25x20 C8.8 Z F                           | 4    |
| 31   | 001-1207  | Guard  | 1    |
| 32   | 001-1209  | Washer fender Ø06 Z                                    | 4    |
| 33   | 001-1210  | Bolt PN M06-1.00x12 C4.6 Z F                           | 4    |
|      | 050-0618  | Gearbox 540 rpm, complete; BRC-X42, X48 <sup>20</sup>  | -    |
|      | 050-0619  | Gearbox 540 rpm, complete; BRC-X60, X72 <sup>21</sup>  | -    |

<sup>19</sup> Shield no longer available, must order (qty. 1) guard 001-1207, (qty. 1) guard support 001-1201 and assembly hardware.

<sup>20</sup> Fill using approx. 26 fl.oz. (0.8 qt.) of SAE 90W gear oil.

<sup>21</sup> Fill using approx. 26 fl.oz. (0.8 qt.) of SAE 90W gear oil.

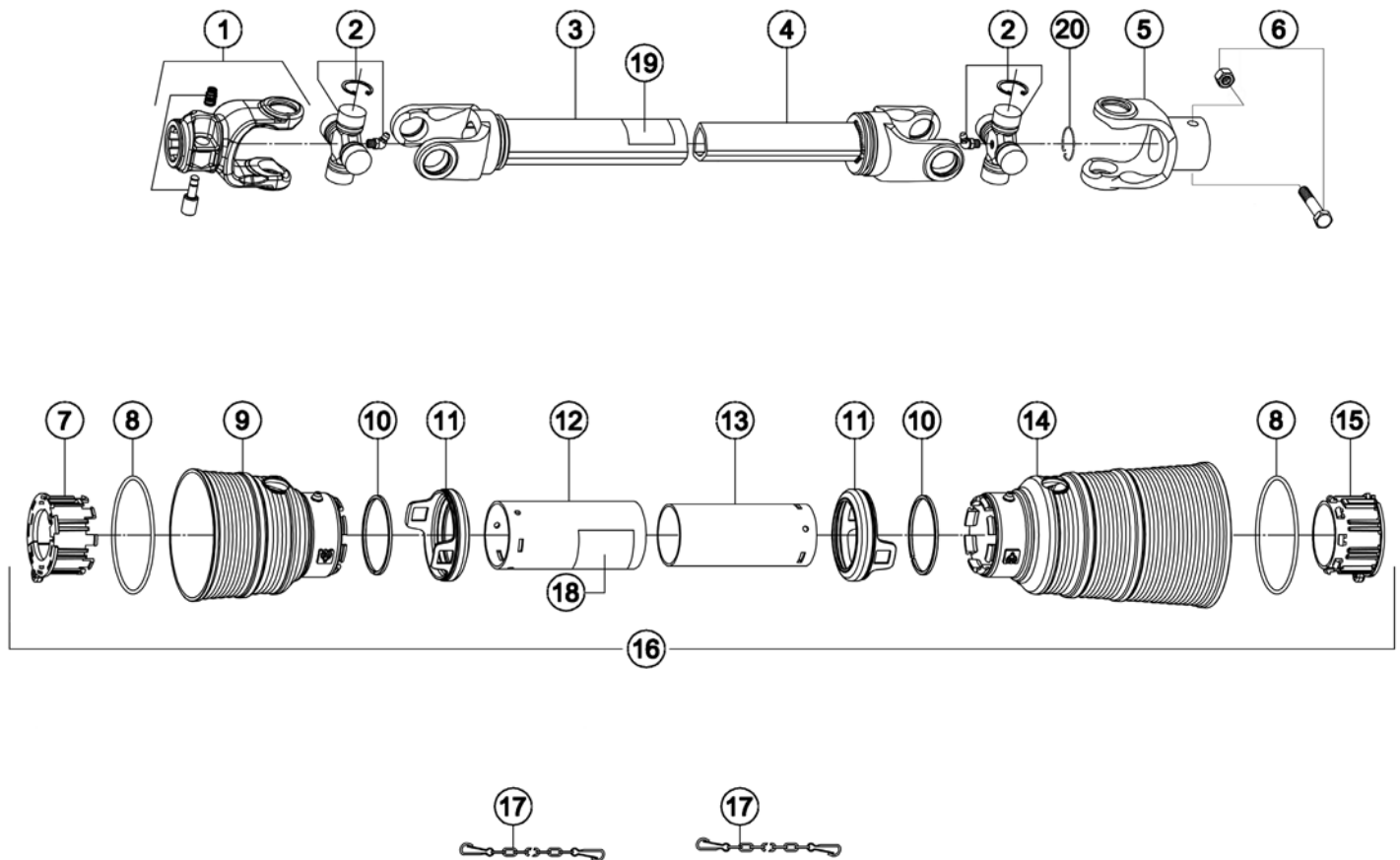

| Ref. | Part #    | Description   | Qty. |
|------|-----------|---|------|
| 1    | 1024010C  | Yoke assembly (tractor end)                                 | 1    |
| 2    | 1004020C  | Cross w/bearing   | 2    |
| 3    | 1944052NC | Outer tube w/yoke; BRC-142, 148 <sup>22</sup>               | 1    |
|      | 1944062NC | Outer tube w/yoke; BRC-160 <sup>23</sup>                    | 1    |
|      | 1944077NC | Outer tube w/yoke; BRC-172 <sup>24</sup>                    | 1    |
| 4    | 1954054NC | Inner tube w/yoke; BRC-142, 148 <sup>25</sup>               | 1    |
|      | 1954064NC | Inner tube w/yoke; BRC-160 <sup>26</sup>                    | 1    |
|      | 1954079NC | Inner tube w/yoke; BRC-172 <sup>27</sup>                    | 1    |
| 5    | 1074566C  | Yoke assembly (implement end)                               | 1    |
| 6    | 503-314B  | Bolt HH ½"-13x3.5" G2 Z P w/nut ES ½"-13                    | 1    |
| 7    | 1784710C  | Locking ring, outer tube                                    | 1    |
| 8    | 1211733C  | Stiffening ring   | 2    |
| 9    | 1781703C  | Standard cone (tractor end)                                 | 1    |
| 10   | 1211735C  | Safety ring   | 2    |
| 11   | 1881709C  | Safety sleeve   | 2    |
| 12   | 1773050C  | Shield, outer tube; BRC-142, 148                            | 1    |
|      | 1773060C  | Shield, outer tube; BRC-160                                 | 1    |
|      | 1773075C  | Shield, outer tube; BRC-172                                 | 1    |
| 13   | 1872050C  | Shield, inner tube; BRC-142, 148                            | 1    |
|      | 1872060C  | Shield, inner tube; BRC-160                                 | 1    |
|      | 1872075C  | Shield, inner tube; BRC-172                                 | 1    |
| 14   | 1781704C  | Long cone (implement end)                                   | 1    |
| 15   | 1784711C  | Locking ring, inner tube                                    | 1    |
| 16   | 96SL4050C | Shield, complete; BRC-142, 148                              | 1    |
|      | 96SL4060C | Shield, complete; BRC-160                                   | 1    |
|      | 96SL4075C | Shield, complete; BRC-172                                   | 1    |
| 17   | 1006065C  | Chain, anti-rotation  | 2    |
| 18   | 950-463B  | Decal "DANGER - Rotating driveline, keep away" outer shield | 1    |
| 19   | 950-464B  | Decal "DANGER - Guard missing, do not operate" outer tube   | 1    |
| 20   | 004-2122  | Snap ring, outer Ø35  | 1    |
|      | 050-0454  | Driveline w/shear pin, complete; BRC-142, 148 #398487-      | -    |
|      | 050-0455  | Driveline w/shear pin, complete; BRC-160 #398487-           | -    |
|      | 050-0456  | Driveline w/shear pin, complete; BRC-172 #398487-           | -    |

<sup>22</sup> Can be replaced with outer tube w/yoke 1904056NC.

<sup>23</sup> Can be replaced with outer tube w/yoke 1904066NC.

<sup>24</sup> Can be replaced with outer tube w/yoke 1904081NC.

<sup>25</sup> Can be replaced with inner tube w/yoke 1914056NC.

<sup>26</sup> Can be replaced with inner tube w/yoke 1914066NC.

<sup>27</sup> Can be replaced with inner tube w/yoke 1914081NC.

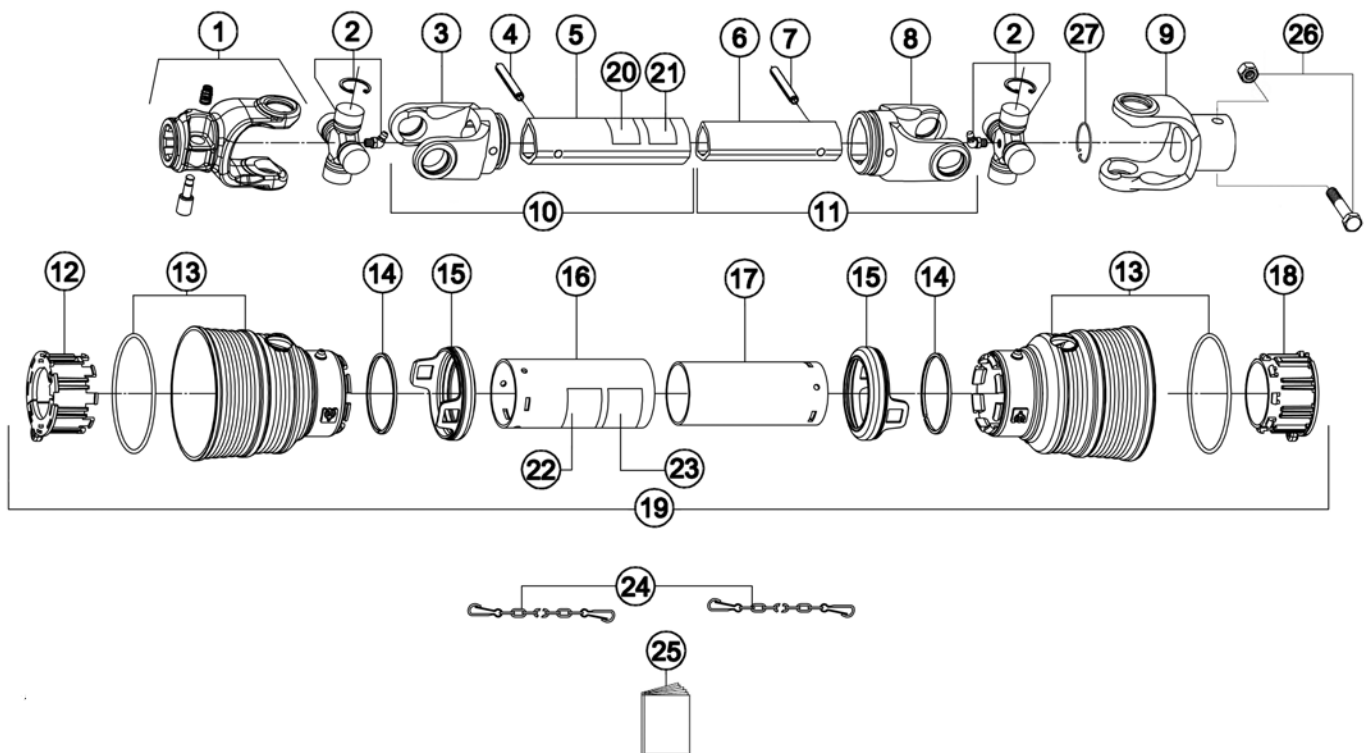

| Ref. | Part #    | Description   | Qty. |
|------|-----------|---|------|
| 1    | 1024010C  | Yoke assembly (tractor end)                                       | 1    |
| 2    | 1004020C  | Cross w/bearing   | 2    |
| 3    | 1704027C  | Yoke, outer tube; #398488+  | 1    |
| 4    | 001-8044  | Roll pin Ø8x60; #398488+  | 1    |
| 5    | 1524056C  | Outer tube; BRC-142, 148 #398488+                                 | 1    |
|      | 1524066C  | Outer tube; BRC-160 #398488+                                      | 1    |
|      | 1524081C  | Outer tube; BRC-172 #398488+                                      | 1    |
| 6    | 1525056C  | Inner tube; BRC-142, 148 #398488+                                 | 1    |
|      | 1525066C  | Inner tube; BRC-160 #398488+                                      | 1    |
|      | 1525081C  | Inner tube; BRC-172 #398488+                                      | 1    |
| 7    | 000-8679  | Roll pin Ø8x55; #398488+  | 1    |
| 8    | 1704029C  | Yoke, inner tube; #398488+  | 1    |
| 9    | 1074566C  | Yoke assembly (implement end)                                     | 1    |
| 10   | 1904056NC | Outer tube w/yoke; BRC-142, 148                                   | 1    |
|      | 1904066NC | Outer tube w/yoke; BRC-160  | 1    |
|      | 1904081NC | Outer tube w/yoke; BRC-172  | 1    |
| 11   | 1914056NC | Inner tube w/yoke; BRC-142, 148                                   | 1    |
|      | 1914066NC | Inner tube w/yoke; BRC-160  | 1    |
|      | 1914081NC | Inner tube w/yoke; BRC-172  | 1    |
| 12   | 1784710C  | Locking ring, outer tube  | 1    |
| 13   | 1881703C  | Standard cone (black)   | 2    |
| 14   | 1211735C  | Safety ring   | 2    |
| 15   | 1881709C  | Safety sleeve   | 2    |
| 16   | 1873048C  | Shield, outer tube (black); BRC-142, 148 #398488+                 | 1    |
|      | 1873058C  | Shield, outer tube (black); BRC-160 #398488+                      | 1    |
|      | 1873073C  | Shield, outer tube (black); BRC-172 #398488+                      | 1    |
| 17   | 1872048C  | Shield, inner tube; BRC-142, 148 #398488+                         | 1    |
|      | 1872058C  | Shield, inner tube; BRC-160 #398488+                              | 1    |
|      | 1872073C  | Shield, inner tube; BRC-172 #398488+                              | 1    |
| 18   | 1784711C  | Locking ring, inner tube  | 1    |
| 19   | 97SS4048C | Shield, complete (black); BRC-142, 148 #398488+                   | 1    |
|      | 97SS4058C | Shield, complete (black); BRC-160 #398488+                        | 1    |
|      | 97SS4073C | Shield, complete (black); BRC-172 #398488+                        | 1    |
| 20   | 950-464B  | Decal "DANGER - Guard missing, do not operate" outer tube         | 1    |
| 21   | 1140011C  | Decal "guard missing" pictorial - ISO standard, outer tube        | 1    |
| 22   | 950-463B  | Decal "DANGER - Rotating driveline, keep away" outer shield       | 1    |
| 23   | 1140010C  | Decal "rotating driveline" pictorial - ISO standard, outer shield | 1    |
| 24   | 1006065C  | Chain, anti-rotation  | 2    |
| 25   | 1140910AC | Operator's manual, driveline                                      | 1    |
| 26   | 503-314B  | Bolt HH ½"-13x3.5" G2 Z P w/nut ES ½"-13                          | 1    |
| 27   | 004-2122  | Snap ring, outer Ø35  | 1    |
|      | 050-0063  | Driveline w/shear pin, complete; BRC-142, 148 #398488+            | -    |
|      | 050-0064  | Driveline w/shear pin, complete; BRC-160 #398488+                 | -    |
|      | 050-0065  | Driveline w/shear pin, complete; BRC-172 #398488+                 | -    |

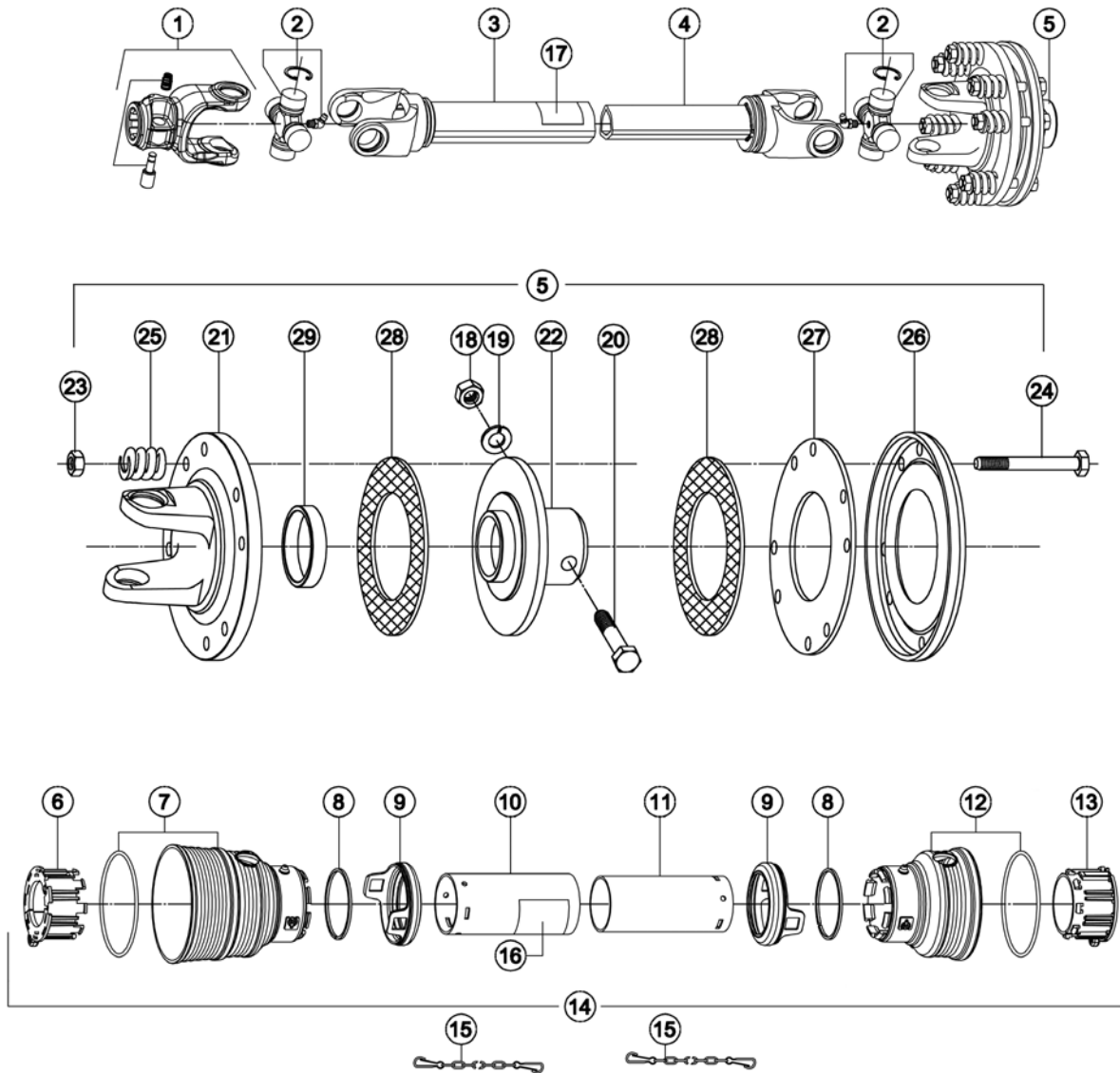

| <b>Ref.</b> | <b>Part #</b> | <b>Description</b>  | <b>Qty.</b> |
|-------------|---------------|---|-------------|
| 1           | 1024010C      | Yoke assembly (tractor end)   | 1           |
| 2           | 1004020C      | Cross w/bearing   | 2           |
| 3           | 1944072NC     | Outer tube w/yoke   | 1           |
| 4           | 1954074NC     | Inner tube w/yoke   | 1           |
| 5           | 1344011C      | Slip clutch, complete (implement end)                                 | 1           |
| 6           | 1784710C      | Locking ring, outer tube  | 1           |
| 7           | 1781703C      | Standard cone   | 1           |
| 8           | 1211735C      | Safety ring   | 2           |
| 9           | 1881709C      | Safety sleeve   | 2           |
| 10          | 1773070C      | Shield, outer tube  | 1           |
| 11          | 1872070C      | Shield, inner tube  | 1           |
| 12          | 1781702C      | Short cone  | 1           |
| 13          | 1784711C      | Locking ring, inner tube  | 1           |
| 14          | 96SC4070C     | Shield, complete  | 1           |
| 15          | 1006065C      | Chain, anti-rotation  | 2           |
| 16          | 950-463B      | Decal "DANGER - Rotating driveline, keep away" outer shield           | 1           |
| 17          | 950-464B      | Decal "DANGER - Guard missing, do not operate" outer tube             | 1           |
| 18          | 000-1075      | Nut HH M12-1.25 C6 Z TK   | 1           |
| 19          | 000-1077      | Washer lock Ø12 Z   | 1           |
| 20          | 000-5672      | Bolt HH M12-1.25x70 C8.8 Z P  | 1           |
| 21          | 1704006C      | Yoke, slip clutch   | 1           |
| 22          | 1706308C      | Hub with flange, slip clutch  | 1           |
| 23          | 003-0156      | Nut PT M10-1.50 C6 TK Z   | 8           |
| 24          | 001-9360      | Bolt HH M10-1.50x85 C8.8 Z P  | 8           |
| 25          | 1215012C      | Spring, slip clutch   | 8           |
| 26          | 1135007C      | Pressure disc, slip clutch  | 1           |
| 27          | 1135008C      | Inner disc, slip clutch   | 1           |
| 28          | 1805010C      | Friction disc, slip clutch  | 2           |
| 29          | 1705009C      | Bushing, slip clutch  | 1           |
|             | 050-0375      | Driveline w/slip clutch, complete; BRC-242, 248, 260, 272<br>#398550- | -           |

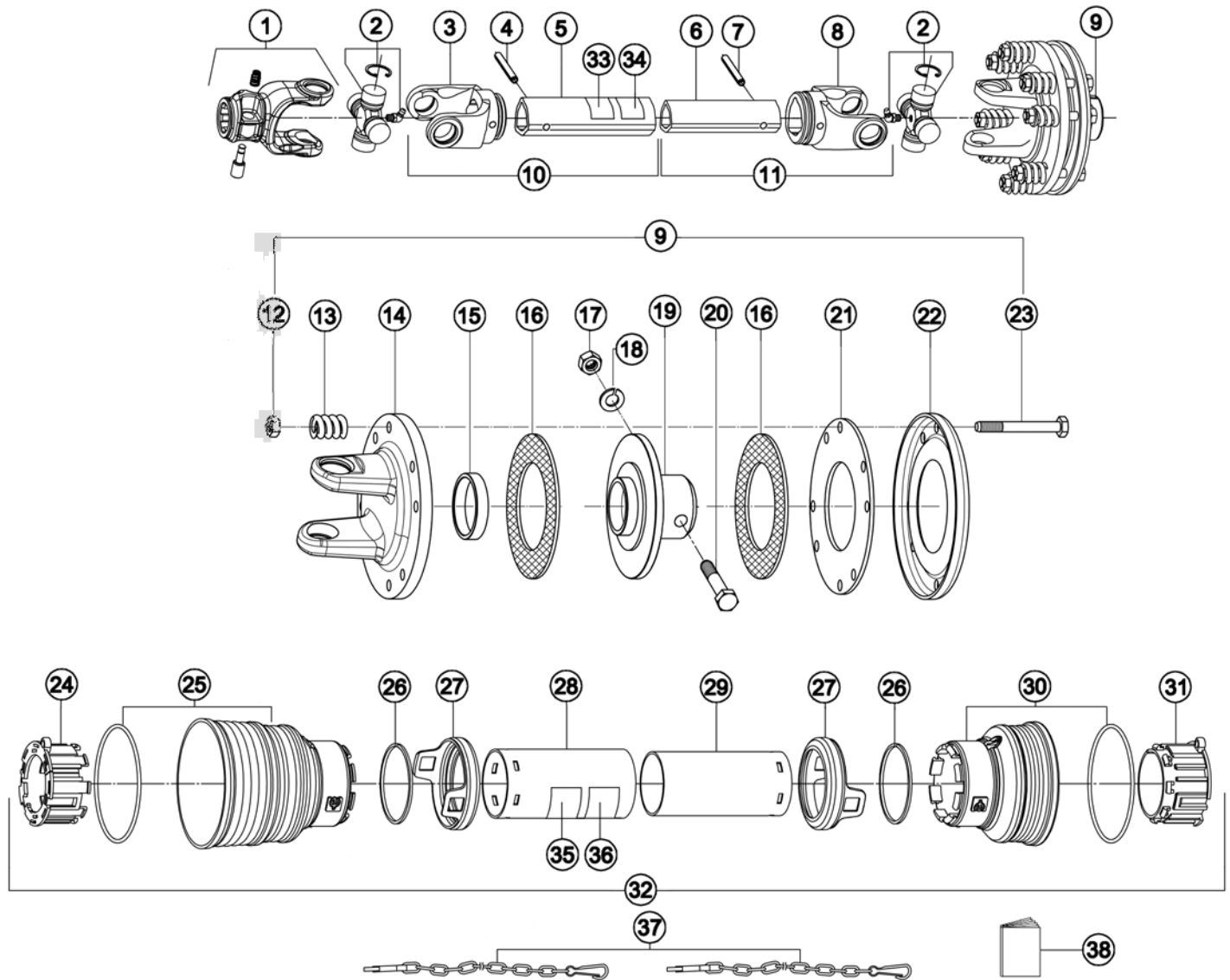



| Ref. | Part #    | Description   | Qty. |
|------|-----------|---|------|
| 1    | 1024010C  | Yoke assembly (tractor end)   | 1    |
| 2    | 1004020C  | Cross w/bearing   | 2    |
| 3    | 1704027C  | Yoke, outer tube; #398551+  | 1    |
| 4    | 001-8044  | Roll pin Ø8x60; #398551+  | 1    |
| 5    | 1524076C  | Outer tube; #398551+  | 1    |
| 6    | 1525076C  | Inner tube; #398551+  | 1    |
| 7    | 000-8679  | Roll pin Ø8x55; #398551+  | 1    |
| 8    | 1704029C  | Yoke, inner tube; #398551+  | 1    |
| 9    | 1344011C  | Slip clutch, complete (implement end)                                 | 1    |
| 10   | 1904076NC | Outer tube w/yoke   | 1    |
| 11   | 1914076NC | Inner tube w/yoke   | 1    |
| 12   | 003-0156  | Nut PT M10-1.50 C6 TK Z   | 8    |
| 13   | 1215012C  | Spring, slip clutch   | 8    |
| 14   | 1704006C  | Yoke, slip clutch   | 1    |
| 15   | 1705009C  | Bushing, slip clutch  | 1    |
| 16   | 1805010C  | Friction disc, slip clutch  | 2    |
| 17   | 000-1075  | Nut HH M12-1.25 C6 Z TK   | 1    |
| 18   | 000-1077  | Washer lock Ø12 Z   | 1    |
| 19   | 1706308C  | Hub with flange, slip clutch  | 1    |
| 20   | 000-5672  | Bolt HH M12-1.25x70 C8.8 Z P  | 1    |
| 21   | 1135008C  | Inner disc, slip clutch   | 1    |
| 22   | 1135007C  | Pressure disc, slip clutch  | 1    |
| 23   | 001-9360  | Bolt HH M10-1.50x85 C8.8 Z P  | 8    |
| 24   | 1784710C  | Locking ring, outer tube  | 1    |
| 25   | 1881703C  | Standard cone (black); #398551+                                       | 1    |
| 26   | 1211735C  | Safety ring   | 2    |
| 27   | 1881709C  | Safety sleeve   | 2    |
| 28   | 1873068C  | Shield, outer tube (black); #398551+                                  | 1    |
| 29   | 1872068C  | Shield, inner tube; #398551+  | 1    |
| 30   | 1881701C  | Extra short cone (black); #398551+                                    | 1    |
| 31   | 1784711C  | Locking ring, inner tube  | 1    |
| 32   | 97SE4068C | Shield, complete (black); #398551+                                    | 1    |
| 33   | 950-464B  | Decal "DANGER - Guard missing, do not operate" outer tube             | 1    |
| 34   | 1140011C  | Decal "guard missing" pictorial - ISO standard, outer tube            | 1    |
| 35   | 950-463B  | Decal "DANGER - Rotating driveline, keep away" outer shield           | 1    |
| 36   | 1140010C  | Decal "rotating driveline" pictorial - ISO standard, outer shield     | 1    |
| 37   | 1006065C  | Chain, anti-rotation  | 2    |
| 38   | 1140910AC | Operator's manual, driveline  | 1    |
|      | 050-0067  | Driveline w/slip clutch, complete; BRC-242, 248, 260, 272<br>#398551+ | -    |

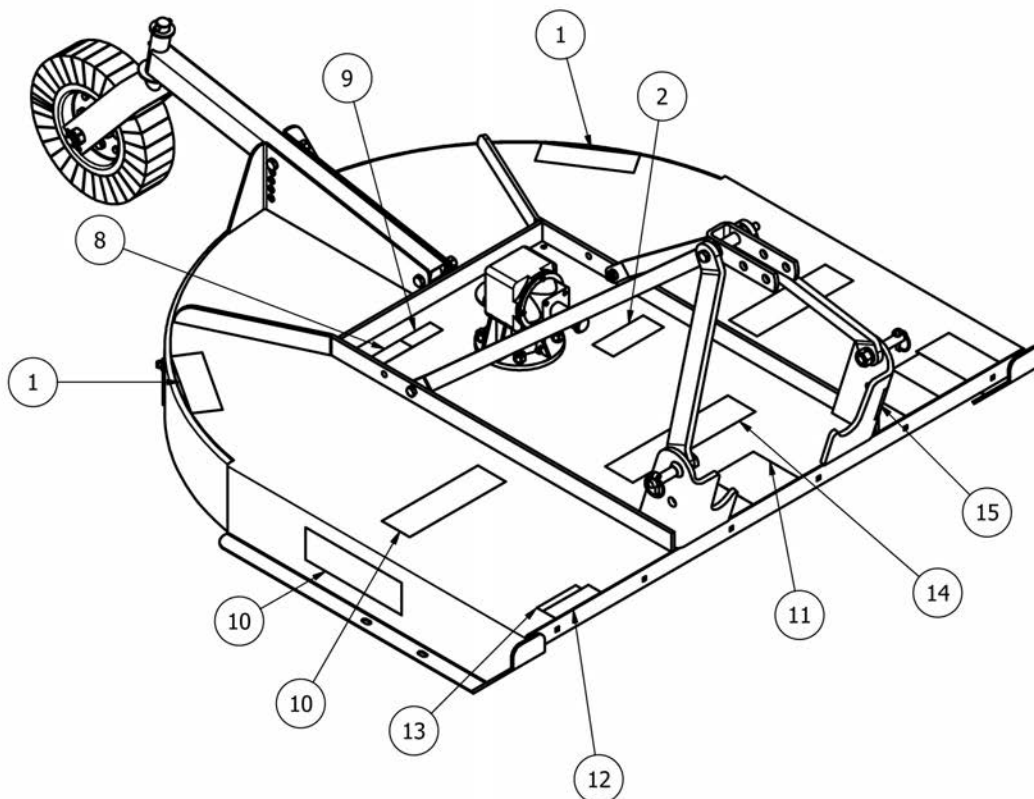
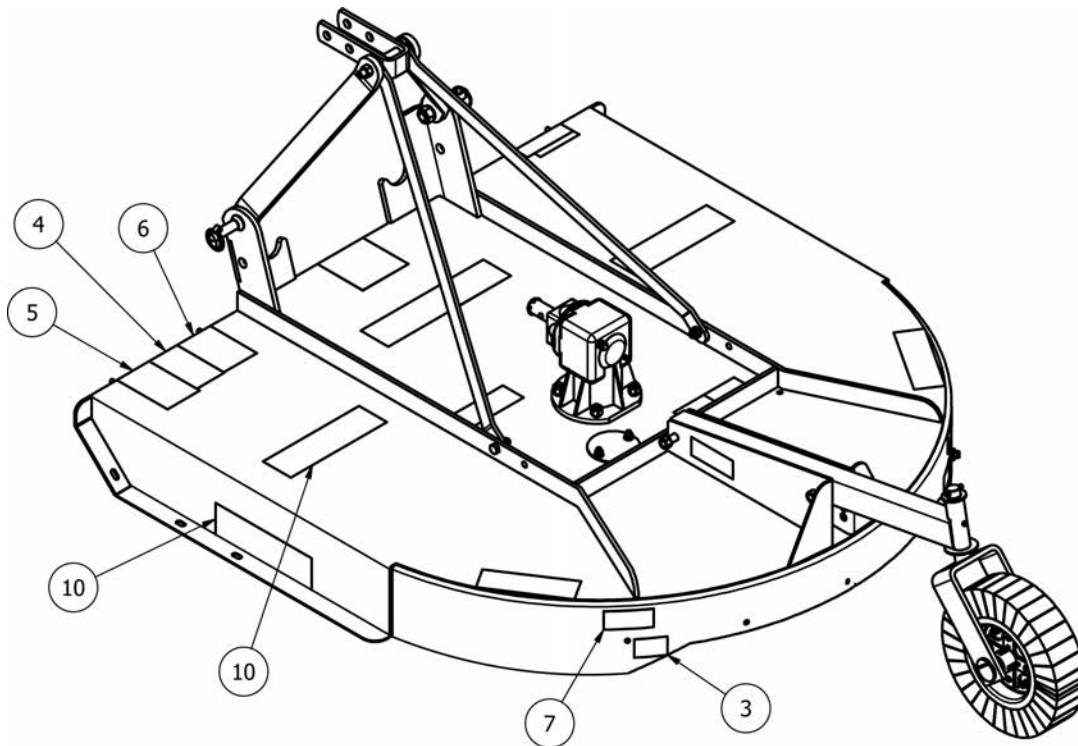

## BRC-142, 148, 160, 172, 242, 248, 260, 272

| Ref. | Part #   | Description                                      | Qty. |
|------|----------|--|------|
| 1    | 950-116B | Decal "DANGER - Rotating blades; Thrown objects" | 2    |
| 2    | 950-109B | Decal "DANGER - Avoid injury from PTO"           | 1    |
| 3    | 950-213B | Decal "DANGER - Replace shields"                 | 2    |
| 4    | 950-407B | Decal "WARNING - Crushing and pinching hazard"   | 1    |
| 5    | 950-406B | Decal "WARNING - Falling off"                    | 1    |
| 6    | 950-111B | Decal "CAUTION - To avoid serious injury"        | 1    |
| 7    | 950-366B | Decal, red reflective                            | 2    |
| 8    | 950-964B | Decal "BRC"                                      | 1    |
| 9    | 950-236B | Decal "142"                                      | 1    |
|      | 950-244B | Decal "148"                                      | 1    |
|      | 950-245B | Decal "160"                                      | 1    |
|      | 950-246B | Decal "172"                                      | 1    |
|      | 950-239B | Decal "242"                                      | 1    |
|      | 950-496B | Decal "248"                                      | 1    |
|      | 950-270B | Decal "260"                                      | 1    |
|      | 950-247B | Decal "272"                                      | 1    |
| 10   | 950-107B | Decal "BEFCO"                                    | -    |
| 11   | 950-103B | Decal "B" small; BRC-X42, X48                    | 1    |
|      | 950-104B | Decal "B" medium; BRC-X60, X72                   | 1    |
| 12   | 950-381B | Decal "BEFCO INC." address                       | 1    |
| 13   | 950-358B | Decal "Made in USA"                              | 1    |
| 14   | 950-145B | Decal "Tornado"                                  | 1    |
| 15   | 950-940B | Decal "Quick-Hitch Compatible"                   | 1    |
|      | 971-404B | Operator's & Parts Manual "Tornado BRC"          | 1    |

## Use only original spare parts

*All rights reserved. It is unlawful to copy, reprint or use any of the information or details in this manual without the expressed written permission of the Company. Technical information provided in this manual is approximate, the Company reserves the right to modify or improve the models shown for technical or commercial purposes. Pictures in this manual do not necessarily show the machine as delivered.*

---

# **BEFCO®**

P.O. Box 6036  
Rocky Mount, NC 27802-6036  
Tel.: 252.977.9920 - Fax: 252.977.9718  
[www.befco.com](http://www.befco.com)

