

Zoom Camera

ATC-HZ5230T-LCN



- 1/2.8" SONY Progressive Scan STARVIS CMOS
- 360x AF Zoom(30x optical zoom, 12x digital zoom)
- 1080p 60/50/30/25fps
- Mechanical Day&Night
- True WDR
- 3D DNR, Defog
- UART RS232-TTL(Pleco-D, Pelco C, VISCA, Hitachi)

ATC-HZ5230T-LCN



· Dimensions

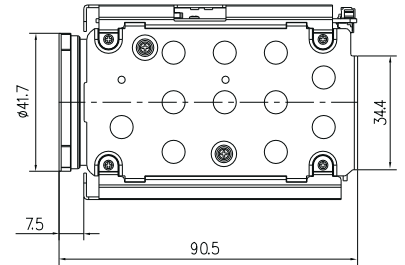
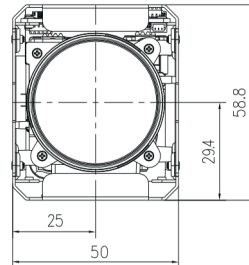

Specifications

Image Sensor	1/2.8" SONY Progressive Scan STARVIS CMOS
Effective Pixels	2.13MP 1945(H) x 1097(V)
Video Output mode	LVDS / CVBS / 9pin FFC
Max. Video Resolution	LVDS :1080p@60(50fps)
Synchronization system	Internal / External Optio n
Day mode:	0.1Lux(F1.6)
Min.Illumination	Night mode: 0.05Lux(F1.6/ IR-cut filter on)
Sens-Up	off, AGC45dB
S/N Rate	More than 55dB(AGC off, Sens-Up off)
Type	AF Optical zoom lens(DC Iris), IR Correctiv
Focal Length	f=4.3~129mm
Lens	
F-value	F1.6(W)~5.0(T)
Angle	Horizontal 58.9°(W)~2.11°(T),
of View	Vertical 45.3°(W)~1.61°(T)
Zoom ratio	Optical 30x / Digital 12x
Focus Min.	Working
Distance	0.01m(Wide)/1.0m(Tele)~∞
Focus Control	Auto/Interval/One Push/Manual/Preset
AE mode	Auto/Shutter Priority/Iris Priority/AGC Priority/Manual
Brightness	0~14
Manual Shutter	1/1, 1/2, 1/4(3), 1/8(6), 1/15(12), 1/30(25), 1/60(50)~1/10000
Manual Iris	F1.6~F32, Close
Sense-up	Off~32fields
ETC	Spot AE, Slow AE
D&N Mode	Auto/Day(Color)/Night(BW)/External-H or L
White Balance	AUTO/One Push/Indoor/Outdoor/ATW/Manual
Image Freeze	Off/On
Image Flip	Off/Horizontal/Vertical/H+V(180°Flip)
Privacy Mask	Zone8 Zones/14 mask color selectable
Digital Image Stabilization	Yes
Motion Detection	4 Zones

D-WDR	Off/Low/Middle/High
WDR	Off/On, Adjustable(Level:0~29, Contrast:0~5,Bright:0~19)
BLC	Off/On, Area selectable
HLC	Off/On, Area selectable
AGC	Max.72dB
Sharpness	Adjustable(0~15)
3D-DNR	Off/Auto/Low/Middle/High
2D-DNR	Off/Auto/Low/Middle/High
D fog	Off/On/Auto
Preset Position	256 position Presets(Zoom,Focus), 16Memory Presets, Custom Preset
Language	English
Remote	RS232 TTL + 5.0V(+3.3V compatible)
UART	ProtocolVISCA/Pelco-D/Pelco-P/Hitachi: Automatic detection
Baud rate	2400/4800/9600/19200/38400/57600/115200bps
UTC	-
Supply Voltage	12VDC(9V to 15VDC)
Power Consumption	Max.6.4W / Non-working zoom&focus 3.8W
Dimension	(mm) 50x58.8x90.5mm
Weight	Approx.232g
Operating Temperature	-10°C~+50°C, Humidity(20~80%)
Storage Temperature	-20°C~+60°C, Humidity(20~95%)