

STYLE # SNR

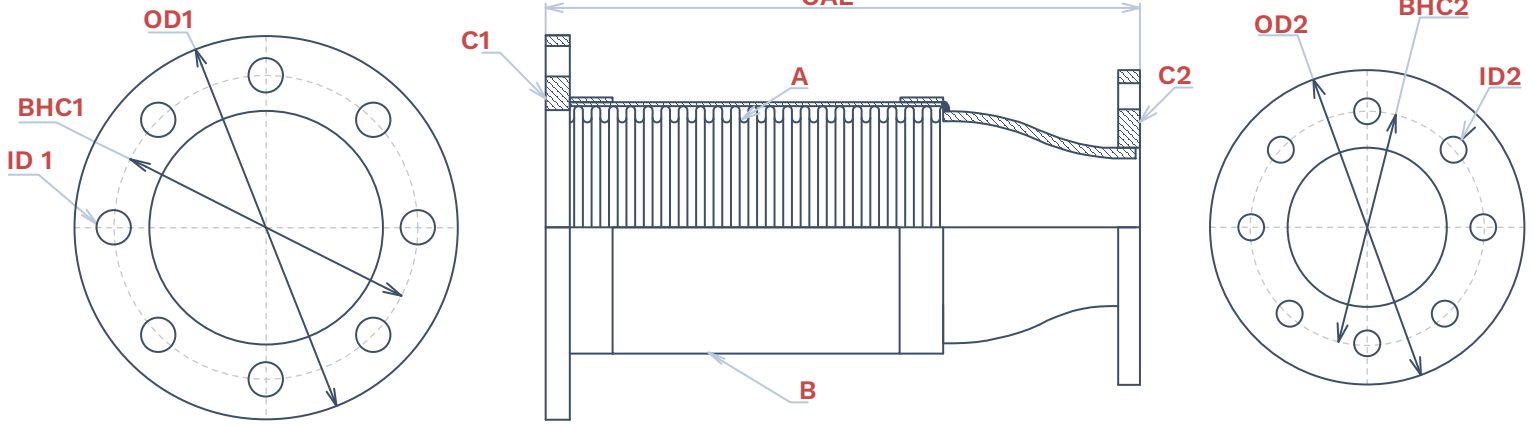

DESIGN

Special Notes:

- A) Tube 321 Stainless Steel
- B) Braid 304 Stainless Steel
- C) Ends: Carbon Steel ANSI 150
- D) Ends: 750 Degrees F
- Temp:
- Axial: 0.0"
- Lateral: 0.125"

Global Flex Mfg.

GFM Part Number	Size Inches	Over All Length	Flange OD		Bolt Hole Center		No Bolt Hole		Hole Size		WORKING PRESSURE		Weight
									AT 70F	AT 250F			
SNR-250200	2-1/2"X2"	13.0"	7.0"	6.0"	5.50"	4.75"	4	4	0.75"	0.75"	442	390	15.0
SNR-300200	3"X2"	13.0"	7.5"	6.0"	6.00"	4.75"	4	4	0.75"	0.75"	310	286	16.25
SNR-400200	4"X2"	13.0"	9.0"	6.0"	7.50"	4.75"	8	4	0.75"	0.75"	250	230	22.0
SNR-400250	4"X2-1/2"	13.0"	9.0"	7.0"	7.50"	5.50"	8	4	0.75"	0.75"	250	230	23.0
SNR-400300	4"X3"	13.0"	9.0"	7.5"	7.50"	6.00"	8	4	0.75"	0.75"	250	230	24.0
SNR-500250	5"X2-1/2"	16.0"	10.0"	7.0"	8.50"	4.75"	8	4	0.875"	0.75"	185	170	29.0
SNR-500300	5"X3"	16.0"	10.0"	7.5"	8.50"	6.00"	8	4	0.875"	0.75"	185	170	31.5
SNR-500400	5"X4"	16.0"	10.0"	9.0"	8.50"	7.50"	8	8	0.875"	0.75"	185	170	32.5
SNR-600300	6"X3"	17.0"	11.0"	7.5"	9.50"	6.00"	8	4	0.875"	0.75"	165	151	33.0
SNR-600400	6"X4"	17.0"	11.0"	9.0"	9.50"	7.50"	8	8	0.875"	0.75"	165	151	32.0
SNR-600500	6"X5"	17.0"	11.0"	10.0"	9.50"	8.50"	8	8	0.875"	0.875"	165	151	35.0
SNR-800400	8"X4"	18.0"	13.5"	9.0"	11.75"	7.50"	8	8	0.875"	0.75"	175	161	39.0
SNR-800500	8"X5"	18.0"	13.5"	10.0"	11.75"	8.50"	8	8	0.875"	0.875"	175	161	41.0
SNR-800600	8"X6"	18.0"	13.5"	11.0"	11.75"	9.50"	8	8	0.875"	0.875"	175	161	42.0
SNR-1000600	10"X6"	18.0"	16.0"	11.0"	14.25"	9.50"	12	8	1.00"	0.875"	175	161	49.0
SNR-1000800	10"X8"	18.0"	16.0"	13.5"	14.25"	11.75"	12	8	1.00"	0.875"	175	161	51.0
SNR-1200100	12"X10"	20.0"	19.0"	18.0"	17.00"	14.25"	12	12	1.00"	1.00"	160	147	65.0