

DRAGONFLY



WARNING

READ THIS DRIVER'S MANUAL. IT CONTAINS IMPORTANT SAFETY INFORMATION. KEEP FOR FUTURE REFERENCE.



ELECTRIC ADVENTURE VEHICLE
DRIVER'S MANUAL



D-FLY

D-FLY GLOBAL LTD

DRIVER'S MANUAL

WARNING

RISK OF DEATH OR SERIOUS INJURY You must read every single part of this Driver's Manual before driving, to ensure you are able to drive safely. Whenever you drive a Dragonfly, you risk death or serious injury from a loss of control, collisions and falls.

This Driver's Manual contains important information relating to the proper use, adjustment and maintenance of your Dragonfly. You are responsible for reading this document in its entirety and ensuring that all drivers of this Dragonfly are fully informed on all safety instructions, precautions and warnings and have the information to do so safely and responsibly. Proper maintenance of the Dragonfly will also ensure the safety of the driver and longevity of your vehicle.

Failure to follow these instructions can lead to an improper use of the Dragonfly, and the faster deterioration of certain components which may lead to an accident.

Your Dragonfly should only be used with the charger, battery and power cords supplied. Refer to the Battery and Charger section (4.5) for instructions on how to operate the battery and charger.

BEFORE DRIVING: MAKE ALL NECESSARY PREPARATIONS.

- Wear personal protective equipment, including helmet and body protection.
- Fully charge your battery.
- Inflate your tires and making sure your tires are in good condition. The recommended max tire pressure is 50PSI (2.7 bar - 3.4 bar).
- Make your roll spring, shock spring and brake adjustments. Get familiar with these adjustments as they are key to performance.
- Ensure all connection elements (such as the folding system) are correctly tightened and not broken.
- Check that your brakes function effectively.
- Confirm that you have not exceeded the maximum permissible weight (264lbs / 120kg) of the user and cargo.
- Check that your lights and reflective equipment are fully functional and visible.
- Check any safety components such as your horn and turn signals are fully functional.

 READ THE DRIVER'S MANUAL IN FULL BEFORE DRIVING.

IMPORTANT NOTES AND DISCLAIMERS

- Read this driver's manual in full and return it to your vehicle accessory case for future reference.
- Keep the original Dragonfly packaging. As stated in our Return Policy section (8.3), the original packaging will be needed in the event of a warranty claim or return. If the Dragonfly is returned in alternative packaging and the product is damaged as a result, the warranty will be void.
- By using the Dragonfly, you acknowledge that you are responsible for any loss, injury or damage caused by not following the above instructions and that negligence while driving the Dragonfly will automatically lead to your warranty being void.



WARNING

Pay close attention to safety messages contained in this manual. This information alerts you to potential hazards that could hurt you or others. Incorrect assembly, maintenance, or use of your Dragonfly can cause component or performance failure, or injury or death.

This publication includes the latest product information. Please visit the D-Fly website at d-fly.com for the latest user manual and instructions. D-Fly reserves the right to make changes at any time without notice and without incurring any obligation. This manual should be considered a permanent part of the scooter and should remain with the scooter when it is resold. No part of this publication may be reproduced without written consent.



CONTACT INFORMATION

Regardless of the problem, we're here to help! Get in touch via:

WEBSITE

www.d-fly.com

HELPLINES

USA (+1) 213 376 5572

UK (+44) 204 586 0484

EMAIL

hello@d-fly.com



CONGRATULATIONS

You are the proud owner of a Dragonfly, an electric adventure vehicle that combines the full-body engagement of snowboarding, kite surfing and skateboarding with the steering, responsiveness and stability of a performance sports car all into one. The more you push it, the more fun you have.

Designed with performance in mind, built on cutting edge technology, using the highest quality materials. The unique Dragonfly 3D full-tilt steering system draws inspiration from the racetrack – but goes so much further. It combines four-wheel steering with dual independent hydraulic-damped suspension to give you a physical and emotional drive like no other.

As a Dragonfly owner, you are part of a forward-thinking community that is adopting technology to help move towards an emission-free future. **Lean in** and enjoy driving your Dragonfly. It's electrifying!

THE **D-FLY** TEAM

PRODUCT OVERVIEW

DF

Weight: 79lbs / 36kgs

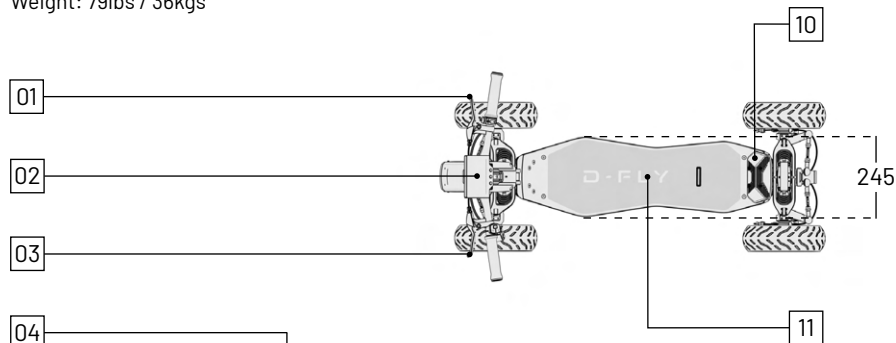

01. Right Front Brake Lever
02. Display
03. Left Rear Brake Lever
04. Mode Selection
05. Accelerator
06. Headlight
07. Battery Lock
08. Battery
09. Motors
10. Rear Light
11. Deck
12. Lights, Horn and Turn Signals
13. Offset
14. Tiller
15. Folding Mechanism

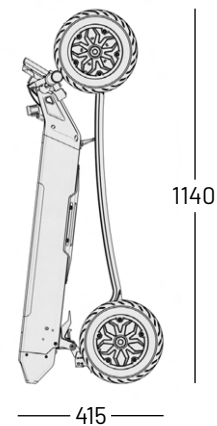
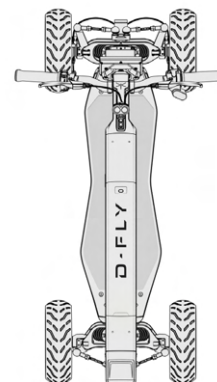
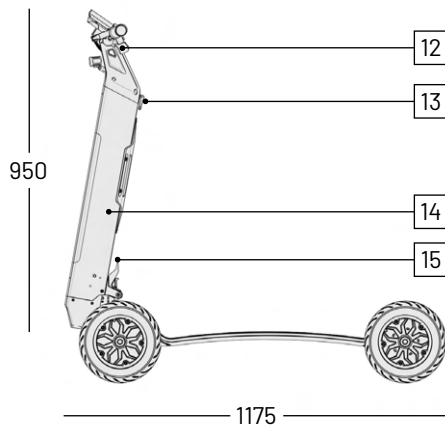
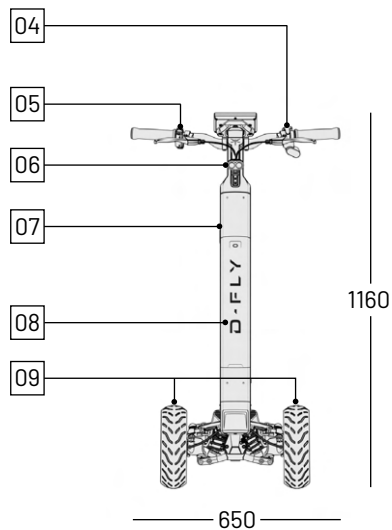

DFX

Weight: 81lbs / 37kgs

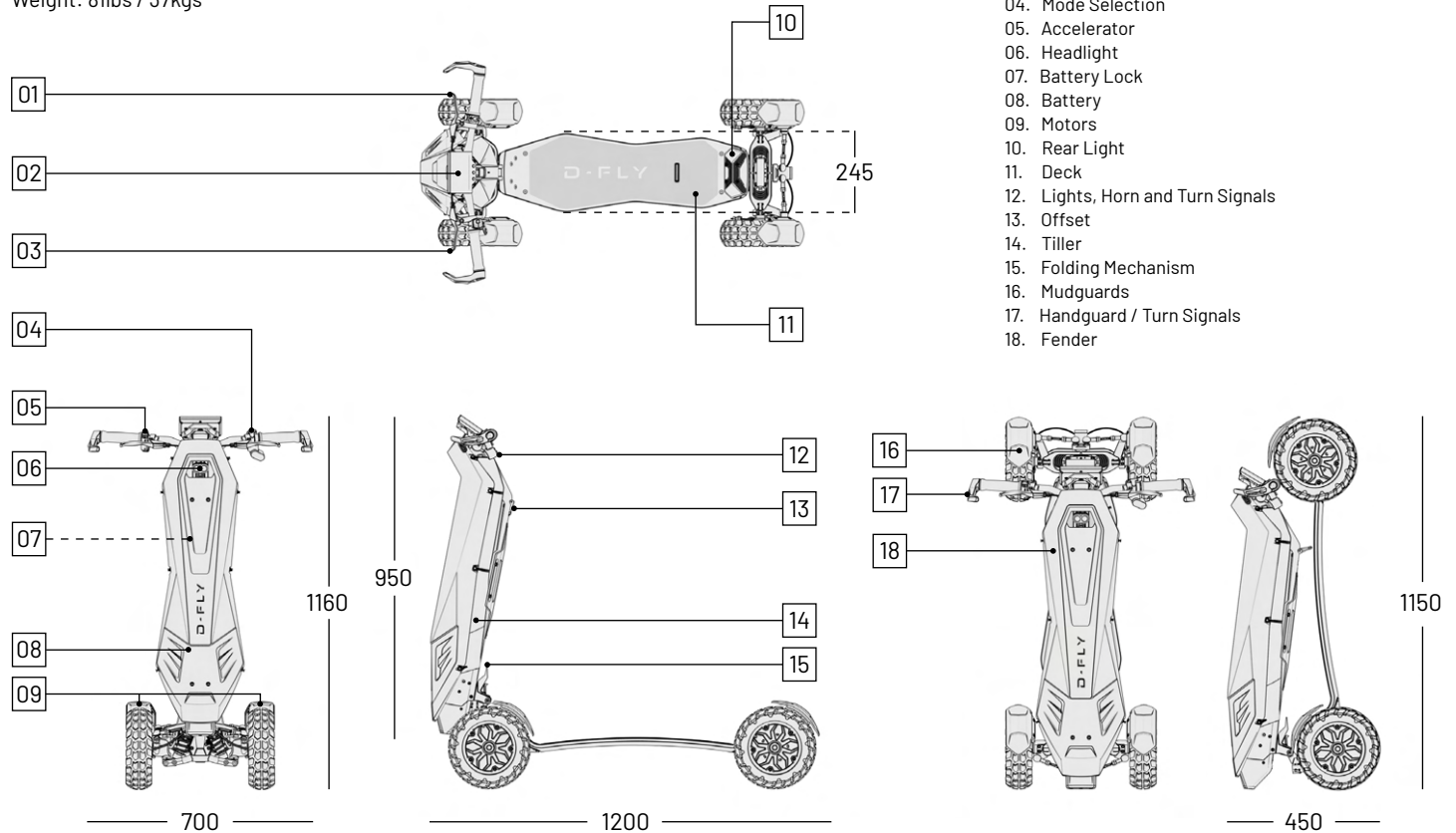

- 01. Right Front Brake Lever
- 02. Display
- 03. Left Rear Brake Lever
- 04. Mode Selection
- 05. Accelerator
- 06. Headlight
- 07. Battery Lock
- 08. Battery
- 09. Motors
- 10. Rear Light
- 11. Deck
- 12. Lights, Horn and Turn Signals
- 13. Offset
- 14. Tiller
- 15. Folding Mechanism
- 16. Mudguards
- 17. Handguard / Turn Signals
- 18. Fender

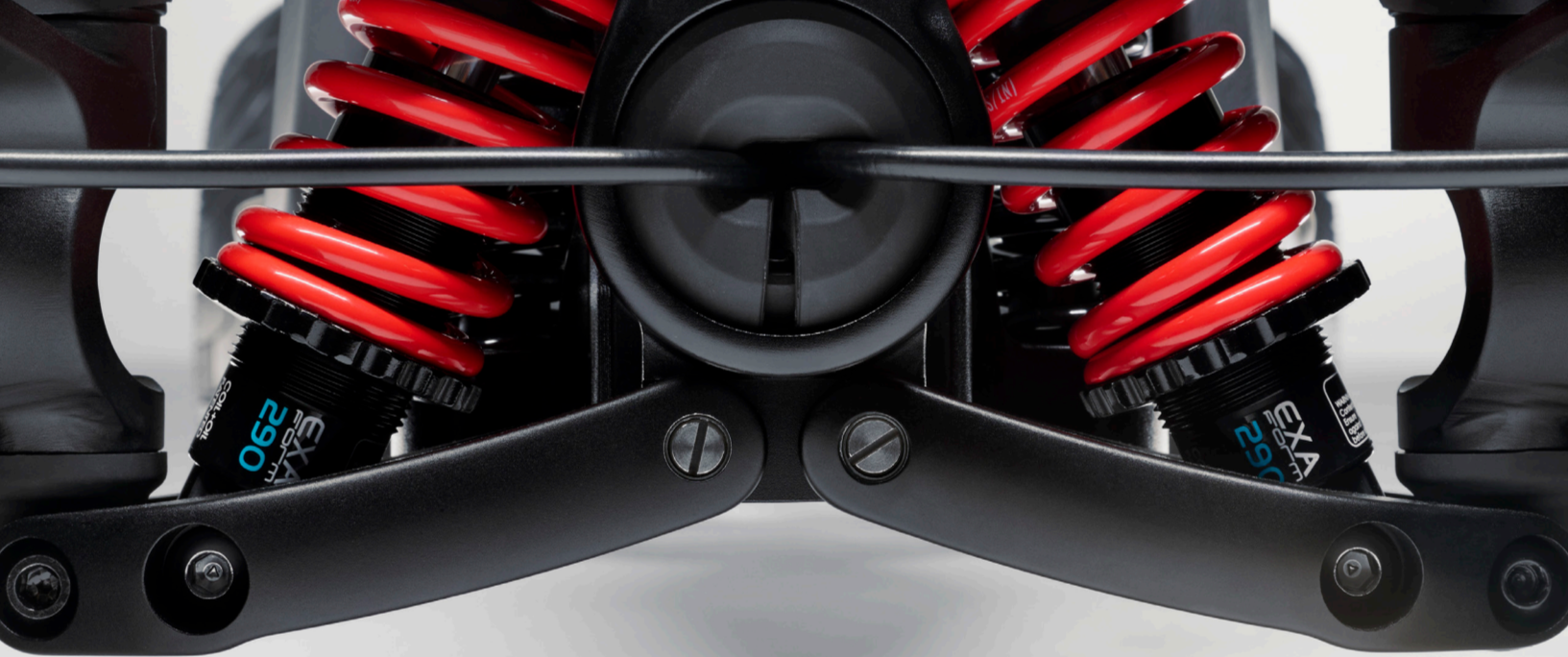

The Dragonfly vehicles are covered by the following patent applications:

**GB2590370, UAP6001100/2022, AU2020399185, CA3,161,343, CN2020800960584,
EP20828821.7, JP2022-535622, KR10-2022-7023473, MYPI2022003036, NZ789896,
SA522432926, SG11202250304K, US17/784,540.**

The Dragonfly vehicles are covered by the following registered designs:

GB6078614, DM/208 654, US35/510,860, US29/837,158, US29/836,403. GB6078610, GB6078612.

Patents available at www.d-fly.com/patents

TABLE OF CONTENTS

1 QUICK START GUIDE	10		
2 UNBOXING	12		
2.1 Your Dragonfly	12		
2.2 Inside Your Dragonfly Box	12		
2.3 Unpacking	12		
2.4 Serial Number	13		
2.5 Liability Disclaimer	13		
2.6 Driver's Manual Updates	13		
3 SAFETY	14		
4 MEET YOUR DRAGONFLY	18		
4.1 Reflective Sticker Positioning	18		
4.2 Unfolding and Folding Your Dragonfly	18		
4.3 Inflating Your Tires	19		
4.4 Dragonfly Specifications	20		
4.5 Battery and Charger	22		
4.5.1 First Time Charging	22		
4.5.2 Inserting Your Battery	22		
4.5.3 On-Vehicle Charging	22		
4.5.4 Removing Your Battery to Charge	22		
4.5.5 Lithium-Ion Battery Maintenance	23		
4.5.6 D-Fly Battery Specifications	23		
4.6 Maximizing Your Dragonfly's Range	24		
4.7 Your Digital Dashboard (HMI)	26		
4.8 Dragonfly App	49		
4.9 Phone Mount Adapter	49		
5 DRIVING	50		
5.1 Unlocking	50		
5.1.1 Alarm	50		
5.2 Getting On	50		
5.3 Driving	51		
5.4 Driving Modes	51		
5.5 Accelerating	52		
5.6 Braking	52		
5.6.1 Mechanical Parking Brake	52		
5.6.2 E-Parking (P) Brake	52		
5.6.3 Hill Starts	53		
5.6.3.1 Parking	53		
5.6.3.2 Starting	53		
5.7 Adjusting your Dragonfly	53		
5.7.1 Your Toolkit	53		
5.7.2 Roll Spring Adjustment / Deck Tilt	54		
5.7.3 Shock Spring Adjustment	54		
5.7.4 Light Adjustment	54		
5.7.5 Brake Adjustment	55		
5.7.6 Tire and Tube Replacement	55		
6 MAINTENANCE	56		
6.1 Storage	56		
6.2 Cleaning	56		
6.3 Repair	56		
6.4 Spare Parts	56		
6.5 Maintenance Reminders	56		
7 TROUBLESHOOT AND FAQs	57		
7.1 Troubleshoot	57		
7.2 FAQs	58		
8 WARRANTY	60		
8.1 Terms	60		
8.2 Claims	60		
8.3 Return and Refund Policy	60		
9 D-FLY GROUP DISCLAIMER	62		
10 DRIVER'S OBLIGATIONS	62		
11 DECLARATION OF CONFORMITY	68		

1 QUICK START GUIDE

STEP 1

⚠️ **Safety First** ⚠️ **Read the Driver's Manual in full!**

STEP 2

Follow the unboxing protocol in the manual!

It's simple and shows you how to safely unpack your new Dragonfly. The hard copy manual can be found in the zip pocket of the accessory case.

STEP 3

Remove the battery from its packaging. Place it on charge for a minimum of 12 hours. This first time maximum charge is important! Failure to fully charge your battery for the first time could invalidate your warranty.

See section 4.5.1 of your Driver's Manual.

STEP 4

If you didn't follow step 1, please read the manual in full!

It's important and this will give you all the detailed knowledge for both driving and safely setting up the vehicle **safely**.

STEP 5

After 12 hours of charging, load your battery into your vehicle as per the manual instructions.

See section 4.5.2 of your Driver's Manual.

STEP 6

If applicable, fit your accessories following the instructions provided in the Accessories Installation Manual.

See www.d-fly.com/manuals or scan the QR Code below.



STEP 7

Watch the 'How to Drive' videos on our youtube channel.

See www.youtube.com/@d-flygroup



2 UNBOXING

2.1 YOUR DRAGONFLY

Thank you for purchasing your new Dragonfly. Use great caution when unpacking.

- Handle all components carefully!
- Keep fingers away from any folding or unfolding parts.
- Pay attention when cutting open the box that you do not accidentally cut any electrical cables, cutting through cables will void your warranty.
- Check all components and make sure there are no signs of damage. If you notice any damage to the box or components, please take a photo and contact Customer Service immediately.
- Keep the original Dragonfly packaging. As stated in our Return Policy section (8.3), the original packaging will be needed in the event of a warranty claim or return. If the Dragonfly is returned in alternative packaging and the product is damaged as a result, the warranty will be void.

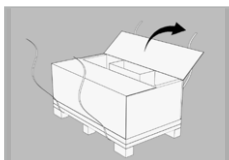

1. Please take care opening the lid.

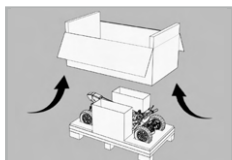

2. Lift and remove the outer sleeve and two end panels.

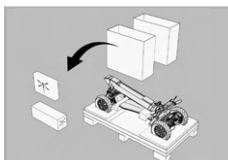

3. Remove the side boxes. Your Battery and D-FLY accessory case are in these.

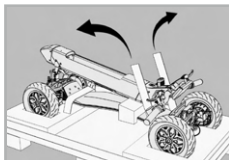

4. With your vehicle exposed release the two retaining straps from the deck.

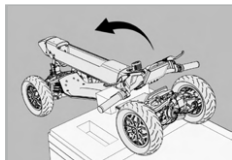

5. Using the rear lift handle, carefully lift and roll out of the base packaging.

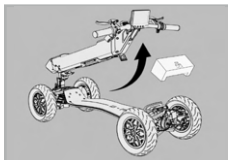

6. Remove the tiller strap and remove the foam spacer and any other protection.

⚠ READ THIS MANUAL IN FULL BEFORE DRIVING.

⚠ FULLY CHARGE YOUR DRAGONFLY BEFORE DRIVING

⚠ KEEP ANY PLASTIC PACKAGING AWAY FROM CHILDREN AND BABIES TO AVOID SUFFOCATION.

Your Dragonfly should only be handled by an adult. Please keep the box and its contents away from children under the age of 36 months; there are small components in the box and there could be a danger of suffocation if children come into contact with them. Please check your Dragonfly for any defects before first using it. Please keep all packaging when unboxing and assembling your vehicle.

2.2 INSIDE YOUR DRAGONFLY BOX

Inside the box you will find:

- Accessory Case
- Battery
- Your Dragonfly
- Any other vehicle accessories ordered.

In the accessory case, you will find:

- Charger
- Power Cord
- Tool Roll*
- Alarm Fobs
- Key
- Phone Mount Adaptor
- Founder's Note
- Ownership Card
- Bungee Cord
- Reflective Stickers

*See section 4.7 for a full breakdown of your tool roll.

If you have ordered any additional accessories, you will also receive them in the same box. If any of these items are missing when you open the box, contact Customer Service.

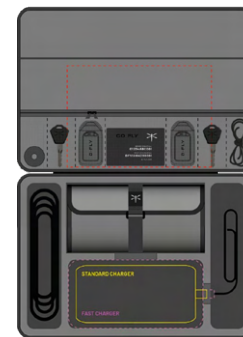

2.3 SERIAL NUMBER

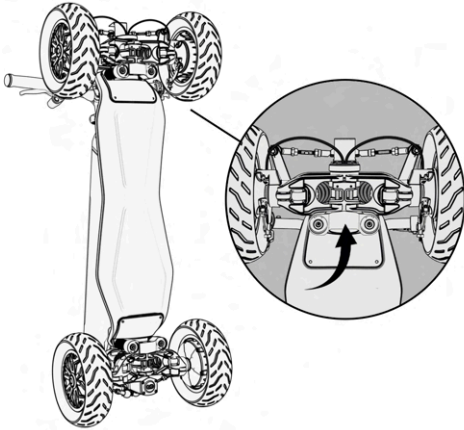

Before driving your new Dragonfly, record your unique vehicle serial number which is engraved on the underside of your deck. We recommend you take a picture of it and save that information somewhere safe. If you write the number down, store this information in a secure location, apart from your vehicle storage location. Your serial number identifies your unique product and order replacements. This number will also support warranty claims, insurance claims (in the event of loss, theft, damage incurred) and asset tracking.

⚠ Serial number ownership cannot be transferred, and warranty is null and void if you sell your Dragonfly.

2.4 LIABILITY DISCLAIMER

D-Fly Group Ltd, D-Fly USA Inc and all other D-Fly companies (“DFly Group”) are not liable for damages incurred, loss, injuries, fees, claims or legal disputes of any description that result due to the disregard of the information featured in this driver’s manual, or the disregard of any applicable federal, state or local laws.

The user assumes all risks associated with the use of the Dragonfly, including but not limited to the risk of accidents, personal injury, and property damage. D-Fly Group, the manufacturer and distributor of the Dragonfly and its components shall not be liable for any damages arising from the use or inability to use the Dragonfly.

The user is solely responsible for the proper and safe operation of the Dragonfly, and for complying with all relevant laws, regulations, and ordinances. The user must carefully read and understand the Dragonfly driver’s manual before operating it.

This liability disclaimer shall be governed by and construed in accordance with the laws of each country the Dragonfly is sold into, and any legal action arising from or related to the Dragonfly, or this liability disclaimer shall be brought in the courts of the country and/or state. If any provision of this liability disclaimer is found to be invalid or unenforceable, that provision shall be enforced to the maximum extent possible, and the remaining provisions shall remain in full force and effect.

By using the Dragonfly, the user acknowledges and agrees to the terms of this liability disclaimer.

2.5 DRIVER’S MANUAL UPDATES

Our Driver’s Manual will help you better understand your Dragonfly and how to best use it. This Driver’s Manual is subject to updates. Always ensure you have the latest version by checking with the current manual available for download on our website www.d-fly.com/manuals or by scanning the QR below.



3 SAFETY

SAFETY PRECAUTIONS

⚠ IMPORTANT! READ CAREFULLY AND KEEP FOR FUTURE REFERENCE.

It is critical that you familiarize yourself with your Dragonfly's operating limits and performance specifications provided in this manual. These limits have been provided to maximize driver safety and minimize the risk of damaging your vehicle. Your Dragonfly's longevity is contingent on your careful observation of these limits.



AVOID DRIVING ON WATER OR WET SURFACES

Always drive your vehicle on clean, dry and flat surfaces. Your Dragonfly should not be driven over any potholes or road imperfections. We do not recommend you drive on wet surfaces, however, if you are driving on wet surfaces, brake earlier for a longer stopping distance.

⚠ Always gently apply your back (left) brake first.



NEVER IMMERSE YOUR DRAGONFLY IN WATER

Do not let water come into contact with your vehicle's electrical components, as excessive exposure to water poses a serious risk of fire, shock, or malfunction. This can lead to injury and fatality.



WATCH OUT FOR OVERHEAD OBSTACLES

Remember – you are higher from the ground when standing on your Dragonfly. And always wear a certified helmet.



BEWARE OF SPINNING, MOVING & FOLDING PARTS

Any loose article of clothing or personal accessory, body parts, or hair can get caught in your Dragonfly's spinning, moving and folding parts and could result in serious injury or death. Beware of any sharp edges caused by use or incurred during an accident. If you spot a sharp edge, contact Customer Service.



NO STUNTS

Jumping, drops and acrobatics are a misuse of your Dragonfly. Jumps, drops and acrobatics may result in structural or electronic damage and cause injury.



NO TANDEM DRIVING

Your Dragonfly is made for an individual adult driver. Driving with more than one person on your vehicle, especially children, is strictly prohibited.



NO CARGO

Do not carry excessive loads of carrying cargo. Only carry items appropriate for Dragonfly accessories.



WEIGHT LIMIT

A Dragonfly driver weight must not be less than 90lbs / 40 – 50KG. A driver weight below the weight limit is at a risk of an accident because they will not be able to shift sufficient weight to turn the vehicle properly.

- Do not put weight on the handlebars – your Dragonfly's unique steering system will be affected by any additional weight placed on the handlebars. This presents a high risk of an accident, injury or death.
- Increased payloads will increase braking distance and decrease the battery's performance.
- Your vehicle's maximum cargo weight is 264lbs / 120KG.

⚠ DO NOT exceed this cargo weight as it will place stress on the Dragonfly and risk damaging the product's structural integrity.



NEVER TUNE OR MODIFY THE DRAGONFLY

Never open sealed electrical components (motor, controller, battery, HMI). Do not attempt to alter your Dragonfly's performance. Any tampered components will invalidate your warranty.



ABIDE BY LOCAL REGULATIONS (LAWS)

It is your duty to abide by all applicable federal, state and local laws and regulations. Always anticipate your trajectory and speed while respecting the codes of the road, the code of the sidewalk and paying special attention for the most vulnerable



INNER CITY DRIVING

Inner city / urban environments come with many obstacles, such as curbs or steps. Do not attempt jumps over or from obstacles. It is important to anticipate and adapt your trajectory and speed to those of a pedestrian when approaching these kinds of obstacles. Always dismount your vehicle when obstacles become dangerous, due to their height, depth, shape or slippage.



BEGINNERS MUST DRIVE WITH CAUTION

If you have little or no experience driving the Dragonfly, use caution. Familiarize yourself with all the hand controls, components and your Dragonfly's performance (acceleration, braking, turning). Start driving with your vehicle in Driving Mode 1 (D1). Practice in a safe zone - avoid moving vehicles and pedestrians. Use personal protective gear, visibility equipment (both physical and vehicular) and make sure your horn works properly.



BRAKING PRECAUTION

Do not drive until you are familiar with your Dragonfly's braking systems. Your vehicle is equipped with an electric front braking system operated by the right lever and a mechanical drum rear braking system operated by the left lever. Test the braking mechanisms by kick-pushing your vehicle and applying the brakes.

⚠ Always gently apply your back (left) brake first.

Using the front brakes first puts you at risk of shifting your weight forward and toppling over the handlebars. Use your back brake (left lever) first then feather (apply light amounts of pressure in quick succession) to your front brake (right lever) until both brake levers are fully pressed and you are at a complete stop.

⚠ Avoid sudden braking.

Always anticipate braking ahead of any obstacle. Always keep your weight evenly distributed on your Dragonfly, especially when braking to avoid falling forward.



UPHILL DRIVING

Do not exceed the rated slope of 25% incline for your vehicle. Exceeding it could cause overheating, and lead to mechanical and/or electronic damage. Once the hazards and conditions of an incline have been assessed, we recommend approaching a hill with increased speed. It is normal for the vehicle to slow down as you climb the hill; the motor and battery are working harder at this point.

⚠ There is an automatic cut off point.

If you are attempting a hill which is particularly long, the automatic cut off can occur; it is the system's way of avoiding damage. If this happens, stop and turn off your Dragonfly, allow the motors to cool and then start up your vehicle again to proceed with your journey.



LIFTING YOUR DRAGONFLY

Always use the rear carrier handle when lifting your Dragonfly. Always use sound judgment and lift safely, including bending your knees when lifting heavy objects. Do not attempt to lift your vehicle if you are pregnant or suffer from any medical conditions that could be aggravated by bearing weight such as those related to joints or back injuries or weakness. Always ask for assistance if needed. Your Dragonfly is better pulled like luggage.



PHYSICAL IMPAIRMENTS

Consult your physician before driving your Dragonfly if you have any disabilities and impairments (visual, hearing, language, seizure, etc).



ALWAYS WEAR PROTECTIVE GEAR

Always wear appropriate head protection. We recommend you wear a full-face helmet, knees, elbows, hands and upper body protective gear. Always wear appropriate footwear. Make sure your footwear fits securely and does not expose your toes.



PLASTIC COVERINGS

⚠ WARNING Keep all plastic coverings and small plastic parts away from children to avoid suffocation.



MINIMUM DRIVER AGE

The Dragonfly is designed to be used and operated by adults and should not be used by anyone under the age of 18 years old.



MINIMUM DRIVER HEIGHT

The Dragonfly is designed to be used and operated by drivers with a minimum height of 150cm / 60 inches.



SPECIAL PRECAUTIONS FOR DRIVING IN LOW LIGHT / NIGHT TIME

Ensure that you are always visible, including by wearing high-visibility clothing and have your lights on when driving in low light or the night time. Before you drive, check that your front and rear lighting equipment and your horn and safety components are fully functional.



DRIVING AWARENESS IN PUBLIC AND CROWDED PLACES

Avoid high traffic areas, and crowded places. If you must drive in high traffic areas or crowded places, always drive according to local regulations, with awareness, and wearing full personal protective equipment.



BE SEEN AND BE HEARD

Notify your presence when approaching a pedestrian or cyclist when you are not seen or heard.



RESPECT PROTECTED, PRIVATE & INAPPROPRIATE LAND FOR DRIVING

If you are approaching protected or private property, or land where driving is inappropriate, please dismount your Dragonfly and walk.



BEWARE: BRAKES BECOME HOT WITH USE

When you drive your Dragonfly, your brakes will gradually heat up. Do not touch the brakes during use and always give a cooldown period of at least twice your drive duration before trying to touch the brakes.



REGULAR CHECKS

Regularly check the tightening of the various bolted elements. In particular, the wheel axles, the folding system, the steering system, the shock spring bolts, deck spring bolts, and the brake components. Always check your brakes, steering system and any key components critical for your drive before driving (lights, horn, brake levers etc).



DEFLATE TIRES BEFORE REMOVING BOLTS

Always deflate your tire(s) completely before removing the wheel bolts to change them or replace your inner tube.

⚠ As with any mechanical component, your vehicle is subject to high loads, stresses and wear over time. The various materials and components may react differently to wear or fatigue. If a component shows signs of having exceeded its life cycle, it may break suddenly, risking injuries to the user. Cracks, scratches and discoloration in the areas subject to high stresses indicate that the component has exceeded its service life and should be replaced.





4 MEET YOUR DRAGONFLY

4.1 REFLECTIVE STICKER POSITIONING

Within your accessory case you will find a set of reflective stickers. Peel and fix the reflective stickers in the locations illustrated below.

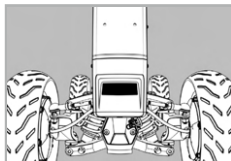

1. Tiller (front).

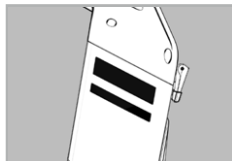

2. Tiller (side).

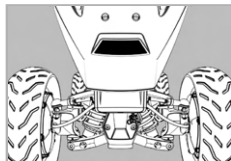

3. Fender.

4.2 UNFOLDING & FOLDING YOUR DRAGONFLY

⚠ Be careful when handling your Dragonfly.

Be mindful of your fingers when unfolding and folding your vehicle. Ensure you follow all maintenance instructions to preserve the structural integrity of your Dragonfly's folding system.

To unfold the Dragonfly:

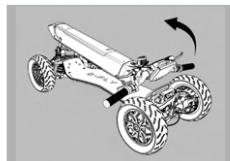

1. Your Dragonfly will arrive folded. Using the hand grips, simply separate the handlebars from the deck to unfold your vehicle.

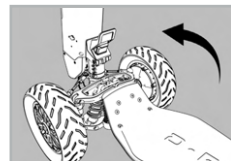

2. To lock your Dragonfly into position, hold the tiller in the upright position and use your other hand to pull up the lower latch into position until you hear the secondary safety catch click into position.

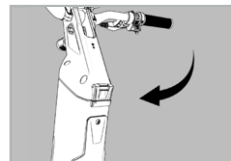

3. Close the Tiller offset.

To fold the Dragonfly:

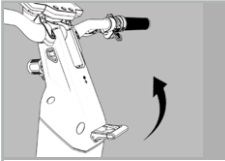

1. First, open the tiller offset. This is very important as it protects the dashboard from coming into contact with the rear wheels. Keep one hand at the top of the tiller, preferably on the handlebar.

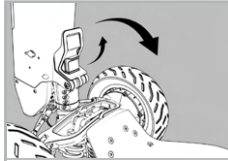

2. While steadying the tiller, use your opposite hand to lift the safety catch on the folding mechanism and pull down the lower latch.

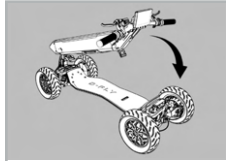

3. Slowly and carefully fold the handlebars and tiller towards the deck.

To secure your folded Dragonfly there is a bungee cord in your accessory case zip pocket:

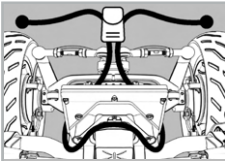

1. Carefully stand up your folded Dragonfly and loop the bungee over your HMI as shown.

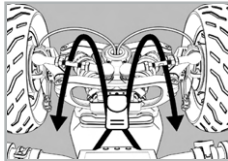

2. Stretch each bungee around the rod ends as per the image and pull tight.



3. Each bungee end can now be clipped into the small hook. You will feel a slight snap when it's clipped into place.

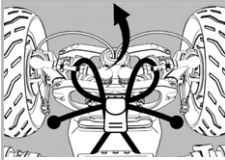

4. Press the small button on the hook to tighten if needed.

4.3 INFLATING YOUR TIRES

For safety reasons, when you first receive your Dragonfly, your tires will not be pressurized.

Before driving, you must put pressure in your tires. Follow these instructions to inflate your tires:

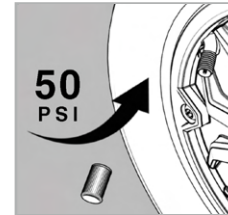

- 1.** Remove the dust cap on each valve found on the outer edge of your tires.
- 2.** In your toolkit, there is a valve extender. Find this tool.
- 3.** Screw the valve extender on to the tire valve, and plug the other end of the extender to a bike pump (or any similar pump, foot pump, electric pump etc).
- 4.** Now, pump **50PSI (3.44738 bar)** of pressure into each tire. **Do not exceed 50PSI.** Once all tires are inflated, you are set to learn how to use your Dragonfly.

⚠ WARNING Always deflate your tire(s) completely before removing the wheel bolts to change them or replace your inner tube.

4.4 DRAGONFLY SPECIFICATIONS

Brand	D-Fly
Model	DF
Lithium Battery	48 Volt 19.6 Ah
Battery Power	960WH
Motor Power	1000W (2 x 500W)
Peak Power Output	1650W
Max Speed*	25MPH or 40KMH
Max Mileage (Range)**	50 Miles or 80 Kilometers
Charging Time	7 Hours (0% to 100%)
Max Climb Capacity	25% Slope
Max Load	263lbs / 120kg
Brake Type	Front Modulated Electric (right hand) Rear Dual Drum (left hand)
Display	Smart TFT Display
Tires	10" Pneumatic Slick
Materials	Aerospace Grade Aluminum Carbon Fiber Stainless Steel
Waterproof Rating***	IPX 4
Household Voltage	110V - 240V, 50/60HZ
Extras	n/a

*For Max Speed, you must observe all local, state and federal laws. Unlock Max Speed by agreeing to the Driver's Obligations disclaimer when engaging OFF-ROAD mode (D3).

**Max Mileage (Range) is subject to driving conditions: certain variables including and not limited to weight, speed, intensity of acceleration/deceleration, topography, weather conditions, charge level etc, will affect the max range achievable.

***IPX Level 4 means the vehicle is protected from sustained exposure to low-pressure water sprays and contact. The Dragonfly cannot be fully submerged for prolonged periods of time. Use a dampened cloth and dry your vehicle after cleaning, do not use a high-pressure washer to clean the Dragonfly.



Brand	D-Fly
Model	DFX
Lithium Battery	48 Volt 19.6 Ah
Battery Power	960WH
Motor Power	1000W (2 x 500W)
Peak Power Output	1650W
Max Speed*	25MPH or 40KMH
Max Mileage (Range)**	50 Miles or 80 Kilometers
Charging Time	7 Hours (0% to 100%)
Max Climb Capacity	25% Slope
Max Load	263lbs / 120kg
Brake Type	Front Modulated Electric (right hand) Rear Dual Drum (left hand)
Display	Smart TFT Display
Tires	10" Pneumatic All-Terrain
Materials	Aerospace Grade Aluminum Carbon Fiber Stainless Steel
Waterproof Rating***	IPX 4
Household Voltage	110V - 240V, 50/60HZ
Extras	Fender and Rear Cover Mudguards x4 Handguards with turn signals

*For Max Speed, you must observe all local, state and federal laws. Unlock Max Speed by agreeing to the Driver's Obligations disclaimer when engaging OFF-ROAD mode (D3)

**Max Mileage (Range) is subject to driving conditions: certain variables including and not limited to weight, speed, intensity of acceleration/deceleration, topography, weather conditions, charge level etc, will affect the max range achievable.

***IPX Level 4 means the vehicle is protected from sustained exposure to low-pressure water sprays and contact. The Dragonfly cannot be fully submerged for prolonged periods of time.

Use a dampened cloth and dry your vehicle after cleaning, do not use a high-pressure washer to clean the Dragonfly.



4.5 BATTERY AND CHARGER

⚠️ WARNING

WHEN CONNECTED TO A POWER OUTLET should there be an abnormal state, voltage, current, temperature or short circuit, the indicator will flash red. If this occurs, disconnect the battery from the power source.

⚠️ Fully charge your Dragonfly before driving.

4.5.1 FIRST TIME CHARGING

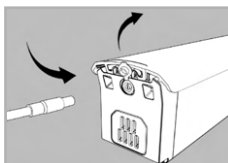

1. Remove the charger from the accessories case. Open the small battery end cap and insert the charger barrel socket cable.

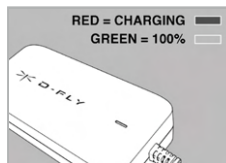

2. Connect to a power outlet and switch on the power. A red light indicator will signal the battery is being charged; this light will turn to green as the battery progressively charges.

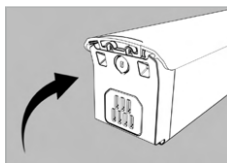

3. Close the cap once charging is complete.

4.5.2 INSERTING YOUR BATTERY

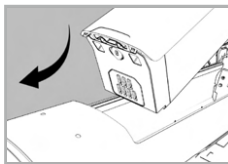

1. Once your battery is fully charged insert into the tiller. Carefully align the connector slots at the base of the battery into the cradle.

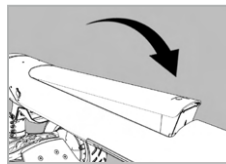

2. Push down firmly. There will be an audible connection click, the front light will flash once and there is an audible sound. This indicates the vehicle is off but NOT alarmed.

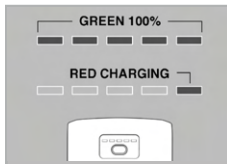

3. Press the button on the front of your battery to view its charge status.

4.5.3 ON-VEHICLE CHARGING

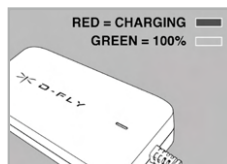

1. Open the cap and insert barrel socket cable.

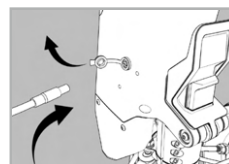

2. Connect to a power outlet and switch on power.



3. Close the cap once charging is complete.

4.5.4 REMOVING YOUR BATTERY TO CHARGE

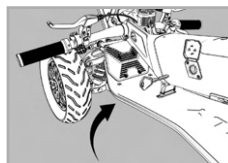

1. Place the tiller in the folded position and open the lock cover.

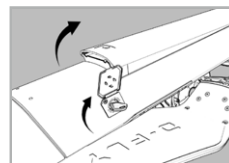

2. Using your battery or Fob key in the side lock turn clockwise 90 degrees to release the battery.

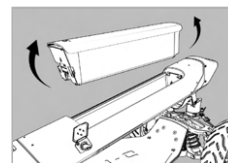

3. Using two hands lift and slide to remove the battery from its cradle. Place on a hard, flat, dry surface away from direct sunlight.

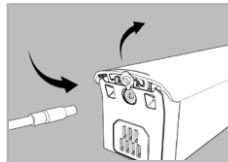

4. Open the cap, insert barrel socket cable and connect to a power outlet.

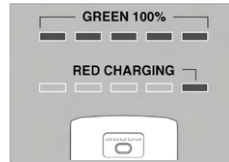

5. Switch on. A red-light indicator will signal the battery is being charged; this light will turn to green as the battery progressively charges.

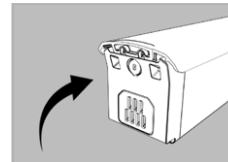

6. Close the cap once charging is complete.

4.5.5 LITHIUM-ION BATTERY MAINTENANCE

- **Always** charge your battery in a dry and clean environment, with a temperature between **0° to 45°**. **Do not** use your Dragonfly battery charger anywhere subject to high humidity, exposure to heat, flammable materials, confined spaces, near other electrical devices, or places lacking proper ventilation like a locked car.
- **Do not** let children or pets near your charger.
- **Always** turn your Dragonfly off during charging.
- **Never** leave your battery charging unattended.
- **Do not** leave your charger plugged in when it is not in use.
- Only use your Dragonfly branded charger to charge your Dragonfly battery. **Do not** use your Dragonfly charger on any other electric device, or any alternative device which could function with the use of your Dragonfly charger.
- **Do not** attempt to modify your battery or charger in any way.
- During transport, **do not** subject your battery or the box(es) to violent shaking, bumps, rain or direct sunlight.
- **Always** store your battery at a half-charged state and in a cool and dry environment, charge once every 3 months. The ideal storage temperature is **5° to 35°C**, relative humidity: **≤ 65% (+ 20% tolerance)**. The battery performance will decrease in temperatures **below -5° or above 35°C**. In the cold, the battery range and power will decrease.
- Battery performance may decrease after **500** charges.
- If you enter a warm environment after your Dragonfly was in a cold temperature, charge it for **1-2 hours**, to prevent condensation from building inside the battery unit.
- **Stop** using your charger if the charging light does not switch on when you plug your charging cable into the unit, or the battery takes an unusually long time to charge. If your charger is deficient, you will need to replace it.
- **Stop** using your battery if you drop it or at any sign of:
 - leakage
 - extreme temperature radiating from the battery (hot or cold)
 - smell (sour or any odour)
 - deformation/swelling/indentations
 - discolouring or any change from the original state
- **Do not** place your battery inside any other electrical appliance, for example, a washing machine or drying machine.
- If you notice any damage on your battery, or you experience a battery malfunction, **stop** using it and immediately contact Customer Service.

⚠ Do not spray your battery with water or immerse it in water. It is not waterproof and contact with water can damage it, or may cause a short circuit, fire, or electric shock.

⚠ D-Fly Group is not responsible for damages, accidents or any issue arising from the modification, tampering, neglect or disassembly of your Dragonfly battery charger.

You can dispose of your Dragonfly Lithium-Ion battery through a battery recycling company that can refine and reuse the non-ferrous metals in the battery. Please check our website for available disposal partners.

4.5.6 D-FLY BATTERY SPECIFICATIONS

Battery type	Lithium-ion
Charging time	7H
Volage	48V
Capacity	960WH
Capacity	19.6Ah
Discharging Temperature Range	-20° to 65°
Charging Temperature Range	0° to 45°
Storage Temperature (1 month)	-10° to 45°
Storage Temperature (3 month)	-5° to 35°
Dimensions	407.5mm x 105mm x 79mm
Weight	5.226kg

4.6 MAXIMIZING YOUR DRAGONFLY'S RANGE

Your Dragonfly's max range will be affected by certain variables:



BATTERY CONDITION

Always take proper care of your battery, making sure it is charged appropriately. A well-maintained battery provides consistently greater range. Please note that batteries will decline in performance if they are older, have over 1000 recharges, are heavily used and poorly charged and/or kept in the cold.



TEMPERATURE

Driving, storing and charging your vehicle within our recommended temperature range (4.5.5) helps maintain optimal battery performance to achieve the best range. Driving in temperatures below our recommended temperature range reduces range and battery performance.



DRIVING CONDITIONS

The weather you drive in will greatly affect the Dragonfly's max range. Driving against windy and more challenging conditions will decrease range. Dry and non-windy conditions will enable you to maximize range. Driving in the direction of wind flow will increase range.



DRIVING SURFACE

Driving on flat, smooth and even surfaces will improve range. Driving on uneven, rugged surfaces will decrease range. You should always drive on flat, clean, dry and level surfaces, away from other vehicles and pedestrians.



DRIVING STYLE

Maintaining a continued, moderate driving speed will improve range. Frequent start and stops, and acceleration and deceleration will decrease range.



REGENERATIVE BRAKING

To improve your battery efficiency and range up to 10%, try to maximise the benefits of the regenerative braking using the motors. This will also reduce rear brake wear. Refer to the Braking section of this manual (5.6).



CARGO WEIGHT

A higher cargo weight will decrease range.



TIRE PRESSURE

Keep your tires inflated to the recommended inflation pressure level of 50PSI. Pressure below the recommended level will decrease range. Be cautious of your tire wearing down, thin and balding tires will decrease range.



4.7 YOUR DIGITAL DASHBOARD (HMI)

Your HMI Dashboard is the central point for all of your vehicle's status information. It also enables you to configure your personal Dragonfly settings to optimize your Drive and connect mobile devices to enjoy additional APP features.

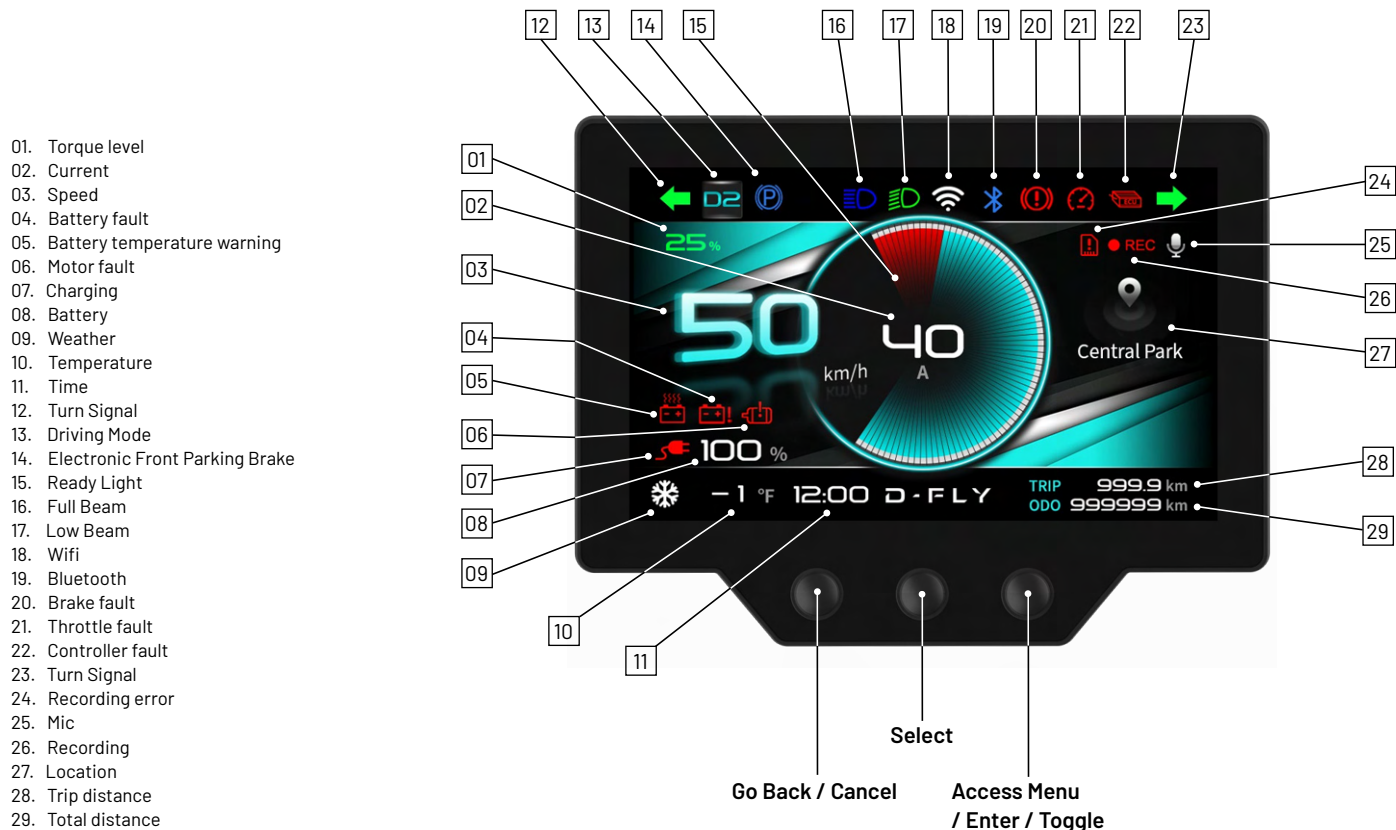

Your Dragonfly has a number of "SAFE" default settings:-

- "P" means your electronic parking brake is activated (front wheels are locked and vehicle will not move).
- Torque = 25%
- E-ABS Intensity = 25%
- E-ABS = Off
- Brake Lever = Active
- Battery = 100% (If it does not read 100% your battery is not fully charged!)
- Trip = 0 km
- Odometer = 0 km

Main Menu

To access the main options menu, press the right button of the screen. A menu will appear with the following options:

Connection

Select to connect your mobile device via bluetooth or wifi to access the D-Fly App and enjoy additional app features include Navigation, Messaging and Social Media notifications.

Dashcam

Access the live camera feed from your on-board dashcam straight to your screen & mobile device.

Screen Mode

Select your screen contrast, between a day or night setting, or an automatic (AUTO) setting which automatically detects the light level and adjusts your screen.

Brightness

Select to adjust screen brightness, between a low, high or auto brightness.

Unit Settings

Select your preferred unit of measure. Metric or Imperial. Celsius or Fahrenheit temperature display.

Language

Select your preferred language of operation

Vehicle Settings

Configure your driving style:

- **Kickstart** - Turn ON Kickstart if you want to engage your motors with a kick-push above 3kmh. Otherwise select OFF for normal function. We suggest OFF as the default.
- **E-ABS Braking** - Turn E-ABS to ON / OFF. This activates One Drive mode. As the name suggests One Drive enables you to accelerate and brake with one finger! By rotating the accelerator you will speed up, by releasing the accelerator the brakes will auto engage. **NOTE: At slow speeds the auto brakes will need to be supplemented by applying the mechanical rear brakes.**
- **Torque Level** - Adjust the torque (power) level delivered to the front wheels. 4 levels are available from 25% to 100%. Default is set to 25%.
- **E-Brake Setting** - Adjust the braking intensity delivered to your front E-ABS brake system. This in turn increases the amount of regenerative power delivered back to the battery. Typically up to 10% of improved battery performance with 100% Brake intensity selected. **NOTE: E-Braking intensity increases with speed!**
- **Shutdown** - Adjust the amount of time before your Dragonfly will automatically shut down when parked.
- **OFF-ROAD** - turn on OFF-ROAD to enable full power output. You will be required to agree to your Driver's Obligations disclaimer..

Dashcam Settings

Configure your camera settings:

- **Camera Rotate** - Camera Rotate alters the camera recording between portrait and landscape. This is helpful for social media sharing.
- **Camera Mirror** - If you turn your camera through 180 degrees you can record your reactions to your adventure and then post your recordings. Mirror the screen so you are being recorded the right way up.
- **Code Format** - Select the video format you want to record in.
- **Loop Recording** - Your dashcam records in continuous loops. You can configure the time of those loops from 1, 2, 3, 5 or 10 mins
- **Mic Settings** - Turn your microphone on or off
- **Video Quality** - Manage your dashcam's storage by prioritising Quality, Space or a Balanced setting.
- **Format** - Format your dashcam's internal storage to erase all files & optimise the performance of recording. **Caution: when formatting, the device will erase all existing files.**

Device Information

Access your Dragonfly's model, software and firmware versions.

START UP



When you start your Dragonfly the screen will initialize and you will hear the start up sound sequence before arriving at the home screen (approx 4 seconds).



Once at the home screen, you will see your speed at 0 km/h/mph on the left hand side, the Amps output at 0 A in the centre, your trip data at 0 km, and your odometer at 0 km.

You can also see the battery level in white (100%) and the torque level in green (25%). The gear selected is P for park, shown in Blue on the top line. The daylight running lights indicator is shown in Green.

CONNECTION



1. Press Menu then select **Connection**.



2. Select **Mobile Connection**.



3. Scan the QR code to download the D-Fly App. Once installed on your phone, scan the QR code again which will automatically connect you to either Bluetooth or Wifi connection depending on the option you have selected. You will need to select the device code in your smart phone Bluetooth settings or Select the Wifi network hotspot on the Dragonfly Screen.



4. Once connected, the screen will show your paired device.



5. While your mobile device is connected to the D-Fly App, you will be able to keep up to date with your **social media notifications**...



6. Take calls...



7. And receive **message alerts** to your digital dashboard.



8. You will also have access to fully **synchronised map navigation**.



9. Select **WiFi Connection** for faster connection speeds.

Both Bluetooth & WiFi can be connected at the same time.



10. Scan the QR code and if you haven't already downloaded the D-FLY app.

Once installed, select the wifi hotspot from your phone. Select the matching code on the screen and you will be notified that your devices are paired.



11. Once connected, the device connected section will show your paired device.



12. In Connection, toggle down to **Reset Connection** and press select.



13. Select **Reset Mobile Device** to reset the Bluetooth connection with a paired device.



14. RToggle down and select **Reset Wifi** if there appears to be a fault or you have a new mobile device.

DASHCAM



1. Select **Dashcam** and your HMI will display the video image live on your screen.



2. Additional critical drive information is displayed over the top of the live feed.

SCREEN MODE



1. Select **Screen Mode** on the main menu.



2. Select Screen Mode **AUTO, Day or Night.**

The HMI will adjust to the typical light conditions or automatically recognise conditions for optimal contrast during your drive.



3. Toggle down to select **Night.**



4. Toggle down to select **Day.**

BRIGHTNESS



1. Select **Brightness** on the main menu.



2. Select **AUTO, Low or High.**

The HMI will adjust the brightness or automatically recognise the optimal brightness for your Drive.



3. Toggle down to select **Low.**



4. Toggle down to select **High.**

UNIT SETTINGS



1. Select **Unit Settings** on the main menu.



2. Select **Speed unit**.



3. Toggle between **Metric** (km) & **Imperial** (miles).



4. The display will auto adjust the speedometer, trip data and odometer readings.



5. At the Unit Settings menu, toggle down and select **Temperature unit**.



6. Select **Celsius...**



7. Or toggle down and select **Fahrenheit**.

LANGUAGE



1. To change the language of your dashboard, go to the main menu, toggle down and select **Language**.



2. The default language setting is **English**.



3. Toggle down to choose your preferred language.

NOTE: Not all languages will be available.

VEHICLE SETTINGS



1. Toggle down to **Vehicle Settings** at the main menu and press select. This opens up several subsections for you to personalise Drive options.



2. Select **Kickstart**.



3. Choose between having Kickstart **ON** or **OFF**.



4. Kickstart is **not recommended** and we suggest **OFF** remains the selected option.



5. At the Vehicle Settings menu, toggle down to **E-ABS Power** and press select.



6. The default is set to **OFF**



7. Toggle down and select **ON** to switch on E-ABS Power and your **ONE DRIVE FEATURE**.



8. At the Vehicle Settings menu, toggle down to **Torque Level** and press select.



9. There are four options available to activate the torque level which suits your Drive. Default is set to 25%. This is the lowest setting and allows drivers to explore their Dragonfly for the first time in complete safety.



10. Toggle down through each setting.



11. As you increase the torque level from 25% up to 100% the amount of power delivered to the wheels will increase. The torque curve of acceleration will also increase!



12. Explore these options carefully. They also relate directly to the gear you have selected.

Each gear limits the maximum speed you can reach. The torque level relates to how fast you will reach that speed limit.



13. At the Vehicle Settings menu, toggle down to **E-Brake Setting** and press select.



14. The E-Brake Setting relates directly to the **ONE DRIVE** setting. Once the **E-ABS** is turned on and **ONE DRIVE** is active the amount of auto E-Brake applied is set via E-Brake setting.

Toggle down through the settings.



15. The higher the level, the greater the amount of braking is applied when you release the accelerator. **ONE DRIVE** is a new feature and unique to Dragonfly. We recommend getting familiar with this setting off road in a quiet area. Feel how acceleration and braking are linked in their intensity.



16. With **ONE DRIVE** enabled, your regenerative braking is optimised. This feature typically gives you up to 10% of battery recharge.



17. The higher the brake setting the greater the amount of battery charging will occur during your drive.



18. At the Vehicle Settings menu, toggle down to Shutdown.



19. Press select to activate the automatic shutdown.



20. Toggle through the various shutdown times and select your preference.

The greater the time, the longer before your Dragonfly will auto shutdown.



21. At the Vehicle Settings menu, toggle down to **OFF-ROAD**. Select **OFF-ROAD** to unlock enhanced performance and full power output, to tackle challenging terrain.



22. In order to enable **OFF-ROAD** mode, you must **accept the disclaimer** on your digital display unit.

DASHCAM SETTINGS



1. Select **Dashcam Settings** on the main menu.



2. Select **Camera**.



3. Camera Rotate flips the view of your camera feed upside down. This can be useful when you turn the camera back on itself and want the image to remain the correct way up.



4. Toggle down to Camera Mirror.

Camera Mirror flips the view of your camera feed horizontally. This can be useful to avoid a confusing feed, where right is left and left is right.



5. Select Code Format from the Dashcam Settings menu.



6. Code Format is a recording setting used by video recording devices. Default is H.265.



7. Toggle to **H264** and press select. This setting relates to high resolution video recording formats. For reduced bandwidth H265 is a better choice. Some devices operate only with H264 and this setting can be more appropriate for streaming.



8. Select **Loop Recording** from the Dashcam Settings menu.



9. Toggle through the options and activate your desired loop recording time. Default is continuous recording. Shorter intervals of one or two minutes may be preferred for social media sharing.



10. Select **Mic Settings** from the Dashcam Settings menu.



11. Select **ON** (default) to turn the sound of your dashcam mic on.



12. Toggle down and select **OFF** to turn the sound of your dashcam mic off.



13. Select **Video Quality** from the Dashcam Settings menu.



14. Select **Quality Priority** to prioritise high quality footage.



15. Toggle down to **Space Priority** and press select to record in lower quality and prioritise space efficiency.



16. Toggle down and select **Balanced** to record in equal balance between quality and space efficiency.



17. Select **Format** from the Dashcam Settings menu.



18. Select **Yes** to format the dashcam unit.

⚠ WARNING
Formating the dashcam unit will delete all recordings. Be sure to download all the videos you want to save to your mobile device via the app.



19. If you do not want to format the unit, toggle down and select **NO**.

DEVICE INFORMATION



1. Toggle down to **Device Information** from the main menu and press select.



2. The vehicle software and firmware versions will be displayed.

4.8 DRAGONFLY APP

Scan the QR code below to download the D-Fly App.



4.9 PHONE MOUNT ADAPTER

Supplied within your charger case is a small adapter ring. This is to be used with the Quad Lock mount system (Quad Lock USA® - Official Store: <https://quadlockcase.com>)

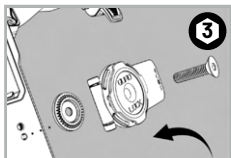

Carefully remove the rubber cap from the stem and place the adapter ring on the stem aligning the underside peg before securing the Quad Lock mount.



5 DRIVING

⚠ Before driving, please check your local laws and regulations. It is your responsibility to adhere to any applicable laws when driving. D-Fly Group Ltd cannot be held liable for your breach of the laws.

5.1 UNLOCKING / LOCKING



To unlock your Dragonfly, simply press the unlock button twice on your fob (both presses must be within three seconds of each other) and your Dragonfly will come to life. You will hear the power on sound.

Note: The 10m activation range can be affected by other electrical interference.

To switch off and lock:

1 x Press Lock Button = Switches Dragonfly off but still allows movement of the vehicle. You will hear the power off sound.

2 x Press Lock Button = Switches Dragonfly off. The double click activates the alarm, locking the front wheels. You will hear the alarm on sound.

5.1.1 ALARM

The motion sensing alarm has two stages: If your alarmed Dragonfly is moved there will be an audible sound to indicate an activated alarm. Should movement continue the alarm volume will increase.

To stop the alarm press the **Unlock** button.

5.2 GETTING ON

⚠ Keep your Dragonfly switched off while you familiarize yourself with it.



1. Getting on and standing

First put a foot on the deck and get a feel for it. Once you are comfortable, place your second foot on the deck. Practice getting on and off several times.

2. Finding your stance

Grab the handlebars. Pick a stance based on which foot you are most comfortable placing forward. Place your opposite foot to the rear of the deck at an angle which enables you to stay balanced, in control and safe. Familiarize yourself with your weight distribution on the deck, shifting all your weight to your front foot and then to your rear foot, feeling the weight on your front foot roll from your heel to your toes. Become familiar with the deck movement underneath your feet until you are totally at ease and comfortable with it.

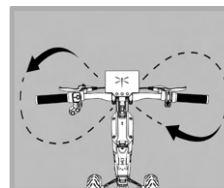

3. Leaning the tiller

Start to engage the tiller, tilting left and right, twisting the handlebars and feeling the motions of steering. You will notice the possibility to draw a figure 8 with the handlebars and tiller, and that will guide the natural flow of your body movement when steering. Get familiar with the turning angles of the front wheels as you turn the handlebars.



4. Tilting the deck

Your Dragonfly deck tilts left and right which enables you to turn in your chosen direction. Practise tilting the deck left and right while stationary and observe how the deck tilting also changes the direction of the back wheels.

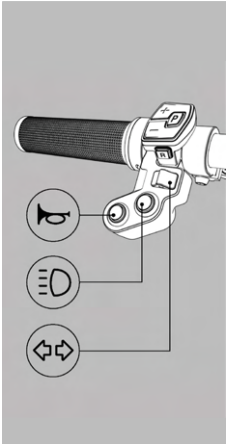

4. Lights, horn and turn signals

Familiarize yourself with all safety components.

Lights: The lights can be operated with the press of a button on the left-hand side of the handlebars, marked with the lights icon displayed above. Be aware, the daylight running lights are always on by default. Press the lights button to switch your lights to full beam. If you want to turn the lights off altogether, press and hold the lights button until the lights switch off. It is always recommended to drive with your lights on.

Horn: Press the horn button to emit a warning sound. The horn button is marked with the horn icon displayed above. Always be seen and be heard.

Turn Signals: Always use the turn signals before turning. Your turn signals can be controlled by flicking the turn signal button left or right, displayed by the arrow turn signals displayed above. Flick the button back to the middle once you are finished using the turn signal.

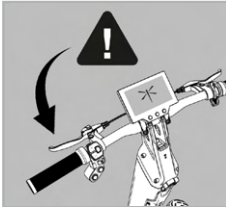

5. Testing the brakes

Your Dragonfly is equipped with an electric front braking system operated by the right lever and a mechanical drum rear braking system operated by the left lever. Start testing the braking mechanisms by kick-pushing your vehicle and applying the brakes. **Note: The front electronic brakes only work when your Dragonfly is switched on. E-Braking performance increases with speed.**

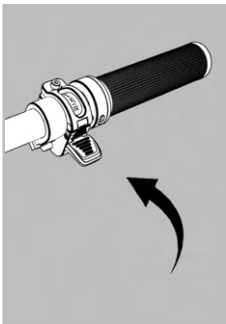

6. Accelerating

Your vehicle's acceleration is controlled by an accelerator. The button is located on the right-hand side of the handlebars. Familiarize yourself with the accelerator before trying to maximize speed.

7. Traction control

Your Dragonfly has the ability to intelligently control the power to each front wheel. In slippery conditions this means that more power is directed to the wheel that has the grip. Be aware that in these conditions the front wheels may feel a little different and you might need to adjust your typical steering style to counter the effect of the traction control.

5.3 DRIVING

⚠ Your Dragonfly is a powerful e-mobility vehicle. Always use caution before and during your drive and always wear personal protective equipment when driving. Always practice somewhere safe, away from moving objects and pedestrians and away from any potential hazard.

Note: We recommend you disable the push start feature (see page 38).

1. Turn your Dragonfly on.
2. Push your vehicle until a 1.5 - 3mph / 3 - 5kmh speed is reached. Once you reach that speed, press the accelerator and prepare for your Dragonfly to accelerate.
3. Practice at the lowest speed possible, in D1 speed setting and 25% torque, to get familiar with your vehicle's manoeuvrability.
4. Practice turning your vehicle, at the lowest speed. Make sure to slow down when taking sharp turns. Keep your body evenly balanced when making turns to avoid a fall.
5. First practice turning by twisting the handlebars similar to a bicycle or motorbike. Then progress to lean steering. Combine these two movement into one figure of 8 pattern. Notice that the deck also tilts and when you move your weight from left to right. This is the 3rd dimension of steering. Twist, lean & tilt. Take your time to master this technique at slow speeds.
6. Practice braking and judging good stopping distance, paying attention to the weather and surface conditions you are driving on.
7. Keep practicing at low speed to get used to your Dragonfly before driving it in public.

5.4 DRIVING MODES

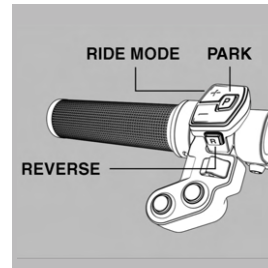

Your Dragonfly comes with various drive modes.

They are as follows*:

Driving Mode 1 (D1)	Max speed 4mph / 6kmh
Driving Mode 2 (D2)	Max speed 12mph / 20kmh
OFF ROAD (D3)**	Enhanced performance
Reverse (R)	Max speed 3mph / 5kmh
Park (P)	Locks the front wheels when Dragonfly is off.

* All figures rounded up the nearest whole number

** To access D3, OFF-ROAD mode needs to be accepted or switched to "Always ON". See page 43.

For use on private land, Dragonfly has enhanced performance in order to deliver the torque required for more demanding terrain. This mode has a greater potential risk of injury and therefore requires careful consideration for safety and all applicable laws. Upon selecting OFF-ROAD mode you will be reminded of this.

In order to drive your Dragonfly, you will need to disengage Parking (P) and engage one of the driving modes. Press (P) to disengage Parking mode and click the + and - buttons to toggle between the different drive modes available.

5.5 ACCELERATING

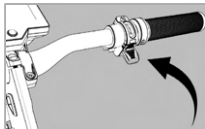

Your Dragonfly's acceleration is controlled by an accelerator. The button is located on the right-hand side of the handlebars. Familiarize yourself with the accelerator before trying to maximize speed.
⚠ Always practise at low speeds first, in D1 mode.

5.6 BRAKING

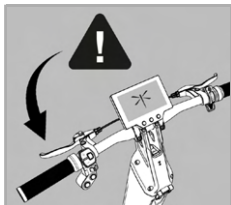

⚠ Always apply your back (left hand) brake first.
⚠ Avoid sudden braking.
Testing the brakes Your Dragonfly is equipped with an electric front braking system operated by the right lever and a mechanical drum rear braking system operated by the left lever. Always anticipate braking ahead of any obstacle. Keep your weight evenly distributed on your Dragonfly, particularly when braking, to avoid falling forward.
Note: The front e-brakes and e-parking brake only work when the vehicle is on. E-Braking performance increases with speed.

Front E-ABS

Your Dragonfly is equipped with **ONE DRIVE** technology. This function also turns on enhanced battery regenerative braking. Turn **ON** by selecting E-ABS from the vehicle settings menu and select **ON**. Once enabled, acceleration and braking are controlled with one finger. At slow speeds it is recommended to supplement the front E-brakes with the rear mechanical left hand brake lever.

***Regenerative braking** As you brake, the system will automatically allocate a quantity of the braking force to energy regeneration and some to the electronic brake mechanism. As a result, the system simultaneously slows the vehicle down and recharges the battery for improved energy efficiency, greater range and the benefit of reduced rear brake wear.

You can adjust the intensity of **ONE DRIVE E-Braking** in the vehicle settings menu. Toggle between **25%** and **100%**. These values correlate to brake intensity at the front wheels as well as the amount of battery regeneration.

Test these settings in a safe place, well away from obstacles, pedestrians and traffic. It's important to get familiar with this driving style prior to driving in a public place.

Note: 100% E-Braking as part of the ONE DRIVE technology can add up to 10% battery efficiency.

5.6.1 MECHANICAL PARKING BRAKE

⚠ WARNING

FAILURE TO ENGAGE PARKING BRAKE MAY RESULT IN DAMAGE OR INJURY OR DEATH

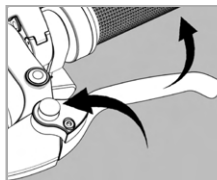

When your Dragonfly is stationary and switched off, engage your parking brake to lock your rear wheels and stop any possibility of motion.

Squeeze your left rear brake lever to its maximum position and depress the button on top of the lever. To turn off simply tighten the lever once more and the button will auto release.

5.6.2 E-PARKING (P) BRAKE

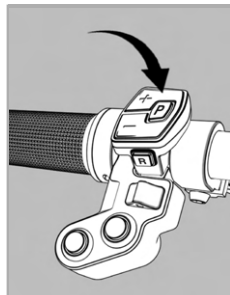

⚠ WARNING Your electronic Parking brake only works when your Dragonfly is switched ON.

Your vehicle is equipped with an electronic parking (P) brake. Once engaged, the system locks the front wheels and prevents any movement. This is an intelligent and intuitive system. If any directional pressure is applied while (P) brake is activated, the system will correct any movement. For example, if you park your Dragonfly on an incline and pressure applied on the deck causes an initial shift in your position, the system will automatically reposition your vehicle in its original parking place.

To engage your electronic parking (P) brake, press on the P button. This will disengage your driving mode and lock your front wheels.

5.6.3 HILL STARTS

The following instructions are relevant if your Dragonfly is parked uphill.

5.6.3.1 PARKING

With your Dragonfly switched on, press the P button on the left hand multi function switch. Now engage the mechanical rear brake parking by following the instructions in 5.6.2.

Note: Once the mechanical parking brake is engaged you are safe to turn off the vehicle. This will turn off the electronic parking brake. At this point, do not stand on or introduce a payload to your vehicle as there is a risk of rolling downhill.

Regular rear brake maintenance is required to ensure the operation of the mechanical brake.

5.6.3.2 STARTING

⚠ WARNING Always ensure your (P) Parking mode is turned on before standing on your Dragonfly, especially when the vehicle is stationary uphill. This means your Dragonfly should be on, with (P) mode engaged.

⚠ WARNING To avoid rolling downhill when you want to hill start, always release the parking (P) brake with your digit on the accelerator ready to press and move uphill.

Note: When pulling your right brake lever you will disable the front motors and will not move forward. On a hill start, press accelerator to find the bite point while pressing the mechanical brake lever. Release the lever to move forward.

Before you stand on the vehicle you need to have your Dragonfly turned on and the parking (P) brake will automatically be turned on. Make sure you check that parking (P) mode is engaged before you stand on the vehicle.

When you then stand on your vehicle it will not move. Once you release the parking (P) brake, your vehicle will be able to move and you will need to press the accelerator.

5.7 ADJUSTING YOUR DRAGONFLY

You can adjust your vehicle to suit your driving style. Carve with 3-D Full Tilt or cruise around bends at leisurely pace.

Each Dragonfly comes with 8 adjustable springs:

4 x black springs to regulate the stiffness of your deck tilt.
4 x red springs to independently regulate the suspension of your wheels.

5.7.1 YOUR TOOLKIT

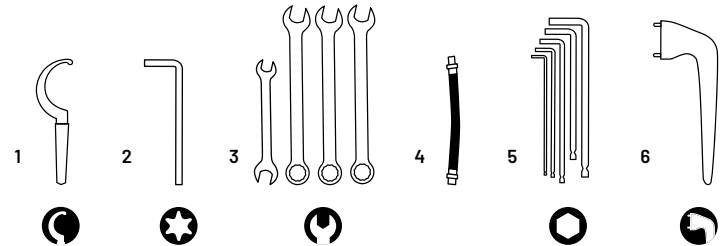

1. Shock Wrench (adjusting suspension)
2. Wheel Bolt Star Wrench (tire replacement)
3. Wrenches
4. Valve Extender
5. Allen Wrench (2, 5, 3, 4, 5, 8)
6. Wheel Cap Wrench

5.7.2 ROLL SPRING ADJUSTMENT / DECK TILT

On the underside of your Dragonfly, you will find 4 location points that enable you to modify the tightness of the springs, which in turn control the stiffness of the deck tilt. Looser springs mean more tilt and therefore a tighter turn radius, and tighter springs mean less tilt and therefore a wider turn radius.

Each spring comes with three settings:

1. Loose (factory setting)
2. Medium
3. Firm

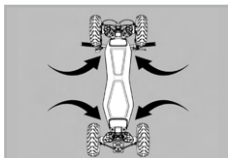

1. Fold and stand up Dragonfly to easily access the 4 points on the underside.

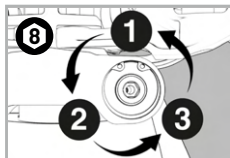

2. Using the largest (No8) Allen wrench turning counter-clockwise through the three settings means a tighter spring. Turning clockwise means a looser spring. You will see the setting number visible.

⚠ WARNING All four roll springs require the same setting.

The following guidelines are your recommended spring setting for optimal tilt, based on weight range:

- **Spring setting 1** Up to 175lbs / 80kgs
- **Spring setting 2** Between 175lbs - 210lbs / 80kgs - 95kgs
- **Spring setting 3** Above 210lbs / 95kgs

5.7.3 SHOCK SPRING ADJUSTMENT

Your shock springs can also be tightened and loosened to suit your drive preference.

NOTE: When you receive your Dragonfly, the shock springs will be tight for a firm drive.

There is a unique tool in your tool roll which you will use to turn the dial that controls the tightness of your shock springs. The dials for each spring can be found on the bottom end of your hydraulic shock springs. The tighter you adjust your spring, the harder the drive. A looser adjustment will soften your drive.

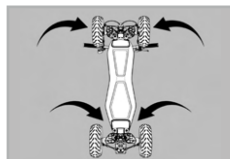

1. Fold and stand up Dragonfly to easily access the underside.

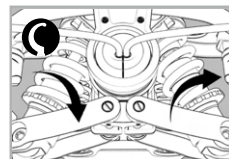

2. Using the special tool, turn the dial to either tighten or loosen the red shock spring.

⚠ WARNING Ensure all four shock springs are set to the same tightness.

5.7.4 LIGHT ADJUSTMENT

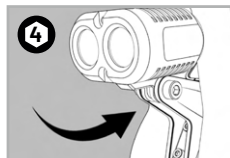

1. Using the allen wrench to loosen the bolt below to light to adjust to the angle required.

5.7.5 BRAKE ADJUSTMENT

Rear Brakes

The mechanical rear brakes respond to a pull on the left-hand lever. When you pull the lever, the rear wheels should immediately lock. Over time and with consistent use, it is common to see a brake cable loosen.



To tighten the rear brake cable, locate the thumbscrew on the inner side of the back wheel, and rotate it clockwise. Keep testing by pressing the brake lever as you rotate the nut, until you are satisfied with the tightness of the brake.

⚠ WARNING When you rotate the wheel the wheel should run freely. When the brake lever is depressed the wheel should come to a complete stop and with the lever held firm the wheel should not move.

Front Brakes

The front brakes are electronic and adjustable and respond to a pull on the right lever. You can adjust the front brake settings on your HMI screen.

ONE DRIVE MODE

On the main HMI menu, scroll to Vehicle Settings, then select E-ABS / ON to activate the electronic ABS. This setting will activate **ONE DRIVE MODE**. You can then adjust the amount of power delivered to that system.

E-ABS Power

This setting enables you to choose how much braking force is generated on the front wheels when you release the accelerator with **ONE DRIVE MODE** enabled. You can toggle between the following options -

- 25%
- 50%
- 75%
- 100%

⚠ WARNING Always remember to apply the rear brakes first.

5.7.6 TIRE AND TUBE REPLACEMENT

You may wish to change your tires, for performance purposes or for maintenance and repair. You are able to do so very easily, with a tool provided in your tool roll. First, let the air out of your tire, then follow these instructions to complete a tire and tube replacement:



1. Using the Wheel Bolt Star Key remove the five bolts on the outer wheel rim.



2. Remove the wheel ring and slide off the tire and inner tube as one.

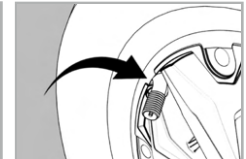

3. Replace the inner tube, or tire and slide back on together, lining up the valve correctly.

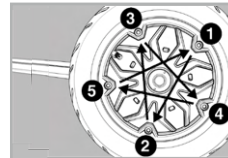

4. Replace the wheel ring and bolts, following the correct tightening sequence.

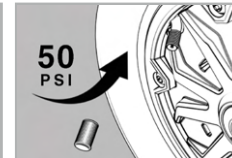

5. Inflate the tire with 50PSI. Do not exceed. Then replace the dust cap.

⚠ WARNING Always deflate your tire(s) completely before removing the wheel bolts to change them or replace your inner tube.

6 MAINTENANCE

6.1 STORAGE

Always store your vehicle securely. Keep your Dragonfly in a cool, dry place, away from extreme weather and sharp temperature deviations (for example: do not keep your Dragonfly near any heating units or inside a cold storage unit). Keep your vehicle locked with your fob and consider adding locking technology such as a chain and padlock. The following are recommended Dragonfly storage temperatures:

Storage Temperature (1 month) -10° to 45°

Storage Temperature (3 month) -5° to 35°

6.2 CLEANING



To avoid the build-up of dirt, potential rust or aesthetic degradation that could affect your Dragonfly's performance, we recommend you clean your vehicle after every use. Clean your vehicle with a damp cloth first, then a dry cloth to finish. Your Dragonfly is water resistant rated IPX5. This means it can sustain a low-pressure sustained jet spray. Always keep your lights clean for good visibility on your drive, and any reflective materials free from dirt.



⚠ WARNING Never use a power washer to clean your vehicle.

6.3 REPAIR

Any issue with the following components can be repaired following our repair tutorials on the following YouTube link:

www.youtube.com/@d-flygroup

For any repair which does not feature in our tutorial videos, please visit your local e-mobility repair shop, or contact customer service.

Customer Service

Email hello@d-fly.com

Telephone USA (+1) 213 376 5572

UK (+44) 204 586 0484

6.4 SPARE PARTS

If you need to replace or order spare parts, visit www.d-fly.com, or contact customer services on hello@d-fly.com

6.5 MAINTENANCE REMINDERS

- Regular maintenance is a matter of safety. Always clean your Dragonfly after use. Always check all components on your vehicle before driving.
- All self-tightening nuts and any other self-tightening fastenings may, with time lose their efficiency and will thus need to be retightened. You can tighten all fastenings yourself or take your Dragonfly to a local bicycle, motorbike or car mechanic for this maintenance requirement.

Service packs and replacement parts are available on line at d-fly.com/parts

7 TROUBLESHOOT AND FAQs

7.1 TROUBLESHOOT

If there is a technical fault with your Dragonfly, a warning light will be displayed on your HMI. Should you see one of these lights, please follow the relevant advice below.



⚠ Battery Temperature Warning

Switch your vehicle off. Find a cool place to let your vehicle rest and reduce in temperature. The time for the vehicle to cool will vary depending on the ambient temperature. Once cool, restart your vehicle. If the problem persists, remove the battery. Let your battery rest in a well ventilated, cool and dry location, out of direct sunlight. Once completely cool, re-load your battery into your vehicle and restart. If the Battery Temperature Warning light remains, stop driving. Contact customer service for advice. The battery may have reached the end of its life and require replacement or simply a cable is loose and will require a service.



⚠ Battery Fault

Switch your vehicle off. Find a cool place to let your vehicle rest and reduce in temperature. The time for the vehicle to cool will vary depending on the ambient temperature. Once cooled down, restart your vehicle. If the problem persists, remove the battery and replace it once again to ensure it's not a simple connection error. It's important that the battery blade connections are clean and the battery snaps firmly into place. When the battery is replaced, the front light will flash once and you will hear the activation sound. If this does not occur check the battery charge levels. The battery may need to be recharged. If the Battery Fault sign continues to appear, stop driving immediately. Contact customer service for advice. The battery may have reached the end of its life and require replacement or simply a cable is loose and will require a service.



⚠ Motor Fault

Switch your vehicle off. Find a cool place to let your vehicle rest and reduce in temperature. The time for the vehicle to cool will vary depending on the ambient temperature. Once cooled down, restart your vehicle. If the problem persists, check the motor cable connector and ensure that it is clean and properly connected. Check the motor cable for damage, wear or cuts. If you see any of those signs, stop riding immediately and contact customer service. The motor or connector may need to be replaced.



⚠ Brake Fault

Switch your vehicle off. Find a cool place to let your vehicle rest and reduce in temperature. The time for the vehicle to cool will vary depending on the ambient temperature. Once cooled down, restart your vehicle. If the problem persists, check the brake cables leading from the brake levers. and ensure they are clean and properly connected. Check the electric brake wire for damage, wear, cuts. If you see any of those signs, stop riding immediately and contact customer service. The brake lever and cable may need to be replaced.



⚠ Throttle Fault

Switch your vehicle off. Find a cool place to let your vehicle rest and reduce in temperature. The time for the vehicle to cool will vary depending on the ambient temperature. Once cooled down, restart your vehicle. If the problem persists, check the throttle wire connector and ensure that it is clean and properly connected. Check the throttle wire for damage, wear or cuts. If you see any of those signs, stop riding immediately and contact customer service. The throttle and wire may need to be replaced.



⚠ Controller Fault

Switch your vehicle off. Find a cool place to let your vehicle rest and reduce in temperature. The time for the vehicle to cool will vary depending on the ambient temperature. Once cooled down, restart your vehicle - this process will reload and refresh the controller. Check your firmware version against the latest version of the Driver's Manual available at www.d-fly.com/manuals. If the Controller Fault icon persists, stop riding immediately and contact customer service. The controller may need to be replaced. Further troubleshooting and 'How To' videos are available at d-fly.com and on our [YouTube](#) channel.

Customer Service

Email hello@d-fly.com
Telephone **USA (+1) 213 376 5572**
UK (+44) 204 586 0484

7.2 FAQs

How do I repair or service my vehicle?

Your vehicle comes with total modularity! All components are plug and play and can be changed with the toolkit provided. They're easily replaced and we are building all the resources to educate our drivers on how to maintain and service their vehicles at home. No more added service charges, or dependencies on the manufacturer! Our mantra is this: *one person, one tool, 15 minutes!* (Relatively all fixes shouldn't take much longer than 15 minutes to complete, with only one of the tools provided).

Are the batteries removable and/or changeable?

Yes! The batteries are easily removable. You can charge one at your home or office, and drive with another. Having an extra battery will give you more autonomy! We've also installed a lock key to provide further security for the battery itself.

How many motors does my Dragonfly have?

The DF and the DFX come with two 500W motors, one in each of the front wheels.

What suspension does my DF and DFX have?

There is an adjustable double wishbone hydraulic damped sprung suspension at each of the 4 wheels of the vehicle. This allows you to personalize your driving experience for different types of roads and conditions by adjusting the stiffness of the suspension struts. There's a tool provided in each of the DF and DFX toolkits as standard.

Does my Dragonfly have lights for night time driving or turn signals for turning?

Yes! Your Dragonfly comes with automotive grade front and rear lighting and rear turn signals as standard. The DFX also comes with additional turn signals in the handlebars. These handlebars are an optional extra for DF drivers.

How long should my battery take to charge?

The battery will take 3-7 hours to charge fully. Premium battery cells have been chosen to extend range and battery life.

What is the spec of the battery?

20 Ah high quality Samsung cells.

What's the maximum hill ratio it can handle?

Up to 25% is all good!

What is the maximum continuous power?

1650 Kw/h

How does the Dragonfly perform under hot and humid conditions?

A dragonfly is a personal electric vehicle. Its performance is subject to weather conditions. As with any battery operated personal mobility vehicle, extreme heat, cold and humidity etc affect performance and can degrade it. Consult the battery section of our user manual for the proper operating specifications.

For a full list of FAQs visit www.d-fly.com/faqs

Contact customer service at hello@d-fly.com

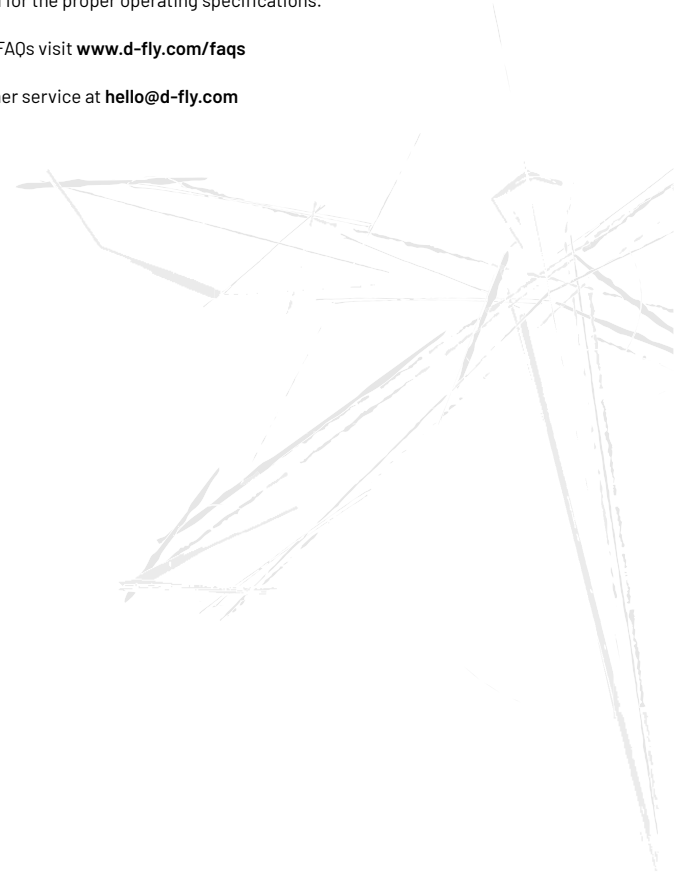



8 WARRANTY

8.1 DRAGONFLY WARRANTY POLICY

This warranty policy is only valid for the original purchaser of your Dragonfly.

1. We warrant that on delivery, and for a period of 12 months from the date of delivery (Limited Warranty period), your Dragonfly and its components shall be free from defects in material and workmanship and operate as described.
2. For any warranty claim to be considered, your Dragonfly must be in an assembled, clean and sanitary condition, and accompanied by proof of purchase.
3. Damage resulting from normal wear and tear, including the results of fatigue, is not covered. It is the driver's responsibility to regularly inspect and properly maintain his/her Dragonfly.
4. To make a warranty claim: (a) Contact Customer Services (**hello@d-fly.com**) during the Limited Warranty period, within 7 days of discovery, and outline the reason for your claim; (b) Ensure you provide adequate photographic/video evidence of the issue which will help us to assess and process your claim as quickly as possible. (c) You will then be instructed on next steps. If a product needs to be shipped back to us, it will be at your cost. We cannot be held responsible for damage to the product that takes place in transit or for lost product in transit. (d) If your warranty claim is accepted, we may, at our discretion, choose to repair or replace the defective product. We reserve the right to repair or replace with the most comparable components or a model of equal or greater value.
5. Dragonfly Limited Warranty will be void under the following conditions: (a) Your Dragonfly is deemed to have been subjected to abuse, neglect, improper repair, lack of proper use or maintenance according to the Driver's Manual, alteration, modification, installation of unauthorised parts, corrosion, an accident or other abnormal, excessive, or improper use. (b) Your Dragonfly is used in an unauthorised rental or fleet sharing program, motorsports or racing events that are not commissioned by D-Fly Group Ltd, D-Fly USA Inc. or any other D-Fly company.

8.2 CLAIMS

At D-Fly Group Ltd, D-Fly USA Inc and all other D-Fly companies, we are committed to providing our customers with the highest level of service and support. If you encounter any issues with your Dragonfly, we want to help you resolve them as quickly and effectively as possible.

To report a claim, please follow the steps outlined below:

1. Contact Customer Service by phone on **(+1) 213 376 557 USA / (+44) 204 586 0484 UK** or by email at **hello@d-fly.com**.
2. Provide your full name, contact information, and your Dragonfly serial number.
3. Describe the issue you are experiencing with your Dragonfly in as much detail as possible, including any relevant photos or videos.

Our Customer Service team will review your claim and determine whether it is covered under the terms of your warranty or service agreement. If your claim is covered, we will provide instructions on how to proceed.

8.3 RETURN AND REFUND POLICY

Return and Refund Conditions

Product purchased from D-Fly Group Ltd, D-Fly USA Inc and any other D-Fly company may only be returned:

1. Within 30 days from the date the product was ordered, by the original purchaser.
2. In the original packaging as shipped, unused, and without any sign of damage. If the Dragonfly is returned in alternative packaging and the product is damaged as a result, the warranty will be void.
3. Once your request to return is approved by us in writing.

If the product received does not match the product purchased, you may contact us to arrange for the product to be returned and the correct product re-shipped to you.

Obtaining Approval to Return Product

Please write to us at hello@d-fly.com with your:

- Original Purchaser Name
- Order number
- Unique Customer ID
- Product Serial Number(s)
- Purchase Date
- Reason for request

We will endeavour to reply to you within a maximum of 48 hours

Spare Parts

Spare parts are entirely non-refundable.

Returning Product for Refund

You are entirely responsible for all shipping and handling costs and must ensure to mitigate any risk of loss or damage of the product while in transit to us. Always ship recorded delivery (proof of delivery) and with sufficient loss insurance to cover the full value of the product. Please remember, when returning product containing lithium-ion batteries, it must be shipped according to all applicable regulations. It is your duty to inform the carrier of the batteries before shipment.

Refund Process

We must first receive and assess the returned product(s) before we can determine if your refund request will be accepted in full, partially, or declined. This will depend on the state of the product(s) once received by us. It is not guaranteed we will refund the full value of your purchase should the product(s) not be as originally shipped, unused and without any sign of damage.

Once approved in full or in part, we will refund you this amount, net of any transaction fees incurred, to the original method of payment. This refund can take 5-7 business days.

Refund Values

Should you have purchased product using foreign exchange please note that the amount that you will receive once refunded may not match the exact amount spent. The amount that you receive will depend on the exchange rate on the day the refund is issued.

Product on Sale

Any product purchased on sale, during a promotion, can only be refunded at the given price paid during the time of sale.

Returning Incorrectly Received Product

We do not charge shipping or handling costs for the return of product that does not match what was ordered, provided the product is returned within 30 days of the original order date.

You will also not be charged any additional costs associated with shipping the correct product to you as ordered.

However, if the product you return is ultimately determined to be the correct product matching your original order, then the product return costs (including shipping and handling) will be deducted from any amount refunded or will be charged to you in the event that you wish this product or any other product be reshipped.

⚠️ We cannot guarantee the receipt of your products when you return them and cannot be held liable for returns lost in transit. If you discover a defect or a manufacturing fault, please refer to the Warranty Policy (6). All warranty claims will be subject to the Warranty Policy.

9 D-FLY GROUP DISCLAIMER

DRAGONFLY WARRANTY POLICY

This policy applies to the use of your Dragonfly made available by D-Fly Group (“we”, “us”, or “our”). By using our product, you (“user”, “owner” or “you”) agree to the terms and conditions of this policy.

Responsibility for use You are solely responsible for your use of your Dragonfly and any accidents or injuries that may occur while using it. You should only use your Dragonfly if you are familiar with the proper operation of it and if you are physically and mentally able to do so safely.

Safety measures You are required to wear a helmet while using the Dragonfly. You should also follow all traffic laws and regulations while using the Dragonfly, and you should not use the Dragonfly while under the influence of drugs or alcohol.

Maintenance and repair You are responsible for the maintenance and repair of the Dragonfly, including keeping the Dragonfly charged and ensuring that it is in good working condition at all times. If you encounter any issues with the Dragonfly, you should immediately stop using it and contact us for assistance.

Liability We are not responsible for any accidents or injuries that occur while you are using the Dragonfly. We also are not responsible for any damage to the Dragonfly or for any personal property that may be lost or damaged while using the Dragonfly.

Indemnification You agree to indemnify and hold us harmless from any and all claims, damages, or expenses that may arise from your use of the Dragonfly.

Changes to this policy We reserve the right to change this policy at any time without notice. Any changes to this policy will be posted on our website and will be effective immediately upon posting.

Governing law This policy and your use of the Dragonfly will be governed by and construed in accordance with the laws of the state and the federal laws of the country in question.

By using our products, you acknowledge that you have read and understand this policy and agree to be bound by its terms and conditions.

10 DRIVER'S OBLIGATIONS

PLEASE READ THESE TERMS AND CONDITIONS CAREFULLY. THIS DOCUMENT SETS FORTH LEGALLY BINDING TERMS AND CONDITIONS FOR YOUR USE OF THE DRAGONFLY.

- THESE TERMS AND CONDITIONS CONTAIN VERY IMPORTANT INFORMATION REGARDING YOUR RIGHTS AND OBLIGATIONS, AS WELL AS CONDITIONS, LIMITATIONS, AND EXCLUSIONS THAT MIGHT APPLY TO YOU.

BY PLACING AN ORDER FOR PRODUCTS FROM THIS WEBSITE, YOU AFFIRM THAT YOU ARE OF LEGAL AGE TO ENTER INTO THIS AGREEMENT, AND YOU ACCEPT AND ARE BOUND BY THE TERMS AND CONDITIONS HEREIN. YOU AFFIRM THAT IF YOU PLACE AN ORDER ON BEHALF OF AN ORGANIZATION OR COMPANY, YOU HAVE THE LEGAL AUTHORITY TO BIND ANY SUCH ORGANIZATION OR COMPANY TO THESE TERMS AND CONDITIONS.

In consideration of Your use of any Dragonfly provided by D-Fly Group Ltd, D-Fly USA, Inc. or any of their respective affiliates (“D-Fly”), You (“Driver,” “You,” or “Your”) (acting for all of Driver’s family, heirs, agents, affiliates, representatives, successors, and assigns) agree to all terms and conditions in these Driver Terms and Conditions (“Terms and Conditions”). These Terms and Conditions are subject to change by D-Fly (referred to as “us”, “we”, or “our” as the context may require) without prior written notice at any time, in our sole discretion. Any changes to the Terms and Conditions will be in effect as of the “Last Updated Date” referenced on this website. You should review these Terms and Conditions before purchasing any product that is available through this website. Your continued use of this website after the “Last Updated Date” will constitute your acceptance of and agreement to such changes.

You should CAREFULLY READ the Terms and Conditions before using the Dragonfly. Capitalized terms have the meanings given to them were defined in the Terms and Conditions.

YOU MAY NOT ORDER OR OBTAIN PRODUCTS FROM THIS WEBSITE IF YOU (A) DO NOT AGREE TO THESE TERMS AND CONDITIONS, (B) ARE NOT THE OLDER OF (i) AT LEAST 18 YEARS OF AGE OR (ii) LEGAL AGE TO FORM A BINDING CONTRACT WITH D-FLY, OR (C) ARE PROHIBITED FROM ACCESSING OR USING THIS WEBSITE OR ANY OF THIS WEBSITE’S CONTENTS OR GOODS BY APPLICABLE LAW.

THESE TERMS AND CONDITIONS CONTAIN RELEASES, DISCLAIMERS, AND ASSUMPTION OF RISK PROVISIONS AND A BINDING ARBITRATION AGREEMENT THAT LIMIT YOUR LEGAL RIGHTS AND REMEDIES.

All applicable laws (including, without limitation, those applicable to traffic, pedestrians, parking, charging and electric vehicles) must be obeyed, including any helmet laws in Your area.

1. GENERAL RENTAL AND USE OF VEHICLE.

1.1 Driver is At Least 18 Years Old.

Driver represents and certifies that Driver is at least 18 years old.

1.2 Driver is a Competent Vehicle Operator.

Driver represents and agrees that they are familiar with the operation of the Dragonfly, and is reasonably competent and physically fit to drive the vehicle. You can find materials provided by the vehicle manufacturer within the driver's manual. By choosing to drive a Dragonfly, Driver assumes all responsibilities and risks for any injuries or medical conditions. You are responsible for determining whether conditions, including, without limitation, rain, fog, snow, hail, ice, heat or electrical storms, make it dangerous to operate a Dragonfly. You are advised to adjust Your driving behavior and braking distance to suit the weather, visibility, surrounding environment, and traffic conditions.

Further, Driver represents and agrees that they will use and operate the Dragonfly in a proper and safe manner, and under normal operating conditions. Normal operating conditions require adherence to vehicle manufacturer specifications as provided in in the driver's manual, and routine care and maintenance by You.

Driver acknowledges and understands that the U.S. Consumer Product Safety Commission recommends the following safety tips to help prevent scooter deaths and injuries and You agree to follow such tips as guidelines: CPSC Safety Alert: Electric-Powered Scooters.

1.3 Driver Must Follow Laws Regarding Use and/or Operation of Vehicle.

Driver agrees to follow all laws pertaining to the use, possession, driving, parking, charging, and/or operation of the vehicle, including all state and local laws and the rules and regulations pertaining to vehicles in the area where You are operating the vehicle, including any helmet laws.

Driver should check with local authorities for driving guidelines and restrictions. Many local jurisdictions prohibit the use of motorized scooters on roadways and sidewalks. Driver acknowledges and agrees that certain states may require a driver's license and may require certain safety equipment for use of the Dragonfly and that additional vehicle code requirements may exist. Driver undertakes sole responsibility to become informed of such applicable laws before purchasing the Dragonfly. Driver also acknowledges that driving the Dragonfly also creates a risk to others and You shall determine what insurance protection he requires before purchasing the Dragonfly.

It is the complete responsibility of the Driver to ensure that your Dragonfly is operated in accordance with all applicable laws. You assume all liability and risk associated with the use of the Dragonfly.

1.4 Prohibited Acts.

Driver agrees to the following:

- D-Fly recommends against operation of a vehicle while carrying or holding a briefcase, backpack, bag, smart phone or other item that can alter balance or impair safe operation of the Dragonfly. If You choose to carry such an item, D-Fly recommends that you ensure the item fits snugly to your body and does not impede your ability to operate the vehicle safely.
- Do not place heavy objects on the handlebar of the Dragonfly, such as heavy backpacks or bags.
- Do not use any cellular telephone, text messaging device, portable music player, or other device that may distract You from operating the Dragonfly safely.
- Do not operate a Dragonfly while under the influence of any alcohol, drugs, medication, or other substance that may impair Your ability to operate a Dragonfly safely.
- Do not carry a second person or child on a Dragonfly.
- Do not mount or dismount curbs or any other elevated surface. The Dragonfly is not a stunt scooter. It's intended use is for road surfaces, trails, tracks, paths and parks where you can legally drive.

1.5 Vehicle is Intended for Only Limited Types of Use.

Driver agrees that they will not use the Dragonfly for racing, or stunt or trick driving. Driver agrees that they will not operate and/or use the Dragonfly through water (beyond normal urban driving), or in any location that is prohibited, illegal, and/or a nuisance to others.

1.6 Weight and Cargo Limits.

You must not exceed the maximum weight limit for the Dragonfly as set forth in the driver's manual.

1.7 No Alterations.

You must not tamper with, alter software or hardware on Dragonfly which will void your warranty.

1.8 Charger and Plug.

Driver agrees to ONLY use charger and plug provided by D-Fly. No other charger or plug may be used for charging Dragonfly.

1.9 Insurance.

YOUR AUTOMOTIVE INSURANCE POLICIES MAY NOT PROVIDE COVERAGE FOR ACCIDENTS INVOLVING OR DAMAGE TO THIS VEHICLE. TO DETERMINE IF COVERAGE IS PROVIDED, YOU SHOULD CONTACT YOUR AUTOMOTIVE INSURANCE COMPANY OR AGENT.

1.10 Electric Vehicle

The Dragonfly is an electric vehicle that requires periodic charging of its battery in order to operate. Driver agrees to use and operate the vehicle safely and prudently in light of the vehicle being an electric Vehicle and all of the limitations and requirements associated therewith. Driver understands and agrees with each of the following:

- The level of charge power remaining in the Dragonfly will decrease with use of the Dragonfly (over both time and distance), and that as the level of charge power of the Dragonfly decreases, the speed and other operational capabilities of the Dragonfly may decrease (or cease in their entirety).
- The rate of loss of charging power during the use of the Dragonfly is not guaranteed and will vary based on the Dragonfly, road conditions, weather conditions, and other factors.

1.11 Charging of Vehicle

Driver may charge the Dragonfly only by plugging a manufacturer-approved charging cord into an outlet that may be lawfully used for such purpose. Driver agrees to follow all laws and rules pertaining to the charging of the Dragonfly, including all state and local laws and all public and private rules and regulations pertaining to the area and to the property where Driver is charging the Vehicle.

2. ADDITIONAL TERMS OF USE

2.1 Safety Check

Before each use of a Dragonfly, Driver shall conduct a basic safety inspection of the vehicle, which includes inspecting the following: (i) trueness of the wheels; (ii) safe

operation of all brakes and lights; (iii) good condition of the deck, tiller, tires and wheels; (iv) sufficient battery charge power; and (iv) any sign of damage, unusual or excessive wear, or other open and obvious mechanical problem/maintenance need. Driver agrees not to drive the Dragonfly if there are any noticeable issues, and to immediately notify customer service to alert D-Fly of any problems.

2.2 Helmets; Safety

D-Fly recommends that all Drivers wear a Snell, CPSC, ANSI or ASTM approved helmet that has been properly sized, fitted and fastened according to the manufacturer's instructions. D-Fly does not represent or warrant the quality or safety characteristics of any helmet, and the Driver agrees that none of the Released Persons is liable for any injury suffered by Driver while using the Dragonfly, whether or not Driver is wearing a helmet at the time of injury. Driver assumes all risk of not wearing a helmet or other protective gear. Driver may need to take additional safety measures or precautions not specifically addressed herein.

3. GOVERNING LAW AND JURISDICTION; DISPUTE RESOLUTION AND BINDING ARBITRATION

All matters arising out of or relating to these Terms and Conditions are governed by and construed in accordance with the internal laws of the State of Delaware without giving effect to any choice or conflict of law provision or rule (whether of the State of Delaware or any other jurisdiction) that would cause the application of the laws of any jurisdiction other than those of the State of Delaware.

- YOU AND D-FLY ARE AGREEING TO GIVE UP ANY RIGHTS TO LITIGATE CLAIMS IN A COURT OR BEFORE A JURY, OR TO PARTICIPATE IN A CLASS ACTION OR REPRESENTATIVE ACTION WITH RESPECT TO A CLAIM. OTHER RIGHTS THAT YOU WOULD HAVE IF YOU WENT TO COURT MAY ALSO BE UNAVAILABLE OR MAY BE LIMITED IN ARBITRATION.
- ANY CLAIM, DISPUTE, OR CONTROVERSY (WHETHER IN CONTRACT, TORT, OR OTHERWISE, WHETHER PRE-EXISTING, PRESENT, OR FUTURE, AND INCLUDING STATUTORY, CONSUMER PROTECTION, COMMON LAW, INTENTIONAL TORT, INJUNCTIVE AND EQUITABLE CLAIMS) BETWEEN YOU AND US ARISING FROM OR RELATING IN ANY WAY TO YOUR PURCHASE OF PRODUCTS THROUGH THE WEBSITE, WILL BE RESOLVED EXCLUSIVELY AND FINALLY BY BINDING ARBITRATION.
- The arbitration will be administered by the American Arbitration Association ("AAA") in accordance with the Consumer Arbitration Rules (the "AAA Rules") then in effect, except as modified by this Section 3 (The AAA Rules are available at www.adr.org/arb_med or by calling the AAA at 1-800-778-7879). The Federal Arbitration Act will

govern the interpretation and enforcement of this section.

- The arbitrator will have exclusive authority to resolve any dispute relating to arbitrability and/or enforceability of this arbitration provision, including any unconscionability challenge or any other challenge that the arbitration provision or the agreement is void, voidable, or otherwise invalid. The arbitrator will be empowered to grant whatever relief would be available in court under law or in equity. Any award of the arbitrator(s) will be final and binding on each of the parties and may be entered as a judgment in any court of competent jurisdiction.
- You agree to an arbitration on an individual basis. In any dispute, NEITHER YOU NOR D-FLY WILL BE ENTITLED TO JOIN OR CONSOLIDATE CLAIMS BY OR AGAINST OTHER CUSTOMERS IN COURT OR ARBITRATION OR OTHERWISE PARTICIPATE IN ANY CLAIM AS A CLASS REPRESENTATIVE, CLASS MEMBER OR IN A PRIVATE ATTORNEY GENERAL CAPACITY. The arbitral tribunal may not consolidate more than one person's claims and may not otherwise preside over any form of a representative or class proceeding. The arbitral tribunal has no power to consider the enforceability of this class arbitration waiver and any challenge to the class arbitration waiver may only be raised in a court of competent jurisdiction.

If any provision of this arbitration agreement is found unenforceable, the unenforceable provision will be severed, and the remaining arbitration terms will be enforced.

4. GOODS NOT FOR RESALE OR EXPORT

You represent and warrant that You are buying the Dragonfly from the website for Your own personal or household use only, and not for resale or export. You further represent and warrant that all purchases are intended for final delivery to locations within the U.S.

5. RELEASES; DISCLAIMERS; ASSUMPTION OF RISK

Driver agrees to fully release, indemnify, and hold harmless D-Fly and all of its respective owners, managers, members, partners, officers, employees, contractors, officers, directors, equity holders, affiliates, successors and assigns (collectively, the "Released Persons") for all "Claims" arising out of or in any way related to Driver's use, possession or operation of, or participation with, the Dragonfly or any other user's use, possession or operation of, or participation with, the Dragonfly purchased by Driver, including, but not limited to, those Claims related to the legal possession, operation or use of the Dragonfly purchased by You and those Claims based on Released Persons' alleged negligence, breach of contract, and/or breach of express or implied warranty, except for Claims based on Released Persons' gross negligence or willful misconduct. This release is intended to be a general and complete release of all Claims. "Claims" means, collectively, any and all claims, injuries, demands, liabilities, disputes, causes of action (including statutory,

contract, negligence, or other tort theories), proceedings, obligations, debts, liens, fines, charges, penalties, contracts, promises, costs, expenses (including attorney's fees, whether incurred at trial, on appeal, or otherwise), damages (including but not limited to, for personal injury, wrongful death, property damage, and injury to driver or to third parties, consequential, compensatory, or punitive damages), or losses (whether known, unknown, asserted, unasserted, fixed, conditional, or contingent).

Driver acknowledges and agrees that driving the Dragonfly has certain inherent risks of injury and or death, which risks increase further if the vehicle is not used in accordance with safe driving procedures and the terms hereof and pursuant to the driver's manual. Driver is further aware that the usual risks, hazards and dangers of personal injury, death and disability increase when using ramps, curbs, steps, half pipes, inclines, or declines, bowls or any other structure or device. Driver also understands that these risks, hazards and dangers are further increased when other persons, whether or not of the same level of experience or skill, are using the same vehicle.

Further, Driver is aware that Driver's use of the Dragonfly involves obvious and not-so-obvious risks, dangers, and hazards that may result in injury or death to Driver or others and damage to property, and that such risks, dangers, and hazards cannot always be predicted or avoided. Risks, dangers, and hazards, include, but are not limited to:

- vehicles and other objects;
- pedestrians;
- traffic;
- vehicle or component malfunction;
- road conditions;
- weather conditions;
- failure to follow applicable laws regarding use and/or operation of the vehicle;
- commission of any of the prohibited acts listed in Section 1.4;
- failure to perform the required safety check pursuant to Section 2.1;
- failure to wear a helmet, including, but not limited to, where required by law; and
- negligent acts or omissions by D-Fly, any other Released Person, Driver, or third party.

Driver is solely and fully responsible for the safe and legal operation of the Dragonfly at all times. Driver agrees that vehicles are machines that may malfunction, even if the vehicle is properly maintained and that such malfunction may cause injury. Driver assumes full and complete responsibility for all related risks, dangers, and hazards. Driver ASSUMES THE RISK OF ANY INJURY OR DAMAGE TO PROPERTY OR PERSON ARISING FROM THE USE, POSSESSION OR OPERATION OF THE DRAGONFLY, AND D-FLY DISCLAIMS ANY LIABILITY FOR YOUR USE, POSSESSION OR OPERATION OF THE DRAGONFLY.

To the fullest extent permitted by law, this release and hold harmless agreement includes any and all Claims related to or arising from the sole or partial negligence of D-Fly, the Released Parties or any other party. Driver hereby expressly waives any claims against the Released Parties or any other party which Driver does not know or suspect to exist in Driver's favor at the time of use of the Dragonfly, and expressly waives Driver's rights under any statutes that purport to preserve Driver's unknown claims.

6. LEGAL STATUS

IT IS THE RESPONSIBILITY OF Driver, NOT D-FLY, TO ASCERTAIN, AND OBEY, ALL APPLICABLE LOCAL, STATE, FEDERAL AND INTERNATIONAL LAWS IN RESPECT OF THE USE, POSSESSION AND OPERATION OF THE DRAGONFLY, AND D-FLY DISCLAIMS ANY AND ALL LIABILITIES FOR YOUR COMPLIANCE WITH APPLICABLE LAW IN THE USE, POSSESSION OR OPERATION OF YOUR DRAGONFLY. Should your vehicle be confiscated by customs in Your country or any other country, you will NOT be refunded and You waive any rights you may have to deny Your payment to D-Fly.

7. MISCELLANEOUS

- You will not assign any of Your rights or delegate any of Your obligations hereunder without our prior written consent. Any purported assignment or delegation in violation hereof is null and void. No assignment or delegation relieves You of any of your obligations hereunder. The failure by us to enforce any right or provision hereof will not constitute a waiver of future enforcement of that right or provision. The waiver of any right or provision will be effective only if in writing and signed by a duly authorized representative of D-Fly. These Terms and Conditions do not and are not intended to confer any rights or remedies upon any person other than You.
- We may provide any notice to You hereunder by (i) sending a message to the email address You provide or (ii) by posting to the website. Notices sent by email will be effective when we send the email and notices we provide by posting will be effective upon posting. It is Your responsibility to keep your email address current.
- If any provision of these Terms and Conditions is invalid, illegal, void, or unenforceable, then that provision will be deemed severed from these Terms and Conditions and will not affect the validity or enforceability of the remaining provisions of these Terms and Conditions.
-

8. ACKNOWLEDGMENTS

These Terms and Conditions are effective and binding upon Driver's heirs, agents, personal representatives and assigns. Driver has read the foregoing and acknowledges that they understand and agree to all of the above terms and conditions. Driver has had

the opportunity to ask any and all questions regarding these Terms and Conditions and the effect of the same. Driver agrees that by purchasing items or sending payment for items, they assume all risks and waive and release certain substantial rights that they may have or possess.

9. Driver ACCEPTANCE

- Driver represents and certifies that Driver has read and expressly agrees to the Terms and Conditions hereof. Driver intends their assent to these Terms and Conditions to be a complete and unconditional release of all liability to the greatest extent permitted by applicable law.
- Driver represents and certifies that Driver is familiar with the operation of the Dragonfly, and is reasonably competent and physically fit to drive the vehicle.
- Driver represents and certifies that Driver is 18 years old or over, will wear a helmet where required by applicable law, will drive at Driver's own risk, will not drive a Dragonfly with another occupant, and will obey all applicable traffic laws.
- By placing an order, Driver represents that the Dragonfly will be used in a lawful manner.



11 DECLARATION OF CONFORMITY

D-FLY

Product name: DRAGONFLY - Model: DF
Max load: 120KG - Rated power: 500W
Year of Manufacture: 2023
FCC ID: 2BAVCFD & IC : 30366-DF
Business Name: D-FLY GLOBAL LIMITED
Address: 136 Kensington Church Street,
London, W8 4BH, England



CONFORMS TO
ANSI / CAN /
UL Std.2272



Intertek
5026686



ENERGY
PERFORMANCE
VERIFIED
RENDEMENT
ENERGETIQUE
VERIFIE

CONFORMS TO
BS EN17128:2020

Intertek
EP 5026359



Use only (54.6Vdc, 3A) Charger
Use only the battery pack supplied
with this Personal E-Mobility Device

⚠ WARNING Changes or modifications to this unit not expressly approved by the party responsible for compliance could void the user's authority to operate the equipment.

NOTE: This equipment has been tested and found to comply with the limits for a Class B digital device, pursuant to Part 15 of the FCC Rules. These limits are designed to provide reasonable protection against harmful interference in a residential installation. This equipment generates, uses and can radiate radio frequency energy and, if not installed and used in accordance with the instructions, may cause harmful interference to radio communications.

However, there is no guarantee that interference will not occur in a particular installation. If this equipment does cause harmful interference to radio or television reception, which can be determined by turning the equipment off and on, the user is encouraged to try to correct the interference by one or more of the following measures:

- Reorient or relocate the receiving antenna.
- Increase the separation between the equipment and receiver.
- Connect the equipment into an outlet on a circuit different from that to which the receiver is connected.
- Consult the dealer or an experienced radio/TV technician for help.

This device complies with Part 15 of the FCC Rules. Operation is subject to the following two conditions:

- (1) this device may not cause harmful interference, and
- (2) this device must accept any interference received, including interference that may cause undesired operation.

"FCC RF Radiation Exposure Statement Caution: To maintain compliance with the FCC's RF exposure guidelines, place the product at least 14cm from nearby persons.

This device contains license-exempt transmitter(s)/receiver(s) that comply with Innovation, Science and Economic Development Canada's license-exempt RSS(s). Operation is subject to the following two conditions:

- This device may not cause interference.
- This device must accept any interference, including interference that may cause undesired operation of the device.

L'émetteur/récepteur exempt de licence contenu dans le présent appareil est conforme aux CNR d'Innovation, Sciences et Développement économique Canada applicables aux appareils radio exempts de licence. L'exploitation est autorisée aux deux conditions suivantes :

- L'appareil ne doit pas produire de brouillage;
- L'appareil doit accepter tout brouillage radioélectrique subi, même si le brouillage est susceptible d'en compromettre le fonctionnement.

To maintain compliance with the RF exposure guidelines, place the product at least 14cm from nearby persons.

Pour rester en conformité avec les consignes d'exposition aux RF, placez le produit à au moins 14 cm des personnes proches.

⚠ FAILURE TO READ AND FOLLOW ALL INSTRUCTIONS MAY RESULT IN SERIOUS INJURY

CAN ICES-3(B)/NMB-3(B)



D-FLY

D-FLY GLOBAL LTD

adventurist

noun 🗨️ (ad-ven-chuh-rist)

Driven by natural curiosity and eager to try new things. People with a fascinating array of passions and interests. An exploratory spirit and insatiable appetite to find joy in everyday life! *Adventurists* are among the most interesting people you'll ever meet. The drivers through the Journey of Life.

Find your adventure. Drive Dragonfly!

