

EXPLORE
THE WORLD!
WEMUG®



2020 AUTUMN & WINTER

EXPLORE
THE WORLD!
WEMUG®

2020 AUTUMN & WINTER

INTRODUCTION

WEMUG ORIGINATES ITS PRODUCT FROM THE IDEA OF CREATING QUALITY AND CHICLY DESIGNED PORTABLE ITEMS FOR URBAN LIFESTYLE. STARTING FROM 2010, WEMUG BEGAN ITS WONDERFUL JOURNEY. WE BELIEVE THAT DRINKWARE SHOULD BE AN INTEGRATION OF FUNCTIONALITY AND FASHIONABILITY. THEY SHOULD BE AN EXPLICIT EXPRESSION OF ONES TASTE AND STYLE.

WEMUG BRINGS MY JOURNEY WITH SIMPLICITY AND STYLE.
MY JOURNEY COMES ALONG WITH MY OWN ATTITUDE.
MY WORLD. MY WAY.





| Brew Bottle Series |

BREW BOTTLE F550 365 DAYS

USDS **23.2**

Size: Height 183mm; Width 73mm / **Weight:** 126G / **Material:** Body - Tritan; Cap - PP; Inner LID - PP; Filter - PP; Nylon(Mesh cloth) / **Capacity :** 550ml / **Temp:** -20 °C- 100°C





| Brew Bottle Series |

BREW BOTTLE F550 365 DAYS



FROSTY
WHITE/
BLACK USD\$ **23.2**

FROSTY
WHITE+
BRONZE
CAP USD\$ **29.4**

Size: Height 183mm; Width 73mm / Weight: 126g/149g
Material: Body-Tritan / Cap & Inner Lid-PP / Stainless Steel (copper)
Capacity: 550ml / Temp: -20°C- 100°C



HOW TO MAKE COLD BREW TEA OR COFFEE?

STEP 1

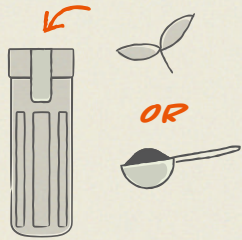

Put the Tea leaves /
Ground coffee into the filter.

STEP 2

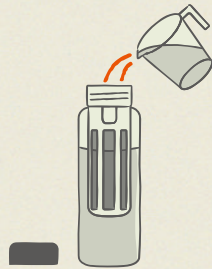

Add cold water.

STEP 3

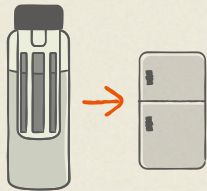

Close the lid and put
it in the fridge.

STEP 4

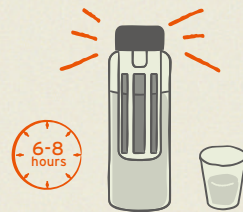

Enjoy your tea or
coffee after 6-8 hours.



WEMUG FILTER

NUDE USD\$ 9.2

| Brew Bottle Series |

COPPER BREW BOTTLE S550



PINK / STONE / CHOCOLATE

USD\$ **26.3**

Size: Height 183mm; Width 73mm / **Weight:** 149G / **Material:** Body - Tritan; Cap - PP/Stainless Steel; Inner LID - PP; Filter - PP;Nylon(Mesh cloth) / **Capacity :** 550ml / **Temp:** -20 °C- 100°C



| Brew Bottle Series |

COPPER BREW BOTTLE S650



GOLDEN YELLOW /
STONE / CHOCOLATE

USD\$ **27.8**

Size: Height 220mm; Width 73mm / **Weight:** 168G / **Material:** Body - Tritan; Cap - PP/Stainless Steel; Inner LID - PP; Filter - PP;Nylon(Mesh cloth) / **Capacity :** 650ml / **Temp:** -20 °C- 100°C

EXPLORE
THE WORLD!



W

WEMUG highly emphasizes imagination of a city, winning acclaim from Japan and European countries soon after its launch.

| Water Bottle Series |

EMOJI BOTTLE F550



01 BLUE

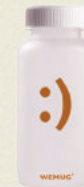

02 BROWN



03 YELLOW



04 GREEN

USDS **15.4**

Size: W73xH175mm / **Weight:** 100g / **Material:** Body - Tritan; Cap & Inner LID - PP / **Capacity:** 550ml / **Temp:** -20°C-100°C /

| Water Bottle Series |

EMOJI BOTTLE F550



05 OLIVE :-(

06 OLIVE XD

USDS **15.4**

Size: W73xH175mm / **Weight:** 100g / **Material:** Body - Tritan; Cap & Inner LID - PP / **Capacity:** 550ml / **Temp:** -20°C-100°C /



05 BLUE ;P

06 BLUE :-(

| Water Bottle Series |



01 PINK



02 BEIGE



03 GREEN



04 BLUE



05 BLACK

MILK BOTTLE F620

USD\$ 17.0

Size: Height 215mm; Width 70mm / **Weight:** 103G / **Capacity:** 620ml / **Material:** Body - Tritan;
Cap - PP; Inner LID - PP / **Temp:** -20°C- 100°C /



180° EASY OPEN



| Milk Bottle Series |

WEMUG AIRLINES STICKERS

USDS 6.1

Feature: Water resistance
One way to world. Adventure the lifestyle.

MILK BOTTLE + AIRLINES STICKERS SET USDS 20.1

| Water Bottle Series |

QUOTE F550



USDS **15.4**

Size: W73xH175mm / **Weight:** 100G / **Capacity:**550ml / **Material:** Body-Tritan Cap & Inner Lid-PP / **Temperature Range:** · -20°C to 100°C



SILI-CUP POUCH

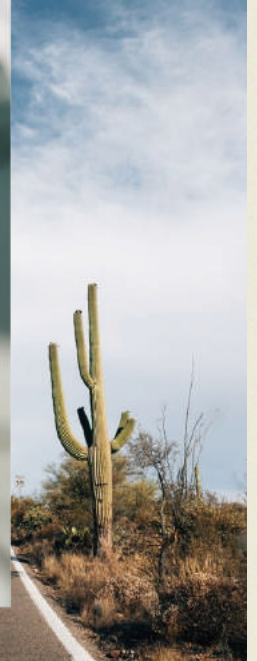

01 ORANGE



02 ARMY GREEN



03 YELLOW



04 BLUE



05 BEIGE

USDS **13.8**

Size: 130 x 150mm / **Weight:** 51g (cup only) / 61g (with Tyvek pouch) / **Capacity:** 200ml
Material: DuPont Tyvek high-density polyethylene fibers / **Temperature Range:** -50°C to 230°C
Features: Durable and washable

| BREW Bottle Series I

BREW BOTTLE SLEEVE



USD\$ **10.20** (SLEEVES ONLY)

Size: 11.5×16.5cm / **Weight:** 34g
Material: Neoprene



| BREW Bottle Series I

MILK BOTTLE SLEEVE



USD\$ **10.20** (SLEEVES ONLY)

Size: 11×18cm / **Weight:** 34g
Material: Neoprene

ADVENTURE THE LIFESTYLE

THE PASSION FOR ADVENTURE HAD BROUGHT TOGETHER A GROUP OF DESIGNERS FROM HONG KONG AND TAIWAN. THEY TRAVELLED ALL AROUND THE WORLD, EXPLORING FOR IDEAS. H.A.N.D WAS BORN OF SUCH PASSION IN 2013. CAPTURING THE UNIQUE CHARACTERS FROM WITHIN THE CITY AS WELL AS THE GREAT OUTDOORS, THEIR DESIGNS HAD FUSED THE FASHION OF THE CITY INTO THE OUTDOOR LIFESTYLE, CREATING A SERIES OF BAG THAT IS THE UNIQUE DESIGN CONCEPT OF H.A.N.D.

WHILE WE UTILIZE THE STURDY AND WATER RESISTANT NATURE OF THE FABRIC, WE ALSO DEMAND QUALITY CRAFTSMANSHIP. EVERY STITCH IS THERE TO EMPHASIZE THE ELEMENTAL SENSATION OF THE MATERIAL. THE SIMPLE LINES AND IMPACT OF COLORS BRING OUT THE LIVELY, CASUAL FEELING THAT LACKS IN MOST CONTEMPORARY DESIGNS.

TO CREATE YOUR OWN STYLE IS WHAT H.A.N.D. IS ALL ABOUT.



H.A.N.D
BY WEMUG & CO.



| H.A.N.D Sports Club |

FANNY BAG



Basket Ball

Tennis

Badminton



+



+



+



USD\$ **29.5** (SPORTS CLUB PIN INCLUDED)

Size: W270 H165 D65mm **Weight:** 143G / **Material:** Polyester

Features: · Water Repellent fabric · Light in weight · Tear-resistant ripstop fabric



| H.A.N.D Sports Club |

CUBE POUCH



USDS **21.7** (SPORTS CLUB PIN INCLUDED)

Size: W160 H100 D60 / **Weight:** 69G / **Material:** Polyester / **Features:** · Water Repellent fabric · Light in weight · Tear-resistant ripstop fabric



**EXPLORE
THE WORLD!**



WEMUG[®]

WEMUG & Lifestyle Ltd.

wemughk.com | 852-3521-0335 | sales@wemug.com.hk

Rm.152, 20/FI., Cityplaza Three, Taikoo Wan Road, Hong Kong.

Facebook : WEMUG | Instagram : wemug.hand