

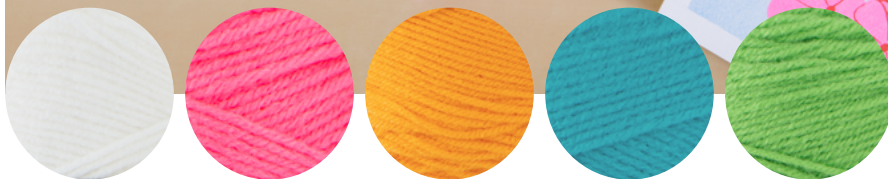

MAKE THIS

PUNCH NEEDLE COASTERS



White

Pretty 'n
Pink

Saffron

Turqua

Spring
Green

 CRAFT | SKILL LEVEL: **BEGINNER**





MAKE THIS

WHAT YOU'LL NEED



YARN

- **Red Heart® Super Saver®**
(7 oz/198 g; 364 yds /333 m)

COLORS

Quantity

- **Contrast A** White (0311)
1 ball
- **Contrast B** Pretty 'n Pink (0722)
1 ball
- **Contrast C** Saffron (0234)
1 ball
- **Contrast D** Turqua (0512)
1 ball
- **Contrast E** Spring Green (0672)
1 ball

TOOLS

- Susan Bates® Adjustable Punch Needle.
- 20" x 14" [51 x 35.5 cm] piece of Monk's Cloth for all 6 Coasters.
- Susan Bates® 5" [12.5 cm] Hoop-La Embroidery Hoop.
- Hot glue gun and glue sticks.
- Felt in color of your choice for Coaster backing.
- Scissors.
- Tape measure.



MAKE THIS

INSTRUCTIONS

MEASUREMENT

Approximately 4" [10 cm] diameter.

1. Transfer the design to fabric. *(See below for two methods)*

Note: See pages 6 to 8 for printed patterns. all designs are shown final size when printed at 100%.

Light box or window source

1. Place the printed pattern on a light box or tape to a window- sunny days are best.
2. Center the cloth over the pattern and tape or hold in place.
3. Trace pattern onto cloth with pencil or felt tip marker.

In Hoop method

1. Cut out the pattern.
2. Center and tape the pattern to the inside of the hoop.
3. Trace pattern onto cloth with pencil or felt tip marker.
Remove pattern.



2. Place fabric in Anchor® Embroidery Hoop.





MAKE THIS

INSTRUCTIONS

3. Thread Susan Bates® Punch Needle following package instructions. Yarn should move freely through the barrel of the needle. Set Needle to Position A – 24mm.



4. Keep in mind that the loop side of your project will be the reverse of what you have traced.
5. Start with the main outline of the design then move to the smaller details following colors indicated on diagrams.

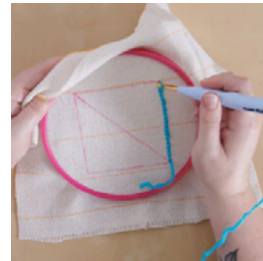
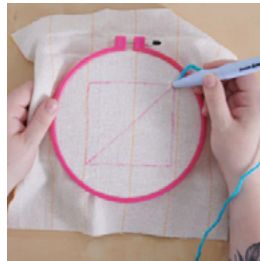

6. Keep slack on yarn as you punch so that the yarn will stay in the cloth. If you have too much tension on the yarn it will pull back up as you pull up your needle for the next punch.
7. Keep the opening (eye) of the needle facing the direction you are punching.
8. Be sure to punch the needle all the way down until the handle touches the foundation cloth.

9. **Do not** lift the needle too high out of your cloth in between punches. Again, the tension will pull up the prior stitches. Drag the needle across the cloth to the next punch.

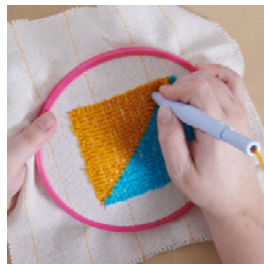



MAKE THIS

INSTRUCTIONS

10. Once complete, trim excess fabric around each Coaster, leaving a ½" [1.5 cm] border.



11. Using hot glue, fold the edges to back of work and glue in place.



12. Cut felt to shape of Coaster and glue to back.



We love seeing your makes! Share your photos using #YARNSPO and tag us @yarnspirations on Instagram or find us on Facebook.



MAKE THIS

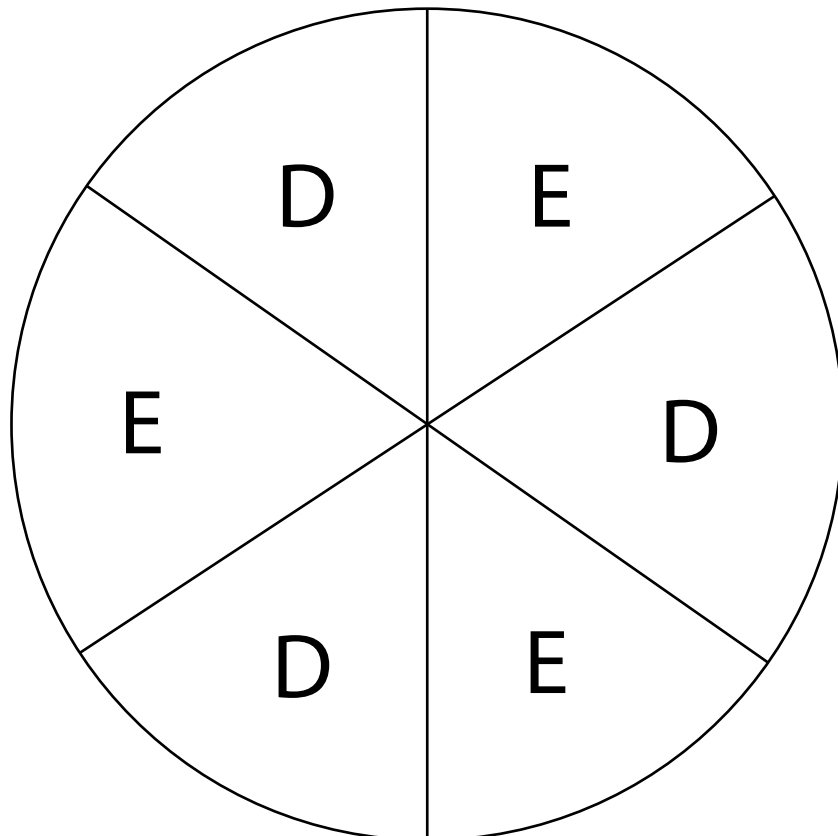
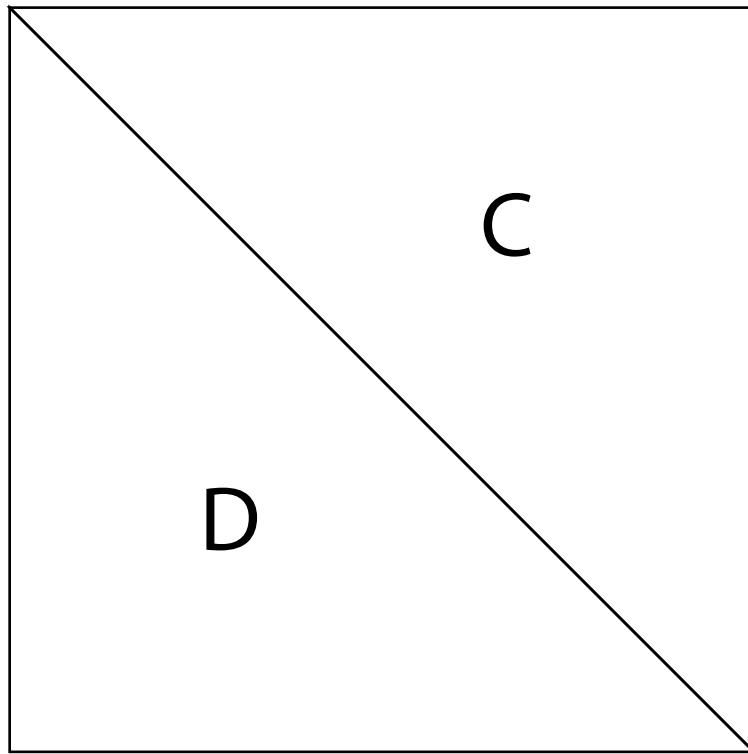



MAKE THIS

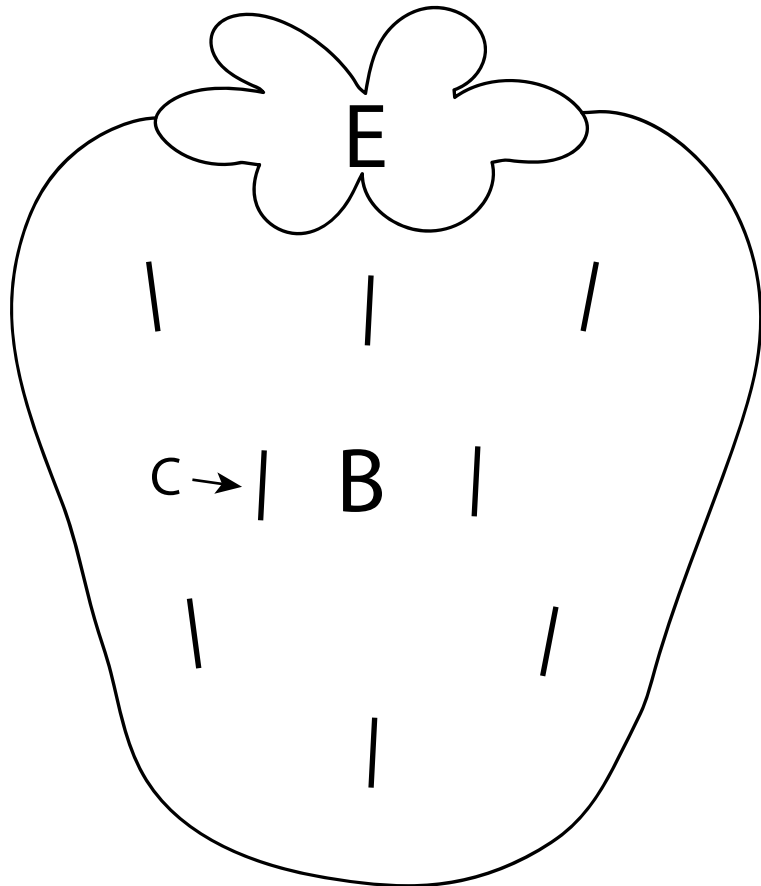
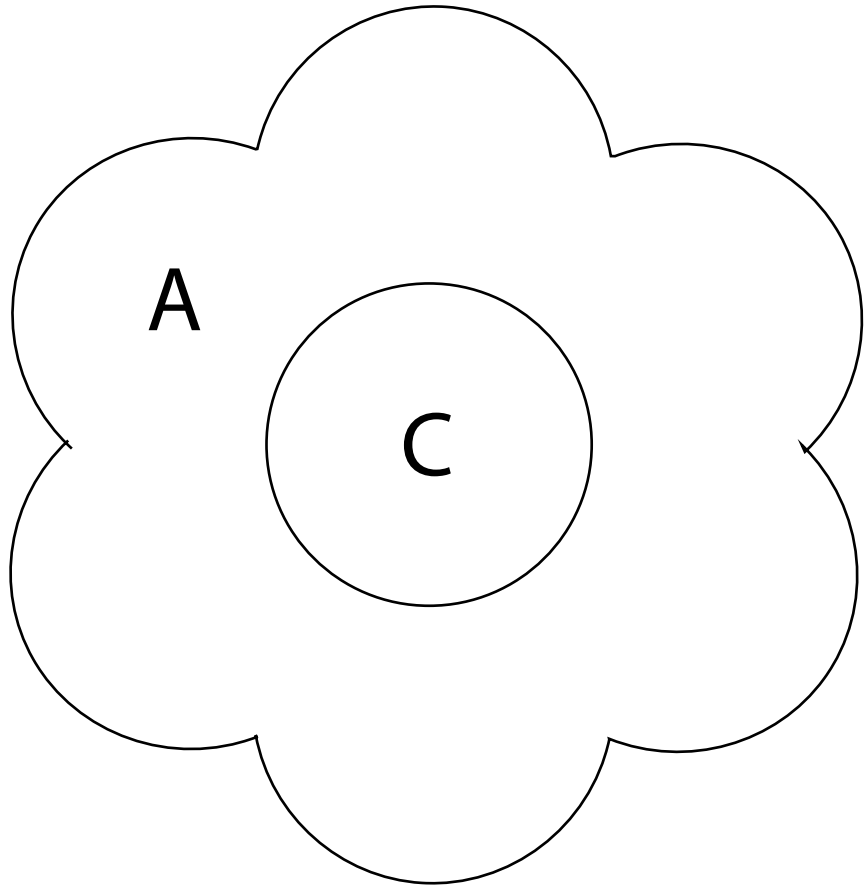



MAKE THIS

