



Emily Berney  
Designer



CROCHET | SKILL LEVEL: INTERMEDIATE

## ABBREVIATIONS

**Beg** = Beginning

**Ch** = Chain(s)

**Hdc** = Half double crochet

**Hdcbp** = Yoh and draw up a loop around post of next sttich at back of work, inserting hook from right to left. Yoh and draw through all loops on hook.

**Hdcfp** = Yoh and draw up a loop around post of next stitch at front of work, inserting hook from right to left. Yoh and draw through all loops on hook.

**Rem** = Remaining

**Rep** = Repeat

**Rnd(s)** = Round(s)

**Sc** = Single crochet

**Sc2tog** = Draw up a loop in each of next 2 sc. Yoh and draw through all 3 loops on hook

**Sl st** = Slip stitch

**St(s)** = Stitch(es)

**Yoh** = Yarn over hook

## MATERIALS

Patons® Classic Wool Worsted™ (3.5 oz/100 g; 194 yds/177 m)

Contrast A Desert (77752)

1 ball

Patons® Alpaca Blend™ (3.5 oz/100 g; 155 yds/142 m)

Contrast B Yam (01021)

1 ball

Size U.S. H/8 (5 mm) crochet hook **or size needed to obtain gauge.** Large eye embroidery needle. **Optional:** Sticky-back water soluble fabric stabilizer to transfer embroidery motif.

## SIZE

One size to fit Adult.

## GAUGE

14 sc and 17 rows = 4" [10 cm] with Contrast A.

## INSTRUCTIONS

**Notes:** Join all rnds with sl st to first st.

Ch 2 at beg of rnd **does not** count as st.

With A, ch 72. Join with sl st to first ch making sure not to twist ch.

**1st rnd:** Ch 2. 1 hdc in each ch around. Join. 72 hdc.

**2nd rnd:** Ch 2. \*1 hdcfp around next hdc. 1 hdcbp around next hdc. Rep from \* around. Join. Rep 2nd rnd for 2" [5 cm].

**Next rnd:** Ch 1. 1 sc in each st around. Join.

Rep last rnd until work from beg measures 6½" [16.5 cm].

**Shape top: 1st rnd:** Ch 1. \*1 sc in each of next 7 sc. Sc2tog. Rep from \* around. Join. 64 sc.

**2nd rnd:** Ch 1. \*1 sc in each of next 6 sc. Sc2tog. Rep from \* around. Join. 56 sc.

**3rd rnd:** Ch 1. \*1 sc in each of next 5 sc. Sc2tog. Rep from \* around. Join. 48 sc.

**4th rnd:** Ch 1. \*1 sc in each of next 4 sc. Sc2tog. Rep from \* around. Join. 40 sc.

**5th rnd:** Ch 1. \*1 sc in each of next 3 sc. Sc2tog. Rep from \* around. Join. 32 sc.

**6th rnd:** Ch 1. \*1 sc in each of next 2 sc. Sc2tog. Rep from \* around. Join. 24 sc.

**7th rnd:** Ch 1. \*1 sc in next sc. Sc2tog. Rep from \* around. Join. 16 sc.

**8th rnd:** Ch 1. \*Sc2tog. Rep from \* around. Join. 8 sc.

Fasten off leaving long end. Draw end tightly through rem sts and fasten securely.

Using B and template, embroider floral motif onto side of Hat (see page 3).

**Optional:** Using a sticky-back water soluble stabilizer, draw embroidery design on stabilizer, attach onto Hat and embroider.



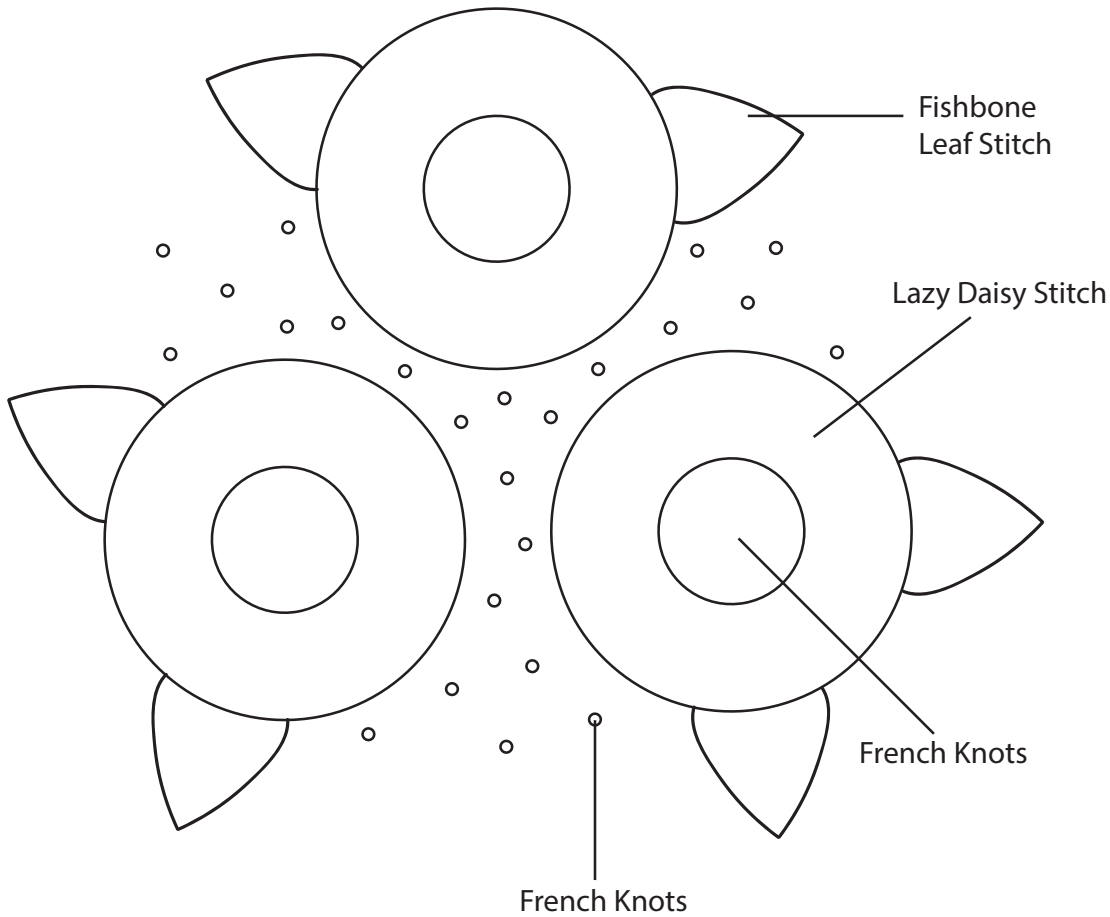

Fishbone Leaf Stitch

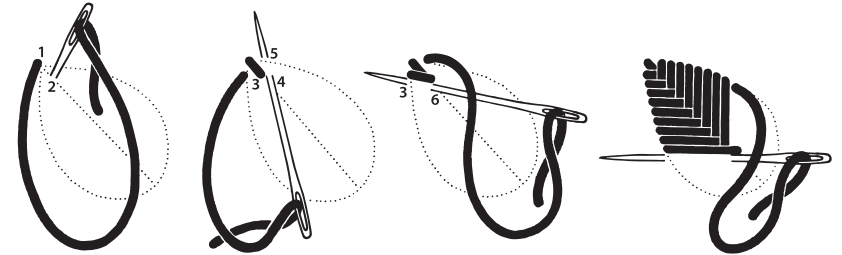

Lazy Daisy Stitch

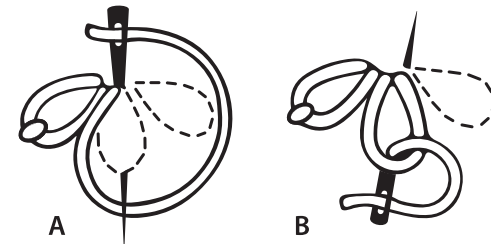

French Knots

