



MATERIALS

Coats & Clark™ Dual Duty XP® All-purpose thread

Coats & Clark™ Machine Quilting thread

Coats & Clark™ Dual Duty Plus® Hand Quilting thread

Fabric required:	1/8 yard (.11m) of second border fabric
Each cardinal requires three different reds, A, B and C. Also needed are gold D and gray E for the beak.	1/8 yard (.11m) of second cornerstone fabric
1/8 yard (.11m) of red fabric A	Scraps for the border
1/8 yard (.11m) of red fabric B	3/4 yard (1.60m) light, neutral fabric for background F and backing
1/8 yard (.11m) of red fabric C	3/8 yard (.34m) for binding
1/8 yard (.11m) of gold fabric D	Cotton batting 45" X 45"(115cm x 115cm)
1/8 yard (.11m) of gray fabric E	(4) large black beads for eyes
1/8 yard (.11m) of first border fabric	
1/8 yard (.11m) of first cornerstone fabric	

 SEWING | SKILL LEVEL: **INTERMEDIATE**

Featuring Coats & Clark™ Dual Duty XP® All-purpose thread

Nothing says winter holidays quite like the majestic cardinal! This patchwork quilt captures its distinctive red color. Quilted by hand or machine, this 40" (102cm) square size is perfect for a wall hanging, couch throw or table topper. Coats & Clark™ Hand Quilting thread creates hand stitches that accent the details of this quilt.

MEASUREMENTS

40" x 40" (102cm x 102cm)

CUT

Print the pattern pieces (pages 11-14). Each pattern piece is marked with the fabric letter it should be cut from. For fabrics A, B, C D and E, cut the fabric into fourths, measuring 4½" x 11" (11cm x 28cm). Stack the fabrics with the right side up. Then pin the pattern pieces on. This will result in four of each pattern piece.

From fabric A:

Cut four each from pieces 11, 16, 17 and 18.

From fabric B:

Cut four each from pieces 21 and 8

From fabric C:

Cut four each from pieces 5, 6 and 10

From fabric D:

Cut four from piece 26

From fabric E:

Cut four from piece 14

From background fabric:

Cut ½ yard (.46m) of background fabric into four pieces 11" x 18" (28cm x 46cm). Stack them right side up. Pin on the pieces 1, 2, 3, 4, 7, 9, 13, 15, 19, 22, 23, and 25 and cut them out.

28 squares 3" x 3" (8cm x 8cm)

From assorted colors:

29 squares 3" x 3" (8cm x 8cm)

From first border fabric:

Four strips 28" x 3½" (71cm x 9cm)

From first cornerstone fabric:

Four squares 3½" x 3½" (9cm x 9cm)

From second border fabric:

Four strips 34" x 3½" (86cm x 9cm)

Four strips 2¾" (7cm) x width of fabric for binding

From second cornerstone fabric:

Four squares 3½" x 3½" (9cm x 9cm)

From the fabrics for backing:

One square 41" x 41" (104cm x 104cm)

Notes:

- All seams ¼" (.5cm).
- Press the seams open after each step. Note: Many quilters prefer to press the seams to the side. Either is correct, but you may find that you can be more precise if you press the seams open.

SEWING

1. Thread with Coats & Clark™ Dual Duty XP® All-purpose or Coats & Clark™ Machine Quilting thread.
2. Preliminary piecing. Stitch (4F to 5C), (7F to 8B), (9F to 10C), (18A to 19F) and (21B to 22F).

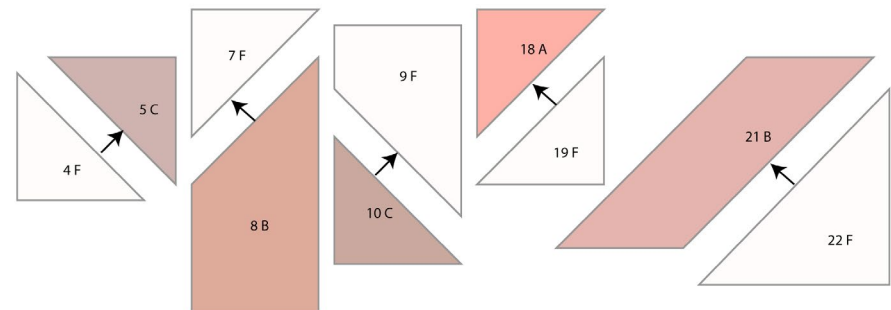

3. Stitch 4F/5C to 6C.

4. Then add it to 3F

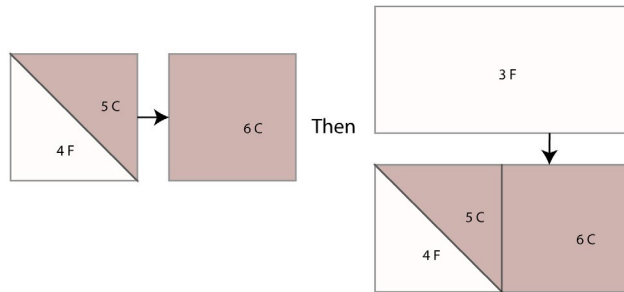

5. Next add 7F/8B to the ones just sewn.

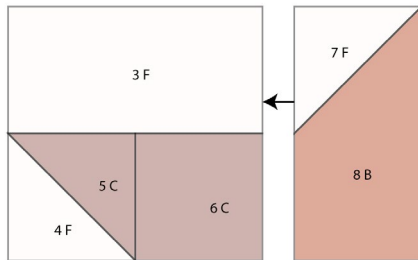

6. Add 2F to the group and then add 1F.

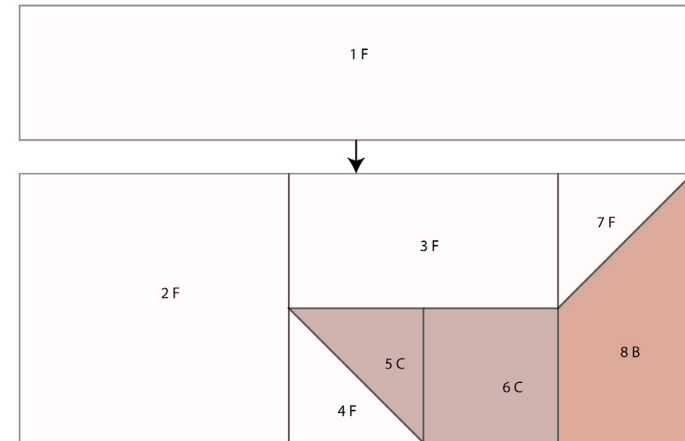

7. Add 9F/10C to 11A. Then add 18A/19F to the other end of 11A.

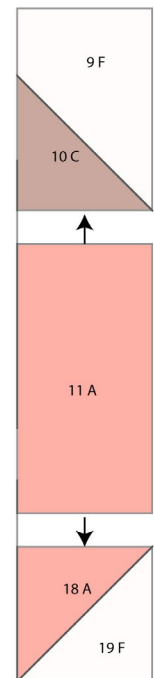

8. Stitch 21B/22F to 23F

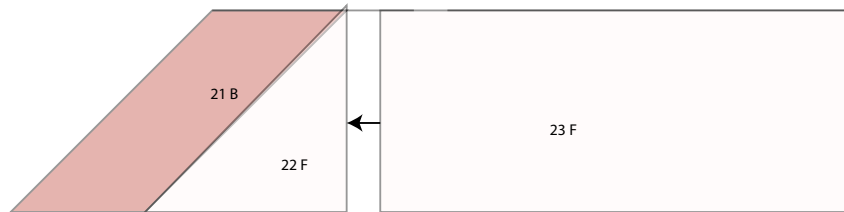

9. Stitch a partial seam as shown joining 16A/17A to 21B/22F/23F.

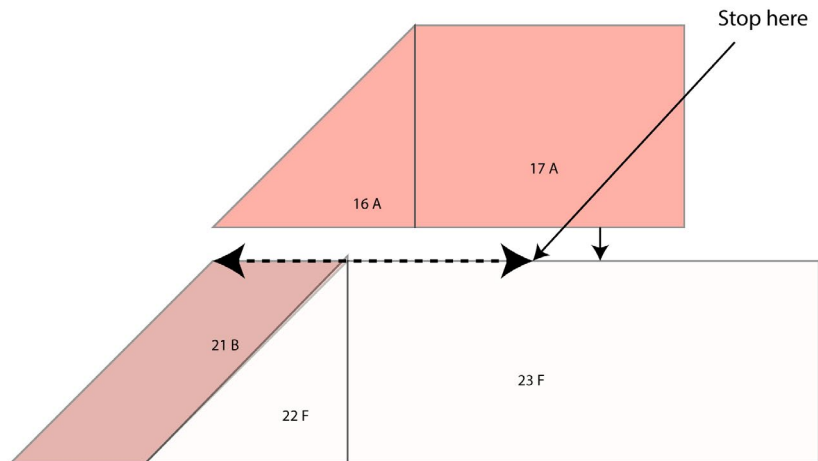

10. Add 15F to 16A/17A/21B/22F/23F.

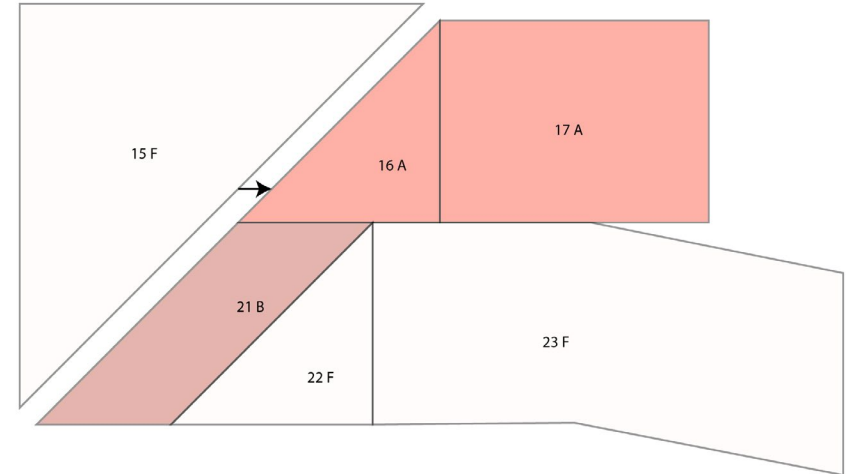

11. Sew 1F/2F/3F/4F/5C/6C/7F/8B to 15F/16A/17A/21B/22F/23F.

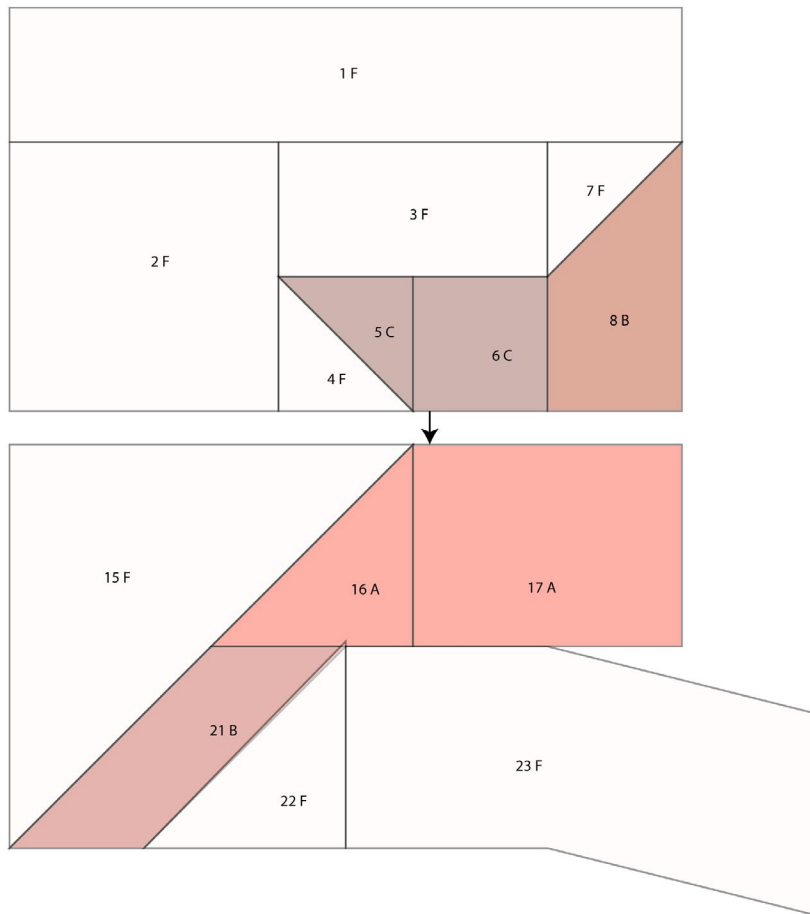

12. Add 9F/10C/11A/18A/19F to the pieced block.

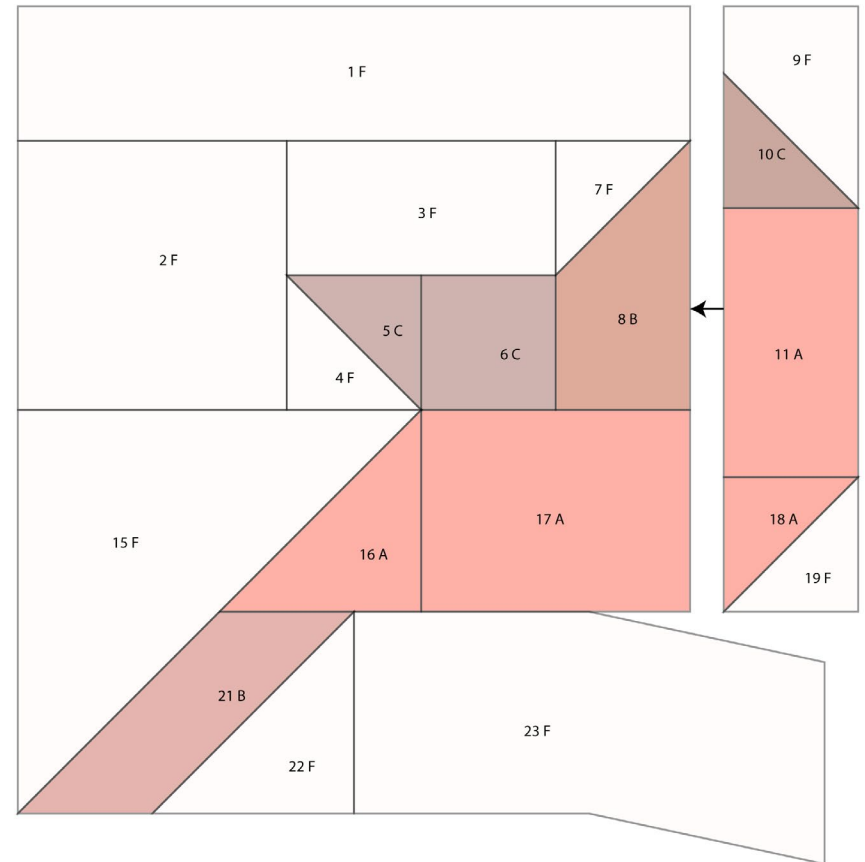

13. Finish sewing the seam we left partially sewn.

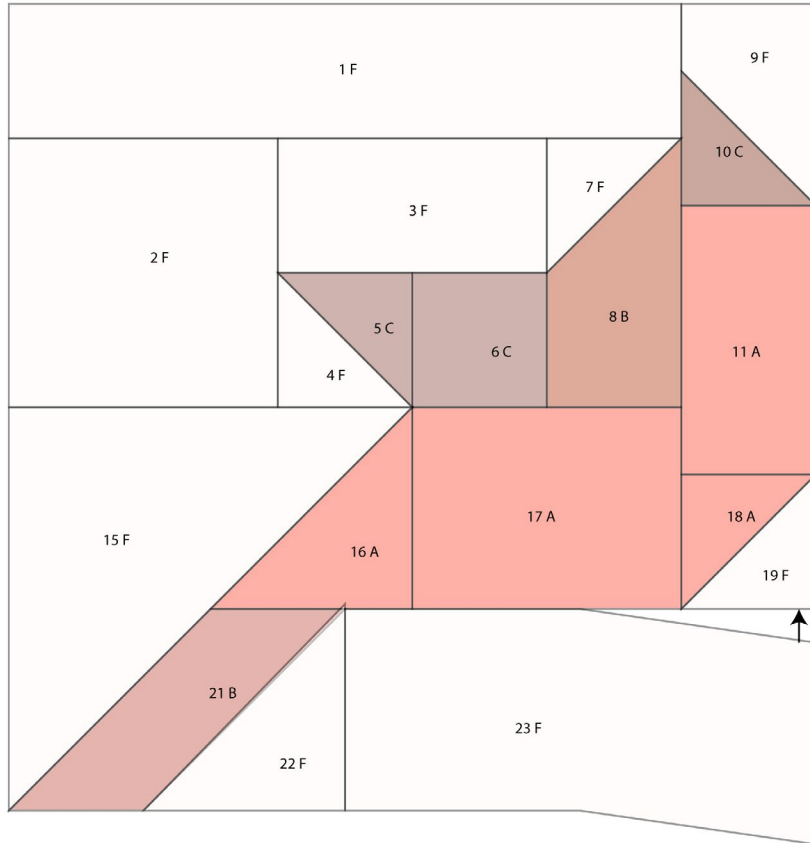

14. Add the final two strips, first 13F, then 25F.

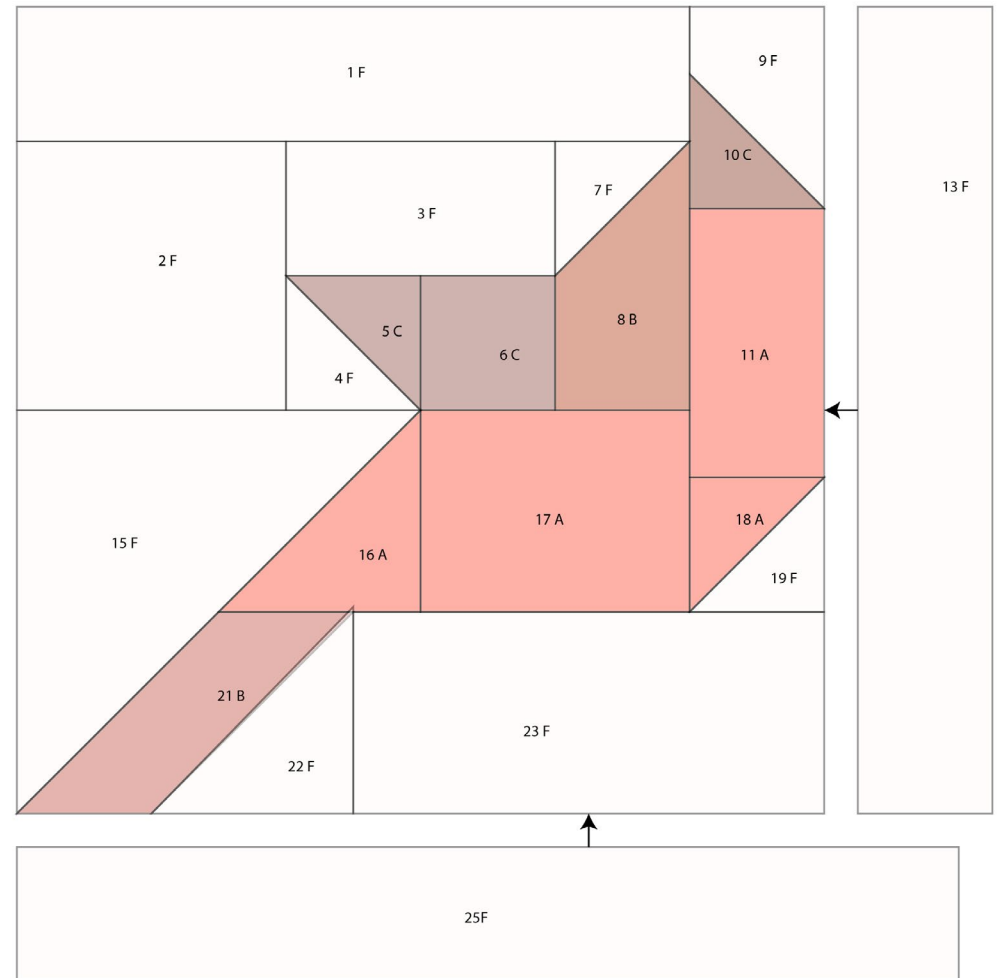

15. Applique 26D and 14E on block for Beak as shown in photo. The Cardinal blocks are now finished!
16. Next, the colored square border will be added around the blocks. Create the strips shown using the 3" (8cm) squares you cut. You can follow the colors shown or you can lay out your blocks and create your own configuration.

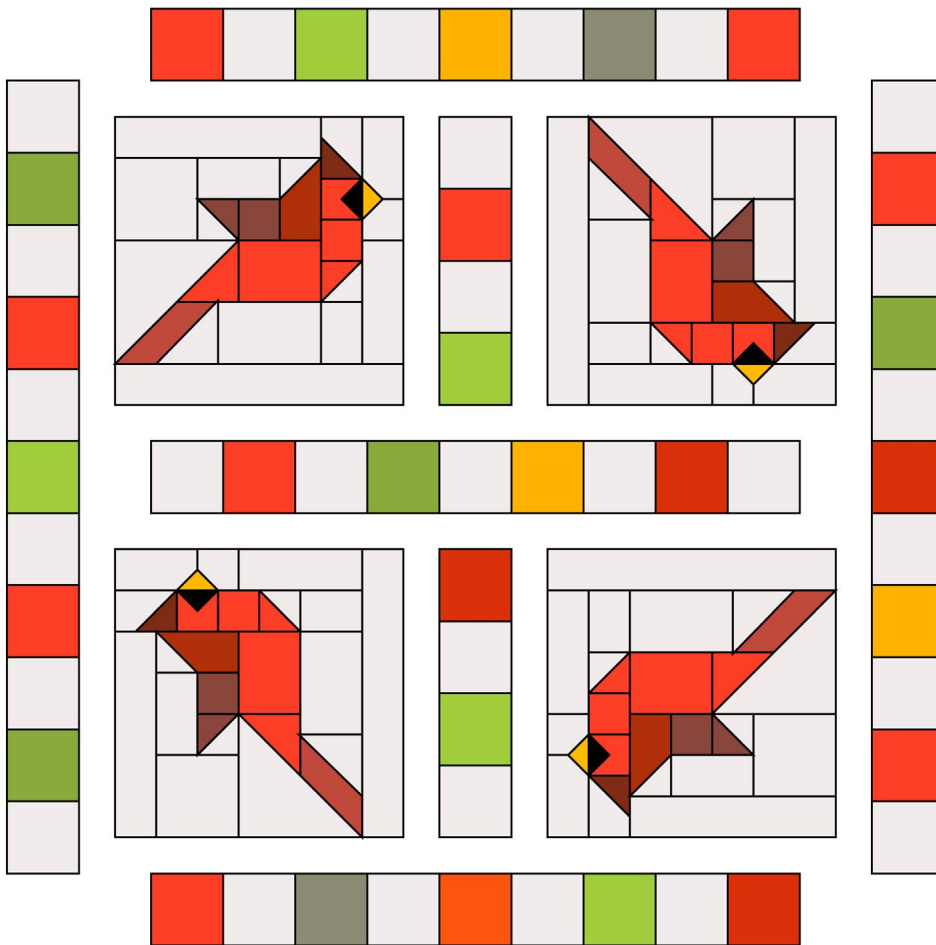

17. Add the strips between the cardinal blocks as shown.

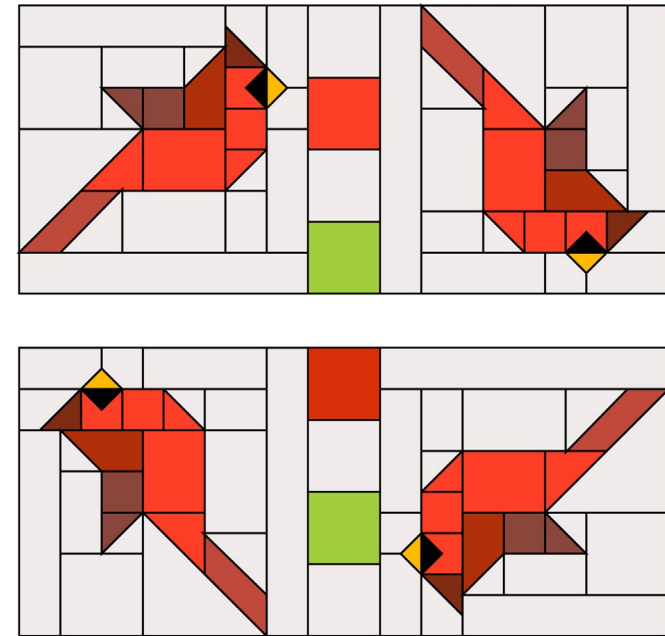

18. Add the center, upper and lower strips as shown.

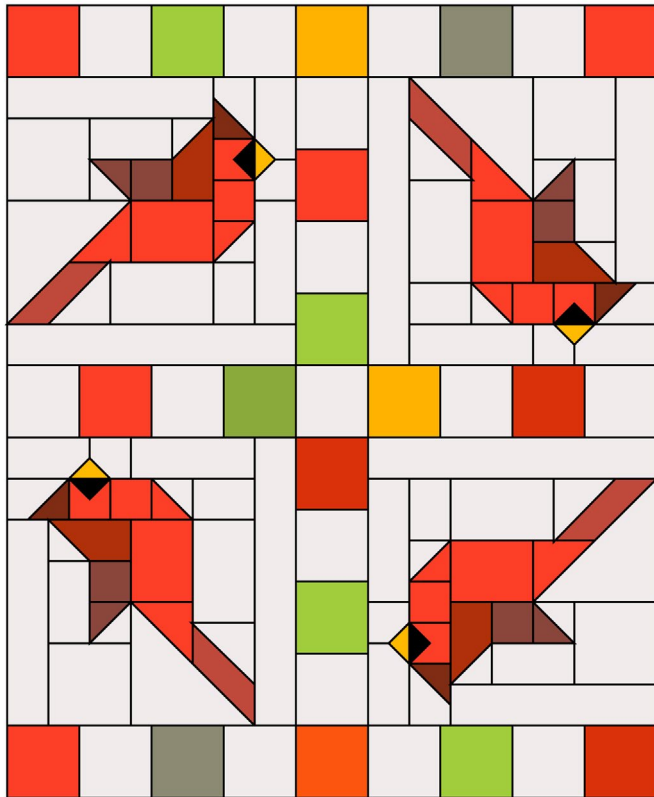

19. Add the side strips.

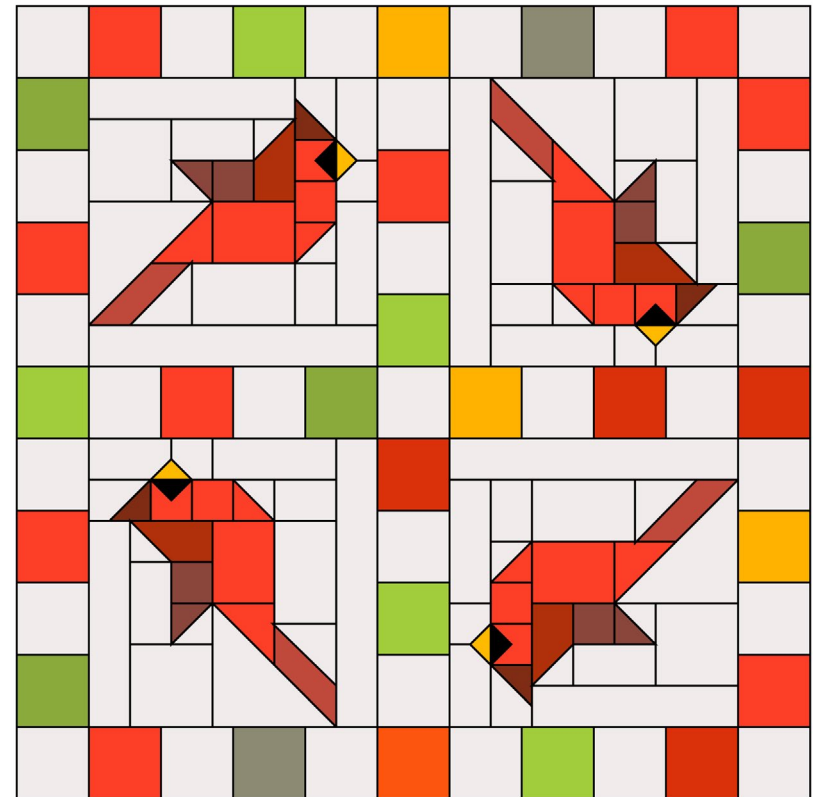

20. Sew two of the 28" x 3½" (71cm x 9cm) first border strips on the top and bottom of the quilt.

21. Sew the first cornerstone $3\frac{1}{2}$ " x $3\frac{1}{2}$ " (9cm x 9cm) squares to the top and bottom of the other two 28 " x $3\frac{1}{2}$ " (71 cm x 9cm) first border strips.

23. Repeat with the second border and second cornerstone squares.

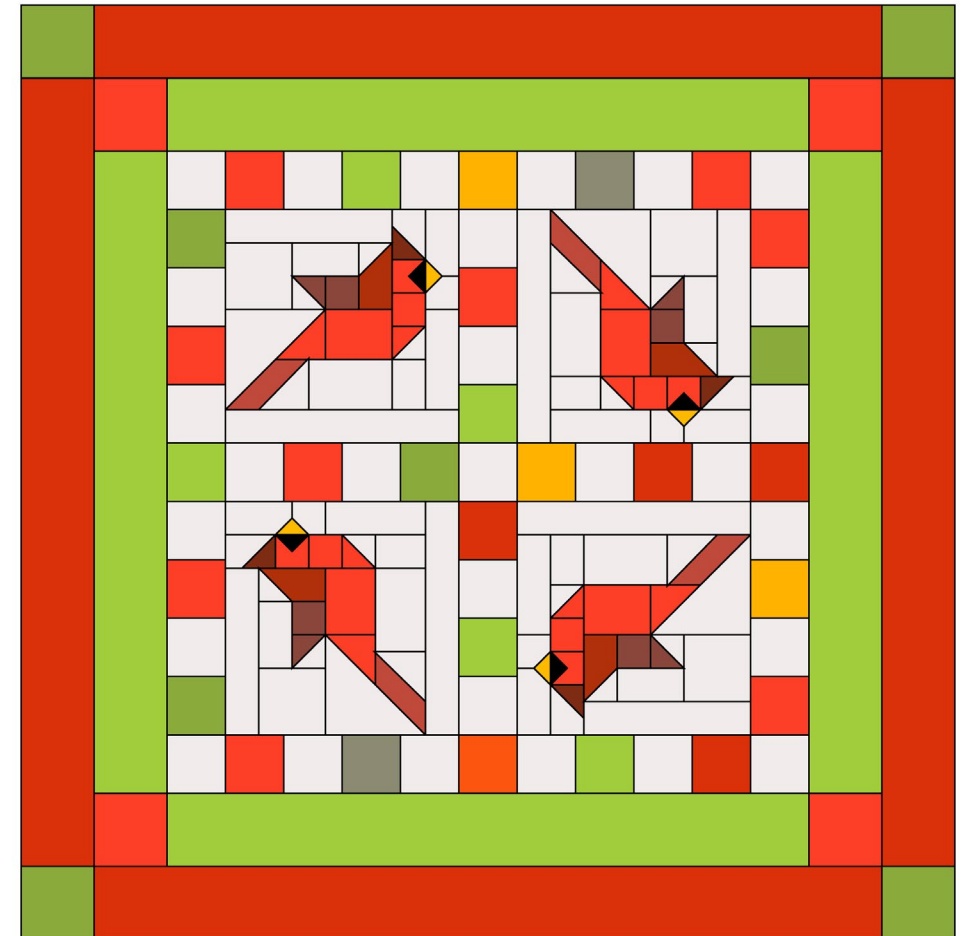
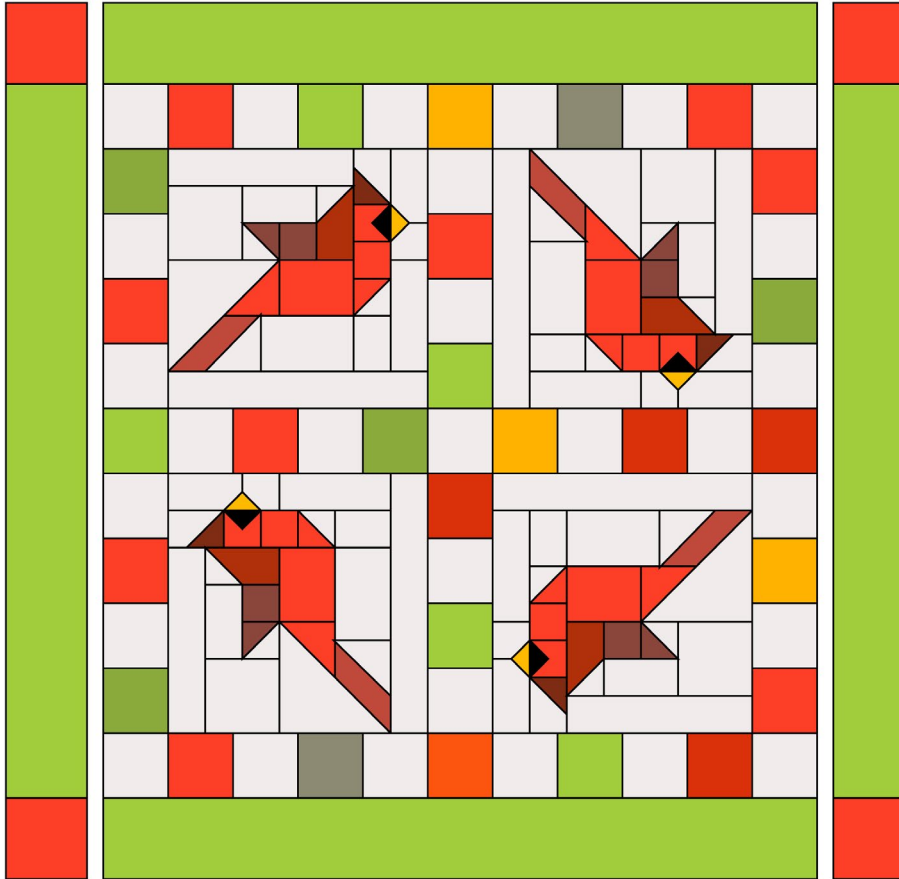

22. Finish by adding the side borders of the quilt.

24. The quilt top is complete!

25. To quilt it, layer it with the 41" x 41" (104cm x 104cm) backing fabric and cotton batting.
26. Follow the quilting diagram and quilt your quilt by hand or machine.
27. Trim off the excess batting and backing even with the outer edge of the quilt.
28. Stitch the binding strips end to end and press in half, lengthwise.
29. Bind the quilt.
30. Sew on the beads for eyes.

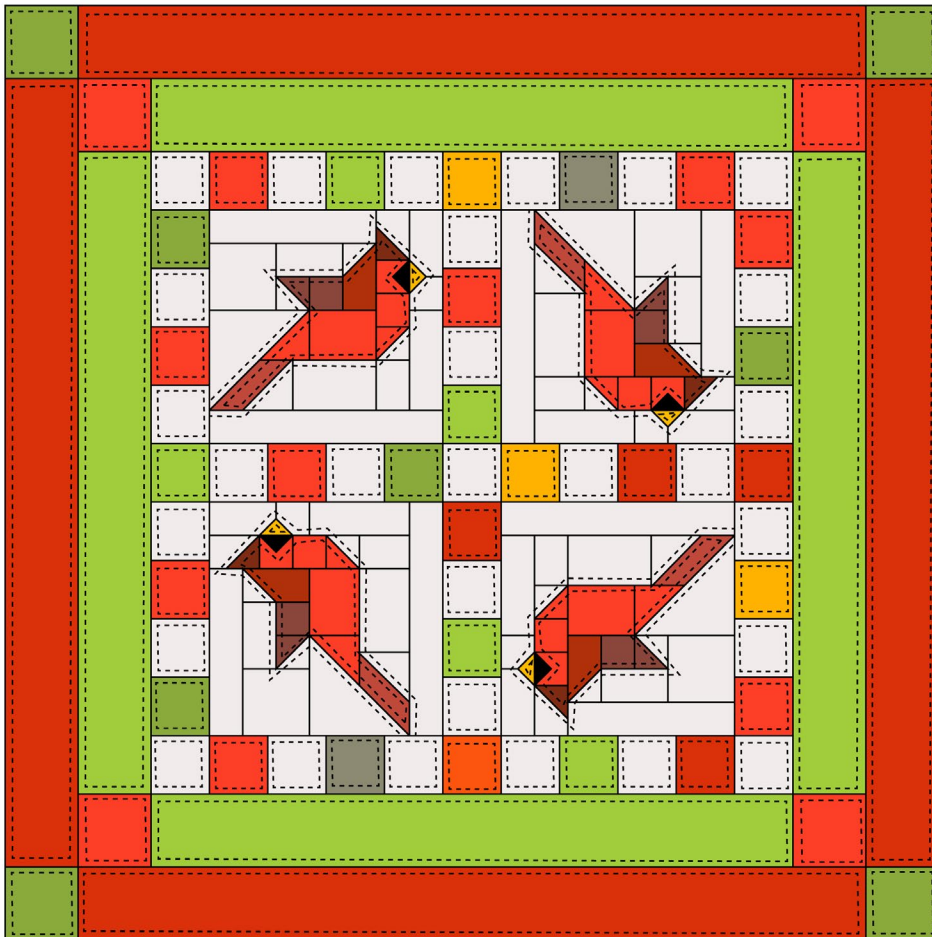

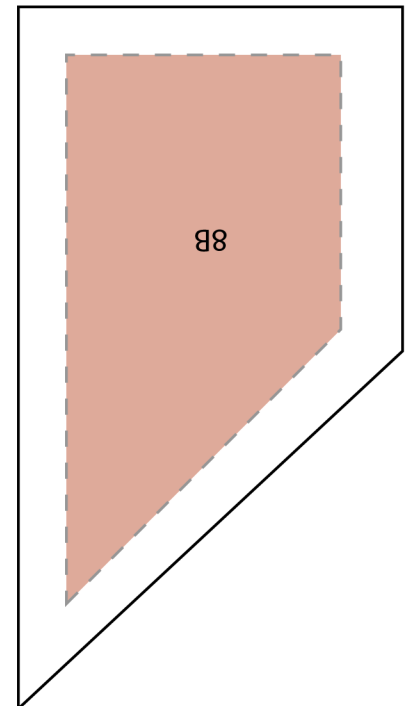
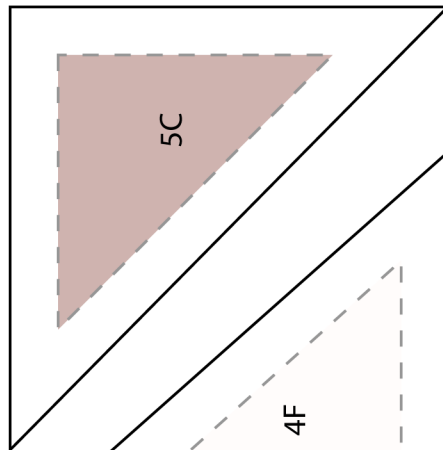
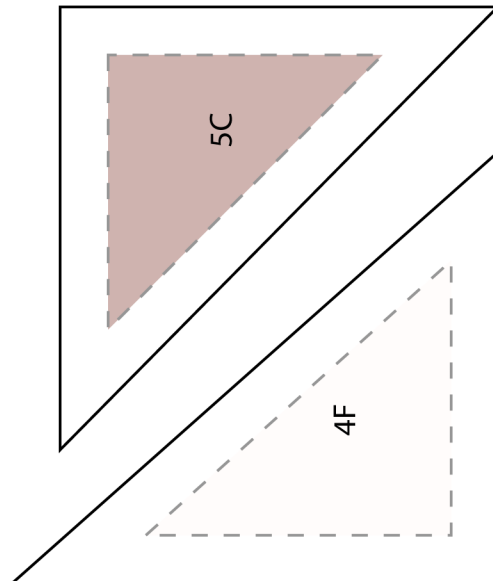
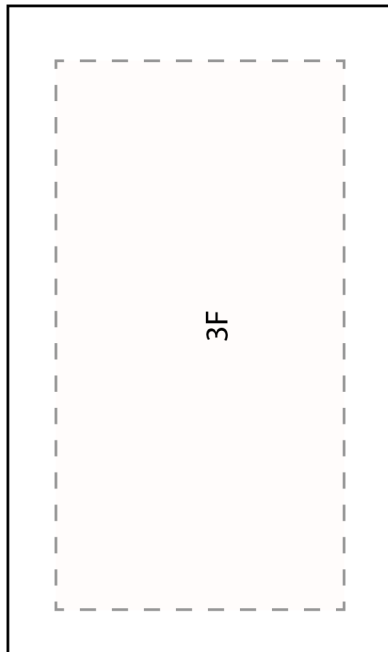
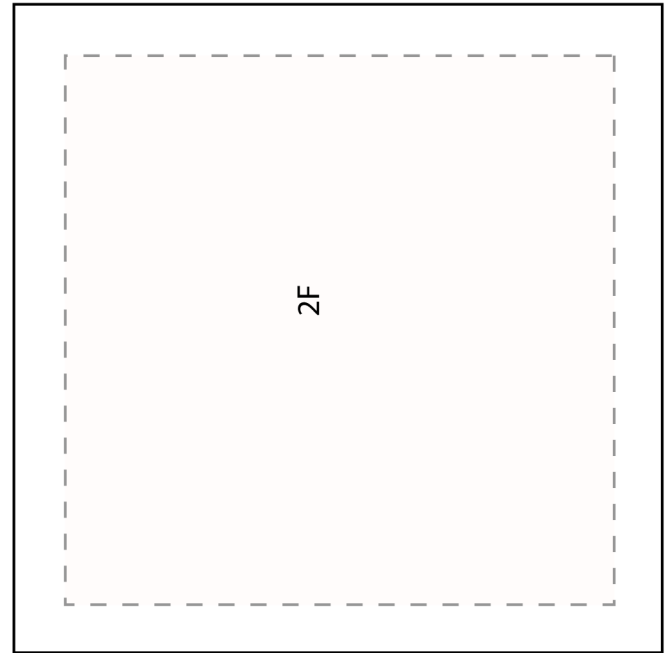
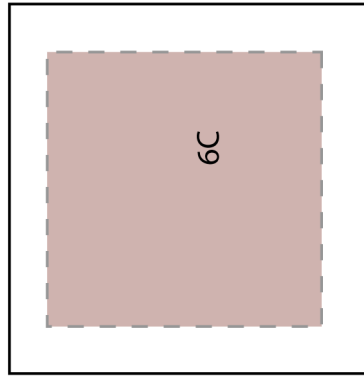
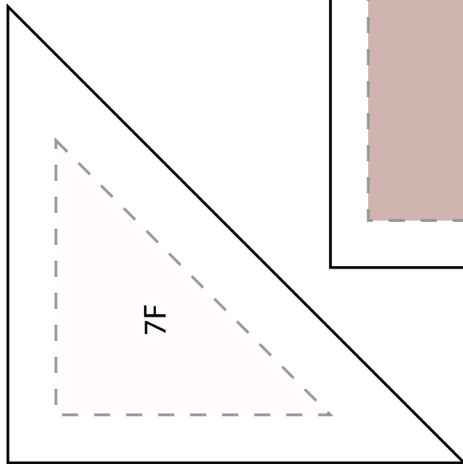
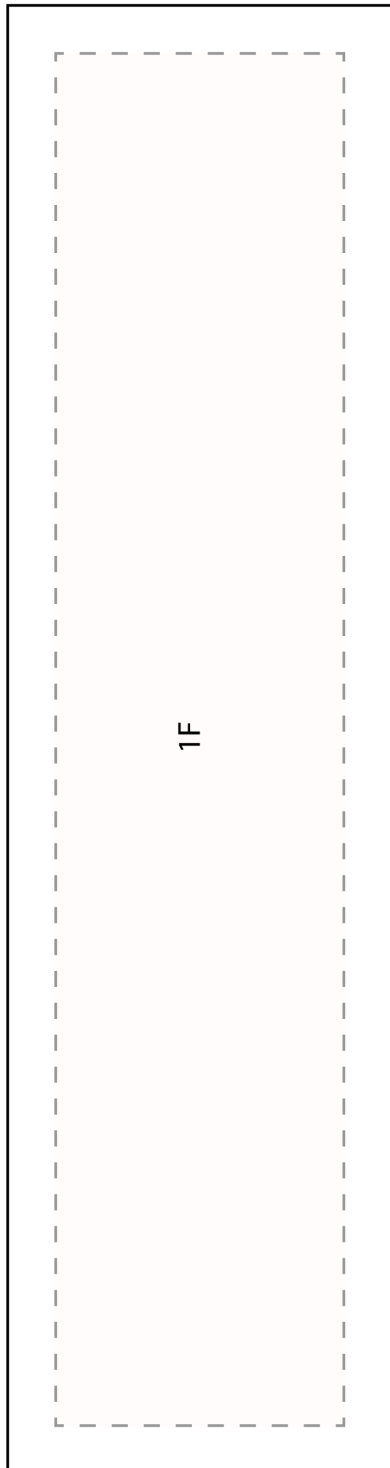

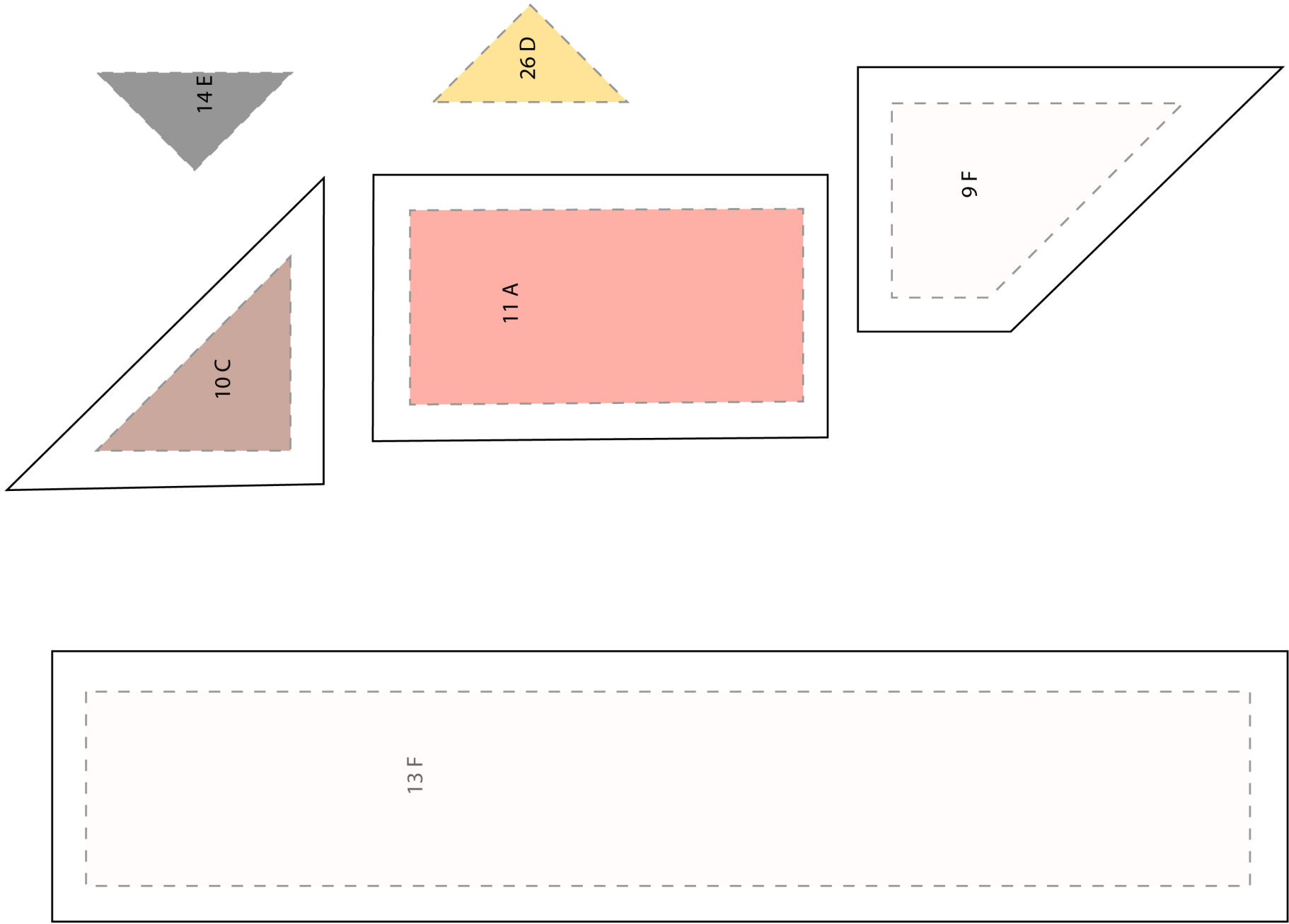

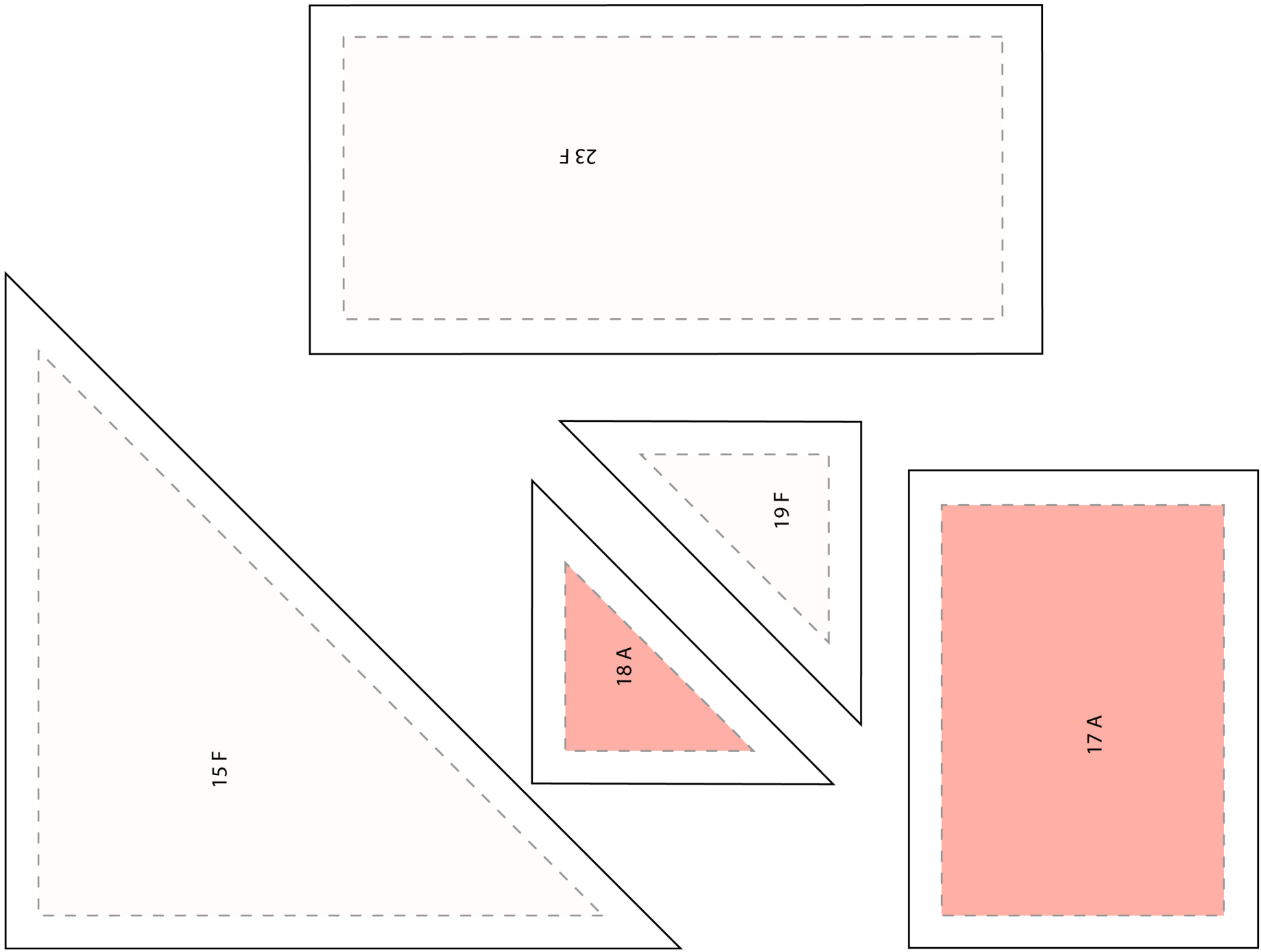

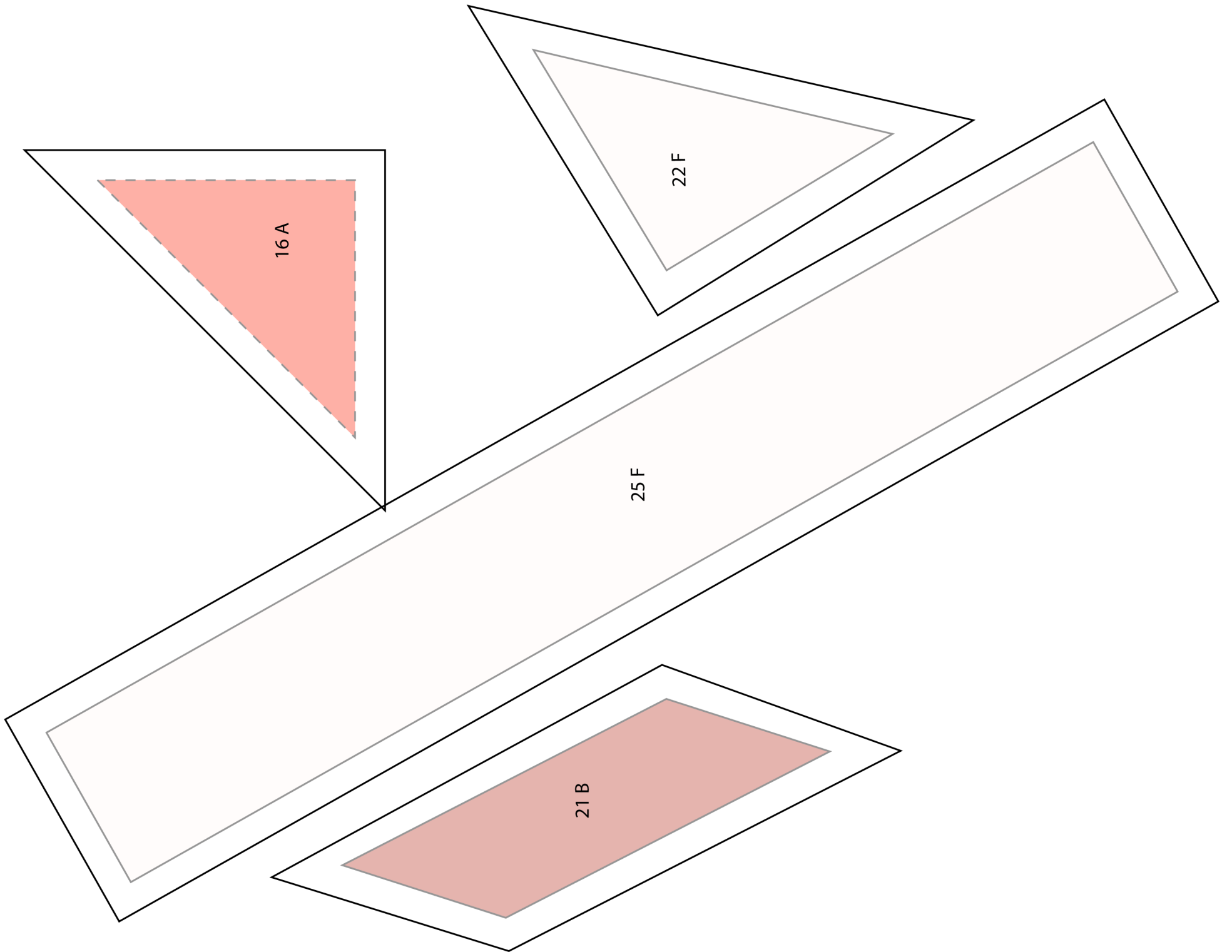

16 A

22 F

25 F

21 B